

---

## **Traffic Safety Council**

### **Date**

2017/06/21

### **Time**

5:00 P.M.

### **Location**

Hearing Room, 2<sup>nd</sup> Floor, Civic Centre  
300 City Centre Drive, Mississauga, ON L5B 3C1

### **Members**

Councillor Sue McFadden, Ward 10  
Councillor Chris Fonseca, Ward 3  
Councillor John Kovac, Ward 4  
Sandra Beniuk, Citizen Member  
Arvind Bhaskar, Citizen Member  
Brad Butt, Citizen Member  
Robert Crocker, Peel District School Board Trustee  
Tamara Coulson, Citizen Member  
Louise Goegan, Citizen Member  
Denise Gordon-Mohamud, Citizen Member  
Sushil Kumra, Citizen Member  
Heather Relf, Citizen Member (Vice-Chair)  
Ajay Sharma, Citizen Member  
Mashkoor Sherwani, Citizen Member  
Daniel Suess, Citizen Member  
Boris Swedak, Life Member  
Altamash Syed, Citizen Member  
Thomas Thomas, Dufferin-Peel Catholic District School Board Trustee  
Katherine Vukobrat, Citizen Member  
Peter Westbrook, Citizen Member (Chair)

**ADVISORY BOARD**

Andy Bate, Manager, Traffic Services and Road Safety

Anna Capuano, Principals/Vice-Principals Association Dufferin-Peel Catholic District School Board

Sheelagh Duffin, Supervisor, Crossing Guards

Daniel Elias, Principals/Vice-Principals Association Peel District School Board

Chris Ellis, Acting Manager, Parking Enforcement

Anna Gentile/ Marcy Macina - Central Planning and Operations Officer, Student Transportation of Peel Region (STOPR)

Alex Liya, Traffic Operations Technician

Sgt. Jason Watson, Peel Regional Police

Denna Yaunan, Traffic Operations Technologist

Erica Warsh, Transportation Demand Management Coordinator

**Contact**

Angie Melo, Legislative Coordinator, Legislative Services

905-615-3200 ext. 5423/Fax 905-615-4181/Email: [angie.melo@mississauga.ca](mailto:angie.melo@mississauga.ca)

**Find it Online**

<http://www.mississauga.ca/portal/cityhall/trafficsafetycouncil>

1. CALL TO ORDER2. DECLARATIONS OF CONFLICT OF INTEREST3. PRESENTATIONS / DEPUTATIONS

- 3.1 Colin Patterson, Supervisor, Road Safety, to speak regarding Pedestrian Crossover Pilot Project.

4. PUBLIC QUESTION PERIOD

Traffic Safety Council may grant permission to a person who is present at Traffic Safety Council and wishes to address a matter on the Agenda. Persons addressing Traffic Safety Council will ask their question within a time limit of 5 minutes, as public question period total limit is 15 minutes.

5. MATTERS TO BE CONSIDERED5.1 Minutes of Previous Meeting

Draft minutes of the May 24, 2017 Traffic Safety Council meeting.

RECOMMEND APPROVAL5.2 Site Inspection Report – Meadowvale Village Public School (Ward 11)

Site Inspection Report for the inspection conducted on May 31, 2017 at the intersection of Crawford Mill Avenue and Gooderham Estates Boulevard for the students attending Meadowvale Village Public School.

RECOMMENDATION

That the request for the placement of a crossing guard at the intersection of Crawford Mill Avenue and Gooderham Estates Blvd., for the students attending Meadowvale Village Public School, be denied as the warrants are not met.

RECOMMEND APPROVAL5.3 Site Inspection Report – Meadowvale Village Public School (Ward 11)

Site Inspection Report for the inspection conducted on May 31, 2017 at the intersection of Old Derry Road and Gooderham Estates Boulevard, for the students attending Meadowvale Village Public School.

RECOMMENDATION

That the request for the placement of a crossing guard at the intersection of Old Derry Road and Gooderham Estates Blvd., for the students attending Meadowvale Village Public School, be denied as the warrants are not met.

RECOMMEND APPROVAL**5.4 Site Inspection Report – Homelands Senior Public School (Ward 2)**

Site Inspection Report for the inspection conducted on June 6, 2017 at 2420 Homelands Drive in front of Homelands Senior Public School.

RECOMMENDATION

1. That the Peel District School Board consider removing the school bus loading zone from the front of Homelands Senior Public School.
2. That Parking Enforcement be requested to enforce the "No Stopping/No Parking" prohibitions during the peak times of 8:10 a.m. to 8:30 a.m., and from 2:20 p.m. to 2:45 p.m., on Homelands Drive for the students attending Homelands Senior Public School.
3. That Peel Regional Police be requested to enforce 40 KM/H speed zone from 8:10 a.m. to 8:30 a.m., on Homelands Drive for the students attending Homelands Senior Public School, as time and manpower permits.
4. That Transportation and Works be requested to review the feasibility of installing a pedestrian crossover at Thornlodge Park path in front of Homelands Senior Public School.

RECOMMEND APPROVAL**5.5 Site Inspection Report – Bishop Scalabrini Catholic Elementary School (Ward 7)**

Site Inspection Report for the inspection conducted on June 8, 2017 at 225 Central Parkway West, in front of Bishop Scalabrini Catholic Elementary School.

RECOMMENDATION

That the Principal of Bishop Scalabrini Catholic Elementary School be requested to continue to remind parents to:

- a. not park their vehicles in the staff parking lot; and
- b. to utilize the Kiss and Ride area to drop off their children.

RECOMMEND APPROVAL

5.6 Site Inspection Report – Bishop Scalabrini Catholic Elementary School (Ward 7)

Site Inspection Report for the inspection conducted on June 8, 2017 at the rear of Bishop Scalabrini Catholic Elementary School on Palgrave Road and Melville Avenue.

RECOMMENDATION

That Transportation and Works be requested to install "No Stopping" corner prohibitions on Melville Avenue at Palgrave Road, for the students attending Bishop Scalabrini Catholic Elementary School.

RECOMMEND APPROVAL

5.7 Site Inspection Request – Tecumseh Public School (Ward 2)

Email dated June 6, 2017 from Sheelagh Duffin, Supervisor, Crossing Guards, in response to an area residents' inquiry regarding installation of school crossing signs on Chriseden Drive, for the students attending Tecumseh Public School.

RECOMMEND RECEIPT/REFERRAL

5.8 Site Inspection Request – Artesian Drive Public School (Ward 8)

Email dated June 7, 2017 from Angie Melo, Legislative Coordinator, on behalf of area resident regarding traffic safety concerns in front of Artesian Drive Public School.

RECOMMEND RECEIPT/REFERRAL

5.9 Site Inspection Request – St. Simon Stock Elementary School (Ward 10)

Email dated June 7, 2017 from Julie Luceno with respect to traffic safety concerns on Lisgar Drive, at the Kiss and Ride entrance of St. Simon Stock School.

RECOMMEND RECEIPT/REFERRAL

5.10 Site Inspection Request – St. Timothy Separate School (Ward 7)

Email dated June 7, 2017 from Sandra Carusi regarding traffic safety concerns at the intersection of Cherry Post Drive and Corsair Road for the students attending St. Timothy Separate School.

RECOMMEND RECEIPT/REFERRAL

5.11 Site Inspection Request – Whitehorn Public School and St. Raymond Catholic School (Ward 6)

Email dated June 12, 2017 from Ouliana Drobychevskaia, Traffic Operations Technologist on behalf of area resident with respect to traffic safety concerns at the intersection of Whitehorn Avenue and Mersey Street for the students attending Whitehorn Public School and St. Raymond Catholic School.

RECOMMEND RECEIPT/REFERRAL

5.12 Site Inspection Request – Bristol Road Middle School (Ward 5)

Email dated June 13, 2017 from Nadia Pinelli, Vice Principal, Bristol Road Middle School, regarding traffic safety concerns during school entry and exit times, in front of Bristol Road Middle School.

RECOMMEND RECEIPT/REFERRAL

6. TRANSPORTATION AND WORKS ACTION ITEMS

6.1 Transportation and Works Action Items List – May 2017

RECOMMEND RECEIPT

7. INFORMATION ITEMS

7.1 Traffic Safety Council Membership

Resignation letter from Katherine Vukobrat, Citizen Member, dated June 14, 2017.

RECOMMEND RECEIPT/REFERRAL

7.2 East Credit Pupil Accommodation Review

Email dated June 9, 2017 from Sheelagh Duffin, Supervisor, Crossing Guards, with respect to the East Credit Pupil Accommodation Review.

RECOMMEND RECEIPT

7.3 City of Mississauga Notice of Study Completion

City of Mississauga Notice of Study Completion, Municipal Class Environmental Assessment Study for Mavis Road, from Courtneypark Drive to Ray Lawson Boulevard, dated June 1, 2017.

RECOMMEND RECEIPT

7.4 City of Mississauga Notice of Public Information Centre

City of Mississauga Notice of Public Information Centre with respect to a Municipal Class Environmental Assessment Study for Sheridan Park Drive Extension, between Homelands Drive and Speakman Drive, dated June 15, 2017

RECOMMEND RECEIPT

OTHER BUSINESS

DATE OF NEXT MEETING: September 27, 2017

ADJOURNMENT





Traffic Safety Council  
JUN 21 2017

City of Mississauga  
**Corporate Report**



<p>Date: 2017/05/30</p> <p>To: Chair and Members of General Committee</p>	<p>Originator's files: MG.23.REP</p>
<p>From: Geoff Wright, P. Eng., MBA, Commissioner of Transportation and Works</p>	<p>Meeting date: 2017/06/14</p>

**Subject**

**Pedestrian Crossover Pilot Project**

**Recommendation**

1. That General Committee endorse the Pedestrian Crossover Pilot Project to create an education and awareness campaign, and to identify, design, install and evaluate potential pedestrian crossover locations, as outlined in the report from the Commissioner of Transportation and Works, dated May 30, 2017 and entitled "Pedestrian Crossover Pilot Project"
2. That appropriate capital budget funds for the Pedestrian Crossover Pilot Project as outlined in the report from the Commissioner of Transportation and Works, dated May 30, 2017 and entitled "Pedestrian Crossover Pilot Project", be considered as part of the 2018 Business Planning and Budget process.

**Report Highlights**

- Effective January 1, 2016 the Ministry of Transportation Ontario (MTO) issued a new regulation (402/15) under the *Highway Traffic Act* which established a new traffic control device called the Level 2 Pedestrian Crossover.
- This new legislation has provided municipalities with an additional option for pedestrian control at locations that previously would not have warranted the installation of any type of pedestrian traffic control.
- The development of a pilot project will require potential locations to be identified, designed and constructed.
- City staff believe that adequate public education and development of an implementation strategy are integral to the success of the new pedestrian crossovers and that an evaluation period to better determine pedestrian and motorist compliance is necessary.

- Currently, there is no funding available for a Pedestrian Crossover Pilot Project and the adoption of such is estimated to cost \$100,000 through capital funding for the design and implementation of three Level 2 Pedestrian Crossovers.

## Background

Effective January 1, 2016, the MTO issued a new regulation (402/15) under the *Highway Traffic Act* which established a new traffic control device called the Level 2 Pedestrian Crossover. This new traffic control device consists of new roadside signs and pavement markings that serve to enhance the mobility of pedestrians at mid-block locations and at intersections, including right-turn channels and roundabouts.

In June of 2016 the MTO updated and released Ontario Traffic Manual (OTM) Book 15 - Pedestrian Crossing Treatments. OTM Book 15 includes all of the background information and justification regarding the use of pedestrian crossovers as safe crossing treatments in Ontario. A pedestrian crossover is any portion of a roadway distinctly indicated for pedestrian crossing by signs on the roadway and lines or other markings on the surface of the roadway as prescribed by the regulations and the *Highway Traffic Act*. The presence of a pedestrian in the crosswalk requires the driver of a vehicle approaching the crossover to stop before entering the crossover.

Prior to the *Highway Traffic Act* update and subsequent release of OTM Book 15, there was only the Level 1 Pedestrian Crossover, which is rarely used within the province, except within the City of Toronto. The Level 1 Pedestrian Crossover has not been used in Mississauga since the mid 1990's when the MTO modified the traffic signal warrant methodology to allow for mid-block or intersection pedestrian signals.

## Comments

The new pedestrian crossovers are a defined set of roadside signs and pavement markings, which combine for a new passive treatment to provide pedestrians the right-of-way when crossing the roadway.

There are four types of pedestrian crossovers included in OTM Book 15 which can be used at mid-block and intersection locations including right-turn channels and roundabouts (refer to Appendix 1):

- Level 1 Type A Pedestrian Crossover - The original type pedestrian crossover that is defined by the prescribed use of regulatory side mounted and overhead illuminated signs, flashing amber beacons and pavement markings.

- Level 2 Type B Pedestrian Crossover - Distinctly defined by the prescribed use of side mounted and overhead mounted regulatory signs, rapid rectangular flashing beacons and pavement markings.
- Level 2 Type C Pedestrian Crossover - Distinctly defined by the prescribed use of side mounted and overhead mounted regulatory signs and pavement markings.
- Level 2 Type D Pedestrian Crossover - Distinctly defined by the prescribed use of side mounted regulatory signs and pavement markings.

In addition to the signs mentioned above for Pedestrian Crossover Types B, C, and D, there are additional signs and markings that forewarn drivers of the pedestrian crossing. These markings consist of a yield line known as "sharks teeth markings" prior to the crosswalk and "ladder style" crosswalk markings.

The Level 2 Pedestrian Crossover provides the right-of-way to pedestrians through the use of "Stop for Pedestrians" signs, "Pedestrian Crossing Ahead" warning signs and pavement markings reinforcing the requirement for vehicles to stop and provide the right-of-way to pedestrians. Additional measures such as rectangular rapid flashing beacons and overhead signs may also be required depending on the width of the roadway and volumes of vehicular traffic. The pedestrian crossover sign and pavement markings legally provide the pedestrian with the right-of-way when crossing a road and establish the requirement for vehicles to stop. Although some versions of the new pedestrian crossovers have beacons and overhead signs associated with them, the signs and pavement markings themselves govern the right-of-way while the beacons serve only to draw attention to the sign at busier locations.

This new legislation has provided municipalities with an additional option for pedestrian control at locations that previously would not have warranted the installation of any type of pedestrian traffic control.

#### Statutory Requirements

The *Highway Traffic Act* regulates the use of the Level 2 Pedestrian Crossover to roadways posted at 60 km/h and under. Drivers approaching a Level 2 Pedestrian Crossover must stop before entering a pedestrian crossover when a pedestrian is crossing the roadway, shall not overtake another vehicle already stopped at a pedestrian crossover and shall not proceed into the crossover until the pedestrian is no longer on the roadway.

#### Installation Warrants

The Level 1 pedestrian crossover has primarily been used in the City of Toronto while most other municipalities, including the City of Mississauga, preferred to use pedestrian activated traffic signals in lieu of the Level 1 pedestrian crossover. Level 1 pedestrian crossovers are recommended at locations when four or more lanes of travel and significant traffic volumes are present. Due to the substantial capital costs required to install Level 1 pedestrian crossovers,

the preferred method of traffic control at this type of cross section remains a pedestrian activated traffic signal.

Similar to all other traffic control devices, installation guidelines will be followed to determine when and where a Level 2 Pedestrian Crossover may be considered. The following guidelines are used to assist staff in considering locations for installations:

- 100 or more pedestrians observed crossing over an eight-hour period or 55 or more pedestrians observed crossing over a four-hour period;
- No existing traffic control within 200 metres (656 feet);
- Adherence to Ontario Traffic Manual Book 15 lane configuration and traffic volume conditions;
- Posted speed of 60 km/h or less; and,
- Adequate sight line visibility.

It is anticipated that three Level 2 Pedestrian Crossover locations will be selected for the Pedestrian Crossover Pilot Project.

#### Educational Outreach and Implementation Strategy

City staff believe that adequate public education and the development of an implementation strategy is integral to the success of the new pedestrian crossovers.

Pedestrian crossovers pose a significant change in mobility and on-road operating conditions for both pedestrians and motorists and are a prominent culture change for motorists that will take time to adapt and adhere to.

Although a few jurisdictions throughout the province have installed Level 2 Pedestrian Crossovers in 2016, additional public awareness and education is necessary to ensure that all road users understand their shared responsibilities when using this new form of traffic control. For this reason, the following key components are identified for implementation:

- Education outreach and awareness
- Review selection and implementation of suitable Level 2 Pedestrian Crossover locations
- Monitor safety and compliance at new Level 2 Pedestrian Crossovers
- Report evaluation results and recommendations for future use of pedestrian crossovers

### **Financial Impact**

The proposed pilot project for the Level 2 Pedestrian Crossover requires capital funds for design and implementation of three potential locations. The following preliminary capital budget requirements for the Level 2 Pedestrian Crossover initiative are identified for consideration by the Budget Committee as part of the 2018 Business Planning and Budget process:

Budget Year	Item	Proposed Capital Budget
2018	Education Outreach and Pedestrian Crossover Installation	\$100,000

## Conclusion

The introduction of new legislation provides the City with an additional traffic control device to provide safer roadway crossing conditions for pedestrians. These new crossing treatments will allow pedestrians to cross with the right-of-way under a greater number of conditions and will provide the City with a more cost-effective solution to ensure pedestrian safety.

The implementation of a new traffic control device such as the Level 2 Pedestrian Crossover requires the development of an education and awareness campaign to ensure that all road users understand their shared responsibilities when using this new form of traffic control. The development of a pilot project will require potential locations to be identified, designed, and constructed. Following the installation of the devices, staff will require an evaluation period to better determine how the new control is operating, including pedestrian and motorist compliance.

Currently, there are no capital funds available for a Pedestrian Crossover Pilot Project. If a Pedestrian Crossover Pilot Project is endorsed, design and implementation of three Level 2 Pedestrian Crossovers is estimated to cost \$100,000 through capital funding. Should the pilot concept and required funding be approved by Council, staff will bring forward an information report to General Committee outlining the locations and the specific type of Level 2 crossover that will be implemented.

## Attachments

Appendix 1: Pedestrian Crossover Types

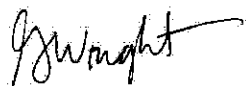

---

Geoff Wright, P. Eng., MBA, Commissioner of Transportation and Works

Prepared by: Colin Patterson, C.E.T., Supervisor of Road Safety

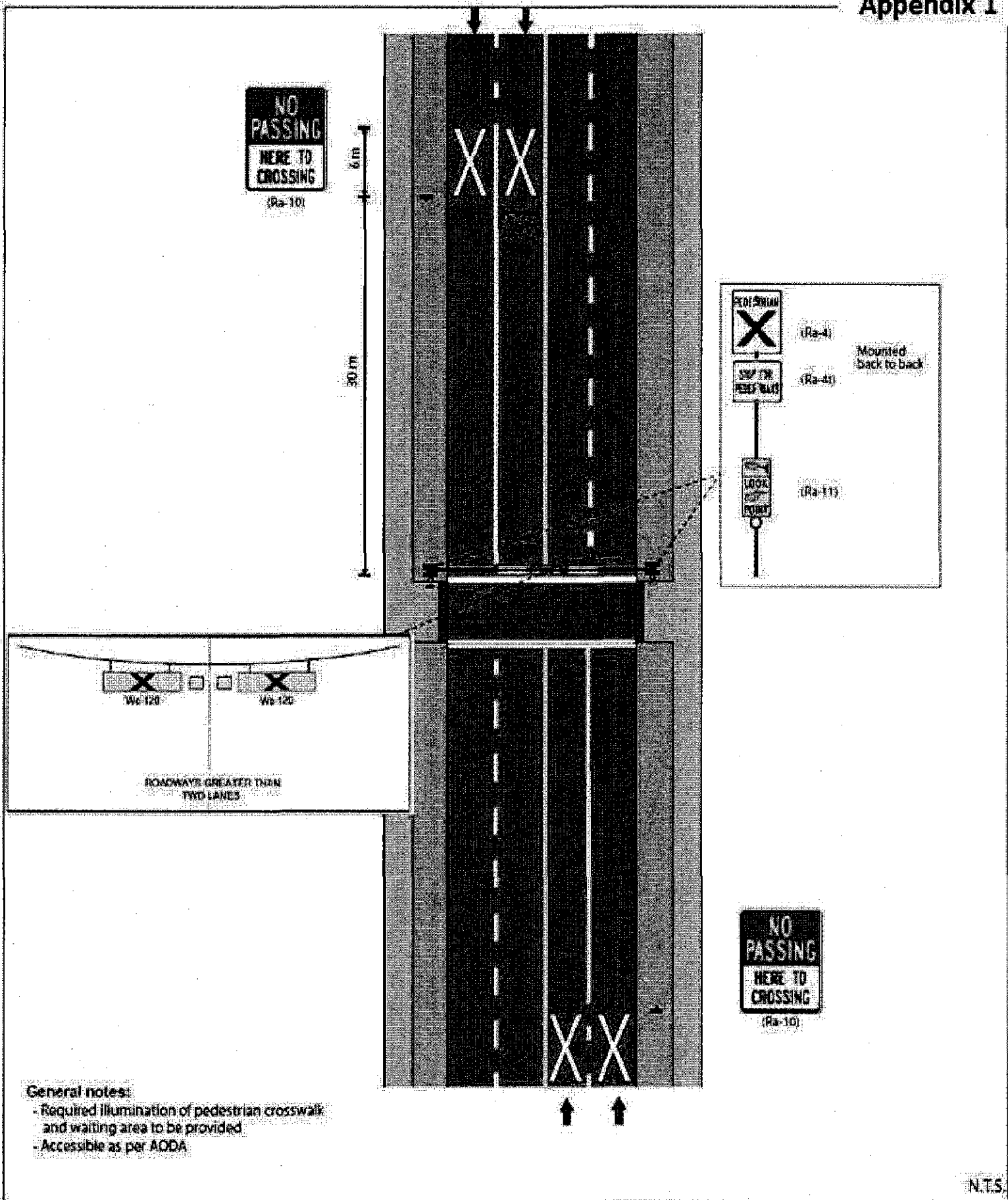

Pedestrian Crossover Level 1 Type A

**© Pushbutton**

## Pedestrian Crossover Level 2 Type B

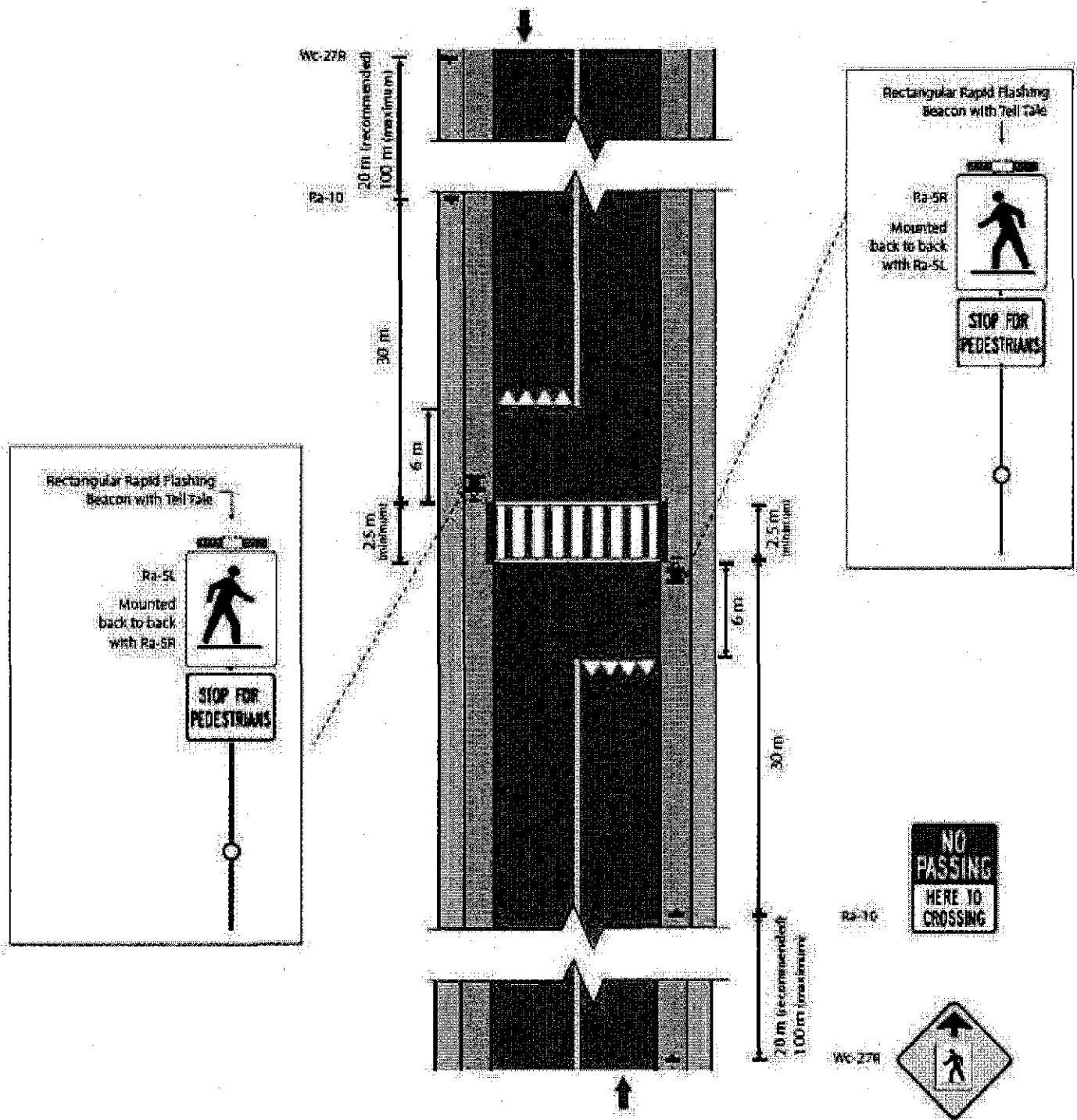

**General notes:**

- Required illumination of pedestrian crosswalk and waiting area to be provided
- Accessible as per AODA

○ Pushbutton

N.T.S.

**Pedestrian Crossover Level 2 Type C**



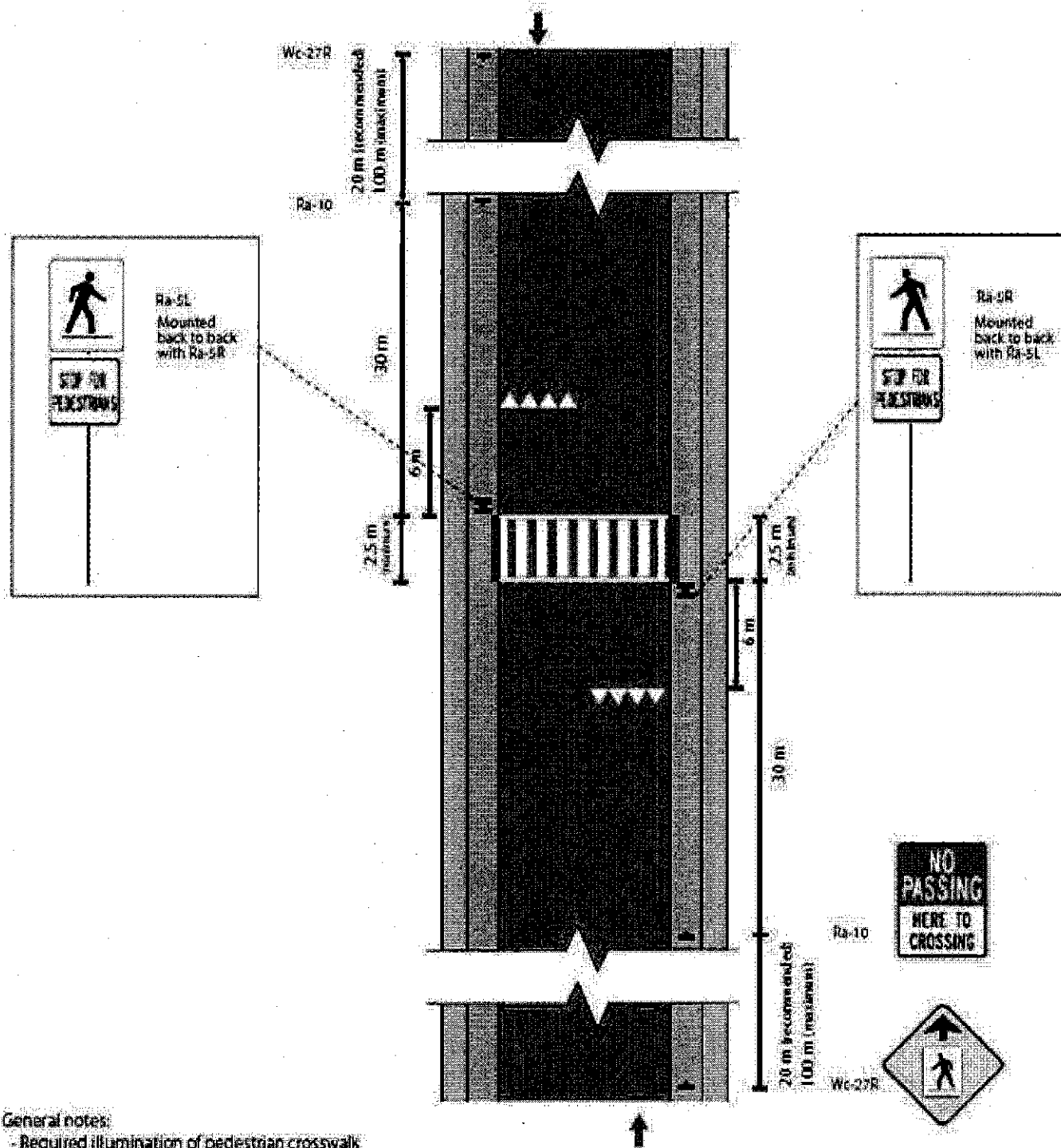

**General notes:**

- Required illumination of pedestrian crosswalk and waiting area to be provided
- Accessible as per AODA



City of Mississauga  
**Minutes**



---

## Traffic Safety Council

### Date

2017/05/24

### Time

5:00 P.M.

### Location

Hearing Room, 2<sup>nd</sup> Floor, Civic Centre  
300 City Centre Drive, Mississauga, ON L5B 3C1

### Members Present

Councillor Sue McFadden, Ward 10  
Councillor Chris Fonseca, Ward 3  
Councillor John Kovac, Ward 4  
Sandra Beniuk, Citizen Member  
Brad Butt, Citizen Member  
Robert Crocker, Peel District School Board Trustee  
Tamara Coulson, Citizen Member  
Denise Gordon-Mohamud, Citizen Member  
Sushil Kumra, Citizen Member  
Heather Relf, Citizen Member (Vice-Chair)  
Ajay Sharma, Citizen Member  
Mashkoor Sherwani, Citizen Member  
Altamash Syed, Citizen Member  
Katherine Vukobrat, Citizen Member  
Peter Westbrook, Citizen Member (Chair)

### Members Absent

Boris Swedak, Life Member  
Arvind Bhaskar, Citizen Member  
Louise Goegan, Citizen Member  
Dan Suess, Citizen Member  
Thomas Thomas, Dufferin-Peel Catholic District School Board Trustee

**ADVISORY BOARD PRESENT**

Sheelagh Duffin, Supervisor, Crossing Guards

Michael Foley, Acting Manager, Parking Enforcement

Kevin Kealy, Supervisor, Parking Enforcement

Marcy Macina, Central Planning and Operations Officer, Student Transportation of Peel Region (STOPR)

Alex Liya, Traffic Operations Technician

**Contact**

Angie Melo, Legislative Coordinator, Legislative Services

905-615-3200 ext. 5423/Fax 905-615-4181/Email: [angie.melo@mississauga.ca](mailto:angie.melo@mississauga.ca)

**Find it Online**

<http://www.mississauga.ca/portal/cityhall/trafficsafetycouncil>

1. CALL TO ORDER 5:02 PM
2. DECLARATIONS OF CONFLICT OF INTEREST - Nil
3. PRESENTATIONS / DEPUTATIONS - Nil
4. PUBLIC QUESTION PERIOD - Nil

Traffic Safety Council may grant permission to a person who is present at Traffic Safety Council and wishes to address a matter on the Agenda. Persons addressing Traffic Safety Council will ask their question within a time limit of 5 minutes, as public question period total limit is 15 minutes.

5. MATTERS TO BE CONSIDERED

5.1 Minutes of Previous Meeting

Draft minutes of the April 26, 2017 Traffic Safety Council meeting.

Approved (B. Butt)

5.2 Site Inspection Report – Ruth Thompson Middle School (Ward 10)

Site Inspection Report for the inspection conducted on April 27, 2017 at the intersection of Tenth Line West and Sunlight Street/Serena Way for the students attending Ruth Thompson Middle School.

RECOMMENDATION

1. That Transportation and Works be requested to consider the feasibility of the following for the students attending Ruth Thompson Middle School:
  - a. Repaint the existing markings (crosswalk and stop bar) at the intersection of Tenth Line West and Sunlight Street/Serena Way.
  - b. Review the pedestrian walk time and ensure it is set at a slow walking speed at the intersection of Tenth Line West and Sunlight Street/Serena Way.
  - c. Repair the northbound pedestrian signal head on the west side as the “red flashing” and the “don’t walk hand” signals do not light up at the intersection of Tenth Line West and Sunlight Street/Serena Way.
2. That the Principal of Ruth Thompson Middle School be requested to:
  - a. Advise the students to obey the traffic signals at the intersection of Tenth Line West and Sunlight Street/Serena Way.
  - b. Remind student to always wear their helmets when cycling.

Approved (S. Kumra)

Recommendation - TSC-0069-2107

### 5.3 Site Inspection Report – Rotherglen Meadowvale Elementary School (Ward 11)

Site Inspection Report for the inspection conducted on May 11, 2017 on Gaslamp Walk just north of Old Derry Road, for the students attending Rotherglen Meadowvale Elementary School.

#### RECOMMENDATION

1. That Parking Enforcement be requested to enforce "No Stopping" violations at the emergency exit on the west side of Gaslamp Walk between the peak times of 8:20 AM – 9:00 AM, and from 3:25 PM – 3:50 PM, for the students attending Rotherglen Meadowvale Elementary School.
2. That the Head of School of Rotherglen Meadowvale Elementary School be requested to remind parents to not stop and/or park at the emergency exit on Gaslamp Walk.

Approved (A. Bhaskar)

Recommendation – TSC-0070-2017

### 5.4 Site Inspection Report – St. Richard Elementary School (Ward 9)

Site Inspection Report for the inspection conducted on May 16, 2017 at the intersection of Joliette Crescent and Copenhagen Road, in front of St. Richard Elementary School.

#### RECOMMENDATION

1. That the request for the placement of a crossing guard at the intersection of Joliette Crescent and Copenhagen Road for the students attending St. Richard Elementary School, be denied as the warrants are not met.
2. That Transportation and Works be requested to review the signage in front of St. Richard Elementary School.

Approved (H. Relf)

Recommendation – TSC-0071-2017

### 5.5 Site Inspection Report – St. Julia Catholic Elementary School (Ward 11)

Site Inspection Report for the inspection conducted on May 17, 2017 at 6770 Historic Trail, in front of St. Julia Catholic Elementary School.

#### RECOMMEND APPROVAL

1. That the request for the placement of a crossing guard on Historic Trail, in front of St. Julia Catholic Elementary School be denied as the warrants are not met.
2. That Traffic Safety Council be requested to conduct a further site inspection at 6770 Historic Trail, in front of St. Julia Catholic Elementary School, in September 2017.

Approved (T. Coulson)

Recommendation – TSC-0072-2017

5.6 Site Inspection Report – St. Julia Catholic Elementary School (Ward 11)

Site Inspection Report for the inspection conducted on May 17, 2017 at the intersection of Historic Trail and Pepperidge Crossing for the students attending St. Julia Catholic Elementary School.

RECOMMENDATION

That the request for the placement of a crossing guard at the intersection of Historic Trail and Pepperidge Crossing for the students attending St. Julia Catholic Elementary School be denied as the warrants are not met.

Approved (B. Butt)

Recommendation – TSC-0073-2017

5.7 Site Inspection Report – École Secondaire Ste. Famille (Ward 11)

Site Inspection Report for the inspection conducted on May 18, 2017 at the intersection of Fengate Drive and Meadowvale Boulevard, for the students attending École Secondaire Ste. Famille.

RECOMMENDATION

That the Site Inspection Report for the inspection conducted on May 18, 2017 at the intersection of Fengate Drive and Meadowvale Boulevard, for the students attending École Secondaire Ste. Famille be received for information.

Approved (T. Thomas)

Recommendation – TSC-0074-2017

5.8 Site Inspection Request – Homelands Senior Public School (Ward 2)

RECOMMENDATION

That the email dated May 10, 2017 from Councillor Karen Ras' office on behalf of an area resident with respect to traffic safety concerns in front of Homelands Public School, be received and referred to the Traffic Safety Council Site Inspection Subcommittee for a report back to the Traffic Safety Council.

Approved (D. Suess)

Recommendation – TSC-0075-2017

#### 5.9 Site Inspection Request – St Timothy's Catholic School (Ward 7)

##### RECOMMENDATION

That the email dated May 2, 2017 from Councillor Nando Iannicca's office regarding traffic safety concerns on Cliff Road and in front of St. Timothy's Catholic School be received and referred to the Traffic Safety Council Site Inspection Subcommittee for a report back to the Traffic Safety Council.

Approved (D. Suess)

Recommendation – TSC-0076-2017

#### 5.10 Site Inspection Request – Bishop Scalabrini Catholic School (Ward 7)

##### RECOMMENDATION

That the email dated May 2, 2017 from Councillor Nando Iannicca's office regarding traffic safety concerns on Palgrave and Melville at the rear of Bishop Scalabrini Catholic School and in front of Bishop Scalabrini Catholic School be received and referred to the Traffic Safety Council Site Inspection Subcommittee for a report back to the Traffic Safety Council.

Approved (T. Thomas)

Recommendation – TSC-0077-2017

#### 6. SUB COMMITTEE REPORTS

##### 6.1 Walk to School Subcommittee Update

Louise Goegan, Chair, Walk to School Subcommittee provided an update on the schools that have been approached for a launch and relaunch of the Walk to School Program. Ms. Goegan announced that Britannia Public School and Burnhamthorpe Public School will launch a Walk to School Program in September 2017. Ms. Goegan advised that although promotional items for the Walk to School baskets were recently purchased, there are other costs associated which are required to launch the Walk to School program, such as printing of survey and maps and purchasing cardboard transit buses for the participating schools.

##### RECOMMENDATION

1. That the verbal update provided by Louise Goegan, Chair, Walk To School Subcommittee, with respect to the schools launching a Walk to School Program in the fall 2017 be received for information.
2. That the amount of up to \$3,000.00 be approved for the printing costs and promotional items required for the launch of a Walk to School Program in the fall 2017 at participating schools.

Approved (H. Relf)

Recommendation – TSC-0078-2017



## 7. PARKING ENFORCEMENT REPORT

### 7.1 Parking Enforcement School Zone Report – April 2017

No discussion on the matter.

#### RECOMMENDATION

That the Report with respect to parking enforcement in school zones for the month of April 2017, be received for information.

Received (B. Butt)

Recommendation – TSC-0079-2017

## 8. TRANSPORTATION AND WORKS ACTION ITEMS REPORT

### 8.1 Transportation and Works Action Items Report – April 2017

The Transportation and Works Action Items Report for April 2017 was not available at the time of print of the agenda and was presented to the Traffic Safety Council Members at the time of the meeting. There was no discussion on the matter.

#### RECOMMENDATION

That the Report with respect to Transportation and Works Action Items for the month of April 2017, be received for information.

Received (D. Suess)

Recommendation – TSC-0080-2017

## OTHER BUSINESS

Robert Crocker, Peel District School Board Trustee, announced that the Peel District School Board has selected Peter Joshua as its new Director of Education, who succeeds retiring Director, Tony Pontes.

DATE OF NEXT MEETING: June 21, 2017

ADJOURNMENT 5:25 PM



5.2-1

# Site Inspection Report

Traffic Safety Council

JUN 21 2017

Corporate Services  
Office of the City Clerk



<b>Site</b>			
School: Meadowvale Village Public School	Address: 890 Old Derry Rd. West Mississauga, Ontario L5W 1A1	School Times: 9:10 AM 3:40 PM WTS <input checked="" type="checkbox"/> <input type="radio"/> Yes <input type="radio"/> No	
Student Population: 552	French Immersion Population: <input type="text"/>	No. of Large Buses: <input type="text"/> No. of Students on the Bus: 342	No. of Small Buses: <input type="text"/> No. of Students on the Bus: <input type="text"/>
School: <input type="text"/>	Address: <input type="text"/>	School Times: <input type="text"/> AM <input type="text"/> PM WTS <input type="checkbox"/> <input type="radio"/> Yes <input type="radio"/> No	
Student Population: <input type="text"/>	French Immersion Population: <input type="text"/>	No. of Large Buses: <input type="text"/> No. of Students on the Bus: <input type="text"/>	No. of Small Buses: <input type="text"/> No. of Students on the Bus: <input type="text"/>
Location: (Please identify the location with reference or nearest intersection. Indicate nearest school and address.) Crawford Mill Ave. and Gooderham Estates Blvd.			
Proximity to School <input type="checkbox"/> In front of <input checked="" type="checkbox"/> within 400 feet/metres			
Accident History (during school times) Yes <input type="radio"/> No <input type="radio"/> Comments: <input type="text"/>			
Date of Inspection: 2017 05 04 AM <input checked="" type="radio"/> PM <input checked="" type="radio"/>		Inspection Time: 8:40 AM <input type="radio"/> 3:40 PM <input type="radio"/>	Requested By: Public Health Nurse
Prepared By: P. Westbrook - AM, D. Yaunan/T. Coulson - PM		Request For: Placement of a School Crossing Guard	

<b>Observers</b>			
File Number: RT.10	File Number: RT.10	Ward: Ward 11	
Observed By: T. Coulson	<input type="checkbox"/> AM <input type="checkbox"/> PM <input checked="" type="checkbox"/> AM & PM		
Observed By: P. Westbrook	<input checked="" type="checkbox"/> AM <input type="checkbox"/> PM <input type="checkbox"/> AM & PM		
Observed By: D. Yaunan	<input type="checkbox"/> AM <input type="checkbox"/> PM <input checked="" type="checkbox"/> AM & PM		
Observed By: S. Duffin	<input type="checkbox"/> AM <input type="checkbox"/> PM <input checked="" type="checkbox"/> AM & PM		
Observed By: S. Kumra	<input type="checkbox"/> AM <input checked="" type="checkbox"/> PM <input type="checkbox"/> AM & PM		
Observed By: Jiusi Lu (Peel Public Health Nurse)	<input type="checkbox"/> AM <input checked="" type="checkbox"/> PM <input type="checkbox"/> AM & PM		

<b>Site Conditions</b>			
School Signs: <input checked="" type="checkbox"/> School Area Signs <input type="checkbox"/> School Crossing Signs <input type="checkbox"/> Parking/Stopping Prohibition			
Posted Speed Limit: <input checked="" type="checkbox"/> 40 km/hr <input type="checkbox"/> 50 km/hr <input type="checkbox"/> 60 km/hr <input type="checkbox"/> Other: <input type="text"/>			
Visibility of Crossing Pedestrians: <input type="checkbox"/> Poor <input type="checkbox"/> Fair <input checked="" type="checkbox"/> Good	Comments: <input type="text"/>		
Sight Obstructions: <input type="checkbox"/> Hedges <input type="checkbox"/> Trees <input type="checkbox"/> Fences <input type="checkbox"/> Bus Shelter <input type="checkbox"/> Newspaper Boxes <input type="checkbox"/> Other (Specify): <input type="text"/>			
Road Grade: <input checked="" type="checkbox"/> Flat <input type="checkbox"/> Incline <input type="checkbox"/> Decline			
Road Geometrics: <input checked="" type="checkbox"/> Straight <input type="checkbox"/> Curved	Comments: <input type="text"/>		
Road Width: <input type="text"/> Curb to Curb: 39 feet/metres	No. of Bike Lanes: <input type="text"/>	No. of Through Lanes: 2	No. of Turning Lanes: <input type="text"/>
Leg: <input type="checkbox"/> N <input type="checkbox"/> S <input type="checkbox"/> E <input type="checkbox"/> W			
Road Width: <input type="text"/> Curb to Curb: <input type="text"/> feet/metres	No. of Bike Lanes: <input type="text"/>	No. of Through Lanes: <input type="text"/>	No. of Turning Lanes: <input type="text"/>
Leg: <input type="checkbox"/> N <input type="checkbox"/> S <input type="checkbox"/> E <input type="checkbox"/> W			
Road Conditions: AM: <input checked="" type="checkbox"/> Dry <input type="checkbox"/> Wet <input type="checkbox"/> Snow Covered <input type="checkbox"/> Ice PM: <input checked="" type="checkbox"/> Dry <input type="checkbox"/> Wet <input type="checkbox"/> Snow Covered <input type="checkbox"/> Ice			
Sidewalks: <input type="checkbox"/> Not Present <input checked="" type="checkbox"/> North <input checked="" type="checkbox"/> South <input checked="" type="checkbox"/> East <input checked="" type="checkbox"/> West			
Route Survey: <input type="checkbox"/> Shopping Area <input type="checkbox"/> Construction <input type="checkbox"/> Driveway <input type="checkbox"/> Parked Vehicle(s) <input type="checkbox"/> Transit Bus Stop <input type="checkbox"/> Underpass Within <input type="text"/> feet/metres Other (specify): <input type="text"/>			

## Details

Weather Conditions:	AM: <input checked="" type="checkbox"/> Dry <input type="checkbox"/> Sunny <input type="checkbox"/> Rain <input type="checkbox"/> Snow	Temperature: <u>10 C</u>	Other: <u></u>
	PM: <input checked="" type="checkbox"/> Dry <input checked="" type="checkbox"/> Sunny <input type="checkbox"/> Rain <input type="checkbox"/> Snow	Temperature: <u>22 C</u>	Other: <u></u>
Type of Crossing:	<input type="checkbox"/> 4 Way Intersection <input checked="" type="checkbox"/> 3 Way Intersection	<input type="checkbox"/> Midblock (i.e., not an intersection)	
Type of Control:	<input type="checkbox"/> Traffic Lights <input type="checkbox"/> Yield Signs	<input type="checkbox"/> No Control	<input type="checkbox"/> Adequate Control
	<input type="checkbox"/> Stop Signs (Traffic is stopped on one street only)	<input checked="" type="checkbox"/> All Way Stop (Traffic is stopped in all directions)	

## Crossing Guard Warrant Survey

<b>Location:</b>	Crawford Mill Ave. and Gooderham Estates Blvd.		
<input checked="" type="checkbox"/> Safe Gap Time	Safe Gap Time Calculation (if applicable):	$\left( \frac{W}{3.5} + 4 \right)$	<div style="border: 1px solid black; padding: 2px; display: inline-block;">15</div> = sec.
<input type="checkbox"/> Signalized Intersection Turning Traffic Count	(width figure measured in feet)		

## Morning Intervals

# of Pods	Time (AM)	Gaps Leg: <input checked="" type="checkbox"/> N <input type="checkbox"/> S <input type="checkbox"/> E <input type="checkbox"/> W	# of Gaps
	7:30 - 7:35		
	7:35 - 7:40		
	8:40 - 8:45	11, 17, 33, 19, 1, 11, 11, 11, 11, 75	9
11P	8:45 - 8:50	1, 39, 11, 11, 11, 25, 11, 11, 11, 11, 19, 11	4
11P	8:50 - 8:55	24, 1, 15, 11, 11, 11, 11, 20, 11, 11, 24, 11, 11, 11, 16, 11	5
2P, 3P, 11P	8:55 - 9:00	11, 16, 11, 11, 11, 11, 11, 11, 24, 11, 11, 11	2
11P	9:00 - 9:05	11, 1, 23, 11, 11, 11, 11, 11, 11, 11, 11, 26, 11, 1, 23, 1	3
11	9:05 - 9:10	15, 11, 11, 21, 11, 11, 11, 11, 11, 42, 11, 16, 11, 18	6
	8:10 - 8:15		
	8:15 - 8:20		
	8:20 - 8:25		
	8:25 - 8:30		
	8:30 - 8:35		
	8:35 - 8:40		
	8:40 - 8:45		
	8:45 - 8:50		
	8:50 - 8:55		
	8:55 - 9:00		

## Afternoon Intervals

[illegible]

**Observations**

Volume of Traffic (see Intersection Plan):

AM: ☐ Heavy ☐ Light ☒ Intermittent PM: ☐ Heavy ☐ Light ☒ Intermittent

Number of Crossing Pedestrians:

AM: North 17 East      South      West      PM: North 12 East      South      West     

Turning Traffic:

AM: ☐ Heavy ☐ Light ☐ Intermittent PM: ☐ Heavy ☐ Light ☐ Intermittent**Traffic Behaviour**AM: ☐ Illegal U-turns ☐ Running Red Light ☐ Speeding ☐ Stopping Non-Compliance ☐ Illegal Stopping ☐ Illegal Parking ☐ OtherPM: ☐ Illegal U-turns ☐ Running Red Light ☐ Speeding ☒ Stopping Non-Compliance ☐ Illegal Stopping ☐ Illegal Parking ☐ Other**Comments/Conflicts**

- STOPPING COMPLIANCE GOOD WHEN PEDESTRIANS PRESENT.
- MOST STUDENTS ACCOMPANIED BY PARENTS.
- PEDESTRIANS CROSSED CONFIDENTLY.
- VEHICLES COURTEOUS TO CROSSING PEDESTRIANS. INTERSECTION FUNCTIONS WELL.
- ALL WAY STOP PROVIDES PROTECTION FOR CROSSING STUDENTS.
- INTERSECTION WELL MARKED, ZEBRA STRIPING NORTH AND EAST LEGS.
- A NUMBER OF VEHICLES USE THE DAVID LEEDER MIDDLE SCHOOL KISS AND RIDE ALLEVIATING CONGESTION IN FRONT OF THE SCHOOL.
- SIGNAGE IN PLACE.

**Recommendations**

- 1) THAT THE WARRANTS HAVE NOT BEEN MET FOR THE PLACEMENT OF A SCHOOL CROSSING GUARD.

## Site Inspection Report

Traffic Safety Council

JUN 21 2017

Corporate Services  
Office of the City Clerk

<b>Site</b>	
School: Meadowvale Village Public School	Address: 890 Old Derry Rd. West Mississauga, Ontario L5W 1A1
School Times: 9:10 AM 3:40 PM	WTS: <input checked="" type="checkbox"/> Yes <input type="checkbox"/> No
Student Population: 552	French Immersion Population: <input type="checkbox"/>
No. of Large Buses: <input type="checkbox"/>	No. of Small Buses: <input type="checkbox"/>
No. of Students on the Bus: 342	No. of Students on the Bus: <input type="checkbox"/>
School: <input type="text"/>	Address: <input type="text"/>
School Times: <input type="text"/> AM <input type="text"/> PM	WTS: <input type="checkbox"/> Yes <input type="checkbox"/> No
Student Population: <input type="text"/>	French Immersion Population: <input type="text"/>
No. of Large Buses: <input type="text"/>	No. of Small Buses: <input type="text"/>
No. of Students on the Bus: <input type="text"/>	No. of Students on the Bus: <input type="text"/>
Location: (Please identify the location with reference or nearest intersection. Indicate nearest school and address) Old Derry Rd. and Gooderham Estates Blvd.	
Proximity to School: <input type="checkbox"/> in front of <input checked="" type="checkbox"/> within 180 feet/metres	
Accident History (during school times): Yes <input type="checkbox"/> No <input type="checkbox"/> Comments: <input type="text"/>	
Date of Inspection: AM 2017 05 04 PM 2017 05 31	Inspection Time: 8:40 AM 3:40 PM
Requested By: Public Health Nurse	
Prepared By: D. Suess-AM, H. Kocznur-PM	Request For: Placement of a School Crossing Guard

<b>Observers</b>	
File Number: RT.10	File Number: RT.10
Ward: Ward 11	
Observed By: D. Suess	<input checked="" type="checkbox"/> AM <input type="checkbox"/> PM <input type="checkbox"/> AM & PM
Observed By: B. Butt	<input type="checkbox"/> AM <input type="checkbox"/> PM <input checked="" type="checkbox"/> AM & PM
Observed By: H. Relf	<input type="checkbox"/> AM <input checked="" type="checkbox"/> PM <input type="checkbox"/> AM & PM
Observed By: H. Kocznur	<input type="checkbox"/> AM <input type="checkbox"/> PM <input checked="" type="checkbox"/> AM & PM
Observed By: <input type="text"/>	<input type="checkbox"/> AM <input type="checkbox"/> PM <input type="checkbox"/> AM & PM
Observed By: <input type="text"/>	<input type="checkbox"/> AM <input type="checkbox"/> PM <input type="checkbox"/> AM & PM

<b>Site Conditions</b>	
School Signs: <input checked="" type="checkbox"/> School Area Signs <input checked="" type="checkbox"/> School Crossing Signs <input type="checkbox"/> Parking/Stopping Prohibition	
Posted Speed Limit: <input checked="" type="checkbox"/> 40 km/hr <input type="checkbox"/> 50 km/hr <input type="checkbox"/> 60 km/hr <input type="checkbox"/> Other: <input type="text"/>	
Visibility of Crossing Pedestrians: <input type="checkbox"/> Poor <input type="checkbox"/> Fair <input checked="" type="checkbox"/> Good	Comments: <input type="text"/>
Sight Obstructions: <input type="checkbox"/> Hedges <input type="checkbox"/> Trees <input type="checkbox"/> Fences <input type="checkbox"/> Bus Shelter	
<input type="checkbox"/> Newspaper Boxes <input type="checkbox"/> Other (Specify): <input type="text"/>	
Road Grade: <input checked="" type="checkbox"/> Flat <input type="checkbox"/> Incline <input type="checkbox"/> Decline	
Road Geometrics: <input checked="" type="checkbox"/> Straight <input type="checkbox"/> Curved	Comments: <input type="text"/>
Road Width: 16 metres	Curb to Curb: <input type="text"/> feet/metres
Leg: <input type="checkbox"/> N <input checked="" type="checkbox"/> S <input type="checkbox"/> E <input type="checkbox"/> W	No. of Bike Lanes: <input type="text"/> No. of Through Lanes: 2 No. of Turning Lanes: <input type="text"/>
Road Width: 16 metres	Curb to Curb: <input type="text"/> feet/metres
Leg: <input type="checkbox"/> N <input checked="" type="checkbox"/> S <input type="checkbox"/> E <input type="checkbox"/> W	No. of Bike Lanes: <input type="text"/> No. of Through Lanes: 2 No. of Turning Lanes: <input type="text"/>
Road Conditions: AM: <input checked="" type="checkbox"/> Dry <input type="checkbox"/> Wet <input type="checkbox"/> Snow Covered <input type="checkbox"/> Ice	
PM: <input checked="" type="checkbox"/> Dry <input type="checkbox"/> Wet <input type="checkbox"/> Snow Covered <input type="checkbox"/> Ice	
Sidewalks: <input type="checkbox"/> Not Present <input checked="" type="checkbox"/> North <input checked="" type="checkbox"/> South <input type="checkbox"/> East <input checked="" type="checkbox"/> West	
Route Survey: <input type="checkbox"/> Shopping Area <input type="checkbox"/> Construction <input checked="" type="checkbox"/> Driveway <input type="checkbox"/> Parked Vehicle(s)	
<input checked="" type="checkbox"/> Transit Bus Stop <input type="checkbox"/> Underpass Within <input type="text"/> feet/metres	Other (specify): <input type="text"/>

## Details

Weather Conditions:	AM: <input checked="" type="checkbox"/> Dry <input type="checkbox"/> Sunny <input type="checkbox"/> Rain <input type="checkbox"/> Snow	Temperature: <input type="text" value="9 C"/> Other: <input type="text"/>
	PM: <input checked="" type="checkbox"/> Dry <input checked="" type="checkbox"/> Sunny <input type="checkbox"/> Rain <input type="checkbox"/> Snow	Temperature: <input type="text" value="23 C"/> Other: <input type="text"/>
Type of Crossing:	<input checked="" type="checkbox"/> 4 Way Intersection <input type="checkbox"/> 3 Way Intersection	<input type="checkbox"/> Midblock (i.e., not an intersection)
Type of Control:	<input type="checkbox"/> Traffic Lights <input type="checkbox"/> Yield Signs	<input type="checkbox"/> No Control <input type="checkbox"/> Adequate Control
	<input type="checkbox"/> Stop Signs (Traffic is stopped on one street only)	<input checked="" type="checkbox"/> All Way Stop (Traffic is stopped in all directions)

## Crossing Guard Warrant Survey

Location: Old Derry Rd. and Gooderham Estates Blvd.	
<input checked="" type="checkbox"/> Safe Gap Time	Safe Gap Time Calculation (if applicable): $\left( \frac{W}{3.5} + 4 \right)$ <span style="border: 1px solid black; padding: 2px;">19</span> = sec.
<input type="checkbox"/> Signalized Intersection Turning Traffic Count	

## Morning Intervals

[illegible]

## Afternoon Intervals

[illegible]

5.3 - 3

Morning Intervals			
# of Peds	Time (AM)	Gaps Leg: <input type="checkbox"/> N <input type="checkbox"/> S <input type="checkbox"/> E <input checked="" type="checkbox"/> W	# of Gaps
	7:30 - 7:35		
	7:35 - 7:40		
	7:40 - 7:45		
	7:45 - 7:50	19	1
	7:50 - 7:55	30	1
	7:55 - 8:00	21	1
	8:00 - 8:05	22	1
	8:05 - 8:10	35	1
	8:10 - 8:15	20, 23, 25	3
	8:15 - 8:20		
	8:20 - 8:25		
	8:25 - 8:30		
	8:30 - 8:35		
	8:35 - 8:40		
	8:40 - 8:45		
	8:45 - 8:50		
	8:50 - 8:55		
	8:55 - 9:00		

Afternoon Intervals			
# of Peds	Time (PM)	Gaps Leg: <input type="checkbox"/> N <input type="checkbox"/> S <input type="checkbox"/> E <input checked="" type="checkbox"/> W	# of Gaps
	2:30 - 2:35		
	2:35 - 2:40		
	2:40 - 2:45	28, 25	2
	2:45 - 2:50	20	1
	2:50 - 2:55	21, 30, 24	3
	2:55 - 3:00	25, 23, 40	3
	3:00 - 3:05	37, 22, 35	3
	3:05 - 3:10	23	1
	3:10 - 3:15		
	3:15 - 3:20		
	3:20 - 3:25		
	3:25 - 3:30		
	3:30 - 3:35		
	3:35 - 3:40		
	3:40 - 3:45		
	3:45 - 3:50		
	3:50 - 3:55		
	3:55 - 4:00		



**Observations**

Volume of Traffic (see Intersection Plan):

AM: ☒ Heavy ☐ Light ☐ IntermittentPM: ☒ Heavy ☐ Light ☐ Intermittent

Number of Crossing Pedestrians:

AM: North  East  South  West PM: North  East  South  West 

Turning Traffic:

AM: ☒ Heavy ☐ Light ☐ IntermittentPM: ☒ Heavy ☐ Light ☐ Intermittent**Traffic Behaviour**AM: ☐ Illegal U-turns ☐ Running Red Light ☐ Speeding ☒ Stopping Non-Compliance ☐ Illegal Stopping ☐ Illegal Parking ☐ OtherPM: ☐ Illegal U-turns ☐ Running Red Light ☐ Speeding ☐ Stopping Non-Compliance ☐ Illegal Stopping ☐ Illegal Parking ☐ Other**Comments/Conflicts**

- INTERSECTION FUNCTIONS WELL.
- NO CONFLICTS OBSERVED.
- ALL WAY STOP PROVIDES PROTECTION FOR CROSSING STUDENTS.
- NO STUDENTS CROSSED ON THE WEST LEG OF THE INTERSECTION BETWEEN 8:40 - 9:10 AM; TWO STUDENTS CROSSED BETWEEN 9:10 - 9:15 AM, AFTER THE SCHOOL BELL.

**Recommendations**

- 1) THAT THE WARRANTS HAVE NOT BEEN MET FOR THE PLACEMENT OF A SCHOOL CROSSING GUARD.

5.4 -1

## Site Inspection Report

Traffic Safety Council

JUN 21 2017

Corporate Services  
Office of the City Clerk

<b>Site</b>	
School: <b>Homelands Senior Public School</b>	Address: <b>2420 Homelands Drive Mississauga, Ontario L5K 1H2</b>
Student Population: <b>437</b>	French Immersion Population: <b>111</b>
No. of Large Buses: <b>6 Vans</b>	No. of Small Buses: <b>8</b>
No. of Students on the Bus: <b>299</b>	No. of Students on the Bus: <b></b>
School Times: <b>8:30 AM</b> <b>2:30 PM</b>	WTS: <input checked="" type="checkbox"/> Yes <input type="checkbox"/> No
School: <b></b>	Address: <b></b>
Student Population: <b></b>	French Immersion Population: <b></b>
No. of Large Buses: <b></b>	No. of Small Buses: <b></b>
No. of Students on the Bus: <b></b>	No. of Students on the Bus: <b></b>
Location: (Please identify the location with reference or nearest intersection. Indicate nearest school and address) <b>IFOS @ 2420 Homelands Drive</b>	
Proximity to School: <input checked="" type="checkbox"/> In front of <input type="checkbox"/> within <b></b> feet/metres	
Accident History (during school times): Yes <input type="checkbox"/> No <input type="checkbox"/> Comments: <b></b>	
Date of Inspection: <b>2017 06 06</b>	Inspection Time: <b>8:00 AM</b> <b>2:30 PM</b>
Prepared By: <b>H. Kocznr/S. Duffin</b>	Request For: <b>Safety Review</b>

<b>Observers</b>	
File Number: <b>RT.10</b>	File Number: <b>RT.10</b>
Observed By: <b>D. Gordon-Mohamud</b>	Ward: <b>Ward 2</b>
Observed By: <b>B. Butt</b>	<input checked="" type="checkbox"/> AM <input type="checkbox"/> PM <input type="checkbox"/> AM & PM
Observed By: <b>S. Beniuk</b>	<input checked="" type="checkbox"/> AM <input type="checkbox"/> PM <input type="checkbox"/> AM & PM
Observed By: <b>S. Duffin</b>	<input type="checkbox"/> AM <input type="checkbox"/> PM <input checked="" type="checkbox"/> AM & PM
Observed By: <b>H. Kocznr</b>	<input type="checkbox"/> AM <input type="checkbox"/> PM <input checked="" type="checkbox"/> AM & PM
Observed By: <b></b>	<input type="checkbox"/> AM <input type="checkbox"/> PM <input type="checkbox"/> AM & PM

<b>Site Conditions</b>	
School Signs: <input checked="" type="checkbox"/> School Area Signs <input type="checkbox"/> School Crossing Signs <input checked="" type="checkbox"/> Parking/Stopping Prohibition	
Posted Speed Limit: <input checked="" type="checkbox"/> 40 km/hr <input type="checkbox"/> 50 km/hr <input type="checkbox"/> 60 km/hr <input type="checkbox"/> Other: <b></b>	
Visibility of Crossing Pedestrians: <input type="checkbox"/> Poor <input type="checkbox"/> Fair <input checked="" type="checkbox"/> Good	Comments: <b></b>
Sight Obstructions: <input type="checkbox"/> Hedges <input type="checkbox"/> Trees <input type="checkbox"/> Fences <input type="checkbox"/> Bus Shelter	
<input type="checkbox"/> Newspaper Boxes <input type="checkbox"/> Other (Specify): <b></b>	
Road Grade: <input type="checkbox"/> Flat <input type="checkbox"/> Incline <input checked="" type="checkbox"/> Decline	
Road Geometrics: <input checked="" type="checkbox"/> Straight <input type="checkbox"/> Curved	Comments: <b></b>
Road Width: <b>31 feet</b> Curb to Curb: <b></b> feet/metres	No. of Bike Lanes: <b>2</b> No. of Through Lanes: <b></b> No. of Turning Lanes: <b></b>
Leg: <input type="checkbox"/> N <input type="checkbox"/> S <input type="checkbox"/> E <input type="checkbox"/> W	
Road Width: <b></b> Curb to Curb: <b></b> feet/metres	No. of Bike Lanes: <b></b> No. of Through Lanes: <b></b> No. of Turning Lanes: <b></b>
Leg: <input type="checkbox"/> N <input type="checkbox"/> S <input type="checkbox"/> E <input type="checkbox"/> W	
Road Conditions: AM: <input type="checkbox"/> Dry <input checked="" type="checkbox"/> Wet <input type="checkbox"/> Snow Covered <input type="checkbox"/> Ice	
PM: <input type="checkbox"/> Dry <input checked="" type="checkbox"/> Wet <input type="checkbox"/> Snow Covered <input type="checkbox"/> Ice	
Sidewalks: <input type="checkbox"/> Not Present <input checked="" type="checkbox"/> North <input checked="" type="checkbox"/> South <input type="checkbox"/> East <input type="checkbox"/> West	
Route Survey: <input type="checkbox"/> Shopping Area <input type="checkbox"/> Construction <input type="checkbox"/> Driveway <input type="checkbox"/> Parked Vehicle(s)	
<input checked="" type="checkbox"/> Transit Bus Stop <input type="checkbox"/> Underpass Within <b></b> feet/metres	Other (specify): <b></b>



5.4 - 3

### Observations

Volume of Traffic (see Intersection Plan):

AM: ☒ Heavy ☐ Light ☐ Intermittent PM: ☐ Heavy ☐ Light ☒ Intermittent

Number of Crossing Pedestrians:

AM: North  East  South  West  PM: North  East  South  West

Turning Traffic:

AM: ☐ Heavy ☐ Light ☐ Intermittent PM: ☐ Heavy ☐ Light ☐ Intermittent

### Traffic Behaviour

AM: ☐ Illegal U-turns ☐ Running Red Light ☒ Speeding ☐ Stopping Non-Compliance ☒ Illegal Stopping ☐ Illegal Parking ☐ Other

PM: ☐ Illegal U-turns ☐ Running Red Light ☐ Speeding ☐ Stopping Non-Compliance ☒ Illegal Stopping ☒ Illegal Parking ☐ Other

### Comments/Conflicts

- SCHOOL BUS LOADING ZONE MARKED IN FRONT OF THE SCHOOL, NOT USED, ALL SCHOOL BUSES ACCOMMODATED ON SCHOOL PROPERTY.
- SPEEDING IN AM ONLY EASTBOUND AND ILLEGAL STOPPING CONCERNS IN AM AND PM.
- TEACHER ADVISES THAT 150 STUDENTS ARE ON A SCHOOL TRIP.
- TRAFFIC STOPS FOR PEDESTRIANS TO CROSS AT THORNLODGE PARK PATHWAY OPPOSITE THE SCHOOL.
- TEACHER ASSISTED PEDESTRIANS IN THE AM TO CROSS THE ROAD.
- SPEED BOARD PRESENT WESTBOUND.
- STUDENTS CROSS BOTH DIRECTIONS AT PARK PATHWAY TO ACCESS VARIOUS AREA SCHOOLS, NOT JUST HOMELANDS SENIOR PUBLIC SCHOOL.

### Recommendations

- 1) THAT THE SCHOOL BUS LOADING ZONE IN FRONT OF THE SCHOOL BE REMOVED.
- 2) THAT PARKING ENFORCEMENT BE REQUESTED TO ENFORCE "NO STOPPING/NO PARKING" ZONES BETWEEN THE PEAK TIMES OF 8:10 - 8:30 AM AND 2:20 - 2:45 PM.
- 3) THAT PEEL REGIONAL POLICE BE REQUESTED TO ENFORCE 40 KM/HR SPEED ZONE BETWEEN THE PEAK TIMES OF 8:10 - 8:30 AM, AS TIME AND MANPOWER PERMITS.
- 4) THAT TRANSPORTATION AND WORKS BE REQUESTED TO REVIEW THE FEASIBILITY OF INSTALLING A PEDESTRIAN CROSSOVER AT THORNLODGE PARK PATH IN FRONT OF THE SCHOOL.

# Site Inspection Report

Corporate Services  
Office of the City Clerk



<b>Site</b>			
School:	Bishop Scalabrini Catholic Elementary School	Address:	225 Central Parkway West Mississauga, Ontario L5B 3J5
School Times	8:45 AM 3:15 PM	WTS	<input checked="" type="checkbox"/> Yes <input type="checkbox"/> No
Student Population	399	French Immersion Population	
No. of Large Buses		No. of Small Buses	1
No. of Students on the Bus		No. of Students on the Bus	
School:		Address:	
School Times		WTS	<input type="checkbox"/> Yes <input type="checkbox"/> No
Student Population		French Immersion Population	
No. of Large Buses		No. of Small Buses	
No. of Students on the Bus		No. of Students on the Bus	
Location: (Please identify the location with reference or nearest intersection. Indicate nearest school and address)			
IFOS @ 225 Central Parkway West			
Proximity to School			
<input checked="" type="checkbox"/> in front of <input type="checkbox"/> within <input type="checkbox"/> feet/metres			
Accident History (during school times) Yes <input type="checkbox"/> No <input type="checkbox"/> Comments:			
Date of Inspection: 2017 06 08 Inspection Time: 8:15 AM 3:05 PM Requested By: Councillor/Trustee			
Prepared By: H. Kocznr Request For: Safety Review			

<b>Observers</b>			
File Number:	RT.10	File Number:	RT.10
Ward:	Ward 7		
Observed By:	T. Coulson	<input type="checkbox"/> AM	<input type="checkbox"/> PM <input checked="" type="checkbox"/> AM & PM
Observed By:	H. Kocznr	<input type="checkbox"/> AM	<input type="checkbox"/> PM <input checked="" type="checkbox"/> AM & PM
Observed By:		<input type="checkbox"/> AM	<input type="checkbox"/> PM <input type="checkbox"/> AM & PM
Observed By:		<input type="checkbox"/> AM	<input type="checkbox"/> PM <input type="checkbox"/> AM & PM
Observed By:		<input type="checkbox"/> AM	<input type="checkbox"/> PM <input type="checkbox"/> AM & PM
Observed By:		<input type="checkbox"/> AM	<input type="checkbox"/> PM <input type="checkbox"/> AM & PM

<b>Site Conditions</b>			
School Signs:	<input checked="" type="checkbox"/> School Area Signs	<input type="checkbox"/> School Crossing Signs	<input type="checkbox"/> Parking/Stopping Prohibition
Posted Speed Limit:	<input checked="" type="checkbox"/> 40 km/hr	<input type="checkbox"/> 50 km/hr	<input type="checkbox"/> 60 km/hr
Other:	Flashing 40 km's Signs		
Visibility of Crossing Pedestrians:	<input type="checkbox"/> Poor	<input type="checkbox"/> Fair	<input checked="" type="checkbox"/> Good
Comments:			
Sight Obstructions:	<input type="checkbox"/> Hedges	<input type="checkbox"/> Trees	<input type="checkbox"/> Fences
<input type="checkbox"/> Newspaper Boxes	<input type="checkbox"/> Other (Specify):	<input type="checkbox"/> Bus Shelter	
Road Grade:	<input checked="" type="checkbox"/> Flat	<input type="checkbox"/> Incline	<input type="checkbox"/> Decline
Road Geometrics:	<input checked="" type="checkbox"/> Straight	<input type="checkbox"/> Curved	Comments:
Road Width: 16.9 metres	Curb to Curb: 17.1 feet/metres	No. of Bike Lanes	No. of Through Lanes 4
Leg: <input type="checkbox"/> N <input type="checkbox"/> S <input type="checkbox"/> E <input type="checkbox"/> W		No. of Turning Lanes	
Road Width:	Curb to Curb:	No. of Bike Lanes	No. of Through Lanes
Leg: <input type="checkbox"/> N <input type="checkbox"/> S <input type="checkbox"/> E <input type="checkbox"/> W		No. of Turning Lanes	
Road Conditions:	AM: <input checked="" type="checkbox"/> Dry <input type="checkbox"/> Wet	<input type="checkbox"/> Snow Covered	<input type="checkbox"/> Ice
PM: <input checked="" type="checkbox"/> Dry <input type="checkbox"/> Wet	<input type="checkbox"/> Snow Covered	<input type="checkbox"/> Ice	
Sidewalks:	<input type="checkbox"/> Not Present	<input checked="" type="checkbox"/> North	<input checked="" type="checkbox"/> South
<input type="checkbox"/> East	<input type="checkbox"/> West		
Route Survey:	<input checked="" type="checkbox"/> Shopping Area	<input type="checkbox"/> Construction	<input type="checkbox"/> Driveway
<input type="checkbox"/> Transit Bus Stop	<input type="checkbox"/> Underpass	Within <input type="checkbox"/> feet/metres	<input type="checkbox"/> Parked Vehicle(s)
Other (specify):			

**Details**

Weather Conditions: AM: ☒ Dry ☒ Sunny ☐ Rain ☐ Snow Temperature: 17 C Other: \_\_\_\_\_  
 PM: ☒ Dry ☒ Sunny ☐ Rain ☐ Snow Temperature: 26 C Other: \_\_\_\_\_

Type of Crossing: ☐ 4 Way Intersection ☐ 3 Way Intersection ☒ Midblock (i.e., not an intersection)

Type of Control: ☐ Traffic Lights ☐ Yield Signs ☒ No Control ☐ Adequate Control  
☐ Stop Signs (Traffic is stopped on one street only) ☐ All Way Stop (Traffic is stopped in all directions)

**Crossing Guard Warrant Survey**

Location: IFOS @ 225 Central Parkway West

☐ Safe Gap Time Safe Gap Time Calculation (if applicable):  $\left( \frac{W}{3.5} + 4 \right)$  = sec.  
☐ Signalized Intersection Turning Traffic Count

**Morning Intervals**

# of Peds	Time (AM)	Leg: <input type="checkbox"/> N <input type="checkbox"/> S <input type="checkbox"/> E <input type="checkbox"/> W	# of Gaps
	7:30 - 7:35		
	7:35 - 7:40		
	7:40 - 7:45		
	7:45 - 7:50		
	7:50 - 7:55		
	7:55 - 8:00		
	8:00 - 8:05		
	8:05 - 8:10		
	8:10 - 8:15		
	8:15 - 8:20		
	8:20 - 8:25		
	8:25 - 8:30		
	8:30 - 8:35		
	8:35 - 8:40		
	8:40 - 8:45		
	8:45 - 8:50		
	8:50 - 8:55		
	8:55 - 9:00		

**Afternoon Intervals**

# of Peds	Time (PM)	Leg: <input type="checkbox"/> N <input type="checkbox"/> S <input type="checkbox"/> E <input type="checkbox"/> W	# of Gaps
	2:30 - 2:35		
	2:35 - 2:40		
	2:40 - 2:45		
	2:45 - 2:50		
	2:50 - 2:55		
	2:55 - 3:00		
	3:00 - 3:05		
	3:05 - 3:10		
	3:10 - 3:15		
	3:15 - 3:20		
	3:20 - 3:25		
	3:25 - 3:30		
	3:30 - 3:35		
	3:35 - 3:40		
	3:40 - 3:45		
	3:45 - 3:50		
	3:50 - 3:55		
	3:55 - 4:00		

**Observations**

Volume of Traffic (see Intersection Plan):

AM: ☐ Heavy ☐ Light ☒ IntermittentPM: ☐ Heavy ☒ Light ☐ Intermittent

Number of Crossing Pedestrians:

AM: North ☐ East ☐ South ☐ West ☐ PM: North ☐ East ☐ South ☐ West ☐

Turning Traffic:

AM: ☐ Heavy ☐ Light ☐ IntermittentPM: ☐ Heavy ☐ Light ☐ Intermittent**Traffic Behaviour**AM: ☐ Illegal U-turns ☐ Running Red Light ☐ Speeding ☐ Stopping Non-Compliance ☐ Illegal Stopping ☐ Illegal Parking ☐ OtherPM: ☐ Illegal U-turns ☐ Running Red Light ☐ Speeding ☐ Stopping Non-Compliance ☐ Illegal Stopping ☐ Illegal Parking ☐ Other**Comments/Conflicts**

- KISS AND RIDE UNDERUTILIZED; FUNCTIONS WELL.
- PLENTY OF PARKING.
- PARKING LOT FLOWS WELL.
- NO CONFLICTS OBSERVED.

**Recommendations**

- 1) THAT THE PRINCIPAL OF BISHOP SCALABRINI CATHOLIC ELEMENTARY SCHOOL BE REQUESTED TO REMIND PARENTS TO NOT PARK IN THE STAFF PARKING LOT BUT INSTEAD TO USE THE KISS AND RIDE.

5.6 -1

Traffic Safety Council

JUN 21 2017

## Site Inspection Report

Corporate Services  
Office of the City Clerk

<b>Site</b>		<b>School:</b> Bishop Scalabrini Catholic Elementary School		<b>Address:</b> 225 Central Parkway West Mississauga, Ontario L5B 3J5		<b>School Times:</b> 8:45 AM 3:15 PM	
<b>Student Population:</b> 399		<b>French Immersion Population:</b>		<b>No. of Large Buses:</b>		<b>No. of Small Buses:</b> 1	
<b>WTS:</b> <input checked="" type="checkbox"/> Yes <input type="checkbox"/> No		<b>No. of Students on the Bus:</b>		<b>No. of Students on the Bus:</b>			
<b>School:</b>		<b>Address:</b>		<b>School Times:</b>		<b>WTS:</b> <input type="checkbox"/> Yes <input type="checkbox"/> No	
<b>Student Population:</b>		<b>French Immersion Population:</b>		<b>No. of Large Buses:</b>		<b>No. of Small Buses:</b>	
<b>No. of Students on the Bus:</b>		<b>No. of Students on the Bus:</b>		<b>No. of Students on the Bus:</b>			
<b>Location:</b> (Please identify the location with reference or nearest intersection. Indicate nearest school and address) At the rear of the school on Palgrave Rd. and Melville Ave.							
<b>Proximity to School:</b> <input checked="" type="checkbox"/> At the rear of the school <input type="checkbox"/> within _____ feet/metres							
<b>Accident History (during school times):</b> Yes <input type="checkbox"/> No <input type="checkbox"/> <b>Comments:</b>							
<b>Date of Inspection:</b> 2017 06 08		<b>Inspection Time:</b> 8:15 AM 3:05 PM		<b>Requested By:</b> Councillor/Trustee			
<b>Prepared By:</b> A. Liya/S. Duffin				<b>Request For:</b> Safety Review			

<b>Observers</b>		<b>File Number:</b> RT.10		<b>File Number:</b> RT.10		<b>Ward:</b> Ward 7	
<b>Observed By:</b> L. Goegan		<input type="checkbox"/> AM <input type="checkbox"/> PM <input checked="" type="checkbox"/> AM & PM					
<b>Observed By:</b> A. Bhaskar		<input checked="" type="checkbox"/> AM <input type="checkbox"/> PM <input type="checkbox"/> AM & PM					
<b>Observed By:</b> A. Liya		<input type="checkbox"/> AM <input type="checkbox"/> PM <input checked="" type="checkbox"/> AM & PM					
<b>Observed By:</b> S. Duffin		<input type="checkbox"/> AM <input type="checkbox"/> PM <input checked="" type="checkbox"/> AM & PM					
<b>Observed By:</b>		<input type="checkbox"/> AM <input type="checkbox"/> PM <input type="checkbox"/> AM & PM					
<b>Observed By:</b>		<input type="checkbox"/> AM <input type="checkbox"/> PM <input type="checkbox"/> AM & PM					

<b>Site Conditions</b>							
<b>School Signs:</b>		<input type="checkbox"/> School Area Signs		<input type="checkbox"/> School Crossing Signs		<input type="checkbox"/> Parking/Stopping Prohibition	
<b>Posted Speed Limit:</b>		<input type="checkbox"/> 40 km/hr		<input checked="" type="checkbox"/> 50 km/hr		<input type="checkbox"/> 60 km/hr	
<b>Visibility of Crossing Pedestrians:</b>		<input type="checkbox"/> Poor		<input type="checkbox"/> Fair		<input checked="" type="checkbox"/> Good	
<b>Sight Obstructions:</b>		<input type="checkbox"/> Hedges		<input type="checkbox"/> Trees		<input type="checkbox"/> Fences	
<b>Road Grade:</b>		<input checked="" type="checkbox"/> Flat		<input type="checkbox"/> Incline		<input type="checkbox"/> Decline	
<b>Road Geometrics:</b>		<input checked="" type="checkbox"/> Straight		<input type="checkbox"/> Curved		<b>Comments:</b>	
<b>Road Width:</b>		<b>Curb to Curb:</b>		<b>No. of Bike Lanes:</b>		<b>No. of Through Lanes:</b> 2	
<b>Leg:</b> <input type="checkbox"/> N <input type="checkbox"/> S <input type="checkbox"/> E <input type="checkbox"/> W		<b>feet/metres:</b>		<b>No. of Turning Lanes:</b>			
<b>Road Width:</b>		<b>Curb to Curb:</b>		<b>No. of Bike Lanes:</b>		<b>No. of Through Lanes:</b>	
<b>Leg:</b> <input type="checkbox"/> N <input type="checkbox"/> S <input type="checkbox"/> E <input type="checkbox"/> W		<b>feet/metres:</b>		<b>No. of Turning Lanes:</b>			
<b>Road Conditions:</b>		<b>AM:</b> <input checked="" type="checkbox"/> Dry <input type="checkbox"/> Wet		<input type="checkbox"/> Snow Covered		<input type="checkbox"/> Ice	
<b>PM:</b> <input checked="" type="checkbox"/> Dry <input type="checkbox"/> Wet		<input type="checkbox"/> Snow Covered		<input type="checkbox"/> Ice			
<b>Sidewalks:</b>		<input type="checkbox"/> Not Present		<input checked="" type="checkbox"/> North		<input type="checkbox"/> South	
<b>Route Survey:</b>		<input type="checkbox"/> Shopping Area		<input type="checkbox"/> Construction		<input type="checkbox"/> Driveway	
<input type="checkbox"/> Transit Bus Stop		<input type="checkbox"/> Underpass		<b>Within</b>		<b>feet/metres:</b>	
<input type="checkbox"/> Other (specify):							



<b>Details</b>					
Weather Conditions:	AM: <input checked="" type="checkbox"/> Dry <input checked="" type="checkbox"/> Sunny <input type="checkbox"/> Rain <input type="checkbox"/> Snow	Temperature: <input type="text"/> 17 C	Other: <input type="text"/>		
	PM: <input checked="" type="checkbox"/> Dry <input checked="" type="checkbox"/> Sunny <input type="checkbox"/> Rain <input type="checkbox"/> Snow	Temperature: <input type="text"/> 26 C	Other: <input type="text"/>		
Type of Crossing:	<input type="checkbox"/> 4 Way Intersection <input checked="" type="checkbox"/> 3 Way Intersection <input type="checkbox"/> Midblock (i.e., not an intersection)				
Type of Control:	<input type="checkbox"/> Traffic Lights <input type="checkbox"/> Yield Signs <input type="checkbox"/> No Control <input type="checkbox"/> Adequate Control <input type="checkbox"/> Stop Signs (Traffic is stopped on one street only) <input type="checkbox"/> All Way Stop (Traffic is stopped in all directions)				

<b>Crossing Guard Warrant Survey</b>	
Location:	At the rear of the school on Palgrave Rd. and Melville Ave.
<input type="checkbox"/> Safe Gap Time <input type="checkbox"/> Signalized Intersection Turning Traffic Count	Safe Gap Time Calculation (if applicable): $\left( \frac{W}{3.5} + 4 \right)$ <input type="text"/> = sec. (width figure measured in feet)

Morning Intervals			
# of Peds	Time (AM)	Gaps Leg: <input type="checkbox"/> N <input type="checkbox"/> S <input type="checkbox"/> E <input type="checkbox"/> W	# of Gaps
	7:30 - 7:35		
	7:35 - 7:40		
	7:40 - 7:45		
	7:45 - 7:50		
	7:50 - 7:55		
	7:55 - 8:00		
	8:00 - 8:05		
	8:05 - 8:10		
	8:10 - 8:15		
	8:15 - 8:20		
	8:20 - 8:25		
	8:25 - 8:30		
	8:30 - 8:35		
	8:35 - 8:40		
	8:40 - 8:45		
	8:45 - 8:50		
	8:50 - 8:55		
	8:55 - 9:00		

Afternoon Intervals			
# of Peds	Time (PM)	Gaps Leg: <input type="checkbox"/> N <input type="checkbox"/> S <input type="checkbox"/> E <input type="checkbox"/> W	# of Gaps
	2:30 - 2:35		
	2:35 - 2:40		
	2:40 - 2:45		
	2:45 - 2:50		
	2:50 - 2:55		
	2:55 - 3:00		
	3:00 - 3:05		
	3:05 - 3:10		
	3:10 - 3:15		
	3:15 - 3:20		
	3:20 - 3:25		
	3:25 - 3:30		
	3:30 - 3:35		
	3:35 - 3:40		
	3:40 - 3:45		
	3:45 - 3:50		
	3:50 - 3:55		
	3:55 - 4:00		

**Observations**

Volume of Traffic (see Intersection Plan):

AM: ☐ Heavy ☐ Light ☐ IntermittentPM: ☐ Heavy ☐ Light ☐ Intermittent

Number of Crossing Pedestrians:

AM: North ☐ East ☐ South ☐ 93 West ☐PM: North ☐ East ☐ South ☐ 93 West ☐

Turning Traffic:

AM: ☐ Heavy ☐ Light ☐ IntermittentPM: ☐ Heavy ☐ Light ☐ Intermittent**Traffic Behaviour**AM: ☐ Illegal U-turns ☐ Running Red Light ☐ Speeding ☐ Stopping Non-Compliance ☐ Illegal Stopping ☐ Illegal Parking ☐ OtherPM: ☐ Illegal U-turns ☐ Running Red Light ☐ Speeding ☐ Stopping Non-Compliance ☐ Illegal Stopping ☐ Illegal Parking ☐ Other**Comments/Conflicts**

AM - NUMEROUS VEHICLES STOPPED ON MELVILLE AVE. AND PALGRAVE RD. TO DROP STUDENTS OFF THAT THEN USED THE WALKWAY TO ACCESS BISHOP SCALABRINI CATHOLIC ELEMENTARY SCHOOL. LOCAL TRAFFIC MINIMAL. NEARLY ALL TRAFFIC SCHOOL RELATED.

- SOME VEHICLES PARKED/STOPPED TOO CLOSE TO THE INTERSECTION ON MELVILLE AVE. IMPEDING SIGHTLINES AND TRAFFIC TURNING FROM PALGRAVE RD. ONTO MELVILLE AVE.

- WALKWAY WELL USED BY BISHOP SCALABRINI AND OLDER STUDENTS, 93 IN BOTH AM AND PM AND NUMEROUS PARENTS DROPPING OFF AND PICKING UP.

PM - A MULTITUDE OF VEHICLES PARKED/STOPPED ON MELVILLE AVE. AND PALGRAVE RD. TO PICK UP STUDENTS. ALL USED THE WALKWAY FROM PALGRAVE RD. TO THE SCHOOL AND VICE VERSA. LITTLE LOCAL TRAFFIC. MATURE, QUIET NEIGHBOURHOOD. WALKWAY WELL USED AND SEEMS TO FOSTER A SENSE OF COMMUNITY WITH SCHOOL PARENTS AND STUDENTS.

**Recommendations**

- 1) THAT TRANSPORTATION AND WORKS BE REQUESTED TO INSTALL "NO STOPPING" CORNER PROHIBITIONS ON MELVILLE AVE. AT THE INTERSECTION OF MELVILLE AVE. AND PALGRAVE RD.

**Angie Melo**

**From:** Sheelagh Duffin  
**Sent:** 2017/06/06 12:10 PM  
**To:**  
**Cc:** Ouliana Drobychevskaia; Kimberley Leslie; Angie Melo; Kelly Walter  
**Subject:** SR #3685888 - Chriseden Drive Crosswalk Request

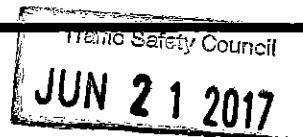

**Follow Up Flag:** Follow up  
**Flag Status:** Flagged

Hello Ms. Kaleman,

Thank you for your enquiry regarding the installation of school crossing signs at Tecumseh Public School.

In Mississauga, school crossing signs are placed only when the crosswalk is manned by a school crossing guard. Mississauga Traffic Safety Council considers matters related to student safety including conducting warrant studies for the implementation of crossing guards.

By copy of this email to Kelly Walter I am requesting that she schedule a site inspection for the students of Tecumseh Public School at the walkway at the east side of Tecumseh Public School to determine if the warrants are met for the implementation of a school crossing guard or if there are other enhancements that could be implemented to better provide for student safety. The times of the inspection would be 8:20 – 8:50 am and 3:20 – 3:50 pm.

You will be notified of the date of the inspection once it is scheduled should you wish to attend. Given the time of year, it may not be possible to schedule the inspection prior to the end of this school year. However, it will be scheduled in the fall, early in the new school year in the.

Kelly, kindly notify Ms. Kaleman of the date of the inspection once it is scheduled at:

MICHELLE KALEMAN

Thank you. Should you have questions regarding the site inspection process, please do not hesitate to contact me.

Sheelagh



**Sheelagh Duffin**  
Supervisor, Crossing Guards  
T 905-896-5167 | F 905 896-5166  
[sheelagh.duffin@mississauga.ca](mailto:sheelagh.duffin@mississauga.ca)

City of Mississauga | Transportation & Works Department,  
Works Operations & Maintenance Division  
3185 Mavis Road, Mississauga ON L5C 1T7

5.8 -1

**Angie Melo**

---

**From:** Sheelagh Duffin  
**Sent:** 2017/06/07 4:49 PM  
**To:** Kelly Walter  
**Cc:** Angie Melo  
**Subject:** FW: Request for Site Inspection in Front of Artesian Drive Public School



**Follow Up Flag:** Follow up  
**Flag Status:** Flagged

Hi Kelly,

Would you kindly schedule a site inspection and gap study at Dunoon Drive and Artesian Drive for the students of Artesian Drive PS to determine if the warrants are met for the placement of a crossing guard. The times of the inspection would be 8:00 – 8:30 am and 2:50 – 3:20 pm.

The site inspection will need to be scheduled in the new school year in September preferable, or October.

Thank you.

Sheelagh  
5167



**Sheelagh Duffin**  
Supervisor, Crossing Guards  
T 905-896-5167 | F 905 896-5166  
[sheelagh.duffin@mississauga.ca](mailto:sheelagh.duffin@mississauga.ca)

City of Mississauga | Transportation & Works Department,  
Works Operations & Maintenance Division  
3185 Mavis Road, Mississauga ON L5C 1T7



Please consider the environment before printing.

---

**From:** Angie Melo  
**Sent:** 2017/06/07 3:05 PM  
**To:** Sheelagh Duffin  
**Subject:** Request for Site Inspection in Front of Artesian Drive Public School

Good afternoon Sheelagh,

I received a called from a resident expressing safety concerns in front of Artesian Drive Public School, and the need for a crossing guard in front of the school. The resident spoke of the incident in which a school child, whom she

claimed, came from nowhere, crossed the street in her scooter, right in front of her car. The resident was shaken 5.8-2  
about the incident and stated that she travels this route every morning and has observed vehicles illegally parked to  
drop their children to school, and that the children are coming out of the vehicles and running across the street to  
the school without looking for oncoming vehicles. The resident advised that she has also contacted Parking  
Enforcement to have the area monitored for the illegal parking.

The resident believes that this area requires a crossing guard so that children can safely walk across the street to the  
school.

Kindly consider the above request for a site inspection on Artesian Drive, in front of Artesian Drive Public School, for  
the placement of a crossing guard.

Regards,  
Angie



**Angie Melo**  
Legislative Coordinator  
T 905-615-3200 ext. 5423  
[angie.melo@mississauga.ca](mailto:angie.melo@mississauga.ca)



Please consider the environment before printing.

5.9-1

**Angie Melo**

**From:** Angie Melo  
**Sent:** 2017/06/15 12:16 PM  
**To:** Angie Melo  
**Subject:** FW: Site Inspection Request - St. Simon Stock Elementary School

Traffic Safety Council

**JUN 21 2017**

---

**From:** Sheelagh Duffin  
**Sent:** 2017/06/15 12:07 PM  
**To:**  
**Cc:** Angie Melo; Kelly Walter; [dale.lucas@dpcdsb.org](mailto:dale.lucas@dpcdsb.org)  
**Subject:** RE: Site Inspection Request - St. Simon Stock Elementary School

Hello Julie,

By copy of this email to Kelly Walter I am requesting that she schedule a safety review in front of St. Simon Stock Catholic School. The times of the inspection would be 8:15 – 8:45 am and 3:15 – 3:45 pm.

The inspection will take place in the fall, 2017. You will be notified of the date once it is scheduled should you wish to attend.

Kelly – kindly coordinate with Dale Lucas of the Dufferin Peel Catholic District School Board to ensure that he is available to review the operation of the Kiss and Ride at the same time.

Thank you.

Sheelagh  
5167



**Sheelagh Duffin**  
Supervisor, Crossing Guards  
T 905-896-5167 | F 905 896-5166  
[sheelagh.duffin@mississauga.ca](mailto:sheelagh.duffin@mississauga.ca)

City of Mississauga | Transportation & Works Department,  
Works Operations & Maintenance Division  
3185 Mavis Road, Mississauga ON L5C 1T7



Please consider the environment before printing.

---

**From:** Angie Melo  
**Sent:** 2017/06/08 8:52 AM  
**To:** Sheelagh Duffin  
**Subject:** Site Inspection Request - St. Simon Stock Elementary School

Good morning Sheelagh,

Please consider the email below requesting a site inspection in front of St. Simon Stock Elementary School.

Thank you  
Angie



**Angie Melo**  
Legislative Coordinator  
T 905-615-3200 ext. 5423  
[angie.melo@mississauga.ca](mailto:angie.melo@mississauga.ca)



Please consider the environment before printing.

---

**From:** Julie Luceno [ ]  
**Sent:** 2017/06/07 8:38 PM  
**To:** Angie Melo  
**Subject:** RE: Traffic Safety Council  
Response

Hi Angie,

Thank you for the update.

I have an additional request with respect to St. Simon Stock School kiss and ride entrance. (6440 Lisgar Dr, Mississauga, ON L5N 6X3).

Right now cars are allowed to park on the road at the entrance of the kiss and ride, see map below with yellow arrow. This means that the cars who want to enter the kiss and ride need to line up on the roadway, completely blocking the roadway to oncoming traffic. The area at the kiss and ride entrance only allows for about 4 or 5 parking spaces, however it causes significant congestion issues during drop off and pick up times. Would it be possible to put either no parking signs in that location, or limit parking to certain hours? This would help to improve the safety and concession at drop off and pick up times. Drop off time is 8:30 to 8:45 and pick up time is 3:15 to 3:30. The drop off is not that bad, but the pick-up time causes issues from 3:00pm when cars start to line, right to 3:30 pm. This is especially an issue on rainy or winter days. Generally speaking, these cars belong to people who are picking up their kids from school, they can easily park in the school parking or on the side street Beechnut Row.

Thank you for your consideration.

Sincerely,  
Julie Luceno-Panza

5.10-1

**Angie Melo**

**From:** Sheelagh Duffin  
**Sent:** 2017/06/13 3:46 PM  
**To:** sandracarusi  
**Cc:** Traffic Safety; Angie Melo; Kelly Walter  
**Subject:** RE: Crossing Guard

Traffic Safety Council  
**JUN 21 2017**

Hello Ms. Carusi,

By copy of this email to Kelly Walter I am requesting that she schedule a Mississauga Traffic Safety Council site inspection and gap study at the intersection of Cherry Post Drive and Corsair Road to determine if the warrants are met for the placement of a school crossing guard for the students of St. Timothy Catholic School. The times of the inspection would be 8:30 – 9:00 am and 3:30 – 4:00 pm.

Since this school year is nearly over, the site inspection will be scheduled in the fall.

Kelly – Kindly notify Ms. Carusi of the date of the inspection once it is scheduled.

Thank you. Should you have any questions regarding the warrant process, please do not hesitate to contact me.

Sheelagh



**Sheelagh Duffin**

Supervisor, Crossing Guards  
T 905-896-5167 | F 905 896-5166

[sheelagh.duffin@mississauga.ca](mailto:sheelagh.duffin@mississauga.ca)

City of Mississauga | Transportation & Works Department,  
Works Operations & Maintenance Division  
3185 Mavis Road, Mississauga ON L5C 1T7



Please consider the environment before printing.

---

**From:** Angie Melo **On Behalf Of** Traffic Safety  
**Sent:** 2017/06/07 10:24 AM  
**To:** Sheelagh Duffin  
**Subject:** FW: Crossing Guard

Please see request below for consideration of the placement of a crossing guard at Cherry Post Drive and Corsair Road, for students attending St. Timothy Catholic School.

Angie



**Angie Melo**

Legislative Coordinator  
T 905-615-3200 ext.5423  
[angie.melo@mississauga.ca](mailto:angie.melo@mississauga.ca)



Please consider the environment before printing.

---

**From:** sandracarusi [redacted]  
**Sent:** 2017/06/07 8:53 AM  
**To:** Traffic Safety  
**Cc:** [sasha.smith@mississauga.ca](mailto:sasha.smith@mississauga.ca)  
**Subject:** Crossing Guard

Hi I live on \_\_\_\_\_ my home backs on to 2 schools Corsair and Camilla. My kids need to cross Corsair to go to the walkway to Florian yo go to their school St Timothy. The parents of Corsair and Camilla speed and don't stop for the kids to cross the street. We would like a crossing guard at Cherry Post and Corsair. Would that be possible?

**Sandra Carusi**

Sent from my Bell Samsung device over Canada's largest network.

**Angie Melo**

**From:** Sheelagh Duffin  
**Sent:** 2017/06/13 11:18 AM  
**To:** Kelly Walter  
**Cc:** Ouliana Drobychevskaia; Angie Melo; mariusz.bartoszi  
**Subject:** FW: Whitehorn Avenue between Pickwick Drive and Duval Drive

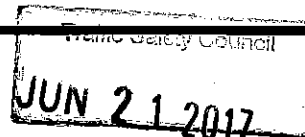

Hi Kelly,

Would you kindly schedule a Mississauga Traffic Safety Council site inspection and gap study at the intersection of Whitehorn Avenue and Mersey Street for the students of Whitehorn Public School and St. Raymond Catholic School for the fall, 2017. The times of the inspection would be 8:00 – 9:00 am and 3:00 – 3:45 pm. As per the resident's request, kindly note that particular attention should be paid to congestion in front of Whitehorn PS and congestion caused by school buses loading and unloading.

Kindly contact M. Bartosz with the date of the inspection once it is scheduled in the event they would like to attend.

Thank you.

Sheelagh  
 5167



**Sheelagh Duffin**  
 Supervisor, Crossing Guards  
 T 905-896-5167 | F 905 896-5166  
[sheelagh.duffin@mississauga.ca](mailto:sheelagh.duffin@mississauga.ca)

City of Mississauga | Transportation & Works Department,  
 Works Operations & Maintenance Division  
 3185 Mavis Road, Mississauga ON L5C 1T7



Please consider the environment before printing.

---

**From:** Ouliana Drobychevskaia  
**Sent:** 2017/06/12 10:46 AM  
**To:** Sheelagh Duffin  
**Subject:** Whitehorn Avenue between Pickwick Drive and Duval Drive

Sheelagh,

As per our conversation last Friday, please see below the resident's contact information and the details of his request. As I previously advised, we scheduled the TMC at the intersection of Whitehorn Avenue and

Mersey Street but I do not expect the warrants to be met. I will inform you about the TMC results once I receive them. Please schedule a sight inspection to see if any improvements (i.e. adjust school buses arrival time, stopping/parking areas, etc.) could be implemented to improve the situation within this section of Whitehorn Avenue.

5.11-2

Thank you,  
Ouliana

MARIUSZ BARTOSZ

"Caller want a stop installed at Mersey St and Whitehorn Ave, says it is a dangerous intersection with school kids going on and off bus"

5.12 -1

## Angie Melo

**From:** Marcotte, David <david.marcotte@peelsb.com>  
**Sent:** 2017/06/14 5:57 AM  
**To:** Sheelagh Duffin; Pinelli, Nadia  
**Cc:** Streete, Cheryl; Kelly Walter; Angie Melo; peter\_westbrook  
**Subject:** Re: School Traffic Safety

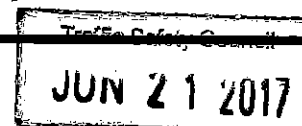

Thank you, we will be in contact in the new school year to address these concerns.

Dave Marcotte  
Maintenance Services  
905-279-4310 ext 1767

---

**From:** Sheelagh Duffin <Sheelagh.Duffin@mississauga.ca>  
**Sent:** Tuesday, June 13, 2017 4:35 PM  
**To:** Pinelli, Nadia  
**Cc:** Streete, Cheryl; Kelly Walter; Angie Melo; peter\_westbrook ; Marcotte, David  
**Subject:** RE: School Traffic Safety

Hi Nadia,

We will change the pm time to 2:45 – 3:15. We do like to arrive before the bell as parents are jockeying for spots to stop/park to pick up their students.

Have a great evening!!

Sheelagh



**Sheelagh Duffin**  
Supervisor, Crossing Guards  
T 905-896-5167 | F 905 896-5166  
[sheelagh.duffin@mississauga.ca](mailto:sheelagh.duffin@mississauga.ca)

City of Mississauga | Transportation & Works Department,  
Works Operations & Maintenance Division  
3185 Mavis Road, Mississauga ON L5C 1T7



Please consider the environment before printing.

**From:** Pinelli, Nadia [mailto:nadia.pinelli@peelsb.com]  
**Sent:** 2017/06/13 4:19 PM  
**To:** Sheelagh Duffin  
**Cc:** Streete, Cheryl; Kelly Walter; Angie Melo; peter\_westbrook ; Marcotte, David  
**Subject:** Re: School Traffic Safety

Thank you very much Sheelagh for your response. The safety review will be very helpful.

I ask that the afternoon review take place between 2:45-3:15pm which is the time when most parents are waiting to pick up students and traffic is heaviest.

Thanks again,  
**Nadia Pinelli**  
Vice Principal  
Bristol Road Middle School  
210 Bristol Road East  
Mississauga, ON L4Z3V5  
P: 905.755.9809 F: 905.755.9196  
@nadiapinelli

---

**From:** Sheelagh Duffin <[Sheelagh.Duffin@mississauga.ca](mailto:Sheelagh.Duffin@mississauga.ca)>  
**Sent:** June 13, 2017 4:14 PM  
**To:** Pinelli, Nadia  
**Cc:** Streete, Cheryl; Kelly Walter; Angie Melo; Peter Westbrook ([peter\\_westbrook](mailto:peter_westbrook)) ; Marcotte, David  
**Subject:** RE: School Traffic Safety

Hello Nadia,

By copy of this email to Kelly Walter I am requesting that she schedule a Mississauga Traffic Safety Council safety review in front of Bristol Road Middle School for early in the new school year in September/October. The times of the safety review would be 8:30 – 9:00 am and 3:00 – 3:30 pm.

Kelly – kindly schedule at a time that is convenient for Dave Marcotte to review the Kiss and Ride at the same time.

Thanks, Nadia. Kelly will advise you also of the date of the safety review once it is scheduled.

Sheelagh



**Sheelagh Duffin**  
Supervisor, Crossing Guards  
T 905-896-5167 | F 905 896-5166  
[sheelagh.duffin@mississauga.ca](mailto:sheelagh.duffin@mississauga.ca)

City of Mississauga | Transportation & Works Department,  
Works Operations & Maintenance Division  
3185 Mavis Road, Mississauga ON L5C 1T7



5.12-3

---

**From:** Pinelli, Nadia [<mailto:nadia.pinelli@peelsb.com>]  
**Sent:** 2017/06/13 12:51 PM  
**To:** Sheelagh Duffin  
**Cc:** Streete, Cheryl  
**Subject:** School Traffic Safety

Hi Sheelagh,

I received your contact information back in March at a meeting you presented at along with your colleague Peter. I am a VP at Bristol Road Middle School and currently looking at taking further safety precautions during our school entry and exit times. It has come to our attention that there is high traffic from parents dropping off and picking up students, causing safety concerns for our staff and students.

Please let me know if you are the right contact and if so, would you be able to visit or call to discuss this further?

Thanks,

**Nadia Pinelli**

Vice Principal  
Bristol Road Middle School  
210 Bristol Road East  
Mississauga, ON L4Z3V5  
P: 905.755.9809 F: 905.755.9196  
@nadiapinelli

*NOTE: This e-mail message is intended for the named recipient(s) above, and may contain information that is privileged, confidential and/or exempt from disclosure under applicable law. If you have received this message in error, or are not the named recipient(s), please do not read the content. Instead, immediately notify the sender and delete this e-mail message. Any unauthorized use, disclosure or distribution is prohibited. The Peel District School Board and sender assume no responsibility for any errors or omissions in the content or transmission of this email.*

*NOTE: This e-mail message is intended for the named recipient(s) above, and may contain information that is privileged, confidential and/or exempt from disclosure under applicable law. If you have received this message in error, or are not the named recipient(s), please do not read the content. Instead, immediately notify the sender and delete this e-mail message. Any unauthorized use, disclosure or distribution is prohibited. The Peel District School Board and sender assume no responsibility for any errors or omissions in the content or transmission of this email.*

May-17			
Reference	School / Location	Item	Action
TSC-0069-2017	Ruth Thompson Middle School	<p>1. That Transportation and Works be requested to consider the feasibility of the following for the students attending Ruth Thompson Middle School:</p> <p>a. Repaint the existing markings (crosswalk and stop bar) at the intersection of Tenth Line West and Sunlight Street/Serena Way.</p> <p>b. Review the pedestrian walk time and ensure it is set at a slow walking speed at the intersection of Tenth Line West and Sunlight Street/Serena Way.</p> <p>c. Repair the northbound pedestrian signal head on the west side as the "red flashing" and the "don't walk hand" signals do not light up at the intersection of Tenth Line West and Sunlight Street/Serena Way.</p>	<p>a) forwarded to Traffic Maintenance Dept</p> <p>b) forwarded to Traffic Signals Dept</p> <p>c) forwarded to Traffic Signals Dept</p>
TSC-0071-2017	St. Richard Catholic School	<p>2. That Transportation and Works be requested to review the signage in front of St. Richard Elementary School.</p>	completed

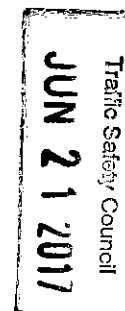

7.1 -1

**Angie Melo**

---

**To:** angie.melo@mississauga.ca  
**Subject:** FW: Your Membership on Traffic Safety Council



**From:** Kathy Vukobrat  
**Sent:** 2017/06/14 10:59 PM  
**To:** Angie Melo  
**Subject:** Re: Your Membership on Traffic Safety Council

Dear Traffic Safety Council Members,

As discussed at our last meeting, I will be moving from Mississauga at the end of June, 2017. Unfortunately, to meet the eligibility requirements to serve as a citizen member on TSC, I must be a Mississauga resident. Therefore, sadly, this letter will serve as my resignation from Traffic Safety Council.

It has been a privilege to participate with such diverse, intelligent and committed people. I will continue to work in Mississauga and hope to have the opportunity to see you at other City events.

Thank you this learning opportunity and please know, it was an honour to meet and work with each member on the TSC. I wish everyone much success.

All the very best!

Kind Regards,

Kathy

Kathy Vukobrat



Angie Melo

7.2-1

Traffic Safety Council

JUN 21 2017

**From:** Sheelagh Duffin  
**Sent:** 2017/06/09 9:34 AM  
**To:** Angie Melo  
**Cc:** Peter Westbrook (peter\_westbrook@mississauga.ca); Kelly Walter  
**Subject:** Emailing: Final%20PAR%20Board%20Decision%20Letter%20to%20Parents.pdf  
**Attachments:** Final%20PAR%20Board%20Decision%20Letter%20to%20Parents.pdf

**Follow Up Flag:** Follow up  
**Flag Status:** Flagged

Hi Angie,

There are no Peel District School Board schools closing in Mississauga for the 2017-2018 school year. However, attached please find the letter from the Dufferin Peel Catholic District School Board that was sent to the St. Dunstan Catholic School and St. Gertrude Catholic School parents advising that those schools would be closing effective June 30, 2017.

This has affected the school crossing at Ceremonial Drive and Mirage Place in front of St. Gertrude. This school crossing is no longer required so I have re-located the crossing guard for September 2017. Site Inspections and gap studies have been requested for September, 2017 for two other crossing locations to determine if the warrants continue to be met for retention of the crossing guard(s). The guards at these locations cross for Champlain Trail Public School as well as St. Gertrude Catholic School. The two locations are, Bristol Road West and Ceremonial Drive and Bristol Road West and Guildwood Way/Shackelton Way (2 crossing guards). We did not have any crossing guards in place to cross students for St. Dunstan Catholic School.

At the request of STOPR, several site inspection and gap studies took place in the spring of 2017 to determine if crossing guards should be placed pro-actively for September 2017 to cross students from St. Dunstan Catholic School that are being re-directed to St. Herbert Catholic School and St. Bernadette Catholic School. They were not recommended pro-actively but were recommended to be re-inspected in September when the students are crossing to their new schools. The locations are:

- 1) Creditview Road and Rathkeale Road for students living south of Eglinton that are being re-directed to St. Bernadette Catholic School
- 2) Creditview Road and Carolyn Road for students living north of Eglinton Avenue that are being re-directed to St. Herbert Catholic School
- 3) Creditview Road and Princelea Place for students living north of Eglinton Avenue that are being re-directed to St. Herbert Catholic School

Thank you.

Sheelagh  
5167



**Sheelagh Duffin**  
Supervisor, Crossing Guards  
T 905-896-5167 | F 905 896-5166  
[sheelagh.duffin@mississauga.ca](mailto:sheelagh.duffin@mississauga.ca)



May 25, 2016

**RE: EAST CREDIT PUPIL ACCOMMODATION REVIEW**

Dear Parents and Guardians:

By now, you would have heard news of the Board of Trustees' decision regarding the East Credit Pupil Accommodation Review in which your school was involved. At its meeting of May 24, the Board approved the closure of two schools, St. Dunstan and St. Gertrude, effective June 2017.

With changes to the way in which the Ministry of Education funds school operating costs, (where schools are now funded to a level commensurate with their enrolment), the reality of declining enrolment and an excess of 1618 pupil places within the schools in the review area, the Board of Trustees was faced with making a difficult decision.

The months of meetings and public engagement opportunities that your community was part of culminated last night when the Board of Trustees received the Final Staff Report which recommended the closure of three schools (St. Valentine, Our Lady of Good Voyage and St. Dunstan), effective June 2017.

During the meeting, a motion with an alternative option was introduced proposing the closure of St. Dunstan and St. Gertrude schools with the following relocations:

- St. Dunstan students residing north of Eglinton Avenue relocate to St. Herbert
- St. Dunstan students residing south of Eglinton Avenue relocate to St. Bernadette
- St. Gertrude regular track students relocate to St. Valentine
- St. Gertrude French Immersion students relocate to St. Gregory

After lengthy debate, Trustees approved the motion, choosing to close only two schools: St. Dunstan and St. Gertrude.

As Trustees, we did not want to close any schools. We were engaged throughout the process reading the many emails, reports and presentations and hearing the community members tell us why we should not close schools. However, as much as we heard and empathized with the many voices of our community members, the fact of the matter remains that we have a significant financial challenge that had to be addressed.

We realize the impact that our decision has on parents and communities. This was an extremely difficult decision for us to have to make.

We will now turn our focus to ensuring strong transitions for the children and families of school communities that will experience a change effective September 2017. Moving forward, the next steps in the process include the creation of a transition plan to facilitate the closures and transition the students and staff into the receiving schools. This will begin in the coming months. We will be communicating with the communities affected in this regard.

**Dufferin-Peel Catholic District School Board**

---

On behalf of the Board of Trustees, I thank you for your engagement and trust that you will continue to work with us as we begin the transition process.

Sincerely,

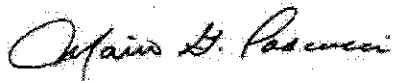

Mario Pascucci  
Chair of the Board

Copies: Board of Trustees

7.3-1



**CITY OF MISSISSAUGA**  
**NOTICE OF STUDY COMPLETION**  
**Municipal Class Environmental Assessment Study**  
**for Mavis Road**

Traffic Safety Council  
**JUN 21 2017**

**Region of Peel**  
 Working for you

The City of Mississauga, in partnership with the Region of Peel, has completed a Municipal Class Environmental Assessment (Class EA) study and preliminary design for the section of Mavis Road from Courtneypark Drive West, in the City of Mississauga, to Ray Lawson Boulevard, in the City of Brampton. The Study was conducted in accordance with the planning and design process for 'Schedule C' projects as outlined in the Municipal Engineers Association *Municipal Class Environmental Assessment* document, as amended in 2015, which is approved under the *Ontario Environmental Assessment Act*.

The study was undertaken to investigate the need for additional north-south capacity and address current and future needs to best serve a variety of users including motorists, transit users, pedestrians and cyclists. A context sensitive design approach was used in recognition of the multi-modal transportation needs of the area while protecting the established residential community and businesses.

The Preferred Design for Mavis Road generally includes the following key elements:

- Widening Mavis Road to 6 through-lanes;
- Reducing the posted speed from 70km/hr to 60 km/hr in the City of Mississauga;
- A sidewalk (east side) and multi-use trail (west side);
- Widening the Highway 407 Bridge to accommodate the additional lanes, sidewalk and multi-use trail;
- No impacts to natural features within the Fletcher's Creek valley;
- Intersection improvements;
- A southbound transit queue jump lane at Derry Road West intersection; and
- Streetscape/landscape mitigation and enhancements.

The Environmental Study Report (ESR) has been prepared to document the planning and decision-making process for this study. By this Notice, the ESR is being placed on the public record for a thirty (30) day review period from and including June 6 to July 5, 2017 at the following locations and through the website [www.mississauga.ca/mavisroadea](http://www.mississauga.ca/mavisroadea):

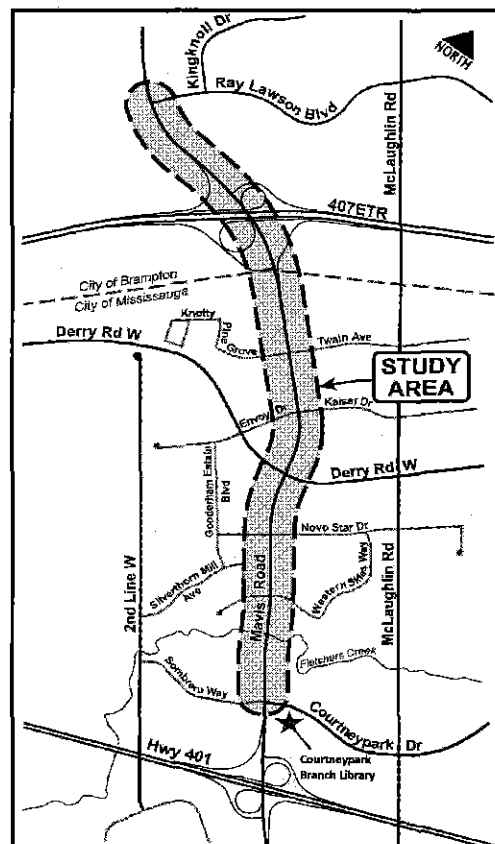

**The City of Mississauga**  
**Office of the City Clerk**  
 300 City Centre Drive, 2nd Floor  
 Mississauga ON L5B 3C1  
 Telephone: 905.615.4311  
 Monday-Friday: 8:30 am to 4:30 pm  
 Weekends: Closed

**The Region of Peel Clerk's**  
**Division**  
 10 Peel Centre Drive  
 Brampton ON L6T 4B9  
 Telephone: 905.791.7800  
 Monday-Friday: 8:30 am to 4:30 pm  
 Weekends: Closed

**Courtneypark Branch Library**  
 730 Courtneypark Drive West  
 Mississauga ON L5W 1L9  
 Telephone: 905.615.4745  
 Monday-Friday: 8:00 am to 9:00 pm  
 Saturday: 9:00 am to 5:00 pm  
 Sunday: 1:00 pm to 5:00 pm

Interested persons may provide written comments to the City of Mississauga's Project Manager, Dana Glofcheskie (see contact information below). If concerns regarding this project cannot be resolved in discussions with the City of Mississauga and Region of Peel, a person or party may request the Minister of the Environment and Climate Change to make an order (referred to as a Part II Order) for the project to comply with Part II of the Environmental Assessment Act which addresses Individual Environmental Assessments. The written request must be received by the Minister within the thirty (30) calendar day review period, with a copy to the Director, Environmental Approvals Branch and the City of Mississauga Project Manager.

Honorable Glen Murray  
 Minister of Environment and Climate Change  
 77 Wellesley Street West, 11th Floor  
 Toronto ON M7A 2T5

Director, Environmental Approvals Branch  
 Ministry of the Environment and Climate Change  
 135 St. Clair Avenue West, 1st Floor  
 Toronto ON M4V 1P5

City of Mississauga Project Manager  
 Dana Glofcheskie, P. Eng.  
 201 City Centre Drive, Suite 800  
 Mississauga ON L5B 2T4  
 Tel: 905.615.3200 ext. 8243  
[dana.glofcheskie@mississauga.ca](mailto:dana.glofcheskie@mississauga.ca)

*Personal information is collected under the authority of the Environmental Assessment Act and will be used in the assessment process. With exception of personal information, all comments shall become part of the public records. Questions about this collection should be directed to the Project Manager listed in the notice. This Notice first issued on June 1, 2017.*

# CITY OF MISSISSAUGA – NOTICE OF PUBLIC INFORMATION CENTRE

## Municipal Class Environmental Assessment Study for Sheridan Park Drive Extension

7.4-1

### WHAT?

- The City of Mississauga is undertaking a study for the proposed extension of Sheridan Park Drive between Homelands Drive and Speakman Drive.
- The site location and approximate extent of the Study Area are shown on the map.

### WHY?

- Complete the road network in the area to improve connectivity in Sheridan Park Corporate Centre (Sheridan Park) and surrounding areas for all users.
- Maximize access to the neighbourhood and business areas.
- Support multi-modal transportation in the study area.

### HOW?

- The study is being carried out in accordance with the requirements of a Schedule B undertaking as outlined in the Municipal Engineers Association *Municipal Class Environmental Assessment Manual* (October 2000, as amended in 2015), which is an approved process under the *Ontario Environmental Assessment Act*.
- The study will examine how traffic operates both now and in the future – and determine ways to address existing and future issues. It will also examine the impacts of extending Sheridan Park Drive on the social, cultural and natural environments and develop mitigation measures.
- Several alternatives have been developed and evaluated and are being refined through community and agency consultation. The Project Team will then select a preferred alternative.
- At the end of the study, a Project File documenting the entire study process will be available for public review.

### GET INVOLVED!

- Consultation is an important part of the Municipal Class EA process. Throughout the study, the City will make contact with various agencies and members of the community, and consider their opinions as part of any decisions that are made.
- A Public Information Centre (PIC) has been scheduled so that attendees can review study progress and discuss any questions or comments with the Project Team directly. At the PIC, the Project Team will present information on the study area as it is today, the alternative solutions evaluated, the preliminary preferred solution and some design concepts / options.

### **WE WANT TO HEAR FROM YOU – PLEASE ATTEND THE PUBLIC INFORMATION CENTRE!**

**6:00 – 8:00 pm**

**Tuesday June 27, 2017**

**Sheridan Park Alliance Church – 2440 Fifth Line West, Mississauga**

To find out more about project announcements and other information please visit the project website:

**[www.mississauga.ca/sheridanparkea](http://www.mississauga.ca/sheridanparkea)**

If you have any questions or comments regarding the study, please contact:

**[SheridanParKEA@rjburnside.com](mailto:SheridanParKEA@rjburnside.com)**

**Dana Glofcheskie, P.Eng.**  
Project Manager  
City of Mississauga  
201 City Centre Dr, Suite 800  
Mississauga, ON L5B 2T4  
(905) 615-3200 ext. 8243

**David Argue, P.Eng., PTOE**  
Consultant Project Manager  
R.J. Burnside & Associates Limited  
6990 Creditview Road, Unit 2  
Mississauga, ON L5N 8R9  
(905) 821-5895

Personal information is collected under the authority of the Environmental Assessment Act and will be used in the assessment process. With exception of personal information, all comments shall become part of the public records. Questions about this collection should be directed to the Project Manager listed in the notice.

This notice was first published June 15, 2017.

### WHERE?

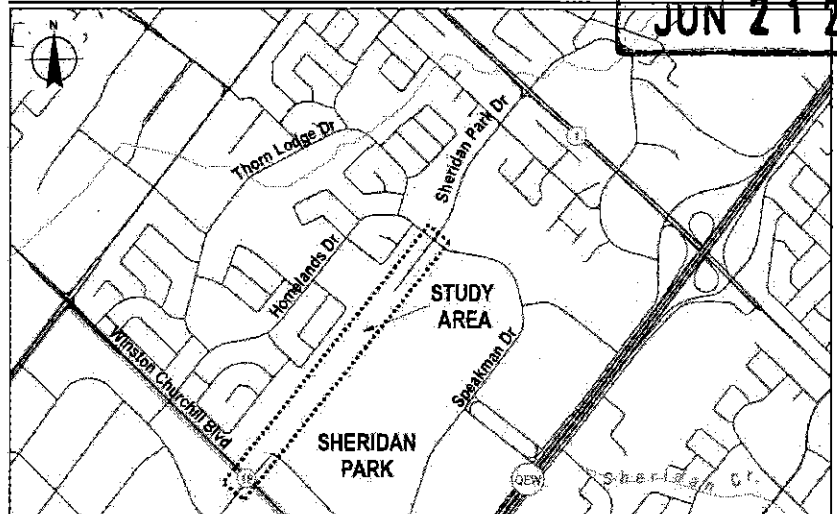

Traffic Safety Council

**JUN 21 2017**