

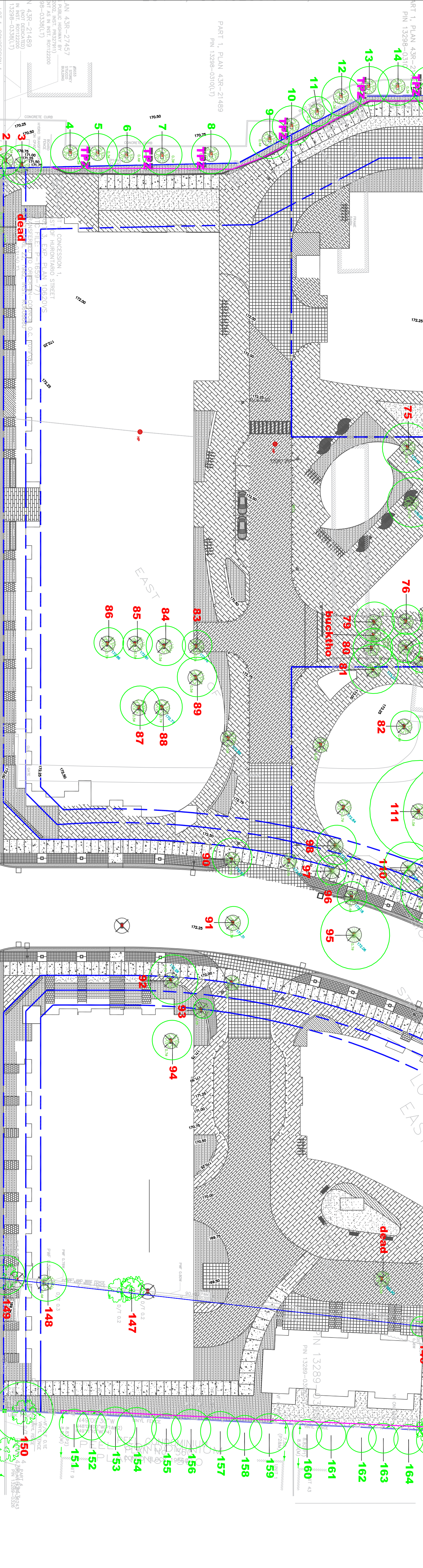

Tree Inventory
Refer to Table 1 of report dated 21 May 2019 for details of trees within the proposed development property within vicinity of the proposed development.

Tree Removal
The removal of 132 trees will be required to accommodate the proposed development.

Tree Preservation
The preservation of 52 trees will be possible with commencement of the demolition phase to ensure the retention of trees.

Encroachment within the driplines of some trees
Within the dripline of Trees 4-10, 12-15, 17, 19-24, the trees are in good health and are not damaged by construction. A tree protection plan will be required to ensure roots are not damaged by construction. A site-specific arboricultural practice.



 <p>KUNTZ FORESTRY CONSULTING INC.</p> <p>1111 Lakeshore Boulevard PO Box 1027, Lakeshore, WI PO 1-888-368-2211 e: info@kuntzforestry.ca www.kuntzforestry.ca</p>	
<p>Terraplan Landscape Architects 20 Champlain Boulevard, Suite 201 Toronto, ON M5H 2Z1</p>	
<p>Property: 91 and 131 Eglington Avenue East Mississauga, ON</p>	
<p>Tree Inventory & Preservation Plan</p>	
Project	P-1889
Date	21 May 2019
Scale	1:500
	Figure 1