

GENERAL NOTES

- VERIFY ALL DIMENSIONS.
- DO NOT SCALE DRAWINGS.
- REPORT ANY DISCREPANCIES, DISCOVERED ERRORS, OR OMISSIONS TO THE LANDSCAPE ARCHITECT BEFORE PROCEEDING.
- IT IS ADVISED THAT CONTRACTORS CONTACT THE LANDSCAPE ARCHITECT PRIOR TO CONSTRUCTION TO ENSURE THE USE OF THE LATEST REVISED DRAWINGS.
- DRAWINGS AND SPECIFICATIONS ARE THE PROPERTY OF THE LANDSCAPE ARCHITECT.

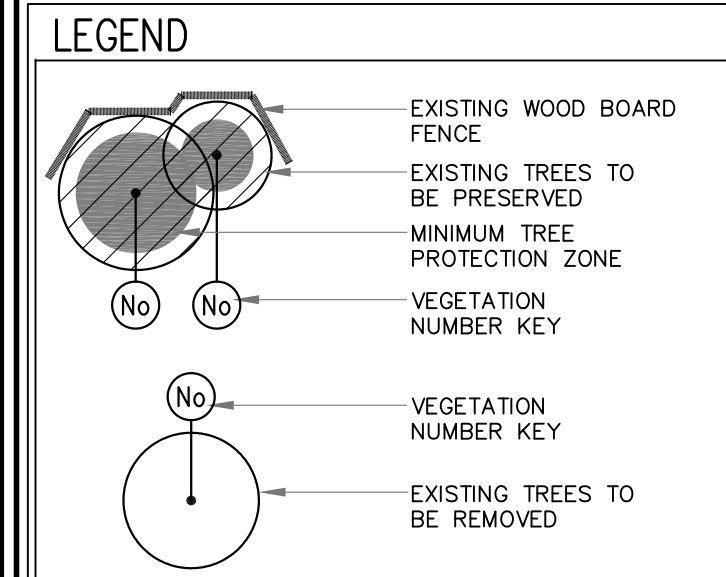

EXISTING TREE INVENTORY

KEY	SPECIES	CALIPER (in cm)	CROWN (in m)	HEALTH	STRUCTURE	COMMENTS	PRESERVATION DIRECTION	MIN. TPZ	KEY
1	NATURALIZED GROUPING	WHIP-65	VARIES	VARIES		MIXED, NATURALIZED GROUPING OF TREES AND SHRUBS WHICH OCCURS ALONG THE TOP OF EXISTING BANK AND ALONG CREEK SLOPE. THIS GROUPING IS DOMINATED BY DECLINING ASH TREES AND SEVERAL MANTOBA MAPLES. A SMALLER NUMBER OF CRACK WILLOW MOSTLY ALONG THE EAST CREEK BANK ARE PRESENT. THE MAJORITY OF THE TREES EXHIBIT MULTIPLE STEMS AND ONE SIDED FORMS DUE TO CROWDING. OVERALL, THE VEGETATION ALONG THE WEST SIDE OF THE CREEK IS COMPOSED EITHER OF EXOTIC, INVASIVE SPECIES OR DEAD OR DECLINING ASH TREES. THIS GROUPING IS IN GENERALLY POOR CONDITION. THE EXISTING TOP OF BANK APPEARS TO BE FILL MATERIAL AND DEBRIS.	(SELECTIVE REMOVALS OF THE IMMATURE, NATURALIZED AND INVASIVE TREES ALONG THE STACKED TOP OF BANK MAY BE REQUIRED DUE TO THE PROPOSED GRADING TO RE-ESTABLISH THE TOP OF BANK)	NA	1
2	CRACK WILLOW	65.0	15.0	FAIR	MULTI-STEMMED	MATURE, MULTI-STEMMED TREE LOCATED ALONG THE EXISTING CREEK BANK. SOME DIEBACK THROUGHOUT IS NOTED AS WELL AS SEVERAL POTENTIALLY WEEK BRANCH UNIONS	PRESERVE	4.2	2
3	SIBERIAN ELM	15.30	9.0	POOR-FAIR	MULTI-STEMMED	ASYMMETRICAL FORM, CROWDED BY ADJACENT TREE. DIEBACK THROUGHOUT, INCLUDED BANK	REMOVE	2.4	3
4	MANTOBA MAPLE	16.0	6.0	FAIR	HORIZONTAL	LEANING, CROWDED BY ADJACENT TREE	REMOVE	1.8	4
5	SIBERIAN ELM	17.0	6.0	GOOD	MULTI-STEMMED	NARROW FORM, CROWDED BY ADJACENT TREE	PRESERVE	1.8	5
6	SIBERIAN ELM	18.0	6.0	GOOD	MULTI-STEMMED	FENCE INGROWN, DIEBACK ON LOWER BRANCHES	REMOVE	1.8	6
7	SIBERIAN ELM	25.0	6.0	GOOD	DOUBLE STEM	DAMAGE TO LOWER BRANCHES	REMOVE	1.8	7
8	SIBERIAN ELM	18.0	5.0	POOR	IRREGULAR FORM	FENCE INGROWN, DIEBACK THROUGHOUT	REMOVE	1.8	8
9	ASH	6.0	6.0	DEAD			REMOVE	NA	9
10	MANTOBA MAPLE	29.0	6.0	POOR-FAIR	ASYMMETRICAL FORM	CROWDED BY ADJACENT TREE; SOME DIEBACK THROUGHOUT	REMOVE	1.8	10
11	NORWAY MAPLE	32.0	6.0	FAIR	ASYMMETRICAL FORM	CROWDED BY ADJACENT TREE; SOME INTERNAL DIEBACK	REMOVE	2.4	11
12	NORWAY MAPLE	24.0	7.0	GOOD	GOOD FORM	MINOR INTERNAL DIEBACK	REMOVE	1.8	12
13	ASH	40.0	6.0	DEAD			REMOVE	2.4	13
14	MANTOBA MAPLE	60.0	18.0	DEAD			REMOVE	3.6	14

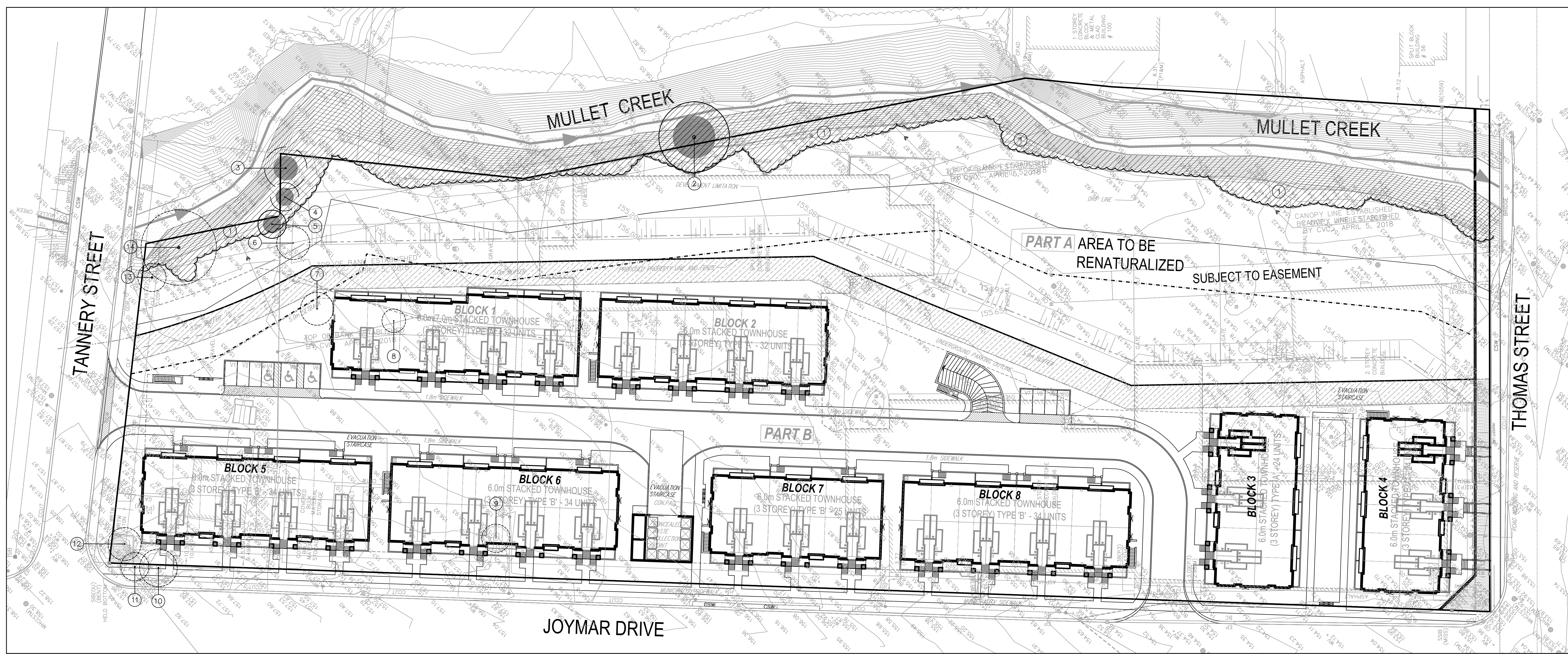
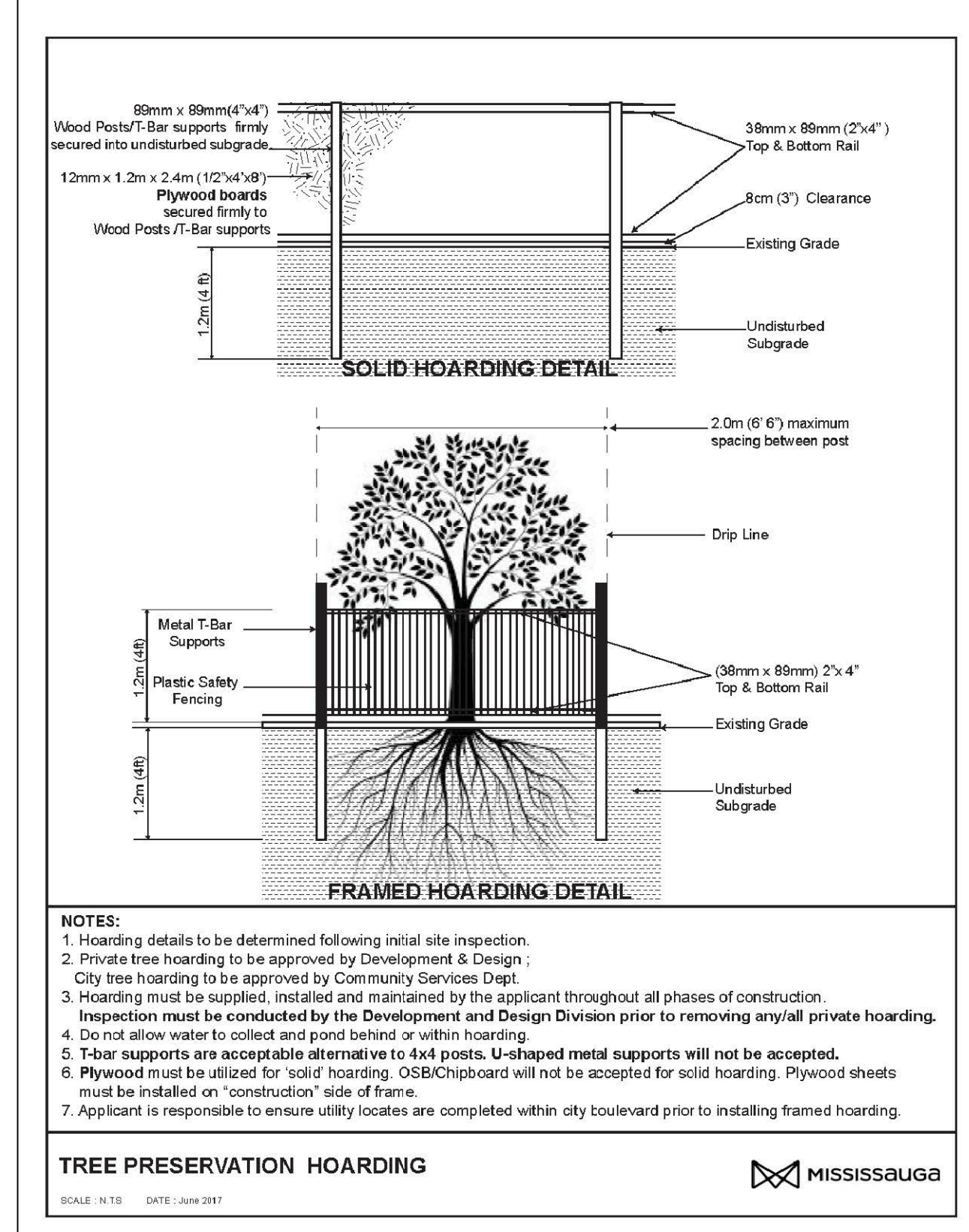

Watt O'Leary
MATTHEW C. GEHRES
 International Society of Arboriculture
 Certified Arborist #ON-11144
 Date: date

ISA

It is the responsibility of the Contractor and/or Owner to ensure that the drawings with the latest revisions are used for construction.

SBK 5770 HURONTARIO STREET, SUITE 320
 MISSISSAUGA, ONTARIO, L5R 3G5
 T: 416.695.4949 F: 905.712.3101
 WWW.STRYBOS.COM

STRYBOS BARRON KING
 LANDSCAPE ARCHITECTURE

PROJECT: **PROPOSED STACKED TOWNHOUSE DEVELOPMENT**
 65-95 JOYMAR DRIVE
 MISSISSAUGA, ONTARIO

DRAWING TITLE: **EXISTING TREE INVENTORY AND PRESERVATION PLAN**

SCALE: AS SHOWN PROJECT No. 19-5173
 DATE: MAY 2019
 DRAWN BY: SS DRAWING No. V100
 CHECKED BY: MG