

LEGEND		LEGEND	
	EXISTING TO REMAIN		ASPHALT PAVEMENT AREA
	EXISTING WALL		PA - CONCRETE AREA (W/ LANDSCAPED CONCRETE PAVEMENT AREA)
	PROPOSED WALL		GRAVEL AREA
	SIDE WALK		DEMOLITION WORK
	PAINTED RUMBLE STRIP		SOFT LANDSCAPE AREA
	BUILDING ENTRANCE		FIRE ROUTE
	STOP SIGN		

TOTAL CURB LENGTH = 0'-0" L.F.T.

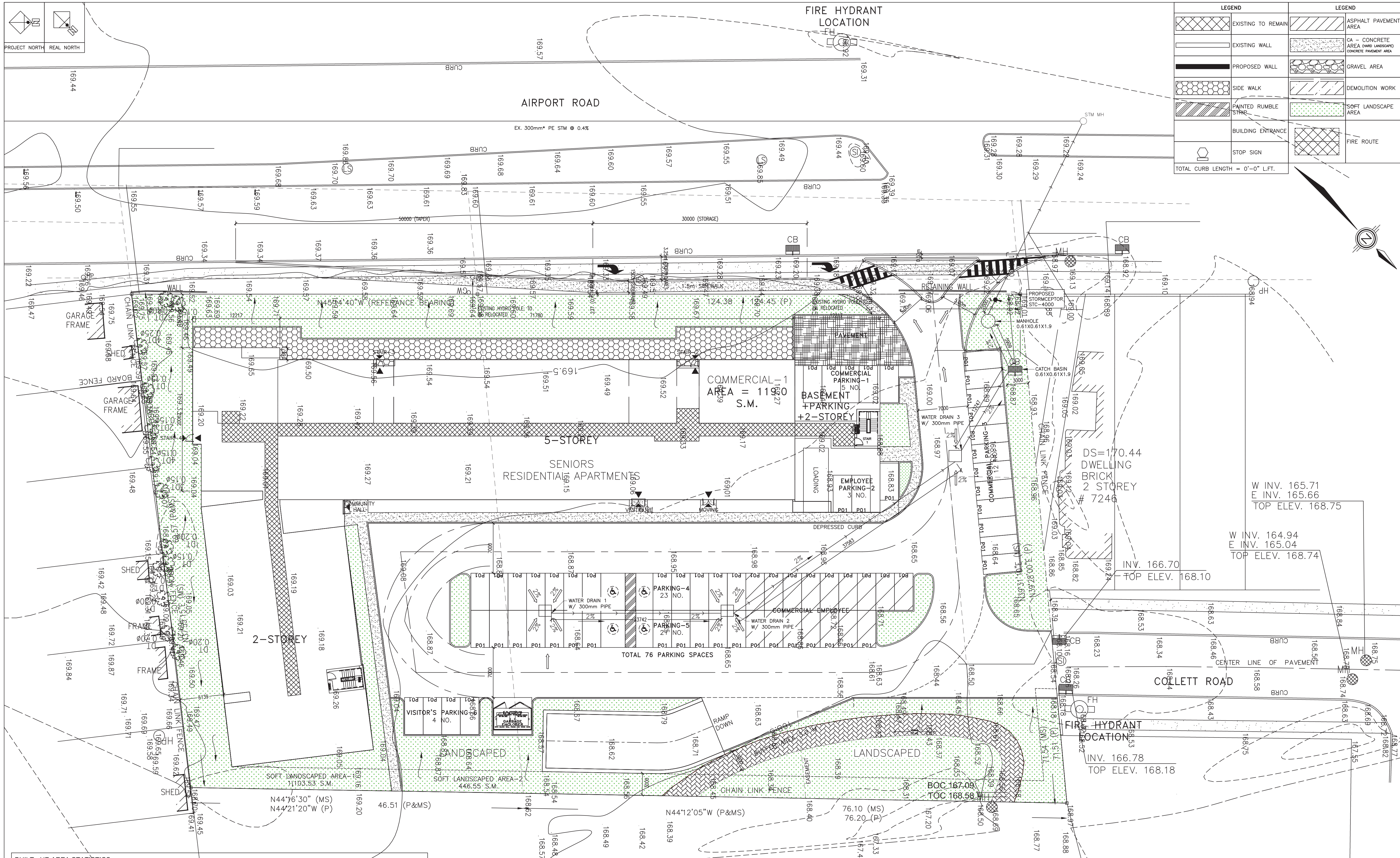

NO.	ISSUED FOR	NO.
17.		
16.		
15.	TO PLANNER - PROGRESS DWG. FOR COORDINATION	NOV. 17/2016
14.	OWNER/PLANNER REVIEW - SITE PLAN REVISED	NOV. 09/2016
14.	OWNER'S REVIEW - REVISED AS PLANNER'S COMMENTS	SEP. 27/2016
13.	OWNER'S REVIEW - PARKING REVISED - FLOOD LINE ADDED	SEP. 12/2016

**PROJECT**  
**PROPOSED SENIOR CONDO BUILDING**  
 7211 & 7233 AIRPORT ROAD  
 PARTS # 1, 2 & 3  
 MISSISSAUGA, ONTARIO

**DRAWING TITLE**  
**- SITE PLAN**  
**- PARKING OPTION-3**

**NOTE:**  
 - DO NOT SCALE DRAWINGS.  
 - ALL DIMENSIONS TO BE CHECKED AND VERIFIED ON THE JOB SITE.  
 - ANY AND ALL DISCREPANCIES TO BE REPORTED TO THE ARCHITECT.  
 - ALL DRAWINGS REMAIN THE PROPERTY OF THE ARCHITECT.

	A. DETAIL NO.
	B. LOCATION SHEET
	C. DETAILED ON

PROJECT NO. 1625	DRAWN BY A.V.
DATE JUNE 2016	CHECKED BY C.V.

**DRAWING NO.**  
**SP-100A**

BUILT - UP AREA STATISTICS						
	AREA - sq.mt.	EXISTING AREA - sq.mt.	DEMOLISH AREA - sq.mt.	TOTAL EXISTING TO REMAIN AREA - sq.ft.	PROPOSED AREA - sq.mt.	TOTAL AREA - sq.mt.
SITE AREA	8,656.00	-	-	-	-	2,625.90
BASEMENT AREA - TOTAL					5700.45	
BASEMENT PARKING BELOW GRADE					5700.45	
FIRST FLOOR AREA					2,625.90	2594.57
SECOND FLOOR AREA					2,609.12	2609.12
THIRD FLOOR AREA					1,407.50	1,407.50
FOURTH FLOOR AREA					1,407.50	1,407.50
FIFTH FLOOR AREA					1,407.50	1,407.50
TOTAL BUILDING AREA					12020.76	12020.76
TOTAL LOT COVERAGE					00.00	00.00
ASPHALT PAVEMENT AREA					00.00	00.00
LANDSCAPE AREA STATISTICS					00.00	00.00
SOFT LANDSCAPE AREA					00.00	00.00
HARD LANDSCAPE CONCRETE AREA					00.00	00.00
GRAVELED AREA					00.00	00.00
TOTAL LANDSCAPE AREA					3,052.29	00.00
EXISTING LANDSCAPE AREA = 14,256 %						