

TREE INVENTORY OBTAINED
JULY 23, 2015

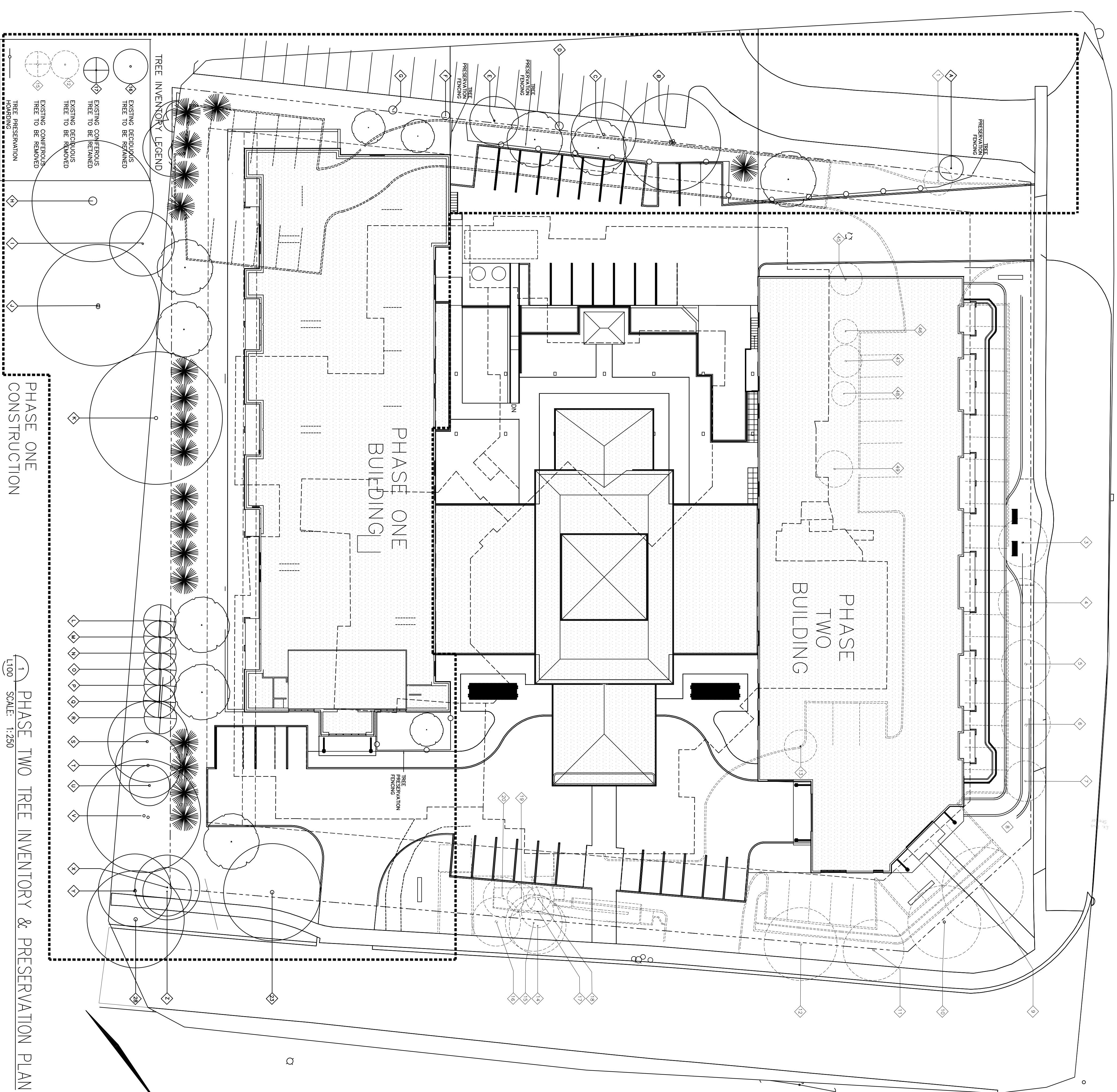

NO.	BOTANICAL NAME	COMMON NAME	DBH (CM)	CANOPY (M)	CONDITION	CONSTRUCTION STATUS	PHASE OUTCOME
1	Acer platanoides 'Columnar'	COLUMNAR NORWAY MAPLE	20	4.5	FAIR	CURB REMOVAL	TWO REMOVE
2	Prunus	CHERRY	2 X 10, 12	6	FAIR - 20% DEAD WEST SIDE	WALL	TWO REMOVE
3	Aesculus hippocastanum	HORSE CHESTNUT	28	6	FAIR - BROWN LEAF CURL	WALL	TWO REMOVE
4	Aesculus hippocastanum	HORSE CHESTNUT	28	6	POOR - BROWN LEAF CURL	WALL	TWO REMOVE
5	Aesculus hippocastanum	HORSE CHESTNUT	28	6	FAIR - BROWN LEAF CURL	WALL	TWO REMOVE
6	Aesculus hippocastanum	HORSE CHESTNUT	28	6	FAIR - BROWN LEAF CURL	WALL	TWO REMOVE
7	Aesculus hippocastanum	HORSE CHESTNUT	30	6	FAIR - BROWN LEAF CURL	WALL	TWO REMOVE
8	Aesculus hippocastanum	HORSE CHESTNUT	30	6	FAIR - BROWN LEAF CURL	WALL	TWO REMOVE
9	Gleditsia triacanthos 'Inermis Shademaster'	SHADEMASTER HORNETLOCUST	39	10	GOOD	REMOVING WALL	TWO REMOVE
10	Gleditsia triacanthos 'Inermis Shademaster'	SHADEMASTER HORNETLOCUST	28	9	GOOD - 5% SHADOWN CANOPY	REMOVING WALL	TWO REMOVE
11	Gleditsia triacanthos 'Inermis Shademaster'	SHADEMASTER HORNETLOCUST	24	7.5	GOOD	REMOVING WALL	TWO REMOVE
12	Gleditsia triacanthos 'Inermis Shademaster'	SHADEMASTER HORNETLOCUST	30	9	GOOD	REMOVING WALL	TWO REMOVE
13	Gleditsia triacanthos 'Inermis Shademaster'	SHADEMASTER HORNETLOCUST	14	4	GOOD	NEW BUILDING	TWO REMOVE
14	Rubina pseudoacacia	BLACK LOCUST	12	7	FAIR - LEANING SOUTH	REMOVING WALL	TWO REMOVE
15	Rubina pseudoacacia	BLACK LOCUST	15	3	FAIR - SHADDED BY MAPLE	REMOVING WALL	TWO REMOVE
16	Inermis 'Shademaster'	SHADEMASTER HORNETLOCUST	30	6	FAIR - SOME DEAD NORTH SIDE	REMOVING WALL	TWO REMOVE
17	Acer platanoides	NORWAY MAPLE	2 X 12, 13	4	FAIR - FLAT SOUTH SIDE, SEAS-SEEDS	REMOVING WALL	TWO REMOVE
18	Acer platanoides	NORWAY MAPLE	11	3	FAIR - FLAT WEST SIDE, 15% DEAD	REMOVING WALL	TWO REMOVE
19	Rubina pseudoacacia	BLACK LOCUST	5	3.5	FAIR - LEANING WEST	REMOVING WALL	TWO REMOVE
20	Acer platanoides	NORWAY MAPLE	2 X 8, 9	5	POOR	REMOVING WALL	TWO REMOVE
21	Acer platanoides	NORWAY MAPLE	35	9	POOR - EAST SIDE TRUNK	DRIVEWAY, NEW SIGN	ONE REMOVE
22	Acer platanoides	NORWAY MAPLE	35	12	GOOD	REMOVING WALL	ONE REMOVE
23	Acer platanoides	NORWAY MAPLE	45	12	GOOD	NEW DRIVEWAY	ONE REMOVE
24	Rubina pseudoacacia	BLACK LOCUST	15	5	POOR	POOR	ONE REMOVE
25	Acer platanoides	NORWAY MAPLE	2 X 7, 8	4	POOR	POOR	ONE REMOVE
26	Rubina pseudoacacia	BLACK LOCUST	7	2	POOR - MAINLY DEAD	MAINLY DEAD	ONE REMOVE
27	Thuja occidentalis	WHITE CEDAR	9	2	POOR	POOR	ONE REMOVE
28	Inermis 'Shademaster'	SHADEMASTER HORNETLOCUST	43	12	GOOD - STREET TREE	STREET TREE	RETAIN
29	Pinus nigra	AUSTRIAN PINE	35	5	FAIR - FLAT WEST SIDE, DEAD LOWER	NEW BUILDING	ONE REMOVE
30	Pinus nigra	AUSTRIAN PINE	26	4	FAIR - FLAT WEST SIDE, DEAD LOWER	NEW BUILDING	ONE REMOVE
31	Pinus nigra	AUSTRIAN PINE	8	2	FAIR	NEW BUILDING	ONE REMOVE
32	Rubina pseudoacacia	BLACK LOCUST	32	8	POOR	NEW BUILDING	ONE REMOVE
33	Fraxinus	ASH	28	8	POOR	NEW BUILDING	ONE REMOVE
34	Fraxinus	ASH	16	4	POOR	NEW BUILDING	ONE REMOVE
35	Prunus	CHERRY?	24	10	POOR	GALL ON TRUNK	ONE REMOVE
36	Fraxinus	ASH	32	9	FAIR	85% DEAD	ONE REMOVE
37	Fraxinus	ASH	13	5	FAIR	15% DEAD	ONE REMOVE
38	Tilia americana	BASSWOOD	32	7	POOR - 70% DEAD	DEMOLISH PARKING	ONE REMOVE
39	Fraxinus	ASH	3 X 8, 9, 14	8	FAIR	DEMOLISH PARKING	ONE REMOVE
40	Acer negundo	MANITOWA MAPLE	3 X 8, 9, 14	8	FAIR	DEMOLISH PARKING	ONE REMOVE
41	Pinus nigra	AUSTRIAN PINE	35	5	FAIR - FLAT WEST SIDE, DEAD LOWER	NEW BUILDING	ONE REMOVE
42	Picea pungens	BLUE COLORADO SPRUCE	26	4	FAIR - LOTS OF SAP LEAKING OUT	NEW BUILDING	ONE REMOVE
43	Picea pungens 'Glaucol'	BLUE COLORADO SPRUCE	20	3	GOOD	NEW BUILDING	ONE REMOVE
44	Picea pungens 'Glaucol'	BLUE COLORADO SPRUCE	30	5	GOOD	NEW BUILDING & WALKWAY	ONE REMOVE
45	Amelanchier	SERVICEBERRY	16	4	FAIR - LEANING SOUTH	NEW BUILDING	TWO REMOVE
46	Amelanchier	SERVICEBERRY	13	3	FAIR - LEANING EAST	NEW BUILDING	TWO REMOVE
47	Amelanchier	SERVICEBERRY	19	4	GOOD	NEW BUILDING	TWO REMOVE
48	Amelanchier	SERVICEBERRY	10	3	FAIR - LEANING WEST	NEW BUILDING	TWO REMOVE
49	Amelanchier 'Columnar'	SERVICEBERRY COLUMNAR	20	4.5	FAIR - PRUNE SLICERS FROM TRUNK	NEW BUILDING	TWO REMOVE
A	Acer platanoides 'Columnar'	NORWAY MAPLE	15	3	GOOD - NEIGHBOURS	NEIGHBOUR'S TREE	RETAIN
B	Maorus alba	MALBERRY	6 X 20, 30	12	GOOD - NEIGHBOURS	CURB REMOVAL	ONE REMOVE
C	Fraxinus	ASH	30	8	DEAD - NEIGHBOURS	CURB REMOVAL	ONE REMOVE
D	Acer platanoides 'Crimson King'	MAPLE	2	1	GOOD - NEIGHBOURS	RETAIN	RETAIN
E	Maorus alba	MALBERRY	4 X 9	6	GOOD - NEIGHBOURS	RETAIN	RETAIN
F	Acer saccharum	SUGAR MAPLE	2	1	GOOD - NEIGHBOURS	CURB REMOVAL	ONE REMOVE
G	Gleditsia triacanthos 'Inermis Shademaster'	SHADEMASTER HORNETLOCUST	2	1	GOOD - NEIGHBOURS	RETAIN	RETAIN
H	Acer saccharum	SILVER MAPLE	100	15	GOOD - NEIGHBOURS	RETAIN	RETAIN
I	Prunus serotina	BLACK CHERRY	20	8	GOOD - NEIGHBOURS	RETAIN	RETAIN
J	Acer saccharum	SILVER MAPLE	2 X 40, 45	15	GOOD - NEIGHBOURS	RETAIN	RETAIN
K	Acer platanoides	NORWAY MAPLE	40	16	GOOD - NEIGHBOURS	RETAIN	RETAIN
L	Picea glauca	WHITE SPRUCE	20	4	GOOD - NEIGHBOURS	RETAIN	RETAIN
M	Picea glauca	WHITE SPRUCE	20	4	GOOD - NEIGHBOURS	RETAIN	RETAIN
N	Picea glauca	WHITE SPRUCE	20	4	GOOD - NEIGHBOURS	RETAIN	RETAIN
O	Picea glauca	NORWAY SPRUCE	30	4	GOOD - NEIGHBOURS	RETAIN	RETAIN
P	Picea glauca	WHITE SPRUCE	22	4	DEAD - NEIGHBOURS	RETAIN	RETAIN
Q	Picea glauca	WHITE SPRUCE	22	4	GOOD - NEIGHBOURS	RETAIN	RETAIN
R	Picea alba	NORWAY SPRUCE	28	4	GOOD - NEIGHBOURS	RETAIN	RETAIN
S	Rubina pseudoacacia	BLACK LOCUST	28	10	GOOD - NEIGHBOURS	RETAIN	RETAIN
T	Rubina pseudoacacia	BLACK LOCUST	30	8	GOOD - NEIGHBOURS	RETAIN	RETAIN
U	Rubina pseudoacacia	BLACK LOCUST	25	5	GOOD - NEIGHBOURS	RETAIN	RETAIN
V	Rubina pseudoacacia	BLACK LOCUST	2 X 30	14	GOOD - NEIGHBOURS	RETAIN	RETAIN
X	Acer platanoides	NORWAY MAPLE	15	8	FAIR - NEIGHBOURS	RETAIN	RETAIN
Y	Acer saccharum	SILVER MAPLE	3 X 18, 20, 25	9	GOOD - CITY	RETAIN	RETAIN
Z	Acer platanoides	NORWAY MAPLE	10	6	FAIR - NEIGHBOURS	RETAIN	RETAIN

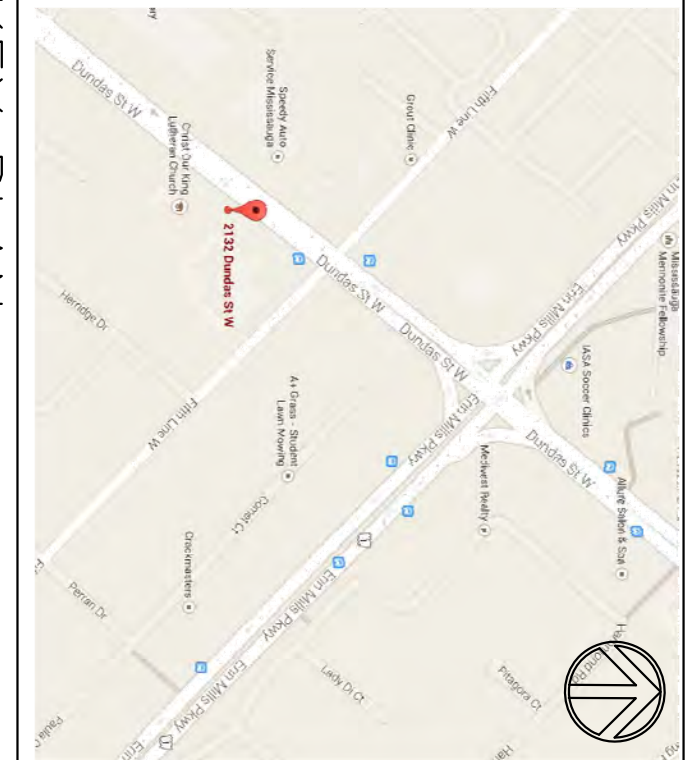

EXISTING TREE PRESERVATION
THE APPLICANT IS RESPONSIBLE FOR ENSURING THAT TREE PROTECTION HOARDING IS MAINTAINED THROUGHOUT ALL PHASES OF DEMOLITION AND CONSTRUCTION IN THE TRAIL FORESTRY SECTION. NO MATERIALS (BUILDING MATERIALS, SOIL, ETC.) MAY BE STOCKPILED WITHIN THE AREA OF PROTECTION. FAILURE TO MAINTAIN THE HOARDING AS WITHIN THE HOARDING WILL BE CAUSE FOR THE TREE PRESERVATION LETTER OF CREDIT TO BE HELD FOR TWO (2) YEARS. THE INSTALLATION OF BELOW GROUND SERVICES REQUIRE HOARDING TO BE REMOVED. FORESTRY STAFF ARE RESPONSIBLE FOR THE INSTALLATION OF BELOW GROUND SERVICES. SHOULD AN ALTERNATE SERVICE ROUTE NOT BE POSSIBLE, STAFF WILL UNSEAL AND DOCUMENT THE ALLOCATION IN ORDER TO MINIMIZE DAMAGE TO THE VEGETATION. OWNER'S SIGNATURE:

3 09 JAN 17 SUBMIT FOR OPA & ZBA APPLICATION
2 23 DEC 16 SUBMIT FOR SITE PLAN APPROVAL
1 07 OCT 16 SUBMIT TO COMMITTEE OF ADJUSTMENT

Revisions:
No. Date Description

CATHERINE H. KIRK
Landscape Architect
237 Dundas St. S., Cambridge, Ont. M5R 5S2
TEL: (919) 623-9274 Fax: (519) 623-1632

SIFTON PROPERTIES
LIMITED
THE ERINVIEW
2132 DUNDAS STREET WEST
MISSISSAUGA, ONTARIO

PHASE TWO TREE
INVENTORY &
PRESERVATION PLAN

Scale: 1:250
Date: 07 MAR 2016
Drawing Number: L100