

THE CORPORATION OF THE CITY OF MISSISSAUGA

BY-LAW NUMBER 0168-2018

A by-law to amend By-law Number 0225-2007, as amended.

WHEREAS pursuant to section 34 of the *Planning Act*, R.S.O. 1990, c.P.13, as amended, the council of a local municipality may pass a zoning by-law;

AND WHEREAS by Order dated December 17, 2009 made under *The Municipal Act, 2001*, S.O. 2001, c. 25, the Minister of Municipal Affairs and Housing prescribed that on January 1, 2010, among other things, by-laws passed by The Corporation of the Town of Milton under section 34 of the *Planning Act* shall remain in force until amended or repealed by the Council of The Corporation of the City of Mississauga;

NOW THEREFORE the Council of The Corporation of the City of Mississauga ENACTS as follows:

1. By-law Number 114-2003, being a Town of Milton Comprehensive Zoning By-law, as it applies to the lands identified on Schedules A1 to A8, is hereby repealed.
2. Map Number 55 of Schedule "B" to By-law Number 0225-2007, as amended, being a City of Mississauga Zoning By-law, is amended by changing thereon from the Town of Milton Zoning By-law 144-2003 zones "A1" and "GA" to "OS1", "G1", "PB1" and "D", the zoning of Parts of Lots 13 and 14, Concession 9, New Survey, in the City of Mississauga, PROVIDED HOWEVER THAT the "OS1", "G1", "PB1" and "D" zoning shall only apply to the lands which are shown on the attached Schedule "A1", which is deemed to be an integral part of this By-law, outlined in the heaviest broken line with the "OS1", "G1", "PB1" and "D" zoning indicated thereon.
3. Map Number 55 of Schedule "B" to By-law Number 0225-2007, as amended, is further amended by changing thereon from the Town of Milton Zoning By-law 144-2003 zones "A1" and "GA" to "G1", "PB1" and "D", the zoning of Parts of Lots 11 and 12, Concession 9, New Survey, in the City of Mississauga, PROVIDED HOWEVER THAT the "G1", "PB1" and "D" zoning shall only apply to the lands which are shown on the attached Schedule "A2", which is deemed to be an integral part of this By-law, outlined in the heaviest broken line with the "G1", "PB1" and "D" zoning indicated thereon.

4. Map Number 56 of Schedule "B" to By-law Number 0225-2007, as amended, being a City of Mississauga Zoning By-law, is amended by changing thereon from the Town of Milton Zoning By-law 144-2003 zones "A1" and "GA" to "G2", "PB1" and "D", the zoning of Parts of Lots 9 and 10, Concession 9, New Survey, in the City of Mississauga, PROVIDED HOWEVER THAT the "G2", "PB1" and "D" zoning shall only apply to the lands which are shown on the attached Schedule "A3", which is deemed to be an integral part of this By-law, outlined in the heaviest broken line with the "G2", "PB1" and "D" zoning indicated thereon.
  
5. Map Number 56 of Schedule "B" to By-law Number 0225-2007, as amended, is further amended by changing thereon from the Town of Milton Zoning By-law 144-2003 zones "A1" and "GA" to "G1", "PB1" and "D", the zoning of Parts of Lots 7, 8 and 9, Concession 9, New Survey, in the City of Mississauga, PROVIDED HOWEVER THAT the "G1", "PB1" and "D" zoning shall only apply to the lands which are shown on the attached Schedule "A4", which is deemed to be an integral part of this By-law, outlined in the heaviest broken line with the "G1", "PB1" and "D" zoning indicated thereon.
  
6. Map Numbers 56 and 57 of Schedule "B" to By-law Number 0225-2007, as amended, being a City of Mississauga Zoning By-law, is amended by changing thereon from the Town of Milton Zoning By-law 144-2003 zones "A1" and "GA" to "G1", "PB1" and "D", the zoning of Parts of Lots 5, 6 and 7, Concession 9, New Survey, in the City of Mississauga, PROVIDED HOWEVER THAT the "G1", "PB1" and "D" zoning shall only apply to the lands which are shown on the attached Schedule "A5", which is deemed to be an integral part of this By-law, outlined in the heaviest broken line with the "G1", "PB1" and "D" zoning indicated thereon.
  
7. Map Number 57 of Schedule "B" to By-law Number 0225-2007, as amended, is further amended by changing thereon from the Town of Milton Zoning By-law 144-2003 zones "A1" and "GA" to "G1", "PB1" and "D", the zoning of Parts of Lots 3, 4 and 5, Concession 9, New Survey, in the City of Mississauga, PROVIDED HOWEVER THAT the "G1", "PB1" and "D" zoning shall only apply to the lands which are shown on the attached Schedule "A6", which is deemed to be an integral part of this By-law, outlined in the heaviest broken line with the "G1", "PB1" and "D" zoning indicated thereon.

8. Map Numbers 57 of Schedule "B" to By-law Number 0225-2007, as amended, is further amended by changing thereon from the Town of Milton Zoning By-law 144-2003 zones "A1" and "GA" to "OS1", "G1", "G2", "PB1" and "D", the zoning of Parts of Lots 2 and 3, Concession 9, New Survey, in the City of Mississauga, PROVIDED HOWEVER THAT the "OS1", "G1", "G2", "PB1" and "D" zoning shall only apply to the lands which are shown on the attached Schedule "A7", which is deemed to be an integral part of this By-law, outlined in the heaviest broken line with the "OS1", "G1", "G2", "PB1" and "D" zoning indicated thereon.
  
9. Map Numbers 57 and 58 of Schedule "B" to By-law Number 0225-2007, as amended, being a City of Mississauga Zoning By-law, is amended by changing thereon from the Town of Milton Zoning By-law 144-2003 zone "A1" to "G2", "PB1" and "D", the zoning of Parts of Lot 1, Concession 9, New Survey, and Part of Lot 6, Concession 2, North of Dundas Street, in the City of Mississauga, PROVIDED HOWEVER THAT the "G2", "PB1" and "D" zoning shall only apply to the lands which are shown on the attached Schedule "A8", which is deemed to be an integral part of this By-law, outlined in the heaviest broken line with the "G2", "PB1" and "D" zoning indicated thereon.
  
10. This By-law shall not come into force until Mississauga Official Plan Amendment Number 90 is in full force and effect.

ENACTED and PASSED this 4<sup>th</sup> day of July 2018.

APPROVED AS TO FORM City Solicitor MISSISSAUGA			
MEM			
Date	2018	06	22

*Bonnie Crombie*

MAYOR

*W. J. [Signature]*

CLERK

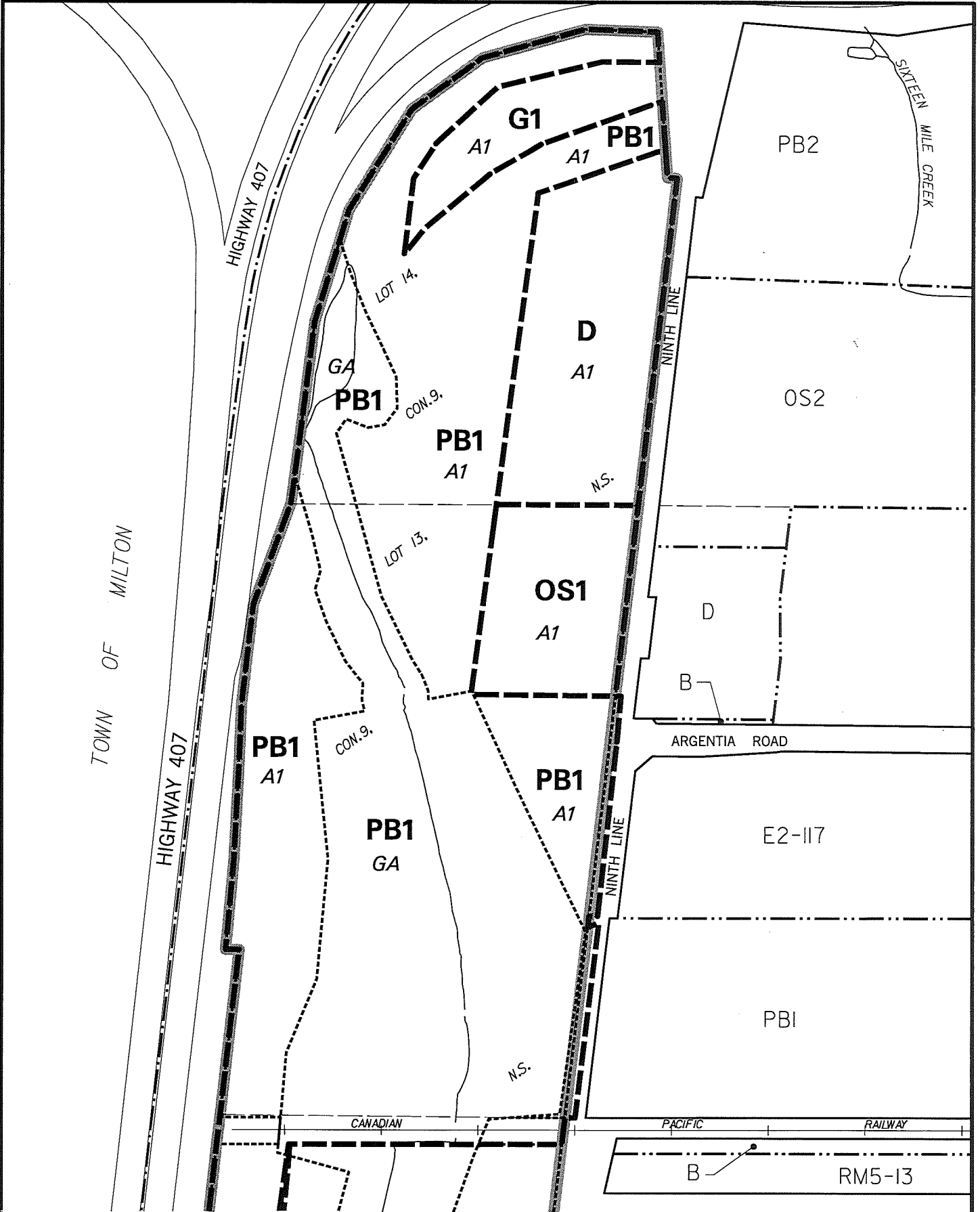

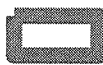
 Area annexed from the Town of Milton as defined in Schedule A of Annexation Order dated December 17, 2009, Minister of Municipal Affairs and Housing

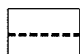
 Zone lines from Town of Milton Zoning By-Law 144-2003

This is not a Plan of Survey.

**CITY OF MISSISSAUGA**

**THIS IS SCHEDULE "A1" TO**

**BY-LAW** 0168-2018

**PASSED BY COUNCIL ON**

July 4, 2018

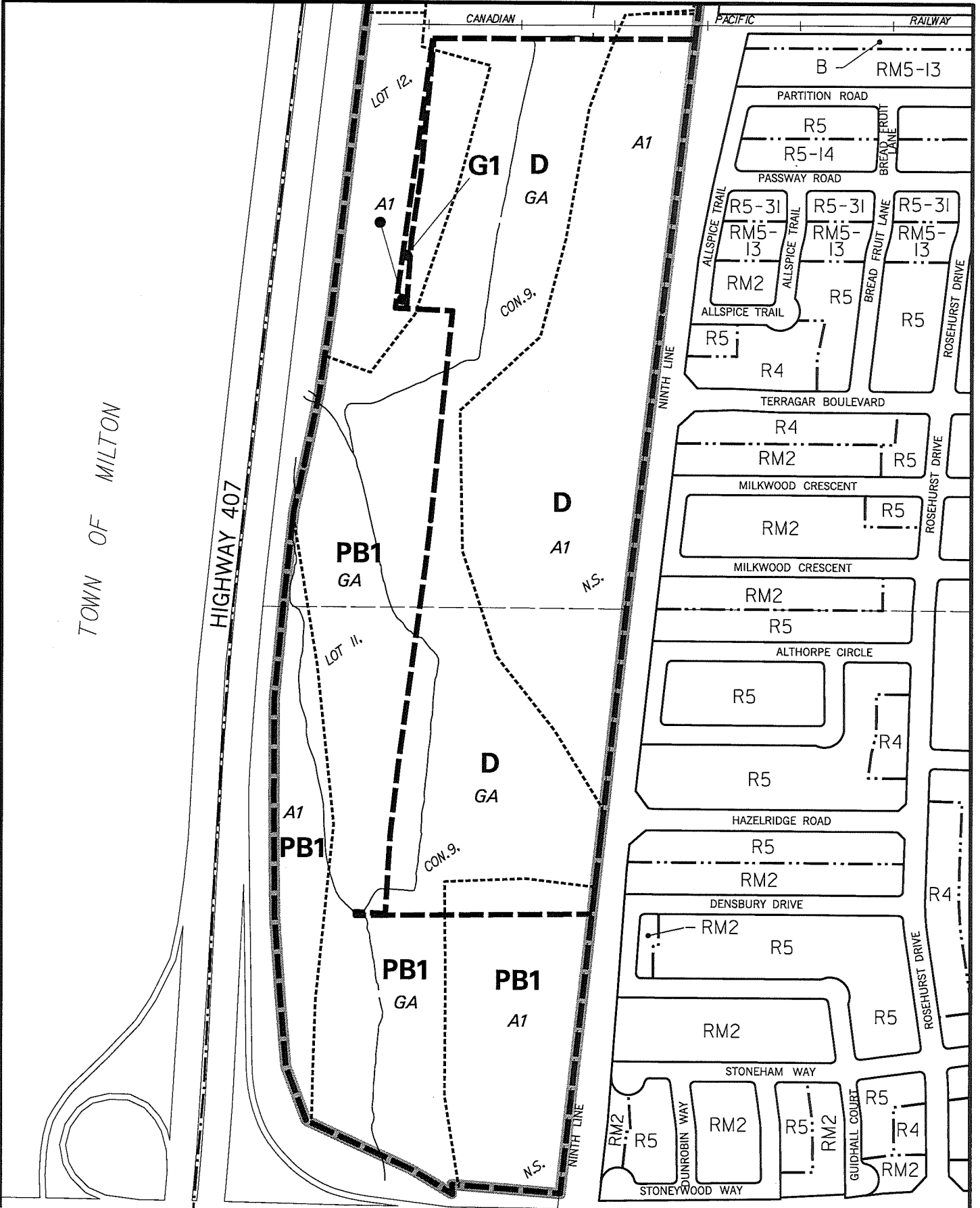

Area annexed from the Town of Milton as defined in Schedule A of Annexation Order dated December 17, 2009, Minister of Municipal Affairs and Housing



Zone lines from Town of Milton Zoning By-Law 144-2003

This is not a Plan of Survey.

**CITY OF MISSISSAUGA**

**THIS IS SCHEDULE "A2" TO**

**BY-LAW** 0168-2018

**PASSED BY COUNCIL ON**

July 4, 2018

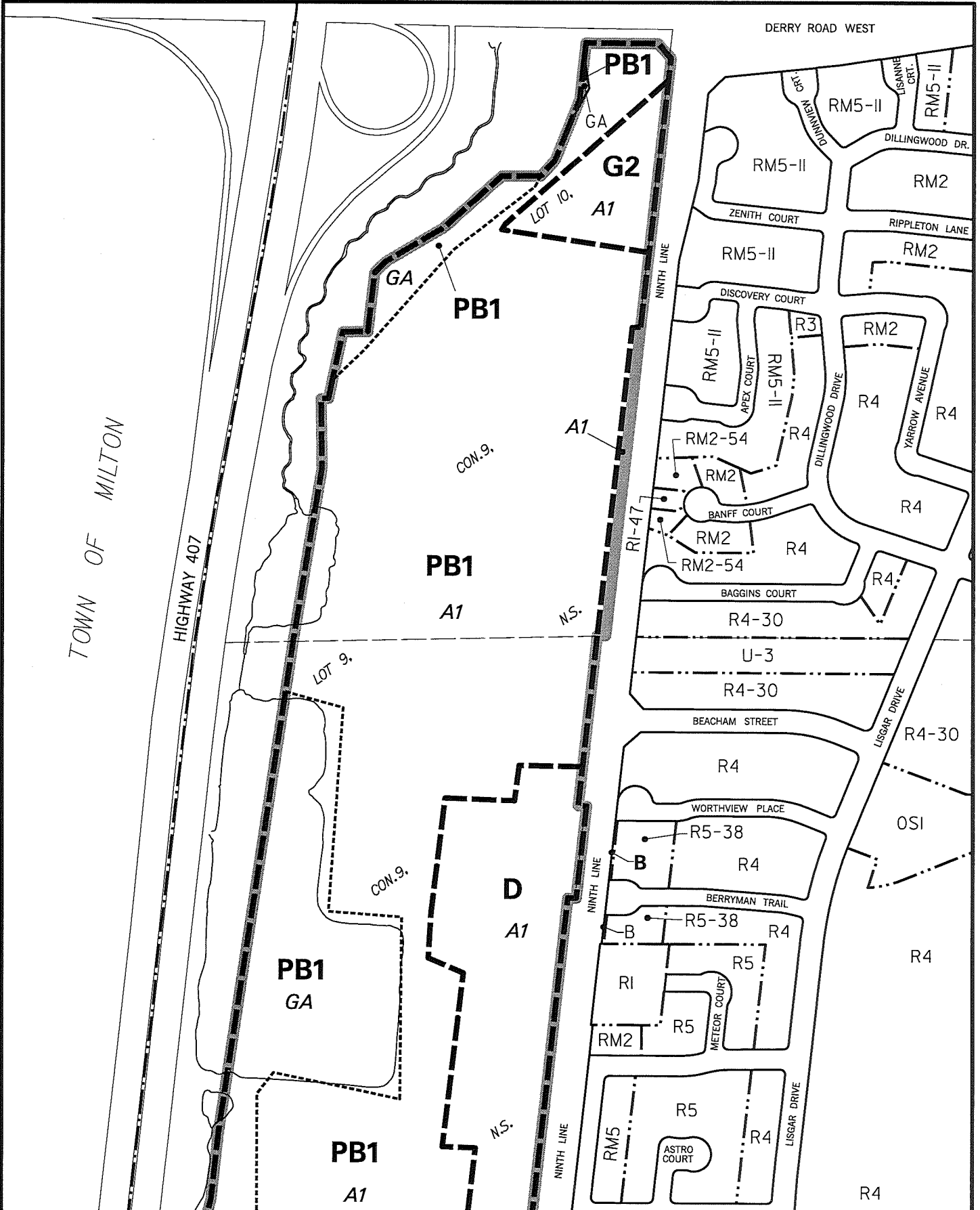

Area annexed from the Town of Milton as defined in Schedule A of Annexation Order dated December 17, 2009, Minister of Municipal Affairs and Housing



Zone lines from Town of Milton Zoning By-Law 144-2003

This is not a Plan of Survey.

**CITY OF MISSISSAUGA**

**THIS IS SCHEDULE "A3" TO**

**BY-LAW** 0168-2018

**PASSED BY COUNCIL ON**

July 4, 2018

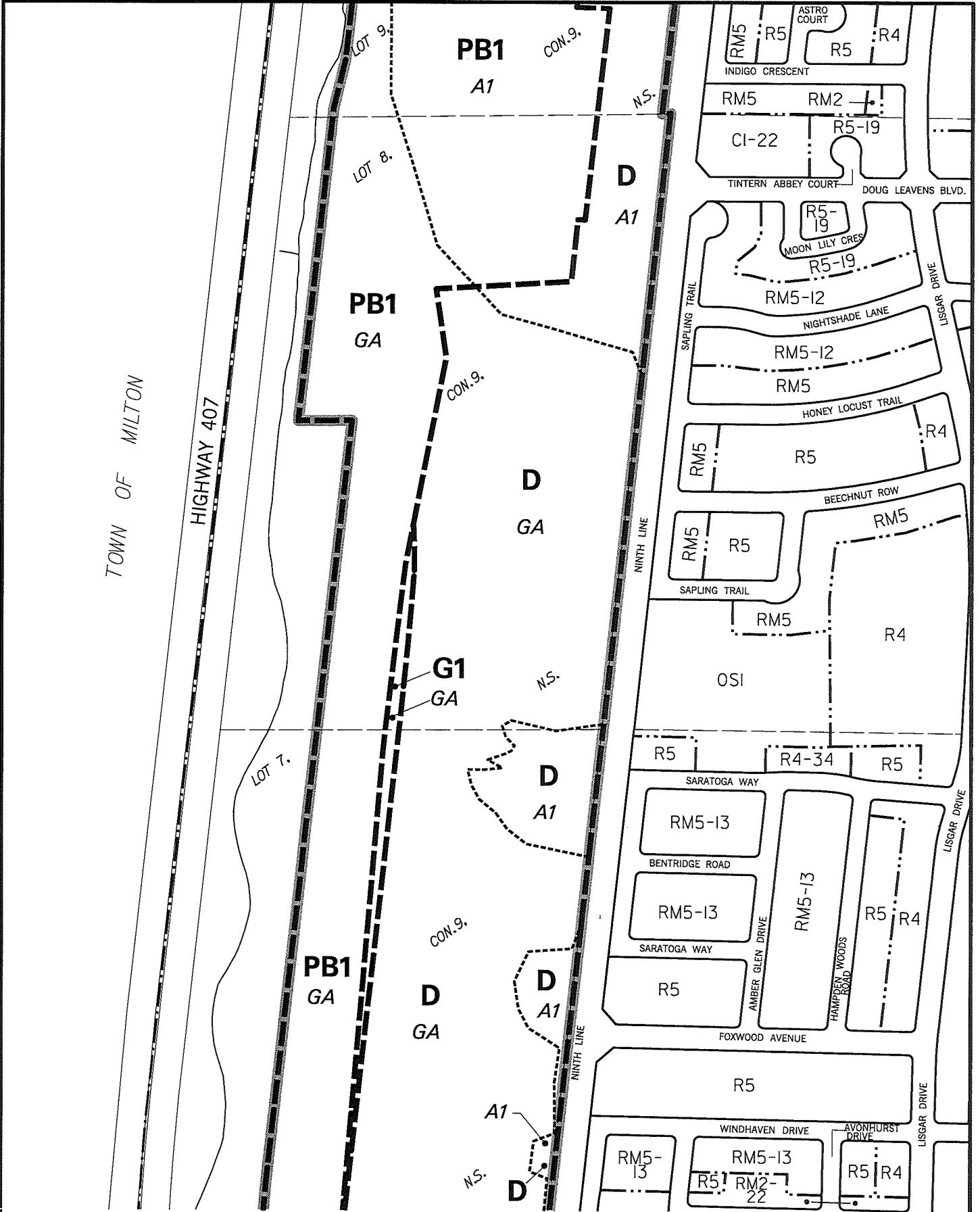

Area annexed from the Town of Milton as defined in Schedule A of Annexation Order dated December 17, 2009, Minister of Municipal Affairs and Housing



Zone lines from Town of Milton Zoning By-Law 144-2003

This is not a Plan of Survey.

**CITY OF MISSISSAUGA**

**THIS IS SCHEDULE "A4" TO**

**BY-LAW** 0168-2018

**PASSED BY COUNCIL ON**

July 4, 2018

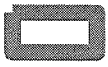
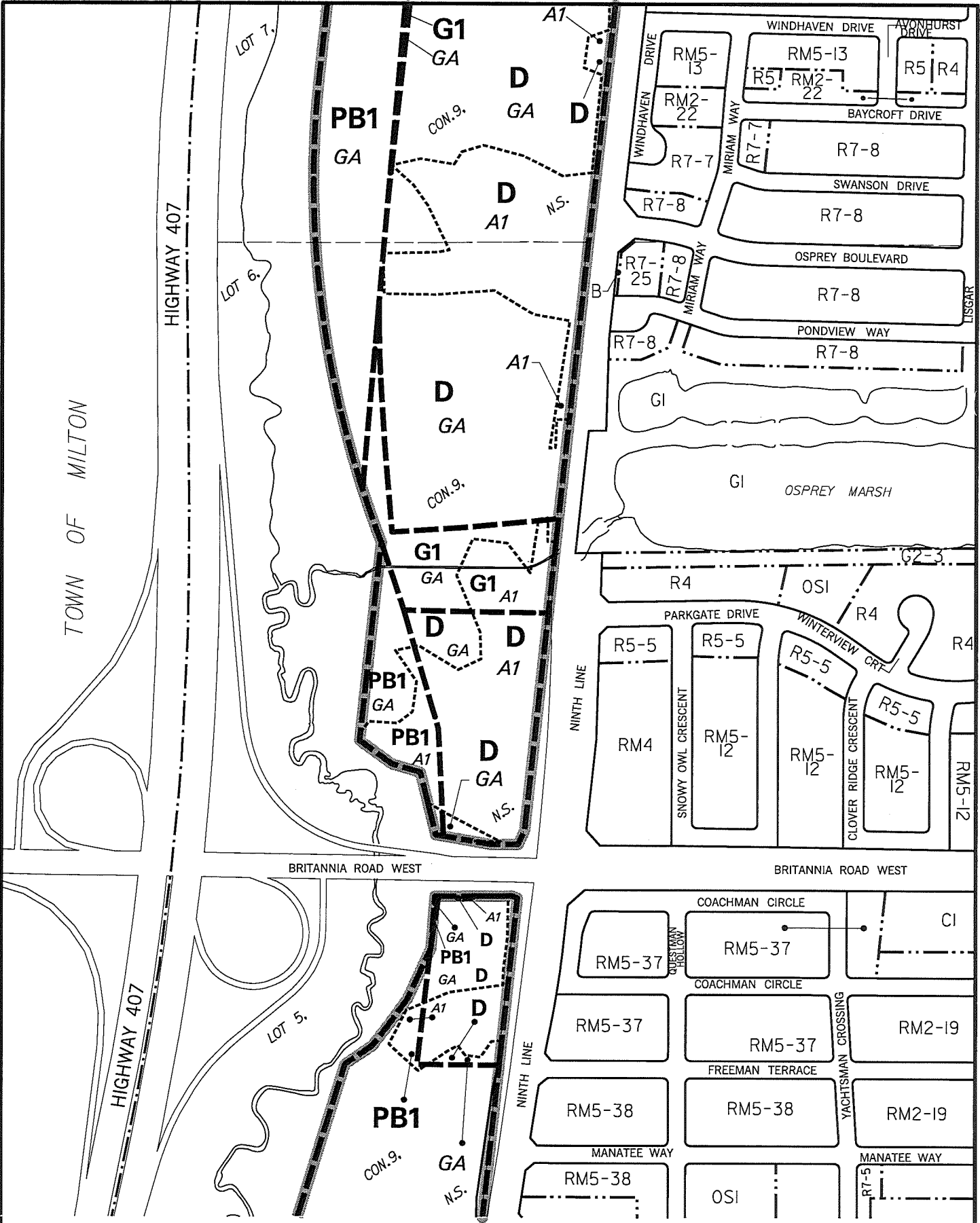

Area annexed from the Town of Milton as defined in Schedule A of Annexation Order dated December 17, 2009, Minister of Municipal Affairs and Housing



Zone lines from Town of Milton Zoning By-Law 144-2003

This is not a Plan of Survey.

**CITY OF MISSISSAUGA**

**THIS IS SCHEDULE "A5" TO**

**BY-LAW 0168-2018**

**PASSED BY COUNCIL ON**

July 4, 2018



TOWN OF MILTON

HIGHWAY 407

HIGHWAY 407

LOT 5.

LOT 4.

LOT 3.

GA  
PB1

PB1  
A1

G1

N.S.

GA

G1

PB1

GA

G1

N.S.

GA

PB1  
A1

N.S.

D  
A1

NINTH LINE

NINTH LINE

MANATEE WAY

RM5-38

R6-1

OSI

McDOWELL DRIVE

R6-1

R7-6

CHESSMAN COURT

R7-6

SWORDSMAN DRIVE

R7-6

RM5-38

LACMAN TRAIL

RM5-38

OSI

G1

R7

R6

R7

R6

R7

R6

R7

BRINWOOD GATE

R6

R7

R6

R7

R6

R7

RM2-41

R7

R6

R7

BLOOMINGTON CRESCENT

RM5-43

RM2-41

R7

R6

R6

BLOOMINGTON CRESCENT

RM5-43

RM2-41

R7

R6

R6

C5-18

RM2-19

RM2-19

RM1-14

R7

KELDREW AVENUE

RM2-19

RM1-14

R6

R7

JENNIC GROVE

RM1-14

R6

R7

R7

RAFTSMAN COVE

R7

RM2-19

RM2-19

RM1-14

RM1-14

R6

R7

TOPAZ PLACE

RM2-19

RM1-14

R7

R6

DOLomite HEIGHTS

RM1-14

R6

R7

R6

LONGFORD DRIVE

RM1-14

R7

R6

R7

ARBOURVIEW TERRACE

RM1-14

R7

R6

R7

REGATTA COURT

R6

R7

R7

OSI

LONGFORD DR

R7

R6

R7

R6

DEEPWOOD HEIGHTS

R7

R7

R7

R7

TALIAS CRESCENT

RM5-21

R7

R7

R7

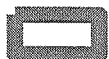

Area annexed from the Town of Milton as defined in Schedule A of Annexation Order dated December 17, 2009, Minister of Municipal Affairs and Housing



Zone lines from Town of Milton Zoning By-Law 144-2003

This is not a Plan of Survey.

CITY OF MISSISSAUGA

THIS IS SCHEDULE "A6" TO

BY-LAW 0168-2018

PASSED BY COUNCIL ON

July 4, 2018

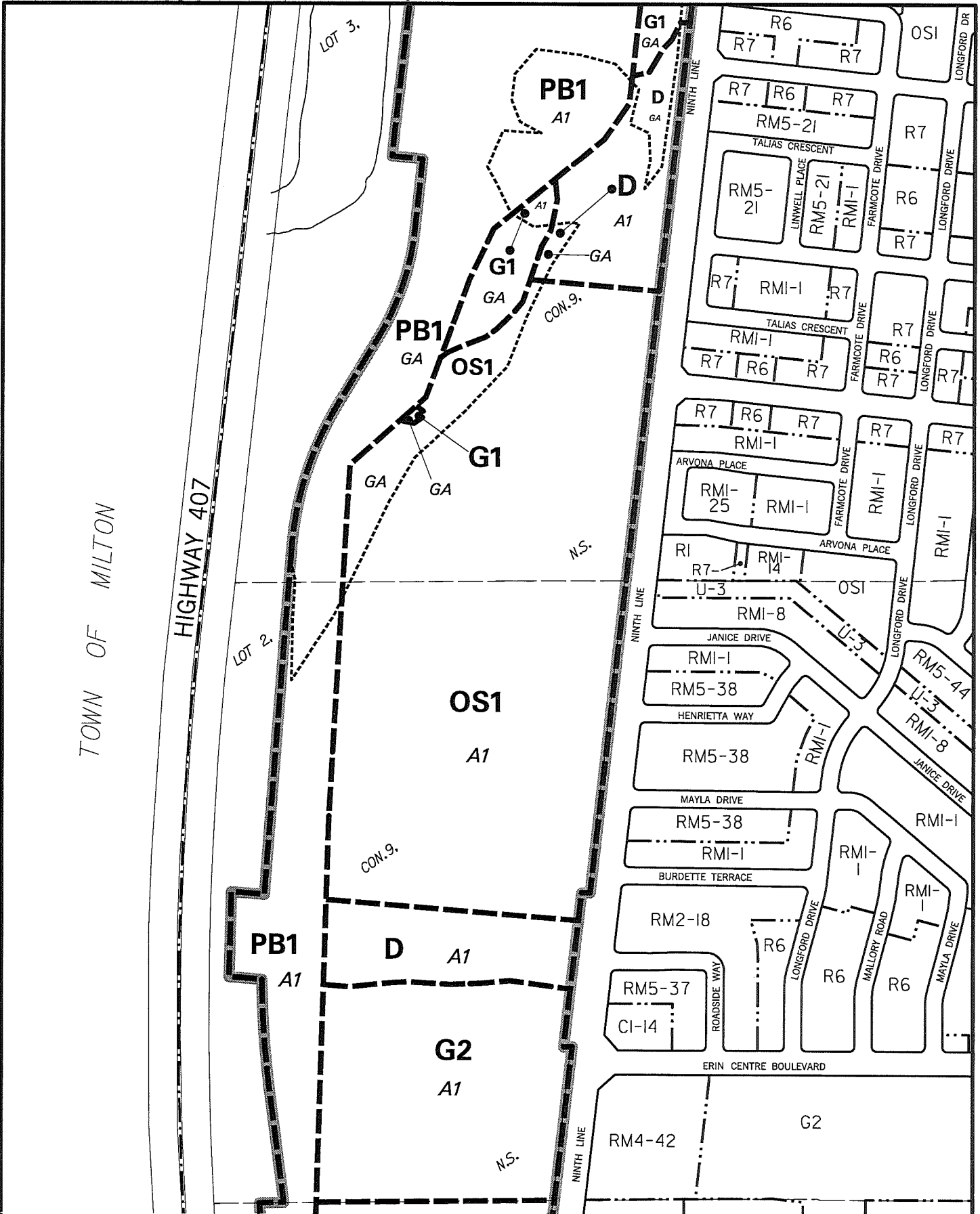

 Area annexed from the Town of Milton as defined in Schedule A of Annexation Order dated December 17, 2009, Minister of Municipal Affairs and Housing

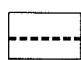
 Zone lines from Town of Milton Zoning By-Law 144-2003

This is not a Plan of Survey.

**CITY OF MISSISSAUGA**

**THIS IS SCHEDULE "A7" TO**

**BY-LAW** 0168-2018

**PASSED BY COUNCIL ON**

July 4, 2018

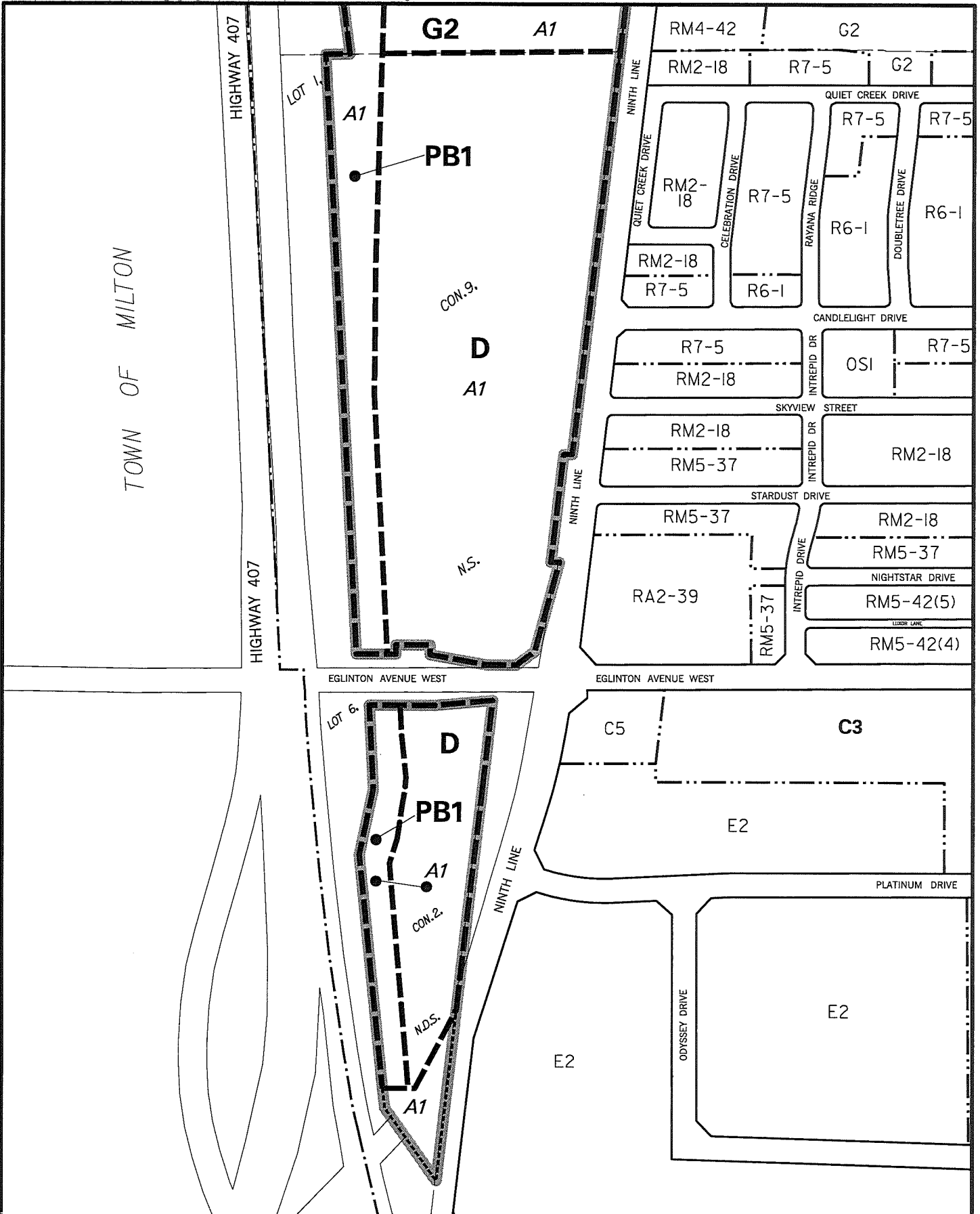

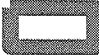
 Area annexed from the Town of Milton as defined in Schedule A of Annexation Order dated December 17, 2009, Minister of Municipal Affairs and Housing

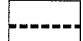
 Zone lines from Town of Milton Zoning By-Law 144-2003

This is not a Plan of Survey.

**CITY OF MISSISSAUGA**

**THIS IS SCHEDULE "A8" TO**

**BY-LAW** 0168-2018

**PASSED BY COUNCIL ON**

July 4, 2018

**APPENDIX "A" TO BY-LAW NUMBER 0168-2018**

Explanation of the Purpose and Effect of the By-law

The purpose of this By-law is to rezone the lands located on the west side of Ninth Line, north of Highway 403, to City of Mississauga zones, and to repeal the Town of Milton Zoning By-law as it pertains to these lands.

This By-law amends the zoning of the property outlined on the attached Schedules "A1" to "A8" from Town of Milton zones "A1" and "GA" to City of Mississauga zones "OS1" (Open Space - Community Park), "G1" (Greenlands - Natural Hazards), "G2" (Greenlands - Natural Features), "PB1" (Parkway Belt) and "D" (Development).

The Town of Milton zones formerly provided for open space and agricultural uses.

The City of Mississauga zones permit the following:

"OS1" permits passive and active recreational uses and stormwater management facilities.

"G1" permits flood control, stormwater management and erosion management uses and natural heritage features and areas conservation.

"G2" permits natural protection areas and natural heritage features and areas conservation.

"PB1" permits passive recreational uses and conservation uses.

"D" permits a building or structure legally existing on the date of passing of this By-law and the existing legal use of such building or structure.

Location of Lands Affected

Lands located between Highway 403 and the northern boundary of Mississauga, west of Ninth Line, in the City of Mississauga, as shown on the attached Maps designated as Schedules "A1" to "A8".

Further information regarding this By-law may be obtained from Romas Juknevičius of the City Planning and Building Department at 905-615-3200 ext. 4115.

<http://teamsites.mississauga.ca/sites/18/Bylaws/CD.04-NIN.by-law.rj.jmcc.docx>