

AVERAGE GRADE CALCULATIONS	29A and 29B		30A and 30B	
	PROPERTY SIDE LINES POINTS	A	108.42m	E
	B	108.62m	F	108.65m
	C	108.70m	G	108.55m
	D	108.62m	H	108.54m
	E	108.45m	I	108.47m
	F	108.65m	J	108.62m
	G	108.55m	K	108.66m
	H	108.54m	L	108.64m
AVERAGE GRADE:	108.57m		108.57m	

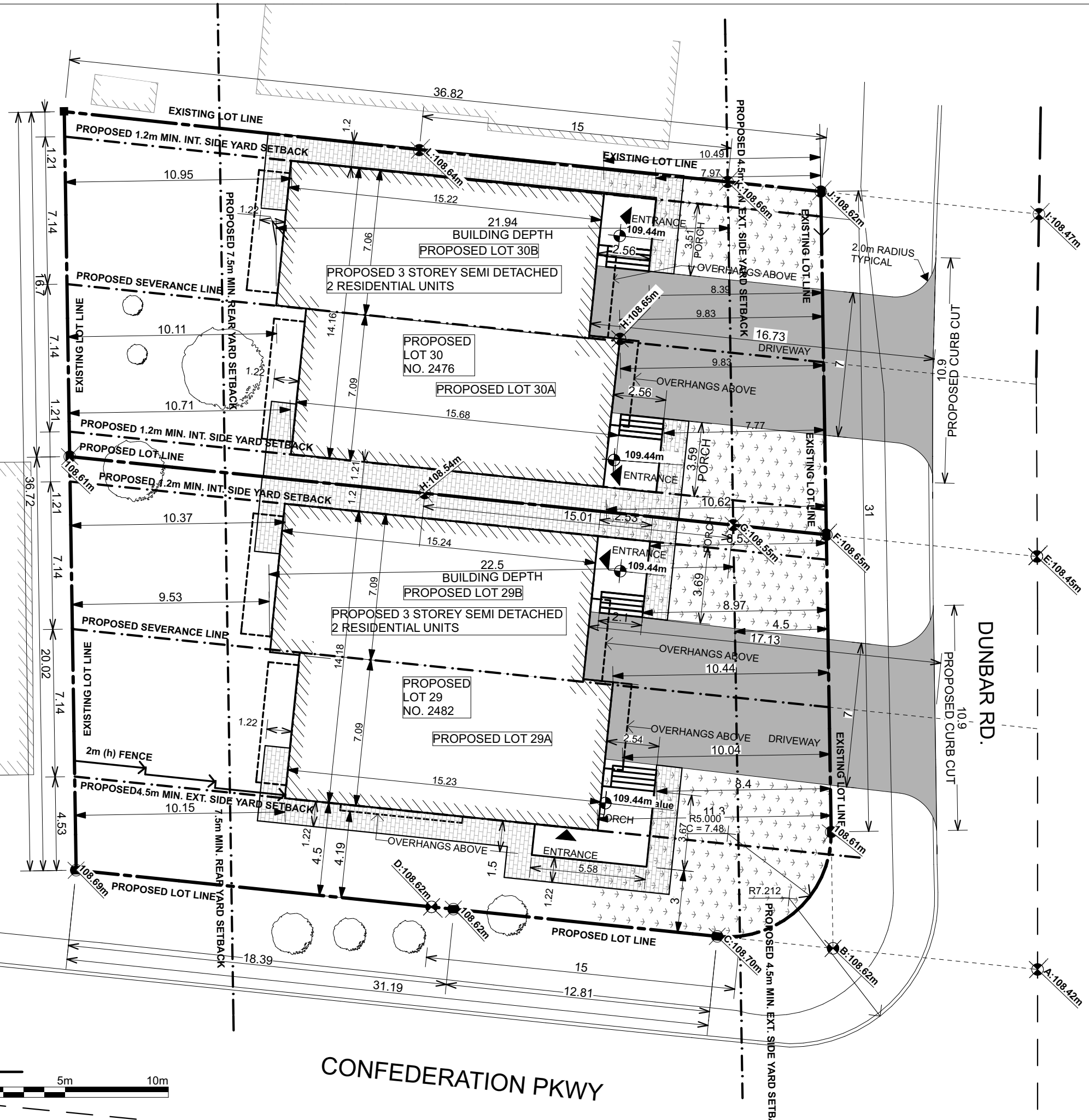

1. Copyright of this drawing is reserved by the Architect. The drawing and all associated documents are an instrument of service by the Architect. The drawing and the information contained therein may not be reproduced in whole or in part without prior written permission of the Architect.
2. These Contract Documents are the property of the Architect. The Architect bears no responsibility for the interpretation of these documents by the Contractor. Upon written application, the Architect will provide written/graphic clarification or supplementary information regarding the intent of the Contract Documents. The Architect will review Shop Drawings submitted by the Contractor for design conformance only.
3. Drawings are not to be scaled for construction. The Contractor is to verify all existing conditions and dimensions required to perform the work and report any discrepancies with the Contract Documents to the Architect before commencing any work.
4. Positions of exposed mechanical or electrical devices, fittings, and fixtures are indicated on architectural drawings. The locations shown on the architectural drawings govern over the Mechanical and Electrical drawings. Those items not clearly located will be located as directed by the Architect.
5. These drawings are not to be used for construction unless noted below as "Issuance: For Construction"
6. All work is to be carried out in conformance with the Code and Bylaws of the authorities having jurisdiction.
7. The Architect of these plans and specifications gives no warranty or representation to any party about the constructability of the building(s) represented by them. All contractors or subcontractors must satisfy themselves when bidding and at all times ensure that they can properly construct the work represented by these plans. © TREVOR MCIVOR ARCHITECT INC 2017

Issue Name	Change ID	Issue Date
Issued for Zoning By-Law Amendment		2020-02-27
Issued for Zoning By-Law Amendment		2019-04-16

TREVOR MCIVOR ARCHITECT INC

Architecture:
 Trevor McIvor
 Trevor McIvor trevor@trevormcivor.com

Reza Kolahdouzan
 reza@trevormcivor.com

134 Peter St., #1301
 Toronto, ON M5A 4M2
 t: (416) 525 7772
 w: www.trevormcivor.com

Consultant	Architect

2476-2482 Confederation Parkway
 Mississauga, ON, Canada

SITE PLAN

A101

1 **SITE PLAN**

A101 SCALE: 1:200

CONFEDERATION PKWY

DUNBAR RD.