

TREE PROTECTION ZONE, BARRIER & FENCING/HOARDING.

1. THE TREE PROTECTION ZONE SHALL BE ESTABLISHED BY THE INSTALLATION OF TREE PROTECTION FENCING AS ILLUSTRATED ON THE PLAN DRAWINGS.
2. TREE PROTECTION FENCING IS TO BE ERRECTED PRIOR TO THE COMMENCEMENT OF ANY CONSTRUCTION, GRADING OR CLEARING ACTIVITIES, AND IS TO REMAIN IN PLACE THROUGHOUT THE ENTIRE DURATION OF CONSTRUCTION AND RESTORATION EFFORTS.
3. ALL SUPPORTS AND BRACING USED TO SAFELY SECURE THE FENCING SHALL BE LOCATED OUTSIDE OF THE TREE PROTECTION FENCE. ALL SUPPORTS AND/OR BRACING SHALL BE INSTALLED IN A MANNER SO AS TO MINIMIZE DAMAGE TO THE ROOT SYSTEM.

TREE PROTECTION NOTES:

1. THIS TREE PROTECTION PLAN SHALL BE READ IN CONJUNCTION WITH THE TREE INVENTORY/ARBORIST REPORT/TREE PROTECTION PLAN PREPARED BY WOOD, 2020.
2. ALL CLEARING SHALL COMPLY WITH THE MIGRATORY BIRD CONVENTION ACT, SUCH THAT ALL CLEARING ACTIVITIES ARE OUTSIDE OF THE SEASONAL BREEDING WINDOW FROM APRIL 1 TO AUGUST 31. IF CLEARING OF VEGETATION IS REQUIRED DURING THIS TIMEFRAME, THE CONTRACTOR SHALL OBTAIN A QUALIFIED AVIAN BIOLOGIST TO CLEAR THE AREA OF NESTS IN CONNECTION WITH CLEARING AND GRUBBING ACTIVITIES. IF NESTING ACTIVITY IS OBSERVED, THE CONTRACTOR MUST CEASE WORK IN THIS AREA AND IMMEDIATELY NOTIFY THE CONTRACT ADMINISTRATOR.
3. ALL TREES LOCATED WITHIN THE PROJECT AREA DESIGNATED FOR PRESERVATION/PROTECTION AND ALL TREES ON ADJACENT PROPERTIES SHALL BE PRESERVED. IN THE EVENT THAT A TREE DESIGNATED FOR PRESERVATION/PROTECTION IS DAMAGED OR KILLED BY THE ACTIONS OF THE CONTRACTOR OR THEIR AGENT/SUBCONTRACTORS, THE CONTRACTOR WILL BE RESPONSIBLE FOR THE REPLACEMENT OF THE DESTROYED PLANT MATERIAL WITH MATERIAL OF EQUAL VALUE AND COMPARABLE SPECIES TO THE SATISFACTION OF THE OWNER.
4. TREES SHALL NOT HAVE ANY RIGGING CABLES OR HARDWARE OF ANY SORT ATTACHED OR WRAPPED AROUND THEM.
5. AREAS WITHIN THE TREE PROTECTION BARRIERS ARE NOT TO BE USED FOR ANY TYPE OF STORAGE (I.E., STOCKPILING, CONSTRUCTION MATERIAL AND EQUIPMENT ETC.)
6. NO GRADE CHANGES SHALL OCCUR WITHIN THE TREE PROTECTION ZONES.
7. THE CONTRACTOR WILL TAKE EVERY PRECAUTION TO PREVENT DAMAGE TO TREES OR SHRUBS, INCLUDING PROTECTING THE STEM AND ROOT SYSTEM FROM DAMAGE, COMPACTION OR CONTAMINATION RESULTING FROM THE CONSTRUCTION TO THE SATISFACTION OF THE CONTRACT ADMINISTRATOR.
8. THE CONTRACTOR MUST REPORT IMMEDIATELY ANY DAMAGE TO TREES SUCH AS BROKEN LIMBS, DAMAGE TO ROOTS, OR WOUNDS TO THE MAIN TRUNK OR STEMS SO THAT THE DAMAGE CAN BE ADDRESSED IMMEDIATELY.
9. ANY ROOTS OR BRANCHES WHICH EXTEND BEYOND THE TREE PROTECTION ZONE(S) INDICATED ON THE PLAN(S) WHICH REQUIRES PRUNING MUST BE APPROVED BY THE CONTRACT ADMINISTRATOR. ALL PRUNING MUST BE COMPLETED BY A CERTIFIED ARBORIST OR OTHER TREE CARE PROFESSIONAL AS APPROVED BY THE CONTRACT ADMINISTRATOR. ALL PRUNING OF TREE ROOTS AND BRANCHES MUST BE IN ACCORDANCE WITH BEST ARBORICULTURE STANDARDS.

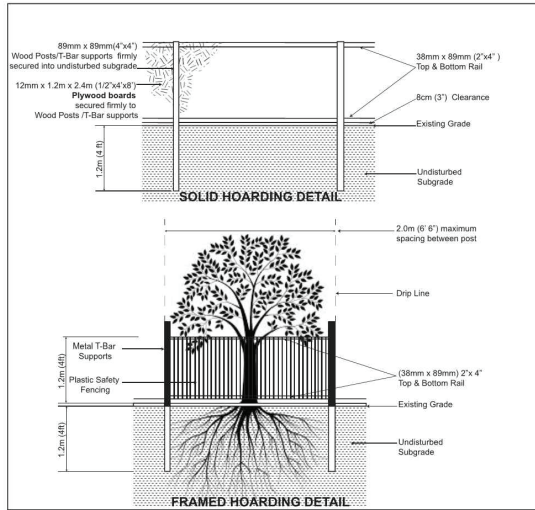

NOTES:

1. Hoarding details to be determined following initial site inspection.
 2. Private tree hoarding to be approved by Development & Design ; City tree hoarding to be approved by Community Services Dept.
 3. Hoarding must be supplied, installed and maintained by the applicant throughout all phases of construction.
- Inspection must be conducted by the Development and Design Division prior to removing any/all private hoarding.
4. Do not allow water to collect and pond behind or within hoarding.
 5. T-bar supports are acceptable alternative to 4x4 posts. U-shaped metal supports will not be accepted.
 6. Plywood must be utilized for 'solid' hoarding. OSB/Chipboard will not be accepted for solid hoarding. Plywood sheets must be installed on 'construction' side of frame.
 7. Applicant is responsible to ensure utility locales are completed within city boulevard prior to installing framed hoarding.

TREE PRESERVATION HOARDING



SCALE: N.T.S. DATE: June 2017

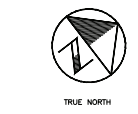
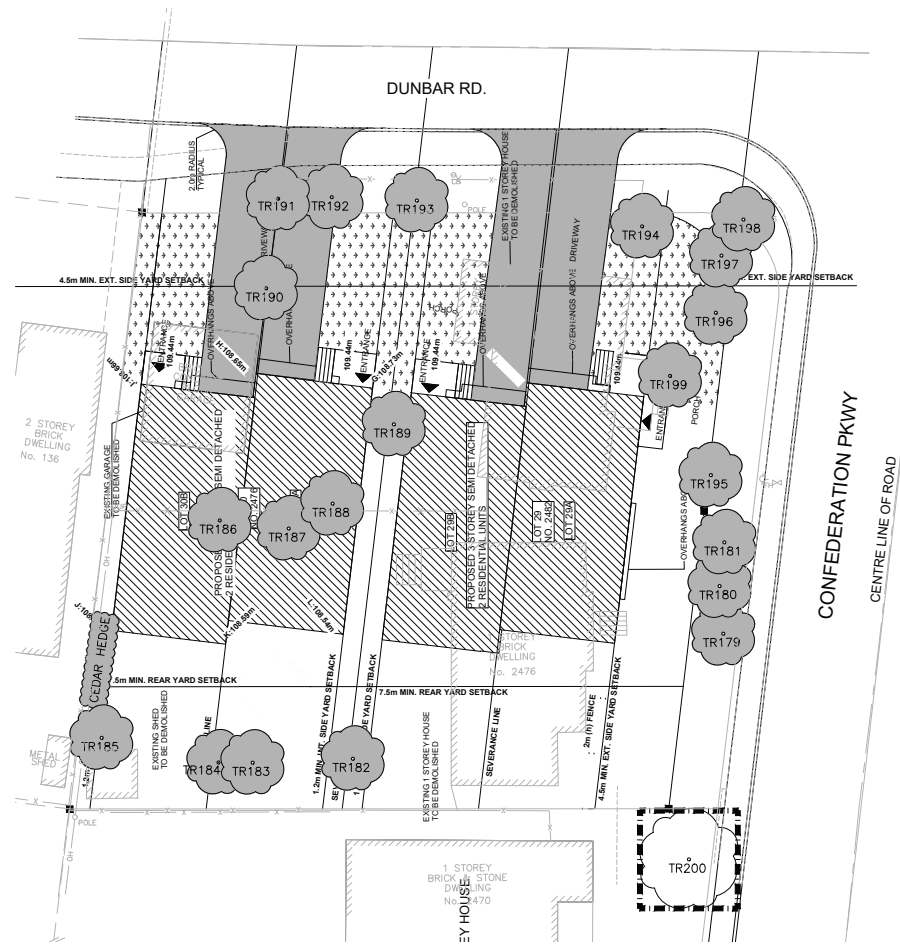

LEGEND

- TREES TO BE REMOVED (Solid circle symbol)
- TREE TO BE PROTECTED (Hollow circle symbol)
- TREE PROTECTION FENCE (Dashed line symbol)
- EXISTING LIGHT STANDARD (Circle with cross symbol)

SCALE VALID ONLY FOR 24"x36" VERSION

CONFEDERATION PARKWAY
PREEMINENT DEVELOPMENTS INC.

EXISTING TREE LOCATIONS PLAN



Scale 1:150
 Consultant File No. TPB188171
 Drawing No. 1