Traffic Safety Council

Date

2016/01/27

Time

5:00 P.M.

Location

Hearing Room, 2nd Floor, Civic Centre
300 City Centre Drive, Mississauga, ON L5B 3C1

Members

Councillor Sue McFadden, Ward 10
Councillor Chris Fonseca, Ward 3
Councillor John Kovac, Ward 4
Anna Abbruscato, Dufferin-Peel Catholic District School Board Trustee
Sandra Beniuk, Citizen Member
Robert Crocker, Peel District School Board Trustee
Tamara Coulson, Citizen Member
Louise Goegan, Citizen Member
Denise Gordon-Mohamud, Citizen Member
Sushil Kumra, Citizen Member
Heather Relf, Citizen Member (Vice-Chair)
Ajay Sharma, Citizen Member
Mashkoor Sherwani, Citizen Member
Daniel Suess, Citizen Member
Boris Swedak, Life Member
Altamash Syed, Citizen Member
Katherine Vukobrat, Citizen Member
Peter Westbrook, Citizen Member (Chair)

ADVISORY BOARD

Andy Bate, Supervisor, Traffic Operations

Sheelagh Duffin, Supervisor, Crossing Guards

Daniel Elias, Principals/Vice-Principals Association Peel District School Board

Barry Foley, Manager, Parking Enforcement

Anna Gentile/ Marcy Macina - Central Planning and Operations Officer, Student Transportation of Peel Region (STOPR)

Shawn Kearns, Principals/Vice-Principals Association Dufferin-Peel Catholic District School Board

Alex Liya, Traffic Operations Technician

Tim Murphy, Peel Regional Police

Denna Yaunan, Traffic Operations Technician

Erica Warsh, Transportation Demand Management Coordinator

Contact

Angie Melo, Legislative Coordinator, Legislative Services

905-615-3200 ext. 5423/Fax 905-615-4181/Email: angie.melo@mississauga.ca

Find it Online

<http://www.mississauga.ca/portal/cityhall/trafficsafetycouncil>

INDEX – TRAFFIC SAFETY COUNCIL – January 27, 2016CALL TO ORDERDECLARATIONS OF DIRECT (OR INDIRECT) PECUNIARY INTERESTPRESENTATIONS / DEPUTATIONS

Ivana Di Millo, Director, Communications, Shawn Slack, Director, IT, and Wendy McClymont, Manager, 311 Citizen Contact Centre, with respect to Pingstreet City Application.

MATTERS TO BE CONSIDERED

1. Approval of November 25, 2015 Minutes
2. Site Inspection Report – Munden Park Public School (Ward 7)
3. Site Inspection Report – St. Basil Catholic School (Ward 3)
4. Site Inspection Report – Brian W. Fleming Public School (Ward 3)
5. Site Inspection Report – St. Christopher Catholic School, Hillcrest Middle School, Whiteoaks Public School, and Lorne Park Secondary School (Ward 2)
6. Site Inspection Report – Fairview Public School (Ward 7)
7. Site Inspection Report – Corliss Public School (Ward 5)
8. Site Inspection Request – St. Veronica Catholic School and David Leeder Middle School (Ward 11)
9. Parking Enforcement School Zones for November and December 2015

CALL TO ORDERDECLARATIONS OF DIRECT (OR INDIRECT) PECUNIARY INTERESTPRESENTATIONS / DEPUTATIONS

Ivana Di Millo, Director, Communications, Shawn Slack, Director, IT, and Wendy McClymont, Manager, 311 Citizen Contact Centre, with respect to Pingstreet City Application.

MATTERS TO BE CONSIDERED1. Approval of November 25, 2015 Minutes

Minutes of the Traffic Safety Council meeting held on November 25, 2015.

RECOMMEND APPROVAL2. Site Inspection Report – Munden Park Public School (Ward 7)

Site Inspection Report for the safety review conducted on December 8, 2015 at the bridge in Camilla Park over the Cooksville Creek for the students attending Munden Park Public School.

RECOMMENDATION

That the Site Inspection Report for the safety review conducted on December 8, 2015 at the bridge in Camilla Park over the Cooksville Creek for the students attending Munden Park Public School, be received for information.

RECOMMEND APPROVAL3. Site Inspection Report – St. Basil Catholic School (Ward 3)

Site Inspection Report for the site inspection conducted on December 10, 2015 at 4235 Golden Orchard Drive in front of St. Basil Catholic School.

RECOMMENDATION

1. That Transportation and Works be requested to review the signage in the St. Basil Catholic School area as follows:
 - a. Changing “No Parking” signs at the school entrance and exit driveway to “No Stopping” signs;
 - b. Adding more “No U Turn” signs to create No U Turn zones;

- c. Replace "No Stopping" signs opposite the school with "No Stopping" Monday to Friday between 8:00 a.m. to 4:00 p.m. September to June; and
 - d. Add more "No Stopping" signs for better visibility.
2. That Parking Enforcement be requested to enforce all parking and stopping prohibitions from 8:20 a.m. to 8:45 a.m., and 3:05 p.m. to 3:30 p.m., once signage is in place for the students attending St. Basil Catholic School.
3. That Peel Regional Police be requested to enforce "No U Turn" violations from 8:20 a.m. to 8:45 a.m. and 3:05 p.m. to 3:30 p.m., for the students attending St. Basil Catholic School.
4. That the Principal of St. Basil Catholic School be requested to consider the following:
 - a. Advise parents to use the Kiss and Ride area when dropping off their children in the morning.
 - b. Providing safety vests for the staff who operate the Kiss and Ride area.
5. That the City of Mississauga, Ward 3 Councillor be requested to consider removing the existing "No Parking" signs on the east side of Golden Orchard Drive between Larny Court and the school exit driveway for the students attending St. Basil Catholic School.
6. That the Student Transportation of Peel Region be requested to relocate the school bus stops currently located at the south leg of Greybrook Crescent and the entrance driveway to St. Basil Catholic School.

RECOMMEND APPROVAL

4. Site Inspection Report – Brian W. Fleming Public School (Ward 3)

Site Inspection Report for the site inspection conducted on December 15, 2015 at 3255 Havenwood Drive for the students attending Brian W. Fleming Public School.

RECOMMENDATION

1. That Parking Enforcement be requested to enforce parking prohibitions between 3:10 p.m. and 3:45 p.m. on Havenwood Drive, for the students attending Brian W. Fleming Public School
2. That the Transportation and Works Department be requested to review signage in the area for students attending Brian W. Fleming Public School.

RECOMMEND APPROVAL

5. Site Inspection Report – St. Christopher Catholic School, Hillcrest Middle School, Whiteoaks Public School and Lorne Park Secondary School (Ward 2)

Site Inspection Report for the site inspection and safety review conducted on January 11, 2016 at the intersection of Clarkson Road and Birchwood Drive, for the students attending St. Christopher Catholic School, Hillcrest Middle School, Whiteoaks Public School and Lorne Park Secondary School. .

RECOMMENDATION

1. That the request for a crossing guard at the intersection of Clarkson Road and Birchwood Drive, for the students attending St. Christopher Catholic School and Whiteoaks Public School, be denied as the warrants are not met.
2. That the City of Mississauga, Ward 2 -Councillor be requested to consider conducting a survey of area residents living on the east side of Clarkson Road to determine if they are in favour of a sidewalk being constructed on the east side of Clarkson Road, for students attending St. Christopher Catholic School, Hillcrest Middle School, Whiteoaks Public School and Lorne Park Secondary School.
3. That the Transportation and Works Department be requested to conduct a speed study on Clarkson Road in the area of Birchwood Drive in order to determine if traffic calming measures should be recommended, for the students attending St. Christopher Catholic School, Hillcrest Middle School, Whiteoaks Public School and Lorne Park Secondary School.

RECOMMEND APPROVAL

6. Site Inspection Report – Fairview Public School (Ward 7)

Site Inspection Report for the site inspection conducted on January 14, 2016 at the east leg at Duke of York Boulevard, and Webb Drive for the students attending Fairview Public School.

RECOMMENDATION

1. That the request for a crossing guard at the east leg of Duke of York Boulevard and Webb Drive, for students attending Fairview Public School, be denied as the warrants are not met.
2. That the Traffic Safety Council be requested to re-inspect existing crossing at the west leg of Duke of York Boulevard and Webb Drive to determine if the warrants continue to be met.

RECOMMEND APPROVAL

7. Site Inspection Report – Corliss Public School (Ward 5)

Site Inspection Report for the site inspection conducted on January 19, 2016 at the intersection of Sigsbee Drive and Brandon Gate Drive, north leg, for the students attending Corliss Public School.

RECOMMENDATION

That the request for a crossing guard at the intersection of Brandon Gate Drive and Sigsbee Drive, north leg, for the students attending Corliss Public School, be denied as the warrants are not met.

RECOMMEND APPROVAL

8. Site Inspection Request – St. Veronica Catholic School and David Leeder Middle School (Ward 11)

An email dated January 7, 2016 from Anna Gentile, from Student Transportation of Peel Region requesting a safety review at the intersection of Mavis Road and Crawford Mill Avenue/Novo Star Drive, and, at the intersections of McLaughlin Road and Novo Star Drive/Arrowsmith Drive from 8:00 a.m. to 8:40 a.m. and from 2:10 p.m. to 3:30 p.m.

RECOMMEND RECEIPT/REFERRAL

9. Parking Enforcement in School Zones for November and December 2015

report from the Manager of Parking Enforcement with respect to parking enforcement in school zones for November and December 2015.

RECOMMEND RECEIPT

OTHER BUSINESS

Date of Next Meeting: February 24, 2016

ADJOURNMENT

City of Mississauga Minutes

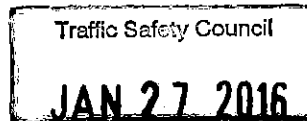

Traffic Safety Council

Date

2015/11/25

Time

7:00 a.m.

Location

Hearing Room, 2nd Floor, Civic Centre
300 City Centre Drive, Mississauga, ON L5B 3C1

Members Present

Councillor Sue McFadden, Ward 10
Councillor Chris Fonseca, Ward 3
Councillor John Kovac, Ward 4
Sandra Beniuk, Citizen Member
Robert Crocker, Peel District School Board Trustee
Tamara Coulson, Citizen Member
Louise Goegan, Citizen Member
Denise Gordon-Mohamud, Citizen Member
Heather Relf, Citizen Member (Vice-Chair)
Mashkoor Sherwani, Citizen Member
Daniel Suess, Citizen Member
Altamash Syed, Citizen Member
Katherine Vukobrat, Citizen Member
Peter Westbrook, Citizen Member (Chair)

Members Absent

Anna Abbruscato, Dufferin-Peel Catholic District School Board Trustee
Ajay Sharma, Citizen Member
Boris Swedak, Life Member
Sushil Kumra, Citizen Member

Advisory Board Present

Sheelagh Duffin, Supervisor, Crossing Guards
Alex Liya, Traffic Operations Technician
Denna Yaunan, Traffic Operations Technician
Craig Terry, Parking Enforcement Officer

Contact

Angie Melo, Legislative Coordinator, Legislative Services
905-615-3200 ext. 5423/ Fax 905-615-4181/ Email angie.melo@mississauga.ca

Find it online

<http://www.mississauga.ca/portal/cityhall/trafficsafetycouncil>

CALL TO ORDER 5:00 p.m.

DECLARATIONS OF CONFLICT OF INTEREST - NIL

PRESENTATIONS / DEPUTATIONS - NIL

MATTERS TO BE CONSIDERED

1. Approval of October 28, 2015 Minutes

Minutes of the Traffic Safety Council meeting held on October 28, 2015 as amended.

Approved (A. Syed)

2. Site Inspection Report – Lancaster Public School (Ward 5)

Site Inspection Report for the site inspections conducted on November 5, 2015 at 7425 Netherwood Road in front of Lancaster Public School.

RECOMMENDATION

1. That the warrants for a crossing guard in front of Lancaster Public School has been met.
2. That Transportation and Works be requested to review the signage on Redstone Road and Netherwood Road in the vicinity of Lancaster Public School.
3. That the Peel District School Board be requested to review the operation of the Kiss & Ride and Dismissal Program at Lancaster Public School
4. That the Traffic Safety Council, approach the Principal of Lancaster Public School regarding the Walk to School Program.

Approved (L. Goegan)

Recommendation TSC-0150-2015

3. Site Inspection Report – Meadowvale Village Public School (Ward 11)

Site Inspection Report for site inspections conducted on November 10, 2015 at the intersection of Hush Lane and Second Line for the students attending Meadowvale Village Public School.

RECOMMENDATION

That the request for a crossing guard at the intersection of Hush Lane and Second Line for Students attending Hush Lane and Second Line for the students attending Meadowvale Village Public School be denied as warrants are not met.

Approved (D. Suess)

Recommendation TSC-0151-2015

4. Site Inspection Report – St. Jerome Catholic School (Ward 7)

Site Inspection Report for site inspections conducted on November 12, 2015 at the intersection of Paisley Boulevard and Pollard Drive for the students attending St. Jerome Catholic School.

RECOMMENDATION

1. That the request for a crossing guard at the intersection of Paisley Boulevard and Pollard Drive, for students attending St. Jerome Catholic School be denied as the warrants are not met.
2. That Transportation and Works be requested to review signage on Paisley Boulevard in the vicinity of St. Jerome Catholic School.

Approved (Councillor S. McFadden)

Recommendation TSC-0152-2015

5. Parking Enforcement in School Zones for October 2015

RECOMMENDATION

That the report from the Manager of Parking Enforcement with respect to parking enforcement in school zones for the month of October 2015 be received for information.

Approved (D. Suess)

Recommendation TSC-0153-2015

6. Dr. Arthur Wood Award

Traffic Safety Council Members discussed potential nominees for the Dr. Arthur Wood Award. Members agreed that they would like the opportunity to review past members and the criteria for the selection of a nominee. Direction was given to the Legislative Coordinator to email Traffic Safety Council Members the criteria, and a list of past recipients of the Dr. Arthur Wood Award and to provide a deadline for submissions so that the Public Information Subcommittee can meet to review the nominations.

7. WildeWood Award Nomination

Peter Westbrook, Chair, presented the names of the schools selected for the WildeWood School Zone Safety Award. Mr. Westbrook provided a brief summary of the successes of the schools selected.

RECOMMENDATION

That the WildeWood Award for School Zone Safety Award be awarded to the following Schools which: have demonstrated that they have a team of staff and/ or volunteers that deserve to be recognized for the efficient operation of the School Zone Safety (Kiss & Ride) Program and promote and/ or encourage active transportation to and from school:

- Plum Tree Park Public School
- Shelter Bay Public School
- Canadian Martyrs Catholic School
- St. Gertrude Catholic School

Approved (D. Gordon-Mohamud)
Recommendation TSC-0154-2015

8. City of Mississauga Advisory Committee Role and Rule

The Members of Traffic Safety Council reviewed the City of Mississauga Advisory Committees Role and Rules dated November 2015.

RECOMMENDATION

That the City of Mississauga Advisory Committees Role and Rules dated November 2015, be received for information.

Approved (T. Coulson)
Recommendation TSC-0155-2015

9. Site Inspection Report – St. Marcellinus Catholic School and Mississauga Secondary School (Ward 11)

Site Inspection Reports for the site inspections conducted as follows:

November 3, 2015, at 730 Courtney Park Drive West, in front of St. Marcellinus Catholic School;

November 3, 2015, at 550 Courtneypark Drive West, in front of Mississauga Secondary School; and

November 19, 2015 at the intersection of Envoy Drive and Othello Court (Tabbyman Walk)

RECOMMENDATION

1. That Transportation and Works be requested to:
 - a) review the feasibility of installing flashing 40 KM school zone signage in front of St. Marcellinus and Mississauga Secondary School, from 7:00 a.m. to 9:00 a.m. and from 2:00 p.m. to 4:00 p.m.
 - b) implement a "No Stopping" driveway prohibitions at Mississauga Secondary School.
2. That Parking Enforcement be requested to enforce the "No Stopping" prohibitions on Courtneypark Drive between Mavis Road and the entrance to St. Marcellinus Catholic School driveway.
3. That Peel Regional Police be requested to continue to enforce "No U-turn" violations on Courtneypark Drive at Spinnaker Circle.
4. That the Peel District School Board be requested to review the operation of the Kiss and Ride at Mississauga Secondary School.
5. That the Principal of Mississauga Secondary School be requested to:
 - a) advise students and parents to use the east entrance on McLaughlin Road
 - b) remind students to cross at the controlled intersection in the afternoon dismissal.
6. That Student Transportation of Peel Region be requested to:
 - a) advise school bus drivers not to block the sidewalk when entering and exiting school property at Mississauga Secondary School.
 - b) advise school bus drivers to load students only in the designated areas.
7. That the request for a crossing guard at the intersection of Envoy Drive and Othello Court (Tabbyman Walk) be denied as warrants are not met.

Approved (Councillor S. McFadden)

Recommendation TSC-0156-2015

10. Site Inspection Reports – Meadowvale Secondary School and Edenwood Middle School (Ward 9)

Site Inspection Reports for the site inspections conducted on November 4, 18 and 20, 2015 at 6700 Edenwood Drive, in front of Meadowvale Secondary School.

RECOMMENDATION

1. That Parking Enforcement be requested to enforce "No Stopping" prohibitions opposite of Meadowvale Secondary School on Edenwood Drive.
2. That the Principals of Meadowvale Secondary School and Edenwood Middle School be requested to consider changing their school entrance and dismissal times to be offset by 15 minutes,

Approved (D. Suess)

Recommendation TSC-0157-2015

11. Site Inspection Report – Forest Avenue Public School and Mentor College (Ward 1)

Site Inspection Report for a site inspection conducted on November 17, 2015 at the intersection of Forest Avenue and Cayuga Avenue, and on November 23, 2015 at the intersection of Forest Avenue and Briarwood Avenue (East and South Legs), for the students attending Forest Avenue Public School and Mentor College.

RECOMMENDATION

1. That the request for a crossing guard at the intersection of Forest Avenue and Cayuga Avenue, for the students attending Forest Avenue Public School and Mentor College, be denied as warrants are not met.
2. That Transportation and Works be requested to review signage on Forest Avenue in front of Forest Avenue Public School and Mentor College.
3. That Parking Enforcement be requested to enforce "No Stopping" prohibitions from 3:00 p.m. to 3:30 p.m. on Forest Avenue in front of Forest Avenue Public School and Mentor College once signage is in place.
4. That the request for a crossing guard at the intersection of Forest Avenue and Briarwood Avenue, (East and South Legs), for the students attending Mentor College, be denied as the warrants are not met.

5. That the Principal of Mentor College be Advised of Section 176 of the *Highway Traffic Act* which stipulates, that no one other than a crossing guard display a stop sign and that crossing guards must be employees of a municipality.

Approved (S. Beniuk)

Recommendation TSC-0158-2015

12. Transportation and Works Action Items List – October 2015

Action Items List from the Transportation and Works Department for the month of October 2015.

RECOMMENDATION

That the Action Items List from the Transportation and Works Department for the month of October 2015 be received for information.

Approved (Councillor S. McFadden)

Recommendation TSC-0159-2015

OTHER BUSINESS

Date of Next Meeting: January 27, 2016

ADJOURNMENT 5:38 p.m.

Site Inspection Report



Traffic Safety Council
JAN 27 2016

Corporate Services
Office of the City Clerk

2

Site	
School: Munden Park Public School	Address: 515 Tedwyn Drive Mississauga ON L5A 1J8
School Times: 8:30 AM <input type="checkbox"/> PM	Student Population: 385
No. of School Buses: 215 Buses	
School: <input type="text"/>	Address: <input type="text"/>
School Times: <input type="text"/> AM <input type="text"/> PM	Student Population: <input type="text"/>
No. of School Buses: <input type="text"/>	

Location: (Please identify the location with reference to nearest intersection. Indicate nearest school and address) Bridge in Camilla Park over Cooksville Creek			
Date of Inspection: 2015 12 08	Inspection Time: 8:00 AM <input type="checkbox"/> PM	Requested By: VP Munden Park PS	
Prepared By: S. Duffin	Request For: safety review		

Observers			
File Number: RT.10	File Number: RT.10	Ward: Ward 7	
Observed By: S. Duffin	<input checked="" type="checkbox"/> AM <input type="checkbox"/> PM <input type="checkbox"/> AM & PM		
Observed By: P. Westbrook	<input checked="" type="checkbox"/> AM <input type="checkbox"/> PM <input type="checkbox"/> AM & PM		
Observed By: M. Macina	<input checked="" type="checkbox"/> AM <input type="checkbox"/> PM <input type="checkbox"/> AM & PM		
Observed By: A. Liya	<input checked="" type="checkbox"/> AM <input type="checkbox"/> PM <input type="checkbox"/> AM & PM		
Observed By: E. Jackett	<input checked="" type="checkbox"/> AM <input type="checkbox"/> PM <input type="checkbox"/> AM & PM		
Observed By: F. Buckley	<input checked="" type="checkbox"/> AM <input type="checkbox"/> PM <input type="checkbox"/> AM & PM		

Details			
Weather Conditions:	AM: <input checked="" type="checkbox"/> Dry <input type="checkbox"/> Sunny <input type="checkbox"/> Rain <input type="checkbox"/> Snow <input type="checkbox"/> Other: <input type="text"/>		
	PM: <input type="checkbox"/> Dry <input type="checkbox"/> Sunny <input type="checkbox"/> Rain <input type="checkbox"/> Snow <input type="checkbox"/> Other: <input type="text"/>		
Type of Crossing:	<input type="checkbox"/> 4 Way Intersection <input type="checkbox"/> 3 Way Intersection <input type="checkbox"/> Midblock (i.e., not an intersection)		
Type of Control:	<input type="checkbox"/> Traffic Lights <input type="checkbox"/> Yield Signs <input checked="" type="checkbox"/> No Control		
	<input type="checkbox"/> Stop Signs (Traffic is stopped on one street only) <input type="checkbox"/> All Way Stop (Traffic is stopped in all directions)		

Site Conditions			
School Signs:	<input type="checkbox"/> School Area Signs <input type="checkbox"/> School Crossing Signs <input type="checkbox"/> Parking/Stopping Prohibition		
Posted Speed Limit:	<input type="checkbox"/> 40 km/hr <input type="checkbox"/> 50 km/h <input type="checkbox"/> 60 km/hr <input type="checkbox"/> Other: <input type="text"/>		
Visibility of Crossing Pedestrians:	<input type="checkbox"/> Poor <input type="checkbox"/> Fair <input type="checkbox"/> Good	Comments: <input type="text"/>	
Sight Obstructions:	<input type="checkbox"/> Hedges <input type="checkbox"/> Trees <input type="checkbox"/> Fences <input type="checkbox"/> Bus Shelter		
	<input type="checkbox"/> Newspaper Boxes <input type="checkbox"/> Other (Specify): <input type="text"/>		
Road Grade:	<input type="checkbox"/> Flat <input type="checkbox"/> Incline <input type="checkbox"/> Decline		
Road Geometrics:	<input type="checkbox"/> Straight <input type="checkbox"/> Curved	Comments: <input type="text"/>	
Road Width:	<input type="text"/> feet/metres	Curb to Curb: <input type="text"/> feet/metres	Curb to Median: <input type="text"/> feet/metres
Road Conditions:	AM: <input checked="" type="checkbox"/> Dry <input type="checkbox"/> Wet <input type="checkbox"/> Snow Covered <input type="checkbox"/> Ice		
	PM: <input type="checkbox"/> Dry <input type="checkbox"/> Wet <input type="checkbox"/> Snow Covered <input type="checkbox"/> Ice		
Sidewalks:	<input type="checkbox"/> Not Present <input type="checkbox"/> North <input type="checkbox"/> South <input type="checkbox"/> East <input type="checkbox"/> West		
Proximity to School:	<input type="checkbox"/> In Front of <input checked="" type="checkbox"/> Within 1KM feet/metres		
Route Survey:	<input type="checkbox"/> Shopping Area <input type="checkbox"/> Construction <input type="checkbox"/> Driveway <input type="checkbox"/> Parked Vehicle(s)		
	<input type="checkbox"/> Transit Bus Stop <input type="checkbox"/> Underpass Within <input type="text"/> feet/metres	Other (specify): Bridge	
Comments / Conflicts:	SEE BELOW FOR COMPLETE COMMENTS		

Crossing Guard Warrant SurveyLocation: **Pedestrian Bridge - Camilla Park**☐ Safe Gap TimeSafe Gap Time Calculation (if applicable): $\left(\frac{W}{3.5} + 4 \right)$ = sec.☐ Signalized Intersection turning traffic count**Morning Intervals**

Time (AM)	# of Peds	# of Conflicts	Gaps	# of Gaps
7:45 - 7:50	<input type="text"/>	<input type="text"/>	<input type="text"/>	<input type="text"/>
7:50 - 7:55	<input type="text"/>	<input type="text"/>	<input type="text"/>	<input type="text"/>
7:55 - 8:00	<input type="text"/>	<input type="text"/>	<input type="text"/>	<input type="text"/>
8:00 - 8:05	<input type="text"/>	<input type="text"/>	<input type="text"/>	<input type="text"/>
8:05 - 8:10	<input type="text"/>	<input type="text"/>	<input type="text"/>	<input type="text"/>
8:10 - 8:15	<input type="text"/>	<input type="text"/>	<input type="text"/>	<input type="text"/>
8:15 - 8:20	<input type="text"/>	<input type="text"/>	<input type="text"/>	<input type="text"/>
8:20 - 8:25	<input type="text"/>	<input type="text"/>	<input type="text"/>	<input type="text"/>
8:25 - 8:30	<input type="text"/>	<input type="text"/>	<input type="text"/>	<input type="text"/>
8:30 - 8:35	<input type="text"/>	<input type="text"/>	<input type="text"/>	<input type="text"/>
8:35 - 8:40	<input type="text"/>	<input type="text"/>	<input type="text"/>	<input type="text"/>
8:40 - 8:45	<input type="text"/>	<input type="text"/>	<input type="text"/>	<input type="text"/>
8:45 - 8:50	<input type="text"/>	<input type="text"/>	<input type="text"/>	<input type="text"/>
8:50 - 8:55	<input type="text"/>	<input type="text"/>	<input type="text"/>	<input type="text"/>
8:55 - 9:00	<input type="text"/>	<input type="text"/>	<input type="text"/>	<input type="text"/>

Afternoon Intervals

Time (PM)	# of Peds	# of Conflicts	Gaps	# of Gaps
2:45 - 2:50	<input type="text"/>	<input type="text"/>	<input type="text"/>	<input type="text"/>
2:50 - 2:55	<input type="text"/>	<input type="text"/>	<input type="text"/>	<input type="text"/>
2:55 - 3:00	<input type="text"/>	<input type="text"/>	<input type="text"/>	<input type="text"/>
3:00 - 3:05	<input type="text"/>	<input type="text"/>	<input type="text"/>	<input type="text"/>
3:05 - 3:10	<input type="text"/>	<input type="text"/>	<input type="text"/>	<input type="text"/>
3:10 - 3:15	<input type="text"/>	<input type="text"/>	<input type="text"/>	<input type="text"/>
3:15 - 3:20	<input type="text"/>	<input type="text"/>	<input type="text"/>	<input type="text"/>
3:20 - 3:25	<input type="text"/>	<input type="text"/>	<input type="text"/>	<input type="text"/>
3:25 - 3:30	<input type="text"/>	<input type="text"/>	<input type="text"/>	<input type="text"/>
3:30 - 3:35	<input type="text"/>	<input type="text"/>	<input type="text"/>	<input type="text"/>
3:35 - 3:40	<input type="text"/>	<input type="text"/>	<input type="text"/>	<input type="text"/>
3:40 - 3:45	<input type="text"/>	<input type="text"/>	<input type="text"/>	<input type="text"/>
3:45 - 3:50	<input type="text"/>	<input type="text"/>	<input type="text"/>	<input type="text"/>
3:50 - 3:55	<input type="text"/>	<input type="text"/>	<input type="text"/>	<input type="text"/>
3:55 - 4:00	<input type="text"/>	<input type="text"/>	<input type="text"/>	<input type="text"/>

Recommendations**Observations**

Volume of Traffic (see Intersection Plan):

AM: ☐ Heavy ☐ Light ☐ Intermittant PM: ☐ Heavy ☐ Light ☐ Intermittant

Number of Crossing Pedestrians:

AM: North East South West PM: North East South West

Turning Traffic:

AM: ☐ Heavy ☐ Light ☐ Intermittant PM: ☐ Heavy ☐ Light ☐ Intermittant

Additional Comments/Conflicts

Pedestrian bridge rehabilitation is completed. Bridge is higher over the creek and access at either end of the bridge to the creek is more restricted. Many students use the bridge and the walkway through Camilla Park to access Munden Park PS both with and without parents. No issues observed.

Additional Recommendations

2c

Camilla Park at the bridge crossing Cookville Creek 8:00-8:30

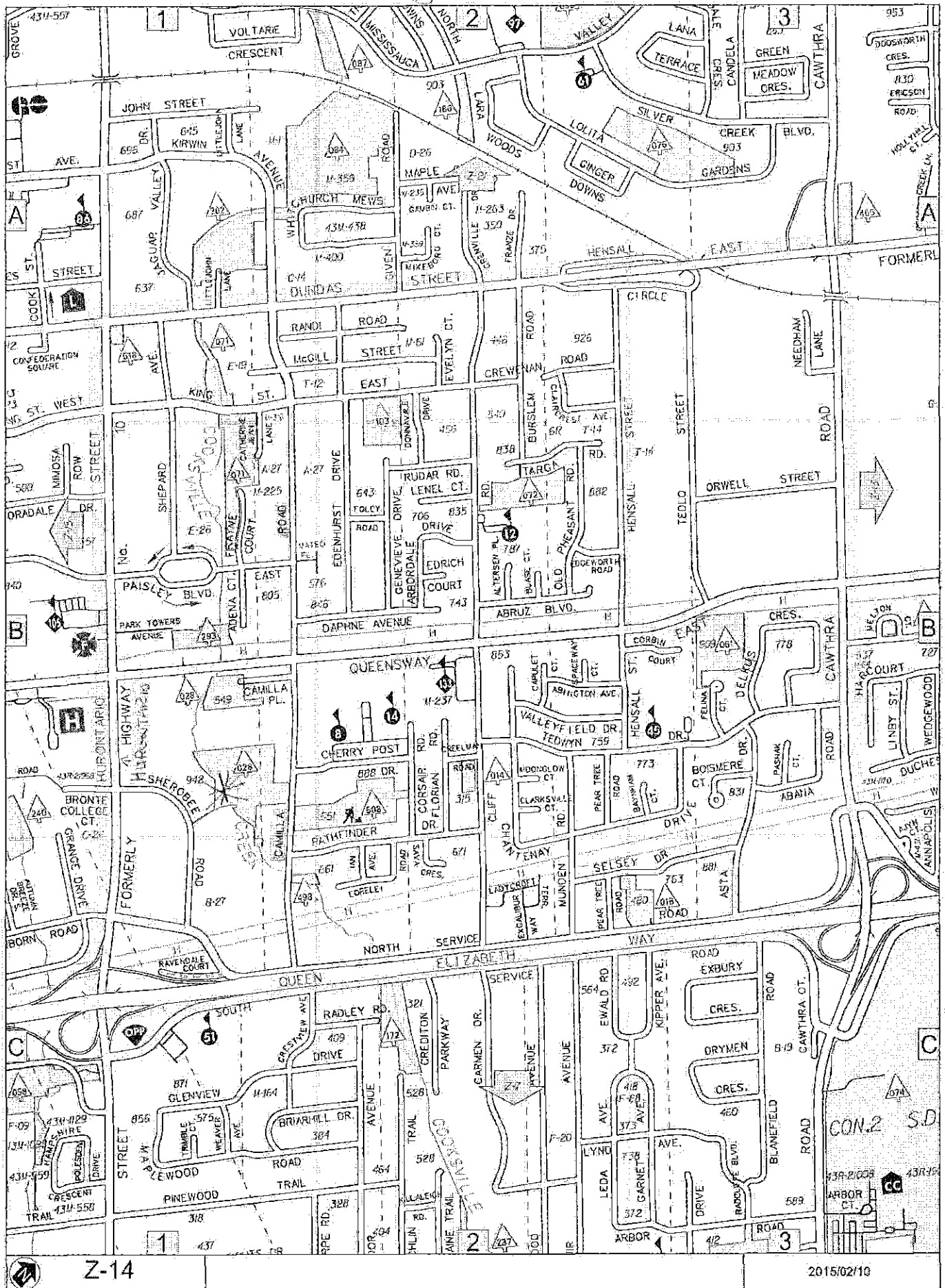

Z-14

2015/02/10

2d

W7

Heather McGuire

From: Sheelagh Duffin
Sent: 2015/11/24 4:51 PM
To: Jackett, Erla (erla.jackett@peelsb.com)
Cc: peter_westbrook; h.relf@; louiseann; Angie
Subject: Melo; Heather McGuire; Frank Buckley
RE: Munden Park Public School

Hello Ms. Jackett,

Thank you for your enquiry concerning the position of the Mississauga Traffic Safety Council concerning the Camilla Park route that requires students to use the bridge crossing Cooksville Creek to access Munden Park PS.

For clarification, Traffic Safety did not declare the route unsafe. As part of the walk about to assess the suitability of the routes students indicated on the School Walking Routes program surveys that they used to walk to school, the School walking Routes subcommittee did walk the Camilla Park route. However, it was decided that the route would not be signed as a suggested walking route as there was no fencing at the bridge across Cooksville Creek, thereby allowing easy access to the Creek. We subsequently were informed by the Parks Department that the creek did in fact flood and that there was some rehabilitation work that would be undertaken sometime in 2016. As always, it is a parents right to select the route their student uses to walk to school. Therefore, some students do, in fact, use that route to walk to school.

By copy of this email to Heather McGuire, I am requesting that she schedule a site inspection for Camilla Park at the bridge to determine if Traffic Safety does have issues with the Creek in its current state. The site inspection is to include STOPP. The time of the inspection would be 8:00 am to 8:30 am.

You will be notified of the time of the inspection once it is scheduled should you wish to attend.

Thank you.

Sheelagh

 MISSISSAUGA

Sheelagh Duffin
Supervisor, Crossing Guards
T 905-896-5167 | F 905-896-5166
sheelagh.duffin@mississauga.ca

City of Mississauga | Transportation and Works Department,
Works Operations and Maintenance Division
3185 Mavis Road
Mississauga ON L5C 1T7

Please consider the environment before printing.

From: Angie Melo
Sent: 2015/11/09 11:54 AM
To: Sheelagh Duffin
Cc: peter_westbrook; h.relf@; louiseann@
Subject: Munden Park Public School

2e

I received a call from Erla Jackett, Vice Principal, at Munden Park Public School following up on a Walk To School route inspection conducted last year, specifically, the Camila Park route.

Ms. Jackett stated that at that time, Peter Westbrook and another female representative of Traffic Safety, advised that the Camila Park route was unsafe and that it would not be recommended as a walking route. Ms. Jackett further stated that she has been in touch with Parks staff from the City of Mississauga and she was advised by them that the Park was in need of much repair.

Ms. Jackett has received several inquiries from parents with respect to the further distance their children need to walk to the school because the Camila Park route is "deemed unsafe", and as such, if TSC deems it unsafe, she will advocate to get these students school busing.

Sheelagh, please review for consideration of a site inspection to be conducted.

Thank you

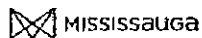

Angie Melo
Legislative Coordinator
T 905-615-3200 ext.5423
angie.melo@mississauga.ca

City of Mississauga | Corporate Services Department,
Legislative Services Division

Please consider the environment before printing.

Site Inspection Report



Traffic Safety Council
JAN 27 2016

Corporate Services
Office of the City Clerk

Site			
School:	St. Basil Catholic School	Address:	4235 Golden Orchard Dr. Mississauga ON L4W 3G1
School Times:	8:45 AM	3:15 PM	
Student Population:	265	Large & Small	
No. of School Buses:	77	Bused	
School:		Address:	
School Times:		AM	PM
Student Population:			
No. of School Buses:			
Location: (Please identify the location with reference to nearest intersection. Indicate nearest school and address)			
4235 Golden Orchard Dr. in front of St. Basil CS			
Date of Inspection:	2015	12	10
Inspection Time:	8:15 AM	3:15 PM	
Requested By:	parent/councillor		
Prepared By:	P. Westbrook/ V. Mansour		Request For:
		signage review, congestion issues	
Observers			
File Number:	RT.10	File Number:	RT.10
Ward:	Ward 3		
Observed By:	S. Duffin	<input type="checkbox"/> AM	<input type="checkbox"/> PM <input checked="" type="checkbox"/> AM & PM
Observed By:	V. Mansour	<input type="checkbox"/> AM	<input type="checkbox"/> PM <input checked="" type="checkbox"/> AM & PM
Observed By:	S. Beniuk	<input checked="" type="checkbox"/> AM	<input type="checkbox"/> PM <input type="checkbox"/> AM & PM
Observed By:	D. Lucas	<input type="checkbox"/> AM	<input checked="" type="checkbox"/> PM <input type="checkbox"/> AM & PM
Observed By:	T. Coulson	<input type="checkbox"/> AM	<input type="checkbox"/> PM <input checked="" type="checkbox"/> AM & PM
Observed By:	P. Westbrook	<input type="checkbox"/> AM	<input type="checkbox"/> PM <input checked="" type="checkbox"/> AM & PM
Details			
Weather Conditions:	AM: <input checked="" type="checkbox"/> Dry <input type="checkbox"/> Sunny <input type="checkbox"/> Rain <input type="checkbox"/> Snow <input type="checkbox"/> Other: 4C		
	PM: <input checked="" type="checkbox"/> Dry <input type="checkbox"/> Sunny <input type="checkbox"/> Rain <input type="checkbox"/> Snow <input type="checkbox"/> Other: 9C		
Type of Crossing:	<input type="checkbox"/> 4 Way Intersection <input type="checkbox"/> 3 Way Intersection <input checked="" type="checkbox"/> Midblock (i.e., not an intersection)		
Type of Control:	<input type="checkbox"/> Traffic Lights <input type="checkbox"/> Yield Signs <input checked="" type="checkbox"/> No Control		
	<input type="checkbox"/> Stop Signs (Traffic is stopped on one street only) <input type="checkbox"/> All Way Stop (Traffic is stopped in all directions)		
Site Conditions			
School Signs:	<input checked="" type="checkbox"/> School Area Signs <input type="checkbox"/> School Crossing Signs <input type="checkbox"/> Parking/Stopping Prohibition		
Posted Speed Limit:	<input checked="" type="checkbox"/> 40 km/hr <input type="checkbox"/> 50 km/h <input type="checkbox"/> 60 km/hr <input type="checkbox"/> Other:		
Visibility of Crossing Pedestrians:	<input type="checkbox"/> Poor <input type="checkbox"/> Fair <input checked="" type="checkbox"/> Good	Comments:	
Sight Obstructions:	<input type="checkbox"/> Hedges <input type="checkbox"/> Trees <input type="checkbox"/> Fences <input type="checkbox"/> Bus Shelter		
	<input type="checkbox"/> Newspaper Boxes <input type="checkbox"/> Other (Specify):		
Road Grade:	<input checked="" type="checkbox"/> Flat <input type="checkbox"/> Incline <input type="checkbox"/> Decline		
Road Geometrics:	<input checked="" type="checkbox"/> Straight <input type="checkbox"/> Curved	Comments:	
Road Width:	NA feet/metres	Curb to Curb:	feet/metres
		Curb to Median:	feet/metres
Road Conditions:	AM: <input checked="" type="checkbox"/> Dry <input type="checkbox"/> Wet <input type="checkbox"/> Snow Covered <input type="checkbox"/> Ice		
	PM: <input checked="" type="checkbox"/> Dry <input type="checkbox"/> Wet <input type="checkbox"/> Snow Covered <input type="checkbox"/> Ice		
Sidewalks:	<input type="checkbox"/> Not Present <input checked="" type="checkbox"/> North <input checked="" type="checkbox"/> South <input checked="" type="checkbox"/> East <input checked="" type="checkbox"/> West		
Proximity to School:	<input checked="" type="checkbox"/> In Front of <input type="checkbox"/> Within	feet/metres	
Route Survey:	<input type="checkbox"/> Shopping Area <input type="checkbox"/> Construction <input type="checkbox"/> Driveway <input type="checkbox"/> Parked Vehicle(s)		
	<input type="checkbox"/> Transit Bus Stop <input type="checkbox"/> Underpass Within	feet/metres	
		Other (specify):	
Comments / Conflicts:	SEE BELOW FOR ALL COMMENTS		

39

Crossing Guard Warrant Survey

Location: 4235 Golden Orchard Dr.

☐ Safe Gap TimeSafe Gap Time Calculation (if applicable): $\left(\frac{W}{3.5} + 4 \right)$ = sec.☐ Signalized Intersection turning traffic count**Morning Intervals**

Time (AM)	# of Peds	# of Conflicts	Gaps	# of Gaps
7:45 - 7:50	<input type="text"/>	<input type="text"/>	<input type="text"/>	<input type="text"/>
7:50 - 7:55	<input type="text"/>	<input type="text"/>	<input type="text"/>	<input type="text"/>
7:55 - 8:00	<input type="text"/>	<input type="text"/>	<input type="text"/>	<input type="text"/>
8:00 - 8:05	<input type="text"/>	<input type="text"/>	<input type="text"/>	<input type="text"/>
8:05 - 8:10	<input type="text"/>	<input type="text"/>	<input type="text"/>	<input type="text"/>
8:10 - 8:15	<input type="text"/>	<input type="text"/>	<input type="text"/>	<input type="text"/>
8:15 - 8:20	<input type="text"/>	<input type="text"/>	<input type="text"/>	<input type="text"/>
8:20 - 8:25	<input type="text"/>	<input type="text"/>	<input type="text"/>	<input type="text"/>
8:25 - 8:30	<input type="text"/>	<input type="text"/>	<input type="text"/>	<input type="text"/>
8:30 - 8:35	<input type="text"/>	<input type="text"/>	<input type="text"/>	<input type="text"/>
8:35 - 8:40	<input type="text"/>	<input type="text"/>	<input type="text"/>	<input type="text"/>
8:40 - 8:45	<input type="text"/>	<input type="text"/>	<input type="text"/>	<input type="text"/>
8:45 - 8:50	<input type="text"/>	<input type="text"/>	<input type="text"/>	<input type="text"/>
8:50 - 8:55	<input type="text"/>	<input type="text"/>	<input type="text"/>	<input type="text"/>
8:55 - 9:00	<input type="text"/>	<input type="text"/>	<input type="text"/>	<input type="text"/>

Afternoon Intervals

Time (PM)	# of Peds	# of Conflicts	Gaps	# of Gaps
2:45 - 2:50	<input type="text"/>	<input type="text"/>	<input type="text"/>	<input type="text"/>
2:50 - 2:55	<input type="text"/>	<input type="text"/>	<input type="text"/>	<input type="text"/>
2:55 - 3:00	<input type="text"/>	<input type="text"/>	<input type="text"/>	<input type="text"/>
3:00 - 3:05	<input type="text"/>	<input type="text"/>	<input type="text"/>	<input type="text"/>
3:05 - 3:10	<input type="text"/>	<input type="text"/>	<input type="text"/>	<input type="text"/>
3:10 - 3:15	<input type="text"/>	<input type="text"/>	<input type="text"/>	<input type="text"/>
3:15 - 3:20	<input type="text"/>	<input type="text"/>	<input type="text"/>	<input type="text"/>
3:20 - 3:25	<input type="text"/>	<input type="text"/>	<input type="text"/>	<input type="text"/>
3:25 - 3:30	<input type="text"/>	<input type="text"/>	<input type="text"/>	<input type="text"/>
3:30 - 3:35	<input type="text"/>	<input type="text"/>	<input type="text"/>	<input type="text"/>
3:35 - 3:40	<input type="text"/>	<input type="text"/>	<input type="text"/>	<input type="text"/>
3:40 - 3:45	<input type="text"/>	<input type="text"/>	<input type="text"/>	<input type="text"/>
3:45 - 3:50	<input type="text"/>	<input type="text"/>	<input type="text"/>	<input type="text"/>
3:50 - 3:55	<input type="text"/>	<input type="text"/>	<input type="text"/>	<input type="text"/>
3:55 - 4:00	<input type="text"/>	<input type="text"/>	<input type="text"/>	<input type="text"/>

Recommendations

SEE BELOW FOR COMPLETE LIST OF RECOMMENDATIONS

Observations

Volume of Traffic (see Intersection Plan):

AM: ☐ Heavy ☐ Light ☐ Intermittant PM: ☐ Heavy ☐ Light ☐ Intermittant

Number of Crossing Pedestrians:

AM: North East South West PM: North East South West

Turning Traffic:

AM: ☐ Heavy ☐ Light ☐ Intermittant PM: ☐ Heavy ☐ Light ☐ Intermittant

Additional Comments/Conflicts

Kiss & Ride is underutilized. Greybrook Drive opposite the school is signed "No Stopping Monday to Friday 8 - 4". Parents parked illegally both AM & PM for drop off and pick up. "No Parking" signs on the east side of Golden Orchard from Larny Ct to the school entrance driveway. Several school buses picked up students at the entrance driveway to St. Basil backing up traffic and 1 school bus dropped off 2 students.

Additional Recommendations

- 1) THAT TRANSPORTATION AND WORKS BE REQUESTED TO REVIEW ALL SIGNAGE IN THE SCHOOL AREA, CHANGING NO PARKING PROHIBITIONS AT SCHOOL ENTRANCE AND EXIT DRIVEWAY TO NO STOPPING, ADDING TO EXISTING NO U TURN SIGNS TO CREATE ZONES, REPLACE NO STOPPING OPPOSITE THE SCHOOL WITH NO STOPPING MONDAY TO FRIDAY 8 - 4 SEPTEMBER TO JUNE AND ADDING ADDITIONAL NO STOPPING SIGNAGE.
- 2) ONCE SIGNAGE IN PLACE:
 - THAT PARKING ENFORCEMENT BE REQUESTED TO ENFORCE NO STOPPING ZONES 8:20 - 8:45 am AND 3:05 - 3:30 pm
 - THAT PEEL REGIONAL POLICE BE REQUESTED TO ENFORCE NO U TURN SIGNAGE 8:20 - 8:45 AM AND 3:05 - 3:30 pm
- 3) THAT THE PRINCIPAL BE REQUESTED TO ADVISE PARENTS TO USE THE KISS AND RIDE IN THE AM
- 4) THAT THE PRINCIPAL BE REQUESTED TO PROVIDE SAFETY VESTS FOR KISS AND RIDE STAFF
- 5) THAT THE COUNCILLOR BE REQUESTED TO CONSIDER REMOVING THE EXISTING NO PARKING PROHIBITION ON THE EAST SIDE OF GOLDEN ORCHARD DRIVE BETWEEN LARNY COURT AND THE SCHOOL EXIT DRIVEWAY.
- 6) THAT STOPR BE REQUESTED TO RELOCATE THE SCHOOL BUS STOPS CURRENTLY LOCATED AT THE SOUTH LEG OF GREYBROOK CRESCENT AND THE ST. BASIL CATHOLIC SCHOOL ENTRANCE DRIVEWAY

3c

4235 GOLDEN ORCHARD 8:15-8:45 and 3:15-3:45

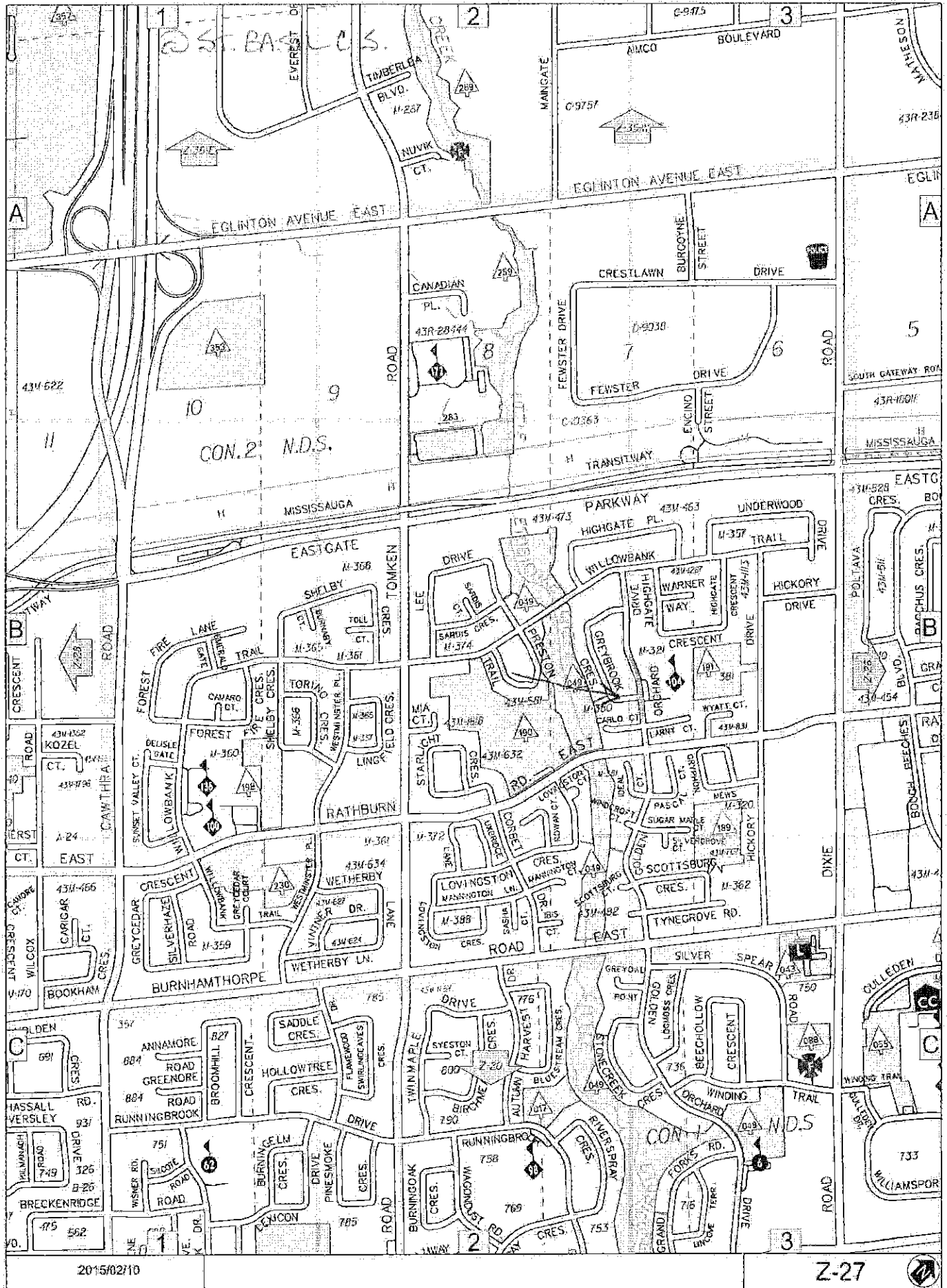

265
STUDENTS
77 MEAS
BUSSED
1316 BUS
25 SMALL
BUSSES

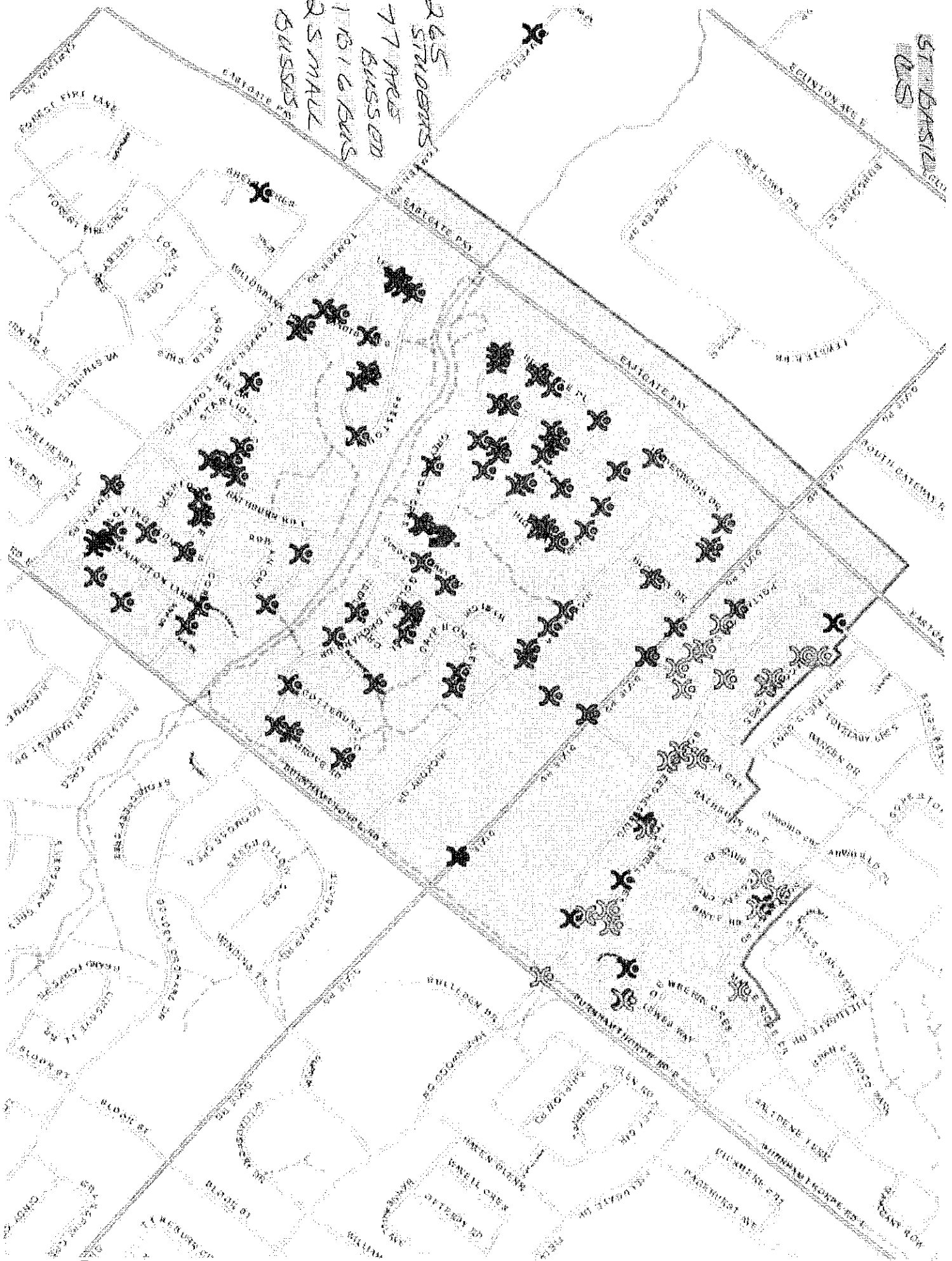

PE

Site Inspection Report



Traffic Safety Council
JAN 27 2016

Corporate Services
Office of the City Clerk

Site	
School: Brian W. Fleming Public School	Address: 3255 Havenwood Dr Mississauga ON L4X 2M2
School Times: 9:00 AM 3:20 PM	Student Population: 496
No. of School Buses: 16	Based
School:	Address:
School Times:	Student Population:
No. of School Buses:	

Location: (Please identify the location with reference to nearest intersection. Indicate nearest school and address) IFOS @ 3255 Havenwood Dr. (Brian W. Fleming PS)			
Date of Inspection: 2015 12 15	Inspection Time: 8:30 AM 3:20 PM	Requested By: resident/Councillor	
Prepared By: P. Westbrook	Request For: Congestion & parking infraction reviews		

Observers	
File Number: RT.10	Ward: Ward 3
Observed By: S. Duffin	<input type="checkbox"/> AM <input type="checkbox"/> PM <input checked="" type="checkbox"/> AM & PM
Observed By: M. Sherwani	<input checked="" type="checkbox"/> AM <input type="checkbox"/> PM <input type="checkbox"/> AM & PM
Observed By: S. Kumra	<input type="checkbox"/> AM <input checked="" type="checkbox"/> PM <input type="checkbox"/> AM & PM
Observed By: P. Westbrook	<input type="checkbox"/> AM <input type="checkbox"/> PM <input checked="" type="checkbox"/> AM & PM
Observed By: D. Yaunan	<input type="checkbox"/> AM <input type="checkbox"/> PM <input checked="" type="checkbox"/> AM & PM
Observed By:	<input type="checkbox"/> AM <input type="checkbox"/> PM <input type="checkbox"/> AM & PM

Details	
Weather Conditions:	AM: <input checked="" type="checkbox"/> Dry <input type="checkbox"/> Sunny <input type="checkbox"/> Rain <input type="checkbox"/> Snow <input type="checkbox"/> Other: 3C
	PM: <input checked="" type="checkbox"/> Dry <input type="checkbox"/> Sunny <input type="checkbox"/> Rain <input type="checkbox"/> Snow <input type="checkbox"/> Other: 8C
Type of Crossing:	<input type="checkbox"/> 4 Way Intersection <input type="checkbox"/> 3 Way Intersection <input checked="" type="checkbox"/> Midblock (i.e., not an intersection)
Type of Control:	<input type="checkbox"/> Traffic Lights <input type="checkbox"/> Yield Signs <input checked="" type="checkbox"/> No Control
	<input type="checkbox"/> Stop Signs (Traffic is stopped on one street only) <input type="checkbox"/> All Way Stop (Traffic is stopped in all directions)

Site Conditions	
School Signs:	<input checked="" type="checkbox"/> School Area Signs <input type="checkbox"/> School Crossing Signs <input checked="" type="checkbox"/> Parking/Stopping Prohibition
Posted Speed Limit:	<input checked="" type="checkbox"/> 40 km/hr <input type="checkbox"/> 50 km/h <input type="checkbox"/> 60 km/hr <input type="checkbox"/> Other:
Visibility of Crossing Pedestrians:	<input type="checkbox"/> Poor <input type="checkbox"/> Fair <input checked="" type="checkbox"/> Good Comments:
Sight Obstructions:	<input type="checkbox"/> Hedges <input type="checkbox"/> Trees <input type="checkbox"/> Fences <input type="checkbox"/> Bus Shelter
	<input type="checkbox"/> Newspaper Boxes <input type="checkbox"/> Other (Specify):
Road Grade:	<input checked="" type="checkbox"/> Flat <input type="checkbox"/> Incline <input type="checkbox"/> Decline
Road Geometrics:	<input type="checkbox"/> Straight <input checked="" type="checkbox"/> Curved Comments:
Road Width:	29 feet/metres Curb to Curb: feet/metres Curb to Median: feet/metres
Road Conditions:	AM: <input checked="" type="checkbox"/> Dry <input type="checkbox"/> Wet <input type="checkbox"/> Snow Covered <input type="checkbox"/> Ice
	PM: <input checked="" type="checkbox"/> Dry <input type="checkbox"/> Wet <input type="checkbox"/> Snow Covered <input type="checkbox"/> Ice
Sidewalks:	<input type="checkbox"/> Not Present <input type="checkbox"/> North <input type="checkbox"/> South <input type="checkbox"/> East <input type="checkbox"/> West
Proximity to School:	<input checked="" type="checkbox"/> In Front of <input type="checkbox"/> Within feet/metres
Route Survey:	<input type="checkbox"/> Shopping Area <input type="checkbox"/> Construction <input type="checkbox"/> Driveway <input type="checkbox"/> Parked Vehicle(s)
	<input type="checkbox"/> Transit Bus Stop <input type="checkbox"/> Underpass Within feet/metres Other (specify):
Comments / Conflicts:	ALL TRAFFIC SCHOOL RELATED AM - LINED UP TO TURN INTO KISS & RIDE FROM 8:55 - 9:00AM AND DISMISSAL FROM 3:15 - 3:20PM

49

Crossing Guard Warrant Survey

Location: 3255 HAVENWOOD DRIVE

☒ Safe Gap TimeSafe Gap Time Calculation (if applicable): $\left(\frac{W}{3.5} + 4\right)$ 12 = sec.☐ Signalized Intersection turning traffic count**Morning Intervals**

Time (AM)	# of Peds	# of Conflicts	Gaps	# of Gaps
7:45 - 7:50				
7:50 - 7:55				
7:55 - 8:00				
8:00 - 8:05				
8:05 - 8:10				
8:10 - 8:15				
8:15 - 8:20				
8:20 - 8:25				
8:25 - 8:30				
8:30 - 8:35			///, 22, 35, ///, 33, 31, 24, /, 41, 17, /	13
8:35 - 8:40			17, /, 20, /, 20, /, 32, 20, 34, /, 46, 38	14
8:40 - 8:45			13, 29, /, 26, /, 17, 68, 38, //, 28, /, 21	18
8:45 - 8:50	///, //		35, 26, 69, ///, 16, 17, ///	11
8:50 - 8:55	///, //		106, 40, //, 22, 20, //, 54, /, 18, /, 31, /, 16, /, 21, /	22
8:55 - 9:00	/, //		///, 19, 18, ///, ///, 21, 24, 12, ///, ///	6

Afternoon Intervals

Time (PM)	# of Peds	# of Conflicts	Gaps	# of Gaps
2:45 - 2:50				
2:50 - 2:55				
2:55 - 3:00				
3:00 - 3:05				
3:05 - 3:10				
3:10 - 3:15				
3:15 - 3:20	///, ///		///, 12, 30, /, 18, //	4
3:20 - 3:25			//, 13, 19, ///, 30, /, 18, 45, 16	9
3:25 - 3:30			75, 12, /, 47, 36, //, 63, ///, 33, /, 35	22
3:30 - 3:35			16, 93, 28, /, 97	18
3:35 - 3:40				
3:40 - 3:45				
3:45 - 3:50				
3:50 - 3:55				
3:55 - 4:00				

Recommendations

- 1) THAT PARKING ENFORCEMENT BE REQUESTED TO MONITOR FROM 3:10 - 3:45 PM
 2) THAT TRANSPORTATION AND WORKS BE REQUESTED TO REVIEW SIGNAGE IN THE SCHOOL AREA.

Observations

Volume of Traffic (see Intersection Plan):

AM: ☐ Heavy ☒ Light ☐ Intermittant PM: ☐ Heavy ☒ Light ☐ Intermittant

Number of Crossing Pedestrians:

AM: North ☐ East ☐ 8 South ☐ West ☐ PM: North ☐ East ☐ 4 South ☐ West ☐

Turning Traffic:

AM: ☐ Heavy ☐ Light ☐ Intermittant PM: ☐ Heavy ☐ Light ☐ Intermittant

4c

Heather McGuire

From: Sheelagh Duffin
Sent: 2015/12/04 4:26 PM
To: Chris Fonseca
Cc: Angie Melo; Heather McGuire; David Marcotte (david.marcotte@peelsb.com); Kristine Gillingham (peter_westbrook@hotmail.com)
Subject: RE: ACTION - Kristine Gillingham (Traffic issues at Brian Fleming School)

Councillor Fonseca,

By copy of this email to Heather McGuire I am requesting that she schedule a site inspection and safety review for the students of Brian W. Fleming PS to address issues of congestion and the number of parking infractions. The times of the inspection will be 8:30 – 9:00 am & 3:20 – 3:50 pm.

We are also copying Dave Marcotte of the Peel Board to request that he attend as well to address issues with the Kiss and Ride.

Your office, as well as Ms. Gillingham will be notified of the date of the inspection should you wish to attend.

Thank you for bringing this matter to our attention.

Sheelagh

 Mississauga

Sheelagh Duffin
Supervisor, Crossing Guards
T 905-896-5167 | F 905-896-5166
sheelagh.duffin@mississauga.ca

City of Mississauga | Transportation and Works Department
Works Operations and Maintenance Division
3185 Mavis Road
Mississauga ON L5C 1T7

Please consider the environment before printing.

From: Angie Melo
Sent: 2015/12/04 8:44 AM
To: Sheelagh Duffin
Subject: FW: ACTION - Kristine Gillingham (Traffic Issues at Brian Fleming School)

Please review for consideration for a site inspection.

 Mississauga

Angie Melo
Legislative Coordinator
T 905-615-3200 ext.5423
angie.melo@mississauga.ca

City of Mississauga | Corporate Services Department,
Legislative Services Division

Please consider the environment before printing.

From: Chris Fonseca
Sent: 2015/12/04 8:07 AM
To: Angie Melo
Subject: ACTION - Kristine Gillingham (Traffic issues at Brian Fleming School)

Good Morning Angie,

Please see Mrs. Gillingham's e-mail below. The Councillor would like this a site inspection be scheduled for this location.

Thank you,
Linda

On Dec 3, 2015, at 1:08 PM, Kristine Gillingham <Kristine.Gillingham@mississauga.ca>

I am writing to you as a concerned parent, frustrated driver and vocal tax payer.

I know I'm not alone in these concerns, and I'm sure you have received other enquiries.

My issues/concerns stem from the parking issues/traffic congestion on Havenwood Drive in and around Brian W Fleming Public School. The parents/caregivers who are responsible for pick up and drop off of students at this school have little regard for parking by-laws on that street, the safety of the children going to and from this school and the hundreds of others trying to use the street PROPERLY.

These drivers have no regard for the No Stopping area on the street, they park in or block the driveways on the street, they double park and block the street making it almost impossible for people like me to get home. If there was another route for me to get home I would take it. Those trying to make the turn into the Kiss n Ride on school property line up northbound and southbound on Havenwood blocking the flow of traffic.

Their concern is only convenience for themselves.

As a parent, I would love to see the privilege of the Kiss n Ride restricted to only school buses. If the city wants to "cash in" they could post a Parking Enforcement Officer their on a daily basis or a Police Officer to remind these drivers of what they're doing wrong.

My children attend St Alfred Catholic School that is located just north of this school, and on a daily basis I park legally and WALK to pick my children up. Their safety is paramount to me, not the proximity of my car to the front door.

I'm asking for your assistance in calming the traffic in the neighbourhood and waking up those citizens who are abusing the privilege.

I thank you in advance.

4e

Email: kristine.gillingham.

It's better to lend a hand than point a finger.

This e-mail (including any attachments) may contain PRIVILEGED and CONFIDENTIAL INFORMATION only for use of the Addressee(s). If you are not the intended recipient of this e-mail or the employee or agent responsible for delivering it to the intended recipient, you are hereby notified that any dissemination or copying of this e-mail is strictly prohibited. If you have received this e-mail in error, please immediately notify me by telephone or e-mail to arrange for the return or destruction of this document. Thank you.

This e-mail (including any attachments) may contain PRIVILEGED and CONFIDENTIAL INFORMATION only for use of the Addressee(s). If you are not the intended recipient of this e-mail or the employee or agent responsible for delivering it to the intended recipient, you are hereby notified that any dissemination or copying of this e-mail is strictly prohibited. If you have received this e-mail in error, please immediately notify me by telephone or e-mail to arrange for the return or destruction of this document. Thank you.

Site Inspection Report



Traffic Safety Council

JAN 27 2016

Corporate Services
Office of the City Clerk

Site	
School: St. Christopher Catholic School	Address: 1195 Clarkson Rd N Mississauga On L5J 2W1
School Times: 8:15 AM 2:45 PM	Student Population: 427
No. of School Buses: 324	Based
School: Hillcrest Middle School	Address: 1530 Springwell Ave Mississauga ON L5J 3H8
School Times: 9:00 AM 3:05 PM	Student Population: 499
No. of School Buses: 321	Based
Location: (Please identify the location with reference to nearest intersection. Indicate nearest school and address) Clarkson Rd & Birchwood Dr.	
Date of Inspection: 2016 01 11	Inspection Time: 7:50 AM 2:45 PM
Requested By: Councillor Ras	
Prepared By: A. Liya	Request For: site inspection & safety review

Observers	
File Number: RT.10	Ward: Ward 2
Observed By: S. Duffin	<input type="checkbox"/> AM <input type="checkbox"/> PM <input checked="" type="checkbox"/> AM & PM
Observed By: P. Westbrook	<input checked="" type="checkbox"/> AM <input type="checkbox"/> PM <input type="checkbox"/> AM & PM
Observed By: S. Beniuk	<input type="checkbox"/> AM <input type="checkbox"/> PM <input checked="" type="checkbox"/> AM & PM
Observed By: D. Suess	<input type="checkbox"/> AM <input type="checkbox"/> PM <input checked="" type="checkbox"/> AM & PM
Observed By: A. Liya	<input type="checkbox"/> AM <input type="checkbox"/> PM <input checked="" type="checkbox"/> AM & PM
Observed By: Councillor Ras; Y. Dubajic (parent)	<input checked="" type="checkbox"/> AM <input type="checkbox"/> PM <input type="checkbox"/> AM & PM

Details	
Weather Conditions:	AM: <input checked="" type="checkbox"/> Dry <input type="checkbox"/> Sunny <input type="checkbox"/> Rain <input type="checkbox"/> Snow <input type="checkbox"/> Other: -9C
	PM: <input type="checkbox"/> Dry <input checked="" type="checkbox"/> Sunny <input type="checkbox"/> Rain <input type="checkbox"/> Snow <input type="checkbox"/> Other: -7C
Type of Crossing:	<input type="checkbox"/> 4 Way Intersection <input checked="" type="checkbox"/> 3 Way Intersection <input type="checkbox"/> Midblock (i.e., not an intersection)
Type of Control:	<input type="checkbox"/> Traffic Lights <input type="checkbox"/> Yield Signs <input type="checkbox"/> No Control
	<input checked="" type="checkbox"/> Stop Signs (Traffic is stopped on one street only) <input type="checkbox"/> All Way Stop (Traffic is stopped in all directions)

Site Conditions	
School Signs:	<input type="checkbox"/> School Area Signs <input type="checkbox"/> School Crossing Signs <input type="checkbox"/> Parking/Stopping Prohibition
Posted Speed Limit:	<input type="checkbox"/> 40 km/hr <input checked="" type="checkbox"/> 50 km/h <input type="checkbox"/> 60 km/hr <input type="checkbox"/> Other:
Visibility of Crossing Pedestrians:	<input type="checkbox"/> Poor <input type="checkbox"/> Fair <input checked="" type="checkbox"/> Good Comments:
Sight Obstructions:	<input type="checkbox"/> Hedges <input type="checkbox"/> Trees <input type="checkbox"/> Fences <input type="checkbox"/> Bus Shelter
	<input type="checkbox"/> Newspaper Boxes <input type="checkbox"/> Other (Specify):
Road Grade:	<input checked="" type="checkbox"/> Flat <input type="checkbox"/> Incline <input type="checkbox"/> Decline
Road Geometrics:	<input checked="" type="checkbox"/> Straight <input type="checkbox"/> Curved Comments:
Road Width:	feet/metres Curb to Curb: 8.1 feet/metres Curb to Median: feet/metres
Road Conditions:	AM: <input checked="" type="checkbox"/> Dry <input type="checkbox"/> Wet <input type="checkbox"/> Snow Covered <input type="checkbox"/> Ice
	PM: <input checked="" type="checkbox"/> Dry <input type="checkbox"/> Wet <input type="checkbox"/> Snow Covered <input type="checkbox"/> Ice
Sidewalks:	<input type="checkbox"/> Not Present <input type="checkbox"/> North <input type="checkbox"/> South <input type="checkbox"/> East <input checked="" type="checkbox"/> West
Proximity to School:	<input type="checkbox"/> In Front of <input type="checkbox"/> Within feet/metres
Route Survey:	<input type="checkbox"/> Shopping Area <input type="checkbox"/> Construction <input type="checkbox"/> Driveway <input type="checkbox"/> Parked Vehicle(s)
	<input type="checkbox"/> Transit Bus Stop <input type="checkbox"/> Underpass Within feet/metres Other (specify):
Comments / Conflicts:	NO CONFLICTS OBSERVED

59

Site Inspection Report



Traffic Safety Council

JAN 27 2016

Corporate Services
Office of the City Clerk

Site	
School: Whiteoaks Public School	Address: 1690 Mazo Cres Mississauga On L5J 1Y8
School Times: 9:10 AM 3:40 PM	Student Population: 649
No. of School Buses: 391	Bused
School: Lorne Park Secondary School	Address: 1324 Lorne Park Rd Mississauga ON L5H 3B1
School Times: 8:20 AM 2:35 PM	Student Population: 1005
No. of School Buses: 85	Bused

Location: (Please identify the location with reference to nearest intersection. Indicate nearest school and address)

Clarkson Rd & Birchwood Dr.

Date of Inspection: 2016 01 11	Inspection Time: 7:50 AM 2:45 PM	Requested By: Councillor Ras
Prepared By:	Request For: site inspection & safety review	

Observers

File Number: RT.10	File Number: RT.10	Ward: Ward 2
Observed By: S. Duffin	<input type="checkbox"/> AM <input type="checkbox"/> PM <input checked="" type="checkbox"/> AM & PM	
Observed By: P. Westbrook	<input checked="" type="checkbox"/> AM <input type="checkbox"/> PM <input type="checkbox"/> AM & PM	
Observed By: S. Benjuk	<input type="checkbox"/> AM <input type="checkbox"/> PM <input checked="" type="checkbox"/> AM & PM	
Observed By: D. Suess	<input type="checkbox"/> AM <input type="checkbox"/> PM <input checked="" type="checkbox"/> AM & PM	
Observed By: A. Liya	<input type="checkbox"/> AM <input type="checkbox"/> PM <input checked="" type="checkbox"/> AM & PM	
Observed By: Councillor Ras, Y. Dubajic (parent)	<input checked="" type="checkbox"/> AM <input type="checkbox"/> PM <input type="checkbox"/> AM & PM	

Details

Weather Conditions:	AM: <input type="checkbox"/> Dry <input type="checkbox"/> Sunny <input type="checkbox"/> Rain <input type="checkbox"/> Snow <input type="checkbox"/> Other:
PM: <input type="checkbox"/> Dry <input type="checkbox"/> Sunny <input type="checkbox"/> Rain <input type="checkbox"/> Snow <input type="checkbox"/> Other:	
Type of Crossing:	<input type="checkbox"/> 4 Way Intersection <input type="checkbox"/> 3 Way Intersection <input type="checkbox"/> Midblock (i.e., not an intersection)
Type of Control:	<input type="checkbox"/> Traffic Lights <input type="checkbox"/> Yield Signs <input type="checkbox"/> No Control
	<input type="checkbox"/> Stop Signs (Traffic is stopped on one street only) <input type="checkbox"/> All Way Stop (Traffic is stopped in all directions)

Site Conditions

School Signs:	<input type="checkbox"/> School Area Signs <input type="checkbox"/> School Crossing Signs <input type="checkbox"/> Parking/Stopping Prohibition
Posted Speed Limit:	<input type="checkbox"/> 40 km/hr <input type="checkbox"/> 50 km/h <input type="checkbox"/> 60 km/hr <input type="checkbox"/> Other:
Visibility of Crossing Pedestrians:	<input type="checkbox"/> Poor <input type="checkbox"/> Fair <input type="checkbox"/> Good Comments:
Sight Obstructions:	<input type="checkbox"/> Hedges <input type="checkbox"/> Trees <input type="checkbox"/> Fences <input type="checkbox"/> Bus Shelter
	<input type="checkbox"/> Newspaper Boxes <input type="checkbox"/> Other (Specify):
Road Grade:	<input type="checkbox"/> Flat <input type="checkbox"/> Incline <input type="checkbox"/> Decline
Road Geometrics:	<input type="checkbox"/> Straight <input type="checkbox"/> Curved Comments:
Road Width:	feet/metres Curb to Curb: feet/metres Curb to Median: feet/metres
Road Conditions:	AM: <input type="checkbox"/> Dry <input type="checkbox"/> Wet <input type="checkbox"/> Snow Covered <input type="checkbox"/> Ice
PM: <input type="checkbox"/> Dry <input type="checkbox"/> Wet <input type="checkbox"/> Snow Covered <input type="checkbox"/> Ice	
Sidewalks:	<input type="checkbox"/> Not Present <input type="checkbox"/> North <input type="checkbox"/> South <input type="checkbox"/> East <input type="checkbox"/> West
Proximity to School:	<input type="checkbox"/> In Front of <input type="checkbox"/> Within feet/metres
Route Survey:	<input type="checkbox"/> Shopping Area <input type="checkbox"/> Construction <input type="checkbox"/> Driveway <input type="checkbox"/> Parked Vehicle(s)
	<input type="checkbox"/> Transit Bus Stop <input type="checkbox"/> Underpass Within feet/metres Other (specify):
Comments / Conflicts:	

Crossing Guard Warrant Survey

Location: Clarkson Rd & Birchwood Dr.

☒ Safe Gap Time Safe Gap Time Calculation (if applicable): $\left(\frac{W}{3.5} + 4 \right)$ 12 = sec.
☐ Signalized Intersection turning traffic count

Morning Intervals

Time (AM)	# of Peds	# of Conflicts	Gaps	# of Gaps
7:45 - 7:50				
7:50 - 7:55			,16, ,12,18, ,25, ,21	6
7:55 - 8:00			28, ,15, ,30, ,20, ,18, ,15, ,22, ,13	10
8:00 - 8:05			,21, ,18, , ,23,	3
8:05 - 8:10			13, , , ,17, ,12	3
8:10 - 8:15			,18, , ,13,	2
8:15 - 8:20			,20, , ,13, ,16, ,16, ,15, ,22, ,18,	7
8:20 - 8:25			, ,12,13, ,19	3
8:25 - 8:30			16, ,32, ,21, ,16,17,25,24, ,19,	11
8:30 - 8:35			,18, ,25, ,18, ,14, ,16,22,	7
8:35 - 8:40			,14, ,26, ,13, ,27, ,35,28, ,16, ,14,	12
8:40 - 8:45			,20, ,14, ,33, ,12, ,21, ,28	8
8:45 - 8:50			23, ,14, ,38,15, ,14, ,14, ,14, ,20	10
8:50 - 8:55			13, ,15, ,15, ,14,	4
8:55 - 9:00				

Afternoon Intervals

Time (PM)	# of Peds	# of Conflicts	Gaps	# of Gaps
2:45 - 2:50			,35, ,17, ,15, ,23, ,22,12, ,	7
2:50 - 2:55			,18, ,17, ,21,	3
2:55 - 3:00			,30, , ,15, ,12,	4
3:00 - 3:05			12, ,25, ,17, ,18,22,	6
3:05 - 3:10			,12, ,22, ,12, ,14, ,19, ,17, ,24, ,14,	9
3:10 - 3:15			89, ,26, ,16,12, ,21, ,12, ,14, ,16, ,13	17
3:15 - 3:20			,43, ,29, ,17, ,19,	7
3:20 - 3:25			20,14,15,12, ,15, ,13, ,17, ,23, ,40,12, ,16	13
3:25 - 3:30			24, ,20, ,24, ,12,15,17, ,12, ,38,	12
3:30 - 3:35				
3:35 - 3:40				
3:40 - 3:45				
3:45 - 3:50				
3:50 - 3:55				
3:55 - 4:00				

Recommendations

SEE BELOW FOR COMPLETE LIST OF RECOMMENDATIONS

Observations

Volume of Traffic (see Intersection Plan):
 AM: ☐ Heavy ☐ Light ☒ Intermittant PM: ☐ Heavy ☒ Light ☐ Intermittant

Number of Crossing Pedestrians:
 AM: North East South 0 West PM: North East South 2 West

Turning Traffic:
 AM: ☐ Heavy ☐ Light ☐ Intermittant PM: ☐ Heavy ☐ Light ☐ Intermittant

Additional Comments/Conflicts**Additional Recommendations**

- 1) THAT THE WARRANTS FOR A CROSSING GUARD HAVE NOT BEEN MET. ADEQUATE GAPS IN TRAFFIC FOR PEDESTRIANS TO CROSS CLARKSON ROAD. NO STUDENTS CROSSED AM AND 2 STUDENTS CROSSED PM.
- 2) THAT COUNCILLOR RAS BE REQUESTED TO CONDUCT A SURVEY OF RESIDENTS LIVING ON THE EAST SIDE OF CLARKSON ROAD TO DETERMINE IF THEY ARE IN FAVOUR OF A SIDEWALK BEING CONSTRUCTED ON THE EAST SIDE OF CLARKSON ROAD.
- 3) THAT TRANSPORTATION AND WORKS BE REQUESTED TO CONDUCT A SPEED STUDY ON CLARKSON ROAD IN THE AREA OF BIRCHWOOD DRIVE IN ORDER TO DETERMINE IF THERE IS SPEEDING OCCURRING AND IF TRAFFIC CALMING MEASURES SHOULD BE RECOMMENDED.

BIRCHWOOD DR + CLARKSON RD 7:50-8:55 and 245-3:30

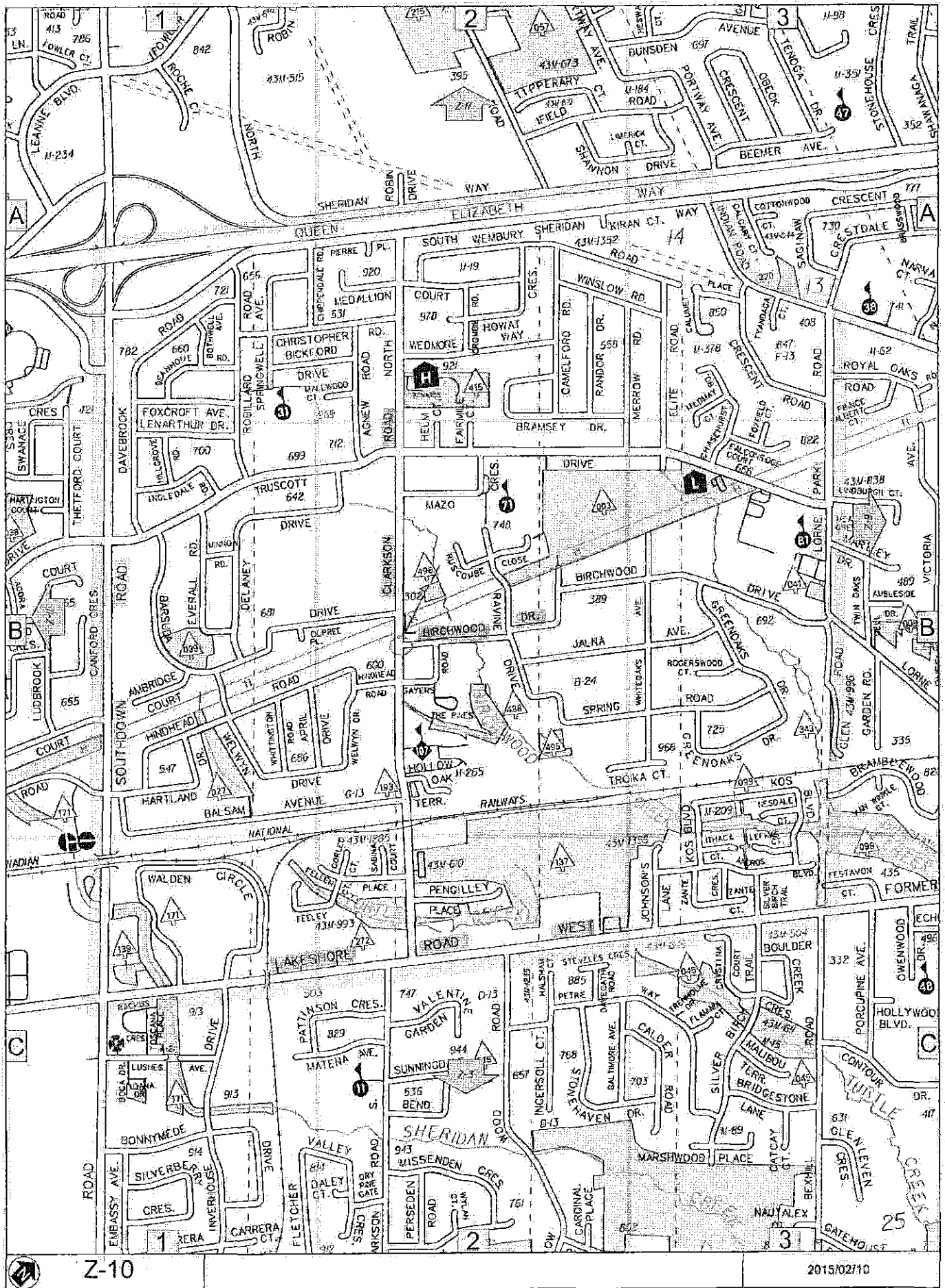

5e

W2

Jan 11 / 16.

Heather McGuire

From: Sheelagh Duffin
Sent: 2015/12/02 4:11 PM
To: Jennifer Waye
Cc: Helena Francisco; Angie Melo; Yvette.Dubajic@; Peter Westbrook
(peter_westbrook@); Andy Bate; Heather McGuire
Subject: RE: Site Inspection Reports - St. Christopher Catholic School

Hello,

By copy of this email to Heather McGuire I am requesting that she schedule a site inspection and safety review ~~7:50-8:55 am~~ and ~~2:45-3:30 pm~~ at Birchwood Drive and Clarkson Road for Monday, January 11. These times should cover the busiest pedestrian commuter times and all 4 area schools, St. Christopher, Hillcrest SR PS, Lorne Park SS, and Whiteoaks PS school entry and dismissal times.

Thank you.

Have a great day!

Sheelagh

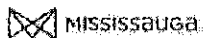

Sheelagh Duffin
Supervisor, Crossing Guards
T 905-896-5167 | F 905-896-5166
sheelagh.duffin@mississauga.ca

City of Mississauga | Transportation and Works Department,
Works Operations and Maintenance Division
3185 Mavis Road
Mississauga ON L5C 1T7

Please consider the environment before printing.

From: Jennifer Waye
Sent: 2015/12/02 3:23 PM
To: Sheelagh Duffin
Cc: Helena Francisco; Angie Melo; Yvette.Dubajic@; Peter Westbrook (peter_westbrook@); Andy Bate
Subject: RE: Site Inspection Reports - St. Christopher Catholic School

Good afternoon Sheelagh,

Thank you for the offer of a further site inspection. Councillor Ras would be pleased to attend and provide input.

Dates that she would be available to attend are:

January 11th
January 12th
January 22nd

Please let us know at your earliest convenience when this will be scheduled and timing, so that we can get it into the Councillor's calendar.

Cheers,

Jennifer Wayer
Administrative Assistant to
Councillor Karen Ras, Ward 2



"This e-mail may not be forwarded to anyone for any reason without express written permission of the author."

From: Sheelagh Duffin
Sent: 2015/11/30 3:21 PM
To: Karen Ras
Cc: Helena Francisco; Jennifer Wayer; Angie Melo; Yvette Dubajic; Peter Westbrook
(peter_westbrook)
Subject: RE: Site Inspection Reports - St. Christopher Catholic School

Councillor Ras,

Thank you for forwarding Mrs. Dubajic's email.

Traffic Safety Council would like to schedule a further site inspection at Birchwood Drive and Clarkson Road to include the Councillor, Mrs. Dubajic, and Operations staff to explore other options for improving crossing Clarkson Road at this location.

Kindly advise a date that the Councillor would be available to attend.

Thank you. We look forward to hearing from you as to your availability.

Sheelagh
5167



Sheelagh Duffin
Supervisor, Crossing Guards
T 905-896-5167 | F 905-896-5166
sheelagh.duffin@mississauga.ca

City of Mississauga | Transportation and Works Department,
Works Operations and Maintenance Division
3185 Mavis Road
Mississauga ON L5C 1T7

Please consider the environment before printing.

5g

From: Jennifer Waye
Sent: 2015/11/27 8:08 AM
To: Sheelagh Duffin; Angie Melo
Cc: Karen Ras; Helena Francisco
Subject: FW: Site Inspection Reports - St. Christopher Catholic School

Good morning Sheelagh & Angie,

Do we have anything further we can do for Mrs. Dubajic? She sent an unanswered email on November 1st.

Cheers,

Jennifer Waye
Administrative Assistant to
Councillor Karen Ras, Ward 2

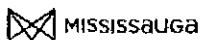

Please consider the environment before printing this e-mail.

"This e-mail may not be forwarded to anyone for any reason without express written permission of the author."

From: Dubajic, Yvette [<mailto:Yvette.Dubajic>]
Sent: 2015/11/26 5:41 PM
To: Karen Ras
Cc: Helena Francisco
Subject: RE: Site Inspection Reports - St. Christopher Catholic School

Karen,

How refreshing to see someone follow up! Truly appreciate your ongoing support.

I responded to Sheelagh and copied everyone on November 1st and haven't received any acknowledgement since then - crickets. See my email below.

I'd like the Traffic Safety Council to explain how any pedestrian crossing Clarkson from our neighbourhood is safe. Waiting for a gap in traffic may work for some but that is not a solution for kids at any part of the day – not just school hours. Who else can I speak to?

Sheelagh,

Thank-you for your response.

I feel like there is a bit of a misunderstanding. My enquiry is not just about getting a crossing guard. It's also about getting a cross walk so that ALL pedestrians have a safe way to cross Clarkson Rd to access the sidewalk on the west side. As for the site inspection, I could have told you in advance that it would have failed due to the fact that parents have made other arrangements over the years for their children to get to school like driving them, car pooling or fill up the bus, which is exactly what we have done. As I'm sure you are aware, we pay robust property taxes in this neighbourhood and yet we do not feel safe crossing Clarkson Rd in order to access the sidewalk. How would the Traffic Safety Council recommend children access the sidewalk even outside of school hours? Wait for a gap in traffic and take a chance?

Please advise how I can escalate my concern and to whom I should reach out to.

Thank-you

5h

Yvette Dubajic

 Please consider the environment before printing this email.

From: Karen Ras [<mailto:Karen.Ras@mississauga.ca>]
Sent: Thursday, November 26, 2015 11:46 AM
To: Dubajic, Yvette
Cc: Karen Ras; Helena Francisco
Subject: RE: Site Inspection Reports - St. Christopher Catholic School

Good morning Ms. Dubajic,

I'm just checking in with you. As you know, I have been copied on all of the email exchanges you've had with staff, but have not seen anything since November 1st. I wanted to ensure that you are getting answers from staff, and wanted you to know that I will attempt to assist in any way that I can.

Kind regards,

Karen

Karen Ras
Councillor, Ward 2
City of Mississauga
300 City Centre Drive
Mississauga, ON L5B 3C1
Ph: 905-896-5200
karen.ras@mississauga.ca
www.karenras.ca

 MISSISSAUGA

 Karen Ras  @RasWard2

 Please consider the environment before printing this e-mail.

"This e-mail may not be forwarded to anyone for any reason without express written permission of the author."

51

-----Original Message-----

From: Dubajic, Yvette (<mailto:Yvette.Dubajic>)

Sent: 2015/11/01 10:37 AM

To: Sheelagh Duffin

Cc: Angie Melo; Karen Ras; Darko Dubajic (Dubajic, Yvette

Subject: RE: Site Inspection Reports - St. Christopher Catholic School

Sheelagh,

Thank-you for your response.

I feel like there is a bit of a misunderstanding. My enquiry is not just about getting a crossing guard. It's also about getting a cross walk so that ALL pedestrians have a safe way to cross Clarkson Rd to access the sidewalk on the west side. As for the site inspection, I could have told you in advance that it would have failed due to the fact that parents have made other arrangements over the years for their children to get to school like driving them, car pooling or fill up the bus, which is exactly what we have done. As I'm sure you are aware, we pay robust property taxes in this neighbourhood and yet we do not feel safe crossing Clarkson Rd in order to access the sidewalk. How would the Traffic Safety Council recommend children access the sidewalk even outside of school hours? Wait for a gap in traffic and take a chance?

Please advise how I can escalate my concern and to whom I should reach out to.

Thank-you

Yvette Dubajic

Site Inspection Report



Traffic Safety Council
JAN 27 2016

Corporate Services
Office of the City Clerk

Site	
School: Fairview Public School	Address: 3590 Joan Dr Mississauga ON L5B 1T8
School Times: 8:55 AM 3:20 PM	Student Population: 499
No. of School Buses: 72	
School:	Address:
School Times: AM PM	Student Population:
No. of School Buses:	

Location: (Please identify the location with reference to nearest intersection. Indicate nearest school and address)
East leg at Duke of York Blvd. and Webb Dr.

Date of Inspection: 2016 01 14 Inspection Time: 8:25 AM 3:20 PM Requested By: Supervisor Crossing Guards

Prepared By: D. Yaunan; T. Coulson Request For: crossing guard

Observers	
File Number: RT.10	File Number: RT.10
Ward: Ward 7	
Observed By: S. Duffin	<input type="checkbox"/> AM <input type="checkbox"/> PM <input checked="" type="checkbox"/> AM & PM
Observed By: D. Yaunan	<input type="checkbox"/> AM <input type="checkbox"/> PM <input checked="" type="checkbox"/> AM & PM
Observed By: T. Coulson	<input type="checkbox"/> AM <input type="checkbox"/> PM <input checked="" type="checkbox"/> AM & PM
Observed By: S. Kumra	<input type="checkbox"/> AM <input checked="" type="checkbox"/> PM <input type="checkbox"/> AM & PM
Observed By:	<input type="checkbox"/> AM <input type="checkbox"/> PM <input type="checkbox"/> AM & PM
Observed By:	<input type="checkbox"/> AM <input type="checkbox"/> PM <input type="checkbox"/> AM & PM

Details	
Weather Conditions:	AM: <input checked="" type="checkbox"/> Dry <input type="checkbox"/> Sunny <input type="checkbox"/> Rain <input type="checkbox"/> Snow <input type="checkbox"/> Other: PM: <input type="checkbox"/> Dry <input type="checkbox"/> Sunny <input checked="" type="checkbox"/> Rain <input type="checkbox"/> Snow <input type="checkbox"/> Other:
Type of Crossing:	<input type="checkbox"/> 4 Way Intersection <input checked="" type="checkbox"/> 3 Way Intersection <input type="checkbox"/> Midblock (i.e., not an intersection)
Type of Control:	<input type="checkbox"/> Traffic Lights <input type="checkbox"/> Yield Signs <input type="checkbox"/> No Control <input type="checkbox"/> Stop Signs (Traffic is stopped on one street only) <input checked="" type="checkbox"/> All Way Stop (Traffic is stopped in all directions)

Site Conditions	
School Signs:	<input type="checkbox"/> School Area Signs <input type="checkbox"/> School Crossing Signs <input type="checkbox"/> Parking/Stopping Prohibition
Posted Speed Limit:	<input type="checkbox"/> 40 km/hr <input checked="" type="checkbox"/> 50 km/h <input type="checkbox"/> 60 km/hr <input type="checkbox"/> Other:
Visibility of Crossing Pedestrians:	<input type="checkbox"/> Poor <input type="checkbox"/> Fair <input checked="" type="checkbox"/> Good Comments:
Sight Obstructions:	<input type="checkbox"/> Hedges <input type="checkbox"/> Trees <input type="checkbox"/> Fences <input type="checkbox"/> Bus Shelter <input type="checkbox"/> Newspaper Boxes <input type="checkbox"/> Other (Specify):
Road Grade:	<input checked="" type="checkbox"/> Flat <input type="checkbox"/> Incline <input type="checkbox"/> Decline
Road Geometrics:	<input checked="" type="checkbox"/> Straight <input type="checkbox"/> Curved Comments:
Road Width:	35 feet/metres Curb to Curb: feet/metres Curb to Median: feet/metres
Road Conditions:	AM: <input checked="" type="checkbox"/> Dry <input type="checkbox"/> Wet <input type="checkbox"/> Snow Covered <input type="checkbox"/> Ice PM: <input type="checkbox"/> Dry <input checked="" type="checkbox"/> Wet <input type="checkbox"/> Snow Covered <input type="checkbox"/> Ice
Sidewalks:	<input type="checkbox"/> Not Present <input checked="" type="checkbox"/> North <input checked="" type="checkbox"/> South <input checked="" type="checkbox"/> East <input checked="" type="checkbox"/> West
Proximity to School:	<input type="checkbox"/> In Front of <input checked="" type="checkbox"/> Within 400 feet/metres
Route Survey:	<input type="checkbox"/> Shopping Area <input type="checkbox"/> Construction <input type="checkbox"/> Driveway <input type="checkbox"/> Parked Vehicle(s) <input type="checkbox"/> Transit Bus Stop <input type="checkbox"/> Underpass Within feet/metres Other (specify):
Comments / Conflicts:	NO CONFLICTS OBSERVED. STUDENTS CROSSING ALL DIRECTIONS AT ALL WAY STOP.

609

Crossing Guard Warrant Survey

Location: East leg at Duke of York Blvd. and Webb Dr.

☒ Safe Gap Time

Safe Gap Time Calculation (if applicable): $\left(\frac{W}{3.5} + 4 \right)$ 14 = sec.

☐ Signalized Intersection turning traffic count

Morning Intervals

Time (AM)	# of Peds	# of Conflicts	Gaps	# of Gaps
7:45 - 7:50			JANUARY 14 2016	
7:50 - 7:55				
7:55 - 8:00				
8:00 - 8:05				
8:05 - 8:10				
8:10 - 8:15				
8:15 - 8:20				
8:20 - 8:25				
8:25 - 8:30	///		///, 15, 16, // INCOMPLETE	2
8:30 - 8:35	///		///, 38, 16, 50, / 36, //, //, 20, ///	9
8:35 - 8:40			///, 32, / 14, //, //, 22, //, //	4
8:40 - 8:45	//		57, 21, //, //, //, //, //	5
8:45 - 8:50	//		///, //, //, //, //, //, //, 20	1
8:50 - 8:55	///		16, 15, //, //, 22, //, //, 15, //, //, 15, / 28, / 15	8
8:55 - 9:00				

Afternoon Intervals

Time (PM)	# of Peds	# of Conflicts	Gaps	# of Gaps
2:45 - 2:50			JANUARY 15 2016	
2:50 - 2:55				
2:55 - 3:00				
3:00 - 3:05				
3:05 - 3:10				
3:10 - 3:15				
3:15 - 3:20				
3:20 - 3:25	/		38, //, //, 14, //, //, //, 57, //, 26, /	8
3:25 - 3:30	///, //		17, / 15, 14, //, //, 32, / 23, //, 28, ///	8
3:30 - 3:35	///, //		15, //, //, //, //, //, 35, / 73	8
3:35 - 3:40	/		32, 14, 16, //, //, //, 23, 25, //, 16, ///	7
3:40 - 3:45			27, 24, //, //, 17, 23, / 18, 30, //, //, //	7
3:45 - 3:50			40, 24, / 28, //, //, //, //, 52, //, //, //	8
3:50 - 3:55				
3:55 - 4:00				

Recommendations

- 1) THAT THE WARRANTS FOR A CROSSING GUARD ON THE EAST LEG OF DUKE OF YORK BLVD. AND WEBB DR. HAVE NOT BEEN MET
- 2) THAT TRAFFIC SAFETY COUNCIL RE- INSPECT EXISTING CROSSING AT THE WEST LEG OF DUKE OF YORK AND WEBB DR. TO DETERMINE IF THE WARRANTS CONTINUE TO BE MET

Observations

Volume of Traffic (see Intersection Plan):

AM: ☐ Heavy ☐ Light ☒ Intermittant PM: ☐ Heavy ☒ Light ☐ Intermittant

Number of Crossing Pedestrians:

AM: North ☐ East ☐ 12 South ☐ West ☐ PM: North ☐ East ☐ 16 South ☐ West ☐

Turning Traffic:

AM: ☐ Heavy ☐ Light ☐ Intermittant PM: ☐ Heavy ☐ Light ☐ Intermittant

East leg of Duke of York Blvd + Webb Dr 8:25-8:55 and 3:20-3:50

6b

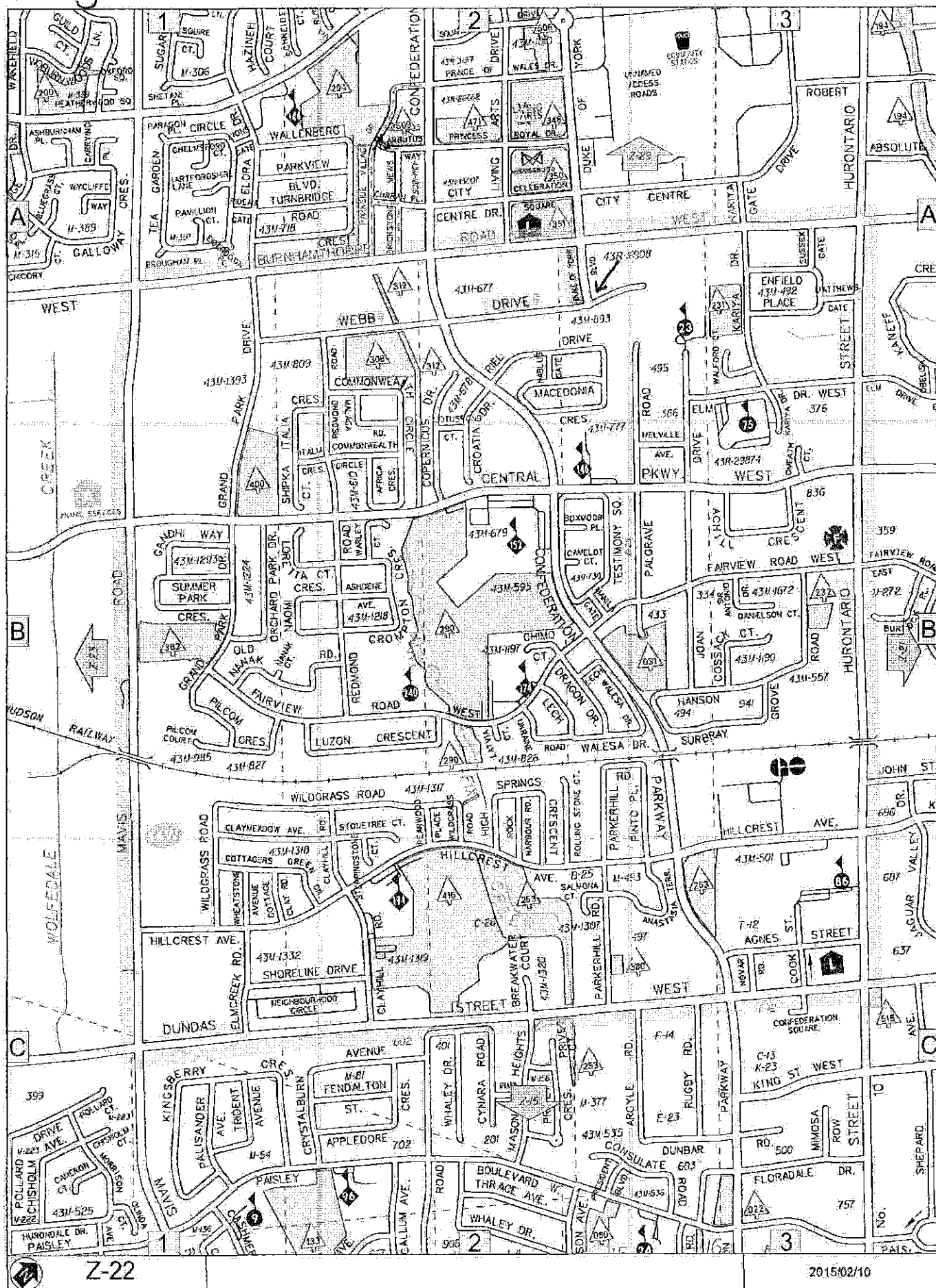

Z-22

2015/02/10

60C

W7

Heather McGuire

From: Sheelagh Duffin
Sent: 2016/01/06 2:52 PM
To: Heather McGuire
Cc: Angie Melo
Subject: FW: Duke of York Boulevard & Webb Drive

Hi Heather,

Would you kindly schedule a site inspection at the east leg of Duke of York Boulevard and Webb Drive for the students of Fairview Public School in order to determine if the warrants are met for the implementation of a school crossing guard at that location. The times of the inspection would be 8:25 – 8:55 am and 3:20 – 3:50 pm. Student Transportation advises that there are potentially 12 students living east of Duke of York Boulevard that could cross at the east leg of Duke of York Boulevard and Webb Drive.

School boundaries changed with the opening of Chris Hadfield Public School. The new boundary for Fairview Public School is east of Duke of York Boulevard and south of Webb Drive. Therefore students living north of Webb Drive and west of Duke of York Boulevard are no longer walking to Fairview Public School but are instead bused to Chris Hadfield Public. The crossing guards in place on Webb Drive just west of Duke of York Boulevard are now only crossing students to school busses. Therefore the existing crossing with 2 crossing guards should be removed at the March Break.

Thank you.

Sheelagh
5167

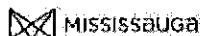

Sheelagh Duffin
Supervisor, Crossing Guards
T 905-896-5167 | F 905-896-5166
sheelagh.duffin@mississauga.ca

City of Mississauga | Transportation and Works Department
Works Operations and Maintenance Division
3185 Mavis Road
Mississauga ON L5C 1T7

Please consider the environment before printing.

From: Macina, Marcy [<mailto:Marcy.Macina@dpedsb.org>]
Sent: 2015/12/14 1:05 PM
To: Sheelagh Duffin
Subject: RE: Duke of York Boulevard & Webb Drive

Hi Sheelagh,

Yes, you are right, just wanted to mention that we do have students attending Fairview that live North of Webb Drive and East of Duke of York Blvd. I am showing 12 walkers.

Thanks ~

Marcy Macina

6ed

Operations Officer, East Area
Student Transportation of Peel Region
Tel: 905.890.6000 or 1.800.668.1140
www.stopr.ca

From: Sheelagh Duffin [<mailto:Sheelagh.Duffin@mississauga.ca>]
Sent: Monday, December 14, 2015 11:53 AM
To: Macina, Marcy <Marcy.Macina@dpcdsb.org>
Subject: Duke of York Boulevard & Webb Drive

Hi Marcy,

With the opening of Chris Hadfield Public School, it appears that the school boundary for Fairview Public School has been redrawn.

We currently have 2 crossing guards in place at Duke of York Boulevard and Webb Drive to cross students north to south in the am and south to north in the pm for Fairview Public School. However, with the boundary change, there are no students attending Fairview Public that live north of Webb Drive and west of Duke of York Boulevard. These students are all bussed to Chris Hadfield Public.

At present, contrary to TSC policy, the crossing guards are only crossing students to school busses.

Would you kindly confirm that there are no elementary age students required to cross Duke of York Boulevard and Webb Drive to attend Fairview Public School.

Thanks, Marcy.

Sheelagh

 MISSISSAUGA

Sheelagh Duffin
Supervisor, Crossing Guards
T 905-896-5167 | F 905-896-5166
sheelagh.duffin@mississauga.ca

City of Mississauga | Transportation and Works Department,
Works Operations and Maintenance Division
3185 Mavis Road
Mississauga ON L5C 1T7

Please consider the environment before printing.

Site Inspection Report

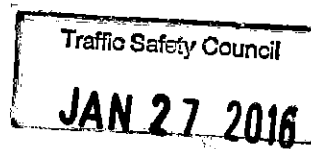

Corporate Services
Office of the City Clerk

7

Site	
School: Corliss Public School	Address: 3730 Corliss Cres. Mississauga ON L4T 2Z4
School Times: 8:30 AM 3:00 PM	Student Population: 260
No. of School Buses: 0	
School:	Address:
School Times: AM PM	Student Population:
No. of School Buses:	

Location: (Please identify the location with reference of nearest intersection. Indicate nearest school and address)			
Brandon Gate Dr & Sigsbee Dr - north leg			
Date of Inspection: 2016 01 19	Inspection Time: 8:00 AM 3:00 PM	Requested By: a parent	
Prepared By: L. Goegan	Request For: crossing guard		

Observers			
File Number: RT.10	File Number: RT.10	Ward: Ward 5	
Observed By: S. Duffin	<input type="checkbox"/> AM <input type="checkbox"/> PM <input checked="" type="checkbox"/> AM & PM		
Observed By: L. Goegan	<input type="checkbox"/> AM <input type="checkbox"/> PM <input checked="" type="checkbox"/> AM & PM		
Observed By: D. Yaunan	<input type="checkbox"/> AM <input type="checkbox"/> PM <input checked="" type="checkbox"/> AM & PM		
Observed By:	<input type="checkbox"/> AM <input type="checkbox"/> PM <input type="checkbox"/> AM & PM		
Observed By:	<input type="checkbox"/> AM <input type="checkbox"/> PM <input type="checkbox"/> AM & PM		
Observed By:	<input type="checkbox"/> AM <input type="checkbox"/> PM <input type="checkbox"/> AM & PM		

Details			
Weather Conditions:	AM: <input checked="" type="checkbox"/> Dry <input type="checkbox"/> Sunny <input type="checkbox"/> Rain <input type="checkbox"/> Snow	Other: -11C	
	PM: <input checked="" type="checkbox"/> Dry <input type="checkbox"/> Sunny <input type="checkbox"/> Rain <input type="checkbox"/> Snow	Other: -4C	
Type of Crossing:	<input type="checkbox"/> 4 Way Intersection <input type="checkbox"/> 3 Way Intersection	<input checked="" type="checkbox"/> Midblock (i.e., not an intersection)	
Type of Control:	<input type="checkbox"/> Traffic Lights <input type="checkbox"/> Yield Signs	<input checked="" type="checkbox"/> No Control	
	<input type="checkbox"/> Stop Signs (Traffic is stopped on one street only)	<input type="checkbox"/> All Way Stop (Traffic is stopped in all directions)	

Site Conditions			
School Signs:	<input type="checkbox"/> School Area Signs <input type="checkbox"/> School Crossing Signs <input type="checkbox"/> Parking/Stopping Prohibition		
Posted Speed Limit:	<input type="checkbox"/> 40 km/hr <input checked="" type="checkbox"/> 50 km/h <input type="checkbox"/> 60 km/hr	Other:	
Visibility of Crossing Pedestrians:	<input type="checkbox"/> Poor <input type="checkbox"/> Fair <input checked="" type="checkbox"/> Good	Comments:	
Sight Obstructions:	<input type="checkbox"/> Hedges <input type="checkbox"/> Trees <input type="checkbox"/> Fences <input type="checkbox"/> Bus Shelter		
	<input type="checkbox"/> Newspaper Boxes <input type="checkbox"/> Other (Specify):		
Road Grade:	<input checked="" type="checkbox"/> Flat <input type="checkbox"/> Incline <input type="checkbox"/> Decline		
Road Geometrics:	<input checked="" type="checkbox"/> Straight <input type="checkbox"/> Curved	Comments:	
Road Width:	32 feet/metres	Curb to Curb:	Curb to Median:
Road Conditions:	AM: <input checked="" type="checkbox"/> Dry <input type="checkbox"/> Wet <input type="checkbox"/> Snow Covered	Ice	
	PM: <input checked="" type="checkbox"/> Dry <input type="checkbox"/> Wet <input type="checkbox"/> Snow Covered	Ice	
Sidewalks:	<input type="checkbox"/> Not Present <input checked="" type="checkbox"/> North <input checked="" type="checkbox"/> South <input checked="" type="checkbox"/> East <input checked="" type="checkbox"/> West		
Proximity to School:	<input type="checkbox"/> In Front of <input checked="" type="checkbox"/> Within 400 feet/metres		
Route Survey:	<input type="checkbox"/> Shopping Area <input type="checkbox"/> Construction <input type="checkbox"/> Driveway <input type="checkbox"/> Parked Vehicle(s)		
	<input type="checkbox"/> Transit Bus Stop <input type="checkbox"/> Underpass Within feet/metres	Other (specify):	
Comments / Conflicts:	NO CONFLICTS OBSERVED.		

79

Crossing Guard Warrant Survey

Location: Brandon Gale Dr & Sigsbee Dr - north leg

☒ Safe Gap Time

Safe Gap Time Calculation (if applicable): $\left(\frac{W}{3.5} + 4 \right)$ 13 = sec.

☐ Signalized Intersection turning traffic count

Morning Intervals

Time (AM)	# of Peds	# of Conflicts	Gaps	# of Gaps
7:45 - 7:50				
7:50 - 7:55				
7:55 - 8:00				
8:00 - 8:05			//// 25 // 20, 20 // 38 // 47 // 22 // 13 ///	10
8:05 - 8:10			19 // // 18, 23 // // 16, 16, 16 // // 24, 13, 39	11
8:10 - 8:15	/P		54 // 13 // 19 // 18, 26 // // 19 // 34	19
8:15 - 8:20			// 38 // // 17, 17 // // 19, 22 // // 13, 15 // // //	8
8:20 - 8:25	/P///		27 // 37, 14 // 18 // 18 // // 13 // // 14 // // 20	10
8:25 - 8:30			21 // // // 15 // 43 // // 19 // 25 // // 18 ///	8
8:30 - 8:35				
8:35 - 8:40				
8:40 - 8:45				
8:45 - 8:50				
8:50 - 8:55				
8:55 - 9:00				

Afternoon Intervals

Time (PM)	# of Peds	# of Conflicts	Gaps	# of Gaps
2:45 - 2:50				
2:50 - 2:55				
2:55 - 3:00				
3:00 - 3:05			//// 27, 15 // 37, 27 // 17 // 14 // 34 // 20	12
3:05 - 3:10			32 // // 17 // 16 // 39 // 19, 22 //	9
3:10 - 3:15	/		24 // 16 // // 13 // 13 // 13 // 24 //	6
3:15 - 3:20	///		24 // 37 // 32, 16 // 23, 21 // 37 // 25	12
3:20 - 3:25	///		/// 16 // // 24, 31 // 16 // 17 // 25 // 25 // 53	12
3:25 - 3:30			// 20 // 21, 29 // 27, 14 // 16 // 24 // 41	12
3:30 - 3:35				
3:35 - 3:40				
3:40 - 3:45				
3:45 - 3:50				
3:50 - 3:55				
3:55 - 4:00				

Recommendations

1) THAT THE WARRANTS FOR A CROSSING GUARD HAVE NOT BEEN MET. ADEQUATE GAPS IN TRAFFIC FOR STUDENTS TO CROSS.

Observations

Volume of Traffic (see Intersection Plan):

AM: ☐ Heavy ☐ Light ☒ Intermittant PM: ☐ Heavy ☒ Light ☐ Intermittant

Number of Crossing Pedestrians:

AM: North 3 East South West PM: North 7 East South West

Turning Traffic:

AM: ☐ Heavy ☒ Light ☐ Intermittant PM: ☐ Heavy ☒ Light ☐ Intermittant

(North leg) Brandon Gate Dr + Sigsbee Dr 8:00-8:30 + 3:00-3:30

7b

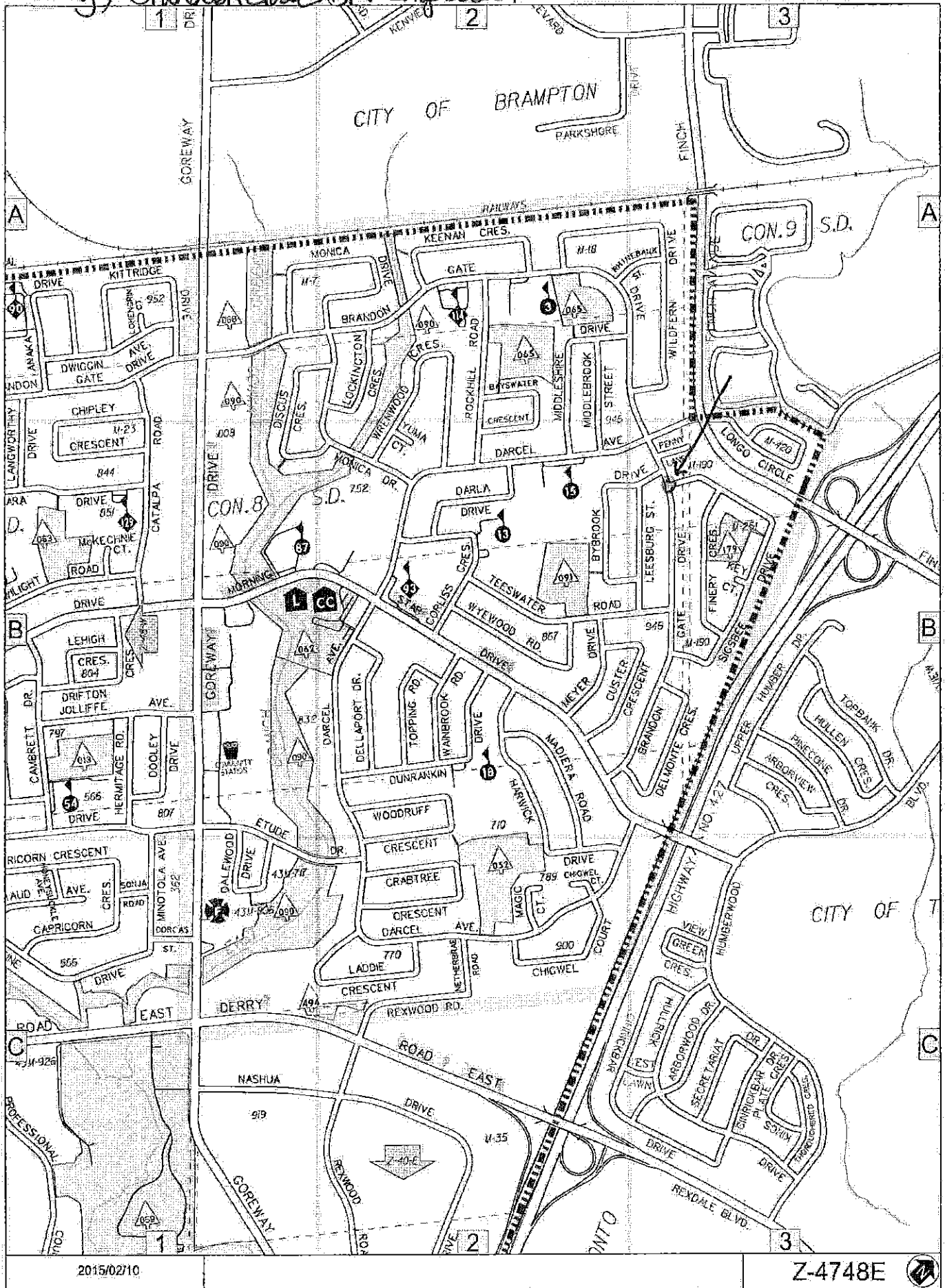

7c

Heather McGuire

From: Sheelagh Duffin
Sent: 2016/01/08 2:27 PM
To: Heather McGuire
Cc: Angie Melo
Subject: Request for a Site Inspection - Brandon Gate Drive & Sigsbee Drive

Hi Heather,

Would you kindly schedule a site inspection for the intersection of Sigsbee Drive and Brandon Gate Drive, north leg, for the students of Corliss Public School. The times of the inspection would be 8:00 – 8:30 am and 3:00 – 3:30 pm.

A parent advises that there are several parents with a number of students that cross at Sigsbee and Brandon Gate. She feels that the signalized intersection at Brandon Gate Drive and Darcel Avenue is too far out of the way to be a reasonable crossing for them.

Kindly notify Zeinab at () of the date and time of the inspection once it is scheduled.

Thank you.

Sheelagh
5167



Sheelagh Duffin
Supervisor, Crossing Guards
T 905-896-5167 | F 905-896-5166
sheelagh.duffin@mississauga.ca

City of Mississauga | Transportation and Works Department,
Works Operations and Maintenance Division
3185 Mavis Road
Mississauga ON L5C 1T7

Please consider the environment before printing.

From: Sheelagh Duffin
Sent: 2016/01/08 4:22 PM
To: Anna.Gentile@dpcdsb.org
Cc: Heather McGuire; Angie Melo
Subject: RE: Transportation Reassessment - Middle School Students grades 6-8

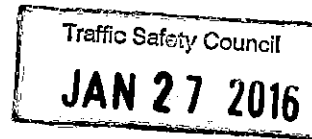

Hi Anna,

By copy of this email to Heather McGuire I am requesting that she schedule safety reviews for the students of St. Veronica Catholic School and David Leeder Middle School in advance of bussing being removed at 1) Mavis Road and Crawford Mill Avenue/Novo Star Drive and 2) McLaughlin Road and Novo Star Drive/Arrowsmith Drive. The times of the inspections would be 8:00 – 8:40 am and 2:10 – 3:30 pm.

Thank you.

Sheelagh



Sheelagh Duffin
Supervisor, Crossing Guards
T 905-896-5167 | F 905-896-5166
sheelagh.duffin@mississauga.ca

City of Mississauga | Transportation and Works Department,
Works Operations and Maintenance Division
3185 Mavis Road
Mississauga ON L5C 1T7

Please consider the environment before printing.

From: Anna.Gentile@dpcdsb.org [mailto:Anna.Gentile@dpcdsb.org]
Sent: 2016/01/07 4:14 PM
To: Sheelagh Duffin
Subject: Transportation Reassessment - Middle School Students grades 6-8

Hello Sheelagh! Happy New Year to you!

STOPR is considering a couple of transportation reassessments for the upcoming school year.

Could Traffic Safety Council perform preliminary site inspections at the following intersections:

Mavis & Crawford Mill Ave/Novo Star Drive
And
McLaughlin Road & Novo Star/Arrowsmith Drive

Kindly review intersections and provide comments/recommendations. Affected Schools will be David Leeder Middle School and St Veronica Elementary School. Students crossing will be in grades 6, 7 & 8.

89



Thanks,

Anna Gentile
 Operations Officer - West Area
 Student Transportation of Peel Region
 Peel District School Board | Peel Region | Peel District School Board

T 505 650 6000 | T 1 800 665 1142 | F 505 650 6000
www.stpr.ca | www.peelschools.org | www.dpsb.org

JAN 27 2016

2015

November

Year
Month2015
11

Values

School Name	Offence Code	Issued Tickets	Total Visits
Allen A Martin Sr.	(blank)		1
Artesian Drive	43	4	2
	(blank)		3
Barondale	27	1	1
	43	5	2
	(blank)		0
Bishop Scalabrini	27	3	2
Brandon Gate	43	2	1
	(blank)		3
Brian W Fleming	27	2	1
	(blank)		2
Briarwood		6	4
Bristol Rd. Middle	(blank)		5
Britannia	(blank)		1
Brookmede	24	1	0
	43	2	0
	(blank)		4
Burnhamthorpe	15	1	0
	27	2	1
	42	7	2
	43	4	2
	(blank)		1
Camilla Road Sr.	27	1	1
	43	1	2
	(blank)		3
Canadian Martyrs	27	2	1
	43	5	3
Cashmere Ave	43	3	1
	(blank)		2
Castlebridge	12	2	0
	24	1	1
Champlain Trail	(blank)		1
Churchill Meadows	42	1	1
Clarkson	(blank)		1
Corliss	3	1	1
Corpus Christi	27	1	0
	(blank)		2
Corsair	43	1	1

99

Year
Month

2015
11

2015
November

School Name	Offence Code	Values	
		Issued Tickets	Total Visits
Credit Valley	(blank)		2
Darcel Ave Sr.	(blank)		6
Derry West Village	12	1	1
	43	4	3
	(blank)		2
Divine Mercy	12	1	1
	42	3	1
	43	3	0
Dixie	(blank)		4
Dunrankin Drive	8	1	0
	43	3	2
	(blank)		3
Edenrose	27	9	5
	(blank)		1
Edenwood Middle	15	1	0
	43	6	2
Erin Centre Middle	43	1	1
	(blank)		3
Fairview	2	1	0
	8	1	1
	(blank)		3
Fairwind Sr	27	1	1
Floradale	24	1	0
	43	6	2
Forest Ave	42	1	1
	43	1	1
	(blank)		1
Forest Glen	43	12	4
	(blank)		0
Glenhaven Sr	12	1	1
	17	1	1
	(blank)		1
Hawthorn	43	2	1
Hazel McCallion Sr.	43	1	1
Holy Cross	12	1	1
Huntington Ridge	24	1	0
	27	1	1
	43	10	5
	(blank)		1

9b

Year
Month

2015
11

2015
November

School Name	Offence Code	Values	
		Issued Tickets	Total Visits
Janet I McDougald	27	2	1
	(blank)		5
Kenollie	24	1	0
	27	1	1
	(blank)		3
Kindree	27	1	1
Lancaster	42	6	2
	43	3	2
	(blank)		2
Levi Creek	27	1	0
	43	7	4
	(blank)		3
Lisgar Middle	43	2	1
	(blank)		2
Lorne Park	12	1	1
	(blank)		2
Marvin Heights	43	3	1
	(blank)		2
Mary Fix Catholic	3	1	0
	7	1	0
	12	1	1
	43	2	1
	(blank)		1
McKinnon	27	1	0
	43	1	1
Mentor College	15	6	0
	42	2	2
	43	2	1
	(blank)		1
Middlebury	12	1	0
	43	4	2
	(blank)		2
Mineola	(blank)		2
Morning Star Middle	15	1	1
	42	3	0
	(blank)		3
Nahani Way	27	2	1
	43	2	2
	(blank)		1

9c

Year
Month

2015
11

2015

November

School Name	Offence Code	Values	
		Issued Tickets	Total Visits
Oakridge	(blank)		1
Oscar Peterson	8	1	0
	15	1	0
	24	1	1
	43	8	4
	(blank)		8
Osprey Woods	7	2	1
	43	3	1
Our Lady of Mt. Carmel	43	1	1
Plowman's Park	(blank)		1
Plum Tree Park	3	2	0
	12	1	1
	24	1	0
	27	1	1
	43	5	2
	(blank)		3
Queen Elizabeth Sr	(blank)		2
Queen of Heaven	(blank)		1
Queenston Dr	24	1	1
	42	2	1
	(blank)		1
Ridgewood	42	1	1
	43	3	3
	(blank)		1
Riverside	42	3	1
	43	1	0
Ruth Thompson Middle	(blank)		1
San Lorenzo Ruiz	(blank)		3
Sawmill Valley	15	1	0
	24	1	1
Settler's Green	43	1	1
	(blank)		1
Shelter Bay	24	1	0
	43	6	1
Sheridan Park	3	1	1
Sherwood Mills	43	5	0
	(blank)		4
St. Alfred	43	1	1
	(blank)		1

92

Year
Month

2015
11

2015
November

School Name	Offence Code	Values	
		Issued Tickets	Total Visits
St. Barbara	27	1	0
	43	8	5
	(blank)		5
St. Basil	27	1	0
	43	3	2
	(blank)		1
St. Bernard of Clairvaux Catholic	43	2	1
	(blank)		1
St. Charles Garnier	(blank)		3
St. David of Wales	(blank)		1
St. Dominic	15	2	1
	27	1	0
	42	2	0
	43	1	1
	(blank)		2
St. Edmund	15	1	1
	43	1	1
	(blank)		3
St. Faustina	42	2	1
	(blank)		1
St. Francis of Assisi	(blank)		1
St. Gerard	43	2	1
	(blank)		1
St. Gertrude	43	1	1
	(blank)		1
St. Jerome	17	1	1
St. John of the Cross	43	2	0
	(blank)		2
St. Jude	43	2	1
	(blank)		1
St. Julia Catholic	27	1	1
	43	4	2
	(blank)		2
St. Luke Catholic	43	1	0
	(blank)		1
St. Margaret of Scotland	3	1	1
	16	1	1
	17	1	0
	24	1	0

9e

Year
Month

2015
11

2015

November

Values			
School Name	Offence Code	Issued Tickets	Total Visits
St. Margaret of Scotland	43	3	1
St. Mark	(blank)		1
St. Martin	42	7	2
St. Matthew	42	1	1
St. Philip	7	1	1
	27	1	0
	43	1	1
	(blank)		3
St. Pio of Pietrelcina	27	1	1
	43	2	1
	(blank)		1
St. Raphael	27	1	1
	(blank)		2
St. Rose of Lima	(blank)		1
St. Sebastian Catholic	42	1	1
	43	1	1
	(blank)		4
St. Simon Stock	27	1	1
St. Sofia	(blank)		1
St. Therese of the Child Jesus	43	2	0
	(blank)		1
St. Veronica	27	2	2
	(blank)		1
St. Vincent de Paul	(blank)		1
Sts. Martha & Mary	42	4	1
	43	2	2
	(blank)		1
Sts. Peter & Paul	27	2	2
	43	1	1
	(blank)		2
T.L. Kennedy	42	1	1
Tecumseh	(blank)		1
The Valleys Sr	(blank)		2
Thomas Street Middle	42	1	0
	43	1	1
	(blank)		3
Thornwood	43	1	1
	(blank)		1
Trelawny	15	1	0

9 f

Year
Month

2015
11

2015
November

School Name	Offence Code	Values	
		Issued Tickets	Total Visits
Trelawny	27	3	2
	43	7	4
	(blank)		0
Vista Heights	43	12	3
Westacres	43	3	3
	(blank)		2
Whitehorn	12	1	1
	43	2	1
	(blank)		3
Springfield	(blank)		2
Miller's Grove	17	1	0
	43	2	1
David Leeder Middle	27	2	1
Olive Grove	(blank)		1
Ascension Of Our Lord	43	1	0
	(blank)		4
John Cabot	15	1	1
	(blank)		1
Grand Total		364	357

- 02 PARKING ON BLVD
- 05 PARKING ON SIDEWALK
- 07 3 METRES OF A FIRE HYDRANT
- 08 PARKING WITHIN 5 METERS OF AS INTER
- 12 IMMOBILE OR UNLICENSED
- 15 PROHIBITED AREA (PARKING)
- 17 PROHIBITED AREA (STOPPING)
- 24 FACING WRONG DIRECTION
- 27 PARKING IN A DESIGNATED FIRE ROUTE
- 28 STOPPING IN A DESIGNATED FIRE ROUTE
- 31 OBSTRUCTING TRAFFIC
- 42 PARKING IN SCHOOL ZONE
- 43 STOPPING IN SCHOOL ZONE

99

Traffic Safety Council

JAN 27 2016

2015

December

Year
Month2015
12

School Name	Offence Code	Values	
		Issued Tickets	Total Visits
Artesian Drive	12	1	0
	43	3	2
	(blank)		1
Barondale	7	1	1
	27	1	1
	43	2	1
	(blank)		1
Blessed Teresa of Calcutta Catholic	27	1	1
	3	1	1
	43	1	1
	(blank)		3
Brian W Fleming			
Briarwood		4	1
	(blank)		3
Bristol Rd. Middle			
Britannia	43	3	1
Brookmede	(blank)		4
Burnhamthorpe	(blank)		1
Camilla Road Sr.	15	2	1
	(blank)		3
Canadian Martyrs	42	1	0
	43	4	3
	(blank)		1
Cashmere Ave	43	1	0
	(blank)		2
Castlebridge	(blank)		2
Champlain Trail	43	1	1
Christ The King Catholic	43	1	1
Churchill Meadows	15	1	1
	27	2	2
	(blank)		1
Clifton	43	1	1
	(blank)		0
Corliss	(blank)		1
Corpus Christi	(blank)		3
Credit Valley	43	2	2
	(blank)		2
Darcel Ave Sr.	(blank)		2
Derry West Village	43	1	1
	(blank)		1

9h

Year
Month

2015
12

2015
December

School Name	Offence Code	Values	
		Issued Tickets	Total Visits
Divine Mercy	15	1	1
	(blank)		2
Dixie	(blank)		3
Dunrankin Drive	27	2	0
	43	3	2
Edenwood Middle	27	1	1
Ellengale	43	1	1
Erin Centre Middle	(blank)		2
Fairview	7	1	1
	39	1	0
	42	1	1
	43	2	0
	(blank)		4
Fairwind Sr	(blank)		1
Fallingbrook Middle	43	1	1
Father Daniel Zanon	(blank)		1
Forest Ave	24	1	1
	(blank)		1
Forest Glen	24	1	1
	27	4	0
	43	7	2
Hazel McCallion Sr.	(blank)		1
Huntington Ridge	27	1	1
	43	2	1
	(blank)		2
Janet I McDougald	27	1	0
	(blank)		6
Kenollie	(blank)		1
Kindree	43	9	4
	(blank)		1
Lancaster	42	1	1
	43	3	1
	(blank)		1
Lisgar Middle	(blank)		3
Lorne Park	(blank)		3
Marvin Heights	43	3	1
	(blank)		2
Mary Fix Catholic	27	2	0
	(blank)		2

9:

Year
Month

2015
12

2015
December

School Name	Offence Code	Values	
		Issued Tickets	Total Visits
McKinnon	43	2	1
Meadowvale Village	(blank)		1
Mentor College	7	1	1
	42	3	1
	43	1	1
Metropolitan Andrei Catholic	15	1	0
	43	6	2
Middlebury	(blank)		1
Mineola	(blank)		1
Morning Star Middle	27	1	0
	42	3	1
	(blank)		2
Munden Park	43	2	1
Oscar Peterson	12	1	1
	27	1	1
	42	2	0
	43	6	2
	(blank)		2
Osprey Woods	27	1	1
	43	1	1
Plowman's Park	27	1	1
Plum Tree Park	12	1	1
	27	1	1
	43	4	3
	(blank)		2
Queen Elizabeth Sr	(blank)		1
Queenston Dr	42	1	1
	(blank)		3
Ray Underhill	43	2	1
Ridgewood	27	2	1
	42	1	0
	43	2	1
	(blank)		1
San Lorenzo Ruiz	43	1	0
	(blank)		3
Settler's Green	43	1	1
	(blank)		2
Sherwood Mills	(blank)		2
St. Basil	42	1	1

93

Year
Month

2015
12

2015
December

School Name	Offence Code	Values	
		Issued Tickets	Total Visits
St. Bernard of Clairvaux Catholic	15	1	1
	27	1	1
	42	1	0
	43	2	1
St. Charles Garnier	(blank)		2
St. Clare	15	1	0
	(blank)		2
St. Dominic	(blank)		5
St. Edmund	15	4	1
	17	3	1
	(blank)		1
St. Francis of Assisi	12	1	1
St. Gertrude	43	2	1
	(blank)		1
St. Herbert	(blank)		1
St. Hilary	7	1	1
St. Julia Catholic	43	5	3
	(blank)		2
St. Louis	12	1	1
	(blank)		2
St. Margaret of Scotland	26	1	1
	43	4	2
	(blank)		1
St. Philip	(blank)		5
St. Pio of Pietrelcina	43	1	1
St. Raphael	(blank)		2
St. Raymond	27	1	1
St. Rose of Lima	(blank)		1
St. Sebastian Catholic	2	1	0
	43	2	2
	(blank)		1
St. Sofia	42	1	1
St. Therese of the Child Jesus	43	3	3
St. Timothy	(blank)		1
St. Veronica	3	1	1
	27	1	1
	(blank)		2
St. Vincent de Paul	27	1	1
Sts. Martha & Mary	27	1	0

9k

Year
Month

2015
12

2015
December

School Name	Offence Code	Values	
		Issued Tickets	Total Visits
Sts. Martha & Mary	(blank)		2
Sts. Peter & Paul	43	2	2
The Valleys Sr	(blank)		1
Thomas Street Middle	12	1	0
	27	1	1
	43	1	1
Thorn Lodge	27	1	1
Thornwood	17	8	1
	42	1	1
	(blank)		1
Trelawny	27	1	1
	43	7	5
	(blank)		0
Westacres	(blank)		1
Whitehorn	43	4	2
	(blank)		1
Springfield	43	3	2
Miller's Grove	17	2	1
	43	1	0
Olive Grove	27	6	2
	(blank)		1
Ascension Of Our Lord	(blank)		3
John Cabot	27	1	1
Meadowvale Secondary	27	1	1
	(blank)		1
Grand Total		216	246

02 PARKING ON BLVD
 05 PARKING ON SIDEWALK
 07 3 METRES OF A FIRE HYDRANT
 08 PARKING WITHIN 5 METERS OF AS INTER
 12 IMMOBILE OR UNLICENSED
 15 PROHIBITED AREA (PARKING)
 17 PROHIBITED AREA (STOPPING)
 24 FACING WRONG DIRECTION
 27 PARKING IN A DESIGNATED FIRE ROUTE
 28 STOPPING IN A DESIGNATED FIRE ROUTE
 31 OBSTRUCTING TRAFFIC
 42 PARKING IN SCHOOL ZONE
 43 STOPPING IN SCHOOL ZONE