

Traffic Safety Council

Date

October 28, 2015

Time

5:00 p.m.

Location

Hearing Room, 2nd Floor
300 Civic Centre, Mississauga, ON L5B 3C1

Members

Councillor Sue McFadden, Ward 10

Councillor Chris Fonseca, Ward 3

Councillor John Kovac, Ward 4

Anna Abbruscato, Dufferin-Peel Catholic District School Board Trustee

Sandra Beniuk, Citizen Member

Robert Crocker, Peel District School Board Trustee

Tamara Coulson, Citizen Member

Louise Goegan, Citizen Member

Denise Gordon-Mohamud, Citizen Member

Sushil Kumra, Citizen Member

Heather Relf, Citizen Member (Vice-Chair)

Ajay Sharma, Citizen Member

Mashkoor Sherwani, Citizen Member

Daniel Suess, Citizen Member

Boris Swedak, Life Member

Altamash Syed, Citizen Member

Katherine Vukobrat, Citizen Member

Peter Westbrook, Citizen Member (Chair)

Advisory Board

Sheelagh Duffin, Supervisor, Crossing Guards

Anna Gentile, Central Planning and Operations Officer, Student Transportation of Peel Region (STOPR)

Tom Howe, Manager, Student Transportation of Peel Region (STOPR)

Alex Liya, Traffic Operations Technician

Denna Yaunan, Traffic Operations Technician

Erica Warsh, Transportation Demand Management Coordinator

Barry Foley, Manager, Parking Enforcement

Peter Brandwood, Peel Regional Police

Daniel Elias, Principals/Vice-Principals' Association Peel District School Board

Shawn Kearns, Principals/Vice-Principals Association Dufferin-Peel Catholic District School Board

Contact

Angie Melo, Legislative Coordinator, Legislative Services

905-615-3200 ext. 5423/ Fax 905-615-4181/ Email angie.melo@mississauga.ca

Find it online

<http://www.mississauga.ca/portal/cityhall/trafficsafetycouncil>

MATTERS TO BE CONSIDERED

1. Approval of September 30, 2015 Minutes
2. Site Inspection Report – Dolphin Senior Public School (Ward 11)
3. Site Inspection Report – Ellengale Public School (Ward 6)
4. Site Inspection Report – Thornwood Public School (Ward 4)
5. Site Inspection Reports – St. Clare Catholic School (Ward 8)
6. Site Inspection Requests
7. Parking Enforcement School Zones for September 2015
8. Transportation and Works Action Items List – September 2015
9. Traffic Safety Council 2016 Meeting Schedule

CALL TO ORDERDECLARATIONS OF CONFLICT OF INTERESTPRESENTATIONS / DEPUTATIONSMATTERS TO BE CONSIDERED1. Approval of September 30, 2015 Minutes

Minutes of the Traffic Safety Council meeting held on September 30, 2015 Minutes.

2. Site Inspection Report – Dolphin Senior Public School

Site Inspection Report for the site inspections conducted on September 30, 2015 at the intersection of Queen Street and Britannia Road West for students attending Dolphin Senior Public School.

RECOMMENDATION

That the Principal of Dolphin Senior Public School be requested to remind the students to only enter the crosswalk when the white walk signal is present and to walk their bikes while crossing the crosswalk.

RECOMMEND APPROVAL3. Site Inspection Report – Ellengale Public School (Ward 6)

Site Inspection Report for site inspections conducted on October 8, 2015 at the intersection of Chada Avenue and Ellengale Drive for the students attending Ellengale Public School.

RECOMMENDATION

1. That the request for a crossing guard at the intersection of Chada Avenue and Ellengale Drive for the students attending Ellengale Public School be denied as the warrants are not met.
2. That Transportation and Works be requested to:
 - a. Remove the school bus loading zone signs on Ellengale Drive.
 - b. Review the signage in front of Ellengale Public School.

RECOMMEND APPROVAL

4. Site Inspection Report – Thornwood Public School (Ward 4)

Site Inspection Report for site inspections conducted on October 13, 2015 at the intersection of Mississauga Valley Boulevard and Central Parkway, for the students attending Thornwood Public School.

RECOMMENDATION

That the request for a third crossing guard at the intersection of Mississauga Valley Boulevard and Central Parkway, for students attending Thornwood Public School, be denied as the warrants are not met.

RECOMMEND APPROVAL

5. Site Inspection Reports – St. Clare Catholic School (Ward 8)

Site Inspection Report for site inspections conducted on October 20, 2015 at 4140 Glen Erin Drive, in front of St. Clare Catholic School and the underpass, for students attending St. Clare Catholic School.

RECOMMENDATION

1. That the request for a crossing guard in front of St. Clare Catholic School be denied as the warrants are not met.
2. That Transportation and Works be requested to review the signage on Glen Erin Drive and Rolling Valley Drive.
3. That Parking Enforcement be requested to enforce “No Stopping” prohibitions on Glen Erin Drive and Rolling Valley Drive from 8:15 a.m. to 8:30 a.m. and at from 2:50 p.m. to 3:14 p.m. once correct signs have been installed.
4. That the Principal of St. Clare Catholic School be requested to advise all parents to use either the Kiss and Ride to drop off students or cross Glen Erin Drive at the underpass.
5. That Peel Regional Police be requested to enforce speeding violations from 8:00 a.m. to 8:30 a.m. and from 3:00 p.m. to 3:30 p.m., on Glen Erin Drive.

RECOMMEND APPROVAL

6. Site Inspection Requests

- 6.1 Email dated September 29, 2015 from Margaret Fleese, requesting a site inspection at the intersection of Paisley Boulevard and Pollard Drive for the students attending St. Jerome Catholic School.

- 6.2 Email dated September 17, 2015 from Councillor Pat Saito on behalf of a resident regarding traffic safety concerns in front of Meadowvale Secondary School.

RECOMMEND RECEIPT/REFERRAL

7. Parking Enforcement in School Zones for September 2015

A final report from the Manager of Parking Enforcement with respect to parking enforcement in school zones for the month of September 2015.

RECOMMEND RECEIPT

8. Transportation and Works Action Items List – September 2015

Action Items List from the Transportation and Works Department for the months of September 2015.

RECOMMEND RECEIPT

9. 2016 Traffic Safety Council Meeting Dates

Memorandum dated October 22, 2015 from Angie Melo, Legislative Coordinator with the 2016 Traffic Safety Council meeting dates.

RECOMMEND RECEIPT

OTHER BUSINESS

Date of Next Meeting: November 25, 2015

ADJOURNMENT

City of Mississauga
Minutes



Traffic Safety Council

Date

September 30, 2015

Time

5:00 p.m.

Location

Committee Room B, 2nd Floor
300 Civic Centre, Mississauga, ON L5B 3C1

Members Present

Councillor Sue McFadden, Ward 10 (left at 5:40 p.m.)
Councillor Chris Fonseca, Ward 3
Councillor John Kovac, Ward 4
Peter Westbrook, Citizen Member (Chair)
Heather Relf, Citizen Member (Vice-Chair)
Anna Abbruscato, Dufferin-Peel Catholic District School Board Trustee
Robert Crocker, Peel District School Board Trustee
Sandra Beniuk, Citizen Member (left at 6:10 p.m.)
Tamara Coulson, Citizen Member
Louise Goegan, Citizen Member
Denise Gordon-Mohamud, Citizen Member (left at 5:40 p.m.)
Sushil Kumra, Citizen Member
Ajay Sharma, Citizen Member
Mashkoor Sherwani, Citizen Member
Daniel Suess, Citizen Member
Altamash Syed, Citizen Member
Katherine Vukobrat, Citizen Member

Members Absent

Fabio Bertucci, Citizen Member
Matthew Moore, Citizen Member
Boris Swedak, Life Member

Advisory Board Present

Sheelagh Duffin, Supervisor, Crossing Guards

Anna Gentile, Central Planning and Operations Officer, Student Transportation of Peel Region (STOPR)

Alex Liya, Traffic Operations Technician

Denna Yaunan, Traffic Operations Technician

Erica Warsh, Transportation Demand Management Coordinator

Barry Foley, Manager Parking Enforcement

Contact

Angie Melo, Legislative Coordinator, Legislative Services

905-615-3200 ext. 5423/ Fax 905-615-4181/ Email angie.melo@mississauga.ca

Find it online

<http://www.mississauga.ca/portal/cityhall/trafficsafetycouncil>

CALL TO ORDER: 5:03 p.m.

Councillor Sue McFadden introduced and welcomed Councillor John Kovac, Ward 4 to Traffic Safety Council.

DECLARATIONS OF CONFLICT OF INTEREST: NIL

PRESENTATIONS / DEPUTATIONS Nil

MATTERS TO BE CONSIDERED

1. Approval of June 24, 2015 Minutes

Minutes of the Traffic Safety Council meeting held on June 24, 2015

Approved (H. Relf)

2. Site Inspection Reports – Holy Cross Catholic School and Corliss Public School

Site Inspection Report for site inspections conducted on September 16, 2015 at the intersection of Darcel Avenue and Brandon Gate Drive for the students attending Holy Cross Catholic School and Corliss Public School.

RECOMMENDATION

That the request for a crossing guard at the intersection of Darcel Avenue and Brandon Gate Drive for the students attending Holy Cross Catholic School and Corliss Public School be denied as the warrants are not met.

Approved (D. Suess)

Recommendation TSC-0106-2015

3. Site Inspection Report – Artesian Public School (Ward 8)

Site Inspection Report for site inspections conducted on September 17, 2015 at the intersection of Artesian Drive and Southampton Drive for the students attending Artesian Public School.

RECOMMENDATION

1. That the request for a crossing guard at the intersection of Artesian Drive and Southampton Drive for the students attending Artesian Public School be denied as the warrants are not met.
2. That the Principal of Artesian Public School be requested to remind the parents and students crossing the north to south across Artesian Drive to cross with the crossing guard at Long Acre Drive.
3. That the Principal of Artesian Public School be requested to remind students to walk their bikes in the crosswalk when crossing the street.

Approved (S. Beniuk)

Recommendation TSC-0107-2015

4. Site Inspection Report – Garthwood Park Public School (Ward 8)

Site Inspection Report for site inspections conducted on September 21, 2015 at the intersection of Burnhamthorpe Road and Loyalist Drive for the students attending Garthwood Park Public School.

RECOMMENDATION

That the request for a crossing guard at the intersection of Burnhamthorpe Road and Loyalist Drive for the students attending Garthwood Park Public School be denied as the warrants are not met.

Approved (S. Beniuk)

Recommendation TSC-0108-2015

5. Site Inspection Report – St. Christopher Catholic School (Ward 2)

Site Inspection Report for the site inspections conducted on September 22, 2015 at the intersection of Clarkson Road and Birchwood Drive for students attending St. Christopher Catholic School.

RECOMMENDATION

That the request for a crossing guard at the intersection of Clarkson Road and Birchwood Drive for students attending St. Christopher Catholic School be denied as the warrants are not met.

Approved (Councillor S. McFadden)

Recommendation TSC-0109-2015

6. Site Inspection Requests

- 6.1 Email dated August 12, 2015 from Councillor Chris Fonseca on behalf of parents concerns with traffic congestion in front on Bough Beeches Boulevard in front of Saints Martha and Mary Catholic School. Councillor Fonseca advised that her office has been in contact with the Peel Regional Police regarding resident concerns of vehicles speeding and requesting that Peel Regional Police enforce speeding violations in this area.

RECOMMENDATION

That the email dated August 12, 2015 from Councillor Chris Fonseca on behalf of parents concerns with traffic congestion in front on Bough Beeches Boulevard in front of Saints Martha and Mary Catholic School be received and referred to the Traffic Safety Council Site Inspection Subcommittee for a report back to the Traffic Safety Council.

Approved (T. Coulson)

Recommendation TSC-0110-2015

- 6.2 Emailed dated September 9, 2015 from Sabrina Colangelo, resident, requesting the implementation of a crossing guard on Glen Erin Drive in front of St. Clare Catholic School.

RECOMMENDATION

That the email dated September 9, 2015 from Sabrina Colangelo, resident, requesting the implementation of a crossing guard on Glen Erin Drive in front of St. Clare Catholic School be received and referred to the Traffic Safety Council Site Inspection Subcommittee for a report back to the Traffic Safety Council.

Approved (T. Coulson)

Recommendation TSC-0111-2015

- 6.3 Email dated September 15, 2015 from Kelly Walter on behalf of Sharon Newing, requesting a site inspection at the intersection of Mississauga Valley Boulevard and Central Parkway to determine if the warrants are met for the implementation of a 3rd crossing guard for students attending Thornwood Public School.

RECOMMENDATION

That the email dated September 15, 2015 from Kelly Walter on behalf of Sharon Newing, requesting a site inspection at the intersection of Mississauga Valley Boulevard and Central Parkway to determine if the warrants are met for the implementation of a 3rd crossing guard for students attending Thornwood Public School be received and referred to the Traffic Safety Council Site Inspection Subcommittee for a report back to the Traffic Safety Council.

Approved (T. Coulson)

Recommendation TSC-0112-2015

- 6.4 Email dated September 17, 2015 from Councillor Ron Starr on behalf of an area resident requesting a site inspection to determine if the warrants are met for the implementation of a crossing guard at the intersection of Chada Avenue and Ellengale Drive for the students attending Ellengale Public School.

RECOMMENDATION

That the email dated September 17, 2015 from Councillor Ron Starr on behalf of an area resident requesting a site inspection to determine if the warrants are met for the implementation of a crossing guard at the intersection of Chada Avenue and Ellengale Drive for the students attending Ellengale Public School be received and referred to the Traffic Safety Council Site Inspection Subcommittee for a report back to the Traffic Safety Council.

Approved (T. Coulson)

Recommendation TSC-0113-2015

- 6.5 Email dated September 10, 2015 from Joanne Redhead, Principal of Lancaster Public School, requesting a site inspection be conducted at the Kiss and Ride entrance to Lancaster Public School to determine if the warrants are met for the implementation of a crossing guard.

RECOMMENDATION

That the email dated September 10, 2015 from Joanne Redhead, Principal of Lancaster Public School, requesting a site inspection be conducted at the Kiss and Ride entrance to Lancaster Public School to determine if the warrants are met for the implementation of a crossing guard be received and referred to the Traffic Safety Council Site Inspection Subcommittee for a report back to the Traffic Safety Council.

Approved (T. Coulson)

Recommendation TSC-0114-2015

- 6.6 Email dated September 22, 2015 from Maria Giles requesting a site inspection and safety review be conducted at the intersection of Glen Erin Drive and Thomas Street for students attending Castlebridge Public School and Thomas Street Middle School.

RECOMMENDATION

That the email dated September 22, 2015 from Maria Giles requesting a site inspection and safety review be conducted at the intersection of Glen Erin Drive and Thomas Street for students attending Castlebridge Public School and Thomas Street Middle School be received and referred to the Traffic Safety Council Site Inspection Subcommittee for a report back to the Traffic Safety

Approved (T. Coulson)

Recommendation TSC-0115-2015

7 Parking Enforcement in School Zones for September 2015

A report from the Manager of Parking Enforcement with respect to parking enforcement in school zones for the month of September 2015. Barry Foley, Manager, Parking Enforcement advised that Parking Enforcement Officers have issued 400 Infraction Notices, since the commencement of school to date.

RECOMMENDATION

That the report from the Manager of Parking Enforcement with respect to parking enforcement in school zones for the month of September 2015 be received for information.

Approved (D. Suess)

Recommendation TSC-0116-2015

8 Transportation and Works Action Items List – June 2015

Action Items List from the Transportation and Works Department for the months of June 2015.

RECOMMENDATION

That the Action Items List from the Transportation and Works Department for the month of June 2015 be received for information.

Approved (Councillor C. Fonseca)

Recommendation TSC-0117-2015

9 Walk to School Subcommittee, International Walk to School Day, and Ridgewood Public School Walking and Rolling Program Kick off Update

Louise Goegan provided an update on the following:

- The Walk to School Subcommittee is working with St. Julia Catholic School on the launch of a Walk to School Program
- The Walk to School Subcommittee will be re-launching the Walk to School Program at Plum Tree Public School on October 1, 2015 and at St. Faustina Catholic School and St. Timothy on October 7, 2015.
- The International Walk to School Day is on Wednesday, October 7, 2015. Members of Traffic Safety Council and Peel Regional Police Officers will be attending at 8 schools in Mississauga. Traffic Safety Council Members will be giving out pencils to students who participated in walking or riding their bike to school.
- The Walk to School Subcommittee Members will be attending the Ridgewood Public School Walking and Rolling Program kickoff and the unveiling of their Learning Garden on October 16, 2015.

RECOMMENDATION

That the verbal updated provided by Louise Goegan, Citizen Member, Traffic Safety Council, with respect to the International Walk to School Day, Ridgewood Public School Waking and Rolling Program Kick Off, and Walk to School Subcommittee matters be received for information.

Approved (T. Coulson)

Recommendation TSC-0118-2015

10. Site Inspection Reports – Levi Creek Public School (Ward 11)

Site Inspection Reports for site inspections conducted on September 15, 2015 at the intersection of Westbridge Way and Bellshire Gate and at the Westbridge Way at the park pathway, for students attending Levi Creek Public School.

RECOMMENDATION

1. That the request for a crossing guard at the intersection of Westbridge Way and Bellshire Gate for the students attending Levi Creek Public School be denied as the warrants are not met.
2. That the request for a crossing guard at Westbridge Way at the park pathway for students attending Levi Creek Public School be denied as the warrants are not met.

3. That Transportation and Works be requested to conduct a speed study on Westbridge Way to include 8:45 to 9:15 a.m. time period and if warranted, request that Peel Regional Police enforce speeding violations on Westbridge Way for the students attending Levi Creek Public School.

Approve (M. Sherwani)

Recommendation TSC-0119-2015

11. Site Inspection Report – Canadian Martyrs Catholic School (Ward 4)

Site Inspection Reports for site inspections conducted on September 24, 2015 at the intersection of 1185 Mississauga Valley Boulevard, in front of Canadian Martyrs Catholic School.

RECOMMENDATION

1. That Peel Regional Police be request to enforce No U-turn violations from 8:00 a.m. to 8:30 a.m. and from 3:00 p.m. to 3:30 p.m. on Mississauga Valley Boulevard, in front of Canadian Martyrs Catholic School.
2. That Parking Enforcement be requested to monitor and enforce parking prohibitions from 2:50 p.m. to 3:15 p.m. in the school vicinity for the students attending Canadian Martyrs Catholic School.
3. That the Principal of Canadian Martyrs Catholic School be requested to advise parents to use the crossing guard at the signalized intersection or the All Way stop at Daralea Heights.

Approved (H. Relf)

Recommendation TSC-0120-2015

12. Public Information Subcommittee Minutes

Minutes of The Public Information Subcommittee meetings held on July 9, 30, August 20, and September 3, 2015.

RECOMMENDATION

That the Minutes of the Public Information Subcommittee meetings held on July 9, 30, August 20, and September 3, 2015 be received.

Approved (L. Goegan)

Recommendation TSC-0121-2015

13. Stakeholder Responsibilities Breakdown Reference Sheet

A reference document, for use by City Councillors, Trustees, School Board Staff and City Staff, listing various issues and the agency responsible for resolving the issues; and a list of various stakeholders and the responsibilities that fall within their respective jurisdictions requires updating. Traffic Safety Council Members discussed the information to be updated on the reference sheet and further that once the reference sheet was updated, that the Legislative Coordinator send it to the school boards.

RECOMMENDATION

That Legislative Coordinator be requested to update the Stakeholder Responsibilities Breakdown Reference Sheet and to distribute to the Dufferin-Peel Catholic District School Board and the Peel District School Board.

Approved (S. Beniuk)

Recommendation TSC-0122-2015

14. Review and approval of the Wilde Wood School Zone Safety Award Application and Process

Peter Westbrook, Chair, spoke to the changes of the Wilde Wood School Zone Safety Award Application and the new time table for which the Wilde Wood School Zone Safety Award would be awarded to the successful schools.

RECOMMENDATION

1. That the new Wilde Wood School Zone Safety Award Application be approved.
2. That the Wilde Wood School Zone Safety Award Application be distributed to The Dufferin-Peel Catholic District Elementary Schools and the Peel District Elementary Schools in the City of Mississauga annually in the second week of October.

Approved (L. Goegan)

Recommendation TSC-0123-2015

15. Review and approval of Traffic Safety Council Terms of Reference

Members discussed amendments to me made, such as the inclusion of Active Transportation staff being part of the Advisory Board, and removal of the Site Plan Review Subcommittee.

RECOMMENDATION

That the Traffic Safety Council Terms of Reference be amended as follows:

- a. That staff from Active Transportation be added as a non-voting member to serve as a resource to the Traffic Safety Council.
- b. Remove the Site Plan Review Subcommittee.

Approved (L. Goegan)

Recommendation TSC-0124-2015

16. Review and approval of the Traffic Safety Council 2015/2016 Workplan

Peter Westbrook, Chair, provided an overview of the items listed on the Workplan and advised that these are items that are currently being worked on and upcoming initiatives. Members were encouraged to think of other initiatives that Traffic Safety Council could undertake in this current workplan or future workplans.

RECOMMENDATION

That the Traffic Safety Council 2015/2016 Workplan be approved.

Approved (S. Beniuk)

Recommendation TSC-0125-2015

OTHER BUSINESS

17. Traffic Safety Council Member Resignation

Angie Melo, Legislative Coordinator, received an email from Traffic Safety Council Citizen Member, Matthew Moore, advising of his resignation from the Traffic Safety Council.

RECOMMENDATION

That the email from Traffic Safety Council Citizen Member, Matthew Moore, dated September 30, 2015, resigning from Traffic Safety Council, be received.

Approved (A. Syed)

Recommendation TSC-0126-2015

18. Traffic Safety Council Citizen Member Seat Vacancy Review

Peter Westbrook, Chair, advised Traffic Safety Council Members, that there is a concern with the lack of attendance of a Traffic Safety Council Citizen Member at meetings and at site inspections. Angie Melo, Legislative Coordinator has reviewed the attendance in accordance with the Council Procedure By-Law 0139-2013 Section 76(1), and will provide Council with the information for their review and consideration.

RECOMMENDATION

That Council be requested to review the seat of a Citizen Member on Traffic Safety Council and declare the seat vacant in accordance with the Council Procedure By-Law 0139-2013 Section 76(1).

Approved (S. Beniuk)

Recommendation TSC-0127-2015

19. Peel Regional Police Representation at Traffic Safety Council Meetings

Traffic Safety Council Members discussed the need of representation from Peel Regional Police at Traffic Safety Council meetings. Councillor McFadden advised that she and Frank Dale (past Councillor Ward 4), met with the Superintendent and Constable Joey Rego, in the past, and that Peel Regional Police advised that they would attend the Traffic Safety Council meetings. Angie Melo, Legislative Coordinator, also advised that she has been in contact with the current Peel Regional Police representative, Peter Brandwood, and that he has advised Angie Melo that he has had scheduling conflicts and has been unable to attend. Peter Brandwood further advised that he will be unavailable to attend Traffic Safety Council meetings for the duration of 2015, but that he will have the Superintendent assign a representative to attend the meetings. Peter Westbrook, Chair, advised that he would contact the Superintendents at 11 and 12 Division to request a representative of Peel Regional Police, Traffic Operations, attend Traffic Safety Council meetings.

RECOMMENDATION

That Peter Westbrook, Chair, Traffic Safety Council contact Peel Regional Police Superintendents of 11 and 12 Divisions, requesting that a representative of Peel Regional Police, Traffic Operations attend Traffic Safety Council meetings.

Approved (Councillor C. Fonseca)

Recommendation TSC-0128-2015

20. Traffic Safety Council Social Media

Councillor Chris Fonseca spoke to the idea of Traffic Safety Council creating a Twitter account, for the purpose of sending out safety messages and messages regarding site inspections results. Councillor Fonseca asked that the Public Information Subcommittee look into the feasibility of a Twitter account for Traffic Safety Council.

RECOMMENDATION

That the Public Information Subcommittee of Traffic Safety Council be requested to research the feasibility of creating a Twitter account for Traffic Safety Council.

Approved (Councillor C. Fonseca)

Recommendation TSC-0129-2015

21. Peel Regional Police School Safety Committee

Sheelagh Duffin, Supervisor, Crossing Guards, provided an update on the Peel Regional Police School Safety Committee and advised that the Committee has now completed the filming of the new video and that a brochure is in draft, but will soon be distributed. Members requested that the Police School Safety Committee be requested to make a presentation of their video and other material, to the Traffic Safety Council at a future meeting.

Recommendation

That the Legislative Coordinator be requested to invite the Peel Regional Police, School Safety Committee, to present the newly created videos on school safety.

Approved (L. Goegan)

Recommendation TSC-0130-2015

OTHER BUSINESS

Date of Next Meeting: October 28, 2015

ADJOURNMENT 6:20 p.m.

Site Inspection Report



Traffic Safety Council

OCT 28 2015

Corporate Services
Office of the City Clerk

Site	
School: Dolphin Sr. Public School	Address: 18 Brookside Dr Mississauga ON L5M 1H3
School Times: 8:30 AM 2:30 PM	Student Population: 500
No. of School Buses: 0	
School: 	Address:
School Times: AM PM	Student Population:
No. of School Buses: 	

Location: (Please identify the location with reference to nearest intersection, indicate nearest school and address)

Queen St & Britannia Rd. W

Date of Inspection: 2015 09 30	Inspection Time: 8:00 AM 2:30 PM	Requested By: Parent
Prepared By: A. Liya	Request For: Safety Review	

Observers

File Number: RT.10	File Number: RT.10	Ward: Ward 11
Observed By: S. Duffin	<input type="checkbox"/> AM <input type="checkbox"/> PM <input checked="" type="checkbox"/> AM & PM	
Observed By: S. Beniuk	<input type="checkbox"/> AM <input type="checkbox"/> PM <input checked="" type="checkbox"/> AM & PM	
Observed By: A. Liya	<input type="checkbox"/> AM <input type="checkbox"/> PM <input checked="" type="checkbox"/> AM & PM	
Observed By: S. Kumra	<input type="checkbox"/> AM <input checked="" type="checkbox"/> PM <input type="checkbox"/> AM & PM	
Observed By: 	<input type="checkbox"/> AM <input type="checkbox"/> PM <input type="checkbox"/> AM & PM	
Observed By: 	<input type="checkbox"/> AM <input type="checkbox"/> PM <input type="checkbox"/> AM & PM	

Details

Weather Conditions:	AM: <input checked="" type="checkbox"/> Dry <input type="checkbox"/> Sunny <input type="checkbox"/> Rain <input type="checkbox"/> Snow <input type="checkbox"/> Other: 12C
	PM: <input checked="" type="checkbox"/> Dry <input checked="" type="checkbox"/> Sunny <input type="checkbox"/> Rain <input type="checkbox"/> Snow <input type="checkbox"/> Other: 17C
Type of Crossing:	<input checked="" type="checkbox"/> 4 Way Intersection <input type="checkbox"/> 3 Way Intersection <input type="checkbox"/> Midblock (i.e., not an intersection)
Type of Control:	<input checked="" type="checkbox"/> Traffic Lights <input type="checkbox"/> Yield Signs <input type="checkbox"/> No Control
	<input type="checkbox"/> Stop Signs (Traffic is stopped on one street only) <input type="checkbox"/> All Way Stop (Traffic is stopped in all directions)

Site Conditions

School Signs:	<input type="checkbox"/> School Area Signs <input type="checkbox"/> School Crossing Signs <input type="checkbox"/> Parking/Stopping Prohibition
Posted Speed Limit:	<input type="checkbox"/> 40 km/hr <input checked="" type="checkbox"/> 50 km/h <input type="checkbox"/> 60 km/hr <input type="checkbox"/> Other:
Visibility of Crossing Pedestrians:	<input type="checkbox"/> Poor <input type="checkbox"/> Fair <input checked="" type="checkbox"/> Good Comments:
Sight Obstructions:	<input type="checkbox"/> Hedges <input type="checkbox"/> Trees <input type="checkbox"/> Fences <input type="checkbox"/> Bus Shelter
	<input type="checkbox"/> Newspaper Boxes <input type="checkbox"/> Other (Specify):
Road Grade:	<input type="checkbox"/> Flat <input type="checkbox"/> Incline <input checked="" type="checkbox"/> Decline West
Road Geometrics:	<input checked="" type="checkbox"/> Straight <input type="checkbox"/> Curved Comments:
Road Width:	<input type="checkbox"/> NA feet/metres Curb to Curb: <input type="checkbox"/> feet/metres Curb to Median: <input type="checkbox"/> feet/metres
Road Conditions:	AM: <input checked="" type="checkbox"/> Dry <input type="checkbox"/> Wet <input type="checkbox"/> Snow Covered <input type="checkbox"/> Ice
	PM: <input checked="" type="checkbox"/> Dry <input type="checkbox"/> Wet <input type="checkbox"/> Snow Covered <input type="checkbox"/> Ice
Sidewalks:	<input type="checkbox"/> Not Present <input checked="" type="checkbox"/> North <input checked="" type="checkbox"/> South <input checked="" type="checkbox"/> East <input checked="" type="checkbox"/> West
Proximity to School:	<input type="checkbox"/> In Front of <input checked="" type="checkbox"/> Within 200 feet/metres
Route Survey:	<input type="checkbox"/> Shopping Area <input type="checkbox"/> Construction <input type="checkbox"/> Driveway <input type="checkbox"/> Parked Vehicle(s)
	<input type="checkbox"/> Transit Bus Stop <input checked="" type="checkbox"/> Underpass West Within 30 feet/metres Other (specify):
Comments / Conflicts:	Intersection has countdown timers and zebra markings. Traffic courteous to crossing pedestrians. No conflicts observed

Crossing Guard Warrant Survey

Location: Queen St & Britannia Rd W

☐ Safe Gap Time Safe Gap Time Calculation (if applicable): $\left(\frac{W}{3.5} + 4 \right)$ = sec.
☒ Signalized Intersection turning traffic count

Morning Intervals

Time (AM)	# of Peds	# of Conflicts	Gaps	# of Gaps
7:45 - 7:50			West Leg	
7:50 - 7:55				
7:55 - 8:00				
8:00 - 8:05	II		IIII	
8:05 - 8:10	III		IIIIIIII	
8:10 - 8:15	IIII		IIII III	
8:15 - 8:20	I,I		IIIIII,IIII	
8:20 - 8:25			IIIIII,IIII	
8:25 - 8:30	III		IIIIII,II	
8:30 - 8:35				
8:35 - 8:40				
8:40 - 8:45				
8:45 - 8:50				
8:50 - 8:55				
8:55 - 9:00				

Afternoon Intervals

Time (PM)	# of Peds	# of Conflicts	Gaps	# of Gaps
2:45 - 2:50				
2:50 - 2:55				
2:55 - 3:00				
3:00 - 3:05				
3:05 - 3:10				
3:10 - 3:15				
3:15 - 3:20				
3:20 - 3:25				
3:25 - 3:30				
3:30 - 3:35			IIII,II	
3:35 - 3:40			IIIIII,IIIIII	
3:40 - 3:45	I,II		II,IIII,IIII	
3:45 - 3:50	I		II,I	
3:50 - 3:55			IIIIII,II,IIII	
3:55 - 4:00	II		II,IIIIII	

Recommendations

1) That the Principal be requested to remind the students to only enter the crosswalk when the white walk signal is present and remind students they must walk their bikes in the crosswalk.

Observations

Volume of Traffic (see Intersection Plan):
 AM: ☐ Heavy ☐ Light ☐ Intermittant PM: ☐ Heavy ☐ Light ☐ Intermittant

Number of Crossing Pedestrians:
 AM: North ☐ East ☐ South ☐ West 16 PM: North ☐ East 24 South 66 West 6

Turning Traffic:
 AM: ☒ Heavy ☐ Light ☐ Intermittant PM: ☐ Heavy ☐ Light ☒ Intermittant

2b DOLPHIN SR P.S. 8:00-8:30 and 2:30-3:00 Safety Review

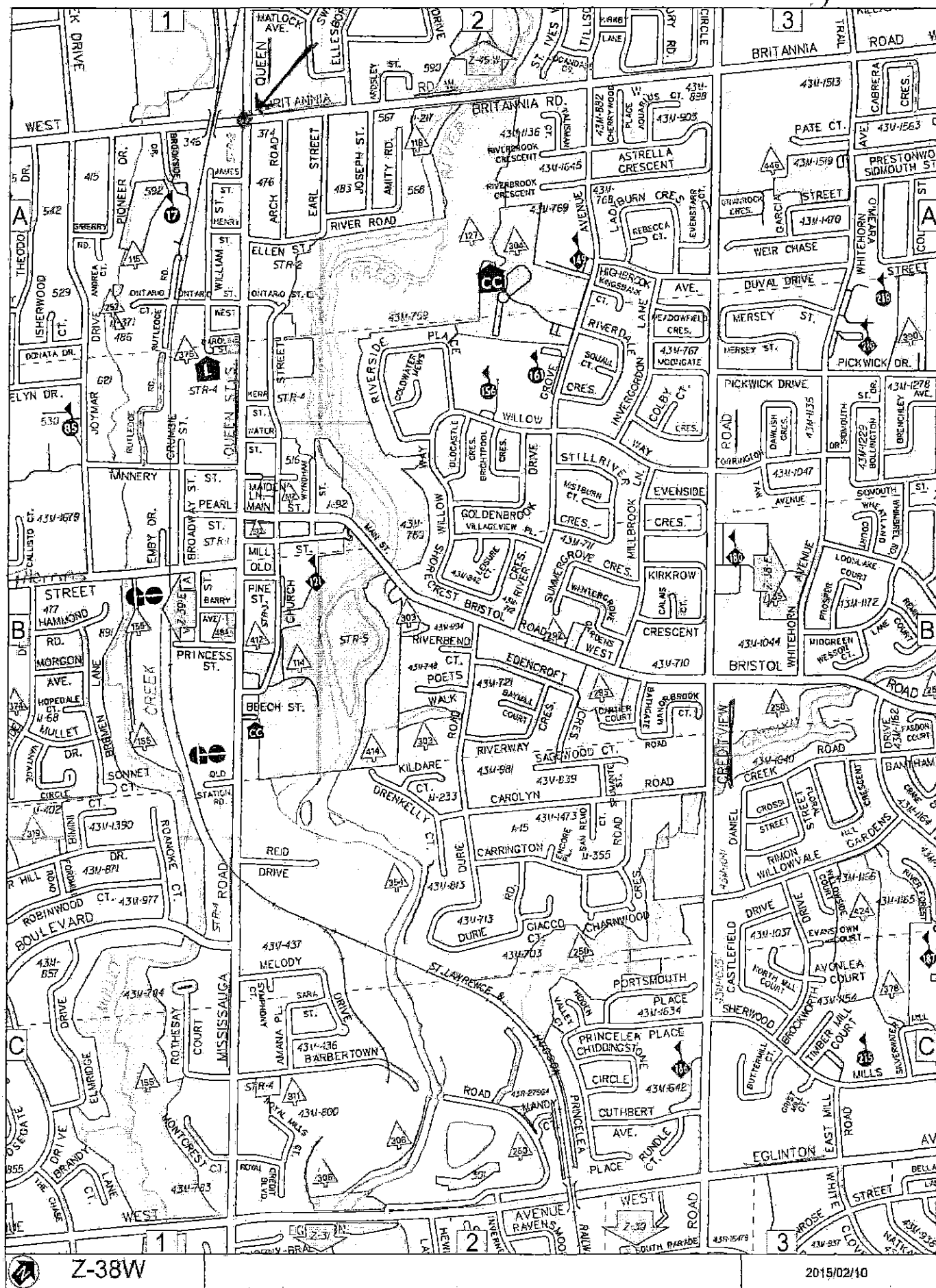

Heather McGuire

Word 11

From: Sheelagh Duffin
Sent: 2015/06/19 12:39 PM
To: Rea, Alison
Cc: Angie Melo; Heather McGuire
Subject: RE: crossing guard needed

Hello Alison,

Thank you for your email.

The mandate of Mississauga Traffic Safety Council is to consider matters related to the safety of students in Mississauga. This includes recommending crossing guards where the warrants are met for students age kindergarten to grade 5. Studies show that students by the age of 10 are able to make good judgements related to traffic and crossing the road.

Traffic Safety Council does, however, conduct safety reviews for all ages of students and make recommendations related to traffic issues and signage. Based on your email, I am assuming that the school you are referring to is Dolphin Senior Public School. Therefore, by copy of this email to Heather McGuire I am requesting that she schedule a Safety Review for the intersection of Queen Street and Britannia Road West for the students of Dolphin Senior Public School for the month of September 2015 when school resumes. The times for the review would be 8:00 – 8:30 am and 2:30 – 3:00 pm.

Thank you. Should you have further questions, please do not hesitate to contact me.

Sheelagh



Sheelagh Duffin
Supervisor, Crossing Guards
T 905-896-5167 | F 905-896-5166
sheelagh.duffin@mississauga.ca

City of Mississauga | Transportation and Works Department,
Works Operations and Maintenance Division
3185 Mavis Road
Mississauga ON L6C 1T7

Please consider the environment before printing.

2d

From: Rea, Alison
Sent: Friday, June 19, 2015 10:43 AM
To: 'heather.mcguire@mississauga.ca'
Subject: crossing guard needed

Hi Heather,

My name is Alison and I just left you a message in regards to my son being hit yesterday at a major intersection in Streetsville. He was crossing the road just around 8 am crossing over Queen st/Mississauga road towards Britannia, he was walking with the walk sign and a car didn't see him and hit him when he turned. My son luckily is okay the driver left the scene and nobody stopped. I am left wondering why there is no crossing guards at such a busy intersection down the street from a middle school, most kids walk or take a Mississauga bus to school (drops them across the street so they still need to cross.) This school is for kids grade 6-8 and I feel its only a matter of time before someone else gets hit there and I would be surprised if this is the first. I drive this way to and from work every day and I myself have been almost hit by people not paying attention or running lights.

Thanks for your time

Alison Rea

Site Inspection Report



Traffic Safety Council

OCT 28 2015

Corporate Services
Office of the City Clerk

Site	
School: Ellengale Public School	Address: 3480 Ellengale Dr Mississauga ON L5C 1Z7
School Times: 9:15 AM 3:45 PM	Student Population: 381
No. of School Buses: 274	BUSED
School:	Address:
School Times:	Student Population:
No. of School Buses:	

Location: (Please identify the location with reference of nearest intersection. Indicate nearest school and address)			
Chada Avenue & Ellengale Drive			
Date of Inspection: 2015 10 08	Inspection Time: 8:45 AM 3:45 PM	Requested By: Councilor Starr	
Prepared By: P. Westbrook	Request For: Crossing Guard & site review		

Observers	
File Number: RT.10	Ward: Ward 6
Observed By: S. Duffin	<input type="checkbox"/> AM <input type="checkbox"/> PM <input checked="" type="checkbox"/> AM & PM
Observed By: M. Sherwani	<input checked="" type="checkbox"/> AM <input type="checkbox"/> PM <input type="checkbox"/> AM & PM
Observed By: A. Syed	<input type="checkbox"/> AM <input checked="" type="checkbox"/> PM <input type="checkbox"/> AM & PM
Observed By: P. Westbrook	<input type="checkbox"/> AM <input type="checkbox"/> PM <input checked="" type="checkbox"/> AM & PM
Observed By: D. Yaunan	<input type="checkbox"/> AM <input type="checkbox"/> PM <input checked="" type="checkbox"/> AM & PM
Observed By:	<input type="checkbox"/> AM <input type="checkbox"/> PM <input type="checkbox"/> AM & PM

Details	
Weather Conditions:	AM: <input checked="" type="checkbox"/> Dry <input type="checkbox"/> Sunny <input type="checkbox"/> Rain <input type="checkbox"/> Snow <input type="checkbox"/> Other: 7C
	PM: <input checked="" type="checkbox"/> Dry <input checked="" type="checkbox"/> Sunny <input type="checkbox"/> Rain <input type="checkbox"/> Snow <input type="checkbox"/> Other: 15C
Type of Crossing:	<input type="checkbox"/> 4 Way Intersection <input type="checkbox"/> 3 Way Intersection <input type="checkbox"/> Midblock (i.e., not an intersection)
Type of Control:	<input type="checkbox"/> Traffic Lights <input type="checkbox"/> Yield Signs <input type="checkbox"/> No Control
	<input type="checkbox"/> Stop Signs (Traffic is stopped on one street only) <input type="checkbox"/> All Way Stop (Traffic is stopped in all directions)

Site Conditions	
School Signs:	<input type="checkbox"/> School Area Signs <input type="checkbox"/> School Crossing Signs <input type="checkbox"/> Parking/Stopping Prohibition
Posted Speed Limit:	<input checked="" type="checkbox"/> 40 km/hr <input type="checkbox"/> 50 km/h <input type="checkbox"/> 60 km/hr <input type="checkbox"/> Other:
Visibility of Crossing Pedestrians:	<input type="checkbox"/> Poor <input type="checkbox"/> Fair <input checked="" type="checkbox"/> Good Comments:
Sight Obstructions:	<input type="checkbox"/> Hedges <input type="checkbox"/> Trees <input type="checkbox"/> Fences <input type="checkbox"/> Bus Shelter
	<input type="checkbox"/> Newspaper Boxes <input type="checkbox"/> Other (Specify):
Road Grade:	<input checked="" type="checkbox"/> Flat <input type="checkbox"/> Incline <input type="checkbox"/> Decline
Road Geometrics:	<input checked="" type="checkbox"/> Straight <input type="checkbox"/> Curved Comments:
Road Width:	26 feet/metres Curb to Curb: feet/metres Curb to Median: feet/metres
Road Conditions:	AM: <input checked="" type="checkbox"/> Dry <input type="checkbox"/> Wet <input type="checkbox"/> Snow Covered <input type="checkbox"/> Ice
	PM: <input checked="" type="checkbox"/> Dry <input type="checkbox"/> Wet <input type="checkbox"/> Snow Covered <input type="checkbox"/> Ice
Sidewalks:	<input type="checkbox"/> Not Present <input checked="" type="checkbox"/> North <input checked="" type="checkbox"/> South <input checked="" type="checkbox"/> East <input checked="" type="checkbox"/> West
Proximity to School:	<input checked="" type="checkbox"/> In Front of <input type="checkbox"/> Within feet/metres
Route Survey:	<input type="checkbox"/> Shopping Area <input type="checkbox"/> Construction <input type="checkbox"/> Driveway <input type="checkbox"/> Parked Vehicle(s)
	<input type="checkbox"/> Transit Bus Stop <input type="checkbox"/> Underpass Within feet/metres Other (specify):
Comments / Conflicts:	72 percent of students are bused. Bus loading signs and no stopping prohibitions in place in front of the school. New on property bus drop-off operational. On street signage should be removed to allow parents to stop/park on school side of the street to avoid parking on

Crossing Guard Warrant Survey

Location: Chada Avenue & Ellengale Dr

☒ Safe Gap TimeSafe Gap Time Calculation (if applicable): $\left(\frac{W}{3.5} + 4 \right)$ 12 = sec.☐ Signalized Intersection turning traffic count.**Morning Intervals**

Time (AM)	# of Peds	# of Conflicts	Gaps	# of Gaps
9:00 - 9:05	II,III,I,I		14,19,60,91,26,46	18
9:05 - 9:10	III		92,84,48	19
9:10 - 9:15	III		50,/,63,/,/,41,39,32,27,15,/,13,25	18
8:00 - 8:05				
8:05 - 8:10				
8:10 - 8:15				
8:15 - 8:20				
8:20 - 8:25				
8:25 - 8:30				
8:30 - 8:35				
8:35 - 8:40				
8:40 - 8:45				
8:45 - 8:50			156	13
8:50 - 8:55	/		108,/,145,22	22
8:55 - 9:00			145,52,/,27,59,/,	22

Afternoon Intervals

Time (PM)	# of Peds	# of Conflicts	Gaps	# of Gaps
2:45 - 2:50				
2:50 - 2:55				
2:55 - 3:00				
3:00 - 3:05				
3:05 - 3:10				
3:10 - 3:15				
3:15 - 3:20				
3:20 - 3:25				
3:25 - 3:30				
3:30 - 3:35				
3:35 - 3:40				
3:40 - 3:45				
3:45 - 3:50	I,II,I,I		18,86,/,53,58,13,/,	17
3:50 - 3:55	/		72,38,65,90,174,136	38
3:55 - 4:00			23,230,50	24

Recommendations

- 1) That the warrants for a crossing guard have not been met
- 2) That Transportation and Works remove the school bus loading zone signs on Ellengale and review signage in front of the school

Observations

Volume of Traffic (see Intersection Plan):

AM: ☐ Heavy ☒ Light ☐ Intermittant PM: ☐ Heavy ☒ Light ☐ Intermittant

Number of Crossing Pedestrians:

AM: North ☐ East ☐ South 15 West ☐ PM: North ☐ East ☐ South 10 West ☐

Turning Traffic:

AM: ☐ Heavy ☐ Light ☐ Intermittant PM: ☐ Heavy ☐ Light ☐ Intermittant

Additional Comments/Conflicts

72 percent of students are bused. Bus loading signs and no stopping prohibitions in place in front of the school. New on property bus drop off operational. On street signage should be removed to allow parents to stop/park on school side of the street to avoid parking on Chada and then having to cross Ellengale. Traffic light on Chada - all school related. No evidence of speeding at either AM or PM school entry or dismissal. Traffic light on Ellengale and school related. No conflicts observed.

Additional Recommendations

3c

Ellengale Dr + Chada Ave - 8:45-9:15 and 3:45-4:15

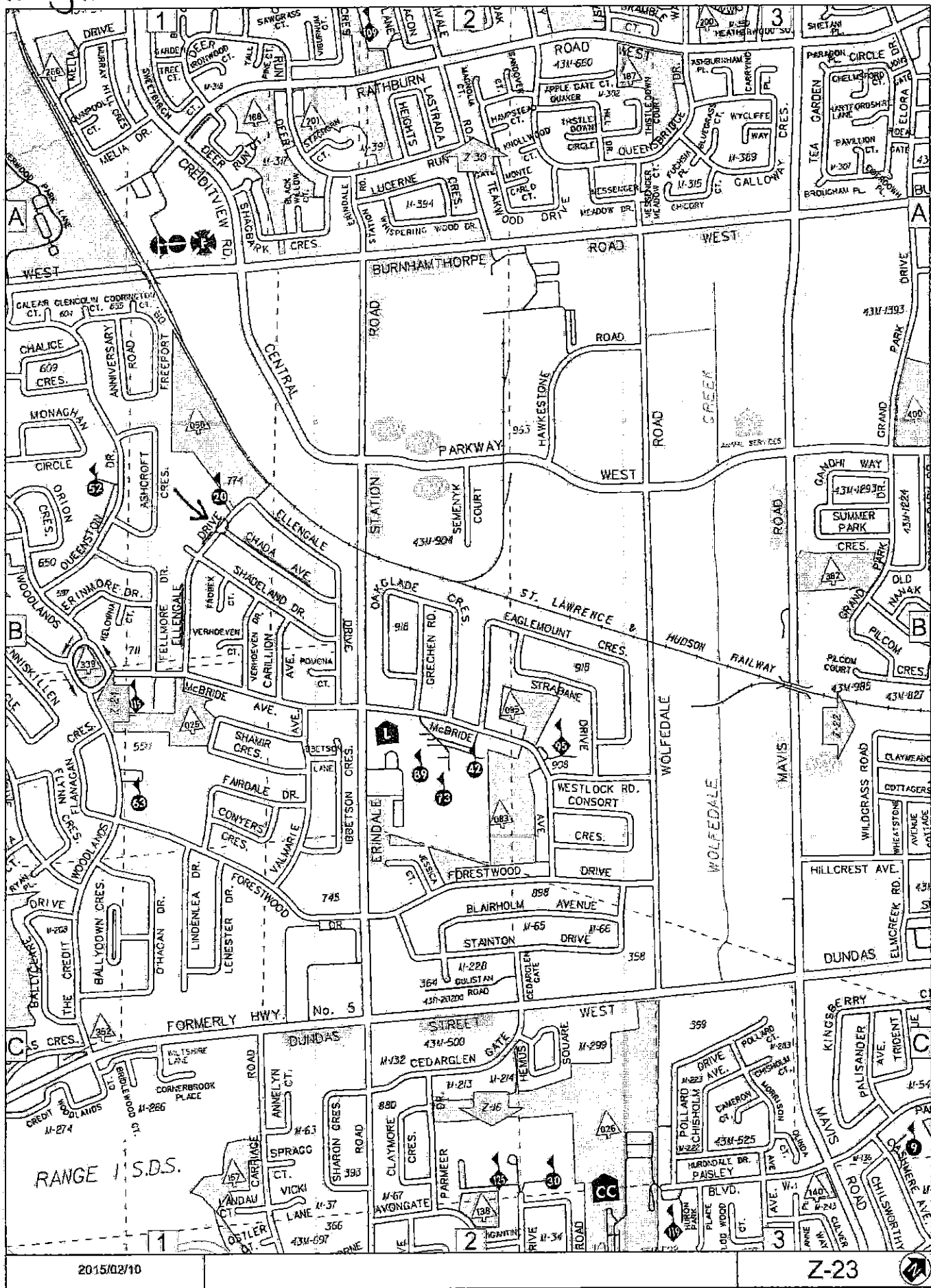

Site Inspection Report



Traffic Safety Council

OCT 28 2015

Corporate Services
Office of the City Clerk

Site	
School: Thornwood Public School	Address: 277 Miss Valley Blvd. Mississauga ON L5A 1Y6
School Times: 8:40 AM 3:10 PM	Student Population: 529
No. of School Buses: 135	Bused
School:	Address:
School Times:	Student Population:
No. of School Buses:	
Location: (Please identify the location with reference of nearest intersection. Indicate nearest school and address)	
Mississauga Valley Blvd & Central Parkway - South leg - N/W corner	
Date of Inspection: 2015 10 13	Inspection Time: 8:10 AM 3:10 PM
Requested By: S. Newing	
Prepared By: T. Coulson	Request For: 3rd crossing guard

Observers	
File Number: RT.10	File Number: RT.10
Ward: Ward 4	
Observed By: S. Duffin	<input type="checkbox"/> AM <input type="checkbox"/> PM <input checked="" type="checkbox"/> AM & PM
Observed By: A. Liya	<input type="checkbox"/> AM <input type="checkbox"/> PM <input checked="" type="checkbox"/> AM & PM
Observed By: T. Coulson	<input type="checkbox"/> AM <input type="checkbox"/> PM <input checked="" type="checkbox"/> AM & PM
Observed By: A. Syed	<input type="checkbox"/> AM <input checked="" type="checkbox"/> PM <input type="checkbox"/> AM & PM
Observed By:	<input type="checkbox"/> AM <input type="checkbox"/> PM <input type="checkbox"/> AM & PM
Observed By:	<input type="checkbox"/> AM <input type="checkbox"/> PM <input type="checkbox"/> AM & PM

Details	
Weather Conditions:	AM: <input checked="" type="checkbox"/> Dry <input type="checkbox"/> Sunny <input type="checkbox"/> Rain <input type="checkbox"/> Snow <input type="checkbox"/> Other: 16C
	PM: <input checked="" type="checkbox"/> Dry <input type="checkbox"/> Sunny <input type="checkbox"/> Rain <input type="checkbox"/> Snow <input type="checkbox"/> Other: 15C
Type of Crossing:	<input checked="" type="checkbox"/> 4 Way Intersection <input type="checkbox"/> 3 Way Intersection <input type="checkbox"/> Midblock (i.e., not an intersection)
Type of Control:	<input checked="" type="checkbox"/> Traffic Lights <input type="checkbox"/> Yield Signs <input type="checkbox"/> No Control
	<input type="checkbox"/> Stop Signs (Traffic is stopped on one street only) <input type="checkbox"/> All Way Stop (Traffic is stopped in all directions)

Site Conditions	
School Signs:	<input type="checkbox"/> School Area Signs <input type="checkbox"/> School Crossing Signs <input type="checkbox"/> Parking/Stopping Prohibition
Posted Speed Limit:	<input type="checkbox"/> 40 km/hr <input checked="" type="checkbox"/> 50 km/hr <input type="checkbox"/> 60 km/hr <input type="checkbox"/> Other:
Visibility of Crossing Pedestrians:	<input type="checkbox"/> Poor <input type="checkbox"/> Fair <input checked="" type="checkbox"/> Good Comments:
Sight Obstructions:	<input type="checkbox"/> Hedges <input type="checkbox"/> Trees <input type="checkbox"/> Fences <input type="checkbox"/> Bus Shelter
	<input type="checkbox"/> Newspaper Boxes <input type="checkbox"/> Other (Specify):
Road Grade:	<input checked="" type="checkbox"/> Flat <input type="checkbox"/> Incline <input type="checkbox"/> Decline
Road Geometrics:	<input checked="" type="checkbox"/> Straight <input type="checkbox"/> Curved Comments:
Road Width:	NA feet/metres Curb to Curb: feet/metres Curb to Median: feet/metres
Road Conditions:	AM: <input checked="" type="checkbox"/> Dry <input type="checkbox"/> Wet <input type="checkbox"/> Snow Covered <input type="checkbox"/> Ice
	PM: <input type="checkbox"/> Dry <input type="checkbox"/> Wet <input type="checkbox"/> Snow Covered <input type="checkbox"/> Ice
Sidewalks:	<input type="checkbox"/> Not Present <input checked="" type="checkbox"/> North <input checked="" type="checkbox"/> South <input checked="" type="checkbox"/> East <input checked="" type="checkbox"/> West
Proximity to School:	<input type="checkbox"/> In Front of <input checked="" type="checkbox"/> Within 750 feet/metres
Route Survey:	<input checked="" type="checkbox"/> Shopping Area <input type="checkbox"/> Construction <input type="checkbox"/> Driveway <input type="checkbox"/> Parked Vehicle(s)
	<input checked="" type="checkbox"/> Transit Bus Stop <input type="checkbox"/> Underpass Within feet/metres Other (specify):
Comments / Conflicts:	Students crossing west to east at Elm Drive lights in AM and East to west in PM instead of crossing north leg of Mississauga Valley Blvd and Central Parkway. Crosswalk well marked - zebra marking and countdown counter in place. No conflicts observed.

49

Crossing Guard Warrant Survey

Location: Mississauga Valley Blvd & Central Parkway - South leg - N7W corner

☐ Safe Gap TimeSafe Gap Time Calculation (if applicable): $\left(\frac{W}{3.5} + 4 \right)$ NA = sec.☒ Signalized Intersection turning traffic count**Morning Intervals**

Time (AM)	# of Peds	# of Conflicts	Gaps	# of Gaps
7:45 - 7:50				
7:50 - 7:55				
7:55 - 8:00				
8:00 - 8:05				
8:05 - 8:10				
8:10 - 8:15	///		///,///	
8:15 - 8:20	///P, /		///,///	
8:20 - 8:25	/		///,///,///	
8:25 - 8:30			///,///	
8:30 - 8:35			///	
8:35 - 8:40			///,///	
8:40 - 8:45				
8:45 - 8:50				
8:50 - 8:55				
8:55 - 9:00				

Afternoon Intervals

Time (PM)	# of Peds	# of Conflicts	Gaps	# of Gaps
2:45 - 2:50				
2:50 - 2:55				
2:55 - 3:00				
3:00 - 3:05				
3:05 - 3:10				
3:10 - 3:15			///, /	
3:15 - 3:20			///,///	
3:20 - 3:25	///P		///,///	
3:25 - 3:30			///,///,///	
3:30 - 3:35			///,///,///	
3:35 - 3:40			///,///	
3:40 - 3:45				
3:45 - 3:50				
3:50 - 3:55				
3:55 - 4:00				

Recommendations

1) That the warrants for a third guard are not met.

Observations

Volume of Traffic (see Intersection Plan):

AM: ☐ Heavy ☐ Light ☐ Intermittant PM: ☐ Heavy ☐ Light ☐ Intermittant

Number of Crossing Pedestrians:

AM: North 7 East South West PM: North 2 East South West

Turning Traffic:

AM: ☐ Heavy ☒ Light ☐ Intermittant PM: ☐ Heavy ☒ Light ☐ Intermittant

Mississauga Valley Blvd + Central Pkwy - South leg - 8:10-8:40 + 3:10-3:40

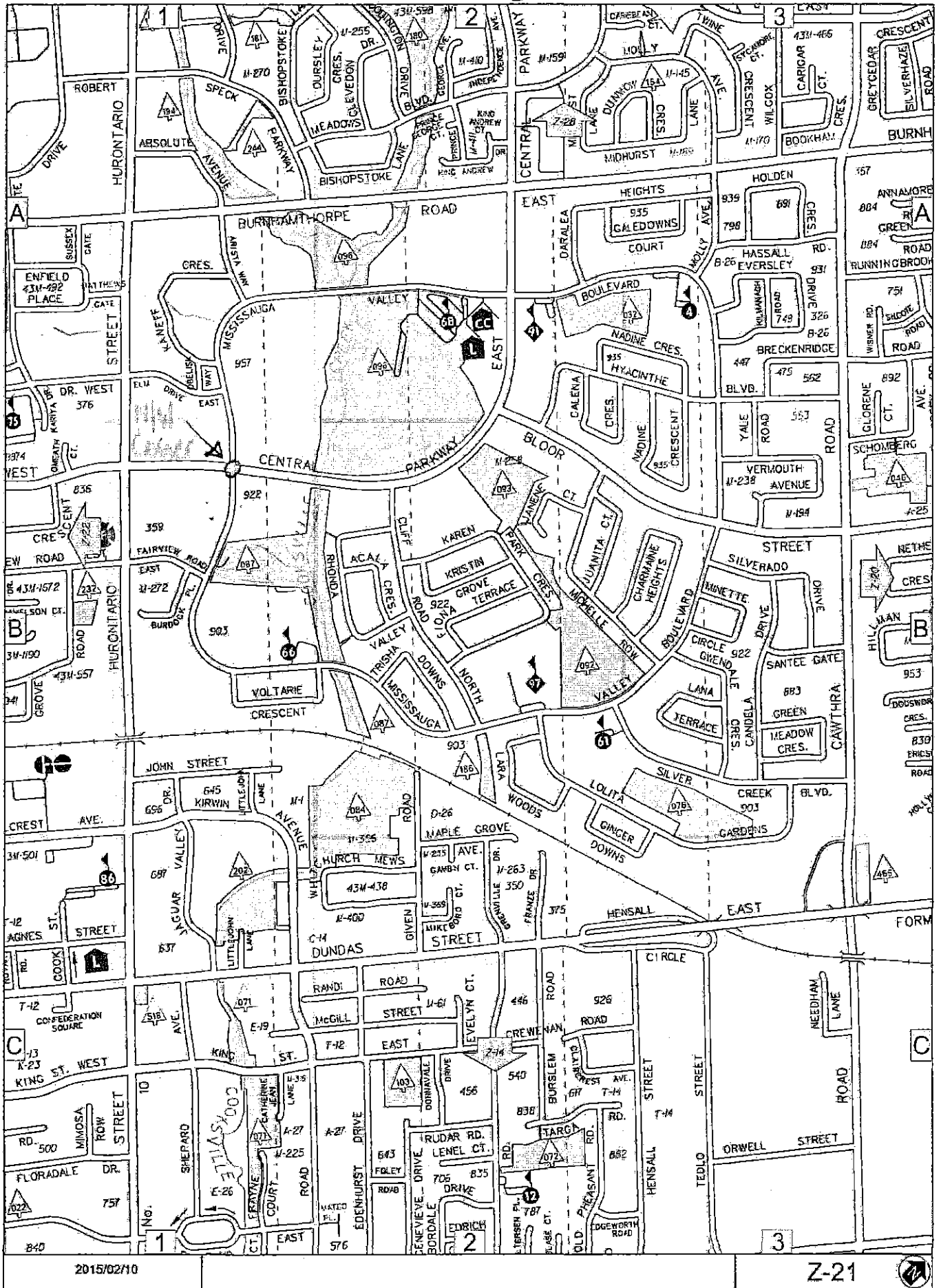

Site Inspection Report



Traffic Safety Council

OCT 28 2015

Corporate Services
Office of the City Clerk

Site	
School: St. Clare Catholic School	Address: 4140 Glen Erin Dr Mississauga ON L5L 2Z3
School Times: 8:30 AM 3:00 PM	Student Population: 275
No. of School Buses: 9	Bused
School: 	Address:
School Times: AM PM	Student Population:
No. of School Buses: 	

Location: (Please identify the location with reference of nearest intersection. Indicate nearest school and address)

4140 Glen Erin Dr. at St. Clare CS and at underpass

Date of Inspection: **2015** **10** **20**

Inspection Time: **8:00 AM** **3:00 PM**

Requested By: **parent**

Prepared By: **A. Liya / D. Suess**

Request For: **Crossing Guard - safety review**

Observers

File Number: RT.10	File Number: RT.10	Ward: Ward 8
Observed By: H. Relf	<input type="checkbox"/> AM <input type="checkbox"/> PM <input checked="" type="checkbox"/> AM & PM	
Observed By: S. Beniuk	<input type="checkbox"/> AM <input type="checkbox"/> PM <input checked="" type="checkbox"/> AM & PM	
Observed By: D. Suess	<input type="checkbox"/> AM <input type="checkbox"/> PM <input checked="" type="checkbox"/> AM & PM	
Observed By: A. Liya	<input type="checkbox"/> AM <input type="checkbox"/> PM <input checked="" type="checkbox"/> AM & PM	
Observed By: S. Duffin	<input type="checkbox"/> AM <input type="checkbox"/> PM <input checked="" type="checkbox"/> AM & PM	
Observed By: 	<input type="checkbox"/> AM <input type="checkbox"/> PM <input type="checkbox"/> AM & PM	

Details

Weather Conditions:	AM: <input type="checkbox"/> Dry <input type="checkbox"/> Sunny <input checked="" type="checkbox"/> Rain <input type="checkbox"/> Snow <input type="checkbox"/> Other: 14C
	PM: <input checked="" type="checkbox"/> Dry <input type="checkbox"/> Sunny <input type="checkbox"/> Rain <input type="checkbox"/> Snow <input type="checkbox"/> Other: 17C
Type of Crossing:	<input type="checkbox"/> 4 Way Intersection <input type="checkbox"/> 3 Way Intersection <input checked="" type="checkbox"/> Midblock (i.e., not an intersection)
Type of Control:	<input type="checkbox"/> Traffic Lights <input type="checkbox"/> Yield Signs <input checked="" type="checkbox"/> No Control
	<input type="checkbox"/> Stop Signs (Traffic is stopped on one street only) <input type="checkbox"/> All Way Stop (Traffic is stopped in all directions)

Site Conditions

School Signs:	<input checked="" type="checkbox"/> School Area Signs <input type="checkbox"/> School Crossing Signs <input type="checkbox"/> Parking/Stopping Prohibition
Posted Speed Limit:	<input checked="" type="checkbox"/> 40 km/hr <input type="checkbox"/> 50 km/h <input type="checkbox"/> 60 km/hr <input type="checkbox"/> Other:
Visibility of Crossing Pedestrians:	<input type="checkbox"/> Poor <input type="checkbox"/> Fair <input checked="" type="checkbox"/> Good Comments:
Sight Obstructions:	<input type="checkbox"/> Hedges <input type="checkbox"/> Trees <input type="checkbox"/> Fences <input type="checkbox"/> Bus Shelter
	<input type="checkbox"/> Newspaper Boxes <input type="checkbox"/> Other (Specify):
Road Grade:	<input checked="" type="checkbox"/> Flat <input type="checkbox"/> Incline <input type="checkbox"/> Decline
Road Geometrics:	<input type="checkbox"/> Straight <input checked="" type="checkbox"/> Curved Comments:
Road Width:	13.7 feet/metres Curb to Curb: feet/metres Curb to Median: 7.6-10.3 feet/metres
Road Conditions:	AM: <input type="checkbox"/> Dry <input type="checkbox"/> Wet <input type="checkbox"/> Snow Covered <input type="checkbox"/> Ice
	PM: <input type="checkbox"/> Dry <input type="checkbox"/> Wet <input type="checkbox"/> Snow Covered <input type="checkbox"/> Ice
Sidewalks:	<input type="checkbox"/> Not Present <input type="checkbox"/> North <input type="checkbox"/> South <input checked="" type="checkbox"/> East <input checked="" type="checkbox"/> West
Proximity to School:	<input checked="" type="checkbox"/> In Front of <input type="checkbox"/> Within feet/metres
Route Survey:	<input type="checkbox"/> Shopping Area <input type="checkbox"/> Construction <input type="checkbox"/> Driveway <input type="checkbox"/> Parked Vehicle(s)
	<input type="checkbox"/> Transit Bus Stop <input type="checkbox"/> Underpass Within feet/metres Other (specify):

Comments / Conflicts: **SEE BELOW**

Crossing Guard Warrant Survey

Location: 4140 Glen Erin Dr in front of the school - SOUTHBOUND

☒ Safe Gap Time Safe Gap Time Calculation (if applicable): $\left(\frac{W}{3.5} + 4 \right)$ 17 = sec.
☐ Signalized Intersection turning traffic count

Morning Intervals

Time (AM)	# of Peds	# of Conflicts	Gaps	# of Gaps
7:45 - 7:50			SOUTHBOUND	
7:50 - 7:55				
7:55 - 8:00				
8:00 - 8:05			,22,19, ,21, ,22,	4
8:05 - 8:10			,31, ,23, ,17, ,18,	4
8:10 - 8:15			,19, , ,18,	2
8:15 - 8:20			,42, ,19, ,23, ,27,24,	5
8:20 - 8:25	/P		,25,	1
8:25 - 8:30	/P			0
8:30 - 8:35				
8:35 - 8:40				
8:40 - 8:45				
8:45 - 8:50				
8:50 - 8:55				
8:55 - 9:00				

Afternoon Intervals

Time (PM)	# of Peds	# of Conflicts	Gaps	# of Gaps
2:45 - 2:50				
2:50 - 2:55				
2:55 - 3:00				
3:00 - 3:05			,30, ,27, ,17, ,34,	5
3:05 - 3:10	//P		,30, ,17, ,19,	3
3:10 - 3:15			,42,22, ,30, ,45,	6
3:15 - 3:20			20,68, ,63, ,21	9
3:20 - 3:25			,23, ,36, ,47, ,70,	9
3:25 - 3:30				
3:30 - 3:35				
3:35 - 3:40				
3:40 - 3:45				
3:45 - 3:50				
3:50 - 3:55				
3:55 - 4:00				

Recommendations

SEE BELOW FOR COMPLETE LIST

Observations

Volume of Traffic (see Intersection Plan):
 AM: ☐ Heavy ☐ Light ☒ Intermittant PM: ☐ Heavy ☐ Light ☒ Intermittant

Number of Crossing Pedestrians:
 AM: North 2P East South West PM: North 2P East South West

Turning Traffic:
 AM: ☐ Heavy ☐ Light ☐ Intermittant PM: ☐ Heavy ☐ Light ☐ Intermittant

5b

Crossing Guard Warrant Survey

Location: 4140 Glen Erin Dr in front of the school - NORTHBOUND

☒ Safe Gap TimeSafe Gap Time Calculation (if applicable): $\left(\frac{W}{3.5} + 4 \right)$ 11 = sec☐ Signalized Intersection turning traffic count**Morning Intervals**

Time (AM)	# of Peds	# of Conflicts	Gaps	# of Gaps
7:45 - 7:50			NORTHBOUND	
7:50 - 7:55				
7:55 - 8:00				
8:00 - 8:05			, 20, //, 18, //, 51, , 35, /, 22, 12, , 40,	18
8:05 - 8:10			26, , 37, /, 38, , 11, 24, /, 32, 18,	14
8:10 - 8:15			53, 15, 19, 15, 19, , 12, 25, 14, /, 14, //, 30,	15
8:15 - 8:20			40, //, 18, //, 12, //, 12, //, 12, 15, 12, //, 33, 45, , 35	18
8:20 - 8:25			//, 34, , 27, //, 44, /, 51, 22, , 12, , 15, /, 15	16
8:25 - 8:30			, 20, //, 15, //, 19, //, 27, 29, , 11, 18, /, 20, //, 18	12
8:30 - 8:35				
8:35 - 8:40				
8:40 - 8:45				
8:45 - 8:50				
8:50 - 8:55				
8:55 - 9:00				

Afternoon Intervals

Time (PM)	# of Peds	# of Conflicts	Gaps	# of Gaps
2:45 - 2:50			NORTHBOUND	
2:50 - 2:55				
2:55 - 3:00				
3:00 - 3:05			26, 26, , 15, 18, , 33, , 49, //, 35, 17, //	13
3:05 - 3:10			11, //, 24, , 20, 35, , 28, , /, 12, /, 16	11
3:10 - 3:15			/, 23, , 11, , 50, , 52, //, 26, //	13
3:15 - 3:20			21, , 22, 50, , 12, //, 23, , 14, , 27, 33	14
3:20 - 3:25			, 25, //, 14, //, 14, , 25, 13, , 16,	8
3:25 - 3:30				
3:30 - 3:35				
3:35 - 3:40				
3:40 - 3:45				
3:45 - 3:50				
3:50 - 3:55				
3:55 - 4:00				

Recommendations

SEE BELOW FOR COMPLETE LIST

Observations

Volume of Traffic (see Intersection Plan):

AM: ☐ Heavy ☐ Light ☒ Intermittant PM: ☐ Heavy ☐ Light ☒ Intermittant

Number of Crossing Pedestrians:

AM: North ☐ East ☐ South ☐ West ☐ PM: North ☐ East ☐ South ☐ West ☐

Turning Traffic:

AM: ☐ Heavy ☐ Light ☐ Intermittant PM: ☐ Heavy ☐ Light ☐ Intermittant

Crossing Guard Warrant Survey

Location: 4140 Glen Erin Dr in front of the school - NORTHBOUND

☒ Safe Gap Time

Safe Gap Time Calculation (If applicable): $\left(\frac{W}{3.5} + 4 \right)$ 11 = sec.

☐ Signalized Intersection turning traffic count

Morning Intervals

Time (AM)	# of Peds	# of Conflicts	Gaps	# of Gaps
7:45 - 7:50			TUNNEL PEDESTRIAN COUNT	
7:50 - 7:55				
7:55 - 8:00				
8:00 - 8:05			//	
8:05 - 8:10			//	
8:10 - 8:15			//	
8:15 - 8:20			////	
8:20 - 8:25			////	
8:25 - 8:30			////////	
8:30 - 8:35				
8:35 - 8:40			* 23	
8:40 - 8:45				
8:45 - 8:50				
8:50 - 8:55				
8:55 - 9:00				

Afternoon Intervals

Time (PM)	# of Peds	# of Conflicts	Gaps	# of Gaps
2:45 - 2:50			TUNNEL PEDESTRIAN COUNT	
2:50 - 2:55				
2:55 - 3:00				
3:00 - 3:05			////	
3:05 - 3:10			////////	
3:10 - 3:15				
3:15 - 3:20				
3:20 - 3:25				
3:25 - 3:30				
3:30 - 3:35			* 28	
3:35 - 3:40				
3:40 - 3:45				
3:45 - 3:50				
3:50 - 3:55				
3:55 - 4:00				

Recommendations

SEE BELOW FOR COMPLETE LIST

Observations

Volume of Traffic (see Intersection Plan):

AM: ☐ Heavy ☐ Light ☒ Intermittant PM: ☐ Heavy ☐ Light ☒ Intermittant

Number of Crossing Pedestrians:

AM: North ☐ East ☐ South ☐ West ☐ PM: North ☐ East ☐ South ☐ West ☐

Turning Traffic:

AM: ☐ Heavy ☐ Light ☐ Intermittant PM: ☐ Heavy ☐ Light ☐ Intermittant

Additional Comments/Conflicts

A few parents parked on Rolling Valley Dr opposite the school and crossed Glen Erin instead of using the tunnel. Most parents and students did use the tunnel. More southbound traffic both AM and PM. Median provides refuge for crossing pedestrians but tunnel still recommended route.

Additional Recommendations

- 1) That the warrants for a crossing guard have not been met
- 2) That Transportation & Works review the signage on Glen Erin Dr & Rolling Valley Dr
- 3) That parking enforcement be requested to enforce No Stopping zones on Glen Erin & Rolling Valley 8:15 - 8:30 AM and 2:50 - 3:15 PM once correct signage in place
- 4) That the principal be requested to advise all parents to use either the Kiss and Ride or cross Glen Erin Dr. at the tunnel.
- 5) That Peel Regional Police be requested to enforce speeding on Glen Erin Dr from 8:00 - 8:30 AM and 3:00 - 3:30 PM.

Angie Melo

6.1

From: Sheelagh Duffin
Sent: 2015/10/22 11:51 AM
To: margaretfleese
Cc: Angie Melo; Heather McGuire
Subject: RE: Dangerous intersection: Paisley Blvd. W and Pollard Drive



Hello Ms. Fleese,

By copy of this email to Heather McGuire I am requesting that she schedule a site inspection at Paisley Boulevard and Pollard Drive for the students of St. Jerome Catholic School to determine if the warrants are met for the implementation of a school crossing guard as well as to review existing signage and markings. The times for the inspection are 8:45 – 9:15 am and 3:45 – 4:15 pm.

Thank you. You will be notified of the date of the inspection should you wish to attend.

Sheelagh



Sheelagh Duffin
Supervisor, Crossing Guards
T 905-896-5167 | F 905-896-5166
sheelagh.duffin@mississauga.ca

City of Mississauga | Transportation and Works Department,
Works Operations and Maintenance Division
3185 Mavis Road
Mississauga ON L5C 1T7

Please consider the environment before printing.

From: Angie Melo
Sent: 2015/09/30 2:12 PM
To: Sheelagh Duffin
Subject: FW: Dangerous intersection: Paisley Blvd. W and Pollard Drive

For review and consideration for a site inspection.

Thank you
Angie



Angie Melo
Legislative Coordinator
T 905-615-3200 ext 5423
angie.melo@mississauga.ca

City of Mississauga | Corporate Services Department,
Legislative Services Division

Please consider the environment before printing.

From: Margaret Fleese
Sent: 2015/09/29 3:06 PM
To: Heather Relf; Angie Melo

6.1a Cc: Angela Aquino; Margaret Fleese; Kevin Hickey
Subject: Dangerous intersection: Paisley Blvd. W and Pollard Drive

Attention : Traffic Safety Council of Mississauga

My name is Margaret Fleese and I live at [redacted] My two children attend St. Jerome School Elementary School (790 Paisley Blvd. W) I am asking for your assistance because I am extremely concerned about the intersection of Paisley Blvd W and Pollard Drive.

A number of children, including my own two children, cross Paisley every day to attend school. Currently there is no crossing guard, no cross walk, and no signs to alert drivers that young children are crossing this busy street daily to get to school. There are students from the local high school and people wanting to get to Huron Park that speed down Paisley without regard for any of the children crossing. To compound the problem, the City of Mississauga have added two additional bus routes that go into Huron Park. There has been a significant increase in traffic and the crossing situation is getting very dangerous for our children. I have had personally two situations where one of my children was almost hit by a speeding car.

I would desperately ask if someone from your office could come out and assess this situation in our neighbourhood to see if this intersection is eligible for a crossing guard or some sort of traffic signage.

Thank you for your consideration,

Margaret Fleese

Angie Melo

6.2

From: Sheelagh Duffin
Sent: 2015/10/22 11:42 AM
To: Heather McGuire
Cc: Angie Melo; Andy Bate
Subject: RE: SR 3104678Meadowvale Secondary School crossings - Ref. W10- 20362350



Hi Heather,

Would you kindly schedule a Safety Review in front of Meadowvale Public School to address the issues as per Councillor Saito's email for both Meadowvale SS and Edenwood Middle School.

The times for the inspection would be 8:00 – 8:30 am and 2:30 – 3:15 pm.

Thank you.

Sheelagh
5167



Sheelagh Duffin
Supervisor, Crossing Guards
T 905-896-5167 | F 905-896-5166
sheelagh.duffin@mississauga.ca

City of Mississauga | Transportation and Works Department,
Works Operations and Maintenance Division
3185 Mavis Road
Mississauga ON L5C 1T7

Please consider the environment before printing.

From: Angie Melo
Sent: 2015/09/17 2:18 PM
To: Sheelagh Duffin
Subject: FW: SR 3104678Meadowvale Secondary School crossings - Ref. W10- 20362350
Importance: High

Councillor Saito is requesting assistance of Traffic Safety Council on this matter. Can you please review the request.

Thank you



Angie Melo
Legislative Coordinator
T 905-615-3200 ext.5423
angie.melo@mississauga.ca

City of Mississauga | Corporate Services Department,
Legislative Services Division

Please consider the environment before printing.

6.29

From: Kimberley Leslie
Sent: 2015/09/17 1:52 PM
To: Andy Bate
Cc: Angie Melo
Subject: SR 3104678Meadowvale Secondary School crossings - Ref. W10- 20362350
Importance: High

More info re: the SR I created this morning as per attached

From: Pat Saito
Sent: 2015/09/17 12:20 PM
To: Andy Bate; Kimberley Leslie; Angie Melo
Subject: UPDATED Action: Meadowvale Secondary School crossings - Ref. W10- 20362350
Importance: High

Good afternoon,
Further to yesterday's request, please see updated comments from resident below and note Councillor Saito is also requesting the assistance of Traffic Safety Council.

I had a better look this morning my update being; clear markings on Battleford and Edenwood Drive intersection, but no markings on the speed bump crossing on Edenwood Dr. adjacent to Meadowvale Secondary School where there is a paved path to cross plus students are cutting across at entrance to same school a few yards from the speed bump. I am not sure but does the middle school have the same start time as the high school because much chaos in the morning and noticed students walking across here to go to the middle school...since this is where cars turn left to drop off students near front doors, it becomes very dangerous navigating on-coming traffic and these middle school students at the same time who are crossing where there is no designated Crosswalk.

From: Pat Saito
Sent: September 16, 2015 4:19 PM
To: Andy Bate; Kimberley Leslie
Subject: Action: Meadowvale Secondary School crossings - Ref. W10- 20362350

Hello,
Please have staff investigate, take appropriate action and provide Councillor Saito with a follow-up response. Your assistance is appreciated.

Ref. W10- 20362350
also would like to bring up a dangerous school crossing or lack of proper markings for one in front of Meadowvale S.S.

There are many students jay-walking and I feel it is partially
Due to no markings on road to designate a proper school crossing. It came to my attention as I now am responsible to drop off my friend's son every morning to same school.

Thank you kindly,
Michelle Stefancic, ext. 5900
Administrative Assistant
Ward 9 Councillor Pat Saito

"This e-mail may not be forwarded to anyone for any reason without express written permission of the author."

Traffic Safety Council
OCT 28 2015

Year
Month

2015
9

2015
September

School Name	Offence Code	Values	
		Issued Tickets	Total Visits
All Saints	43	1	0
	(blank)		1
Artesian Drive	7	43	0
	42	5	1
	43	4	2
Barondale	27	1	1
	43	4	2
	(blank)		1
Brandon Gate	43	5	2
	(blank)		1
Brian W Fleming	2	1	0
	43	11	4
	(blank)		1
Briarwood		4	3
Bristol Rd. Middle	(blank)		1
Britannia	15	1	0
	27	1	1
	42	3	0
	43	16	3
	(blank)		1
Brookmede	43	2	1
	(blank)		2
Burnhamthorpe	27	1	0
	42	1	0
	43	15	4
	(blank)		1
Camilla Road Sr.	12	1	1
	43	1	0
	(blank)		4
Canadian Martyrs	43	4	2
	(blank)		3
Cashmere Ave	43	6	2
Castlebridge	27	1	1
	43	1	1
Champlain Trail	43	1	1
Christ The King Catholic	27	1	1
	43	1	1
Corliss	(blank)		1

79

Year
Month

2015
9

2015
September

School Name	Offence Code	Values	
		Issued Tickets	Total Visits
Corpus Christi	27	1	1
Corsair	(blank)		1
Credit Valley	17	1	1
	27	3	2
	42	1	0
Darcel Ave Sr.	(blank)		2
Divine Mercy	43	1	0
	(blank)		1
Dixie	(blank)		3
Dolphin Sr.	7	1	1
	(blank)		7
Dunrankin Drive	7	1	0
	15	1	1
	43	4	1
Edenrose	27	7	4
	43	3	1
	(blank)		1
Erin Centre Middle	17	1	1
	43	2	0
	(blank)		4
Erin Mills Middle	42	1	1
Fairview	17	1	0
	42	2	1
	43	14	3
	(blank)		0
Fairwind Sr	43	2	0
	(blank)		1
Fallingbrook Middle	(blank)		2
Floradale	43	1	1
Forest Ave	42	2	1
	(blank)		2
Forest Glen	43	5	1
Glenhaven Sr	43	1	1
Hawthorn	42	4	1
Hazel McCallion Sr.	27	1	0
	43	2	2
Hillcrest Middle	7	1	1
	(blank)		0
Holy Cross	(blank)		1

7.6

Year
Month

2015
9

2015
September

School Name	Offence Code	Values	
		Issued Tickets	Total Visits
Huntington Ridge	17	2	1
	43	8	1
	(blank)		1
Janet I McDougald	(blank)		2
Kenollie	7	2	1
	15	1	1
	27	1	1
Kindree	43	4	1
	(blank)		1
	(blank)		1
King's Masting	(blank)		1
Lancaster	27	1	1
	(blank)		3
	(blank)		1
Levi Creek	17	1	1
Lorne Park	43	2	1
Maple Wood	43	3	1
Marvin Heights	35	1	0
	(blank)		2
	(blank)		1
Mary Fix Catholic	(blank)		1
McKinnon	43	4	1
	(blank)		1
	(blank)		1
Meadowvale Village	15	1	1
	(blank)		2
	(blank)		1
Mentor College	15	2	0
	26	1	0
	42	17	1
	43	3	1
	(blank)		1
Metropolitan Andrei Catholic	43	1	1
Middlebury	43	4	1
Mineola	(blank)		4
Morning Star Middle	42	1	1
	(blank)		2
	(blank)		1
Munden Park	43	3	2
	(blank)		1
	(blank)		1
Nahani Way	7	1	1
	43	1	1
	(blank)		1
Oscar Peterson	3	1	1
	12	1	1
	(blank)		1

7c

Year
Month

2015
9

2015
September

School Name	Offence Code	Values	
		Issued Tickets	Total Visits
Oscar Peterson	27	1	1
	43	8	2
	(blank)		2
Osprey Woods	43	8	4
	(blank)		1
Our Lady of Good Voyage	24	1	1
	43	1	0
Our Lady of Mt. Carmel	43	1	1
	(blank)		1
Pheasant Run	(blank)		1
Plum Tree Park	4	2	1
	42	1	1
	43	9	5
	(blank)		5
Queen Elizabeth Sr	(blank)		1
Queenston Dr	(blank)		1
Rick Hansen	43	1	1
Ridgewood	27	1	1
	43	5	2
	(blank)		1
Riverside	(blank)		1
Ruth Thompson Middle	(blank)		1
San Lorenzo Ruiz	43	3	1
Shelter Bay	37	1	1
	43	2	1
	(blank)		1
Sherwood Mills	27	4	3
	43	2	1
	(blank)		1
Silver Creek	12	1	0
	42	1	0
	(blank)		1
St. Albert of Jerusalem	43	1	1
St. Alfred	27	1	0
	43	5	1
St. Barbara	17	1	1
	(blank)		1
St. Basil	26	1	1
	43	1	1

7d

Year
Month

2015
9

2015
September

School Name	Offence Code	Values	
		Issued Tickets	Total Visits
St. Basil	(blank)		0
St. Bernadette	27	1	1
	43	3	1
St. Bernard of Clairvaux Catholic	43	3	1
	(blank)		1
St. Charles Garnier	(blank)		1
St. Clare	(blank)		1
St. David of Wales	29	1	1
	42	2	1
	(blank)		0
St. Dominic	(blank)		1
St. Dunstan	(blank)		1
St. Edmund	27	1	1
	42	1	0
	43	6	2
	(blank)		1
St. Faustina	(blank)		1
St. Gertrude	43	3	2
St. Gregory	(blank)		1
St. Helen	(blank)		1
St. Herbert	27	3	2
	43	1	0
	(blank)		2
St. Hilary	(blank)		1
St. John of the Cross	17	1	1
	27	2	1
	43	1	0
	(blank)		1
St. Joseph (Mississauga)	42	1	1
St. Jude	8	1	1
	27	2	0
	43	1	1
	(blank)		1
St. Julia Catholic	12	1	0
	43	8	4
St. Louis	(blank)		1
St. Luke Catholic	43	1	1
	(blank)		0
St. Margaret of Scotland	17	1	1

7e

Year
Month

2015
9

2015
September

School Name	Offence Code	Values	
		Issued Tickets	Total Visits
St. Margaret of Scotland	43	2	1
	(blank)		1
St. Martin	3	1	1
	42	4	1
St. Matthew	43	2	1
St. Philip	(blank)		2
St. Pio of Pietrelcina	43	2	2
St. Raphael	42	2	1
	(blank)		1
St. Raymond	43	1	1
	(blank)		1
St. Richard	43	2	1
St. Rose of Lima	(blank)		1
St. Sebastian Catholic	3	1	0
	24	1	1
	42	10	1
	43	2	0
St. Simon Stock	17	1	1
	(blank)		1
St. Sofia	43	1	1
St. Teresa of Avila	43	1	1
St. Therese of the Child Jesus	(blank)		1
St. Veronica	(blank)		2
St. Vincent de Paul	(blank)		1
Streetsville	43	1	1
	(blank)		1
Sts. Martha & Mary	43	1	1
	(blank)		1
Sts. Peter & Paul	43	1	1
The Woodlands	27	1	1
	(blank)		2
The Valleys Sr	42	1	0
	(blank)		4
Thomas Street Middle	27	1	1
Thornwood	24	1	1
	43	1	0
Trelawny	43	11	4
	(blank)		1
Vista Heights	7	1	0

7-f

Year
Month

2015
9

2015
September

School Name	Offence Code	Values	
		Issued Tickets	Total Visits
Vista Heights	12	2	1
	24	1	0
	27	1	1
	42	1	1
	43	9	3
	(blank)		3
Westacres	43	2	1
Whitehorn	43	17	4
	(blank)		2
Whiteoaks	(blank)		1
Willow Way	27	2	1
	43	4	2
Silverthorn	43	2	1
	(blank)		1
Holy Name of Mary	43	1	1
David Leeder Middle	(blank)		1
Olive Grove	43	2	0
	(blank)		1
Ascension Of Our Lord	43	1	0
	(blank)		2
Garthwood Park	27	6	3
	(blank)		1
Loyola Catholic	(blank)		2
Grand Total		479	314

8

TRAFFIC SAFETY COUNCIL
Transportation and Works - Action Items

September			
Reference	School / Location	Item	Action
TSC-0119-2015	Levi Creek Public School	3. That Transportation and Works be requested to conduct a speed study on Westbridge Way to include 8:45 to 9:15 a.m. time period and if warranted, request that Peel Regional Police enforce speeding violations on Westbridge Way for students attending Levi Creek Public School	Speed Study Scheduled

Traffic Safety Council
OCT 28 2015

City of Mississauga
Memorandum



To: Members of Traffic Safety Council and Advisory Board Staff

From: Angie Melo, Legislative Coordinator

Date: October 22, 2015

Subject: 2016 Traffic Safety Council Meeting Dates

Please find listed the meeting dates for Traffic Safety Council in 2015:

January 27, 2016
February 24, 2016
March 23, 2016
April 27, 2016
May 25, 2016
June 22, 2016
September 28, 2016
October 26, 2016
November 23, 2016

All meetings are scheduled for 5:00 p.m. in the Hearing Room (next to Council Chambers, south end) 2nd Floor, Mississauga Civic Centre. Please ensure that the above dates are noted in your calendar.

Angie Melo
Legislative Coordinator
(905) 615-3200 ext. 5423