



AGENDA

TRAFFIC SAFETY COUNCIL

THE CORPORATION OF THE CITY OF MISSISSAUGA
WEDNESDAY, JUNE 24, 2015 – 5:00 P.M.

COMMITTEE ROOM 'A', SECOND FLOOR
300 CITY CENTRE DRIVE, MISSISSAUGA, ONTARIO L5B 3C1
MISSISSAUGA, ONTARIO
www.mississauga.ca

Members

Councillor Sue McFadden, Ward 10
Councillor Chris Fonseca, Ward 3
Anna Abbruscato, Trustee Ward 4 - Dufferin-Peel Catholic District School Board
Robert Crocker, Trustee Ward 6 & 11 - Peel District School Board
Sandra Beniuk, Citizen Member, Ward 8
Fabio Bertucci, Citizen Member, Ward 6
Tamara Coulson, Citizen Member, Ward 4
Louise Goegan, Citizen Member, Ward 5
Denise Gordon-Mohamud, Citizen Member, Ward 10
Sushil Kumra, Citizen Member, Ward 8
Matthew Moore, Citizen Member, Ward 10
Heather Relf, Vice-Chair, Citizen Member, Ward 9
Ajay Sharma, Citizen Member, Ward 10
Mashkoor Sherwani, Citizen Member, Ward 3
Daniel Suess, Citizen Member, Ward 7
Boris Swedak, Life Member, Ward 3
Altamash Syed, Citizen Member, Ward 4
Katherine Vukobrat, Citizen Member, Ward 9
Peter Westbrook, Chair, Citizen Member, Ward 2

Advisory Board

Andy Bate, Supervisor, Traffic Operations
Denna Yaunan, Traffic Operations Technician
Sheelagh Duffin, Supervisor, Crossing Guards
Barry Foley, Manager, Parking Enforcement
Cst. Peter Brandwood, Peel Regional Police
Daniel Elias, Principals'/Vice-Principals' Association Peel District School Board
Shawn Kearns, Principals'/Vice-Principals' Association Dufferin-Peel Catholic District School Board
Anna Gentile, Student Transportation and Marcy Macina, Student Transportation
Erica Warsh, Transportation Demand Management Coordinator

Contact: Angie Melo, Legislative Coordinator
Office of the Clerk 905-615-3200 ext. 5423 Fax 905-615-4181
angie.melo@mississauga.ca

INDEX – TRAFFIC SAFETY COUNCIL – June 24, 2015CALL TO ORDERDECLARATIONS OF CONFLICT OF INTERESTPRESENTATIONS / DEPUTATIONS

Rajv Sawhney resident, with respect to walking route safety concerns associated with the removal of school bus service for students attending Meadowvale Village Public School.

MATTERS TO BE CONSIDERED

1. Approval of May 27, 2015 Minutes
2. Site Inspection Reports – St. Julia Catholic School (Ward 11)
3. Site Inspection Report – St. David of Wales (Ward 6)
4. Site Inspection Report – Blessed Teresa of Calcutta Catholic School and Silverthorn Public School (Ward 3)
5. Site Inspection Report – St. Francis of Assisi Catholic School, Sheridan Park Public School and Thorn Lodge Public School (Ward 2)
6. Site Inspection Report – Corliss Public School and Holy Cross Catholic School (Ward 5)
7. Site Inspection Requests
8. Parking Enforcement in School Zones Report for May 2015
9. Transportation and Works Action Items List – May and June 2015
10. Peel Regional Police School Safety Committee

CALL TO ORDERDECLARATIONS OF CONFLICT OF INTERESTPRESENTATIONS / DEPUTATIONS

Rajv Sawhney, resident with respect to walking route safety concerns associated with the removal of school bus service for students attending Meadowvale Village Public School.

MATTERS TO BE CONSIDERED1. Approval of May 27, 2015 Minutes

Minutes of the Traffic Safety Council meeting held on May 27, 2015

2. Site Inspection Reports – St. Julia Catholic School (Ward 11)

Site Inspection Reports for the site inspections conducted as follows:

- a) Site inspections conducted on June 4, 2015 at the intersection of Lamplight Way and Historic Trail;
- b) Site inspections conducted on June 10, 2015 at the intersection of Sombrero Way and Nimbus Gate; and
- c) Site inspections conducted on June 10, 2015 at the intersection of Sombrero Way and Harmony Hill.

RECOMMENDATION

1. That the request for a crossing guard at the intersection of Lamplight Way and Historic Trail, Sombrero Way and Nimbus Gate, and Sombrero Way and Harmony Hill, for students attending St. Julia Catholic School be denied as the warrants are not met.
2. That Transportation and Works be requested to install "No Stopping" corner prohibitions on Historic Trail and Lamplight Way, and on the south side of Lamplight Way across from the intersection for students attending St. Julia Catholic School.
3. That Parking Enforcement staff be requested to enforce "No Stopping" prohibitions from 3:10 p.m. to 3:30 p.m. at Historic Trail and Lamplight Way, and on the south side of Lamplight Way across from the intersection, once "No Stopping" signage is in place, for students attending St. Julia Catholic School.

RECOMMEND APPROVAL

3. Site Inspection Report – St. David of Wales Catholic School (Ward 6)

Site Inspection Report for site inspections conducted on May 21, 2015 at the intersection of Rathburn Road and Perivale Road for the students attending St. David of Wales Catholic School.

RECOMMENDATION

That the request for a crossing guard at the intersection of Rathburn Road and Perivale Road for the students attending St. David of Wales Catholic School be denied as the warrants are not met.

RECOMMEND APPROVAL

4. Site Inspection Report – Blessed Teresa of Calcutta Catholic School and Silverthorn Public School (Ward 3)

Site Inspection Report for site inspections conducted on June 11, 2015 at the intersection of Tomken Road and Runningbrook Drive for the students attending Blessed Teresa of Calcutta Catholic School and Silverthorn Public School.

RECOMMENDATION

That the request for a crossing guard at the intersection of Tomken Road and Runningbrook Drive for the students attending Blessed Teresa of Calcutta Catholic School and Silverthorn Public School be denied as the warrants are not met.

RECOMMEND APPROVAL

5. Site Inspection Report – St. Francis of Assisi Catholic School, Sheridan Park Public School, and Thorn Lodge Public School (Ward 2)

Site Inspection Report for the site inspections conducted on June 17, 2015 at the intersection of Homelands Drive and Barcella Crescent for the students attending St. Francis of Assisi Catholic School, Sheridan Park Public School and Thorn Lodge Public School

RECOMMENDATION

1. That the request for a crossing guard at the intersection of Homelands Drive and Barcella Crescent for students attending St. Francis of Assisi Catholic School, Sheridan Park Public School and Thorn Lodge Public School be denied as the warrants are not met.

2. That Transportation and Works be requested to review the feasibility of extending the No U Turn zone and review all other signage in front of Homelands Senior Public School.
3. That Peel Regional Police be requested to monitor and enforce speeding violations in the school zone between 3:00 p.m. and 3:30 p.m. for students attending St. Francis of Assisi Catholic School, Sheridan Park Public School and Thorn Lodge Public School.

RECOMMEND APPROVAL

6. Site Inspection Report – Corliss Public School and Holy Cross Catholic School (Ward 5)

Site Inspection report for site inspections conducted on June 18, 2015 at the intersection of Darcel Avenue and Brandon Gate Drive for students attending Corliss Public School and Holy Cross Catholic School.

RECOMMENDATION

That the request for a crossing guard at the intersection of intersection of Darcel Avenue and Brandon Gate Drive for students attending Corliss Public School and Holy Cross Catholic School be denied as the warrants are not met.

RECOMMEND APPROVAL

7. Site Inspection Requests

- 7.1 A request for a safety review at Canadian Martyrs Catholic School received from Councillor John Kovac on behalf of parents expressing their concerns with on-street parking, parking on school property and the Kiss & Ride area.
- 7.2 Email dated June 19, 2015 from Alison Rea requesting the placement of a crossing guard at the intersection of Britannia Road West and Queen Street for students attending Dolphin Senior Public School.

RECOMMEND RECEIPT/REFERRAL

8. Parking Enforcement in School Zones for May 2015

A report from the Manager of Parking Enforcement with respect to parking enforcement in school zones for the month of May 2015.

RECOMMEND RECEIPT

9. Peel Regional Police, Operational Planning Bureau's School Safety Committee

Sheelagh Duffin, Supervisor, Crossing Guards, who is a member of the Peel Regional Police School Safety Committee, will provide an overview of the initiatives of the Committee and an update on the draft brochure that is currently being developed.

RECOMMEND RECEIPT

10. Transportation and Works Action Items List – May 2015

Action Items List from the Transportation and Works Department for the months of May and June 2015.

RECOMMEND RECEIPT

OTHER BUSINESS

Date of Next Meeting: September 23, 2015

ADJOURNMENT



MINUTES

TRAFFIC SAFETY COUNCIL

THE CORPORATION OF THE CITY OF MISSISSAUGA
WEDNESDAY, MAY 27, 2015 – 5:00 P.M.

COMMITTEE ROOM 'A', SECOND FLOOR
300 CITY CENTRE DRIVE, MISSISSAUGA, ONTARIO L5B 3C1
MISSISSAUGA, ONTARIO
www.mississauga.ca

Members Present

Councillor Sue McFadden, Ward 10
Councillor Chris Fonseca, Ward 3
Robert Crocker, Trustee Ward 6 & 11 - Peel District School Board
Sandra Beniuk, Citizen Member, Ward 8
Tamara Coulson, Citizen Member, Ward 4
Louise Goegan, Citizen Member, Ward 5
Denise Gordon-Mohamud, Citizen Member, Ward 10 North Zone
Heather Relf, Vice-Chair, Citizen Member, Ward 9
Mashkoor Sherwani, Citizen Member, Ward 3
Daniel Suess, Citizen Member, Ward 7
Altamash Syed, Citizen Member, Ward 4 South Zone
Katherine Vukobrat, Citizen Member, Ward 9
Peter Westbrook, Chair, Citizen Member, Ward 2

Members Absent

Anna Abbruscato, Trustee Ward 4 -Dufferin-Peel Catholic District School Board
Fabio Bertucci, Citizen Member, Ward 6
Sushil Kumra, Citizen Member
Boris Swedak, Life Member, Ward 3
Katherine Vukobrat, Citizen Member, Ward 9

Advisory Board Present

Al Sousa, Manager, Traffic Engineering and Operations
Denna Yaunan, Traffic Operations Technician
Alex Liya, Traffic Operations Technician
Barry Foley, Manager, Parking Enforcement
Kevin Kealy, Supervisor, Parking Enforcement

Contact: Angie Melo, Legislative Coordinator
Office of the Clerk 905-615-3200 ext. 5423 Fax 905-615-4181
angie.melo@mississauga.ca

CALL TO ORDER - 5:07 p.m.

DECLARATIONS OF CONFLICT OF INTEREST - NIL

PRESENTATIONS

Grace Vivilecchia, resident, outlined in a PowerPoint presentation the safety concerns that parents of students attending St. Julia Catholic School have with respect to crossings, condition of sidewalks and curbs, and traffic congestion along the routes where children would be walking as of September 2015, as a result of Student Transportation of Peel Region's (STOPR) decision to remove bussing service to students attending St. Julia Catholic School and Meadowvale Village Public School.

Robert Crocker, Peel District School Board Trustee advised that parents of students attending Meadowvale Public School have approached him stating their concerns, regarding sidewalks, traffic congestion, fencing and the construction around the walking routes.

Ms. Vivilecchia asked the Traffic Safety Council (TSC) Members if the decision to remove bussing comes after the TSC's recommendation that the routes are safe. Sheelagh Duffin, Supervisor, Crossing Guards advised that STOPR advised TSC that STOPR was removing bussing service to students attending St. Julia Catholic School and Meadowvale Village Public School effective September 2015. At that time STOPR requested that TSC conduct several site inspections to determine if there were improvements required to the walking routes to both schools and if the warrants were met for a crossing guard at Second Line West and Lamplight Way. Ms. Vivilecchia pointed out that in February 2007, the TSC made a recommendation to STOPR to reconsider the removal of bussing service. STOPR made the decision to continue bussing. Ms. Duffin, advised that the safety concerns at that time were with respect to the creek, which is no longer considered an issue as infrastructure improvements have subsequently been completed.

RECOMMENDATION

1. That the presentation made by Grace Vivilecchia, resident, with respect to safety concerns associated with the removal of school bus service for students attending St. Julia Catholic Elementary School to the school be received.

2. That the request to conduct a site inspection at Sombrero Way and Nimbus Gate, Sombrero Way and Harmony Hill, and at Lamplight Way and Historic Trail, for students attending St. Julia Catholic Elementary School be referred to the Site Inspection Subcommittee for a report back to the Traffic Safety Council at the next meeting.

Approved (Councillor S. McFadden)
Recommendation TSC-0080-2015

MATTERS CONSIDERED

1. Approval of April 22, 2015 Minutes

Minutes of the Traffic Safety Council meeting held on April 22, 2015

Approved (L. Goegan)

2. Site Inspection Report – Ruth Thompson Middle School (Ward 10)

Site Inspection Report for the safety review conducted on May 12, 2015 at Tenth Line & Sunlight Street/Serena Way for the students attending Ruth Thompson Middle School.

RECOMMENDATION

That Transportation and Works be requested to re-inspect the area of Tenth Line and Sunlight St/Serena Way, once the area development is completed on the east side of Tenth Line and the subdivision is assumed (by the City).

Approved (Councillor S. McFadden)
Recommendation TSC-0081-2015

3. Site Inspection Report – Kenollie Public School (Ward 1)

Site Inspection Report for the safety review conducted on May 14, 2015 at Mineola Road and Woodland Avenue for students attending Kenollie Public School.

RECOMMENDATION

That the request for a crossing guard at the intersection of Mineola Road and Woodland Avenue for students attending Kenollie Public School be denied as the warrants are not met.

Approved (D. Suess)

Recommendation TSC-0082-2015

4. Site Inspection Report – Willow Glen Public School (Ward 2)

Site Inspection Report for the site inspections conducted on May 19, 2015 at the intersection of Lewisham Drive and Brookhurst Road for the students attending Willow Glen Public School.

RECOMMENDATION

1. That the request for a crossing guard at the intersection of Lewisham Drive and Brookhurst Road for the students attending Willow Glen Public School be denied as the warrants are not met.
2. That the Transportation and Works department be requested to review signage and replace faded signs at Lewisham Drive, north of the park path on the west side, and on Brookhurst Road at the bridge for students attending Willow Glen Public School.

Approved (D. Suess)

Recommendation TSC-0083-2015

5. Site Inspection Reports – Forest Glen Public School (Ward 3)

Site Inspection Report for the site inspections conducted on May 20, 2015 at the intersection of Bloor Street and Bridgewood Drive and at the intersection of Ponytrail Drive and Bridgewood Drive for the students attending Forest Glen Public School.

RECOMMENDATION

1. That the request for a crossing guard at the intersection of Bloor Street and Bridgewood Drive, for the students attending Forest Glen Public School be denied as the warrants are not met.

2. That the request for a crossing guard at the intersection of Ponytrail Drive and Bridgewood Drive for the students attending Forest Glen Public School be denied as the warrants are not met.

Approved (L. Goegan)

Recommendation TSC-0084-2015

6. 65th Annual Ontario Traffic Council Conference

Report prepared by Traffic Safety Council Citizen Members Sandra Beniuk, Mashkoor Sherwani and Louise Goegan summarizing the sessions they attended at the 65th Annual Ontario Traffic Council Conference held on May 3rd to 5th, 2015 in Sault Ste. Marie.

RECOMMENDATION

That the Report submitted by Sandra Beniuk, Mashkoor Sherwani and Louise Goegan, Goegan summarizing the sessions they attended at the 65th Annual Ontario Traffic Council Conference held on May 3rd to 5th, 2015 in Sault Ste. Marie.

Approved (D. Gordon-Mohamud)

Recommendation TSC-0085-2015

7. Parking Enforcement in School Zones for April 2015

A report from the Manager of Parking Enforcement with respect to parking enforcement in school zones for the month of April 2015.

RECOMMENDATION

That the report from the Manager of Parking Enforcement with respect to parking enforcement in school zones for the month of April 2015 be received.

Received (D. Suess)

Recommendation TSC-0086-2015

8. Walk to School Subcommittee Meeting Minutes

The Minutes from the Walk to School Subcommittee meeting on May 20, 2015.

RECOMMENDATION

That the Minutes from the Walk to School Subcommittee meeting on May 20, 2015 be received.

Received (Councillor S. McFadden)
Recommendation TSC-0087-2015

The following recommendation emanated from the Walk to School Subcommittee meeting on May 20, 2015:

RECOMMENDATION

That Louise Goegan be appointed as the Chair of the Walk to School Subcommittee for a term ending on November 30, 2018 or until a successor is appointed.

Approved (Councillor S. McFadden)
Recommendation TSC-0088-2015

9. Transportation and Works Action Items List – April 2015

Action Items List from the Transportation and Works Department for the month of April 2015.

RECOMMENDATION

That the Action Items List from the Transportation and Works Department for the month of April 2015 be received.

Received (Councillor C. Fonseca)
Recommendation TSC-0089-2015

10. Site Inspection Report – St. Julia Catholic School and Meadowvale Village Public School (Ward 11)

Site Inspection Reports for the site inspections conducted on May 26, 2015 at Second Line and Silverthorn Mill Avenue, south to north; and on Second Line and Sombrero Way for students attending St. Julia Catholic School and Meadowvale Village Public School.

RECOMMENDATION

1. That the request for a crossing guard at the intersection of Second Line and Silverthorn Mill Avenue for students attending St. Julia Catholic School and Meadowvale Village Public School be denied as the warrants are not met.
2. That the Site Inspection Subcommittee of Traffic Safety Council conduct a further site inspection at Second Line and Sombrero Way for the students attending St. Julia Catholic School and Meadowvale Village Public School in September 2015 when bussing is removed.
3. That Transportation and Works Department be requested to conduct a speed study east of Second line and Sombrero Way for students attending St. Julia Catholic School and Meadowvale Village Public School.

Approved (L. Goegan)

Recommendation TSC-0090-2015

11. Public Information Subcommittee Meeting Minutes

The Minutes from the Public Information Subcommittee meeting on May 25, 2015.

RECOMMENDATION

That the Minutes from the Public Information Subcommittee meeting on May 25, 2015 be received for information.

Received (H. Relf)

Recommendation TSC-0091-2015

The following recommendation emanated from the Public Information Subcommittee meeting on May 25, 2015:

RECOMMENDATION

That Heather Relf be appointed as Chair of the Traffic Safety Council's Public Information Subcommittee for a term ending on November 30, 2018 or until a successor is appointed.

Approved (D. Suess)

Recommendation TSC-0092-2015

OTHER BUSINESS12. Removal of School Bus Service for Students attending St. Julia Catholic Elementary School (Ward 11)

Traffic Safety Council Members reviewed the letter from Councillor George Carlson, dated May 27, 2015 with respect to the removal of school bus service for students attending St. Julia Catholic Elementary School and received it for information.

RECOMMENDATION

That the letter dated May 27, 2015 from Councillor George Carlson with respect to the Removal of School Bus Services for Students attending St. Julia Catholic Elementary School be received for information.

Received (Councillor C. Fonseca)
Recommendation TSC-0093-2015

13. Bike to School Initiative

Councillor Chris Fonseca advised that she spoke to the Members of the Mississauga Cycling Advisory Committee regarding both committees collaborating for a bike to school initiative and that the Committee suggested that a staff member of the Active Transportation Department could link with Traffic Safety Council. Councillor Fonseca will speak to staff and invite them to sit as a Member of the Advisory Board of Traffic Safety Council. Further, Councillor Fonseca advised that the Mississauga Cycling Advisory Committee Technical Subcommittee can collaborate with members of the Walk to School subcommittee on a Walk to School/Bike to School launch for Fall 2015.

RECOMMENDATION

That a staff member from the Active Transportation section of the Transportation, Infrastructure and Planning Division, be requested to sit on the Traffic Safety Council's Advisory Board.

Approved (A. Syed)
Recommendation TSC-0094-2015

14. Katherine Vukobrat advised that when she is at the intersection of Montevideo Drive and Plowmans Heath it is very difficult to see the crossing guard as the sun shines directly in the location where the crossing guard is. Sheelagh Duffin will review and report back to Ms. Vukobrat.

Date of Next Meeting: June 24, 2015

ADJOURNMENT 6:15p.m.

DRAFT

Site Inspection Report



Traffic Safety Council
JUN 24 2015

Corporate Services
Office of the City Clerk

Site	
School: St. Julia Catholic School	Address: 6770 Historic Trail Mississauga ON L5W 1A1
School Times: 8:45 AM 3:15 PM	Student Population: 582
No. of School Buses: 399	Bused
School:	Address:
School Times:	Student Population:
No. of School Buses:	

Location: (Please identify the location with reference to nearest intersection. Indicate nearest school and address)			
Lamplight Way & Historic Trail			
Date of Inspection: 2015 06 04	Inspection Time: 8:15 AM 3:15 PM	Requested By: parent	
Prepared By: V. Mansour	Request For: Crossing guard / safety review		

Observers	
File Number: RT.10	File Number: RT.10
Ward: Ward 11	
Observed By: S. Duffin	<input type="checkbox"/> AM <input type="checkbox"/> PM <input checked="" type="checkbox"/> AM & PM
Observed By: D. Suess	<input type="checkbox"/> AM <input checked="" type="checkbox"/> PM <input type="checkbox"/> AM & PM
Observed By: P. Westbrook	<input checked="" type="checkbox"/> AM <input type="checkbox"/> PM <input type="checkbox"/> AM & PM
Observed By: V. Mansour	<input type="checkbox"/> AM <input type="checkbox"/> PM <input checked="" type="checkbox"/> AM & PM
Observed By:	<input type="checkbox"/> AM <input type="checkbox"/> PM <input type="checkbox"/> AM & PM
Observed By:	<input type="checkbox"/> AM <input type="checkbox"/> PM <input type="checkbox"/> AM & PM

Details	
Weather Conditions:	AM: <input checked="" type="checkbox"/> Dry <input checked="" type="checkbox"/> Sunny <input type="checkbox"/> Rain <input type="checkbox"/> Snow <input type="checkbox"/> Other: +11C
	PM: <input checked="" type="checkbox"/> Dry <input checked="" type="checkbox"/> Sunny <input type="checkbox"/> Rain <input type="checkbox"/> Snow <input type="checkbox"/> Other: +20C
Type of Crossing:	<input type="checkbox"/> 4 Way Intersection <input checked="" type="checkbox"/> 3 Way Intersection <input type="checkbox"/> Midblock (i.e., not an intersection)
Type of Control:	<input type="checkbox"/> Traffic Lights <input type="checkbox"/> Yield Signs <input type="checkbox"/> No Control
	<input checked="" type="checkbox"/> Stop Signs (Traffic is stopped on one street only) <input type="checkbox"/> All Way Stop (Traffic is stopped in all directions)

Site Conditions	
School Signs:	<input checked="" type="checkbox"/> School Area Signs <input type="checkbox"/> School Crossing Signs <input checked="" type="checkbox"/> Parking/Stopping Prohibition <i>Some incomplete</i>
Posted Speed Limit:	<input checked="" type="checkbox"/> 40 km/hr <input checked="" type="checkbox"/> 50 km/hr <input type="checkbox"/> 60 km/hr <input type="checkbox"/> Other:
Visibility of Crossing Pedestrians:	<input type="checkbox"/> Poor <input type="checkbox"/> Fair <input checked="" type="checkbox"/> Good Comments:
Sight Obstructions:	<input type="checkbox"/> Hedges <input type="checkbox"/> Trees <input type="checkbox"/> Fences <input type="checkbox"/> Bus Shelter
	<input type="checkbox"/> Newspaper Boxes <input type="checkbox"/> Other (Specify):
Road Grade:	<input checked="" type="checkbox"/> Flat <input type="checkbox"/> Incline <input checked="" type="checkbox"/> Decline to the east
Road Geometrics:	<input checked="" type="checkbox"/> Straight <input type="checkbox"/> Curved Comments:
Road Width:	32 feet/metres Curb to Curb: feet/metres Curb to Median: feet/metres
Road Conditions:	AM: <input checked="" type="checkbox"/> Dry <input type="checkbox"/> Wet <input type="checkbox"/> Snow Covered <input type="checkbox"/> Ice
	PM: <input checked="" type="checkbox"/> Dry <input type="checkbox"/> Wet <input type="checkbox"/> Snow Covered <input type="checkbox"/> Ice
Sidewalks:	<input type="checkbox"/> Not Present <input checked="" type="checkbox"/> North <input checked="" type="checkbox"/> South <input checked="" type="checkbox"/> East <input checked="" type="checkbox"/> West
Proximity to School:	<input type="checkbox"/> In Front of <input checked="" type="checkbox"/> Within 100 feet/metres
Route Survey:	<input type="checkbox"/> Shopping Area <input type="checkbox"/> Construction <input type="checkbox"/> Driveway <input type="checkbox"/> Parked Vehicle(s)
	<input type="checkbox"/> Transit Bus Stop <input type="checkbox"/> Underpass Within feet/metres Other (specify):
Comments / Conflicts:	No conflicts observed. Stopping compliance good when pedestrians present. Stop at Historic Trail provides protection for crossing students. Traffic primarily school related.

2b

Crossing Guard Warrant Survey

Location: Lamplight Way & Historic Trail

☒ Safe Gap TimeSafe Gap Time Calculation (if applicable): $\left(\frac{W}{3.5} + 4 \right)$ 13 = sec.☐ Signalized Intersection turning traffic count**Morning Intervals**

Time (AM)	# of Peds	# of Conflicts	Gaps	# of Gaps
7:45 - 7:50				
7:50 - 7:55				
7:55 - 8:00				
8:00 - 8:05				
8:05 - 8:10				
8:10 - 8:15				
8:15 - 8:20			//, 15, 33, /, 18, /, 18, 14, 22, /, 22, /	7
8:20 - 8:25			14, //, 50, 29, 22, 33, 17, 25, /, 16, /, 21, //	12
8:25 - 8:30			//, 30, /, 15, /, 57, /, 14, 16, 16, //, //, 22, //, A7, /	14
8:30 - 8:35	//		//, 30, //, 19, //, 14, //, //, 24, //, //, //, //, //	5
8:35 - 8:40			//, //, //, //, 19, //, //, //, //, 54, /, 17, //, //, //	6
8:40 - 8:45	/		17, //, 35, //, //, //, 14, //, //, //, //, //, 17, //, //, 20, 20, //	7
8:45 - 8:50				
8:50 - 8:55				
8:55 - 9:00				

Afternoon Intervals

Time (PM)	# of Peds	# of Conflicts	Gaps	# of Gaps
2:45 - 2:50				
2:50 - 2:55				
2:55 - 3:00				
3:00 - 3:05				
3:05 - 3:10				
3:10 - 3:15				
3:15 - 3:20	//		80, 17, //, 27, /, 14, //, //, 19, //, 14, 37, /	14
3:20 - 3:25			18, //, //, 42, //, 13, //, 65, 16, 48, //, //	14
3:25 - 3:30	//		32, /, 20, //, 76, //, 117, //	17
3:30 - 3:35	////		29, /, 15, 13, 20, 19, //, 52, //, 14, 20, 51, /	15
3:35 - 3:40			29, 24, 65, 26, /, 44, 13, 17, //, 49	18
3:40 - 3:45			28, /, 16, 32, 37, 46, 39, 15, 70, //	19
3:45 - 3:50				
3:50 - 3:55				
3:55 - 4:00				

Recommendations

- 1) That the warrants for a crossing guard have not been met.
- 2) That Transportation & Works be requested to install "No Stopping" corner prohibitions on Historic Trail & Lamplight Way and on the south side of Lamplight Way across from the intersection.
- 3) That Parking Enforcement be requested to attend from 3:10 - 3:30 once "No Stopping" prohibitions are in place.

Observations

Volume of Traffic (see Intersection Plan):

AM: ☐ Heavy ☒ Light ☐ Intermittant PM: ☐ Heavy ☒ Light ☐ Intermittant

Number of Crossing Pedestrians:

AM: North 3 East South West PM: North 9 East South West

Turning Traffic:

AM: ☐ Heavy ☐ Light ☐ Intermittant PM: ☐ Heavy ☐ Light ☐ Intermittant

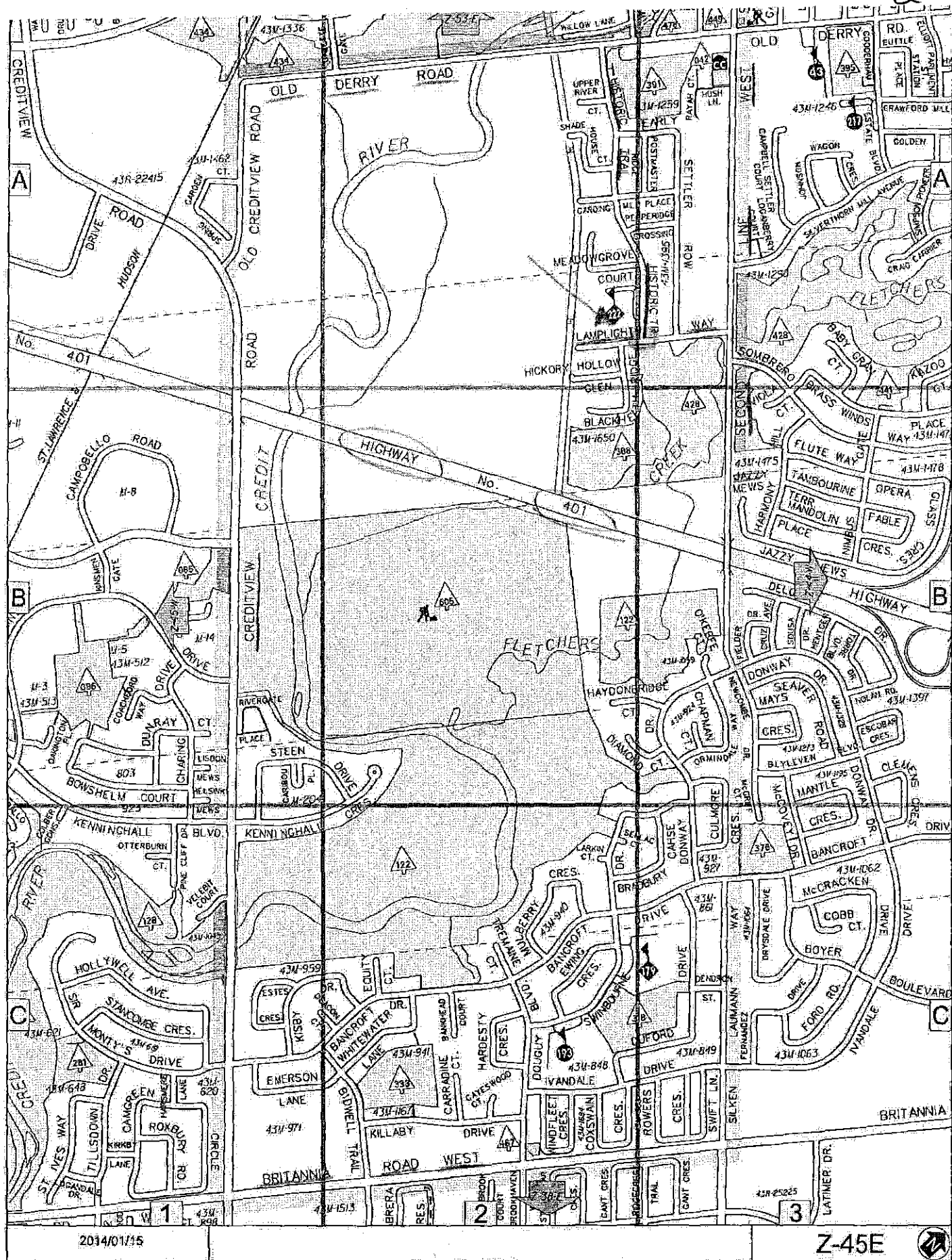

HISTORIC TRAIL + LAMPLIGHT WAY 8:15-8:45 + 3:15-3:45

2d

Site Inspection Report



Corporate Services
Office of the City Clerk

Site	
School: St. Julia Catholic School	Address: 6770 Historic Trail Mississauga ON L5W 1A1
School Times: 8:45 AM 3:15 PM	Student Population: 582
No. of School Buses: 399	Bused
School:	Address:
School Times:	Student Population:
No. of School Buses:	

Location: (Please identify the location with reference to nearest intersection. Indicate nearest school and address)

Sombrero Way & Harmony Hill

Date of Inspection: 2015 06 10	Inspection Time: 8:15 AM 3:15 PM	Requested By: parent
Prepared By: D. Sues	Request For: Crossing Guard / Safety Review	

Observers

File Number: RT.10	File Number: RT.10	Ward: Ward 11
Observed By: A. Syed	<input type="checkbox"/> AM <input checked="" type="checkbox"/> PM <input type="checkbox"/> AM & PM	
Observed By: D. Sues	<input type="checkbox"/> AM <input type="checkbox"/> PM <input checked="" type="checkbox"/> AM & PM	
Observed By: D. Yaunan	<input type="checkbox"/> AM <input type="checkbox"/> PM <input checked="" type="checkbox"/> AM & PM	
Observed By:	<input type="checkbox"/> AM <input type="checkbox"/> PM <input type="checkbox"/> AM & PM	
Observed By:	<input type="checkbox"/> AM <input type="checkbox"/> PM <input type="checkbox"/> AM & PM	
Observed By:	<input type="checkbox"/> AM <input type="checkbox"/> PM <input type="checkbox"/> AM & PM	

Details

Weather Conditions:	AM: <input checked="" type="checkbox"/> Dry <input type="checkbox"/> Sunny <input type="checkbox"/> Rain <input type="checkbox"/> Snow <input type="checkbox"/> Other:
	PM: <input checked="" type="checkbox"/> Dry <input type="checkbox"/> Sunny <input type="checkbox"/> Rain <input type="checkbox"/> Snow <input type="checkbox"/> Other:
Type of Crossing:	<input type="checkbox"/> 4 Way Intersection <input checked="" type="checkbox"/> 3-Way Intersection <input type="checkbox"/> Midblock (i.e., not an intersection)
Type of Control:	<input type="checkbox"/> Traffic Lights <input type="checkbox"/> Yield Signs <input type="checkbox"/> No Control
	<input checked="" type="checkbox"/> Stop Signs (Traffic is stopped on one street only) <input type="checkbox"/> All Way Stop (Traffic is stopped in all directions)

Site Conditions

School Signs:	<input type="checkbox"/> School Area Signs <input type="checkbox"/> School Crossing Signs <input type="checkbox"/> Parking/Stopping Prohibition
Posted Speed Limit:	<input type="checkbox"/> 40 km/hr <input checked="" type="checkbox"/> 50 km/h <input type="checkbox"/> 60 km/hr <input type="checkbox"/> Other:
Visibility of Crossing Pedestrians:	<input type="checkbox"/> Poor <input type="checkbox"/> Fair <input checked="" type="checkbox"/> Good Comments:
Sight Obstructions:	<input type="checkbox"/> Hedges <input type="checkbox"/> Trees <input type="checkbox"/> Fences <input type="checkbox"/> Bus Shelter
	<input type="checkbox"/> Newspaper Boxes <input type="checkbox"/> Other (Specify):
Road Grade:	<input checked="" type="checkbox"/> Flat <input type="checkbox"/> Incline <input type="checkbox"/> Decline
Road Geometrics:	<input checked="" type="checkbox"/> Straight <input type="checkbox"/> Curved Comments:
Road Width:	10 feet/metres Curb to Curb: feet/metres Curb to Median: feet/metres
Road Conditions:	AM: <input checked="" type="checkbox"/> Dry <input type="checkbox"/> Wet <input type="checkbox"/> Snow Covered <input type="checkbox"/> Ice
	PM: <input checked="" type="checkbox"/> Dry <input type="checkbox"/> Wet <input type="checkbox"/> Snow Covered <input type="checkbox"/> Ice
Sidewalks:	<input type="checkbox"/> Not Present <input checked="" type="checkbox"/> North <input checked="" type="checkbox"/> South <input checked="" type="checkbox"/> East <input type="checkbox"/> West
Proximity to School:	<input type="checkbox"/> In Front of <input checked="" type="checkbox"/> Within 650 feet/metres
Route Survey:	<input type="checkbox"/> Shopping Area <input type="checkbox"/> Construction <input type="checkbox"/> Driveway <input type="checkbox"/> Parked Vehicle(s)
	<input type="checkbox"/> Transit Bus Stop <input type="checkbox"/> Underpass Within feet/metres Other (specify):
Comments / Conflicts:	No speeding on Sombrero Way or Harmony Hill. Traffic/vehicle compliance good at intersection.

Crossing Guard Warrant Survey

Location: Sombrero Way & Harmony Hill

☒ Safe Gap Time Safe Gap Time Calculation (if applicable): $\left(\frac{W}{3.5} + 4 \right)$ 13 = sec.
☐ Signalized Intersection turning traffic count

Morning Intervals

Time (AM)	# of Peds	# of Conflicts	Gaps	# of Gaps
7:45 - 7:50				
7:50 - 7:55				
7:55 - 8:00				
8:00 - 8:05				
8:05 - 8:10				
8:10 - 8:15				
8:15 - 8:20			16,67,38,68,47	16
8:20 - 8:25			59,1,214,38	22
8:25 - 8:30			42,49,42,57,1,18,19,30	17
8:30 - 8:35	/		42,39,23,11,14,20,20,18,39,17,1	15
8:35 - 8:40	/		55,28,11,34,60,57,1	14
8:40 - 8:45			147,16,124,124,1	30
8:45 - 8:50				
8:50 - 8:55				
8:55 - 9:00				

Afternoon Intervals

Time (PM)	# of Peds	# of Conflicts	Gaps	# of Gaps
2:45 - 2:50				
2:50 - 2:55				
2:55 - 3:00				
3:00 - 3:05				
3:05 - 3:10				
3:10 - 3:15				
3:15 - 3:20			1,129,27,112	19
3:20 - 3:25			48,33,1,19,22,22,27,15,36	13
3:25 - 3:30			105,21,1,75,32,17,1	31
3:30 - 3:35			48,43,1,153	17
3:35 - 3:40			99,25,113,1	11
3:40 - 3:45			239,46,96,57	32
3:45 - 3:50				
3:50 - 3:55				
3:55 - 4:00				

Recommendations

1) That the warrants for a crossing guard have not been met.

Observations

Volume of Traffic (see Intersection Plan):
 AM: ☐ Heavy ☐ Light ☒ Intermittant PM: ☐ Heavy ☐ Light ☒ Intermittant

Number of Crossing Pedestrians:
 AM: North ☐ East ☐ South ☐ West 2 PM: North ☐ East ☐ South ☐ West 0

Turning Traffic:
 AM: ☐ Heavy ☐ Light ☐ Intermittant PM: ☐ Heavy ☐ Light ☐ Intermittant

2 P

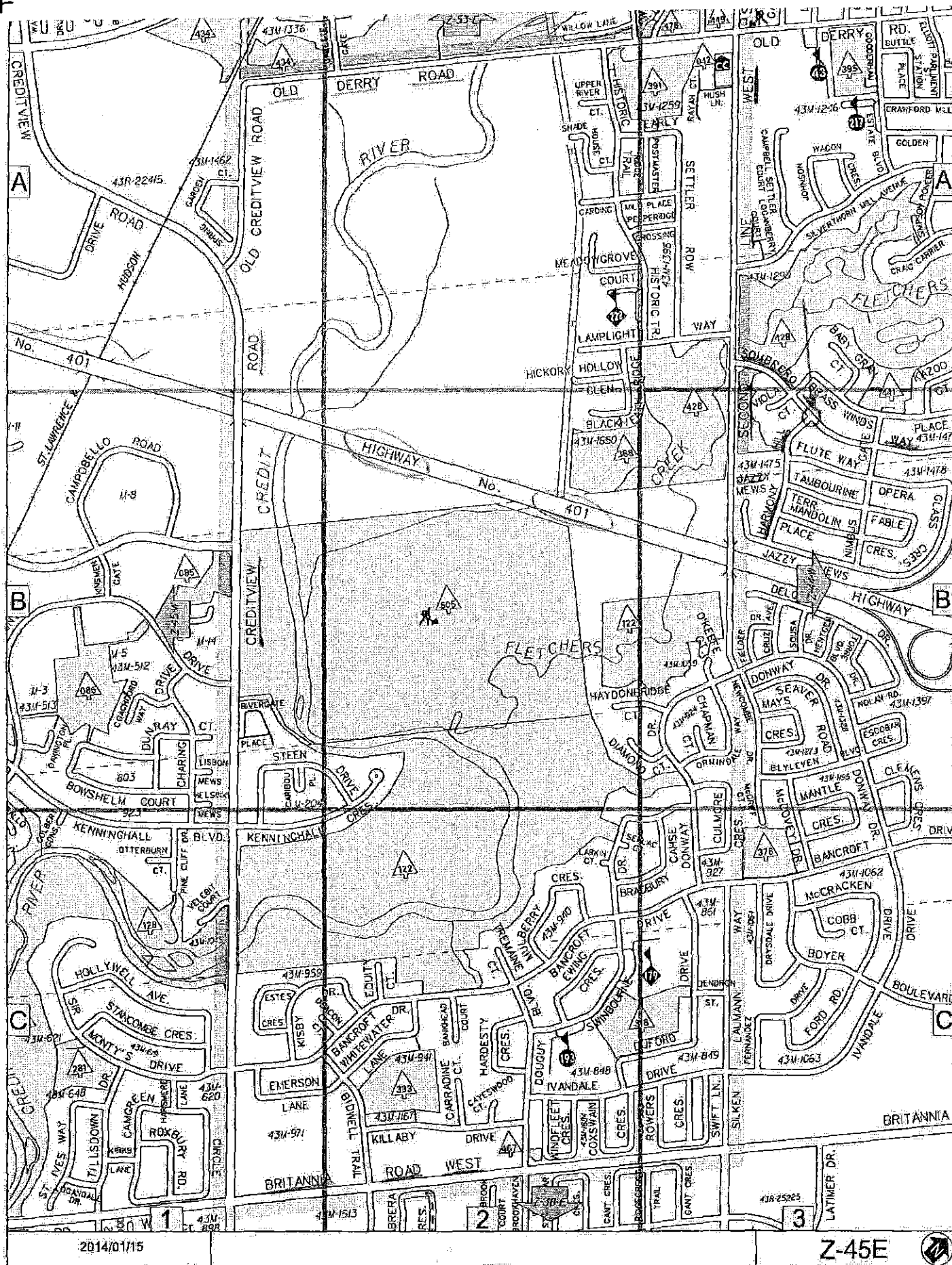

Sombra Way + Harmony Hill 8:15-8:45 + 3:15-3:45

Site Inspection Report



29
Corporate Services
Office of the City Clerk

Site	
School: St. Julia Catholic School	Address: 6770 Historic Trail Mississauga ON L5W 1A1
School Times: 8:45 AM 3:15 PM	Student Population: 582
No. of School Buses: 399	Bused
School:	Address:
School Times:	Student Population:
No. of School Buses:	

Location: (Please identify the location with reference to nearest intersection. Indicate nearest school and address)

Sombrero Way & Nimbus Gate

Date of Inspection: 2015 06 10	Inspection Time: 8:15 AM 3:15 PM	Requested By: parent
Prepared By: H. Relf/A. Liya	Request For: Crossing Guard / safety review	

Observers

File Number: RT.10	File Number: RT.10	Ward: Ward 11
Observed By: S. Duffin	<input type="checkbox"/> AM <input type="checkbox"/> PM <input checked="" type="checkbox"/> AM & PM	
Observed By: A. Liya	<input type="checkbox"/> AM <input type="checkbox"/> PM <input checked="" type="checkbox"/> AM & PM	
Observed By: H.A. Relf	<input type="checkbox"/> AM <input type="checkbox"/> PM <input checked="" type="checkbox"/> AM & PM	
Observed By:	<input type="checkbox"/> AM <input type="checkbox"/> PM <input type="checkbox"/> AM & PM	
Observed By:	<input type="checkbox"/> AM <input type="checkbox"/> PM <input type="checkbox"/> AM & PM	
Observed By:	<input type="checkbox"/> AM <input type="checkbox"/> PM <input type="checkbox"/> AM & PM	

Details

Weather Conditions:	AM: <input checked="" type="checkbox"/> Dry <input checked="" type="checkbox"/> Sunny <input type="checkbox"/> Rain <input type="checkbox"/> Snow <input type="checkbox"/> Other: 13C
	PM: <input checked="" type="checkbox"/> Dry <input checked="" type="checkbox"/> Sunny <input type="checkbox"/> Rain <input type="checkbox"/> Snow <input type="checkbox"/> Other: 26C
Type of Crossing:	<input checked="" type="checkbox"/> 4 Way Intersection <input type="checkbox"/> 3 Way Intersection <input type="checkbox"/> Midblock (i.e., not an intersection)
Type of Control:	<input type="checkbox"/> Traffic Lights <input type="checkbox"/> Yield Signs <input type="checkbox"/> No Control <input checked="" type="checkbox"/> All Way Stop (Traffic is stopped in all directions)
	<input type="checkbox"/> Stop Signs (Traffic is stopped on one street only)

Site Conditions

School Signs:	<input type="checkbox"/> School Area Signs <input type="checkbox"/> School Crossing Signs <input type="checkbox"/> Parking/Stopping Prohibition
Posted Speed Limit:	<input type="checkbox"/> 40 km/hr <input checked="" type="checkbox"/> 50 km/h <input type="checkbox"/> 60 km/hr <input type="checkbox"/> Other:
Visibility of Crossing Pedestrians:	<input type="checkbox"/> Poor <input type="checkbox"/> Fair <input checked="" type="checkbox"/> Good Comments:
Sight Obstructions:	<input type="checkbox"/> Hedges <input type="checkbox"/> Trees <input type="checkbox"/> Fences <input type="checkbox"/> Bus Shelter <input type="checkbox"/> Newspaper Boxes <input type="checkbox"/> Other (Specify):
Road Grade:	<input checked="" type="checkbox"/> Flat <input type="checkbox"/> Incline <input type="checkbox"/> Decline
Road Geometrics:	<input checked="" type="checkbox"/> Straight <input type="checkbox"/> Curved Comments:
Road Width:	9 feet/metres Curb to Curb: feet/metres Curb to Median: feet/metres
Road Conditions:	AM: <input checked="" type="checkbox"/> Dry <input type="checkbox"/> Wet <input type="checkbox"/> Snow Covered <input type="checkbox"/> Ice PM: <input checked="" type="checkbox"/> Dry <input type="checkbox"/> Wet <input type="checkbox"/> Snow Covered <input type="checkbox"/> Ice
Sidewalks:	<input type="checkbox"/> Not Present <input checked="" type="checkbox"/> North <input checked="" type="checkbox"/> South <input checked="" type="checkbox"/> East <input type="checkbox"/> West
Proximity to School:	<input type="checkbox"/> In Front of <input checked="" type="checkbox"/> Within 750 feet/metres
Route Survey:	<input type="checkbox"/> Shopping Area <input type="checkbox"/> Construction <input type="checkbox"/> Driveway <input type="checkbox"/> Parked Vehicle(s) <input type="checkbox"/> Transit Bus Stop <input type="checkbox"/> Underpass Within feet/metres Other (specify):

Comments / Conflicts: Students to be removed from busing Sept 2015. Review of traffic warrant only. Stopping compliance good. All way stop provides protection for crossing students. No pedestrians since currently on the school bus.

2h

Crossing Guard Warrant Survey

Location: Sombbrero Way & Nimbus Gate

☒ Safe Gap Time

Safe Gap Time Calculation (if applicable): $\left(\frac{W}{3.5} + 4 \right)$ 13 = sec.

☐ Signalized Intersection turning traffic count

Morning Intervals

Time (AM)	# of Peds	# of Conflicts	Gaps	# of Gaps
7:45 - 7:50				
7:50 - 7:55			South Leg	
7:55 - 8:00				
8:00 - 8:05				
8:05 - 8:10				
8:10 - 8:15				
8:15 - 8:20			1, 19, 13, 1, 48, 11, 67, 11, 11, 13, 11	12
8:20 - 8:25			23, 11, 15, 11, 11, 17, 1, 22, 13, 34, 11	9
8:25 - 8:30			23, 11, 19, 18, 11, 30, 36, 33, 11, 21, 18	15
8:30 - 8:35			21, 1, 40, 14, 11, 43, 11, 11, 23	10
8:35 - 8:40			43, 11, 29, 1, 29, 1, 24, 1, 122	19
8:40 - 8:45			55, 50, 11, 11, 11, 76, 11, 11	13
8:45 - 8:50				
8:50 - 8:55				
8:55 - 9:00				

Afternoon Intervals

Time (PM)	# of Peds	# of Conflicts	Gaps	# of Gaps
2:45 - 2:50				
2:50 - 2:55			South Leg	
2:55 - 3:00				
3:00 - 3:05				
3:05 - 3:10				
3:10 - 3:15				
3:15 - 3:20			1, 32, 1, 29, 19, 47, 22, 11, 17, 11, 11, 30	15
3:20 - 3:25			29, 11, 14, 44, 11, 14, 11, 31, 22, 13, 11	12
3:25 - 3:30			45, 11, 37, 11, 42, 11, 23, 1, 18, 1, 23, 11, 36	17
3:30 - 3:35			1, 17, 1, 43, 31, 31, 11, 97, 11	16
3:35 - 3:40			48, 11, 39, 1, 37, 12, 17, 1, 35, 31, 1	17
3:40 - 3:45			22, 29, 39, 11, 45, 1, 63, 1, 53, 11, 23, 11, 60	25
3:45 - 3:50				
3:50 - 3:55				
3:55 - 4:00				

Recommendations

See North Leg for comments and recommendations

Observations

Volume of Traffic (see Intersection Plan):

AM: ☐ Heavy ☒ Light ☐ Intermittant PM: ☐ Heavy ☒ Light ☐ Intermittant

Number of Crossing Pedestrians:

AM: North East South West PM: North East South West

Turning Traffic:

AM: ☐ Heavy ☐ Light ☐ Intermittant PM: ☐ Heavy ☐ Light ☐ Intermittant

Crossing Guard Warrant Survey

Location: Sombbrero Way & Nimbus Gate

☒ Safe Gap Time

Safe Gap Time Calculation (if applicable): $\left(\frac{W}{3.5} + 4 \right)$ 12 = sec.

☐ Signalized Intersection turning traffic count

Morning Intervals

Time (AM)	# of Peds	# of Conflicts	Gaps	# of Gaps
7:45 - 7:50				
7:50 - 7:55			North Leg	
7:55 - 8:00				
8:00 - 8:05				
8:05 - 8:10				
8:10 - 8:15				
8:15 - 8:20			1,25,1,18	3
8:20 - 8:25			1,18,1,23,45,111111	5
8:25 - 8:30			1,85,115,1,63,11	21
8:30 - 8:35			45,18,60,1,13,18,15	12
8:35 - 8:40			1,60,75,122,1	21
8:40 - 8:45			1,30,40,22,1,26,11	
8:45 - 8:50				
8:50 - 8:55				
8:55 - 9:00				

Afternoon Intervals

Time (PM)	# of Peds	# of Conflicts	Gaps	# of Gaps
2:45 - 2:50				
2:50 - 2:55			North Leg	
2:55 - 3:00				
3:00 - 3:05				
3:05 - 3:10				
3:10 - 3:15				
3:15 - 3:20				
3:20 - 3:25			40,40,32,180,17,45	27
3:25 - 3:30			1,110,1,58,25,43,21	19
3:30 - 3:35			82,16,1,16,86,18	15
3:35 - 3:40			252,21,45	25
3:40 - 3:45			181,29,15,113,1	27
3:45 - 3:50				
3:50 - 3:55				
3:55 - 4:00				

Recommendations

1) That the traffic warrants for a crossing guard have not been met.

Observations

Volume of Traffic (see Intersection Plan):

AM: ☐ Heavy ☒ Light ☐ Intermittant PM: ☐ Heavy ☒ Light ☐ Intermittant

Number of Crossing Pedestrians:

AM: North East South West PM: North East South West

Turning Traffic:

AM: ☐ Heavy ☐ Light ☐ Intermittant PM: ☐ Heavy ☐ Light ☐ Intermittant

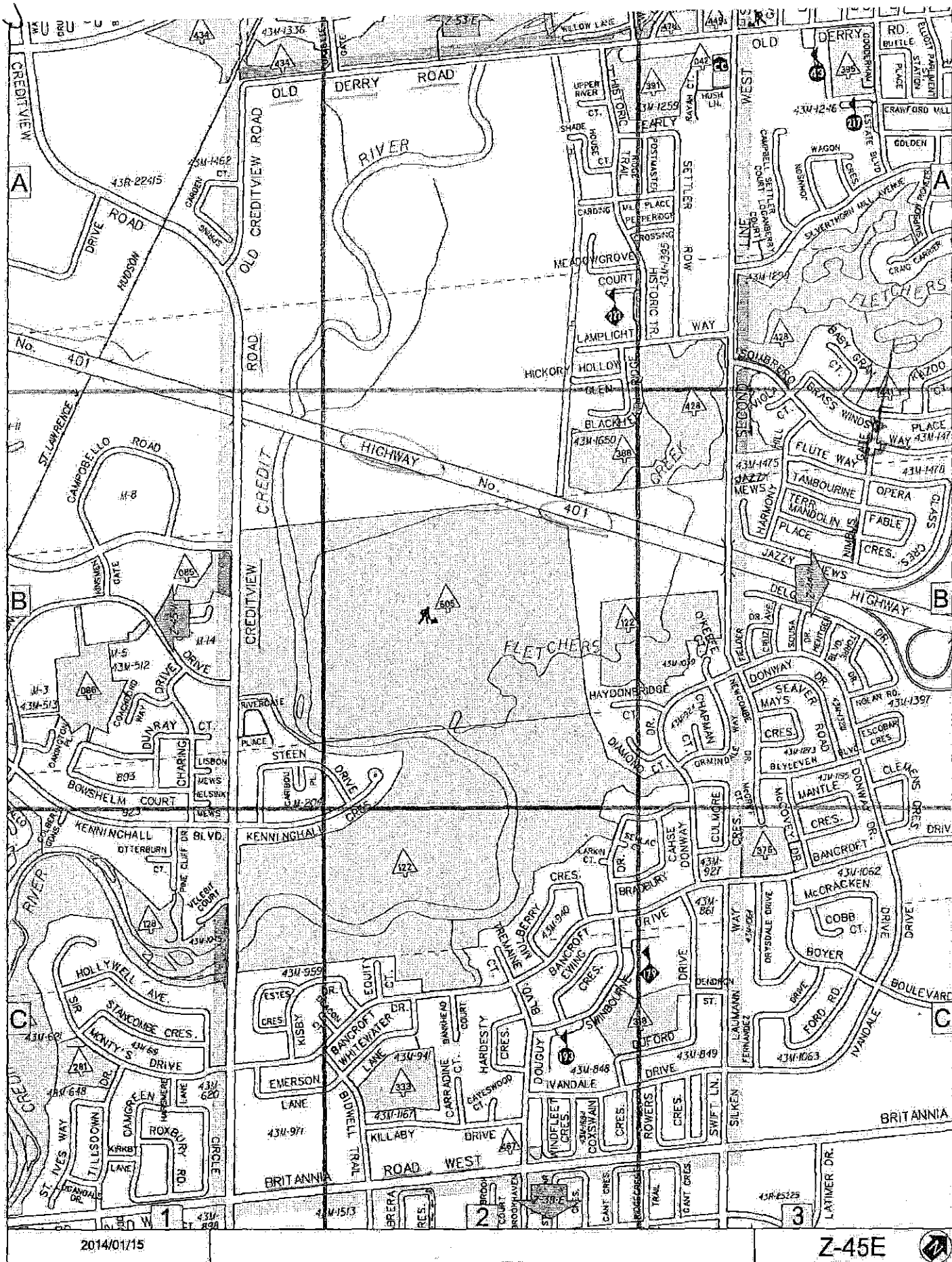

SOMBREAD WAY + NIMBUS GATE 8:15-8:45 + 3:15-3:45

Site Inspection Report



Traffic Safety Council

JUN 24 2015

Corporate Services
Office of the City Clerk

3

Site	
School: St. David of Wales CS	Address: 4200 Beacon Lane Mississauga ON L5C 3V9
School Times: 8:45 AM 3:15 PM	Student Population: 223
No. of School Buses: 14	Buses
School:	Address:
School Times:	Student Population:
No. of School Buses:	

Location: (Please identify the location with reference to nearest intersection. Indicate nearest school and address)			
Rathburn Rd. & Perivale Rd.			
Date of Inspection: 2015 05 21	Inspection Time: 8:15 AM 3:15 PM	Requested By: A parent -reinspection	
Prepared By: V. Mansour	Request For: Crossing Guard - gap study		

Observers			
File Number: RT.10	File Number: RT.10	Ward: Ward 6	
Observed By: S. Duffin	<input type="checkbox"/> AM <input type="checkbox"/> PM <input checked="" type="checkbox"/> AM & PM		
Observed By: S. Kumra	<input checked="" type="checkbox"/> AM <input type="checkbox"/> PM <input type="checkbox"/> AM & PM		
Observed By: A. Syed	<input type="checkbox"/> AM <input checked="" type="checkbox"/> PM <input type="checkbox"/> AM & PM		
Observed By: V. Mansour	<input type="checkbox"/> AM <input type="checkbox"/> PM <input checked="" type="checkbox"/> AM & PM		
Observed By:	<input type="checkbox"/> AM <input type="checkbox"/> PM <input type="checkbox"/> AM & PM		
Observed By:	<input type="checkbox"/> AM <input type="checkbox"/> PM <input type="checkbox"/> AM & PM		

Details			
Weather Conditions:	AM: <input checked="" type="checkbox"/> Dry <input checked="" type="checkbox"/> Sunny <input type="checkbox"/> Rain <input type="checkbox"/> Snow <input type="checkbox"/> Other: 13C		
	PM: <input checked="" type="checkbox"/> Dry <input checked="" type="checkbox"/> Sunny <input type="checkbox"/> Rain <input type="checkbox"/> Snow <input type="checkbox"/> Other: 19C		
Type of Crossing:	<input checked="" type="checkbox"/> 4 Way Intersection <input type="checkbox"/> 3 Way Intersection <input type="checkbox"/> Midblock (i.e., not an intersection)		
Type of Control:	<input checked="" type="checkbox"/> Traffic Lights <input type="checkbox"/> Yield Signs <input type="checkbox"/> No Control		
	<input type="checkbox"/> Stop Signs (Traffic is stopped on one street only) <input type="checkbox"/> All Way Stop (Traffic is stopped in all directions)		

Site Conditions			
School Signs:	<input type="checkbox"/> School Area Signs <input type="checkbox"/> School Crossing Signs <input type="checkbox"/> Parking/Stopping Prohibition		
Posted Speed Limit:	<input type="checkbox"/> 40 km/hr <input checked="" type="checkbox"/> 50 km/h <input type="checkbox"/> 60 km/hr <input type="checkbox"/> Other:		
Visibility of Crossing Pedestrians:	<input type="checkbox"/> Poor <input type="checkbox"/> Fair <input checked="" type="checkbox"/> Good	Comments:	
Sight Obstructions:	<input type="checkbox"/> Hedges <input type="checkbox"/> Trees <input type="checkbox"/> Fences <input type="checkbox"/> Bus Shelter		
	<input type="checkbox"/> Newspaper Boxes <input type="checkbox"/> Other (Specify):		
Road Grade:	<input checked="" type="checkbox"/> Flat <input type="checkbox"/> Incline <input type="checkbox"/> Decline		
Road Geometrics:	<input checked="" type="checkbox"/> Straight <input type="checkbox"/> Curved	Comments:	
Road Width:	NA feet/metres Curb to Curb: feet/metres Curb to Median: feet/metres		
Road Conditions:	AM: <input type="checkbox"/> Dry <input type="checkbox"/> Wet <input type="checkbox"/> Snow Covered <input type="checkbox"/> Ice		
	PM: <input type="checkbox"/> Dry <input type="checkbox"/> Wet <input type="checkbox"/> Snow Covered <input type="checkbox"/> Ice		
Sidewalks:	<input type="checkbox"/> Not Present <input checked="" type="checkbox"/> North <input checked="" type="checkbox"/> South <input checked="" type="checkbox"/> East <input checked="" type="checkbox"/> West		
Proximity to School:	<input type="checkbox"/> In Front of <input checked="" type="checkbox"/> Within 500 feet/metres		
Route Survey:	<input type="checkbox"/> Shopping Area <input type="checkbox"/> Construction <input type="checkbox"/> Driveway <input type="checkbox"/> Parked Vehicle(s)		
	<input type="checkbox"/> Transit Bus Stop <input type="checkbox"/> Underpass Within feet/metres Other (specify):		
Comments / Conflicts:	SEE BELOW FOR ALL COMMENTS		

39

Crossing Guard Warrant Survey

Location: Rathburn Rd. & Perivale Rd.

☐ Safe Gap TimeSafe Gap Time Calculation (if applicable): $\left(\frac{W}{3.5} + 4 \right)$ = sec.☒ Signalized Intersection turning traffic count

Morning Intervals

Time (AM)	# of Peds	# of Conflicts	Gaps	# of Peds
7:45 - 7:50				
7:50 - 7:55			West Leg South Leg	
7:55 - 8:00				
8:00 - 8:05				
8:05 - 8:10				
8:10 - 8:15				
8:15 - 8:20			0,0,0 0,///,/	
8:20 - 8:25	//		0,1,0 0,///	///
8:25 - 8:30			/,0,0,0,0 0,///,0	
8:30 - 8:35	///,//		///,0 ///,///	///,/
8:35 - 8:40	///,/		0,0,0,0 /,///,/	///,///
8:40 - 8:45	//		///,0,0 ///,///,///	//
8:45 - 8:50				
8:50 - 8:55				
8:55 - 9:00				

Afternoon Intervals

Time (PM)	# of Peds	# of Conflicts	Gaps	# of Peds
2:45 - 2:50				
2:50 - 2:55			West Leg South Leg	
2:55 - 3:00				
3:00 - 3:05				
3:05 - 3:10				
3:10 - 3:15				
3:15 - 3:20	////		0,0,0,0,0 0,////,/	
3:20 - 3:25	//,//		///,0, / ///,///,///,///	5,6,1,4
3:25 - 3:30			/,0,0,0 0,///,///	
3:30 - 3:35	/		0,0 ///,///,///	
3:35 - 3:40				
3:40 - 3:45				
3:45 - 3:50				
3:50 - 3:55				
3:55 - 4:00				

Recommendations

1) That the warrants for a crossing guard have not been met.

Observations

Volume of Traffic (see Intersection Plan):

AM: ☐ Heavy ☒ Light ☐ Intermittant PM: ☐ Heavy ☒ Light ☐ Intermittant

Number of Crossing Pedestrians:

AM: North ☐ East ☐ South 14 West 14 PM: North ☐ East ☐ South 16 West 20

Turning Traffic:

AM: ☐ Heavy ☒ Light ☐ Intermittant PM: ☐ Heavy ☒ Light ☐ Intermittant

3b

Additional Comments/Conflicts

Intersection functions well. No speeding observed. Flashing 40K speed zone located directly at the intersection. No conflicts observed at either Rathburn Rd & Perivale Rd and Beacon Lane & Perivale Rd. Stopping compliance was good. Review of accident history indicates nothing unusual for this type of intersection. One(1) minor pedestrian/vehicle conflict with an adult at 8:20 a.m. on March 23 2015.

Additional Recommendations

Site Inspection Report



Traffic Safety Council

JUN 24 2015

Corporate Services
Office of the City Clerk

4

Site	
School: Blessed Teresa of Calcutta Catholic School	Address: 1120 Runningbrook Dr Mississauga ON L4Y 2T2
School: Silverthorn Public School	Address: 3535 Cedar Creek Dr Mississauga ON L4Y 2Y4
School Times: 8:55 AM 3:25 PM	Student Population: 217
No. of School Buses: 42	Bused
School Times: 9:00 AM 3:30 PM	Student Population: 299
No. of School Buses: 167	Bused

Location: (Please identify the location with reference to nearest intersection. Indicate nearest school and address)

Tomken Rd & Runningbrook Dr

Date of Inspection: 2015 06 11	Inspection Time: 8:25 AM 3:25 PM	Requested By: Councilor Fonseca
Prepared By: D. Suess, D. Yaunan	Request For: Crossing Guard	

Observers

File Number: RT.10	File Number: RT.10	Ward: Ward 3
Observed By: S. Duffin	<input type="checkbox"/> AM <input checked="" type="checkbox"/> PM <input type="checkbox"/> AM & PM	
Observed By: M. Sherwani	<input checked="" type="checkbox"/> AM <input type="checkbox"/> PM <input type="checkbox"/> AM & PM	
Observed By: D. Suess	<input type="checkbox"/> AM <input type="checkbox"/> PM <input checked="" type="checkbox"/> AM & PM	
Observed By: D. Yaunan	<input type="checkbox"/> AM <input type="checkbox"/> PM <input checked="" type="checkbox"/> AM & PM	
Observed By:	<input type="checkbox"/> AM <input type="checkbox"/> PM <input type="checkbox"/> AM & PM	
Observed By:	<input type="checkbox"/> AM <input type="checkbox"/> PM <input type="checkbox"/> AM & PM	

Details

Weather Conditions:	AM: <input checked="" type="checkbox"/> Dry <input checked="" type="checkbox"/> Sunny <input type="checkbox"/> Rain <input type="checkbox"/> Snow <input type="checkbox"/> Other: 21C
	PM: <input checked="" type="checkbox"/> Dry <input checked="" type="checkbox"/> Sunny <input type="checkbox"/> Rain <input type="checkbox"/> Snow <input type="checkbox"/> Other: 25C
Type of Crossing:	<input checked="" type="checkbox"/> 4 Way Intersection <input type="checkbox"/> 3 Way Intersection <input type="checkbox"/> Midblock (i.e., not an intersection)
Type of Control:	<input checked="" type="checkbox"/> Traffic Lights <input type="checkbox"/> Yield Signs <input type="checkbox"/> No Control
	<input type="checkbox"/> Stop Signs (Traffic is stopped on one street only) <input type="checkbox"/> All Way Stop (Traffic is stopped in all directions)

Site Conditions

School Signs:	<input type="checkbox"/> School Area Signs <input type="checkbox"/> School Crossing Signs <input type="checkbox"/> Parking/Stopping Prohibition
Posted Speed Limit:	<input type="checkbox"/> 40 km/hr <input checked="" type="checkbox"/> 50 km/h <input type="checkbox"/> 60 km/hr <input type="checkbox"/> Other:
Visibility of Crossing Pedestrians:	<input type="checkbox"/> Poor <input type="checkbox"/> Fair <input checked="" type="checkbox"/> Good Comments:
Sight Obstructions:	<input type="checkbox"/> Hedges <input type="checkbox"/> Trees <input type="checkbox"/> Fences <input type="checkbox"/> Bus Shelter
	<input type="checkbox"/> Newspaper Boxes <input type="checkbox"/> Other (Specify):
Road Grade:	<input checked="" type="checkbox"/> Flat <input type="checkbox"/> Incline <input type="checkbox"/> Decline
Road Geometrics:	<input checked="" type="checkbox"/> Straight <input type="checkbox"/> Curved Comments:
Road Width:	NA feet/metres Curb to Curb: feet/metres Curb to Median: feet/metres
Road Conditions:	AM: <input checked="" type="checkbox"/> Dry <input type="checkbox"/> Wet <input type="checkbox"/> Snow Covered <input type="checkbox"/> Ice
	PM: <input checked="" type="checkbox"/> Dry <input type="checkbox"/> Wet <input type="checkbox"/> Snow Covered <input type="checkbox"/> Ice
Sidewalks:	<input type="checkbox"/> Not Present <input checked="" type="checkbox"/> North <input checked="" type="checkbox"/> South <input checked="" type="checkbox"/> East <input checked="" type="checkbox"/> West
Proximity to School:	<input type="checkbox"/> In Front of <input checked="" type="checkbox"/> Within 500 feet/metres
Route Survey:	<input type="checkbox"/> Shopping Area <input type="checkbox"/> Construction <input type="checkbox"/> Driveway <input type="checkbox"/> Parked Vehicle(s)
	<input type="checkbox"/> Transit Bus Stop <input type="checkbox"/> Underpass Within feet/metres Other (specify):

Comments / Conflicts: Vehicles compliant with signals and crossing pedestrians. Intersection well marked with zebra marking and countdown timers. Turning traffic courteous to pedestrians. Volume of Traffic heavy on Tomken Rd. in the AM.

4a

Crossing Guard Warrant Survey

Location: Tomken Rd & Runningbrook Dr

☐ Safe Gap TimeSafe Gap Time Calculation (if applicable): $\left(\frac{W}{3.5} + 4 \right)$ NA = sec.☒ Signalized Intersection turning traffic count**Morning Intervals**

Time (AM)	# of Peds	# of Conflicts	Gaps		# of Peds
7:45 - 7:50					
7:50 - 7:55			East Leg	West Leg	
7:55 - 8:00					
8:00 - 8:05					
8:05 - 8:10					
8:10 - 8:15					
8:15 - 8:20					
8:20 - 8:25	/		,	,	
8:25 - 8:30			, , ,	, ,	
8:30 - 8:35			, ,0	,	
8:35 - 8:40			,		
8:40 - 8:45			, ,	,0	
8:45 - 8:50					
8:50 - 8:55					
8:55 - 9:00					

Afternoon Intervals

Time (PM)	# of Peds	# of Conflicts	Gaps		# of Peds
2:45 - 2:50					
2:50 - 2:55			East Leg	West Leg	
2:55 - 3:00					
3:00 - 3:05					
3:05 - 3:10					
3:10 - 3:15					
3:15 - 3:20					
3:20 - 3:25			, , , ,0	, , ,	
3:25 - 3:30			, , ,0	, , , ,	
3:30 - 3:35			, ,	,	
3:35 - 3:40	/		, ,	, ,0	
3:40 - 3:45			, ,	,	
3:45 - 3:50			, , ,	, ,	
3:50 - 3:55			, , ,	, ,	
3:55 - 4:00					

Recommendations

See North/ South Inspection for Recommendations

Observations

Volume of Traffic (see Intersection Plan):

AM: ☐ Heavy ☐ Light ☐ Intermittant PM: ☐ Heavy ☐ Light ☐ Intermittant

Number of Crossing Pedestrians:

AM: North ☐ East ☐ South ☐ West ☐ PM: North ☐ East ☐ South ☐ West ☐

Turning Traffic:

AM: ☐ Heavy ☐ Light ☒ Intermittant PM: ☐ Heavy ☐ Light ☒ Intermittant

4b

Crossing Guard Warrant Survey

Location: Tomken Rd & Runningbrook Dr

☐ Safe Gap Time

Safe Gap Time Calculation (if applicable): $\left(\frac{W}{3.5} + 4 \right)$

NA = sec.

☒ Signalized Intersection turning traffic count

Morning Intervals

Time (AM)	# of Peds	# of Conflicts	Gaps		# of Peds
7:45 - 7:50					
7:50 - 7:55			North Leg	South Leg	
7:55 - 8:00					
8:00 - 8:05					
8:05 - 8:10					
8:10 - 8:15					
8:15 - 8:20					
8:20 - 8:25					
8:25 - 8:30			I,II	I,I	
8:30 - 8:35			I,I	I,II	
8:35 - 8:40		W/S	I,III,II	I,III,0	I
8:40 - 8:45			II,II,I	I,I,0	I
8:45 - 8:50	I		II,III,I	III,II,0	I,IIII
8:50 - 8:55			I,IIII,III	IIII,I,II	II,I
8:55 - 9:00			II,IIII,II	III,III,III	0

Afternoon Intervals

Time (PM)	# of Peds	# of Conflicts	Gaps		# of Peds
2:45 - 2:50					
2:50 - 2:55			North Leg	South Leg	
2:55 - 3:00					
3:00 - 3:05					
3:05 - 3:10					
3:10 - 3:15					
3:15 - 3:20					
3:20 - 3:25					
3:25 - 3:30			III,I,II,I	0,II,0,I,0	
3:30 - 3:35			0,IIII,I,II	II,I,0,I	III
3:35 - 3:40			I,III,I	II,0,0	IIII,II
3:40 - 3:45			0,II,I,II	0,I,0	I,IIII,II
3:45 - 3:50			II,II,0	I,0,0	III
3:50 - 3:55			I,III,I,II	II,I,I,0	0
3:55 - 4:00			0,0,I,II,II	I,0,0,0,0	0

Recommendations

1) That the warrants for a crossing guard have not been met.

Observations

Volume of Traffic (see Intersection Plan):

Tomken Rd AM: ☒ Heavy ☐ Light ☐ Intermittant PM: ☐ Heavy ☒ Light ☐ Intermittant

Number of Crossing Pedestrians:

AM: North 1 East South 11 West PM: North 0 East South 23 West

Turning Traffic:

AM: ☐ Heavy ☐ Light ☒ Intermittant PM: ☐ Heavy ☐ Light ☒ Intermittant

4c

Additional Comments/Conflicts

AM - **/S

Pedestrian crossing with adult on South Leg - vehicle on southwest corner turning from Runningbrook to Tomken Rd. southbound(right turn) did not allow pedestrians to cross in front of vehicle. Pedestrian handled it well and was aware.

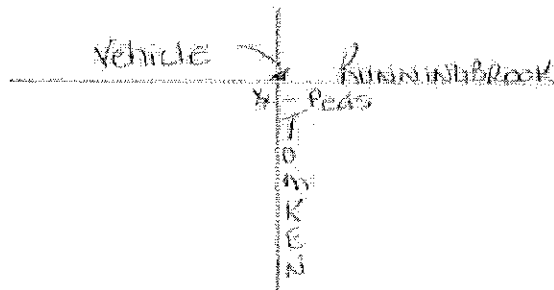

Students use pedestrian crossing signal buttons and walking zones properly. Student confidence high in crossing roads.

Additional Recommendations

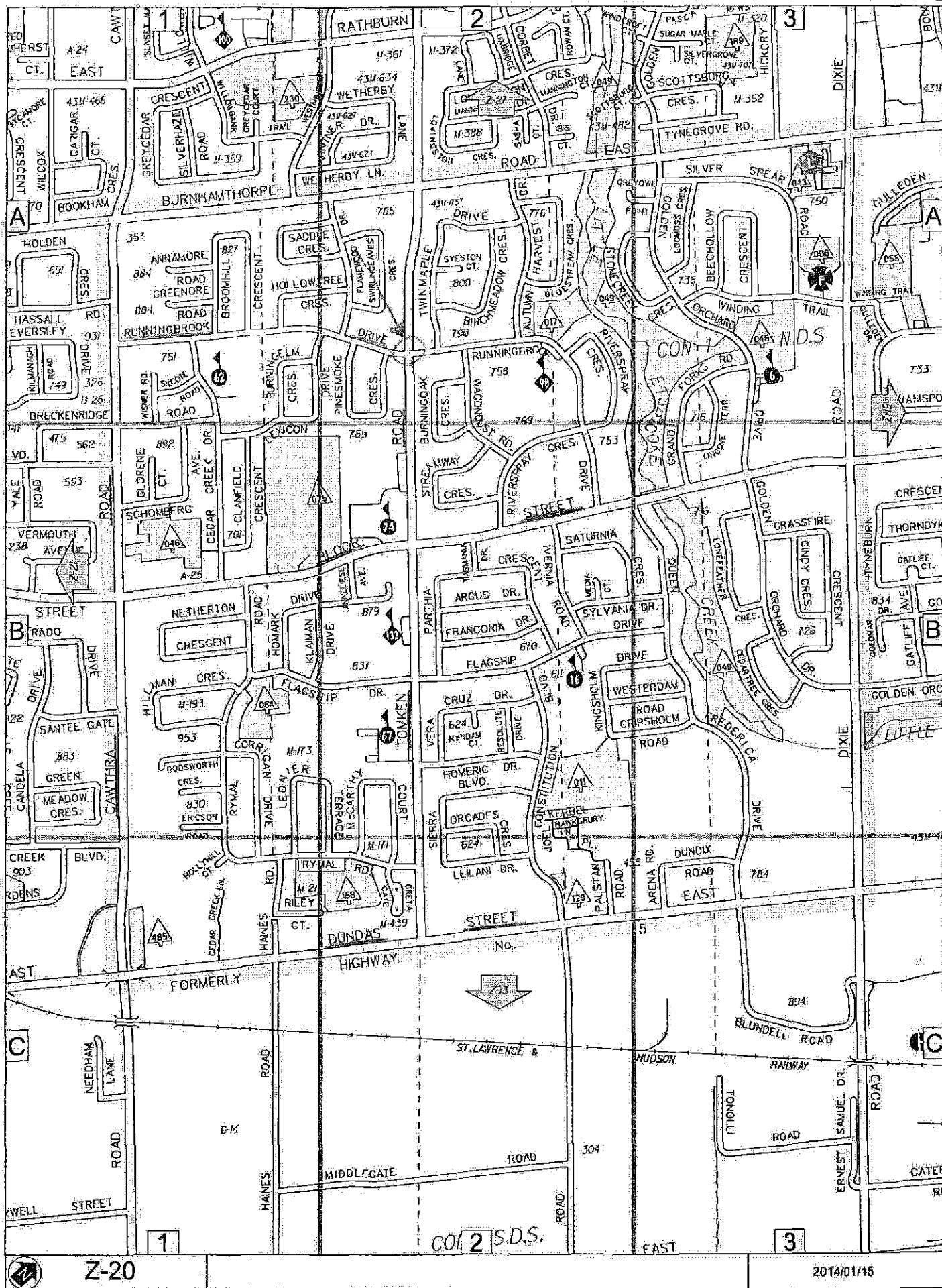

Tomken Rd + Running Brook Dr 8:25-9:00 & 3:25-4:00

4e

Heather McGuire

From: Sheelagh Duffin
Sent: 2015/06/01 10:53 AM
To: Heather McGuire
Cc: Angie Melo; Chris Fonseca
Subject: RE: Crossing guard at Runningbrook for SilverThorn and Blessed Teresa

Hi Heather,

Hello Heather,

As per the request below, would you kindly schedule a further site inspection to determine if the warrants are met for a crossing guard at the intersection of Tomken Road and Runningbrook Drive for the students of Silverthorn Public School and Blessed Teresa of Calcutta Catholic School. The times for the inspection are: 8:25 - 9:00 and 3:25 - 4:00 pm.

Thank you.

Sheelagh
5167

Sheelagh Duffin
Supervisor, Crossing Guards
T 905-896-5167 | F 905-896-5166
sheelagh.duffin@mississauga.ca

City of Mississauga | Transportation and Works Department, Works Operations and Maintenance Division
3185 Mavis Road
Mississauga ON L5C 1T7

Please consider the environment before printing.

-----Original Message-----

From: Angie Melo
Sent: 2015/06/01 10:30 AM
To: Sheelagh Duffin
Subject: FW: Crossing guard at Runningbrook for SilverThorn and Blessed Teresa

Please review the request below.

-----Original Message-----

From: Chris Fonseca
Sent: 2015/06/01 9:18 AM
To: Angie Melo
Subject: FW: Crossing guard at Runningbrook for SilverThorn and Blessed Teresa

Good Morning Angie,

4 f

With the nicer weather, there are many more students walking and crossing at this light.

Can TSC go out one more time to monitor this intersection.

Thanks
Chris

Sent from my iPhone

Site Inspection Report



Traffic Safety Council
JUN 24 2015

Corporate Services
Office of the City Clerk

5

Site	
School: St. Francis of Assisi CS	Address: 2480 Thornlodge Dr Mississauga ON L5K 1K5
School: Sheridan Park Public School	Address: 2280 Perran Dr Mississauga ON L5K 1M1
School Times: 8:00 AM 3:00 PM	Student Population: 508
No. of School Buses: 248	Bused
School Times: 9:00 AM 3:30 PM	Student Population: 569
No. of School Buses: 375	Bused

Location: (Please identify the location with reference to nearest intersection. Indicate nearest school and address)
Barcella Cres & Homelands Dr.

Date of Inspection: 2015 06 17 Inspection Time: 8:00 AM 3:00 PM Requested By: Councilor Ras/parent

Prepared By: S. Beniuk Request For: Safety review & site inspection

Observers	
File Number: RT.10	File Number: RT.10
Ward: Ward 2	
Observed By: S. Beniuk	<input type="checkbox"/> AM <input type="checkbox"/> PM <input checked="" type="checkbox"/> AM & PM
Observed By: S. Duffin	<input type="checkbox"/> AM <input type="checkbox"/> PM <input checked="" type="checkbox"/> AM & PM
Observed By: A. Liya	<input type="checkbox"/> AM <input type="checkbox"/> PM <input checked="" type="checkbox"/> AM & PM
Observed By:	<input type="checkbox"/> AM <input type="checkbox"/> PM <input type="checkbox"/> AM & PM
Observed By:	<input type="checkbox"/> AM <input type="checkbox"/> PM <input type="checkbox"/> AM & PM
Observed By:	<input type="checkbox"/> AM <input type="checkbox"/> PM <input type="checkbox"/> AM & PM

Details	
Weather Conditions:	AM: <input checked="" type="checkbox"/> Dry <input checked="" type="checkbox"/> Sunny <input type="checkbox"/> Rain <input type="checkbox"/> Snow <input type="checkbox"/> Other: 17C
	PM: <input checked="" type="checkbox"/> Dry <input checked="" type="checkbox"/> Sunny <input type="checkbox"/> Rain <input type="checkbox"/> Snow <input type="checkbox"/> Other: 20C
Type of Crossing:	<input type="checkbox"/> 4 Way Intersection <input checked="" type="checkbox"/> 3 Way Intersection <input type="checkbox"/> Midblock (i.e., not an intersection)
Type of Control:	<input type="checkbox"/> Traffic Lights <input type="checkbox"/> Yield Signs <input type="checkbox"/> No Control
	<input checked="" type="checkbox"/> Stop Signs (Traffic is stopped on one street only) <input type="checkbox"/> All Way Stop (Traffic is stopped in all directions)

Site Conditions	
School Signs:	<input checked="" type="checkbox"/> School Area Signs <input type="checkbox"/> School Crossing Signs <input type="checkbox"/> Parking/Stopping Prohibition
Posted Speed Limit:	<input checked="" type="checkbox"/> 40 km/hr <input type="checkbox"/> 50 km/hr <input type="checkbox"/> 60 km/hr <input type="checkbox"/> Other:
Visibility of Crossing Pedestrians:	<input type="checkbox"/> Poor <input type="checkbox"/> Fair <input checked="" type="checkbox"/> Good Comments:
Sight Obstructions:	<input type="checkbox"/> Hedges <input type="checkbox"/> Trees <input type="checkbox"/> Fences <input type="checkbox"/> Bus Shelter
	<input type="checkbox"/> Newspaper Boxes <input type="checkbox"/> Other (Specify):
Road Grade:	<input type="checkbox"/> Flat <input checked="" type="checkbox"/> Incline very slight <input type="checkbox"/> Decline
Road Geometrics:	<input type="checkbox"/> Straight <input type="checkbox"/> Curved Comments:
Road Width:	10 feet/metres Curb to Curb: feet/metres Curb to Median: feet/metres
Road Conditions:	AM: <input checked="" type="checkbox"/> Dry <input type="checkbox"/> Wet <input type="checkbox"/> Snow Covered <input type="checkbox"/> Ice
	PM: <input checked="" type="checkbox"/> Dry <input type="checkbox"/> Wet <input type="checkbox"/> Snow Covered <input type="checkbox"/> Ice
Sidewalks:	<input type="checkbox"/> Not Present <input checked="" type="checkbox"/> North <input checked="" type="checkbox"/> South <input checked="" type="checkbox"/> East <input checked="" type="checkbox"/> West
Proximity to School:	<input type="checkbox"/> In Front of <input checked="" type="checkbox"/> Within 500 feet/metres
Route Survey:	<input type="checkbox"/> Shopping Area <input type="checkbox"/> Construction <input type="checkbox"/> Driveway <input type="checkbox"/> Parked Vehicle(s)
	<input checked="" type="checkbox"/> Transit Bus Stop <input type="checkbox"/> Underpass Within feet/metres Other (specify):
Comments / Conflicts:	SEE BELOW FOR ALL COMMENTS

59

Site Inspection Report



Corporate Services
Office of the City Clerk

Site		School: Thorn Lodge Public School		Address: 2730 Thorn Lodge Dr Mississauga ON L5K 1L2		School Times: 9:00 AM 3:30 PM	
						Student Population: 347	
						No. of School Buses: 281 Bused	
School:		Address:		School Times:		Student Population:	
				No. of School Buses:			

Location: (Please identify the location with reference to nearest intersection. Indicate nearest school and address)
Homelands Dr & Barcella Cres.

Date of Inspection: 2015 06 17 **Inspection Time:** 8:00 AM 3:00 PM **Requested By:** Councilor Ras/parent

Prepared By: S. Beniuk **Request For:** safety review & site inspection

Observers		File Number: RT.10		File Number: RT.10		Ward: Ward 2	
Observed By: S. Beniuk						<input type="checkbox"/> AM <input type="checkbox"/> PM <input checked="" type="checkbox"/> AM & PM	
Observed By: S. Duffin						<input type="checkbox"/> AM <input type="checkbox"/> PM <input checked="" type="checkbox"/> AM & PM	
Observed By: A. Liya						<input type="checkbox"/> AM <input type="checkbox"/> PM <input checked="" type="checkbox"/> AM & PM	
Observed By:						<input type="checkbox"/> AM <input type="checkbox"/> PM <input type="checkbox"/> AM & PM	
Observed By:						<input type="checkbox"/> AM <input type="checkbox"/> PM <input type="checkbox"/> AM & PM	
Observed By: See previous page for details below						<input type="checkbox"/> AM <input type="checkbox"/> PM <input type="checkbox"/> AM & PM	

Details

Weather Conditions: AM: ☐ Dry ☐ Sunny ☐ Rain ☐ Snow ☐ Other:
PM: ☐ Dry ☐ Sunny ☐ Rain ☐ Snow ☐ Other:
Type of Crossing: ☐ 4 Way Intersection ☐ 3 Way Intersection ☐ Midblock (i.e., not an intersection)
Type of Control: ☐ Traffic Lights ☐ Yield Signs ☐ No Control
☐ Stop Signs (Traffic is stopped on one street only) ☐ All Way Stop (Traffic is stopped in all directions)

Site Conditions

School Signs: ☐ School Area Signs ☐ School Crossing Signs ☐ Parking/Stopping Prohibition

Posted Speed Limit: ☐ 40 km/hr ☐ 50 km/h ☐ 60 km/hr ☐ Other:
Visibility of Crossing Pedestrians: ☐ Poor ☐ Fair ☐ Good **Comments:**
Sight Obstructions: ☐ Hedges ☐ Trees ☐ Fences ☐ Bus Shelter
☐ Newspaper Boxes ☐ Other (Specify):
Road Grade: ☐ Flat ☐ Incline ☐ Decline
Road Geometrics: ☐ Straight ☐ Curved **Comments:**
Road Width: feet/metres **Curb to Curb:** feet/metres **Curb to Median:** feet/metres
Road Conditions: AM: ☐ Dry ☐ Wet ☐ Snow Covered ☐ Ice
PM: ☐ Dry ☐ Wet ☐ Snow Covered ☐ Ice
Sidewalks: ☐ Not Present ☐ North ☐ South ☐ East ☐ West
Proximity to School: ☐ In Front of ☐ Within feet/metres
Route Survey: ☐ Shopping Area ☐ Construction ☐ Driveway ☐ Parked Vehicle(s)
☐ Transit Bus Stop ☐ Underpass Within feet/metres **Other (specify):**
Comments / Conflicts:

5b

Crossing Guard Warrant Survey

Location: Homelands Dr & Barcella Cres. - East Leg

☒ Safe Gap Time Safe Gap Time Calculation (if applicable): $\left(\frac{W}{3.5} + 4 \right)$ 13 = sec.
☐ Signalized Intersection turning traffic count

Morning Intervals

Time (AM)	# of Peds	# of Conflicts	Gaps	# of Gaps
7:45 - 7:50				
7:50 - 7:55				
7:55 - 8:00				
8:00 - 8:05			II, 20, IIIII, 27, II, 17, I, 22, I, 28, III, 22	8
8:05 - 8:10	I		58, I, 17, I, 24, IIIII, 27, IIIIIII, 21, IIIIIIIII, 29	11
8:10 - 8:15	II		I, 29, II, 13, IIII, 28, I, 20, II, 23, II, 28, I	9
8:15 - 8:20	IIII		20, IIII, 34, IIIIIIIII, 18, II, 20, IIIII, 15, IIIIIIIII	6
8:20 - 8:25	II		IIIIIIIIIIIIII, 13, III, 22, IIII, 13, I, 17, IIIII	4
8:25 - 8:30			IIIIII, 17, III, 15, IIIIIII, 17, 25, 16, II	5
8:30 - 8:35			30, I, 31, III, 25, IIIII, 17, I, 21, 13, II	8
8:35 - 8:40			91, I, 19, 38, IIIIIIIII, 25, III, 54, II	15
8:40 - 8:45			20, II, 23, IIII, 25, I, 13, II, 19, 26, 34, I	9
8:45 - 8:50			74, IIII, 22, 32, I, 15, III, 30, I, 28	13
8:50 - 8:55			III, 36, IIIII, 25, 14, 14, I, 13, 45, IIIII, 21, II	10
8:55 - 9:00			II, 15, II, 17, I, 38, II, 16, 14, I, 55, II, 38	12

Afternoon Intervals

Time (PM)	# of Peds	# of Conflicts	Gaps	# of Gaps
2:45 - 2:50				
2:50 - 2:55				
2:55 - 3:00				
3:00 - 3:05	I		42, 15, II, 13, 14, 23, II, 20, 45, 15, I	12
3:05 - 3:10	IIIIII		20, II, 22, IIII, 15, 30, II, 14, 19, 44, III, 15, II	11
3:10 - 3:15	I		14, I, 30, II, 20, 13, I, 22, IIIII, 50, 3+, IIIII, 13, II, 18	13
3:15 - 3:20			II, 14, I, 15, IIIII, 33, IIIII, 23, II, 13, 31, IIII	8
3:20 - 3:25			18, I, 24, I, 27, IIIIIII, 20, II, 29, I, 19, IIIII	8
3:25 - 3:30			I, 18, IIIII, 23, I, 21, I, 45, II, 18, I, 20, II, 23, III, 16, III, 20, I	11
3:30 - 3:35				
3:35 - 3:40				
3:40 - 3:45				
3:45 - 3:50				
3:50 - 3:55				
3:55 - 4:00				

Recommendations

- 1) That the warrants for a crossing guard have not been met.
- 2) That Transportation & Works be requested to review extending No U Turn signage and review all other signage in front of Homelands Sr. Public School
- 3) That Peel Regional Police be requested to monitor/enforce speeding between 3:00 and 3:30 PM

Observations

Volume of Traffic (see Intersection Plan):
 AM: ☐ Heavy ☐ Light ☒ Intermittant PM: ☐ Heavy ☒ Light ☐ Intermittant

Number of Crossing Pedestrians:
 AM: North ☐ East 9 South ☐ West ☐ PM: North ☐ East 8 South ☐ West ☐

Turning Traffic:
 AM: ☐ Heavy ☐ Light ☐ Intermittant PM: ☐ Heavy ☐ Light ☐ Intermittant

5c

Additional Comments/Conflicts

- Homelands Sr. Public School used path across from school. These students in grades 6 - 8 are outside the mandate for a crossing guard
- No Thornlodge or Sheridan Park Students crossed in either the AM or PM.
- Thornlodge students crossed with the crossing guard at Thornlodge Dr & Homelands Dr.
- Some evidence of speeding in PM
- All crossing students for St. Francis of Assisi CS crossed with parents

Additional Recommendations

5d

Homelands Dr & Barcella (1st/2nd Leg) 8:00-9:00 + 3:00-4:00

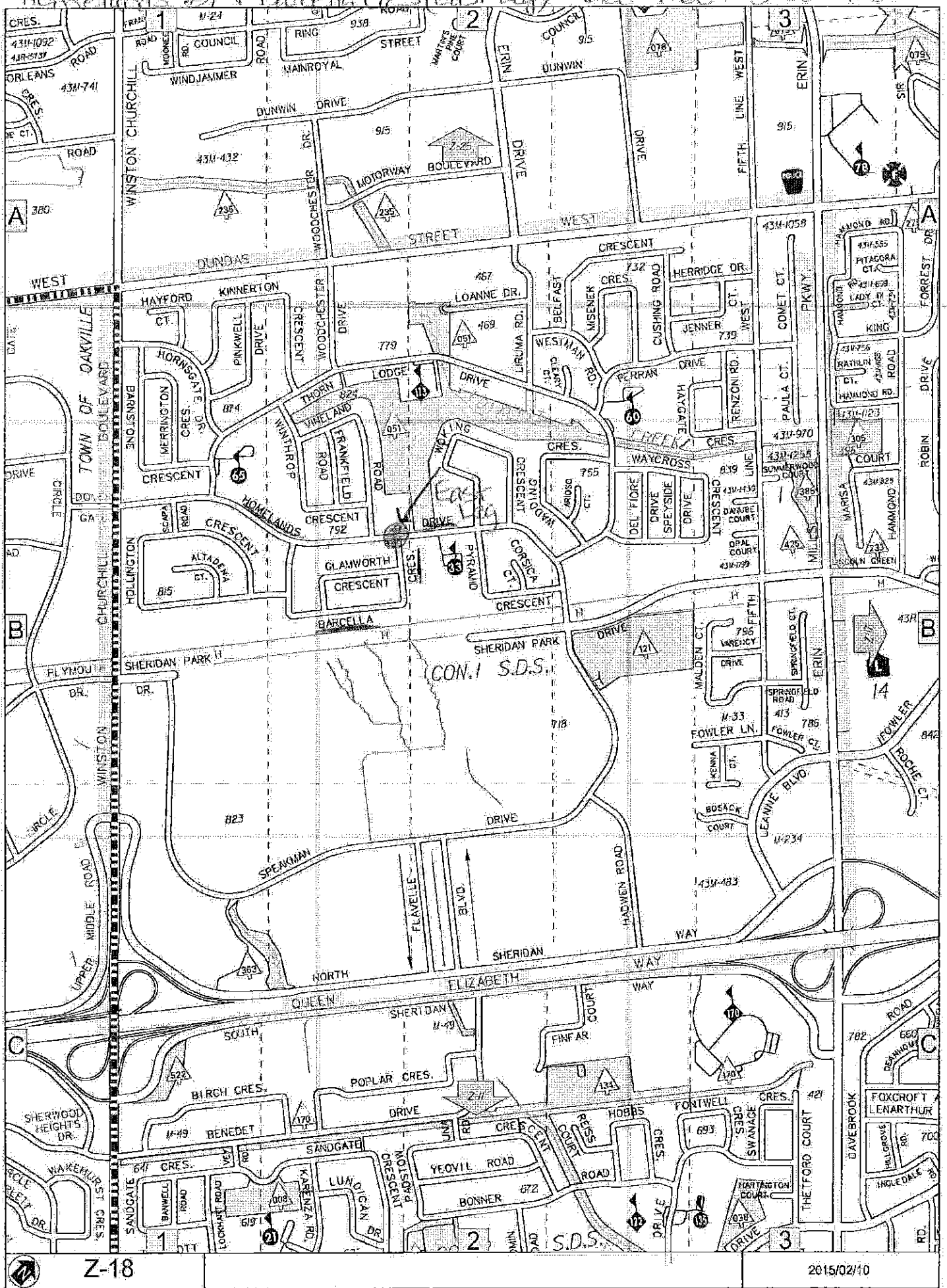

5e

Homelands Dr & Barcella Cres (east leg) 8:00-9:00 + 3:00-4:00

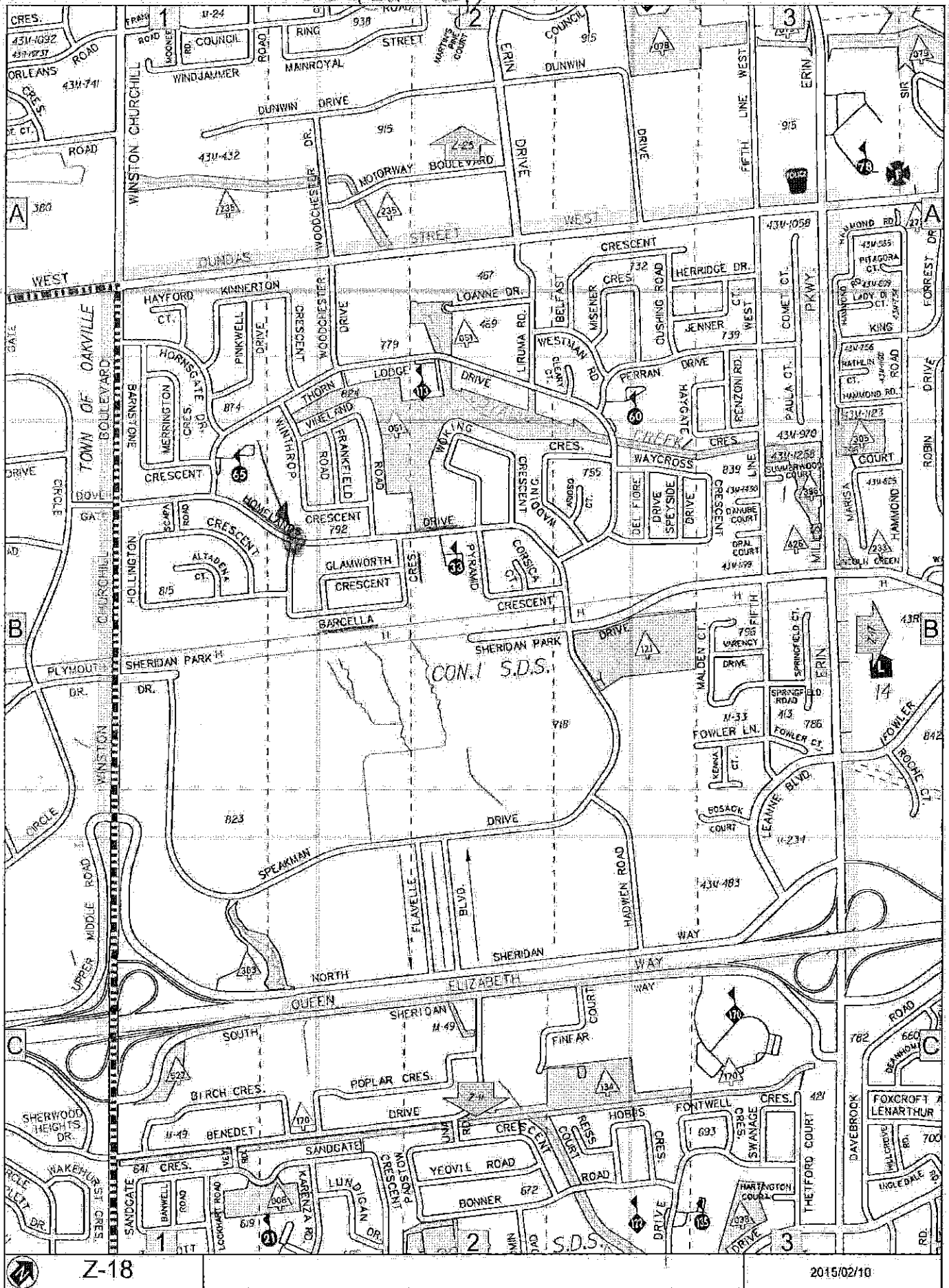

Angie Melo

5f

From: Sheelagh Duffin
Sent: 2015/06/09 2:30 PM
To: Heather McGuire
Cc: Angie Melo; Jennifer Waye; Karen Ras; Helena Francisco
Subject: RE: Traffic Safety Council: Homeland Drive and BarcellaCres.

Hi Heather,

As per the email below, would you kindly schedule a site inspection and safety review at Homelands Drive and Barcella Crescent (the east leg) opposite Thorn Lodge Park for the students of St. Francis of Assisi Catholic School and Sheridan Park Public School . There has not been an inspection at this location in several years.

The times of the inspection would be 8:00 to 9:00 am and 3:00 – 4:00.

Thank you.

Sheelagh
5167



Sheelagh Duffin
Supervisor, Crossing Guards
T 905-896-5167 | F 905-896-5166
sheelagh.duffin@mississauga.ca

City of Mississauga | Transportation and Works Department,
Works Operations and Maintenance Division
3185 Mavis Road
Mississauga ON L5C 1T7

Please consider the environment before printing.

From: Angie Melo
Sent: 2015/06/09 12:33 PM
To: Sheelagh Duffin
Cc: Angie Melo
Subject: FW: Traffic Safety Council: Homeland Drive and BarcellaCres.

Hi Sheelagh,

Please review the email request below.

Thank you



Angie Melo
Legislative Coordinator
T 905-615-3200 ext.5423
angie.melo@mississauga.ca

City of Mississauga | Corporate Services Department,
Legislative Services Division

59

Please consider the environment before printing.

From: Jennifer Waye
Sent: 2015/06/08 3:04 PM
To: Angie Melo
Cc: Karen Ras; Helena Francisco
Subject: Traffic Safety Council: Homeland Drive and BarcellaCres.

Good afternoon Angie,

Councillor Ras has been approached by some moms in this area with the request for a crosswalk or some other crossing system. Their request was reviewed and rejected by T&W, so now we are looking to see if there is anything that can be done by the Traffic Safety Council.

Has this area ever been reviewed? Is there a way to make the crossing of Homelands safer? The elementary schools (Thorn Lodge and St. Francis of Assisi) are across the road, and there is a very long stretch of Homelands without a stop sign.

Thank you,

Jennifer Waye
Administrative Assistant to
Councillor Karen Ras, Ward 2

Site Inspection Report



Traffic Safety Council

JUN 24 2015

Corporate Services
Office of the City Clerk

Site	
School: Holy Cross Catholic School	Address: 3615 Morning Star Dr Mississauga ON L4T 1Y4
School: Corliss Public School	Address: 3730 Corliss Cres Mississauga ON L4T 2Z4
School Times: 8:30 AM 3:00 PM	Student Population: 564
No. of School Buses: 56	BUSED
School Times: 8:40 AM 3:00 PM	Student Population: 273
No. of School Buses: 0	

Location: (Please identify the location with reference to nearest intersection. Indicate nearest school and address)
Darcel Ave. & Brandon Gate Dr.

Date of Inspection: 2015 06 18 Inspection Time: 8:00 AM | 3:00 PM Requested By: Parent/Councillor Parrish

Prepared By: L. Goegan Request For: Crossing Guard

Observers	
File Number: RT.10	File Number: RT.10
Ward: Ward 5	
Observed By: S. Duffin	<input type="checkbox"/> AM <input type="checkbox"/> PM <input checked="" type="checkbox"/> AM & PM
Observed By: L. Goegan	<input type="checkbox"/> AM <input type="checkbox"/> PM <input checked="" type="checkbox"/> AM & PM
Observed By: D. Yaunan	<input type="checkbox"/> AM <input type="checkbox"/> PM <input checked="" type="checkbox"/> AM & PM
Observed By:	<input type="checkbox"/> AM <input type="checkbox"/> PM <input type="checkbox"/> AM & PM
Observed By:	<input type="checkbox"/> AM <input type="checkbox"/> PM <input type="checkbox"/> AM & PM
Observed By:	<input type="checkbox"/> AM <input type="checkbox"/> PM <input type="checkbox"/> AM & PM

Details	
Weather Conditions:	AM: <input checked="" type="checkbox"/> Dry <input checked="" type="checkbox"/> Sunny <input type="checkbox"/> Rain <input type="checkbox"/> Snow <input type="checkbox"/> Other: 21c
	PM: <input checked="" type="checkbox"/> Dry <input type="checkbox"/> Sunny <input type="checkbox"/> Rain <input type="checkbox"/> Snow <input type="checkbox"/> Other: 25C
Type of Crossing:	<input checked="" type="checkbox"/> 4 Way Intersection <input type="checkbox"/> 3 Way Intersection <input type="checkbox"/> Midblock (i.e., not an intersection)
Type of Control:	<input checked="" type="checkbox"/> Traffic Lights <input type="checkbox"/> Yield Signs <input type="checkbox"/> No Control
	<input type="checkbox"/> Stop Signs (Traffic is stopped on one street only) <input type="checkbox"/> All Way Stop (Traffic is stopped in all directions)

Site Conditions	
School Signs:	<input type="checkbox"/> School Area Signs <input type="checkbox"/> School Crossing Signs <input type="checkbox"/> Parking/Stopping Prohibition
Posted Speed Limit:	<input type="checkbox"/> 40 km/hr <input checked="" type="checkbox"/> 50 km/h <input type="checkbox"/> 60 km/hr <input type="checkbox"/> Other:
Visibility of Crossing Pedestrians:	<input type="checkbox"/> Poor <input type="checkbox"/> Fair <input checked="" type="checkbox"/> Good Comments:
Sight Obstructions:	<input type="checkbox"/> Hedges <input type="checkbox"/> Trees <input type="checkbox"/> Fences <input type="checkbox"/> Bus Shelter
	<input type="checkbox"/> Newspaper Boxes <input type="checkbox"/> Other (Specify):
Road Grade:	<input checked="" type="checkbox"/> Flat <input type="checkbox"/> Incline <input type="checkbox"/> Decline
Road Geometrics:	<input checked="" type="checkbox"/> Straight <input type="checkbox"/> Curved Comments:
Road Width:	NA feet/metres Curb to Curb: feet/metres Curb to Median: feet/metres
Road Conditions:	AM: <input checked="" type="checkbox"/> Dry <input type="checkbox"/> Wet <input type="checkbox"/> Snow Covered <input type="checkbox"/> Ice
	PM: <input checked="" type="checkbox"/> Dry <input type="checkbox"/> Wet <input type="checkbox"/> Snow Covered <input type="checkbox"/> Ice
Sidewalks:	<input type="checkbox"/> Not Present <input type="checkbox"/> North <input type="checkbox"/> South <input type="checkbox"/> East <input type="checkbox"/> West
Proximity to School:	<input type="checkbox"/> In Front of <input checked="" type="checkbox"/> Within 500 feet/metres
Route Survey:	<input checked="" type="checkbox"/> Shopping Area <input type="checkbox"/> Construction <input type="checkbox"/> Driveway <input type="checkbox"/> Parked Vehicle(s)
	<input checked="" type="checkbox"/> Transit Bus Stop <input type="checkbox"/> Underpass Within feet/metres Other (specify):

Comments / Conflicts: Most children crossing looked older. Signage is good. No conflicts observed. Intersection works well. Well marked with zebra stripes. Students crossed confidently. Traffic courteous to crossing pedestrians.

69

Crossing Guard Warrant Survey

Location: Brandon Gate Dr & Darcel Ave.

☐ Safe Gap TimeSafe Gap Time Calculation (if applicable): $\left(\frac{W}{3.5} + 4 \right)$

NA = sec.

☒ Signalized Intersection turning traffic count**Morning Intervals**

Time (AM)	# of Peds	# of Conflicts	Gaps	# of Gaps
7:45 - 7:50				
7:50 - 7:55				
7:55 - 8:00				
8:00 - 8:05				
8:05 - 8:10				
8:10 - 8:15				
8:15 - 8:20	/			
8:20 - 8:25				
8:25 - 8:30				
8:30 - 8:35				
8:35 - 8:40				
8:40 - 8:45				
8:45 - 8:50				
8:50 - 8:55				
8:55 - 9:00				

Afternoon Intervals

Time (PM)	# of Peds	# of Conflicts	Gaps	# of Gaps
2:45 - 2:50				
2:50 - 2:55				
2:55 - 3:00				
3:00 - 3:05				
3:05 - 3:10				
3:10 - 3:15				
3:15 - 3:20				
3:20 - 3:25				
3:25 - 3:30				
3:30 - 3:35				
3:35 - 3:40				
3:40 - 3:45				
3:45 - 3:50				
3:50 - 3:55				
3:55 - 4:00				

Recommendations

That the warrants for a crossing guard have not been met, traffic control signals provide protection for crossing students.

Observations

Volume of Traffic (see Intersection Plan):

AM:

☐ Heavy☐ Light☐ Intermittant

PM:

☐ Heavy☐ Light☐ Intermittant

Number of Crossing Pedestrians:

AM:

North

East

South

6

West

PM:

North

East

South

4

West

Turning Traffic:

AM:

☐ Heavy☐ Light☒ Intermittant

PM:

☐ Heavy☐ Light☒ Intermittant

Cob

Angie Melo

From: Sheelagh Duffin
Sent: 2015/06/16 4:44 PM
To: Heather McGuire
Cc: Angie Melo; Carolyn Parrish
Subject: RE: [SUSPICIOUS MESSAGE] SPEED BREAKERS ON PENNY LANE & School Guards

Hello Heather,

As per the email below, would you kindly schedule a site inspection at the intersection of Brandon Gate Drive and Darcel Avenue for the students of Corliss Public School and Holy Cross Catholic School to determine if the warrants are met for the implementation of a school crossing guard. The times of the inspection would be 8:00 – 8:40 am and 3:00 – 3:30 pm. Traffic Safety has not conducted a site inspection at this location in recent years.

Kindly notify Mr. Khan and Councillor Parrish of the date and time of the Site Inspection once it is scheduled.

Thank you.

Sheelagh
5167



Sheelagh Duffin
Supervisor, Crossing Guards
T 905-896-5167 | F 905-896-5166
sheelagh.duffin@mississauga.ca

City of Mississauga | Transportation and Works Department,
Works Operations and Maintenance Division
3185 Mavis Road
Mississauga ON L5C 1T7

Please consider the environment before printing.

From: Carolyn Parrish
Sent: 2015/06/16 4:02 PM
To: Sheelagh Duffin
Cc: Angie Melo
Subject: FW: [SUSPICIOUS MESSAGE] SPEED BREAKERS ON PENNY LANE & School Guards

Hi Sheelagh,

Below is Mr. Khan's reasoning for his request. Please let me know when we could set up an on-site with him.

Thank you,
Carolyn

From: A Khan [redacted]
Sent: 2015/06/10 11:17 AM
To: Carolyn Parrish
Subject: Re: [SUSPICIOUS MESSAGE] SPEED BREAKERS ON PENNY LANE & School Guards

Hi Carolyn,

6c Thanks for your feedback. I completely agree with you in terms of Crossing Guards for Elementary schools. In lieu of this there are kids like my son from this side of the neighborhood (Darcel & Brandon Gate) too who attends school at Corliss and Holy Cross . What about them? My elder son who is in Darcel take his younger brother and cross the intersection on their own in the morning and afternoon. Likewise I have seen so many other kids who takes their siblings and cross the intersection of Darcel & Brandon Gate so they can drop them to Corliss. I might have stressed on Darcel because that's in between the two intersections I mentioned however its more about the elementary kids and I believe they deserve equal protection as well.

With Corliss being the elementary school within our residential address guidelines and because Peel has a strict policy in terms of number of kilometers in distance from the school to the residence in order to provide School Bus service residents at Penny Lane, Sigsbee, Brandon Gate Drive do not get the option of school bus service.

I would definitely like you to raise this issue as its unfair for the kids coming from Darcel and Brandon Gate drive intersection because they cannot get a school crossing guard OR a school bus service option.

On Wed, Jun 10, 2015 at 10:32 AM, Carolyn Parrish <Carolyn.Parrish@mississauga.ca> wrote:

From: Ashfaque Khan [mailto:;]
Sent: 2015/06/08 4:27 PM
To: Carolyn Parrish
Subject: Re: [SUSPICIOUS MESSAGE] SPEED BREAKERS ON PENNY LANE & School Guards

Hi Carolyn

Thank you so much for your reply. I would love to meet the Transportation and Works department to find a suitable solution for the safety of the kids and the drivers. I certainly can't wait for the school crossing guard at Darcel & Brandon Gate drive as I have seen kids going to Darcel public school use it every morning and evening.

If you need anything from me please advise. Once again thank you for getting back.

Mr.Khan

Sent from my iPhone

On Jun 8, 2015, at 4:03 PM, Carolyn Parrish <Carolyn.Parrish@mississauga.ca> wrote:

Hello Ashfaque,

Thanks for both calling and emailing my office.

led

Speed bumps are not permitted on any City road, as they slow down emergency response times. I will however take the speeding concern to Transportation and Works and arrange an on-site inspection.

I will also put in your request for a School Crossing Guard.

Will be in touch soon,

Carolyn

Carolyn Parrish

Councillor, Ward 5

T 905-896-5500 | F 905-896-5463

City of Mississauga

300 City Centre Drive | Mississauga ON | L5B 3C1

www.CarolynParrish.ca

[Sign up for my newsletter](#) to learn about what's going on in Ward 5.

<image001.png>



6e
From: A Khan
Sent: 2015/06/08 10:14 AM
To: Carolyn Parrish
Subject: [SUSPICIOUS MESSAGE] SPEED BREAKERS ON PENNY LANE & School Guards

WARNING: Your email security system has determined the message below may be a potential threat.

If you do not know the sender or cannot verify the integrity of the message, please do not respond or click on links in the message. Depending on the security settings, clickable URLs may have been modified to provide additional security.

Hi Carolyn,

My name is Mr. Ashfaque Khan and I live on Penny Lane in Malton. I have couple of issues which I would like to discuss with you and find a possible solution for the residents in and around Penny Lane.

Please find below the issues which we would like to have your attention:

> Speed Bumps on Penny Lane:

As you are aware of Penny lane is a cul-de-sac street where the traffic ends once you enter it. The residents have small kids in the range of 2-12 yrs playing out during spring/summer months. The parents usually watch the kids however there is always danger of a kid getting hit by a car or so because some of the residents drive a bit faster (above 40kmh). It is in this regard I would request you to kindly arrange for couple of speed bumps installed on the street to avoid any incident.

> School Guard at the intersection of Darcel & Brandon Gate Drive:

Darcel Public School is located between two major intersections (Darcel/Brandon Gate & Darcel/Morningstar Dr). We have 2 school guards at the light of Darcel/Morningstar Dr however we do not have a single guard at Darcel/Brandon Gate lights. The traffic in my opinion is much higher at Darcel/Brandon Gate as the cars are coming off Finch and Hwy 427. I would like your assistance in this regard as to what are the procedures involved so that we can get school guard effective September 2015.

I would appreciate your response. Thank you.

--

From: Angie Melo
Sent: 2015/06/19 12:38 PM
To: Mary Maiorano
Cc: Sheelagh Duffin
Subject: Canadian Martyrs Catholic School

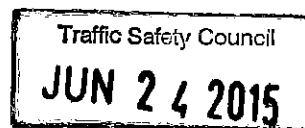

Good afternoon Mary,

Further to our telephone conversation today regarding the concerns expressed by parents of students in junior kindergarten and senior kindergarten attending Canadian Martyrs Catholic School with respect to parking in front of the school, parking on school property, and the Kiss & Ride area, please be advised that I am adding to the Traffic Safety Council's June 24, 2015 agenda the request for a safety review to be conducted in front of Canadian Martyrs Catholic School (1185 Mississauga Valley Blvd.). As we are approaching the end of the school year, the safety review will not be scheduled until the beginning of the school year in September 2015.

Once a date is scheduled for the safety review, you will be advised of the date and time, in the event the parent(s) wish to attend.

Thank you



Angie Melo
Legislative Coordinator
T 905-615-3200 ext.5423
angie.melo@mississauga.ca

City of Mississauga | Corporate Services Department,
Legislative Services Division

Please consider the environment before printing.

7.2

Angie Melo

Subject: FW: crossing guard needed

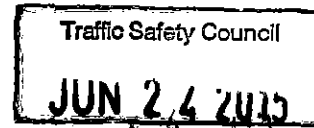

From: Sheelagh Duffin
Sent: 2015/06/19 12:39 PM
To: Rea, Alison
Cc: Angie Melo; Heather McGuire
Subject: RE: crossing guard needed

Hello Alison,

Thank you for your email.

The mandate of Mississauga Traffic Safety Council is to consider matters related to the safety of students in Mississauga. This includes recommending crossing guards where the warrants are met for students age kindergarten to grade 5. Studies show that students by the age of 10 are able to make good judgements related to traffic and crossing the road.

Traffic Safety Council does, however, conduct safety reviews for all ages of students and make recommendations related to traffic issues and signage. Based on your email, I am assuming that the school you are referring to is Dolphin Senior Public School. Therefore, by copy of this email to Heather McGuire I am requesting that she schedule a Safety Review for the intersection of Queen Street and Britannia Road West for the students of Dolphin Senior Public School for the month of September 2015 when school resumes. The times for the review would be 8:00 – 8:30 am and 2:30 – 3:00 pm.

Thank you. Should you have further questions, please do not hesitate to contact me.

Sheelagh



Sheelagh Duffin
Supervisor, Crossing Guards
T 905-896-5167 | F 905-896-5166
sheelagh.duffin@mississauga.ca

City of Mississauga | Transportation and Works Department,
Works Operations and Maintenance Division
3185 Mavis Road
Mississauga ON L5C 1T7

Please consider the environment before printing.

From: Rea, Alison [<mailto:AREa@nexeosolutions.com>]
Sent: 2015/06/19 10:47 AM
To: Sheelagh Duffin
Subject: FW: crossing guard needed

Sorry I didn't attach

Hi Heather,

7.29

My name is Alison and I just left you a message in regards to my son being hit yesterday at a major intersection in Streetsville. He was crossing the road just around 8 am crossing over Queen st/Mississauga road towards Britannia, he was walking with the walk sign and a car didn't see him and hit him when he turned. My son luckily is okay the driver left the scene and nobody stopped. I am left wondering why there is no crossing guards at such a busy intersection down the street from a middle school, most kids walk or take a Mississauga bus to school (drops them across the street so they still need to cross.) This school is for kids grade 6-8 and I feel its only a matter of time before someone else gets hit there and I would be surprised if this is the first. I drive this way to and from work every day and I myself have been almost hit by people not paying attention or running lights.

Thanks for your time

Alison Rea

From: Rea, Alison
Sent: Friday, June 19, 2015 10:46 AM
To: 'sheelagh.duffin@mississauga.ca'
Subject: FW: crossing guard needed

Hi Sheelagh, In Heather absence please find what I sent to her

Alison Rea

From: Rea, Alison
Sent: Friday, June 19, 2015 10:43 AM
To: 'heather.mcguire@mississauga.ca'
Subject: crossing guard needed

Hi Heather,

My name is Alison and I just left you a message in regards to my son being hit yesterday at a major intersection in Streetsville. He was crossing the road just around 8 am crossing over Queen st/Mississauga road towards Britannia, he was walking with the walk sign and a car didn't see him and hit him when he turned. My son luckily is okay the driver left the scene and nobody stopped. I am left wondering why there is no crossing guards at such a busy intersection down the street from a middle school, most kids walk or take a Mississauga bus to school (drops them across the street so they still need to cross.) This school is for kids grade 6-8 and I feel its only a matter of time before someone else gets hit there and I would be surprised if this is the first. I drive this way to and from work every day and I myself have been almost hit by people not paying attention or running lights.

Thanks for your time

Alison Rea

Traffic Safety Council
JUN 24 2015

8

Year
Month

2015
5

2015

May

School Name	Offence Code	Values	
		Issued Tickets	Total Visits
Allen A Martin Sr.	(blank)		1
Artesian Drive	43	2	1
	(blank)		1
Barondale	27	4	1
	(blank)		1
Brandon Gate	27	1	1
	(blank)		2
Brian W Fleming	(blank)		1
Briarwood		2	5
Britannia	17	1	1
	43	4	1
Camilla Road Sr.	(blank)		1
Canadian Martyrs	12	2	0
	27	1	1
	42	1	0
	43	2	1
	(blank)		3
Champlain Trail	43	3	2
	(blank)		2
Churchill Meadows	27	1	1
Corpus Christi	(blank)		1
Corsair	43	1	1
Derry West Village	23	2	1
	43	2	1
	(blank)		1
Divine Mercy	43	2	1
	(blank)		1
Dixie	8	1	1
	10	1	1
	(blank)		5
Dunrankin Drive	43	2	1
	(blank)		3
Edenrose	27	1	1
	43	1	1
Erin Centre Middle	27	1	1
Fairview	2	1	0
	3	4	2
	15	7	1

89

Year
Month

2015
5

2015
May

School Name	Offence Code	Values	
		Issued Tickets	Total Visits
Fairview	17	2	0
	26	1	0
	27	2	0
	42	7	0
	43	3	2
	(blank)		1
Fairwind Sr	42	1	0
	43	4	1
Fallingbrook Middle	27	1	1
Father Daniel Zanon	27	1	0
	(blank)		1
Floradale	(blank)		2
Hillcrest Middle	12	1	1
	24	1	1
	(blank)		0
Holy Cross	15	2	1
	27	2	2
	(blank)		4
Homelands Sr.	(blank)		5
Huntington Ridge	27	1	0
	43	5	3
Janet I McDougald	24	1	1
	27	3	1
	(blank)		0
Kindree	43	4	3
Lancaster	15	1	0
	42	2	1
	43	1	1
	(blank)		1
Levi Creek	43	1	1
Marvin Heights	27	5	2
	(blank)		5
Mary Fix Catholic	43	1	1
	(blank)		1
McKinnon	27	1	1
	42	2	0
	43	2	2
	(blank)		1
Meadowvale Village	27	1	1

Year
Month

2015
5

2015

May

School Name	Offence Code	Values	
		Issued Tickets	Total Visits
Mentor College	12	1	1
	15	1	0
	42	1	0
	43	1	1
	(blank)		2
Metropolitan Andrei Catholic	43	1	1
Middlebury	43	2	1
Morning Star Middle	15	1	1
	(blank)		4
Nahani Way	27	1	1
	43	1	1
	(blank)		2
Oscar Peterson	7	1	1
	43	5	3
	(blank)		3
Osprey Woods	7	1	0
	43	4	2
Our Lady of Good Voyage	27	1	1
Plowman's Park	27	1	1
Plum Tree Park	43	3	3
	(blank)		3
Queen of Heaven	43	1	1
	(blank)		0
Rick Hansen	42	1	1
Ridgewood	27	5	3
	43	2	1
	(blank)		2
Riverside	42	1	1
	(blank)		1
Ruth Thompson Middle	(blank)		1
Sheridan Park	43	1	1
	(blank)		3
Sherwood Mills	27	1	1
	43	1	0
	(blank)		2
St. Albert of Jerusalem	7	1	1
St. Barbara	(blank)		1
St. Bernard of Clairvaux Catholic	8	3	1
	17	1	0

8c

Year
Month

2015
5

2015

May

School Name	Offence Code	Values	
		Issued Tickets	Total Visits
St. Christopher	(blank)		1
St. Dominic	21	1	1
	27	1	1
	(blank)		0
St. Francis of Assisi	(blank)		2
St. Gertrude	17	1	0
	(blank)		3
St. Hilary	27	1	0
	43	1	1
	(blank)		1
St. John of the Cross	27	1	1
St. Joseph (Mississauga)	43	3	1
St. Jude	27	1	1
	43	1	1
St. Margaret of Scotland	17	3	0
	27	1	0
	43	4	3
	(blank)		5
St. Matthew	43	1	1
St. Philip	(blank)		1
St. Pio of Pietrelcina	43	1	1
	(blank)		1
St. Raphael	42	1	1
St. Raymond	43	1	1
	(blank)		8
St. Sofia	(blank)		1
St. Thomas More	27	2	2
	(blank)		2
St. Vincent de Paul	27	2	1
	(blank)		2
Sts. Martha & Mary	(blank)		1
Sts. Peter & Paul	(blank)		2
The Valleys Sr	(blank)		3
Thomas Street Middle	(blank)		1
Thornwood	24	1	1
	(blank)		1
Trelawny	17	2	1
	43	7	3
Vista Heights	(blank)		2

8 d.

Year
Month

2015
5

2015

May

School Name	Offence Code	Values	
		Issued Tickets	Total Visits
Westacres	15	1	1
Whitehorn	27	1	1
	43	1	1
	(blank)		4
Whiteoaks	43	1	1
	(blank)		1
Willow Way	27	2	2
Springfield	(blank)		1
Miller's Grove	(blank)		1
Olive Grove	(blank)		3
Ascension Of Our Lord	(blank)		1
John Cabot	43	1	1
	(blank)		2
Loyola Catholic	(blank)		4
St. Marcellinus	27	5	1
Grand Total		202	236

02 PARKING ON BLVD

05 PARKING ON SIDEWALK

07 3 METRES OF A FIRE HYDRANT

08 PARKING WITHIN 5 METERS OF AS INTER

12 IMMOBILE OR UNLICENSED

15 PROHIBITED AREA (PARKING)

17 PROHIBITED AREA (STOPPING)

24 FACING WRONG DIRECTION

27 PARKING IN A DESIGNATED FIRE ROUTE

28 STOPPING IN A DESIGNATED FIRE ROUTE

31 OBSTRUCTING TRAFFIC

TRAFFIC SAFETY COUNCIL

Transportation and Works - Action Items

May

Reference	School / Location	Item	Action
	Ruth Thompson Middle School	The Transportation and Works Department be requested to re-inspect once the area development is completed on the east side of Tenth Line and the subdivision is assumed (by the City).	this item should not be directed to T&W it is directed to TSC for an addition school site inspection to be conducted
	Willow Glen Public School	That the Transportation and Works Department be requested to review signage and replace faded signs at Lewisham Drive, north of the park path on the west side, and on the Brookhurst Road at the bridge.	utility locates required
	Meadowvale Village Public	That Transportation and Works Department be requested to conduct a speed study east of Second Line on Sombrero Way.	Speed Study requested

Traffic Safety Council
JUN 24 2015

TRAFFIC SAFETY COUNCIL
Transportation and Works - Action Items

June			
Reference	School / Location	Item	Action
	St. Julia Catholic School	The Transportation and Works Department be requested to install "No Stopping" corner prohibition on Historic Trail & Lamplight Way and on the south side of Lamplight Way across from the intersection	utility locates required
	St. Francis of Assisi CS & Sheridan Park Public School	That the Transportation and Works Department be requested to review extending "No U-Turn" signage and review all other signage in front of Homelands Sr. Public school	utility locates required

9.9