



## Traffic Safety Council

**Date**

September 30, 2015

**Time**

5:00 p.m.

**Location**

Committee Room A, 2<sup>nd</sup> Floor  
300 Civic Centre, Mississauga, ON L5B 3C1

**Members**

Councillor Sue McFadden, Ward 10

Councillor Chris Fonseca, Ward 3

Anna Abbruscato, Dufferin-Peel Catholic District School Board Trustee

Sandra Beniuk, Citizen Member

Fabio Bertucci, Citizen Member

Robert Crocker, Peel District School Board Trustee

Tamara Coulson, Citizen Member

Louise Goegan, Citizen Member

Denise Gordon-Mohamud, Citizen Member

Sushil Kumra, Citizen Member

Matthew Moore, Citizen Member

Heather Relf, Citizen Member (Vice-Chair)

Ajay Sharma, Citizen Member

Mashkooor Sherwani, Citizen Member

Daniel Suess, Citizen Member

Boris Swedak, Life Member

Altamash Syed, Citizen Member

Katherine Vukobrat, Citizen Member

Peter Westbrook, Citizen Member (Chair)

**Advisory Board**

Sheelagh Duffin, Supervisor, Crossing Guards

Anna Gentile, Central Planning and Operations Officer, Student Transportation of Peel Region (STOPR)

Tom Howe, Manager, Student Transportation of Peel Region (STOPR)

Alex Liya, Traffic Operations Technician

Denna Yaunan, Traffic Operations Technician

Erica Warsh, Transportation Demand Management Coordinator

**Contact**

Angie Melo, Legislative Coordinator, Legislative Services

905-615-3200 ext. 5423/ Fax 905-615-4181/ Email [angie.melo@mississauga.ca](mailto:angie.melo@mississauga.ca)

**Find it online**

<http://www.mississauga.ca/portal/cityhall/trafficsafetycouncil>

---

MATTERS TO BE CONSIDERED

10. Site Inspection Reports – Levi Creek Public School (Ward 11)
11. Site Inspection Report – Canadian Martyrs Catholic School (Ward 4)
12. Ridgewood Public School – Walking and Rolling Program Kick Off
13. Walk to School Subcommittee Update
14. Public Information Subcommittee Minutes
15. Stakeholder Responsibilities Breakdown Reference Sheet
16. Review and approval of the Wilde Wood School Zone Safety Award Application and Process
17. Review and approval of the Traffic Safety Council Terms of Reference
18. Review and approval of the Traffic Safety Council 20152016 Workplan

MATTERS TO BE CONSIDERED10. Site Inspection Reports – Levi Creek Public School (Ward 11)

Site Inspection Reports for site inspections conducted on September 15, 2015 at the intersection of Westbridge Way and Bellshire Gate and at the Westbridge Way at the park pathway, for students attending Levi Creek Public School.

RECOMMENDATION

1. That the request for a crossing guard at the intersection of Westbridge Way and Bellshire Gate for the students attending Levi Creek Public School be denied as the warrants are not met.
2. That the request for a crossing guard at Westbridge Way at the park pathway for students attending Levi Creek Public School be denied as the warrants are not met.
3. That Transportation and Works be requested to conduct a speed study on Westbridge Way to include 8:45 to 9:15 a.m. time period and if warranted, request that Peel Regional Police enforce speeding violations on Westbridge Way for the students attending Levi Creek Public School.

RECOMMEND APPROVAL11. Site Inspection Report – Canadian Martyrs Catholic School (Ward 4)

Site Inspection Reports for site inspections conducted on September 24, 2015 at the intersection of 1185 Mississauga Valley Boulevard, in front of Canadian Martyrs Catholic School.

RECOMMENDATION

1. That Peel Regional Police be request to enforce No U-turn violations from 8:00 a.m. to 8:30 a.m. and from 3:00 p.m. to 3:30 p.m. on Mississauga Valley Boulevard, in front of Canadian Martyrs Catholic School.
2. That Parking Enforcement be requested to monitor and enforce parking prohibitions from 2:50 p.m. to 3:15 p.m. in the school vicinity for the students attending Canadian Martyrs Catholic School.
3. That the Principal of Canadian Martyrs Catholic School be requested to advise parents to use the crossing guard at the signalized intersection or the All Way stop at Daralea Heights.

RECOMMEND APPROVAL

12. Ridgewood Public School – Walking and Rolling Program Kick Off

Louise Goegan, Citizen Member, to provide a verbal update Ridgewood Public School's Walking and Rolling Program Kick Off.

RECOMMEND RECEIPT

13. Walk to School Subcommittee Update

Louise Goegan, Chair, Walk to School Subcommittee, to provide a verbal update on Walking to School Subcommittee matters.

RECOMMEND RECEIPT

14. Public Information Subcommittee Minutes

Minutes of theThe Public Information Subcommittee meetings held on July 9, 30, August 20, and September 3, 2015.

RECOMMEND RECEIPT

15. Stakeholder Responsibilities Breakdown Reference Sheet

A reference document, for use by City Councillors, Trustees, School Board Staff and City Staff, listing various issues and the agency responsible for resolving the issues; and a list of various stakeholders and the responsibilities that fall within their respective jurisdictions requires updating.

DIRECTION REQUIRED

16. Review and approval of the Wilde Wood School Zone Safety Award Application and Process

RECOMMENDATION

1. That the new Wilde Wood School Zone Safety Award Application be approved.

2. That the Wilde Wood School Zone Safety Award Application be distributed to The Dufferin-Peel Catholic District Elementary Schools and the Peel District Elementary Schools in the City of Mississauga annually in the second week of October.

RECOMMEND APPROVAL

17. Review and approval of Traffic Safety Council Terms of Reference

RECOMMENDATION

That the Terms of Reference for the Traffic Safety Council be approved.

RECOMMEND APPROVAL

18. Review and approval of the Traffic Safety Council 2015/2016 Workplan

RECOMMENDATION

That the Traffic Safety Council 2015/2016 Workplan be approved.

RECOMMEND APPROVAL

OTHER BUSINESS

Date of Next Meeting: October 28, 2015

ADJOURNMENT

# Site Inspection Report



<b>Site</b>	
School: Levi Creek Public School	Address: 1525 Samuelson Circle Mississauga ON L5N 7Z1
School Times: 9:15 AM   3:35 PM	Student Population: 582
No. of School Buses: 390	BUSED
School:	Address:
School Times:	Student Population:
No. of School Buses:	

Location: (Please identify the location with reference of nearest intersection. Indicate nearest school and address)  
Westbridge Way & Bellshire Gate

Date of Inspection: 2015 09 15 Inspection Time: 8:45 AM | 3:35 PM Requested By: Traffic Operations

Prepared By: Heather Relf Request For: Crossing Guard

<b>Observers</b>	
File Number: RT.10	Ward: Ward 11
Observed By:	<input type="checkbox"/> AM <input type="checkbox"/> PM <input type="checkbox"/> AM & PM
Observed By: Heather Relf	<input type="checkbox"/> AM <input type="checkbox"/> PM <input checked="" type="checkbox"/> AM & PM
Observed By: Denna Yaunan	<input type="checkbox"/> AM <input type="checkbox"/> PM <input checked="" type="checkbox"/> AM & PM
Observed By:	<input type="checkbox"/> AM <input type="checkbox"/> PM <input type="checkbox"/> AM & PM
Observed By:	<input type="checkbox"/> AM <input type="checkbox"/> PM <input type="checkbox"/> AM & PM
Observed By:	<input type="checkbox"/> AM <input type="checkbox"/> PM <input type="checkbox"/> AM & PM

<b>Details</b>	
Weather Conditions:	AM: <input checked="" type="checkbox"/> Dry <input checked="" type="checkbox"/> Sunny <input type="checkbox"/> Rain <input type="checkbox"/> Snow <input type="checkbox"/> Other: 17C
	PM: <input checked="" type="checkbox"/> Dry <input checked="" type="checkbox"/> Sunny <input type="checkbox"/> Rain <input type="checkbox"/> Snow <input type="checkbox"/> Other: 28C
Type of Crossing:	<input type="checkbox"/> 4 Way Intersection <input checked="" type="checkbox"/> 3 Way Intersection <input type="checkbox"/> Midblock (i.e., not an intersection)
Type of Control:	<input type="checkbox"/> Traffic Lights <input type="checkbox"/> Yield Signs <input type="checkbox"/> No Control <input checked="" type="checkbox"/> Stop Signs (Traffic is stopped on one street only) <input type="checkbox"/> All Way Stop (Traffic is stopped in all directions)

<b>Site Conditions</b>	
School Signs:	<input type="checkbox"/> School Area Signs <input type="checkbox"/> School Crossing Signs <input type="checkbox"/> Parking/Stopping Prohibition
Posted Speed Limit:	<input type="checkbox"/> 40 km/hr <input checked="" type="checkbox"/> 50 km/h <input type="checkbox"/> 60 km/hr <input type="checkbox"/> Other:
Visibility of Crossing Pedestrians:	<input type="checkbox"/> Poor <input type="checkbox"/> Fair <input checked="" type="checkbox"/> Good Comments:
Sight Obstructions:	<input type="checkbox"/> Hedges <input type="checkbox"/> Trees <input type="checkbox"/> Fences <input type="checkbox"/> Bus Shelter <input type="checkbox"/> Newspaper Boxes <input type="checkbox"/> Other (Specify):
Road Grade:	<input checked="" type="checkbox"/> Flat <input type="checkbox"/> Incline <input type="checkbox"/> Decline
Road Geometrics:	<input checked="" type="checkbox"/> Straight <input type="checkbox"/> Curved Comments:
Road Width:	32 feet/metres Curb to Curb: feet/metres Curb to Median: feet/metres
Road Conditions:	AM: <input checked="" type="checkbox"/> Dry <input type="checkbox"/> Wet <input type="checkbox"/> Snow Covered <input type="checkbox"/> Ice PM: <input checked="" type="checkbox"/> Dry <input type="checkbox"/> Wet <input type="checkbox"/> Snow Covered <input type="checkbox"/> Ice
Sidewalks:	<input type="checkbox"/> Not Present <input checked="" type="checkbox"/> North <input checked="" type="checkbox"/> South <input checked="" type="checkbox"/> East <input checked="" type="checkbox"/> West
Proximity to School:	<input type="checkbox"/> In Front of <input checked="" type="checkbox"/> Within 150 feet/metres
Route Survey:	<input type="checkbox"/> Shopping Area <input type="checkbox"/> Construction <input type="checkbox"/> Driveway <input type="checkbox"/> Parked Vehicle(s) <input type="checkbox"/> Transit Bus Stop <input type="checkbox"/> Underpass Within feet/metres Other (specify):
Comments / Conflicts:	All children crossed with an adult

Crossing Guard Warrant Survey

Location: Bellshire Gate & Westbridge Way

[X] Safe Gap Time Safe Gap Time Calculation (if applicable): ( W / 3.5 + 4 ) 13 = sec.
[ ] Signalized Intersection turning traffic count

Morning Intervals

Table with columns: Time (AM), # of Peds, # of Conflicts, Gaps, # of Gaps. Rows include 7:45-7:50, 7:50-7:55, 7:55-8:00, 9:00-9:05, 9:05-9:10, 9:10-9:15, 8:15-8:20, 8:20-8:25, 8:25-8:30, 8:30-8:35, 8:35-8:40, 8:40-8:45, 8:45-8:50, 8:50-8:55, 8:55-9:00.

Afternoon Intervals

Table with columns: Time (PM), # of Peds, # of Conflicts, Gaps, # of Gaps. Rows include 2:45-2:50, 2:50-2:55, 2:55-3:00, 3:00-3:05, 3:05-3:10, 3:10-3:15, 3:15-3:20, 3:20-3:25, 3:25-3:30, 3:30-3:35, 3:35-3:40, 3:40-3:45, 3:45-3:50, 3:50-3:55, 3:55-4:00.

Recommendations

1) That the warrants for a crossing guard have not been met.

Observations

Volume of Traffic (see Intersection Plan): AM: [ ] Heavy [ ] Light [X] Intermittant PM: [ ] Heavy [X] Light [ ] Intermittant
Number of Crossing Pedestrians: AM: North [ ] East 3 South [ ] West [ ] PM: North [ ] East 9 South [ ] West [ ]
Turning Traffic: AM: [ ] Heavy [ ] Light [ ] Intermittant PM: [ ] Heavy [ ] Light [ ] Intermittant



# Site Inspection Report



Corporate Services  
Office of the City Clerk

<b>Site</b>	
School: Levi Creek Public School	Address: 1525 Samuelson Circle Mississauga ON L5N 7Z1
School Times: 9:15 AM 3:35 PM	Student Population: 582
No. of School Buses: 390	Buses
School:	Address:
School Times:	Student Population:
No. of School Buses:	

Location: (Please identify the location with reference of nearest intersection. Indicate nearest school and address)  
Westbridge Way & the park pathway

Date of Inspection: 2015 09 15 Inspection Time: 8:45 AM 3:35 PM Requested By: Traffic Operations

Prepared By: V. Mansour Request For: Crossing Guard

<b>Observers</b>	
File Number: RT.10	Ward: Ward 11
Observed By: Sheelagh Duffin	<input type="checkbox"/> AM <input type="checkbox"/> PM <input checked="" type="checkbox"/> AM & PM
Observed By: Vivian Mansour	<input type="checkbox"/> AM <input type="checkbox"/> PM <input checked="" type="checkbox"/> AM & PM
Observed By: Tammy Coulson	<input type="checkbox"/> AM <input type="checkbox"/> PM <input checked="" type="checkbox"/> AM & PM
Observed By:	<input type="checkbox"/> AM <input type="checkbox"/> PM <input type="checkbox"/> AM & PM
Observed By:	<input type="checkbox"/> AM <input type="checkbox"/> PM <input type="checkbox"/> AM & PM
Observed By:	<input type="checkbox"/> AM <input type="checkbox"/> PM <input type="checkbox"/> AM & PM

<b>Details</b>	
Weather Conditions:	AM: <input checked="" type="checkbox"/> Dry <input checked="" type="checkbox"/> Sunny <input type="checkbox"/> Rain <input type="checkbox"/> Snow <input type="checkbox"/> Other: 17C
	PM: <input checked="" type="checkbox"/> Dry <input checked="" type="checkbox"/> Sunny <input type="checkbox"/> Rain <input type="checkbox"/> Snow <input type="checkbox"/> Other: 28C
Type of Crossing:	<input type="checkbox"/> 4 Way Intersection <input type="checkbox"/> 3 Way Intersection <input checked="" type="checkbox"/> Midblock (i.e., not an intersection)
Type of Control:	<input type="checkbox"/> Traffic Lights <input type="checkbox"/> Yield Signs <input checked="" type="checkbox"/> No Control
	<input type="checkbox"/> Stop Signs (Traffic is stopped on one street only) <input type="checkbox"/> All Way Stop (Traffic is stopped in all directions)

<b>Site Conditions</b>	
School Signs:	<input type="checkbox"/> School Area Signs <input type="checkbox"/> School Crossing Signs <input type="checkbox"/> Parking/Stopping Prohibition
Posted Speed Limit:	<input type="checkbox"/> 40 km/hr <input checked="" type="checkbox"/> 50 km/h <input type="checkbox"/> 60 km/hr <input type="checkbox"/> Other:
Visibility of Crossing Pedestrians:	<input type="checkbox"/> Poor <input type="checkbox"/> Fair <input checked="" type="checkbox"/> Good Comments:
Sight Obstructions:	<input type="checkbox"/> Hedges <input type="checkbox"/> Trees <input type="checkbox"/> Fences <input type="checkbox"/> Bus Shelter
	<input type="checkbox"/> Newspaper Boxes <input type="checkbox"/> Other (Specify):
Road Grade:	<input checked="" type="checkbox"/> Flat <input type="checkbox"/> Incline <input type="checkbox"/> Decline
Road Geometrics:	<input checked="" type="checkbox"/> Straight <input type="checkbox"/> Curved Comments:
Road Width:	<input type="checkbox"/> 33 feet/metres Curb to Curb: <input type="checkbox"/> feet/metres Curb to Median: <input type="checkbox"/> feet/metres
Road Conditions:	AM: <input checked="" type="checkbox"/> Dry <input type="checkbox"/> Wet <input type="checkbox"/> Snow Covered <input type="checkbox"/> Ice
	PM: <input checked="" type="checkbox"/> Dry <input type="checkbox"/> Wet <input type="checkbox"/> Snow Covered <input type="checkbox"/> Ice
Sidewalks:	<input type="checkbox"/> Not Present <input checked="" type="checkbox"/> North <input checked="" type="checkbox"/> South <input type="checkbox"/> East <input type="checkbox"/> West
Proximity to School:	<input type="checkbox"/> In Front of <input checked="" type="checkbox"/> Within 200 feet/metres
Route Survey:	<input type="checkbox"/> Shopping Area <input type="checkbox"/> Construction <input type="checkbox"/> Driveway <input type="checkbox"/> Parked Vehicle(s)
	<input type="checkbox"/> Transit Bus Stop <input type="checkbox"/> Underpass Within <input type="checkbox"/> feet/metres Other (specify):

Comments / Conflicts: AM - All students crossed with parents. No undue delay observed crossing. Most of the students using the path stayed on North sidewalk. Crossing students and parents crossed confidently. Some isolated incidences of speeding in the AM

**Crossing Guard Warrant Survey**

Location: Westbridge Way and the park pathway

Safe Gap Time      Safe Gap Time Calculation (if applicable):  $\left(\frac{W}{3.5} + 4\right)$  = sec.  
 Signalized Intersection turning traffic count

**Morning Intervals**

Time (AM)	# of Peds	# of Conflicts	Gaps	# of Gaps
7:45 - 7:50			AM GAP 19 SECONDS - USED ANGLE CROSSING MEASURE	
7:50 - 7:55			NO ONE CROSSED ON ANGLE	
7:55 - 8:00				
9:00 - 9:05	2P1P		23,///,20,/,43,////,22,////////////////	5
9:05 - 9:10	2P1P1P		////////////////,20,///,19,////,24,/,22	4
9:10 - 9:15			////,19,/,36,19,/,30,/,46,////////	6
8:15 - 8:20				
8:20 - 8:25				
8:25 - 8:30				
8:30 - 8:35				
8:35 - 8:40				
8:40 - 8:45				
8:45 - 8:50				
8:50 - 8:55			////,36,46,/,	3
8:55 - 9:00			/,20,39,/,43,/,23,////,97,/,	11

**Afternoon Intervals**

Time (PM)	# of Peds	# of Conflicts	Gaps	# of Gaps
2:45 - 2:50			PM GAP 13 SECONDS - USED STRAIGHT ACROSS MEASURE	
2:50 - 2:55				
2:55 - 3:00				
3:00 - 3:05				
3:05 - 3:10				
3:10 - 3:15				
3:15 - 3:20				
3:20 - 3:25				
3:25 - 3:30				
3:30 - 3:35				
3:35 - 3:40			34,/,20,17,/,20,///,14,/,30,15,/,24,42	13
3:40 - 3:45	1,1P		////////,15,////////,24,21,////////,18,////	4
3:45 - 3:50			53,30,/,49,79,///,18,/,18,14,/,17	19
3:50 - 3:55			17,39,/,15,15,/,71,26,////,17,///	14
3:55 - 4:00			29,19,15,/,24,///,41,/,37,13,////,29,/,	15

**Recommendations**

1) That the warrants for a crossing guard have not been met.  
 2) Request Transportation & Works conduct a speed study on Westbridge Way to include 8:45 - 9:15 time and request Peel Regional Police if warranted.

**Observations**

Volume of Traffic (see Intersection Plan):  
 AM:  Heavy  Light  Intermittant      PM:  Heavy  Light  Intermittant

Number of Crossing Pedestrians:  
 AM: North  East  South  West       PM: North  East  South  West

Turning Traffic:  
 AM:  Heavy  Light  Intermittant      PM:  Heavy  Light  Intermittant

# Site Inspection Report



**Traffic Safety Council**  
**SEP 30 2015**

Corporate Services  
Office of the City Clerk

11

<b>Site</b>	School: <b>Canadian Martyrs Catholic</b> Address: <b>1185 Miss. Valley Blvd. Mississauga On L5A 3R7</b>	School Times: <input checked="" type="checkbox"/> 8:30 AM <input type="checkbox"/> 3:00 PM Student Population: <b>486</b> No. of School Buses: <b>53</b> <i>Large, Small</i>
School: Address:	School Times: <input type="checkbox"/> AM <input type="checkbox"/> PM Student Population: No. of School Buses:	School Times: <input type="checkbox"/> AM <input type="checkbox"/> PM Student Population: No. of School Buses:

**Location:** (Please identify the location with reference of nearest intersection. Indicate nearest school and address)  
**1185 Mississauga Valley Blvd in front of Canadian Martyrs CS**

**Date of Inspection:** 2015 09 24      **Inspection Time:** 8:00 AM 3:00 PM      **Requested By:** Councillor Kovac

**Prepared By:** P. Westbrook      **Request For:** Safety Review in front of school

<b>Observers</b>		<b>Ward:</b> Ward 4
<b>File Number:</b> RT.10	<b>File Number:</b> RT.10	
<b>Observed By:</b> S. Duffin	<input type="checkbox"/> AM <input type="checkbox"/> PM <input checked="" type="checkbox"/> AM & PM	
<b>Observed By:</b> V. Mansour	<input type="checkbox"/> AM <input type="checkbox"/> PM <input checked="" type="checkbox"/> AM & PM	
<b>Observed By:</b> T. Coulson	<input checked="" type="checkbox"/> AM <input type="checkbox"/> PM <input type="checkbox"/> AM & PM	
<b>Observed By:</b> A. Syed, S. Kumra	<input type="checkbox"/> AM <input checked="" type="checkbox"/> PM <input type="checkbox"/> AM & PM	
<b>Observed By:</b> P. Westbrook	<input type="checkbox"/> AM <input type="checkbox"/> PM <input checked="" type="checkbox"/> AM & PM	
<b>Observed By:</b> J. Kovac, D. Yaunan	<input type="checkbox"/> AM <input checked="" type="checkbox"/> PM <input type="checkbox"/> AM & PM	

<b>Details</b>	
<b>Weather Conditions:</b>	AM: <input type="checkbox"/> Dry <input checked="" type="checkbox"/> Sunny <input type="checkbox"/> Rain <input type="checkbox"/> Snow <input type="checkbox"/> Other: 15C PM: <input type="checkbox"/> Dry <input checked="" type="checkbox"/> Sunny <input type="checkbox"/> Rain <input type="checkbox"/> Snow <input type="checkbox"/> Other: 22C
<b>Type of Crossing:</b>	<input type="checkbox"/> 4 Way Intersection <input type="checkbox"/> 3 Way Intersection <input type="checkbox"/> Midblock (i.e., not an intersection)
<b>Type of Control:</b>	<input type="checkbox"/> Traffic Lights <input type="checkbox"/> Yield Signs <input type="checkbox"/> No Control <input type="checkbox"/> Stop Signs (Traffic is stopped on one street only) <input type="checkbox"/> All Way Stop (Traffic is stopped in all directions)

<b>Site Conditions</b>	
<b>School Signs:</b>	<input checked="" type="checkbox"/> School Area Signs <input type="checkbox"/> School Crossing Signs <input type="checkbox"/> Parking/Stopping Prohibition
<b>Posted Speed Limit:</b>	<input checked="" type="checkbox"/> 40 km/hr <input type="checkbox"/> 50 km/h <input type="checkbox"/> 60 km/hr <input type="checkbox"/> Other:
<b>Visibility of Crossing Pedestrians:</b>	<input type="checkbox"/> Poor <input type="checkbox"/> Fair <input type="checkbox"/> Good <b>Comments:</b>
<b>Sight Obstructions:</b>	<input type="checkbox"/> Hedges <input type="checkbox"/> Trees <input type="checkbox"/> Fences <input type="checkbox"/> Bus Shelter <input type="checkbox"/> Newspaper Boxes <input type="checkbox"/> Other (Specify):
<b>Road Grade:</b>	<input type="checkbox"/> Flat <input type="checkbox"/> Incline <input type="checkbox"/> Decline
<b>Road Geometrics:</b>	<input type="checkbox"/> Straight <input type="checkbox"/> Curved <b>Comments:</b>
<b>Road Width:</b>	feet/metres <b>Curb to Curb:</b> feet/metres <b>Curb to Median:</b> feet/metres
<b>Road Conditions:</b>	AM: <input type="checkbox"/> Dry <input type="checkbox"/> Wet <input type="checkbox"/> Snow Covered <input type="checkbox"/> Ice PM: <input type="checkbox"/> Dry <input type="checkbox"/> Wet <input type="checkbox"/> Snow Covered <input type="checkbox"/> Ice
<b>Sidewalks:</b>	<input type="checkbox"/> Not Present <input checked="" type="checkbox"/> North <input checked="" type="checkbox"/> South <input type="checkbox"/> East <input type="checkbox"/> West
<b>Proximity to School:</b>	<input checked="" type="checkbox"/> In Front of <input type="checkbox"/> Within feet/metres
<b>Route Survey:</b>	<input type="checkbox"/> Shopping Area <input type="checkbox"/> Construction <input type="checkbox"/> Driveway <input type="checkbox"/> Parked Vehicle(s) <input type="checkbox"/> Transit Bus Stop <input type="checkbox"/> Underpass    Within feet/metres <b>Other (specify):</b>

**Comments / Conflicts:** A number of parents and students were jaywalking across Mississauga Valley Blvd to access the complex across from the school. PM - a number of parents were parking in the no stopping zone to the west of the school driveway.

**Crossing Guard Warrant Survey**

Location: 1185 Mississauga Valley Blvd in front of Canadian Martyrs CS

Safe Gap Time      Safe Gap Time Calculation (if applicable):  $\left( \frac{W}{3.5} + 4 \right)$   = sec.  
 Signalized Intersection turning traffic count

**Morning Intervals**

Time (AM)	# of Peds	# of Conflicts	Gaps	# of Gaps
7:45 - 7:50	<input type="text"/>	<input type="text"/>	<input type="text"/>	<input type="text"/>
7:50 - 7:55	<input type="text"/>	<input type="text"/>	<input type="text"/>	<input type="text"/>
7:55 - 8:00	<input type="text"/>	<input type="text"/>	<input type="text"/>	<input type="text"/>
8:00 - 8:05	<input type="text"/>	<input type="text"/>	<input type="text"/>	<input type="text"/>
8:05 - 8:10	<input type="text"/>	<input type="text"/>	<input type="text"/>	<input type="text"/>
8:10 - 8:15	<input type="text"/>	<input type="text"/>	<input type="text"/>	<input type="text"/>
8:15 - 8:20	<input type="text"/>	<input type="text"/>	<input type="text"/>	<input type="text"/>
8:20 - 8:25	<input type="text"/>	<input type="text"/>	<input type="text"/>	<input type="text"/>
8:25 - 8:30	<input type="text"/>	<input type="text"/>	<input type="text"/>	<input type="text"/>
8:30 - 8:35	<input type="text"/>	<input type="text"/>	<input type="text"/>	<input type="text"/>
8:35 - 8:40	<input type="text"/>	<input type="text"/>	<input type="text"/>	<input type="text"/>
8:40 - 8:45	<input type="text"/>	<input type="text"/>	<input type="text"/>	<input type="text"/>
8:45 - 8:50	<input type="text"/>	<input type="text"/>	<input type="text"/>	<input type="text"/>
8:50 - 8:55	<input type="text"/>	<input type="text"/>	<input type="text"/>	<input type="text"/>
8:55 - 9:00	<input type="text"/>	<input type="text"/>	<input type="text"/>	<input type="text"/>

**Afternoon Intervals**

Time (PM)	# of Peds	# of Conflicts	Gaps	# of Gaps
2:45 - 2:50	<input type="text"/>	<input type="text"/>	<input type="text"/>	<input type="text"/>
2:50 - 2:55	<input type="text"/>	<input type="text"/>	<input type="text"/>	<input type="text"/>
2:55 - 3:00	<input type="text"/>	<input type="text"/>	<input type="text"/>	<input type="text"/>
3:00 - 3:05	<input type="text"/>	<input type="text"/>	<input type="text"/>	<input type="text"/>
3:05 - 3:10	<input type="text"/>	<input type="text"/>	<input type="text"/>	<input type="text"/>
3:10 - 3:15	<input type="text"/>	<input type="text"/>	<input type="text"/>	<input type="text"/>
3:15 - 3:20	<input type="text"/>	<input type="text"/>	<input type="text"/>	<input type="text"/>
3:20 - 3:25	<input type="text"/>	<input type="text"/>	<input type="text"/>	<input type="text"/>
3:25 - 3:30	<input type="text"/>	<input type="text"/>	<input type="text"/>	<input type="text"/>
3:30 - 3:35	<input type="text"/>	<input type="text"/>	<input type="text"/>	<input type="text"/>
3:35 - 3:40	<input type="text"/>	<input type="text"/>	<input type="text"/>	<input type="text"/>
3:40 - 3:45	<input type="text"/>	<input type="text"/>	<input type="text"/>	<input type="text"/>
3:45 - 3:50	<input type="text"/>	<input type="text"/>	<input type="text"/>	<input type="text"/>
3:50 - 3:55	<input type="text"/>	<input type="text"/>	<input type="text"/>	<input type="text"/>
3:55 - 4:00	<input type="text"/>	<input type="text"/>	<input type="text"/>	<input type="text"/>

**Recommendations**

- 1) Request Peel Regional Police enforce Uturns from 8:00 - 8:30 a.m. and 3:00 - 3:30 p.m. in front of the school on Mississauga Valley Blvd.
- 2) Request parking enforcement to monitor the school vicinity from 2:50 - 3:15 p.m.
- 3) Request the principal to advise parents to use the crossing guard at the signalized intersection or the All Way stop at Daralea Heights

**Observations**

Volume of Traffic (see Intersection Plan):  
 AM:  Heavy     Light     Intermittant      PM:  Heavy     Light     Intermittant

Number of Crossing Pedestrians:  
 AM: North  East  South  West       PM: North  East  South  West

Turning Traffic:  
 AM:  Heavy     Light     Intermittant      PM:  Heavy     Light     Intermittant

Ward 4

**Heather McGuire**

---

**From:** Sheelagh Duffin  
**Sent:** 2015/06/19 12:42 PM  
**To:** Heather McGuire  
**Subject:** FW: Canadian Martyrs Catholic School

Add to the September list, please

Sheelagh  
5167

**From:** Angie Melo  
**Sent:** 2015/06/19 12:38 PM  
**To:** Mary Maiorano  
**Cc:** Sheelagh Duffin  
**Subject:** Canadian Martyrs Catholic School

Good afternoon Mary,

Further to our telephone conversation today regarding the concerns expressed by parents of students in junior kindergarten and senior kindergarten attending Canadian Martyrs Catholic School with respect to parking in front of the school, parking on school property, and the Kiss & Ride area, please be advised that I am adding to the Traffic Safety Council's June 24, 2015 agenda the request for a safety review to be conducted in front of Canadian Martyrs Catholic School (1185 Mississauga Valley Blvd.). As we are approaching the end of the school year, the safety review will not be scheduled until the beginning of the school year in September 2015.

Once a date is scheduled for the safety review, you will be advised of the date and time, in the event the parent(s) wish to attend.

Thank you

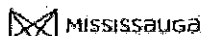

**Angie Melo**  
Legislative Coordinator  
T 905-615-3200 ext.5423  
[angie.melo@mississauga.ca](mailto:angie.melo@mississauga.ca)

City of Mississauga | Corporate Services Department,  
Legislative Services Division

Please consider the environment before printing.

CANADIAN MARTYRS CH. 8:00-8:30 AM & 3:00-3:30

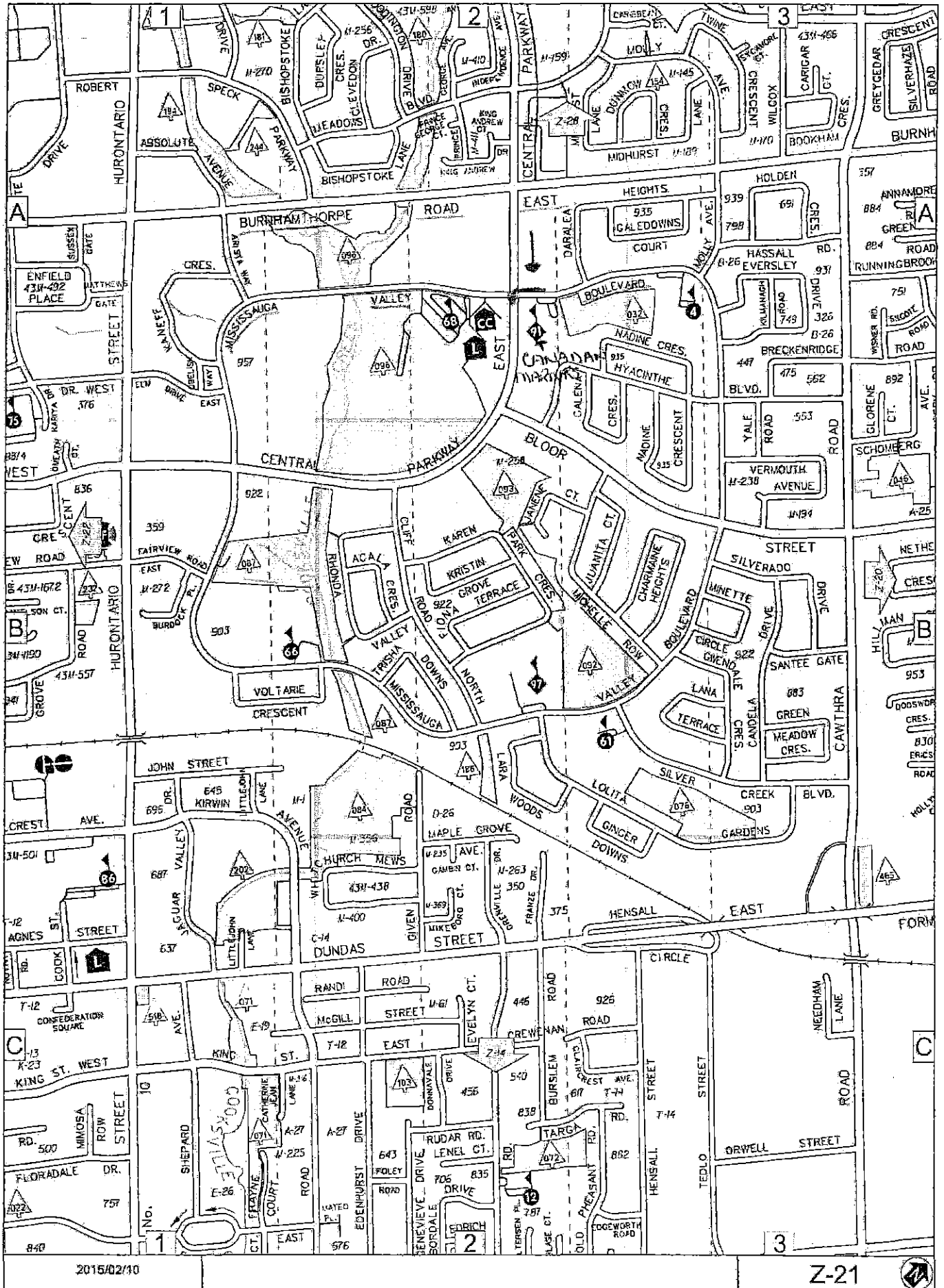



# MINUTES

---

## TRAFFIC SAFETY COUNCIL PUBLIC INFORMATION SUBCOMMITTEE

Thursday, July 9 2015 3:00 p.m.

Committee Boardroom C, 2<sup>nd</sup> FLOOR, MISSISSAUGA CIVIC CENTRE  
300 CITY CENTRE DRIVE, MISSISSAUGA

### MEMBERS PRESENT

- Heather Relf (Citizen Member)
- Daniel Suess (Citizen Member)
- Altamash Syed (Citizen Member)
- Sandra Beniuk, (Citizen Member)
- Sushil Kumra (Citizen Member)
- Peter Westbrook, *ex-officio*

### MEMBERS ABSENT

- Matthew Moore (Citizen Member)
- Ajay Sharma (Citizen Member)
- Denise Gordon-Mohamud (Citizen Member)

### STAFF PRESENT

- Sheelagh Duffin, Crossing Guard Supervisor
- Denna Yauman, Traffic Operations Technologist
- Erica Warsh, Transportation Demand Management Coordinator
- Angie Melo, Legislative Coordinator

**CALL TO ORDER**

3:05 p.m.

**MATTERS CONSIDERED****1. Wilde Wood School Zone Safety Award**

The subcommittee members discussed ways to attract more applicants for the Wilde Wood School Zone Safety Award, such as changing the application, the timeline in which schools submit their application and when success recipients of the award are presented the award.

The subcommittee members agreed that there is a need to meet several more times over the next month to discuss the changes more in depth. It was requested that Angie Melo, Legislative Coordinator, set up another meeting within the next couple of weeks to continue working on the Wilde Wood School Zone Safety Award application form and process.

**2. 2015 annual policy review - Traffic Safety in School Zones**

Sheelagh Duffin, Supervisor, Crossing Guard, advised that she has been requested to provide input into the 2015 annual policy review and would like members of the Public Information to provide input.

Subcommittee Members agreed that this matter should be deferred to a later Public Information Subcommittee meeting.

**OTHER BUSINESS****Traffic Safety Council 2015/2016 Workplan**

Subcommittee Members discussed items for the Traffic Safety Council 2015/2016 Workplan, and agreed, that this matter be brought forward at the next Public Information Subcommittee meeting, and that, subcommittee members forward items to be included in the Workplan to Angie Melo, Legislative Coordinator, before the next Public Information Subcommittee meeting.

**NEXT MEETING DATE – TBA**

ADJOURNMENT 4:35 p.m.





# MINUTES

---

## TRAFFIC SAFETY COUNCIL PUBLIC INFORMATION SUBCOMMITTEE

Thursday, July 30 2015 3:00 p.m.

Committee Boardroom B, 2<sup>nd</sup> FLOOR, MISSISSAUGA CIVIC CENTRE  
300 CITY CENTRE DRIVE, MISSISSAUGA

### MEMBERS PRESENT

- Heather Relf (Citizen Member)
- Daniel Suess (Citizen Member)
- Altamash Syed (Citizen Member)
- Sandra Beniuk, (Citizen Member)
- Sushil Kumra (Citizen Member)
- Peter Westbrook, *ex-officio*

### MEMBERS ABSENT

- Matthew Moore (Citizen Member)
- Ajay Sharma (Citizen Member)
- Denise Gordon-Mohamud (Citizen Member)

### STAFF PRESENT

- Sheelagh Duffin, Crossing Guard Supervisor
- Denna Yaunan, Traffic Operations Technologist
- Angie Melo, Legislative Coordinator

### OTHERS PRESENT

- Louise Goegan, Chair, Walk to School Subcommittee

**CALL TO ORDER**

3:05 p.m.

**MATTERS CONSIDERED**1. **Wilde Wood School Zone Safety Award**

The subcommittee members reviewed and discussed the proposed changes to the Wilde Wood School Zone Safety Award application and had further comments and changes. Angie Melo, Legislative Coordinator was asked to make all the necessary changes to the Wilde Wood School Zone Safety Award application be presented to the Traffic Safety Council at its meeting in September for approval.

2. **Traffic Safety Council 2015/2016 Workplan**

Subcommittee Members further discussed items for the Traffic Safety Council 2015/2015 Workplan, and members agreed that further discussion was required. Louise Goegan, Chair of the Walk to School Subcommittee, advised of the items that the Walk to School Subcommittee would like to have included in the workplan.

Angie Melo, Legislative Coordinator was asked to update the draft Traffic Safety Council 2015/2016 Workplan, and schedule a Public Information Subcommittee meeting within 2 weeks.

3. **Traffic Safety Council Times**

Subcommittee Members discussed the content of the Traffic Safety Times and agreed that the information is outdated and requires updating. Subcommittee members discussed some changes and asked Angie Melo, Legislative Coordinator to make the proposed changes and to this item on an upcoming Public Information Subcommittee meeting.

**NEXT MEETING DATE – TBA**

ADJOURNMENT 5:15 p.m.



# MINUTES

---

## TRAFFIC SAFETY COUNCIL PUBLIC INFORMATION SUBCOMMITTEE

Thursday, August 20, 2015 3:00 p.m.

Committee Boardroom A, 2<sup>nd</sup> FLOOR, MISSISSAUGA CIVIC CENTRE  
300 CITY CENTRE DRIVE, MISSISSAUGA

### MEMBERS PRESENT

- Heather Relf (Citizen Member)
- Daniel Suess (Citizen Member)
- Denise Gordon-Mohamud (Citizen Member)
- Altamash Syed (Citizen Member)
- Sandra Beniuk, (Citizen Member)
- Sushil Kumra (Citizen Member)
- Peter Westbrook, *ex-officio*

### MEMBERS ABSENT

- Matthew Moore (Citizen Member)
- Ajay Sharma (Citizen Member)

### STAFF PRESENT

- Denna Yaunan, Traffic Operations Technologist
- Angie Melo, Legislative Coordinator
- Sheelagh Duffin, Supervisor, Crossing Guard
- Erica Warsh, Transportation Demand Management Coordinator

**CALL TO ORDER**

3:20 p.m.

**MATTERS CONSIDERED**

1. Traffic Safety Council 2015/2016 Workplan

Subcommittee Members further discussed items for the Traffic Safety Council 2015/2015 Workplan and asked Angie Melo, Legislative Coordinator to make suggested amendments and place this item on this next Public Information Subcommittee meeting agenda.

2. Traffic Safety Council TIMES

Subcommittee Members reviewed the draft Traffic Safety TIMES and made further amendments and suggestions. Angie Melo, Legislative Coordinator was asked for make the necessary amendments and to place this item on the next Public Information Subcommittee meeting agenda.

NEXT MEETING DATE – TBA

ADJOURNMENT 5:03 p.m.

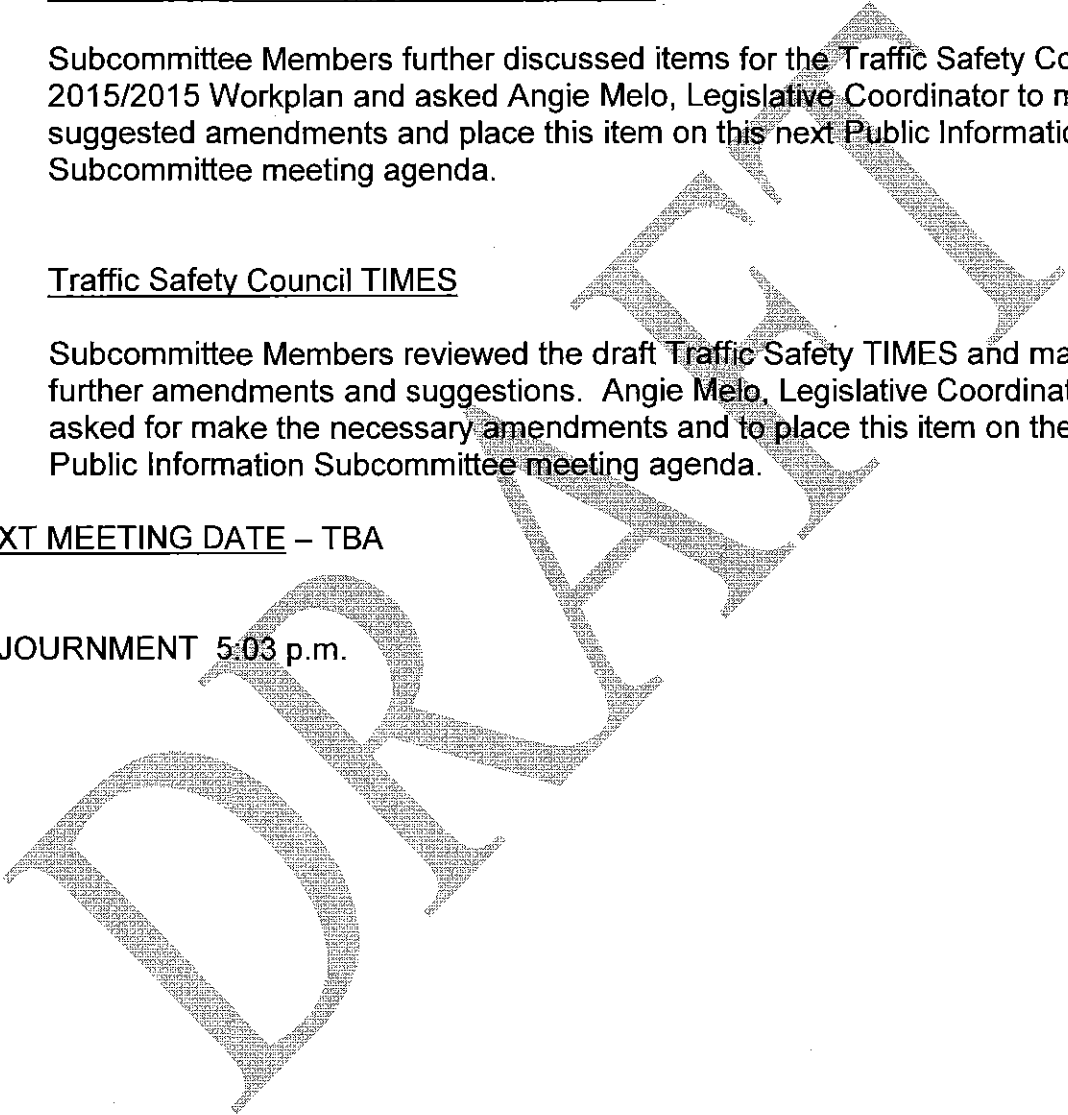

Traffic Safety Council  
SEP 30 2015



# MINUTES

---

## TRAFFIC SAFETY COUNCIL PUBLIC INFORMATION SUBCOMMITTEE

Thursday, September 3, 2015 3:00 p.m.

Committee Boardroom A, 2<sup>nd</sup> FLOOR, MISSISSAUGA CIVIC CENTRE  
300 CITY CENTRE DRIVE, MISSISSAUGA

### MEMBERS PRESENT

- Heather Relf (Citizen Member)
- Daniel Suess (Citizen Member)
- Denise Gordon-Mohamud (Citizen Member)
- Altamash Syed (Citizen Member)
- Sandra Beniuk, (Citizen Member)
- Sushil Kumra (Citizen Member)
- Ajay Sharma (Citizen Member)
- Peter Westbrook, *ex-officio*

### MEMBERS ABSENT

- Matthew Moore (Citizen Member)
- Ajay Sharma (Citizen Member)

### STAFF PRESENT

- Denna Yaunan, Traffic Operations Technologist
- Angie Melo, Legislative Coordinator

### STAFF ABSENT

- Sheelagh Duffin, Supervisor, Crossing Guard
- Erica Warsh, Transportation Demand Management Coordinator

**CALL TO ORDER**

3:15 p.m.

**MATTERS CONSIDERED**

1. Traffic Safety Council 2015/2016 Workplan

Subcommittee Members further discussed items for the Traffic Safety Council 2015/2015 Workplan, and were satisfied with the items on the Traffic Safety Council 2015/2016 Workplan.

2. Traffic Safety Council TIMES

Subcommittee Members reviewed the draft Traffic Safety TIMES and made further amendments. Angie Melo, Legislative Coordinator was asked for make the necessary amendments and to distribute, via email, to subcommittee members for comments.

NEXT MEETING DATE – TBA

ADJOURNMENT 3:55 p.m.

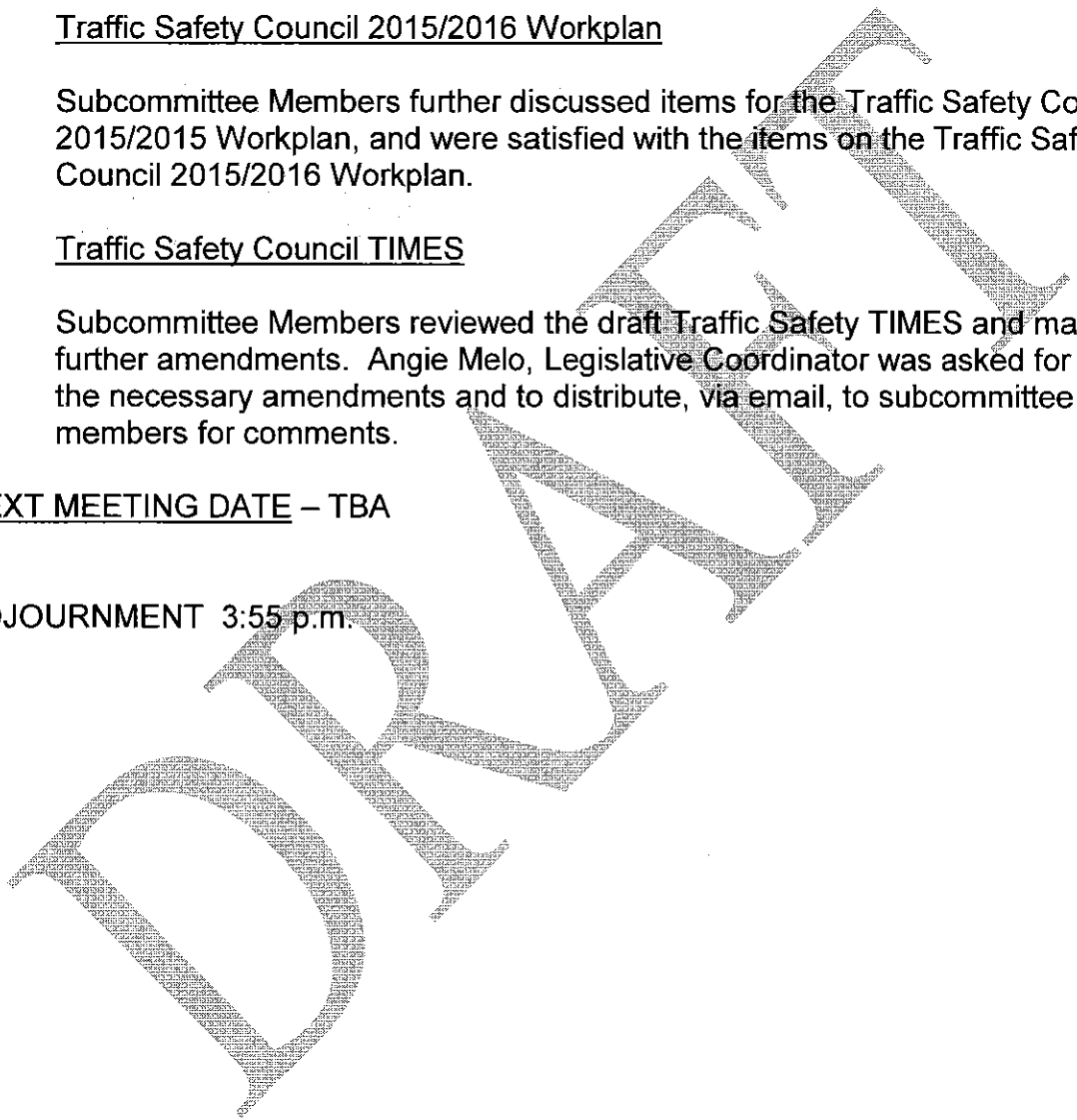



**STAKEHOLDER**

**RESPONSIBILITIES**

**Parents**

get their children safely to and from school  
where a safety concern is identified notify the appropriate agency

**City of Mississauga**  
Transportation and Works Dept.

sidewalk and roadway maintenance (summer and winter)  
traffic signals (pedestrian signals) maintenance  
crossing guard administration  
traffic signs and school zone signage  
parking enforcement

**City of Mississauga**  
Community Services Dept.

park pathway maintenance (summer and winter)  
park lighting maintenance

**City of Mississauga**  
Council

appointment of Traffic Safety Council  
consider / action recommendations from Traffic Safety Council

**City of Mississauga**  
Traffic Safety Council

review and recommendation in respect of:  
crossing guard placement and removal  
school walking route safety  
school zone operation  
school drop-off and pick-up operation  
where a safety concern is identified notify the appropriate agency

**School Board Trustees**

set policy for student eligibility distances for bussing  
where a safety concern is identified notify the appropriate agency

**School Principal**

safety of students on the school property  
where a safety concern is identified notify the appropriate agency

**School Board Administration**

school property maintenance (summer and winter)  
school building maintenance  
school hours  
where a safety concern is identified notify the appropriate agency

**Student Transportation or Peel Region (STOPR)**

provision of student transportation (school bussing) in accordance School Board policy  
establish school bus routes and stops  
identifying safety issues or concerns in respect to bussing  
where a safety concern is identified notify the appropriate agency

**Peel Regional Police**

*Highway Traffic Act* enforcement (u-turns, speeding, etc.)  
personal safety issues

<u>CATEGORY</u>	<u>ISSUE</u>	<u>RESPONSIBILITY</u>
<b>Sidewalks (along city streets)</b>	maintenance and construction (summer and winter)	City of Mississauga Transportation and Works Dept. Call: 311
<b>Signs in School Zones (not on school property)</b>	maintenance and installation	City of Mississauga Transportation and Works Dept. Call: 311
<b>Crossing Guards</b>	placement / removal	Traffic Safety Council City Clerks Office Laura Wilson: 905-615-3200 x 5425
	conduct	Transportation and Works Dept. Sheelagh Duffin: 905-615-3200 x 5167
<b>Park Pathways</b>	maintenance and construction (summer and winter) pathway lighting	City of Mississauga Community Services Dept. Call: 311
<b>School Bus Eligibility (criteria)</b>	distance criteria policy	Board of Trustees Peel District School Board 905-890-1010 Dufferin Peel Catholic District School Board 905-890-1221
<b>School Bus Routes Region</b>	school bus routes and stops	Student Transportation of Peel
	Implementing distance policy	(STOPR) 905-890-1221
<b>Safety</b>	personal safety	Peel Regional Police 905-453-3311 Emergency: 911
	walking routes to schools (physical conditions)	Traffic Safety Council City Clerks Office Laura Wilson: 905-615-3200 x 5425
	school zones operation review	Traffic Safety Council City Clerks Office Laura Wilson: 905-615-3200 x 5425
	school zones -- illegal parking	City of Mississauga Call: 311
	school property	school principal
	students getting to and from school	parents



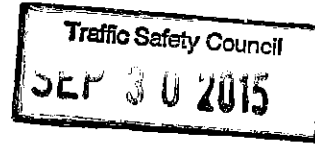

16

## TRAFFIC SAFETY COUNCIL Wilde Wood School Zone Safety Award Application

The City of Mississauga's Traffic Safety Council promotes student safety to and from school. Through the Wilde Wood School Zone Safety Award, we would like to recognize schools who have demonstrated outstanding leadership in the field of Active Transportation. Up to two (2) elementary schools from each school board (Dufferin-Peel Catholic District School Board and the Peel District School Board) may be awarded \$500.00 to benefit the students.

Schools selected as finalists will be subject to an on-site evaluation review conducted by Members of the Traffic Safety Council.

- ❖ **\$500.00 AWARD FROM THE MISSISSAUGA TRAFFIC SAFETY COUNCIL TO DIRECTLY BENEFIT THE STUDENTS!!!!**
- ❖ **The Award will be presented before Members of Council to the successful school at a January 2016 Council meeting.**

School Name: \_\_\_\_\_

Address: \_\_\_\_\_

Principal's Name and email Address: \_\_\_\_\_

Fax or email completed application by [date] to:  
Angie Melo, Legislative Coordinator, 905-615-3200, Ext. 5423  
[angie.melo@mississauga.ca](mailto:angie.melo@mississauga.ca) or fax to 905-615-4181

It's so easy to apply! Please turn page to complete the application

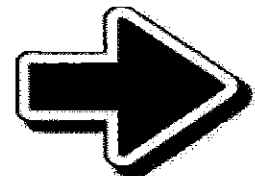



169

1. If your school was awarded \$500.00, what would the funds be used for?

\_\_\_\_\_

\_\_\_\_\_

2. Does your school have an active transportation champion?  Yes  No

Staff  Student Ambassador  Parent Volunteer  Peel Public Health

3. How does your school promote active transportation to and from school? (i.e. newsletter, assemblies, school travel plan) Please list:

\_\_\_\_\_

4. How would you rank the active transportation program at your school?

Excellent  Very Good  Good  Fair

What areas need improvement? \_\_\_\_\_

5. What resources do you enlist to educate parents and students on school zone safety?

Neighbourhood Police Unit  Parking Enforcement Unit  Other

If other, please list: \_\_\_\_\_

6. Does your school have a Kiss & Ride area?  Yes  No – if yes, what resources do you have in the area?

Staff  Student Ambassador  Parent Volunteer

7. Does your school have a Dismissal Program?  Yes  No – if yes, what resources do you have in the area?

Staff  Student Ambassador  Parent Volunteer

8. Does your school have bike racks?  Yes  No – if No, would you be interested in installing bike racks at your school?  Yes  No

# Terms of Reference for Traffic Safety Council

Traffic Safety Council

SEP 30 2010

## Mandate

The Mississauga Traffic Safety Council considers matters related to the safety of students and their movement through the City of Mississauga and shall, wherever the situation warrants it, make recommendations to the Council of the City of Mississauga which are designed and intended to protect elementary and secondary school students from the dangers of vehicular traffic or related hazards. Traffic Safety Council will also work in co-operation with other Committees of Council on issues regarding pedestrian safety throughout the City of Mississauga.

Appointed members are required to attend site inspections on a regular basis to review requests for Crossing Guards and to review safety concerns in school areas and the launch of Walk To School Program.

## Objectives/Goals

The objective of the Traffic Safety Council is to provide a safe environment for students in and around schools. The goal is to contribute to a healthy city by encouraging walking to school and ensuring walking routes are safe.

## Work Plan

All Advisory Committees shall prepare annual Work Plans which will be sent to their parent standing committee, then to Council at the beginning of the New Year, as well as a progress update at the end of the year. Committee members shall work collaboratively with City staff devise these Work Plans to ensure that the workload is manageable and appropriately shared between the two parties. Work plans will need to be carefully crafted in order to meet the Committee's mandate and objectives, as well as the City's Strategic Plan, Master Plans, and budgetary capacity.

The work plan shall speak directly to the specific goals the committee aims to accomplish. The work plan for each Advisory Committee attempts to use the City's Strategic Plan Pillars, action items, master plans, or legislation as sub-headings to organize the committee's focus and nature of work. The Committee shall present its accomplishments as they relate to the work plan, to Council annually.

## Definitions

Definitions are provided for the purpose of clarity and only where necessary. That definitions provided are referenced to the appropriate source/legislation.

## Life Member

Where the Traffic Safety Council reviews or considers a member for appointment as a Life Member, the committee will consider a member's contributions to the long term advancement of the goals and objectives of the Traffic Safety Council.

## Procedures and Frequency of Meetings

All Committees are subject to Council Procedure By-law, which outlines the procedures for Council and Committee meetings.

[http://www7.mississauga.ca/documents/bylaws/procedural\\_by-law\\_2013.pdf](http://www7.mississauga.ca/documents/bylaws/procedural_by-law_2013.pdf)

The Traffic Safety Council will meet approximately 10 times per year, on the last Wednesday of every month, or as determined by the Committee at the call of the Chair. Traffic Safety Council does not meet in July and August.

In addition to attending Committee meetings, members of the Traffic Safety Council will be required to attend site inspections to evaluate and provide recommendations on approximately a minimum of 2 site inspections per month.

## Membership

All members are subject to the Code of Conduct and Complaint Protocol for Local Boards.

[http://www7.mississauga.ca/documents/CityHall/pdf/2014/Local\\_Boards\\_Code\\_of\\_Conduct.pdf](http://www7.mississauga.ca/documents/CityHall/pdf/2014/Local_Boards_Code_of_Conduct.pdf)

and Corporate Policy 02-01-01: Citizen Appointments to Committees, Boards and Authorities. <http://inside.mississauga.ca/Policies/Documents/02-01-01.pdf>

The Traffic Safety Council shall be comprised of:

- 3 Councillors;
- 2 Trustees (1 from the Peel District School Board and 1 from the Dufferin-Peel Catholic District School Board);
- Up to 2 Life Members;
- 11 Citizen Members, ideally representing each ward in the City;
- 3 Citizen Members, representing the city at large.

In addition to the Council appointed members of the Committee, the following are non-voting members who serve as a resource to the Committee:

- Manager of Student Transportation (or Designate), Peel District School Board/Dufferin-Peel Catholic District School Board;
- Principals'/Vice-Principals' Association (1 from the Peel District School Board and 1 from the Dufferin-Peel Catholic District School Board);
- One staff from the Peel District School Board and one from the Dufferin-Peel Catholic School Board;
- Transportation & Works (Traffic Operations) staff;

- Transportation & Works (Crossing Guard Supervisor);
- Manager of Parking Control (or Designate), Transportation and Works, Enforcement Division;
- Peel Regional Police, Traffic Services.

### **Role of Chair**

The Chair of the Committee will be appointed at the first meeting of the Committee.

The role of the Chair is to:

1. Preside at the meetings of Traffic Safety Council using City of Mississauga's Procedure By-law, and keep discussion on topic.
2. Provide leadership to the Traffic Safety Council to encourage that its activities remain focused on its mandate as an Advisory Committee of Council.
3. Review agenda items with the Committee Coordinator and Traffic Operations staff.
4. Recognize each Member's contribution to the Committee's work.
5. Serve as an *ex-officio* member of subcommittees and attend subcommittee meetings when necessary.
6. Liaise with the Manager of (Office in the City that handles the Committee's subject matter) on a regular basis.

### **Role of Committee Members**

The role of Committee Members is to:

1. Ensure that the mandate of (name of committee) is being fulfilled.
2. Provide the Chair with solid, factual information regarding agenda items.
3. When required, advise Council on matters relating to (the matters that the committee deals with).
4. Actively participate in the promotion of the Committee's signature events/Site inspections/etc. (whatever they may be).
5. Notify the Committee Coordinator if they are unable to attend (name of committee) meetings to ensure that quorum will be available for all meetings.

### **Quorum**

1. Quorum of the Traffic Safety Council shall be reached with the presence of a majority of the appointed and elected members, at a time no later than thirty (30) minutes past the time for which the beginning of the meeting was scheduled and so noted on the agenda or notice of the meeting.

2. The issuance of an Agenda for a meeting of this Committee will be considered as notice of that meeting.
3. The presence of one (1) of the appointed Council members shall be required to establish quorum.

### Subcommittees

That, as per the Procedure By-law 139-2013, a Committee of Council may establish a subcommittee which shall consist of members of the parent Committee, as may be determined by such parent Committee and any other member approved by Council.

- Sub-committees will be formed to deal with specific issues, and will make recommendations to the parent Committee. Once the specific issue is dealt with the subcommittee shall cease.
- All appointed members of the subcommittee have the right to vote.
- The Chair of the subcommittee will be appointed at the first meeting of the subcommittee.

The following are subcommittee of the Traffic Safety Council.

- Public Information Subcommittee
- Site Plan Review Subcommittee (to be removed pending further discussion with Planning and Building Department)
- Walk to School Sub-committee

City of Mississauga Traffic Safety 2015/2016 Workplan

Date: September 2015

Traffic Safety Council  
SEP 30 2015

Priority Areas	Action	Timing	Cost
Conduct Site Inspections	<ul style="list-style-type: none"> <li>• Respond to all requests for safety reviews and site inspections and make recommendations to Council</li> <li>• Recommend place or removal of Crossing Guards based on warrant criteria</li> </ul>		
Walk to School Program	<ul style="list-style-type: none"> <li>• 2 school launches in the spring and 2 in the fall</li> <li>• 2 school re-launches in the spring and in the fall</li> <li>• Partner with other Green Active Transportation groups</li> <li>• Promote walking to and from school by participating at school assemblies</li> <li>• Purchase street signs for launch of new schools to the Walk to School Program</li> <li>• Order Frequent Walk to School punch cards</li> <li>• Items for promotional baskets for school launches and re-launches</li> </ul>		<p>\$16,000.00</p> <p>\$ 200.00</p> <p>\$ 3,000.00</p>
Traffic Safety Council Webpage	<ul style="list-style-type: none"> <li>• Review, create and update content on The City of Mississauga Traffic Safety Council Webpage.</li> <li>• Provide links to:               <ul style="list-style-type: none"> <li>○ Peel Walk &amp; Roll</li> <li>○ Active and Safe Routes to School</li> <li>○ Peel Safety Village</li> <li>○ Peel Road Walk</li> <li>○ Ministry of Transportation (MTO Biking)</li> <li>○ City of Mississauga's Active Transportation webpage</li> </ul> </li> </ul>		

189

Priority Areas	Action	Timing	Cost
Partnership with City of Mississauga Active Transportation Department	<ul style="list-style-type: none"><li>Investigate future cycling and walking Initiatives</li></ul>		
Promote and educate students and parents on walking and biking to school safely	<ul style="list-style-type: none"><li>Provide updated publication/newsletters to be distributed to schools</li></ul>		TBD