



AGENDA

TRAFFIC SAFETY COUNCIL

THE CORPORATION OF THE CITY OF MISSISSAUGA
WEDNESDAY, April 23, 2014 – 5:00 P.M.

COMMITTEE ROOM 'A', SECOND FLOOR
300 CITY CENTRE DRIVE, MISSISSAUGA, ONTARIO L5B 3C1
MISSISSAUGA, ONTARIO
www.mississauga.ca

Members

Councillor Frank Dale, Ward 4
Councillor Sue McFadden, Ward 10
Meredith Johnson (Trustee Ward 9 & 10 - Peel District School Board)
Anna Abbruscato (Trustee Ward 4 -Dufferin-Peel Catholic District School Board)
Peter Westbrook (**CHAIR**, Citizen Member Ward 2)
Louise Goegan (**VICE-CHAIR**, Citizen Member Ward 5)
Boris Swedak (Life Member, Ward 3)
Edgar Lethbridge (Citizen Member Ward 4)
Daniel Suess (Citizen Member Ward 7)
John McGlone (Citizen Member Ward 8)
Sushil Kumra (Citizen Member Ward 8)
Heather Relf (Citizen Member Ward 9)
Anna Myrdal (Citizen Member Ward 10)
Matthew Moore (Citizen Member Ward 10)

City-Wide Members

David Brennan (Citizen Member Ward 5 North Zone)
Denise Gordon-Mohamud (Citizen Member Ward 10 North Zone)
Altamash Syed (Citizen Member Ward 4 South Zone)

Advisory Board

Andy Bate, Supervisor, Traffic Operations
Denna Yaunan, Traffic Operations Technician
Sheelagh Duffin, Supervisor, Crossing Guards
Barry Foley, Manager, Parking Enforcement
Cst. Joey Rego, Peel Regional Police
Daniel Elias, Principals'/Vice-Principals' Association Peel District School Board
Shawn Kearns, Principals'/Vice-Principals' Association Dufferin-Peel Catholic District School Board
Anna Gentile & Marcy Macina, Student Transportation

Contact: Angie Melo, Legislative Coordinator
Office of the Clerk 905-615-3200 ext. 5423 Fax 905-615-4181
angie.melo@mississauga.ca

INDEX – TRAFFIC SAFETY COUNCIL – April 23, 2014

CALL TO ORDER

DECLARATIONS OF CONFLICT OF INTEREST

PRESENTATIONS / DEPUTATIONS

MATTERS TO BE CONSIDERED

1. Approval of March 26, 2014 Minutes
2. Site Inspection Reports – Blessed John XXIII Catholic Elementary School (Ward 6)
3. Site Inspection Report – St. Hilary Catholic School (Ward 5)
4. Site Inspection Report – St. Herbert Catholic School (Ward 6)
5. Site Inspection Report – Ridgewood Public School (Ward 5)
6. Site Inspection Report – Oscar Peterson Public School (Ward 10)
7. Site Inspection Reports – Forest Avenue Public School (Ward 1)
8. Site Inspection Reports – Mary Fix Catholic School (Ward 7)
9. Site Inspection Request – Queen of Heaven Catholic School (Ward 1)
10. Dismissal Report – April 2014
11. School Zone Safety (Kiss & Ride) Report – March – April 2014
12. Budget Subcommittee Meeting Minutes – April 2, 2014
13. Walk to School Subcommittee Meeting Minutes – April 11, 2014
14. Transportation and Works Action Items List – February 2014
15. Parking Enforcement in School Zones Month of March 2014
16. Ontario Traffic Council Conference June 2014
17. Resignation Letter from Anna Myrdal, Citizen Member

OTHER BUSINESS

Date of Next Meeting – May 28, 2014

ADJOURNMENT

CALL TO ORDERDECLARATIONS OF CONFLICT OF INTERESTMATTERS TO BE CONSIDERED1. Approval of March 26, 2014 Minutes

Minutes of the Traffic Safety Council meeting held on March 26, 2014.

2. Site Inspection Reports – Blessed John XXIII Catholic Elementary School (Ward 6)

Site Inspection Reports for the inspections conducted on April 2, and April 3, 2014 in front of Blessed John XXIII Catholic Elementary School.

RECOMMENDATION

1. That Transportation and Works be requested to review signage in front of Blessed John XXIII Catholic Elementary School.
2. That Parking Enforcement be requested to enforce parking prohibitions in front of Blessed John XXIII Catholic Elementary School between 3:20 p.m. – 3:40 p.m., once signage is in place.

RECOMMEND APPROVAL3. Site Inspection Report – St. Hilary Catholic School (Ward 5)

Site Inspection Report for the inspection conducted on April 3, 2014 in front of St. Hilary Catholic School.

RECOMMENDATION

1. That Transportation and Works be requested to review signage in front of St. Hilary Catholic School, and extend the No Stopping Zone on the east side of Fairwind Drive South to the school boundary.
2. That Parking Enforcement be requested to enforce parking prohibitions in front of St. Hilary Catholic School between 3:15 p.m. – 3:45 p.m., once signage is in place.

RECOMMEND APPROVAL4. Site Inspection Report – St. Herbert Catholic School (Ward 6)

Site Inspection Report for the inspection conducted on April 9, 2014 at the intersection of Lismic Boulevard and Dream Crest Road, in front of Rick Hansen

Secondary School.

RECOMMENDATION

1. That the request to extend the times of the crossing guard from 8:30 a.m. to 9:00 a.m. and from 3:25 p.m. to 3:55 p.m. for the students attending St. Herbert Catholic School be denied as the warrants have not been met.
2. That Transportation and Works be requested to review signage on the north side of Dream Crest Road between Lismic Boulevard and Cinnamon Road for the students attending St. Herbert Catholic School.

RECOMMEND APPROVAL

5. Site Inspection Report – Ridgewood Public School (Ward 5)

Site Inspection Report for the inspection conducted on April 11, 2014 at the intersection of Cambrett Drive and Shallford Road for the students attending Ridgewood Public School.

RECOMMENDATION

1. That the request for a crossing guard for students attending Ridgewood Public School be denied as the warrants have not been met.
2. That the Peel District School Board be requested to consider the following at Ridgewood Public School:
 - a. Installing a fence across the front of the school, driveway to driveway, to prevent students from walking across the Kiss & Ride area.
 - b. Installing a fence along the north side of the school.
3. That Transportation and Works be requested to review signage in front of Ridgewood Public School.
4. That Traffic Safety Council work with the Principal of Ridgewood Public School to implement a School Walking Route Program.

RECOMMEND APPROVAL

6. Site Inspection Report – Oscar Peterson Public School (Ward 10)

Site Inspection Report for the inspection conducted on April 14, 2014 in front of Oscar Peterson Public School.

RECOMMENDATION

1. That the request to install a layby in front of Oscar Peterson Public School is not recommended as the road width is adequate to accommodate parking on the north side, left turn lane into school Kiss & Ride and a through lane east and west.

2. That the Principal of Oscar Peterson Public School be requested to encourage parents to utilize the park parking lot at school, which is currently not fully utilized, during entry and dismissal times.

RECOMMEND APPROVAL

7. Site Inspection Reports – Forest Avenue Public School (Ward 1)

Site Inspection Reports for inspections conducted on March 18, 2014, April 1, 2014 and April 16, 2014 at the intersection of Hurontario Street and Park Street to review Crossing Guard warrants for students attending Forest Avenue Public School.

RECOMMENDATION

That the Crossing Guard placed at the intersection of Hurontario Street and Park Street for student attending Forest Avenue Public School be removed at the end of the 2013-2014 school year, June 27, 2014, as the warrants have not been met to retain the Crossing Guard, and further, that all conditions are good for self-control of crossing and traffic compliance is very good.

RECOMMEND APPROVAL

8. Site Inspection Reports – Mary Fix Catholic School (Ward 7)

Site Inspection Reports for inspections conducted on April 8, 2014 at the intersection of Paisley Boulevard and Crystalburn Avenue, April 10, 2014 at the intersection of Stillmeadow Road and Louis Drive, and April 15, 2014 at the intersection of Stillmeadow Road and Queensway West, for students attending Mary Mix Catholic School.

RECOMMENDATION

1. That the request for a Crossing Guard at the intersection of Paisley Boulevard and Crystalburn Avenue, for the students attending Mary Fix Catholic School be denied as the warrants have not been met and the all way stop provides protection for crossing students.
2. That the request for a Crossing Guard at the intersection of Stillmeadow Road and Louis Drive for the students attending Mary Fix Catholic School be denied as the warrants have not been met.
3. That the request for a Crossing Guard at the intersection of Stillmeadow Road and Queensway West for the students attending Mary Fix Catholic School be denied as the warrants have not been met.

RECOMMEND APPROVAL

9. Site Inspection Request – Queen of Heaven Catholic School (Ward 1)

Email dated March 25, 2014 from Sheelagh Duffin, Supervisor, Crossing Guards, with respect to a request for Traffic Safety Council to determine if the warrants are met for the implementation of a school crossing guard for the students of Queen of Heaven Catholic School at the intersection of Alexandra Avenue and Fourth Street.

RECEIPT/REFERRED

10. Dismissal Report – April 2014

RECOMMENDATION

That the Dismissal Report for the month of May 2013 be received.

RECOMMEND RECEIPT

The following recommendations emanated from the Dismissal Report for the month of April 2014:

Forest Avenue Public School (Ward 7)

Recommendation

1. That the Peel District School Board be requested to consider the following at Forest Avenue Public School.
 - a. Place Forest Avenue Public School on the 2014 painting contract.
 - b. Painting one way directional arrows on the driveway.
 - c. Install all appropriate signage on site as required.
2. That Transportation and Works be requested to install No U Turn signs on the east side of Elmwood Avenue North, in front of Forest Avenue School.

Artesian Drive Public School (Ward 8)

Recommendation

That the Peel District School Board be requested to consider reviewing the site at Artesian Drive Public School for inclusion in the 2014 pavement painting contract.

St. Margaret of Scotland School (Ward 8)

Recommendation

1. That Parking Enforcement be requested to enforce the “No Stopping” and “No Parking” signs between 3:05 p.m. and 3:25 p.m. on Council Ring Road for St. Margaret of Scotland School.
2. That Transportation and Works be requested to review the adequacy of signs on Council Ring Road beyond the school boundaries with a view to eliminate parking on both sides of the road.

3. That the Dufferin-Peel Catholic District School Board be requested to review the placement of a "No Left Turn" sign at the driveway exit location.

Oscar Peterson Public School (Ward 10)**Recommendation**

1. That Parking Enforcement be requested to attend on Perennial Drive and Tenth Line West to enforce existing posted prohibitions between 3:10 p.m. and 3:35 p.m. for a minimum of three consecutive days for Oscar Peterson Public School.
2. That Transportation and Works be requested to undertake a traffic light study to determine if warrants exist for traffic lights at the intersection of Perennial Drive and Eglinton Avenue.
3. That the Crossing Guard Supervisor be requested to review procedures at the intersections of Perennial Drive and Tenth Line West to determine if improvements are possible.

St. Herbert Catholic School (Ward 6)**Recommendation**

That Parking Enforcement be requested to attend on Fallingbrook Drive to enforce existing posted prohibitions on Fallingbrook Drive between 3:20 p.m. and 3:40 p.m. for St. Herbert Catholic School.

Castlebridge Public School (Ward 9)**Recommendation**

1. That the Peel District School Board be requested to consider placing Castlebridge Public School on the 2014 painting contract.
2. That Parking Enforcement be requested to attend Castlebridge Public School to enforce the existing posted prohibitions between 3:15 p.m. and 3:40 p.m.
3. That the Principal of Castlebridge Public School be requested to encourage more parents to leave their cars at home during dismissal and walk their children home from school.

Erin Centre Middle School (Ward 10)**Recommendation**

That Parking Enforcement be requested to attend at Erin Centre Public School to enforce existing posted prohibitions between 2:00 p.m. and 2:35 p.m.

St. Timothy Catholic School (Ward 1/7)**Recommendation**

1. That Parking Enforcement be requested to enforce the existing posted prohibitions on Cliff Road in front of St. Timothy Catholic School between 2:50 p.m. and 3:40 p.m.

2. That the Principal of St. Timothy Catholic School be requested to encourage parents presently picking up students during the dismissal period, to have their children walk to school.

RECOMMEND APPROVAL

11. School Zone Safety (Kiss & Ride) Report – March - April 2014

That the School Zone Safety (Kiss & Ride) Report from March – April 2014 be received for information.

RECOMMEND RECEIPT

The following recommendations emanated from the School Zone Safety Kiss & Ride) Report for the months of March - April 2014:

March 20, 2014

Lisgar Middle School (Ward 10)

RECOMMENDATION

1. That the Peel District School Board be requested to consider relocating the drop off for Kiss & Ride at Lisgar Middle School, to the south side of the building, to create a larger storage area for cars in the queue to drop off students.
2. That the Principal at Lisgar Middle School be requested to ensure staff at the Kiss & Ride wear the safety vests.

March 26, 2014

Clifton Public School (Ward 7)

RECOMMENDATION

That the Peel District School Board be requested to review the feasibility of the following at the Kiss & Ride at Clifton Public School:

- a. Install Kiss & Ride sign and stop bar at the drop off areas located at the south side of the building.
- b. Fire Route signage on property.
- c. Creating a walkway for parents, from the south part of the parking lot.
- d. Repaint the pavement signs before the start of school in September 2014.

March 27, 2014

Sheridan Park Public School (Ward 2)

RECOMMENDATION

That the Peel District School Board be requested to consider the following at Sheridan Park Public School:

- a. Install a "No Left Turn" sign on driveway exit; and,
- b. Place Kiss & Ride signs on the driveway.

April 2, 2014**Corpus Christi Catholic School (Ward 4/6)****RECOMMENDATION**

That the Dufferin-Peel Catholic District School Board be requested to consider the following at Corpus Christi Catholic School:

- a. Review the Kiss & Ride and Fire Route signage.
- b. Mark two lanes for traffic to exit the driveway.
- c. Move the stop bar located in the Kiss & Ride to all buses more room.

RECOMMEND APPROVAL**12. Budget Subcommittee Meeting Minutes – April 2, 2014**

Minutes from the Budget Subcommittee meeting held on April 2, 2014.

RECOMMENDATION

That the minutes from the April 2, 2014 Budget Subcommittee meeting be received for information.

RECOMMEND RECEIPT

The following recommendations emanated from the Minutes of the Budget Subcommittee meeting held on April 2, 2014:

RECOMMENDATION

1. That the draft Traffic Safety Council Budget from the April 2, 2014 Budget Subcommittee meeting be approved.
2. That the amount of \$775.00 be allocated in the 2014 Traffic Safety Council Operating Budget to send three Mississauga students to participate in the 2013/2014 School Safety Patroller Program.

RECOMMEND APPROVAL**13. Walk to School Subcommittee Meeting Minutes – April 11, 2014**

Minutes from the Walk to School Subcommittee meeting held on April 11, 2014.

RECOMMENDATION

That the Walk to School Subcommittee Meeting Minutes from the meeting held on April 11, 2014 be received.

RECOMMEND RECEIPT

The following recommendations emanated from the Minutes of the Walk to School Subcommittee meeting held on April 11, 2014:

RECOMMENDATION

That Louise Goegan be appointed as Chair of the Traffic Safety Council's Walk to School Subcommittee for a term ending on November 30, 2014 or until a successor is appointed.

RECOMMEND APPROVAL14. Transportation and Works Action Items List – February, 2014

That the Action Items List from the Transportation and Works Department for the month of February, 2014 be received for information.

RECOMMEND RECEIPT15. Parking Enforcement in School Zones Month of March 2014

That the report from the Manager of Parking Enforcement with respect to parking enforcement in school zones for the month of March 2014 be received for information.

RECOMMEND RECEIPT16. Ontario Traffic Council - 2014 Conference- June 1-4, 2014

An invitation to members of Traffic Safety Council to attend the Ontario Traffic Council's 2014 Conference on June 1 - 4, 2014, at the Crowne Plaza Hotel, Kitchener. In the past, three (3) citizen members of Traffic Safety Council attended. Please advise at the meeting of your interest in attending.

DIRECTION REQUIRED

17. Resignation Letter from Anna Myrdal

Letter dated March 31, 2014 from Anna Myrdal, Traffic Safety Council, Citizen Member (Ward 10).

RECOMMEND RECEIPT

OTHER BUSINESS

Date of Next Meeting – May 28, 2014

ADJOURNMENT



Traffic Safety Council

APR 23 2014

Minutes

TRAFFIC SAFETY COUNCIL

THE CORPORATION OF THE CITY OF MISSISSAUGA
WEDNESDAY, March 26, 2014 – 5:00 P.M.

COMMITTEE ROOM 'A', SECOND FLOOR
300 CITY CENTRE DRIVE, MISSISSAUGA, ONTARIO L5B 3C1
MISSISSAUGA, ONTARIO
www.mississauga.ca

Members Present

Councillor Frank Dale, Ward 4
Councillor Sue McFadden, Ward 10
Anna Abbruscato (Trustee Ward 4 -Dufferin-Peel Catholic School Board)
Peter Westbrook (**CHAIR**, Citizen Member Ward 2)
Louise Goegan (**VICE-CHAIR**, Citizen Member Ward 5)
Edgar Lethbridge (Citizen Member Ward 4)
Daniel Suess (Citizen Member Ward 7)
John McGlone (Citizen Member Ward 8)
Sushil Kumra (Citizen Member Ward 8)
Heather Relf (Citizen Member Ward 9)
Anna Myrdal (Citizen Member Ward 10)
Matthew Moore (Citizen Member Ward 10)
Denise Gordon-Mohamud (Citizen Member Ward 10 North Zone)
Altamash Syed (Citizen Member Ward 4 South Zone)

Members Absent

Meredith Johnson (Trustee Ward 9 & 10 – Peel District School Board)
Boris Swedak (Life Member, Ward 3)
David Brennan (Citizen Member Ward 5 North Zone)

Advisory Board Present

Andy Bate, Supervisor, Traffic Operations
Denna Yaunan, Traffic Operations Technician
Sheelagh Duffin, Supervisor, Crossing Guards
Barry Foley, Manager, Parking Enforcement
Matt Nomi, Parking Enforcement Officer
Shawn Kearns, Principals'/Vice-Principals' Association Dufferin-Peel Catholic School Board
Marcy Macina, Student Transportation
David Marcotte, Supervisor, Preventative Maintenance, Peel District School Board

Contact: Angie Melo, Legislative Coordinator
Office of the Clerk 905-615-3200 ext. 5423 Fax 905-615-4181
angie.melo@mississauga.ca

CALL TO ORDER – 5:00 p.m.

DECLARATIONS OF CONFLICT OF INTEREST – Nil

PRESENTATIONS/DEPUTATIONS

Judy Richards, Principal and Harpal Kalsi, Chair, School Council at Oscar Peterson Public School spoke to the Traffic Safety Council (TSC) regarding the traffic and safety concerns at Oscar Peterson Public School. Mr. Kalsi's PowerPoint presentation illustrated the traffic congestion in front of Oscar Peterson Public School. Further, the presentation outlined the efforts undertaken by staff at the school to communicate policies and educate parents on appropriate behaviour at the Kiss & Ride area. Ms. Richards and Mr. Kalsi both conveyed that they have been very persistent in educating parents, getting staff to assist at the Kiss & Ride with escorting children safely off the buses and into the school.

Ms. Richards, advised that there has been an increase of traffic congestion with the implementation of the full day kindergarten classes. Further, when asked about staggering the kindergarten start times, Ms. Richards advised that they must conform to the Ministry Act, and that there are no provisions in the Act to allow for staggered times for the Kindergarten students. Ms. Richards also responded to the inquiry about a carpool campaign and advised that school staff are not permitted to recommend or endorse a carpool campaign, there are too many issues regarding this matter.

Andy Bate, Supervisor, Traffic Operations, advised that if TSC recommends to install a layby, staff from Transportation and Works would have to review the site and determine whether there are any easement and encroachment issues before approving installation of the layby.

Recommendation

That the deputation from Karpal Kalsi, Chair, School Council, and Judy Richards, Principal at Oscar Peterson Public School, with respect to traffic and safety concerns at Oscar Peter Public School be received.

Received (D. Suess)

Recommendation - TSC-0047-2014

MATTERS TO BE CONSIDERED

1. Site Inspection Request – Oscar Peterson Public School (Ward 10)
Email from Councillor Sue McFadden dated March 25, 2014 requesting Traffic Safety Council re-visit Oscar Peterson Public School in the afternoon to review the traffic congestion and safety concerns at the most easterly entrance to the school property and to further evaluate the effectiveness of installing a layby lane on Perennial Drive in front of the school.

Recommendation

That the Site Inspection Subcommittee of Traffic Safety Council re-inspect Oscar Peterson Public School in the morning and afternoon to review the feasibility of installing a layby.

Approved (E. Lethbridge)

Recommendation - TSC-0048-2014

2. Approval of February 26, 2014 Minutes

Minutes of the Traffic Safety Council meeting held on February 26, 2014.

Approved (L. Goegan)

3. Site Inspection Report – St. Marcellinus Secondary School (Ward 11)

Site Inspection Report for the inspection conducted on February 21, 2014 at 730 Courtney Park Drive, in front of St. Marcellinus Secondary School

RECOMMENDATION

That the Site Inspection Report for the inspection conducted on February 21, 2014 in front of St. Marcellinus Secondary School, be received for information.

Approved (D. Suess)

Recommendation - TSC-0049-2014

4. Site Inspection Report – Plum Tree Park Public School and St. John of the Cross Catholic School (Ward 9)

Site Inspection Report for the inspection conducted on March 4, 2014 at 3156 Olympus Mews for the students attending Plum Tree Park Public School and St. John of the Cross Catholic School.

RECOMMENDATION

That the Site Inspection Report for the inspection conducted on March 4, 2014 on 3156 Olympus Mews for the students attending Plum Tree Park Public School and St. John of the Cross Catholic School, be received for information.

Approved (Councillor F. Dale)

Recommendation - TSC-0050-2014

5. Site Inspection Report – Divine Mercy Elementary School (Ward 9)

Site Inspection Report for the inspection conducted on March 20, 2014 at 2840 Ducairn Drive in front of Divine Mercy Elementary School.

RECOMMENDATION

1. That Transportation and Works be requested to review signage in the school area and to consider installing "No U-turn" signs in front of Divine Mercy Elementary School.
2. That Parking Enforcement be requested to enforce parking violations once signs have been installed in front of Divine Mercy Elementary School, between 8:10 a.m. to 8:35 a.m., and 2:30 p.m. to 3:15 p.m.
3. That the Peel Regional Police be requested to enforce "No U-turn" infractions once signs have been installed in front of Divine Mercy Elementary School, between 8:10 a.m. to 8:35 a.m., and 2:30 p.m. to 3:15 p.m.
4. That the Principal of Divine Mercy Elementary School be requested to consider the following:
 - a. Ensure that staff at the Kiss & Ride area wear safety vests.
 - b. Advise parents to have their child's backpacks in the car with them and not in the trunk, to allow for a quick exit from the vehicle.
 - c. Advise parents to take turns alternating one from each direction when entering the Kiss & Ride.
 - d. Monitor the student flow in the marked crosswalk in the Kiss & Ride area at dismissal to allow vehicles to clear in a more timely fashion.

Approved (Councillor S. McFadden)
Recommendation - TSC-0051-2014

6. Site Inspection Report – Olive Grove Private School (Ward 2)

Site Inspection Report for the inspection conducted on March 5, 2014 on 2300 Speakman Drive for the student attending Olive Grove Private School.

RECOMMENDATION

1. That Transportation and Works be requested to review the "No Parking" and "No Stopping" signs in the school zone near Olive Grove Private School.
2. That the Traffic Safety Council's Kiss & Ride Subcommittee assist staff at Olive Grove Private School in improving the efficiency of the Kiss & Ride.
3. That the Principal of Olive Grove Private School be requested to consider the following:
 - a. Educate the parents on the operation of the Kiss & Ride Program.
 - b. Advise parents to have their child's belongings with them rather than in the trunk of the vehicle to allow for quick exit from the vehicle.
 - c. Ensure vehicles pull ahead before dropping off students.
 - d. Advise parents that there is no parking in the Kiss & Ride area.

Approved (H. Relf)
Recommendation - TSC-0052-2014

7. Site Inspection Requests

- 7.1 Email dated January 20, 2014 from David Brennan requesting a site inspection in front of St. Hilary Elementary School.

RECOMMENDATION

That the email dated January 20, 2014 from David Brennan, Citizen Member requesting a site inspection in front of St. Hilary Elementary School be received and referred to the Site Inspection Subcommittee of Traffic Safety Council for a report back to Traffic Safety Council.

Received/Referred (Councillor S. McFadden)
Recommendation - TSC-0053-2014

- 7.2 Email dated March 3, 2014 from Councillor Pat Mullin requesting a site inspection on Perran Drive in front of Sheridan Park Public School.

RECOMMENDATION

That in response to Councillor Mullin's email dated March 3, 2014 requesting a site inspection on Perran Drive in front of Sheridan Park Public School, that the Traffic Safety Council send a memorandum to Councillor Mullin to advise that signage will be installed this spring and that once the signage is in place, this location will be closely monitored.

Received/Referred (Councillor S. McFadden)
Recommendation - TSC-0054-2014

- 7.3 Email dated March 6, 2014 from Councillor Ron Starr requesting a site inspection in front of Blessed John XXIII Catholic School.

RECOMMENDATION

That the email dated March 6, 2014 from Councillor Ron Starr requesting a site inspection in front of Blessed John XXIII Catholic School be received and referred to the Site Inspection Subcommittee of Traffic Safety Council for a report back to Traffic Safety Council.

Received/Referred (Councillor S. McFadden)
Recommendation - TSC-0055-2014

- 7.4 Email dated March 16, 2014 from Sheelagh Duffin requesting a site inspection at the intersection of Havenwood Drive and Willamsport for the students attending Brian W. Fleming Public School and St. Alfred Catholic School.

RECOMMENDATION

That the email dated March 16, 2014 from Sheelagh Duffin, Crossing Guard Supervisor, requesting a site inspection at the intersection of Havenwood Drive and Willamsport for the students attending Brian W. Fleming Public School and St. Alfred Catholic School be received and referred to the Site Inspection Subcommittee of Traffic Safety Council for a report back to Traffic Safety Council.

Received/Referred (Councillor S. McFadden)
Recommendation - TSC-0056-2014

- 7.5 Email dated March 5, 2014 from Sheelagh Duffin requesting a site inspection be scheduled in April at the intersection of Glen Erin Drive and Thomas Street for the students attending Castlebridge Public School.

RECOMMENDATION

That the email dated March 5, 2014 from Sheelagh Duffin, Crossing Guard Supervisor, requesting a site inspection be scheduled in April at the intersection of Glen Erin Drive and Thomas Street for the students attending Castlebridge Public School be received and referred to the Site Inspection Subcommittee of Traffic Safety Council for a report back to Traffic Safety Council.

Received/Referred (Councillor S. McFadden)
Recommendation - TSC-0057-2014

- 7.6 Email dated March 18, 2014 from Sheelagh Duffin requesting a site inspection at Dream Crest Road and Lismic Boulevard for the students attending St. Herbert Catholic School.

RECOMMENDATION

That the email dated March 18, 2014 from Sheelagh Duffin, Crossing Guard Supervisor, requesting a site inspection at Dream Crest Road and Lismic Boulevard for the students attending St. Herbert Catholic School be received and referred to the Site Inspection Subcommittee of Traffic Safety Council for a report back to Traffic Safety Council.

Received/Referred (Councillor S. McFadden)
Recommendation - TSC-0058-2014

- 7.7 Email dated March 20, 2014 from Angie Melo requesting a site inspection on Plum Tree Crescent near Plum Tree Park Public School.

RECOMMENDATION

That the email dated March 20, 2014 from Angie Melo, Legislative Coordinator, requesting a site inspection on Plum Tree Crescent near Plum Tree Park Public

School be received and referred to the Site Inspection Subcommittee of Traffic Safety Council for a report back to Traffic Safety Council.

Received/Referred (Councillor S. McFadden)
Recommendation - TSC-0059-2014

8. School Zone Safety (Kiss & Ride) Report – February and March 2014

RECOMMENDATION

That the School Zone Safety (Kiss & Ride) Report from February - March 2014 be received.

Received (E. Lethbridge)
Recommendation - TSC-0060-2014

The following recommendations emanated from the School Zone Safety Kiss & Ride) Report for the months of February – March 2014:

February 25, 2014

Kindree Public School (Ward 10)

RECOMMENDATION

1. That the Principal at Kindree Public School be requested to consider the following for the Kiss & Ride at the school.
 - a. That the parking lot designated for teachers be blocked off by 8:30 a.m. so that parents cannot use this area as a drop-off zone and that teachers be encouraged to arrive prior to 8:30 a.m.
 - b. That there be more than one staff person monitoring the drop-off zone and enforce this as a no parking area.
 - c. That staff at the Kiss & Ride wear safety vests so they are easily identifiable to parents.
 - d. That the Kiss & Ride cones and stop sign provided be used to enhance the program.
 - e. That the staff be re-educated on how the Kiss & Ride program works so that it will function efficiently.
2. That the Peel District School Board be requested to consider installing a "No left hand turn" sign on the school property to encourage parents to exit to the right only, to help with congestion
3. That the Traffic Safety Council Legislative Coordinator, send the Principal of Kindree Public School an information sheet on Kiss & Ride for distribution with the school newsletter to help educate the parents on how to use the program properly.

Approved (E. Lethbridge)
Recommendation - TSC-0061-2014

March 3, 2014**Whitehorn Public School (Ward 6)****RECOMMENDATION**

That the Peel District School Board be requested to review the feasibility of the following at the Kiss & Ride at Whitehorn Public School:

- a. Install Kiss & Ride sign at the drop-off areas located at the south side of building.
- b. Install right turn only sign at the southeast corner.
- c. Install "No Exit" signs on the south driveway.
- d. Repaint lanes on north exit driveway to show a left-hand lane exit and a right-hand lane exit.

Approved (E. Lethbridge)

Recommendation - TSC-0062-2014

March 4, 2014**Barondale Public School (Ward 5)****RECOMMENDATION**

1. That the Peel District School Board be requested to review the feasibility of painting a stop bar for cars in Kiss & Ride area at Barondale Public School.
2. That the Principal of Barondale Public School be requested to advise staff to wear safety vests at the Kiss & Ride.

Approved (E. Lethbridge)

Recommendation - TSC-0063-2014

March 6, 2014**Plum Tree Park Public School****RECOMMENDATION**

That the Peel District School Board be requested to relocate the "No Left Turn" and "Kiss & Ride" signs at Plum Tree Park Public School as follows:

- a. Move the "No Left Turn" sign to opposite side of driveway on north exit.
- b. Move the "Kiss & Ride" sign to the south entrance.

Approved (E. Lethbridge)

Recommendation - TSC-0064-2014

March 19, 2014**Canadian Martyrs Catholic School (Ward 4)****RECOMMENDATION**

1. That Transportation and Works be requested to review the signage located in front of Canadian Martyrs Catholic for clarity.

- 16
2. That Parking Enforcement be requested to enforce parking violations on a regular basis at Canadian Martyrs Catholic School between 8:00 a.m. to 8:30 a.m. and 3:00 p.m. to 3:30 p.m.
 3. That the Principal at Canadian Martyrs Catholic School be requested to consider the following:
 - a. Send out information to parents on rules and practices of the Kiss & Ride Program.
 - b. Ensure staff monitoring the Kiss & Ride area are wearing safety vests and if more vests are required, that the Principal contact the Traffic Safety Council Legislative Coordinator to request more vests.
 - c. Close off the school parking lot at dismissal time so that vehicles cannot enter the parking lot area to pick up their child.
 - d. Close off Kiss and Ride entrance once the bell has rung so that parents will be forced to either arrive on time or park their car off of school property and walk their child inside.
 4. That the Dufferin-Peel Catholic School Board be requested to remove the markings of two parking spots so that the through lane for the Kiss and Ride is not blocked.

Approved (E. Lethbridge)
Recommendation - TSC-0065-2014

9. Parking Enforcement in School Zones Month of February 2014

Councillor S. McFadden acknowledged the Parking Enforcement staff for the great work they have done in the school zones.

RECOMMENDATION

That the report from the Manager of Parking Enforcement with respect to parking enforcement in school zones for the month of February 2014 be received for information.

Received (Councillor S. McFadden)
Recommendation - TSC-0066-2014

OTHER BUSINESS

Dan Suess, Citizen Member, noted that a working group should be established to review the guidelines and criteria for crossing guards at middle schools. Further, he advised that he would like to take the lead and would like to work with a minimum of three Traffic Safety Council members on this matter. Those who expressed an interest in participating in this working group are, Councillor Sue McFadden, Sheelagh Duffin, Supervisor, Crossing Guards, and Sushil Kumra, Citizen Member.

RECOMMENDATION

That a working group be established to review guidelines and criteria for crossing guards at middle schools and that the working group provide a preliminary report to the Traffic Safety Council, at its meeting in April 23, 2014, and provide a final report to the Traffic Safety Council at its May 28, 2014 meeting.

Received (Councillor S. McFadden)

Recommendation - TSC-0067-2014

Louise Goegan, Citizen Member advised that she received an email from a staff member of Peel Regional Police regarding collaborating on a video. Anna Abbruscato, Ward 4 Trustee, Dufferin-Peel Catholic School Board advised that the Dufferin-Peel Catholic School Board is currently working on a video. It was also noted that the Health & Safety representative from the Peel District School Board advised that they too are working on creating a video(s). Ms. Goegan advised she would respond to the email that the Traffic Safety Council would participate in the video.

Received (L. Goegan)

Date of Next Meeting – April 23, 2014

ADJOURNMENT – 6:03 p.m.

Site Inspection Report



Traffic Safety Council
APR 23 2014

Corporate Services
Office of the City Clerk

Site	
School: Blessed John XXIII Catholic Elementary School	Address: 915 McBride Avenue Mississauga ON L5C 1M1
School Times: 9:00 AM 3:30 PM	Student Population: 200
No. of School Buses: 0	
School:	Address:
School Times:	Student Population:
No. of School Buses:	

Location: (Please identify the location with reference to nearest intersection, indicate nearest school and address)			
915 McBride in front of Blessed John XXIII			
Date of Inspection: 2014 04 02	Inspection Time: 8:30 AM 3:30 PM	Requested By: Parent	
Prepared By: D. Suess	Request For: Review Traffic congestion @ school & road		

Observers			
File Number: RT.10	File Number: RT.10	Ward:	
Observed By: D. Suess	<input checked="" type="checkbox"/> AM	<input type="checkbox"/> PM	<input type="checkbox"/> AM & PM
Observed By: D. Yaunan	<input type="checkbox"/> AM	<input type="checkbox"/> PM	<input checked="" type="checkbox"/> AM & PM
Observed By: S. Duffin	<input type="checkbox"/> AM	<input type="checkbox"/> PM	<input checked="" type="checkbox"/> AM & PM
Observed By: A. Syed	<input type="checkbox"/> AM	<input checked="" type="checkbox"/> PM	<input type="checkbox"/> AM & PM
Observed By:	<input type="checkbox"/> AM	<input type="checkbox"/> PM	<input type="checkbox"/> AM & PM
Observed By:	<input type="checkbox"/> AM	<input type="checkbox"/> PM	<input type="checkbox"/> AM & PM

Details			
Weather Conditions:	AM: <input checked="" type="checkbox"/> Dry <input checked="" type="checkbox"/> Sunny <input type="checkbox"/> Rain <input type="checkbox"/> Snow	Other: +2C	
	PM: <input checked="" type="checkbox"/> Dry <input checked="" type="checkbox"/> Sunny <input type="checkbox"/> Rain <input type="checkbox"/> Snow	Other: +6C	
Type of Crossing:	<input type="checkbox"/> 4 Way Intersection <input type="checkbox"/> 3 Way Intersection	<input type="checkbox"/> Midblock (i.e., not an intersection) N/A	
Type of Control:	<input type="checkbox"/> Traffic Lights <input type="checkbox"/> Yield Signs	<input type="checkbox"/> No Control N/A	
	<input type="checkbox"/> Stop Signs (Traffic is stopped on one street only)	<input type="checkbox"/> All Way Stop (Traffic is stopped in all directions)	

Site Conditions			
School Signs:	<input checked="" type="checkbox"/> School Area Signs <input checked="" type="checkbox"/> School Crossing Signs	<input checked="" type="checkbox"/> Parking/Stopping Prohibition	
Posted Speed Limit:	<input checked="" type="checkbox"/> 40 km/hr <input type="checkbox"/> 50 km/h <input type="checkbox"/> 60 km/hr	Other:	
Visibility of Crossing Pedestrians:	<input type="checkbox"/> Poor <input type="checkbox"/> Fair <input checked="" type="checkbox"/> Good	Comments:	
Sight Obstructions:	<input type="checkbox"/> Hedges <input type="checkbox"/> Trees <input type="checkbox"/> Fences	<input type="checkbox"/> Bus Shelter	
	<input type="checkbox"/> Newspaper Boxes <input type="checkbox"/> Other (Specify):		
Road Grade:	<input checked="" type="checkbox"/> Flat <input type="checkbox"/> Incline <input type="checkbox"/> Decline		
Road Geometrics:	<input type="checkbox"/> Straight <input checked="" type="checkbox"/> Curved	Comments:	
Road Width:	feet/metres	Curb to Curb: feet/metres	Curb to Median: feet/metres N/A
Road Conditions:	AM: <input checked="" type="checkbox"/> Dry <input type="checkbox"/> Wet <input type="checkbox"/> Snow Covered	<input type="checkbox"/> Ice	
	PM: <input type="checkbox"/> Dry <input type="checkbox"/> Wet <input type="checkbox"/> Snow Covered	<input type="checkbox"/> Ice	
Sidewalks:	<input type="checkbox"/> Not Present <input checked="" type="checkbox"/> North <input checked="" type="checkbox"/> South	<input type="checkbox"/> East <input type="checkbox"/> West	
Proximity to School:	<input checked="" type="checkbox"/> In Front of <input type="checkbox"/> Within feet/metres		
Route Survey:	<input type="checkbox"/> Shopping Area <input type="checkbox"/> Construction <input type="checkbox"/> Driveway	<input type="checkbox"/> Parked Vehicle(s)	
	<input type="checkbox"/> Transit Bus Stop <input type="checkbox"/> Underpass Within feet/metres	Other (specify):	
Comments / Conflicts: Principal: Henrietta Peroni 905 279 9478			

2a

Crossing Guard Warrant Survey

Location: _____

☐ Safe Gap Time

Safe Gap Time Calculation (if applicable): $\left(\frac{W}{3.5} + 4 \right)$ _____ = sec.

☐ Signalized Intersection turning traffic count

Morning Intervals

Time (AM)	# of Peds	# of Conflicts	Gaps	# of Gaps
7:45 - 7:50				
7:50 - 7:55				
7:55 - 8:00				
8:00 - 8:05				
8:05 - 8:10				
8:10 - 8:15				
8:15 - 8:20				
8:20 - 8:25				
8:25 - 8:30				
8:30 - 8:35				
8:35 - 8:40				
8:40 - 8:45				
8:45 - 8:50				
8:50 - 8:55				
8:55 - 9:00				

Afternoon Intervals

Time (PM)	# of Peds	# of Conflicts	Gaps	# of Gaps
2:45 - 2:50				
2:50 - 2:55				
2:55 - 3:00				
3:00 - 3:05				
3:05 - 3:10				
3:10 - 3:15				
3:15 - 3:20				
3:20 - 3:25				
3:25 - 3:30				
3:30 - 3:35				
3:35 - 3:40				
3:40 - 3:45				
3:45 - 3:50				
3:50 - 3:55				
3:55 - 4:00				

Recommendations

- 1) T & W review signage in front of the school
- 2) That parking enforcement be requested to enforce no parking once signage in place.

Observations

Volume of Traffic (see Intersection Plan):

AM: ☐ Heavy ☐ Light ☐ Intermittant PM: ☐ Heavy ☐ Light ☐ Intermittant

Number of Crossing Pedestrians:

AM: North ☐ East ☐ South ☐ West ☐ PM: North ☐ East ☐ South ☐ West ☐

Turning Traffic:

AM: ☐ Heavy ☐ Light ☐ Intermittant PM: ☐ Heavy ☐ Light ☐ Intermittant

Additional Comments/Conflicts

No school buses used at this school

Parking area used well

Traffic flow @school very smooth

Kiss & Ride not supervised by staff. Runs smoothly in AM and at dismissal time.

Spoke to the principal and she advised that she had had the snow that was blocking the 6 parking spots moved to the boulevard in front of the school(per original parent concern)

Additional Recommendations

2c

Site Inspection Report



Corporate Services
Office of the City Clerk

Site	
School: Blessed John XXIII Catholic Elementary School	Address: 915 McBride Avenue Mississauga ON L5C 1M1
School Times: 9:00 AM 3:30 PM	Student Population: 200
No. of School Buses: 0	
School:	Address:
School Times:	Student Population:
No. of School Buses:	

Location: (Please identify the location with reference to nearest intersection. Indicate nearest school and address)			
915 McBride in front of Blessed John XXIII			
Date of Inspection: 2014 04 03	Inspection Time: 8:30 AM 3:30 PM	Requested By: Parent	
Prepared By: D. Suess	Request For: Review Traffic congestion @ school & road		

Observers			
File Number: RT.10	File Number: RT.10	Ward:	
Observed By: D. Suess	<input checked="" type="checkbox"/> AM <input type="checkbox"/> PM <input type="checkbox"/> AM & PM		
Observed By: D. Yaunan	<input type="checkbox"/> AM <input type="checkbox"/> PM <input checked="" type="checkbox"/> AM & PM		
Observed By: S. Duffin	<input type="checkbox"/> AM <input type="checkbox"/> PM <input checked="" type="checkbox"/> AM & PM		
Observed By: A. Syed	<input type="checkbox"/> AM <input checked="" type="checkbox"/> PM <input type="checkbox"/> AM & PM		
Observed By:	<input type="checkbox"/> AM <input type="checkbox"/> PM <input type="checkbox"/> AM & PM		
Observed By:	<input type="checkbox"/> AM <input type="checkbox"/> PM <input type="checkbox"/> AM & PM		

Details			
Weather Conditions:	AM: <input checked="" type="checkbox"/> Dry <input checked="" type="checkbox"/> Sunny <input type="checkbox"/> Rain <input type="checkbox"/> Snow <input type="checkbox"/> Other: +2C		
	PM: <input checked="" type="checkbox"/> Dry <input checked="" type="checkbox"/> Sunny <input type="checkbox"/> Rain <input type="checkbox"/> Snow <input type="checkbox"/> Other: +6C		
Type of Crossing:	<input type="checkbox"/> 4 Way Intersection <input type="checkbox"/> 3 Way Intersection <input type="checkbox"/> Midblock (i.e., not an intersection)	N/A	
Type of Control:	<input type="checkbox"/> Traffic Lights <input type="checkbox"/> Yield Signs <input type="checkbox"/> No Control	N/A	
	<input type="checkbox"/> Stop Signs (Traffic is stopped on one street only) <input type="checkbox"/> All Way Stop (Traffic is stopped in all directions)		

Site Conditions			
School Signs:	<input checked="" type="checkbox"/> School Area Signs <input checked="" type="checkbox"/> School Crossing Signs <input checked="" type="checkbox"/> Parking/Stopping Prohibition		
Posted Speed Limit:	<input checked="" type="checkbox"/> 40 km/hr <input type="checkbox"/> 50 km/h <input type="checkbox"/> 60 km/hr <input type="checkbox"/> Other:		
Visibility of Crossing Pedestrians:	<input type="checkbox"/> Poor <input type="checkbox"/> Fair <input checked="" type="checkbox"/> Good	Comments:	
Sight Obstructions:	<input type="checkbox"/> Hedges <input type="checkbox"/> Trees <input type="checkbox"/> Fences <input type="checkbox"/> Bus Shelter		
	<input type="checkbox"/> Newspaper Boxes <input type="checkbox"/> Other (Specify):		
Road Grade:	<input checked="" type="checkbox"/> Flat <input type="checkbox"/> Incline <input type="checkbox"/> Decline		
Road Geometrics:	<input type="checkbox"/> Straight <input checked="" type="checkbox"/> Curved	Comments:	
Road Width:	feet/metres Curb to Curb: feet/metres Curb to Median: feet/metres	N/A	
Road Conditions:	AM: <input checked="" type="checkbox"/> Dry <input type="checkbox"/> Wet <input type="checkbox"/> Snow Covered <input type="checkbox"/> Ice		
	PM: <input type="checkbox"/> Dry <input type="checkbox"/> Wet <input type="checkbox"/> Snow Covered <input type="checkbox"/> Ice		
Sidewalks:	<input type="checkbox"/> Not Present <input checked="" type="checkbox"/> North <input checked="" type="checkbox"/> South <input type="checkbox"/> East <input type="checkbox"/> West		
Proximity to School:	<input checked="" type="checkbox"/> In Front of <input type="checkbox"/> Within feet/metres		
Route Survey:	<input type="checkbox"/> Shopping Area <input type="checkbox"/> Construction <input type="checkbox"/> Driveway <input type="checkbox"/> Parked Vehicle(s)		
	<input type="checkbox"/> Transit Bus Stop <input type="checkbox"/> Underpass Within feet/metres Other (specify):		
Comments / Conflicts:	Principal: Henrietta Peroni 905 279 9478		

Crossing Guard Warrant SurveyLocation: ☐ Safe Gap TimeSafe Gap Time Calculation (if applicable): $\left(\frac{W}{3.5} + 4 \right)$ = sec.☐ Signalized Intersection turning traffic count**Morning Intervals**

Time (AM)	# of Peds	# of Conflicts	Gaps	# of Gaps
7:45 - 7:50	<input type="text"/>	<input type="text"/>	<input type="text"/>	<input type="text"/>
7:50 - 7:55	<input type="text"/>	<input type="text"/>	<input type="text"/>	<input type="text"/>
7:55 - 8:00	<input type="text"/>	<input type="text"/>	<input type="text"/>	<input type="text"/>
8:00 - 8:05	<input type="text"/>	<input type="text"/>	<input type="text"/>	<input type="text"/>
8:05 - 8:10	<input type="text"/>	<input type="text"/>	<input type="text"/>	<input type="text"/>
8:10 - 8:15	<input type="text"/>	<input type="text"/>	<input type="text"/>	<input type="text"/>
8:15 - 8:20	<input type="text"/>	<input type="text"/>	<input type="text"/>	<input type="text"/>
8:20 - 8:25	<input type="text"/>	<input type="text"/>	<input type="text"/>	<input type="text"/>
8:25 - 8:30	<input type="text"/>	<input type="text"/>	<input type="text"/>	<input type="text"/>
8:30 - 8:35	<input type="text"/>	<input type="text"/>	<input type="text"/>	<input type="text"/>
8:35 - 8:40	<input type="text"/>	<input type="text"/>	<input type="text"/>	<input type="text"/>
8:40 - 8:45	<input type="text"/>	<input type="text"/>	<input type="text"/>	<input type="text"/>
8:45 - 8:50	<input type="text"/>	<input type="text"/>	<input type="text"/>	<input type="text"/>
8:50 - 8:55	<input type="text"/>	<input type="text"/>	<input type="text"/>	<input type="text"/>
8:55 - 9:00	<input type="text"/>	<input type="text"/>	<input type="text"/>	<input type="text"/>

Afternoon Intervals

Time (PM)	# of Peds	# of Conflicts	Gaps	# of Gaps
2:45 - 2:50	<input type="text"/>	<input type="text"/>	<input type="text"/>	<input type="text"/>
2:50 - 2:55	<input type="text"/>	<input type="text"/>	<input type="text"/>	<input type="text"/>
2:55 - 3:00	<input type="text"/>	<input type="text"/>	<input type="text"/>	<input type="text"/>
3:00 - 3:05	<input type="text"/>	<input type="text"/>	<input type="text"/>	<input type="text"/>
3:05 - 3:10	<input type="text"/>	<input type="text"/>	<input type="text"/>	<input type="text"/>
3:10 - 3:15	<input type="text"/>	<input type="text"/>	<input type="text"/>	<input type="text"/>
3:15 - 3:20	<input type="text"/>	<input type="text"/>	<input type="text"/>	<input type="text"/>
3:20 - 3:25	<input type="text"/>	<input type="text"/>	<input type="text"/>	<input type="text"/>
3:25 - 3:30	<input type="text"/>	<input type="text"/>	<input type="text"/>	<input type="text"/>
3:30 - 3:35	<input type="text"/>	<input type="text"/>	<input type="text"/>	<input type="text"/>
3:35 - 3:40	<input type="text"/>	<input type="text"/>	<input type="text"/>	<input type="text"/>
3:40 - 3:45	<input type="text"/>	<input type="text"/>	<input type="text"/>	<input type="text"/>
3:45 - 3:50	<input type="text"/>	<input type="text"/>	<input type="text"/>	<input type="text"/>
3:50 - 3:55	<input type="text"/>	<input type="text"/>	<input type="text"/>	<input type="text"/>
3:55 - 4:00	<input type="text"/>	<input type="text"/>	<input type="text"/>	<input type="text"/>

Recommendations

- 1) T & W review signage in front of the school
- 2) That parking enforcement be requested to enforce no parking once signage in place.

Observations

Volume of Traffic (see Intersection Plan):

AM: ☐ Heavy ☐ Light ☐ Intermittant PM: ☐ Heavy ☐ Light ☐ Intermittant

Number of Crossing Pedestrians:

AM: North East South West PM: North East South West

Turning Traffic:

AM: ☐ Heavy ☐ Light ☐ Intermittant PM: ☐ Heavy ☐ Light ☐ Intermittant

Additional Comments/Conflicts

No school buses used at this school

Parking area used well

Traffic flow @school very smooth

Kiss & Ride not supervised by staff. Runs smoothly in AM and at dismissal time.

Spoke to the principal and she advised that she had had the snow that was blocking the 6 parking spots moved to the boulevard in front of the school(per original parent concern)

Additional Recommendations

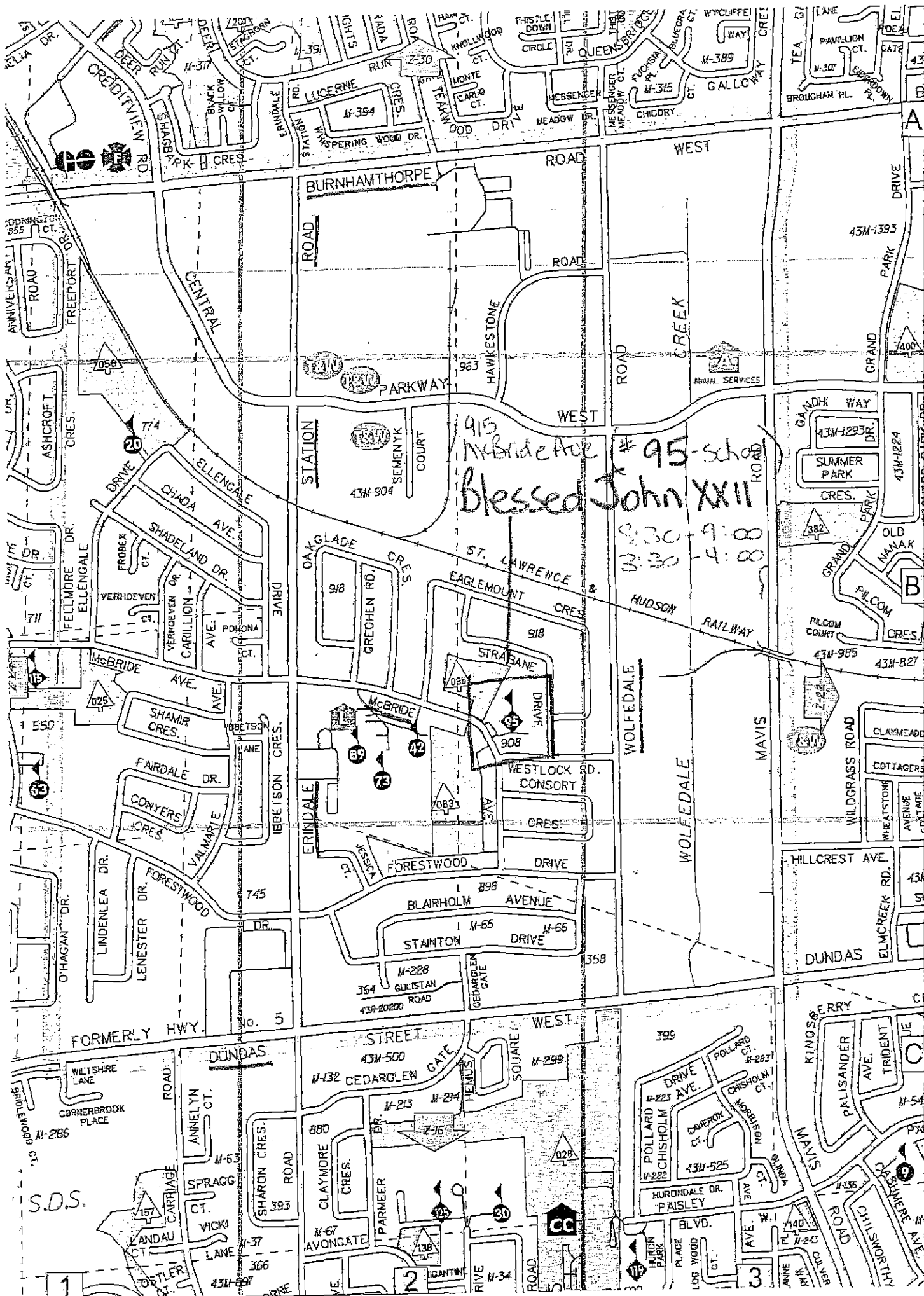

915 McBride Ave #95-school
Blessed John XXII
8:30-9:00
3:30-4:00

S.D.S.

29

Angie Melo
Legislative Coordinator
Legislative Services Division
Email: angie.melo@mississauga.ca
T:905-615-3200 ext. 5423 / F:905-615-3374



From: Ron Starr
Sent: 2014/03/06 3:32 PM
To: Angie Melo
Subject: FW: Safety concerns at Blessed John XX111 Catholic School

Dear Angie:

We were wondering if this matter was raised at Traffic Safety and if there was any decisions made with respects to this.

Any info that you can provide will be greatly appreciated.

Thank you
Natalie J.
Administrative Assistant Ward 6
905-896-5600

From: Sandra V [REDACTED]
Sent: 2014/03/06 1:56 PM
To: Ron Starr
Subject: Safety concerns at Blessed John XX111 Catholic School

Good Afternoon Mr. Starr,

I'm not sure if you can help me; if you can't could you advise as to whom I should be directing my concerns to?

I have three children at Blessed John XX111 and I am very concerned for the safety of my children as well as other students.

We have raised our concerns to the principal of the school, and unfortunately she has not offered any real solutions, she has told me however that my oldest son was almost hit by a car a few weeks ago, that's something you never want to hear.

As you can see from the attached picture the main concern is the build up of snow at the entrance of the school parking lot, which incidently, has eliminated at least six parking spots, and the over flow on McBride Avenue is unbelievable. Why any snow removal contractor with common sense would plow snow at the entrance of driveway is beyond me, this has made visibility very poor, and students have to walk around this snow mound to have access to the school.

I believe there is one simple solution, call the snow removal contractor and politely ask them to remove this snow and plow it to the back of the school parking lot, but for some reason this cant be done?

I look forward to hearing from you, and getting some feedback on how we can address this problem, because quite honestly driving my kids to school or picking them up has become a nightmare.

Site Inspection Report



Traffic Safety Council
APR 23 2014

Corporate Services
Office of the City Clerk

Site	
School: St. Hilary Catholic School	Address: 5070 Fairwind Dr Mississauga ON L5R2N4
School Times: 9:00 AM 3:30 PM	Student Population: 276
No. of School Buses: 1S1L (1 Short, 1 Long)	
School:	Address:
School Times:	Student Population:
No. of School Buses:	

Location: (Please identify the location with reference to nearest intersection. Indicate nearest school and address)
5070 Fairwind Dr in front of St. Hilary CS

Date of Inspection: 2014 04 03 Inspection Time: 8:30 AM 3:00 PM Requested By: TSC member D. Brennan

Prepared By: D. Suess Request For: Safety & Kiss & Ride Reviews

Observers

File Number: RT.10	File Number: RT.10	Ward:
Observed By: L. Goegan	<input checked="" type="checkbox"/> AM <input type="checkbox"/> PM <input type="checkbox"/> AM & PM	
Observed By: D. Suess	<input checked="" type="checkbox"/> AM <input type="checkbox"/> PM <input type="checkbox"/> AM & PM	
Observed By: A. Liya	<input type="checkbox"/> AM <input type="checkbox"/> PM <input checked="" type="checkbox"/> AM & PM	
Observed By: S. Duffin	<input type="checkbox"/> AM <input type="checkbox"/> PM <input checked="" type="checkbox"/> AM & PM	
Observed By: A. Syed	<input type="checkbox"/> AM <input checked="" type="checkbox"/> PM <input type="checkbox"/> AM & PM	
Observed By: D. Brennan	<input type="checkbox"/> AM <input checked="" type="checkbox"/> PM <input type="checkbox"/> AM & PM	

Details

Weather Conditions: AM: ☒ Dry ☒ Sunny ☐ Rain ☐ Snow ☐ Other: +2C
PM: ☒ Dry ☐ Sunny ☐ Rain ☐ Snow ☐ Other: +3C

Type of Crossing: ☐ 4 Way Intersection ☐ 3 Way Intersection ☐ Midblock (i.e., not an intersection)

Type of Control: ☐ Traffic Lights ☐ Yield Signs ☒ No Control
☐ Stop Signs (Traffic is stopped on one street only) ☐ All Way Stop (Traffic is stopped in all directions)

Site Conditions

School Signs: ☒ School Area Signs ☐ School Crossing Signs ☒ Parking/Stopping Prohibition

Posted Speed Limit: ☒ 40 km/hr ☐ 50 km/h ☐ 60 km/hr ☐ Other:

Visibility of Crossing Pedestrians: ☐ Poor ☐ Fair ☒ Good Comments:

Sight Obstructions: ☐ Hedges ☐ Trees ☐ Fences ☐ Bus Shelter
☐ Newspaper Boxes ☐ Other (Specify):

Road Grade: ☒ Flat ☐ Incline ☐ Decline

Road Geometrics: ☐ Straight ☒ Curved Comments:

Road Width: feet/metres Curb to Curb: feet/metres Curb to Median: feet/metres

Road Conditions: AM: ☒ Dry ☐ Wet ☐ Snow Covered ☐ Ice
PM: ☒ Dry ☐ Wet ☐ Snow Covered ☐ Ice

Sidewalks: ☐ Not Present ☐ North ☐ South ☒ East (partial) ☒ West

Proximity to School: ☒ In Front of ☐ Within feet/metres

Route Survey: ☒ Shopping Area ☐ Construction ☐ Driveway ☐ Parked Vehicle(s)
☐ Transit Bus Stop ☐ Underpass Within feet/metres Other (specify):

Comments / Conflicts: Principal: Teresa Loftus 905 568 0056

3a

Crossing Guard Warrant Survey

Location: _____

☐ Safe Gap Time

Safe Gap Time Calculation (if applicable): $\left(\frac{W}{3.5} + 4 \right)$ _____ = sec.

☐ Signalized Intersection turning traffic count

Morning Intervals

Time (AM)	# of Peds	# of Conflicts	Gaps	# of Gaps
7:45 - 7:50				
7:50 - 7:55				
7:55 - 8:00				
8:00 - 8:05				
8:05 - 8:10				
8:10 - 8:15				
8:15 - 8:20				
8:20 - 8:25				
8:25 - 8:30				
8:30 - 8:35				
8:35 - 8:40				
8:40 - 8:45				
8:45 - 8:50				
8:50 - 8:55				
8:55 - 9:00				

Afternoon Intervals

Time (PM)	# of Peds	# of Conflicts	Gaps	# of Gaps
2:45 - 2:50				
2:50 - 2:55				
2:55 - 3:00				
3:00 - 3:05				
3:05 - 3:10				
3:10 - 3:15				
3:15 - 3:20				
3:20 - 3:25				
3:25 - 3:30				
3:30 - 3:35				
3:35 - 3:40				
3:40 - 3:45				
3:45 - 3:50				
3:50 - 3:55				
3:55 - 4:00				

Recommendations

- 1) That T&W review signage in front of the school and extend the No Stopping Zone on the east side of Fairwind Drive South to the school boundary
- 2) Request parking enforcement at the PM dismissal once the signage is in place.

Observations

Volumes of Traffic (see Intersection Plan):

AM: ☐ Heavy ☐ Light ☐ Intermittant PM: ☐ Heavy ☐ Light ☐ Intermittant

Number of Crossing Pedestrians:

AM: North ☐ East ☐ South ☐ West ☐ PM: North ☐ East ☐ South ☐ West ☐

Turning Traffic:

AM: ☐ Heavy ☐ Light ☐ Intermittant PM: ☐ Heavy ☐ Light ☐ Intermittant

Additional Comments/Conflicts

8:30 - 8:40 very light traffic/quiet

8:40 - 8:50 Moderate traffic in conjunction with traffic lights at Eglinton Avenue.

8:50 - 9:00 Moderate

AM - no conflicts. Traffic fluid and speed seems relative to limit. Peter Westbrook conducted a Kiss & Ride Review

PM - vehicles parked in No stopping/No parking zones on street. Vehicles lined up on property starting more than 30 minutes prior to dismissal. Dismissal reasonably orderly despite illegally stopped vehicles. No Parking/No Stopping in effect on west side(school side) of Fairwind Drive to provide sight lines for vehicles exiting the Kiss & Ride due to the curvilinear nature of the road in front of the school.

Additional Recommendations

3c

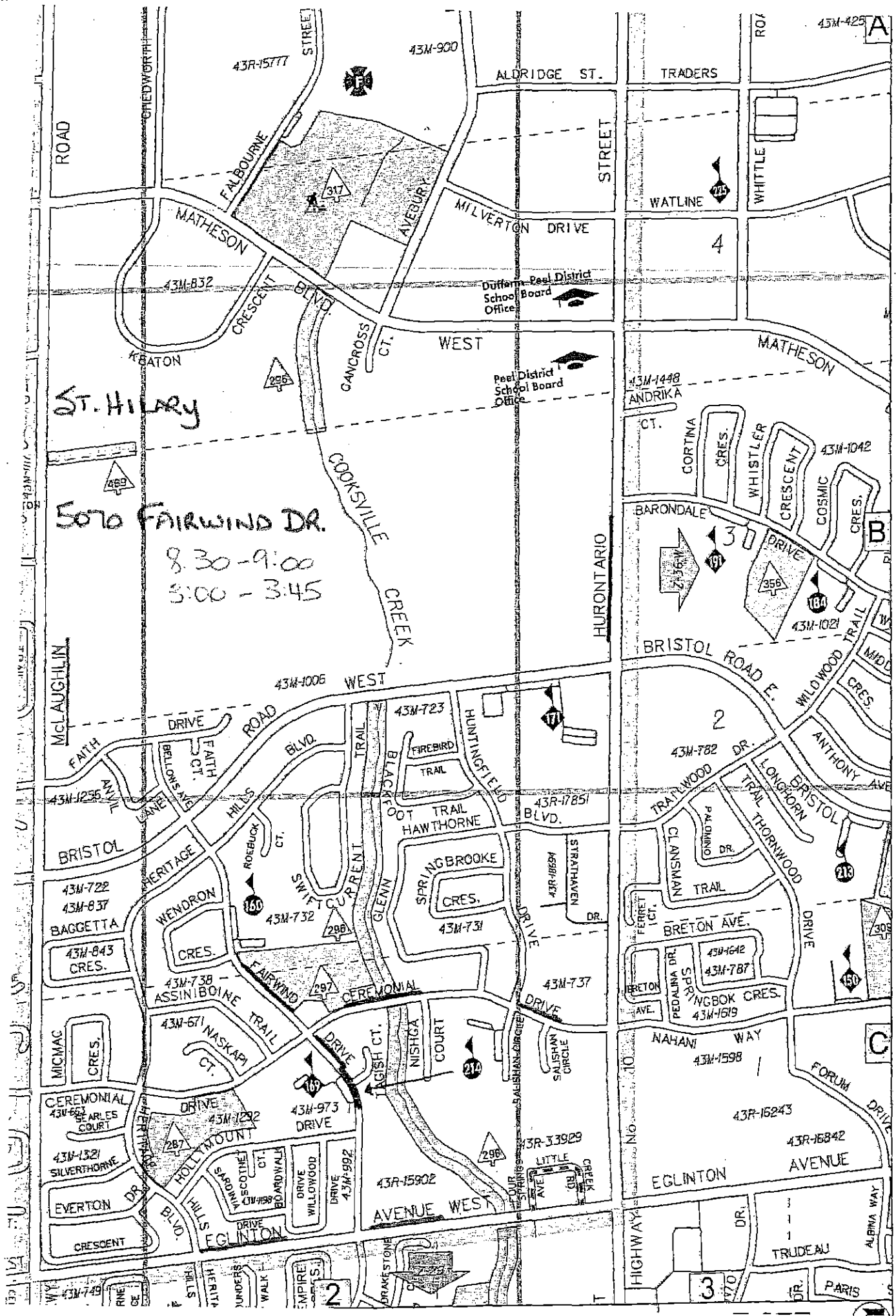

37E
C2

Heather McGuire

From: Heather McGuire
Sent: 2014/01/21 12:55 PM
To: 'Brennan, David'
Subject: RE: St. Hilary (Ward 5)

Hi David,

Thanks for emailing me. I have spoken with Sheelagh and we will be scheduling a safety review in front of St. Hilary.

Heather

-----Original Message-----

From: Brennan, David [REDACTED]
Sent: 2014/01/20 8:43 PM
To: Heather McGuire
Subject: St. Hilary (Ward 5)

Hi Heather,

I am still new to the whole traffic safety committee, and what certain inspections are called, so please bear with me.

My son attends the YMCA daycare at St. Hilary elementary on Fairwind Drive in Ward 5. I am concerned regarding safety at the school in terms of traffic. Many cars are parked illegally along Fairwind which is resulting from increased traffic congestion, as well as children not crossing with the guard further down. Many cars are also idling in the Kiss N' Ride or parking altogether while they take their child into the school. I'm not sure how bad it is earlier, but between 830-9am & 3-330pm, it is horrific to try and drive along Fairwind or enter that parking lot.

Just thought I'd pass that information along.

See you Wednesday.

David Brennan [REDACTED]
[REDACTED]
[REDACTED]
[REDACTED]
[REDACTED]
[REDACTED]
[REDACTED]

Site Inspection Report



Traffic Safety Council
APR 23 2014

Corporate Services
Office of the City Clerk

Site

School:	St. Herbert Catholic School	Address:	5180 Falingbrook Dr. Mississauga ON L5V 2C8	School Times:	9:00 AM	3:30 PM
				Student Population:	317	
				No. of School Buses:	**2	
School:		Address:		School Times:		
				Student Population:		
				No. of School Buses:		

Location: (Please identify the location with reference to nearest intersection. Indicate nearest school and address)

Lismic Blvd & Dream Crest Rd. in front of Rick Hansen SS

Date of Inspection:	2014	04	09	Inspection Time:	8:25 AM	3:30 PM	Requested By:	parents @ St. Herbert CS
---------------------	------	----	----	------------------	---------	---------	---------------	--------------------------

Prepared By:	D. Suess	Request For:	additional time to existing guard for Sherwood Mills
--------------	----------	--------------	--

Observers

File Number:	RT.10	File Number:	RT.10	Ward:		
Observed By:	D. Suess			<input type="checkbox"/> AM	<input type="checkbox"/> PM	<input checked="" type="checkbox"/> AM & PM
Observed By:	A. Liya			<input type="checkbox"/> AM	<input type="checkbox"/> PM	<input checked="" type="checkbox"/> AM & PM
Observed By:	S. Duffin			<input type="checkbox"/> AM	<input type="checkbox"/> PM	<input checked="" type="checkbox"/> AM & PM
Observed By:	A. Syed			<input type="checkbox"/> AM	<input checked="" type="checkbox"/> PM	<input type="checkbox"/> AM & PM
Observed By:				<input type="checkbox"/> AM	<input type="checkbox"/> PM	<input type="checkbox"/> AM & PM
Observed By:				<input type="checkbox"/> AM	<input type="checkbox"/> PM	<input type="checkbox"/> AM & PM

Details

Weather Conditions:	AM:	<input checked="" type="checkbox"/> Dry	<input checked="" type="checkbox"/> Sunny	<input type="checkbox"/> Rain	<input type="checkbox"/> Snow	<input type="checkbox"/> Other:	+5C
	PM:	<input checked="" type="checkbox"/> Dry	<input checked="" type="checkbox"/> Sunny	<input type="checkbox"/> Rain	<input type="checkbox"/> Snow	<input type="checkbox"/> Other:	+10C
Type of Crossing:	<input type="checkbox"/> 4 Way Intersection	<input checked="" type="checkbox"/> 3 Way Intersection	<input type="checkbox"/> Midblock (i.e., not an intersection)				
Type of Control:	<input type="checkbox"/> Traffic Lights	<input type="checkbox"/> Yield Signs	<input type="checkbox"/> No Control				
	<input checked="" type="checkbox"/> Stop Signs (Traffic is stopped on one street only)	<input type="checkbox"/> All Way Stop (Traffic is stopped in all directions)					

Site Conditions

School Signs:	<input checked="" type="checkbox"/> School Area Signs	<input checked="" type="checkbox"/> School Crossing Signs	<input checked="" type="checkbox"/> Parking/Stopping Prohibition
Posted Speed Limit:	<input checked="" type="checkbox"/> 40 km/hr	<input type="checkbox"/> 50 km/h	<input type="checkbox"/> 60 km/hr
Visibility of Crossing Pedestrians:	<input type="checkbox"/> Poor	<input type="checkbox"/> Fair	<input checked="" type="checkbox"/> Good
Sight Obstructions:	<input type="checkbox"/> Hedges	<input type="checkbox"/> Trees	<input type="checkbox"/> Fences
	<input type="checkbox"/> Newspaper Boxes	<input type="checkbox"/> Other (Specify):	Bus Shelter
Road Grade:	<input checked="" type="checkbox"/> Flat	<input type="checkbox"/> Incline	<input type="checkbox"/> Decline
Road Geometrics:	<input checked="" type="checkbox"/> Straight	<input type="checkbox"/> Curved	Comments:
Road Width:	feet/metres	Curb to Curb:	feet/metres
		Curb to Median:	feet/metres
Road Conditions:	AM:	<input checked="" type="checkbox"/> Dry	<input type="checkbox"/> Wet
	PM:	<input checked="" type="checkbox"/> Dry	<input type="checkbox"/> Wet
Sidewalks:	<input type="checkbox"/> Not Present	<input checked="" type="checkbox"/> North	<input checked="" type="checkbox"/> South
		<input checked="" type="checkbox"/> East	<input checked="" type="checkbox"/> West
Proximity to School:	<input type="checkbox"/> In Front of	<input type="checkbox"/> Within	feet/metres
Route Survey:	<input type="checkbox"/> Shopping Area	<input type="checkbox"/> Construction	<input checked="" type="checkbox"/> Driveway
	<input type="checkbox"/> Transit Bus Stop	<input type="checkbox"/> Underpass	Within feet/metres
			Parked Vehicle(s)
			Other (specify): **North Side**
Comments / Conflicts:	Principal: Darrell Puchalski 905 858 1171 **1 small bus and 1 wheelchair bus		

Crossing Guard Warrant Survey

Location: Dream Crest & Lismic in front of Rick Hansen SS

☒ Safe Gap Time

Safe Gap Time Calculation (if applicable): $\left(\frac{W}{3.5} + 4 \right)$ 17 = sec.

☐ Signalized Intersection turning traffic count

Morning Intervals

Time (AM)	# of Peds	# of Conflicts	Gaps	# of Gaps
7:45 - 7:50				
7:50 - 7:55				
7:55 - 8:00				
8:00 - 8:05				
8:05 - 8:10				
8:10 - 8:15				
8:15 - 8:20				
8:20 - 8:25				
8:25 - 8:30	100HS		NO GAPS - crossing guard almost always on crosswalk	
8:30 - 8:35	4		Not measured	
8:35 - 8:40	4+4		Not measured	
8:40 - 8:45	1+2		33, 18, 35, 25, 27, 11	6
8:45 - 8:50	0		52, 32, 18, 47, 18	7
8:50 - 8:55	2+1		40, 32, 18, 38, 23, 19	8
8:55 - 9:00				

Afternoon Intervals

Time (PM)	# of Peds	# of Conflicts	Gaps	# of Gaps
2:45 - 2:50				
2:50 - 2:55				
2:55 - 3:00				
3:00 - 3:05				
3:05 - 3:10				
3:10 - 3:15				
3:15 - 3:20				
3:20 - 3:25				
3:25 - 3:30				
3:30 - 3:35	3		23, 21, 22, 11	3
3:35 - 3:40	2		29, 32, 22, 11	3
3:40 - 3:45	3+2		18, 17, 49, 35, 36, 1	6
3:45 - 3:50	0		33, 39, 24, 28, 17, 29, 30, 20, 19, 1	10
3:50 - 3:55	0		53, 34, 35, 44, 20, 29	11
3:55 - 4:00			37, 23, 19, 39, 50, 32, 35	11

Recommendations

- 1) Warrants no met to extend the times of the crossing guard from 8:30 - 9:00 and 3:25 - 3:55 for St. Herbert CS.
- 2) Request T&W review signage north side of Dream Crest Rd. between Lismic Blvd & Cinnamon Rd.

Observations

Volume of Traffic (see Intersection Plan):

AM: ☐ Heavy ☐ Light ☐ Intermittant PM: ☐ Heavy ☐ Light ☐ Intermittant

Number of Crossing Pedestrians:

AM: North East South West 18 PM: North East South West 10

Turning Traffic:

AM: ☐ Heavy ☒ Light ☐ Intermittant PM: ☐ Heavy ☐ Light ☒ Intermittant

46

Additional Comments/Conflicts

From 8:25 - 8:30 mainly high school students crossed. There were approximately 100 of them which made it difficult to detect public school students.

Parking prohibitions in place except for Dream Crest(North Side) between Lismic & Cinnamon(signs may be missing)

Very heavy traffic on Dream Crest from 8:10 - 8:30 - High School student drop off

Intermittent volume 8:30 - 8:35

Very light volume 8:35 - 8:55

Bus stop on Dream Crest @ North East corner of Lismic

Another one on Dream Crest on the south side approximately 20 metres East of Lismic

Morning: No conflicts observed

Afternoon: No conflicts observed

Many vehicles during high school student arrival and departure times

Crossing Guard present for Sherwood Mills Public School from 8:00 - 8:30 and 2:55 - 3:25

Additional Recommendations

4.C

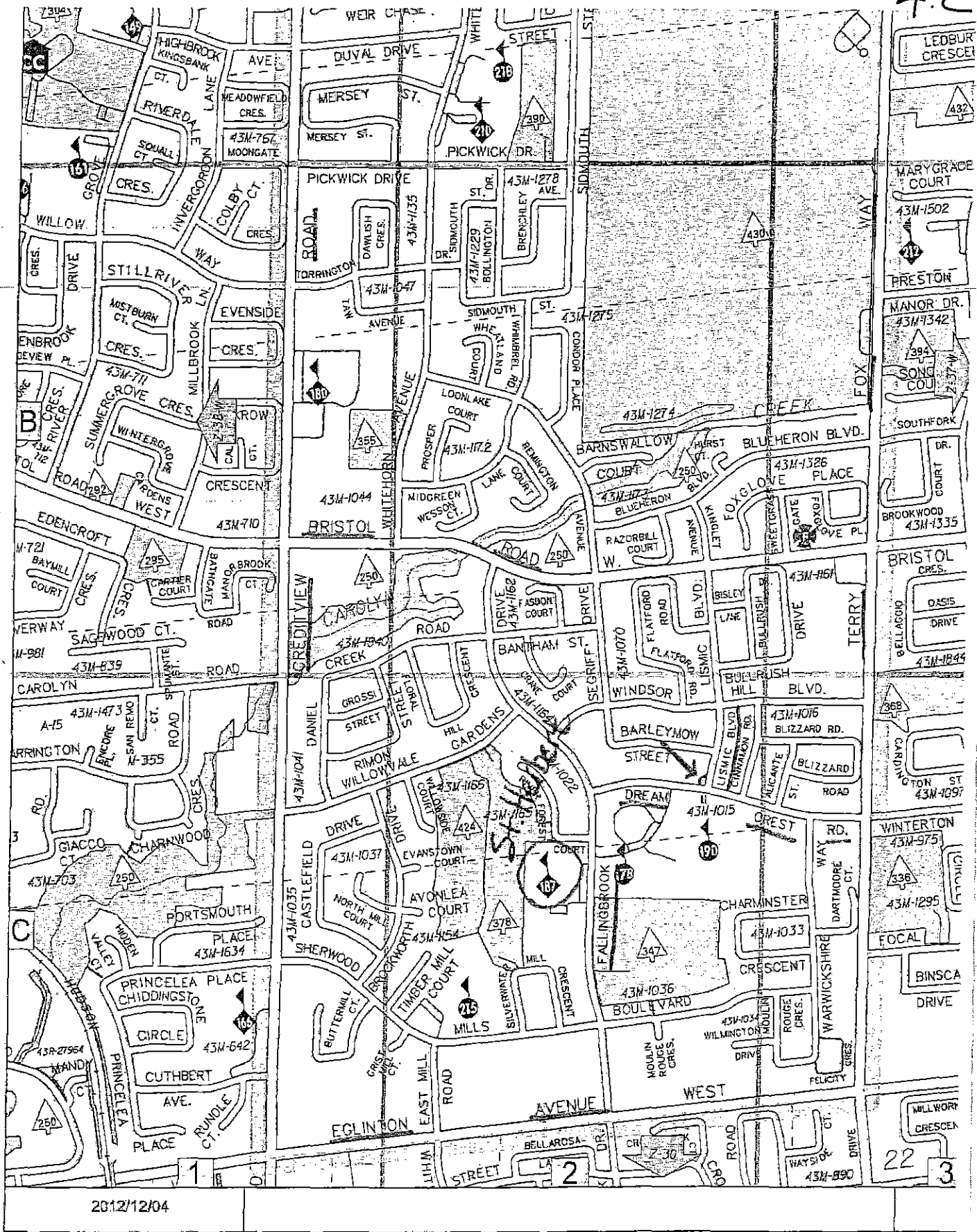

Dreamcrest Park Lismic Blvd.

8:25-8:55 + 3:30-4:00

4d

Heather McGuire

From: Sheelagh Duffin
Sent: 2014/03/19 11:27 AM
To: Heather McGuire
Cc: Angie Melo
Subject: Site Inspection Request Dream Crest Road & Lismic Boulevard

Hi Heather,

Parents have indicated to the crossing guard at St. Herbert Catholic School that they would like to see the hours of the crossing guard at Dream Crest Road and Lismic Boulevard for the students of Fallingbrook PS extended to also cover students living in the Windsor Hill area that cross there to access St. Herbert CS.

Would you kindly schedule a Site Inspection at Dream Crest Road & Lismic Boulevard at the existing school crosswalk for the students of St. Herbert CS. The times for the inspection would be 8:25 – 8:55 and 3:30 – 4:00.

Thank you.
Sheelagh

Sheelagh Duffin
City of Mississauga
Supervisor, Crossing Guards
3185 Mavis Road
Mississauga ON L5C 1T7
905 896-5167
Fax 905 896-5583

Site Inspection Report



Traffic Safety Council

APR 23 2014

Corporate Services
Office of the City Clerk

Site	
School: Ridgewood Public School	Address: 7207 Cambrett Dr Mississauga On L4T 2R3
School Times: 8:40 AM 3:00 PM	Student Population: 778
No. of School Buses: 3L1S	
School: 	Address:
School Times: AM PM	Student Population:
No. of School Buses: 	

Location: (Please identify the location with reference to nearest intersection. Indicate nearest school and address)			
Cambrett Dr. and Shallford Rd.			
Date of Inspection: 2014 04 11	Inspection Time: 8:10 AM 3:00 PM	Requested By: Principal, Balneet Singh	
Prepared By: L. Goegan	Request For: Crossing Guard		

Observers			
File Number: RT.10	File Number: RT.10	Ward: 	
Observed By: L. Goegan	<input type="checkbox"/> AM <input type="checkbox"/> PM <input checked="" type="checkbox"/> AM & PM		
Observed By: S. Duffin	<input type="checkbox"/> AM <input type="checkbox"/> PM <input checked="" type="checkbox"/> AM & PM		
Observed By: D. Yaunan	<input type="checkbox"/> AM <input type="checkbox"/> PM <input checked="" type="checkbox"/> AM & PM		
Observed By: 	<input type="checkbox"/> AM <input type="checkbox"/> PM <input type="checkbox"/> AM & PM		
Observed By: 	<input type="checkbox"/> AM <input type="checkbox"/> PM <input type="checkbox"/> AM & PM		
Observed By: 	<input type="checkbox"/> AM <input type="checkbox"/> PM <input type="checkbox"/> AM & PM		

Details			
Weather Conditions:	AM: <input checked="" type="checkbox"/> Dry <input checked="" type="checkbox"/> Sunny <input type="checkbox"/> Rain <input type="checkbox"/> Snow <input type="checkbox"/> Other: +6C		
	PM: <input checked="" type="checkbox"/> Dry <input checked="" type="checkbox"/> Sunny <input type="checkbox"/> Rain <input type="checkbox"/> Snow <input type="checkbox"/> Other: +17C		
Type of Crossing:	<input type="checkbox"/> 4 Way Intersection <input type="checkbox"/> 3 Way Intersection <input checked="" type="checkbox"/> Midblock (i.e., not an intersection)		
Type of Control:	<input type="checkbox"/> Traffic Lights <input type="checkbox"/> Yield Signs <input type="checkbox"/> No Control		
	<input checked="" type="checkbox"/> Stop Signs (Traffic is stopped on one street only) <input type="checkbox"/> All Way Stop (Traffic is stopped in all directions)		

Site Conditions			
School Signs:	<input checked="" type="checkbox"/> School Area Signs <input checked="" type="checkbox"/> School Crossing Signs <input type="checkbox"/> Parking/Stopping Prohibition		
Posted Speed Limit:	<input checked="" type="checkbox"/> 40 km/hr <input type="checkbox"/> 50 km/h <input type="checkbox"/> 60 km/hr <input type="checkbox"/> Other: 		
Visibility of Crossing Pedestrians:	<input type="checkbox"/> Poor <input type="checkbox"/> Fair <input checked="" type="checkbox"/> Good	Comments: 	
Sight Obstructions:	<input type="checkbox"/> Hedges <input type="checkbox"/> Trees <input type="checkbox"/> Fences <input type="checkbox"/> Bus Shelter		
	<input type="checkbox"/> Newspaper Boxes <input type="checkbox"/> Other (Specify): 		
Road Grade:	<input checked="" type="checkbox"/> Flat <input type="checkbox"/> Incline <input type="checkbox"/> Decline		
Road Geometrics:	<input checked="" type="checkbox"/> Straight <input type="checkbox"/> Curved	Comments: 	
Road Width:	28 feet/metres	Curb to Curb: feet/metres	Curb to Median: feet/metres
Road Conditions:	AM: <input checked="" type="checkbox"/> Dry <input type="checkbox"/> Wet <input type="checkbox"/> Snow Covered <input type="checkbox"/> Ice		
	PM: <input checked="" type="checkbox"/> Dry <input type="checkbox"/> Wet <input type="checkbox"/> Snow Covered <input type="checkbox"/> Ice		
Sidewalks:	<input type="checkbox"/> Not Present <input checked="" type="checkbox"/> North <input checked="" type="checkbox"/> South <input checked="" type="checkbox"/> East <input checked="" type="checkbox"/> West		
Proximity to School:	<input checked="" type="checkbox"/> In Front of <input type="checkbox"/> Within feet/metres		
Route Survey:	<input type="checkbox"/> Shopping Area <input type="checkbox"/> Construction <input type="checkbox"/> Driveway <input type="checkbox"/> Parked Vehicle(s)		
	<input type="checkbox"/> Transit Bus Stop <input type="checkbox"/> Underpass Within feet/metres	Other (specify): 	
Comments / Conflicts: Principal: Balneet Singh 905 677 1350 Most traffic generated by parents of students. A number of students crossed to parents' vehicles			

Crossing Guard Warrant Survey

Location: Cambrett & Shallford

☒ Safe Gap Time

Safe Gap Time Calculation (if applicable): $\left(\frac{W}{3.5} + 4 \right)$ 12 = sec.

☐ Signalized Intersection turning traffic count

Morning Intervals

Time (AM)	# of Peds	# of Conflicts	Gaps	# of Gaps
7:45 - 7:50				
7:50 - 7:55				
7:55 - 8:00				
8:00 - 8:05				
8:05 - 8:10			40,31,68,I,16,III	10
8:10 - 8:15			40,54,I,23,13,14,IIII,16,II,28,I,13,16,I,25	17
8:15 - 8:20	9		23,64,18,I,14,34,IIIII,I,17,IIII,14	12
8:20 - 8:25	14		25,II,14,I,58,I,12,II,21,I,12,I,32,II,19,IIIII	13
8:25 - 8:30	10		IIII,18,II,16,IIII,IIII,I,35,IIIIIII,17,IIII,15	7
8:30 - 8:35	2		IIII,19,IIIII,18,III,32,II,16,IIIIIII	5
8:35 - 8:40	1		22,II,12,IIIIIII,15,I,18,13,IIII,II	5
8:40 - 8:45				
8:45 - 8:50			23 students who were walkers and 13 students who got out of cars and then crossed	
8:50 - 8:55				
8:55 - 9:00				

Afternoon Intervals

Time (PM)	# of Peds	# of Conflicts	Gaps	# of Gaps
2:45 - 2:50				
2:50 - 2:55				
2:55 - 3:00				
3:00 - 3:05	16		//,40,,32,38,14,,23,////,14,/////	11
3:05 - 3:10	12		//,19,51,//////////	5
3:10 - 3:15	6		///////,13,14,23,13,/,16,32,////	7
3:15 - 3:20	8		17,29,17,14,/,30,/,32,/,16,19,/,32,/,52,/,	17
3:20 - 3:25			16,/,12,18,29,21,////////,37,18,14,/,25	13
3:25 - 3:30				
3:30 - 3:35			34 students walking and 8 students getting into cars	
3:35 - 3:40				
3:40 - 3:45				
3:45 - 3:50				
3:50 - 3:55				
3:55 - 4:00				

Recommendations

1) Warrants not met for crossing guard. 2) Recommend school consider installing a fence across the front of the school, driveway to driveway, prevent students walking across the Kiss & Ride. 3) Recommend installation of fence along north side of school as well. 4) T & W to review signage in front of the school 5) That Traffic Safety Council work with principal to implement a school walking routes program.

Observations

Volume of Traffic (see Intersection Plan):

AM: ☐ Heavy

☒ Light

☒ Light ☒ Intermittant

PM: Heavy

☒ Light☒ Intermittant

Number of Crossing Pedestrians:

AM:	North	36
-----	-------	----

East ☐

South

West [

PM: North 42

East ☐South ☐West ☐

Turning Traffic:

AM: ☐ Heavy

☐ Light

Intermittant

PM: ☒ Heavy

☐ Light

└

Intermittent

Additional Comments/Conflicts

280 French immersion students 3 large and 1 small bus transport 187 students.

Additional Recommendations

5c

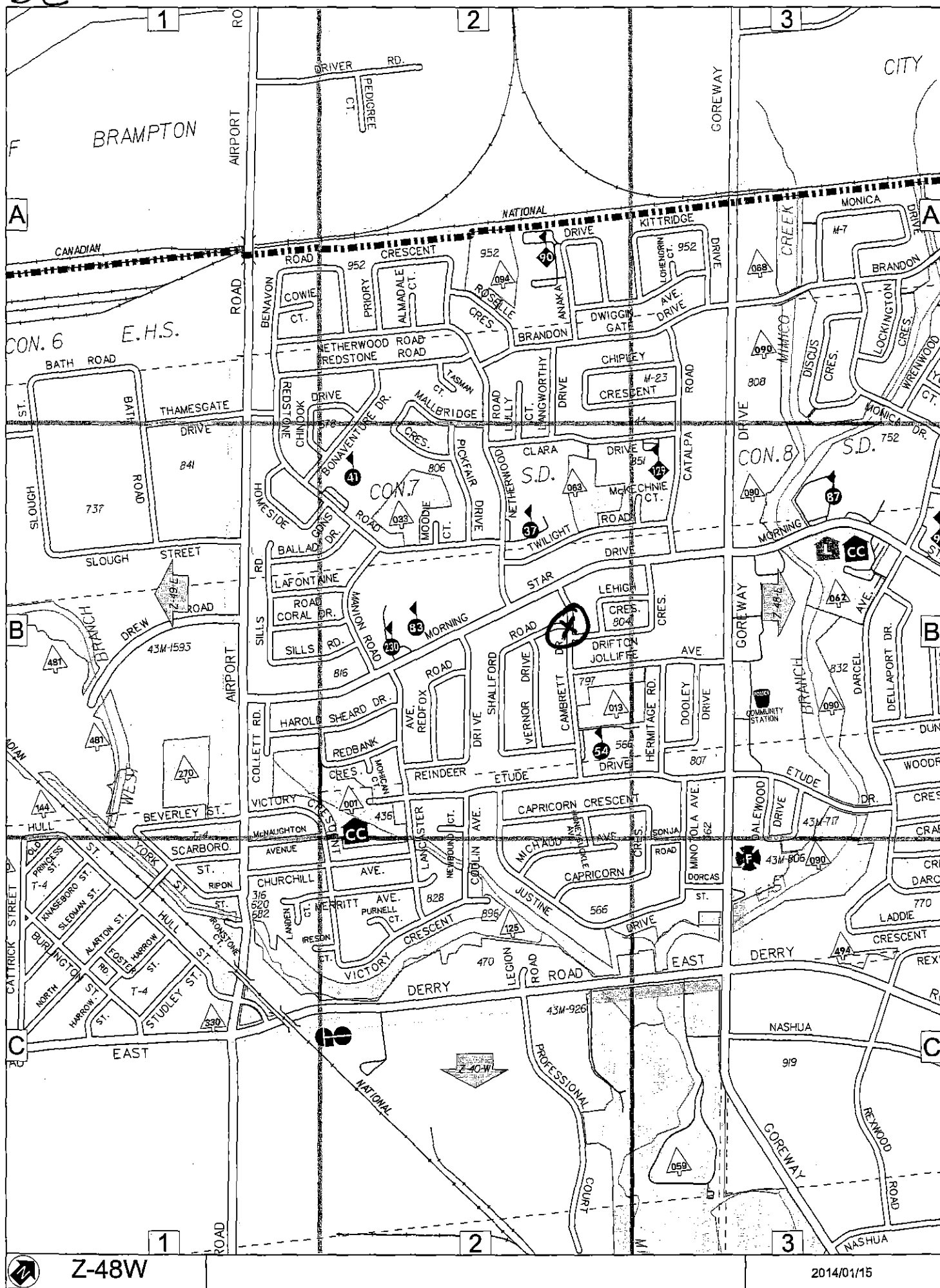

Z-48W

2014/01/15

5d.

Angie Melo

From: Sheelagh Duffin
Sent: 2014/03/31 11:19 AM
To: Heather McGuire
Cc: Annie Melo; Louise Goegan; Peter Westbrook
Subject: TSC Site Inspection Requests

Hi Heather,

Would you kindly schedule the following Site Inspections:

- 1) Oscar Peterson PS - There was a delegation from Oscar Peterson PS at the March 26, 2014 TSC meeting. The request was made that TSC schedule a Site Inspection to supplement the Site Inspection done January 28, 2014 only in the am in order to make a recommendation concerning the installation of a layby on Perennial Dr. between the school entrance driveway and Tenth Line West. The time for the inspection would be 3:25 – 3:55 pm.
- 2) Ridgewood PS – The Principal of Ridgewood PS, Balneet Singh, phoned to say that the traffic in front of the school was a danger to students crossing. Louise Goegan visited the school and has requested a Site Inspection be scheduled at the earliest convenience to determine if the warrants are met for a crossing guard in front of Ridgewood PS. The times of the inspection would be 8:10 – 8:40 am and 3:00 – 3:30 pm

Thank you.

Sheelagh
5167

Sheelagh Duffin
City of Mississauga
Supervisor, Crossing Guards
3185 Mavis Road
Mississauga ON L5C 1T7
905 896-5167
Fax 905 896-5583

Site Inspection Report



Traffic Safety Council
APR 23 2014

Corporate Services
Office of the City Clerk

Site	
School: Oscar Peterson Public School	Address: 5120 Perennial Drive, Mississauga, ON L5M7T6
School Times: 8:55 AM 3:25 PM	Student Population: 954
No. of School Buses:	
School:	Address:
School Times:	Student Population:
No. of School Buses:	

Location: (Please identify the location with reference to nearest intersection. Indicate nearest school and address)			
Date of Inspection: 2014 04 14	Inspection Time: 8:25 AM 3:25 PM	Requested By: Councillor McFadden	
Prepared By: S. Duffin	Request For: potential layby northwest corner Tenth & Perennial		

Observers			
File Number: RT.10	File Number: RT.10	Ward:	
Observed By: H. Relf	<input type="checkbox"/> AM <input type="checkbox"/> PM <input checked="" type="checkbox"/> AM & PM		
Observed By: D. Pest	<input type="checkbox"/> AM <input type="checkbox"/> PM <input checked="" type="checkbox"/> AM & PM		
Observed By: S. Duffin	<input type="checkbox"/> AM <input type="checkbox"/> PM <input checked="" type="checkbox"/> AM & PM		
Observed By: P. Westbrook	<input type="checkbox"/> AM <input checked="" type="checkbox"/> PM <input type="checkbox"/> AM & PM		
Observed By: D. Oude	<input checked="" type="checkbox"/> AM <input type="checkbox"/> PM <input type="checkbox"/> AM & PM		
Observed By:	<input type="checkbox"/> AM <input type="checkbox"/> PM <input type="checkbox"/> AM & PM		

Details			
Weather Conditions:	AM: <input checked="" type="checkbox"/> Dry <input type="checkbox"/> Sunny <input type="checkbox"/> Rain <input type="checkbox"/> Snow <input type="checkbox"/> Other: +20C		
	PM: <input type="checkbox"/> Dry <input type="checkbox"/> Sunny <input checked="" type="checkbox"/> Rain <input type="checkbox"/> Snow <input type="checkbox"/> Other: +15C		
Type of Crossing:	<input type="checkbox"/> 4 Way Intersection <input type="checkbox"/> 3 Way Intersection <input type="checkbox"/> Midblock (i.e., not an intersection)	N/A	
Type of Control:	<input type="checkbox"/> Traffic Lights <input type="checkbox"/> Yield Signs <input type="checkbox"/> No Control		
	<input type="checkbox"/> Stop Signs (Traffic is stopped on one street only) <input type="checkbox"/> All Way Stop (Traffic is stopped in all directions)		

Site Conditions			
School Signs:	<input checked="" type="checkbox"/> School Area Signs <input type="checkbox"/> School Crossing Signs <input type="checkbox"/> Parking/Stopping Prohibition		
Posted Speed Limit:	<input checked="" type="checkbox"/> 40 km/hr <input type="checkbox"/> 50 km/h <input type="checkbox"/> 60 km/hr <input type="checkbox"/> Other:		
Visibility of Crossing Pedestrians:	<input type="checkbox"/> Poor <input type="checkbox"/> Fair <input checked="" type="checkbox"/> Good	Comments:	
Sight Obstructions:	<input type="checkbox"/> Hedges <input type="checkbox"/> Trees <input type="checkbox"/> Fences <input type="checkbox"/> Bus Shelter		
	<input type="checkbox"/> Newspaper Boxes <input type="checkbox"/> Other (Specify):		
Road Grade:	N/A <input checked="" type="checkbox"/> Flat <input type="checkbox"/> Incline <input type="checkbox"/> Decline		
Road Geometrics:	<input checked="" type="checkbox"/> Straight <input type="checkbox"/> Curved	Comments:	
Road Width:	11.5 feet/metres	Curb to Curb:	Curb to Median:
Road Conditions:	AM: <input checked="" type="checkbox"/> Dry <input type="checkbox"/> Wet <input type="checkbox"/> Snow Covered <input type="checkbox"/> Ice		
	PM: <input type="checkbox"/> Dry <input checked="" type="checkbox"/> Wet <input type="checkbox"/> Snow Covered <input type="checkbox"/> Ice		
Sidewalks:	<input type="checkbox"/> Not Present <input checked="" type="checkbox"/> North <input checked="" type="checkbox"/> South <input type="checkbox"/> East <input type="checkbox"/> West		
Proximity to School:	<input checked="" type="checkbox"/> In Front of <input type="checkbox"/> Within	feet/metres	
Route Survey:	<input type="checkbox"/> Shopping Area <input type="checkbox"/> Construction <input type="checkbox"/> Driveway <input type="checkbox"/> Parked Vehicle(s)		
	<input type="checkbox"/> Transit Bus Stop <input type="checkbox"/> Underpass Within	feet/metres	
Comments / Conflicts:	Principal: Judy Richards 905 569-6261 424 French immersion students. 139 transported by bus.		

60a

Crossing Guard Warrant Survey

Location: _____

☐ Safe Gap Time

Safe Gap Time Calculation (if applicable): $\left(\frac{W}{3.5} + 4 \right)$ _____ = sec.

☐ Signalized Intersection turning traffic count

Morning Intervals

Time (AM)	# of Peds	# of Conflicts	Gaps	# of Gaps
7:45 - 7:50				
7:50 - 7:55				
7:55 - 8:00				
8:00 - 8:05				
8:05 - 8:10				
8:10 - 8:15				
8:15 - 8:20				
8:20 - 8:25				
8:25 - 8:30				
8:30 - 8:35				
8:35 - 8:40				
8:40 - 8:45				
8:45 - 8:50				
8:50 - 8:55				
8:55 - 9:00				

Afternoon Intervals

Time (PM)	# of Peds	# of Conflicts	Gaps	# of Gaps
2:45 - 2:50				
2:50 - 2:55				
2:55 - 3:00				
3:00 - 3:05				
3:05 - 3:10				
3:10 - 3:15				
3:15 - 3:20				
3:20 - 3:25				
3:25 - 3:30				
3:30 - 3:35				
3:35 - 3:40				
3:40 - 3:45				
3:45 - 3:50				
3:50 - 3:55				
3:55 - 4:00				

Recommendations

- 1) Lay by not recommended - road width adequate to accommodate parking north side, left turns into school Kiss & Ride and a through land east and west.
- 2) Recommend parents be encouraged to use the park parking lot at school entry and dismissal times. It is not currently fully utilized.

Observations

Volume of Traffic (see Intersection Plan):

AM: ☐ Heavy ☐ Light ☒ Intermittant

PM: ☐ Heavy ☐ Light ☐ Intermittant

Number of Crossing Pedestrians:

N/A

AM: North ☐ East ☐ South ☐ West ☐

PM: North ☐ East ☐ South ☐ West ☐

Turning Traffic:

AM: ☐ Heavy ☐ Light ☐ Intermittant

PM: ☐ Heavy ☐ Light ☐ Intermittant

6b

Additional Comments/Conflicts

Site Inspection subcommittee had a concern that the installation of a lay by would encourage double parking and thus create an unsafe scenario for students exiting vehicles. In addition, the installation of a lay by would reduce the number of parking spaces on street. If a lay by was installed the sidewalk would need to be relocated and would encroach on school property. Also, trees would need to be removed/relocated

Additional Recommendations

5120 Perennial Dr. btwn Tenth Line + Entry Driveway 3:25-3:55

6d

Heather McGuire

From: Sheelagh Duffin
Sent: 2014/03/31 11:19 AM
To: Heather McGuire
Cc: Angie Melo; Louise Goegan; Peter Westbrook
Subject: TSC Site Inspection Requests

Hi Heather,

Would you kindly schedule the following Site Inspections:

- 1) Oscar Peterson PS - There was a delegation from Oscar Peterson PS at the March 26, 2014 TSC meeting. The request was made that TSC schedule a Site Inspection to supplement the Site Inspection done January 28, 2014 only in the am in order to make a recommendation concerning the installation of a layby on Perennial Dr. between the school entrance driveway and Tenth Line West. The time for the inspection would be 3:25 – 3:55 pm.
- 2) Ridgewood PS – The Principal of Ridgewood PS, Balneet Singh, phoned to say that the traffic in front of the school was a danger to students crossing. Louise Goegan visited the school and has requested a Site Inspection be scheduled at the earliest convenience to determine if the warrants are met for a crossing guard in front of Ridgewood PS. The times of the inspection would be 8:10 – 8:40 am and 3:00 – 3:30 pm

Thank you.

Sheelagh
5167

Sheelagh Duffin
City of Mississauga
Supervisor, Crossing Guards
3185 Mavis Road
Mississauga ON L5C 1T7
905 896-5167
Fax 905 896-5583

Site Inspection Report



Traffic Safety Council

APR 23 2014

Corporate Services
Office of the City Clerk

Site	
School: Forest Avenue Public School	Address: 20 Forest Ave. Mississauga ON L5G 1K7
School Times: <input type="checkbox"/> AM <input checked="" type="checkbox"/> 3:30 PM	Student Population: 192
No. of School Buses: <input type="checkbox"/>	
School: <input type="text"/>	Address: <input type="text"/>
School Times: <input type="checkbox"/> AM <input type="checkbox"/> PM	Student Population: <input type="text"/>
No. of School Buses: <input type="text"/>	

Location: (Please identify the location with reference to nearest intersection. Indicate nearest school and address)

Horontario St. and Park St. - Signalized intersection

Date of Inspection: 2014 04 16	Inspection Time: <input type="checkbox"/> AM <input checked="" type="checkbox"/> 3:30 PM	Requested By: Crossing Guard Supervisor
--------------------------------	--	---

Prepared By: D. Suess	Request For: Review Crossing Guard Warrants
-----------------------	---

Observers

File Number: RT.10	File Number: RT.10	Ward: ****
Observed By: D. Suess	<input type="checkbox"/> AM <input checked="" type="checkbox"/> PM <input type="checkbox"/> AM & PM	
Observed By: S. Duffin	<input type="checkbox"/> AM <input checked="" type="checkbox"/> PM <input type="checkbox"/> AM & PM	
Observed By: J. McGlone	<input type="checkbox"/> AM <input checked="" type="checkbox"/> PM <input type="checkbox"/> AM & PM	
Observed By: <input type="text"/>	<input type="checkbox"/> AM <input type="checkbox"/> PM <input type="checkbox"/> AM & PM	
Observed By: <input type="text"/>	<input type="checkbox"/> AM <input type="checkbox"/> PM <input type="checkbox"/> AM & PM	
Observed By: <input type="text"/>	<input type="checkbox"/> AM <input type="checkbox"/> PM <input type="checkbox"/> AM & PM	

Details

Weather Conditions:	AM: <input type="checkbox"/> Dry <input type="checkbox"/> Sunny <input type="checkbox"/> Rain <input type="checkbox"/> Snow <input type="checkbox"/> Other: <input type="text"/>
	PM: <input checked="" type="checkbox"/> Dry <input checked="" type="checkbox"/> Sunny <input type="checkbox"/> Rain <input type="checkbox"/> Snow <input type="checkbox"/> Other: +3C
Type of Crossing:	<input checked="" type="checkbox"/> 4 Way Intersection <input type="checkbox"/> 3 Way Intersection <input type="checkbox"/> Midblock (i.e., not an intersection)
Type of Control:	<input checked="" type="checkbox"/> Traffic Lights <input type="checkbox"/> Yield Signs <input type="checkbox"/> No Control
	<input type="checkbox"/> Stop Signs (Traffic is stopped on one street only) <input type="checkbox"/> All Way Stop (Traffic is stopped in all directions)

Site Conditions

School Signs:	<input type="checkbox"/> School Area Signs <input checked="" type="checkbox"/> School Crossing Signs <input checked="" type="checkbox"/> Parking/Stopping Prohibition
Posted Speed Limit:	<input type="checkbox"/> 40 km/hr <input checked="" type="checkbox"/> 50 km/h <input type="checkbox"/> 60 km/hr <input type="checkbox"/> Other: <input type="text"/>
Visibility of Crossing Pedestrians:	<input type="checkbox"/> Poor <input type="checkbox"/> Fair <input checked="" type="checkbox"/> Good Comments: <input type="text"/>
Sight Obstructions:	<input type="checkbox"/> Hedges <input type="checkbox"/> Trees <input type="checkbox"/> Fences <input type="checkbox"/> Bus Shelter
	<input type="checkbox"/> Newspaper Boxes <input type="checkbox"/> Other (Specify): <input type="text"/>
Road Grade:	<input type="checkbox"/> Flat <input checked="" type="checkbox"/> Incline to north <input type="checkbox"/> Decline <input type="text"/>
Road Geometrics:	<input checked="" type="checkbox"/> Straight <input type="checkbox"/> Curved Comments: <input type="text"/>
Road Width:	N/A feet/metres Curb to Curb: <input type="text"/> feet/metres Curb to Median: <input type="text"/> feet/metres
Road Conditions:	AM: <input type="checkbox"/> Dry <input type="checkbox"/> Wet <input type="checkbox"/> Snow Covered <input type="checkbox"/> Ice
	PM: <input checked="" type="checkbox"/> Dry <input type="checkbox"/> Wet <input type="checkbox"/> Snow Covered <input type="checkbox"/> Ice
Sidewalks:	<input type="checkbox"/> Not Present <input checked="" type="checkbox"/> North <input checked="" type="checkbox"/> South <input checked="" type="checkbox"/> East <input checked="" type="checkbox"/> West
Proximity to School:	<input type="checkbox"/> In Front of <input type="checkbox"/> Within <input type="text"/> feet/metres
Route Survey:	<input type="checkbox"/> Shopping Area <input type="checkbox"/> Construction <input type="checkbox"/> Driveway <input type="checkbox"/> Parked Vehicle(s)
	<input checked="" type="checkbox"/> Transit Bus Stop <input checked="" type="checkbox"/> Underpass Within 50 feet/metres Other (specify): <input type="text"/>
Comments / Conflicts:	Principal: Michele East 905 278 2472

7a

Crossing Guard Warrant Survey

Location: _____

☐ Safe Gap TimeSafe Gap Time Calculation (if applicable): $\left(\frac{W}{3.5} + 4 \right)$ _____ = sec.☒ Signalized Intersection turning traffic count**Morning Intervals**

Time (AM)	# of Peds	# of Conflicts	Gaps	# of Gaps
7:45 - 7:50				
7:50 - 7:55				
7:55 - 8:00				
8:00 - 8:05				
8:05 - 8:10				
8:10 - 8:15				
8:15 - 8:20				
8:20 - 8:25				
8:25 - 8:30				
8:30 - 8:35				
8:35 - 8:40				
8:40 - 8:45				
8:45 - 8:50				
8:50 - 8:55				
8:55 - 9:00				

Afternoon Intervals

Time (PM)	# of Peds	# of Conflicts	Gaps	# of Gaps
2:45 - 2:50				
2:50 - 2:55				
2:55 - 3:00				
3:00 - 3:05				
3:05 - 3:10				
3:10 - 3:15				
3:15 - 3:20				
3:20 - 3:25				
3:25 - 3:30				
3:30 - 3:35	0		0,1,2,3	
3:35 - 3:40	0		3,1,2	
3:40 - 3:45	1 WP		1,0,0	
3:45 - 3:50	1 WP		1,0,0,1	
3:50 - 3:55	0		1,1,0	
3:55 - 4:00	0		0,0,1	

Recommendations

1) Warrants not met for guard. All conditions good for self-control of crossing. Traffic compliance very good.
 RECOMMEND: removal of crossing guard at the end of the 2013 -2014 school year , June 27 2014

Observations

Volume of Traffic (see Intersection Plan):

AM: ☐ Heavy ☐ Light ☐ Intermittant PM: ☒ Heavy ☐ Light ☐ Intermittant

Number of Crossing Pedestrians:

AM: North ☐ East ☐ South ☐ West ☐ PM: North ☐ East ☐ South ☐ 2 West ☐

Turning Traffic:

AM: ☐ Heavy ☐ Light ☐ Intermittant PM: ☐ Heavy ☐ Light ☒ Intermittant

Additional Comments/Conflicts

Principal - Michele East : Trustee: Janet McDougald
Few students crossing/using crosswalk
2 students - each with parent.

Additional Recommendations

7c

Site Inspection Report



Corporate Services
Office of the City Clerk

Site	
School: Forest Avenue Public School	Address: 20 Forest Ave. Mississauga ON L5G 1K7
School Times: 9:00 AM 3:30 PM	Student Population: 192
No. of School Buses:	
School:	Address:
School Times:	Student Population:
No. of School Buses:	

Location: (Please identify the location with reference to nearest intersection. Indicate nearest school and address)			
Hurontario St. and Park St. - Signalized intersection			
Date of Inspection: 2014 04 01	Inspection Time: 8:30 AM 3:30 PM	Requested By: Crossing Guard Supervisor	
Prepared By: D. Suess	Request For: Review Crossing Guard Warrants		

Observers	
File Number: RT.10	File Number: RT.10
Observed By: P. Westbrook	Ward: ***1***
Observed By: S. Duffin	<input type="checkbox"/> AM <input type="checkbox"/> PM <input checked="" type="checkbox"/> AM & PM
Observed By: D. Pest	<input type="checkbox"/> AM <input type="checkbox"/> PM <input checked="" type="checkbox"/> AM & PM
Observed By: D. Suess	<input type="checkbox"/> AM <input type="checkbox"/> PM <input checked="" type="checkbox"/> AM & PM
Observed By:	<input type="checkbox"/> AM <input type="checkbox"/> PM <input type="checkbox"/> AM & PM
Observed By:	<input type="checkbox"/> AM <input type="checkbox"/> PM <input type="checkbox"/> AM & PM

Details	
Weather Conditions:	AM: <input checked="" type="checkbox"/> Dry <input checked="" type="checkbox"/> Sunny <input type="checkbox"/> Rain <input type="checkbox"/> Snow <input type="checkbox"/> Other: -1C
	PM: <input checked="" type="checkbox"/> Dry <input type="checkbox"/> Sunny <input type="checkbox"/> Rain <input type="checkbox"/> Snow <input type="checkbox"/> Other: +7C
Type of Crossing:	<input checked="" type="checkbox"/> 4 Way Intersection <input type="checkbox"/> 3 Way Intersection <input type="checkbox"/> Midblock (i.e., not an intersection)
Type of Control:	<input checked="" type="checkbox"/> Traffic Lights <input type="checkbox"/> Yield Signs <input type="checkbox"/> No Control
	<input type="checkbox"/> Stop Signs (Traffic is stopped on one street only) <input type="checkbox"/> All Way Stop (Traffic is stopped in all directions)

Site Conditions	
School Signs:	<input type="checkbox"/> School Area Signs <input checked="" type="checkbox"/> School Crossing Signs <input checked="" type="checkbox"/> Parking/Stopping Prohibition
Posted Speed Limit:	<input type="checkbox"/> 40 km/hr <input checked="" type="checkbox"/> 50 km/h <input type="checkbox"/> 60 km/hr <input type="checkbox"/> Other:
Visibility of Crossing Pedestrians:	<input type="checkbox"/> Poor <input type="checkbox"/> Fair <input checked="" type="checkbox"/> Good Comments:
Sight Obstructions:	<input type="checkbox"/> Hedges <input type="checkbox"/> Trees <input type="checkbox"/> Fences <input type="checkbox"/> Bus Shelter
	<input type="checkbox"/> Newspaper Boxes <input type="checkbox"/> Other (Specify):
Road Grade:	<input checked="" type="checkbox"/> Flat south <input checked="" type="checkbox"/> Incline north <input type="checkbox"/> Decline
Road Geometrics:	<input checked="" type="checkbox"/> Straight <input type="checkbox"/> Curved Comments:
Road Width:	N/A feet/metres Curb to Curb: feet/metres Curb to Median: feet/metres
Road Conditions:	AM: <input checked="" type="checkbox"/> Dry <input type="checkbox"/> Wet <input type="checkbox"/> Snow Covered <input type="checkbox"/> Ice
	PM: <input checked="" type="checkbox"/> Dry <input type="checkbox"/> Wet <input type="checkbox"/> Snow Covered <input type="checkbox"/> Ice
Sidewalks:	<input type="checkbox"/> Not Present <input checked="" type="checkbox"/> North <input checked="" type="checkbox"/> South <input checked="" type="checkbox"/> East <input checked="" type="checkbox"/> West
Proximity to School:	<input type="checkbox"/> In Front of <input checked="" type="checkbox"/> Within 50 feet/metres
Route Survey:	<input type="checkbox"/> Shopping Area <input type="checkbox"/> Construction <input type="checkbox"/> Driveway <input type="checkbox"/> Parked Vehicle(s)
	<input checked="" type="checkbox"/> Transit Bus Stop <input type="checkbox"/> Underpass Within feet/metres Other (specify):
Comments / Conflicts:	Principal: Michele East 905 278 2472

7d

Crossing Guard Warrant Survey

Location: _____

☐ Safe Gap Time

Safe Gap Time Calculation (if applicable): $\left(\frac{W}{3.5} + 4 \right)$

= sec.

☒ Signalized Intersection turning traffic count

Morning Intervals

Time (AM)	# of Peds	# of Conflicts	Gaps	# of Gaps
7:45 - 7:50				
7:50 - 7:55				
7:55 - 8:00				
8:00 - 8:05				
8:05 - 8:10				
8:10 - 8:15				
8:15 - 8:20				
8:20 - 8:25				
8:25 - 8:30				
8:30 - 8:35	0		0,0,0	
8:35 - 8:40	0		2,1	
8:40 - 8:45	2		2,1	
8:45 - 8:50	1		1,0	
8:50 - 8:55	5		2,1,1	
8:55 - 9:00	1		0,0	

Afternoon Intervals

Time (PM)	# of Peds	# of Conflicts	Gaps	# of Gaps
2:45 - 2:50				
2:50 - 2:55				
2:55 - 3:00				
3:00 - 3:05				
3:05 - 3:10				
3:10 - 3:15				
3:15 - 3:20				
3:20 - 3:25				
3:25 - 3:30				
3:30 - 3:35	0		1,1,0	
3:35 - 3:40	4+3		6,1,0	
3:40 - 3:45	0		0,0,0	
3:45 - 3:50	0		0,0,0	
3:50 - 3:55	0		1,1,3	
3:55 - 4:00	0		0,1,0	

Recommendations

Recommend-1) removal of guard effective June 27 2014 - end of 2013-14 school year. See Site Inspection Report dated April 16 2014.

Observations

Volume of Traffic (see Intersection Plan):

AM: ☒ Heavy ☐ Light ☐ Intermittant

PM: ☒ Heavy ☐ Light ☐ Intermittant

Number of Crossing Pedestrians:

AM: North East South 9 West

PM: North East South 7 West

Turning Traffic:

AM: ☐ Heavy ☐ Light ☒ Intermittant

PM: ☐ Heavy ☐ Light ☒ Intermittant

7e

Additional Comments/Conflicts

Principal - Michele East Trustee: Janet McDougald

192 Students. Only 1 student rides the bus.

Light use of respective students and conditions noted do not warrant continuation of crossing guard. Light traffic at crosswalk - no conflicts - light turning traffic

Good markings (Zebra stripes) Appropriate signage in area

Additional Recommendations

7 f

Site Inspection Report



Corporate Services
Office of the City Clerk

Site	
School: Forest Avenue Public School	Address: 20 Forest Ave. Mississauga ON L5G 1K7
School Times: 9:00 AM	Student Population: 192
No. of School Buses:	
School Times: AM	Student Population:
No. of School Buses:	

Location: (Please identify the location with reference of nearest Intersection. Indicate nearest school and address)			
Hurontario St. and Park St. - Signalized intersection			
Date of Inspection: 2014 03 18	Inspection Time: 8:30 AM	Requested By: Crossing Guard Supervisor	
Prepared By: P. Westbrook/S. Duffin	Request For: Review Crossing Guard Warrants		

Observers			
File Number: RT.10	File Number: RT.10	Ward: ***1***	
Observed By: P. Westbrook	<input type="checkbox"/> AM	<input type="checkbox"/> PM	<input checked="" type="checkbox"/> AM & PM
Observed By: S. Duffin	<input type="checkbox"/> AM	<input type="checkbox"/> PM	<input checked="" type="checkbox"/> AM & PM
Observed By: D. Pest	<input type="checkbox"/> AM	<input type="checkbox"/> PM	<input checked="" type="checkbox"/> AM & PM
Observed By:	<input type="checkbox"/> AM	<input type="checkbox"/> PM	<input type="checkbox"/> AM & PM
Observed By:	<input type="checkbox"/> AM	<input type="checkbox"/> PM	<input type="checkbox"/> AM & PM
Observed By:	<input type="checkbox"/> AM	<input type="checkbox"/> PM	<input type="checkbox"/> AM & PM

Details			
Weather Conditions:	AM: <input checked="" type="checkbox"/> Dry <input type="checkbox"/> Sunny <input type="checkbox"/> Rain <input type="checkbox"/> Snow	Other: -5C	
	PM: <input type="checkbox"/> Dry <input type="checkbox"/> Sunny <input type="checkbox"/> Rain <input type="checkbox"/> Snow	Other:	
Type of Crossing:	<input checked="" type="checkbox"/> 4 Way Intersection <input type="checkbox"/> 3 Way Intersection	<input type="checkbox"/> Midblock (i.e., not an intersection)	
Type of Control:	<input checked="" type="checkbox"/> Traffic Lights <input type="checkbox"/> Yield Signs	<input type="checkbox"/> No Control	
	<input type="checkbox"/> Stop Signs (Traffic is stopped on one street only)	<input type="checkbox"/> All Way Stop (Traffic is stopped in all directions)	

Site Conditions			
School Signs:	<input type="checkbox"/> School Area Signs <input type="checkbox"/> School Crossing Signs	<input type="checkbox"/> Parking/Stopping Prohibition	
Posted Speed Limit:	<input type="checkbox"/> 40 km/hr <input checked="" type="checkbox"/> 50 km/h <input type="checkbox"/> 60 km/hr	Other:	
Visibility of Crossing Pedestrians:	<input type="checkbox"/> Poor <input type="checkbox"/> Fair <input checked="" type="checkbox"/> Good	Comments:	
Sight Obstructions:	<input type="checkbox"/> Hedges <input type="checkbox"/> Trees <input type="checkbox"/> Fences	<input type="checkbox"/> Bus Shelter	
	<input type="checkbox"/> Newspaper Boxes <input type="checkbox"/> Other (Specify):		
Road Grade:	<input checked="" type="checkbox"/> Flat <input type="checkbox"/> Incline <input type="checkbox"/> Decline		
Road Geometrics:	<input checked="" type="checkbox"/> Straight <input type="checkbox"/> Curved	Comments:	
Road Width:	N/A feet/metres Curb to Curb: feet/metres	Curb to Median: feet/metres	
Road Conditions:	AM: <input checked="" type="checkbox"/> Dry <input type="checkbox"/> Wet <input type="checkbox"/> Snow Covered	<input type="checkbox"/> Ice	
	PM: <input type="checkbox"/> Dry <input type="checkbox"/> Wet <input type="checkbox"/> Snow Covered	<input type="checkbox"/> Ice	
Sidewalks:	<input type="checkbox"/> Not Present <input checked="" type="checkbox"/> North <input checked="" type="checkbox"/> South	<input checked="" type="checkbox"/> East <input checked="" type="checkbox"/> West	
Proximity to School:	<input type="checkbox"/> In Front of <input type="checkbox"/> Within feet/metres		
Route Survey:	<input type="checkbox"/> Shopping Area <input type="checkbox"/> Construction <input type="checkbox"/> Driveway	<input type="checkbox"/> Parked Vehicle(s)	
	<input type="checkbox"/> Transit Bus Stop <input type="checkbox"/> Underpass Within feet/metres	Other (specify):	
Comments / Conflicts:	Principal: Michele East 905 278 2472		

79

Crossing Guard Warrant Survey

Location: _____

☐ Safe Gap Time

Safe Gap Time Calculation (if applicable): $\left(\frac{W}{3.5} + 4 \right)$

= sec.

☒ Signalized Intersection turning traffic count

Morning Intervals

Time (AM)	# of Peds	# of Conflicts	Gaps	# of Gaps
7:45 - 7:50				
7:50 - 7:55				
7:55 - 8:00				
8:00 - 8:05			TURNING TRAFFIC ONLY FROM EAST / WEST - SOUTHBOUND	
8:05 - 8:10				
8:10 - 8:15				
8:15 - 8:20				
8:20 - 8:25				
8:25 - 8:30				
8:30 - 8:35			0,0	
8:35 - 8:40			0,0	
8:40 - 8:45	2 WP		0,0	
8:45 - 8:50	1 WP		0,0	
8:50 - 8:55	1 WP &	3 WP	0,0	
8:55 - 9:00			0,1	

Afternoon Intervals

Time (PM)	# of Peds	# of Conflicts	Gaps	# of Gaps
2:45 - 2:50				
2:50 - 2:55				
2:55 - 3:00				
3:00 - 3:05				
3:05 - 3:10				
3:10 - 3:15				
3:15 - 3:20				
3:20 - 3:25				
3:25 - 3:30				
3:30 - 3:35				
3:35 - 3:40				
3:40 - 3:45				
3:45 - 3:50				
3:50 - 3:55				
3:55 - 4:00				

Recommendations

Observations

Volume of Traffic (see Intersection Plan):

AM: ☐ Heavy ☒ Light ☐ Intermittant

PM: ☐ Heavy ☐ Light ☐ Intermittant

Number of Crossing Pedestrians:

AM: North East South West

PM: North East South West

Turning Traffic:

AM: ☐ Heavy ☐ Light ☐ Intermittant

PM: ☐ Heavy ☐ Light ☐ Intermittant

Additional Comments/Conflicts

Principal - Michele East : Trustee: Janet McDougald
192 Students. Only 1 student rides the bus. Turning traffic is very light across south leg of the intersection.
No conflicts observed. Students cross with parents. Intersection is well marked with zebra stripes .
Countdown timers are used.

Additional Recommendations

7 Hurontario + Park.

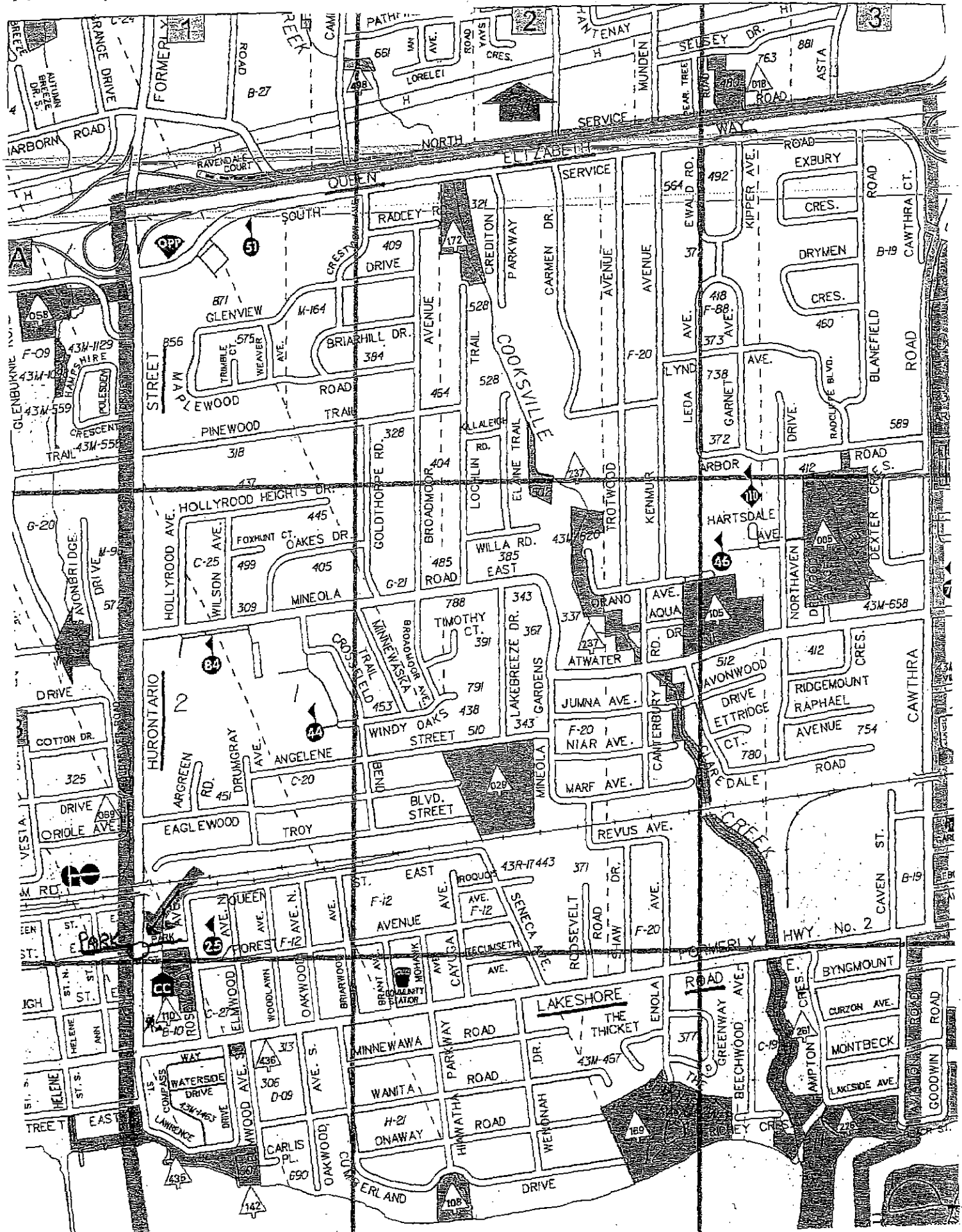

7J

Heather McGuire

From: Sheelagh Duffin
Sent: 2014/02/20 3:38 PM
To: Heather McGuire
Cc: Angie Melo
Subject: Request for Site Inspection - Hurontario and Park Street

AM

Hi Heather,

Would you kindly schedule two Site Inspections to determine if the warrants continue to be met for the retention of the crossing guard at Hurontario Street and Park Street for the students of Forest Avenue Public School.

The number of students crossing at this location has dwindled over the past few years as the student population has declined. There are now 183 students at Forest Avenue with potentially less than 10 students that could cross with the crossing guard, including 4 out of boundary students. Most days there are only 1 to 3 students crossing and they are crossing with parents.

The Site Inspection times would be 8:30 – 9:00 and 3:30 – 4:00

Thank you.

Sheelagh
5167

Sheelagh Duffin
City of Mississauga
Supervisor, Crossing Guards
3185 Mavis Road
Mississauga ON L5C 1T7
905 896-5167
Fax 905 896-5583

8

Site Inspection Report



Traffic Safety Council

APR 23 2014

Corporate Services
Office of the City Clerk

Site	
School: Mary Fix Catholic School	Address: 486 Paisley Blvd Mississauga ON L5B 2M4
School Times: 9:00 AM 3:30 PM	Student Population: 277
No. of School Buses: 1 Small	
School:	Address:
School Times:	Student Population:
No. of School Buses:	
Location: (Please identify the location with reference to nearest intersection. Indicate nearest school and address) Paisley Blvd & Crystalburn Ave.	
Date of Inspection: 2014 04 08	Inspection Time: 8:30 AM 3:30 PM
Requested By: School Travel Planning	
Prepared By: D. Suess/S. Duffin	Request For: Crossing Guard
Observers	
File Number: RT.10	File Number: RT.10
Ward:	
Observed By: D. Suess	<input checked="" type="checkbox"/> AM <input type="checkbox"/> PM <input type="checkbox"/> AM & PM
Observed By: D. Pest	<input type="checkbox"/> AM <input type="checkbox"/> PM <input checked="" type="checkbox"/> AM & PM
Observed By: S. Duffin	<input type="checkbox"/> AM <input type="checkbox"/> PM <input checked="" type="checkbox"/> AM & PM
Observed By: A. Syed	<input type="checkbox"/> AM <input checked="" type="checkbox"/> PM <input type="checkbox"/> AM & PM
Observed By:	<input type="checkbox"/> AM <input type="checkbox"/> PM <input type="checkbox"/> AM & PM
Observed By:	<input type="checkbox"/> AM <input type="checkbox"/> PM <input type="checkbox"/> AM & PM
Details	
Weather Conditions:	AM: <input type="checkbox"/> Dry <input type="checkbox"/> Sunny <input checked="" type="checkbox"/> Rain <input type="checkbox"/> Snow <input type="checkbox"/> Other: +2C
	PM: <input checked="" type="checkbox"/> Dry <input checked="" type="checkbox"/> Sunny <input type="checkbox"/> Rain <input type="checkbox"/> Snow <input type="checkbox"/> Other: +10C
Type of Crossing:	<input type="checkbox"/> 4 Way Intersection <input checked="" type="checkbox"/> 3 Way Intersection <input type="checkbox"/> Midblock (i.e., not an intersection)
Type of Control:	<input type="checkbox"/> Traffic Lights <input type="checkbox"/> Yield Signs <input type="checkbox"/> No Control
	<input type="checkbox"/> Stop Signs (Traffic is stopped on one street only) <input checked="" type="checkbox"/> All Way Stop (Traffic is stopped in all directions)
Site Conditions	
School Signs:	<input checked="" type="checkbox"/> School Area Signs <input checked="" type="checkbox"/> School Crossing Signs <input checked="" type="checkbox"/> Parking/Stopping Prohibition
Posted Speed Limit:	<input checked="" type="checkbox"/> 40 km/hr <input type="checkbox"/> 50 km/h <input type="checkbox"/> 60 km/hr <input type="checkbox"/> Other:
Visibility of Crossing Pedestrians:	<input type="checkbox"/> Poor <input type="checkbox"/> Fair <input checked="" type="checkbox"/> Good Comments:
Sight Obstructions:	<input type="checkbox"/> Hedges <input type="checkbox"/> Trees <input type="checkbox"/> Fences <input type="checkbox"/> Bus Shelter
	<input type="checkbox"/> Newspaper Boxes <input type="checkbox"/> Other (Specify):
Road Grade:	<input checked="" type="checkbox"/> Flat <input type="checkbox"/> Incline <input type="checkbox"/> Decline
Road Geometrics:	<input checked="" type="checkbox"/> Straight <input type="checkbox"/> Curved Comments:
Road Width:	35 feet/metres Curb to Curb: feet/metres Curb to Median: feet/metres
Road Conditions:	AM: <input type="checkbox"/> Dry <input checked="" type="checkbox"/> Wet <input type="checkbox"/> Snow Covered <input type="checkbox"/> Ice
	PM: <input checked="" type="checkbox"/> Dry <input checked="" type="checkbox"/> Wet <input type="checkbox"/> Snow Covered <input type="checkbox"/> Ice
Sidewalks:	<input type="checkbox"/> Not Present <input checked="" type="checkbox"/> North <input checked="" type="checkbox"/> South <input checked="" type="checkbox"/> East <input checked="" type="checkbox"/> West
Proximity to School:	<input type="checkbox"/> In Front of <input checked="" type="checkbox"/> Within 25 feet/metres
Route Survey:	<input type="checkbox"/> Shopping Area <input type="checkbox"/> Construction <input type="checkbox"/> Driveway <input type="checkbox"/> Parked Vehicle(s)
	<input type="checkbox"/> Transit Bus Stop <input type="checkbox"/> Underpass Within feet/metres Other (specify):
Comments / Conflicts:	Principal: Andrea Milanelli 905 270 3140

Additional Comments/Conflicts

Good stopping compliance when pedestrians present
Younger students accompanied by caregivers
No conflicts observed. Some stopping incomplete when no pedestrians present
Adequate signage in place.

Additional Recommendations

86

Site Inspection Report



Corporate Services
Office of the City Clerk

Site	
School: Mary Fix Catholic School	Address: 486 Paisley Blvd Mississauga ON L5B 2M4
School Times: 9:00 AM 3:30 PM	Student Population: 277
No. of School Buses: 1 smll	
School:	Address:
School Times: AM PM	Student Population:
No. of School Buses:	

Location: (Please identify the location with reference of nearest intersection. Indicate nearest school and address)			
Stillmeadow Rd. & Louis Dr.			
Date of Inspection: 2014 04 10	Inspection Time: 8:30 AM 3:30 PM	Requested By: School Travel Planning	
Prepared By: D. Suess/S. Duffin	Request For: placement of a guard		

Observers			
File Number: RT.10	File Number: RT.10	Ward:	
Observed By: D. Suess	<input checked="" type="checkbox"/> AM	<input type="checkbox"/> PM	<input type="checkbox"/> AM & PM
Observed By: D. Pest	<input type="checkbox"/> AM	<input type="checkbox"/> PM	<input checked="" type="checkbox"/> AM & PM
Observed By: S. Duffin	<input type="checkbox"/> AM	<input type="checkbox"/> PM	<input checked="" type="checkbox"/> AM & PM
Observed By: A. Syed	<input type="checkbox"/> AM	<input checked="" type="checkbox"/> PM	<input type="checkbox"/> AM & PM
Observed By:	<input type="checkbox"/> AM	<input type="checkbox"/> PM	<input type="checkbox"/> AM & PM
Observed By:	<input type="checkbox"/> AM	<input type="checkbox"/> PM	<input type="checkbox"/> AM & PM

Details			
Weather Conditions:	AM: <input checked="" type="checkbox"/> Dry <input type="checkbox"/> Sunny <input type="checkbox"/> Rain <input type="checkbox"/> Snow <input type="checkbox"/> Other: +10C		
	PM: <input checked="" type="checkbox"/> Dry <input type="checkbox"/> Sunny <input type="checkbox"/> Rain <input type="checkbox"/> Snow <input type="checkbox"/> Other: +19C		
Type of Crossing:	<input checked="" type="checkbox"/> 4 Way Intersection <input type="checkbox"/> 3 Way Intersection <input type="checkbox"/> Midblock (i.e., not an intersection)		
Type of Control:	<input type="checkbox"/> Traffic Lights <input type="checkbox"/> Yield Signs <input type="checkbox"/> No Control		
	<input type="checkbox"/> Stop Signs (Traffic is stopped on one street only) <input checked="" type="checkbox"/> All Way Stop (Traffic is stopped in all directions)		

Site Conditions			
School Signs:	<input type="checkbox"/> School Area Signs <input type="checkbox"/> School Crossing Signs <input type="checkbox"/> Parking/Stopping Prohibition		
Posted Speed Limit:	<input type="checkbox"/> 40 km/hr <input checked="" type="checkbox"/> 50 km/h <input type="checkbox"/> 60 km/hr <input type="checkbox"/> Other:		
Visibility of Crossing Pedestrians:	<input type="checkbox"/> Poor <input type="checkbox"/> Fair <input checked="" type="checkbox"/> Good	Comments:	
Sight Obstructions:	<input type="checkbox"/> Hedges <input type="checkbox"/> Trees <input type="checkbox"/> Fences <input type="checkbox"/> Bus Shelter		
	<input type="checkbox"/> Newspaper Boxes <input type="checkbox"/> Other (Specify):		
Road Grade:	<input checked="" type="checkbox"/> Flat <input type="checkbox"/> Incline <input type="checkbox"/> Decline		
Road Geometrics:	<input checked="" type="checkbox"/> Straight <input type="checkbox"/> Curved	Comments:	
Road Width:	40 feet/metres	Curb to Curb:	feet/metres
		Curb to Median:	feet/metres
Road Conditions:	AM: <input checked="" type="checkbox"/> Dry <input type="checkbox"/> Wet <input type="checkbox"/> Snow Covered <input type="checkbox"/> Ice		
	PM: <input checked="" type="checkbox"/> Dry <input type="checkbox"/> Wet <input type="checkbox"/> Snow Covered <input type="checkbox"/> Ice		
Sidewalks:	<input type="checkbox"/> Not Present <input type="checkbox"/> North <input type="checkbox"/> South <input type="checkbox"/> East <input type="checkbox"/> West		
Proximity to School:	<input type="checkbox"/> In Front of <input checked="" type="checkbox"/> Within 100 feet/metres		
Route Survey:	<input type="checkbox"/> Shopping Area <input type="checkbox"/> Construction <input type="checkbox"/> Driveway <input type="checkbox"/> Parked Vehicle(s)		
	<input type="checkbox"/> Transit Bus Stop <input type="checkbox"/> Underpass Within feet/metres	Other (specify):	
Comments / Conflicts:	Principal: Andrea Milanetti 905 270 3140		

Additional Comments/Conflicts

light traffic
light pedestrians - very few
no conflicts
sufficient gaps
pedestrians cross confidently

Additional Recommendations

8d

Site Inspection Report



Corporate Services
Office of the City Clerk

Site	
School: Mary Fix Catholic School	Address: 486 Paisley Blvd Mississauga ON L5B 2M4
School Times: 9:00 AM 3:30 PM	Student Population: 277
No. of School Buses: 1 small	
School:	Address:
School Times: AM PM	Student Population:
No. of School Buses:	

Location: (Please identify the location with reference to nearest intersection. Indicate nearest school and address)			
Stillmeadow Rd. & The Queensway			
Date of Inspection: 2014 04 15	Inspection Time: 8:30 AM 3:30 PM	Requested By: Student Travel Planning	
Prepared By: D. Suess	Request For: crossing guard		

Observers		
File Number: RT.10	File Number: RT.10	Ward: ***7***
Observed By: D. Suess	<input type="checkbox"/> AM <input type="checkbox"/> PM <input checked="" type="checkbox"/> AM & PM	
Observed By: D. Yauan	<input type="checkbox"/> AM <input type="checkbox"/> PM <input checked="" type="checkbox"/> AM & PM	
Observed By: S. Duffin	<input type="checkbox"/> AM <input type="checkbox"/> PM <input checked="" type="checkbox"/> AM & PM	
Observed By:	<input type="checkbox"/> AM <input type="checkbox"/> PM <input type="checkbox"/> AM & PM	
Observed By:	<input type="checkbox"/> AM <input type="checkbox"/> PM <input type="checkbox"/> AM & PM	
Observed By:	<input type="checkbox"/> AM <input type="checkbox"/> PM <input type="checkbox"/> AM & PM	

Details	
Weather Conditions:	AM: <input type="checkbox"/> Dry <input type="checkbox"/> Sunny <input type="checkbox"/> Rain <input checked="" type="checkbox"/> Snow <input type="checkbox"/> Other: -1C PM: <input checked="" type="checkbox"/> Dry <input type="checkbox"/> Sunny <input type="checkbox"/> Rain <input type="checkbox"/> Snow <input type="checkbox"/> Other: -1C + overcast
Type of Crossing:	<input checked="" type="checkbox"/> 4 Way Intersection <input type="checkbox"/> 3 Way Intersection <input type="checkbox"/> Midblock (i.e., not an intersection)
Type of Control:	<input checked="" type="checkbox"/> Traffic Lights <input type="checkbox"/> Yield Signs <input type="checkbox"/> No Control <input type="checkbox"/> Stop Signs (Traffic is stopped on one street only) <input type="checkbox"/> All Way Stop (Traffic is stopped in all directions)

Site Conditions	
School Signs:	<input type="checkbox"/> School Area Signs <input type="checkbox"/> School Crossing Signs <input type="checkbox"/> Parking/Stopping Prohibition
Posted Speed Limit:	<input type="checkbox"/> 40 km/hr <input checked="" type="checkbox"/> 50 km/h <input type="checkbox"/> 60 km/hr <input type="checkbox"/> Other:
Visibility of Crossing Pedestrians:	<input type="checkbox"/> Poor <input type="checkbox"/> Fair <input checked="" type="checkbox"/> Good Comments:
Sight Obstructions:	<input type="checkbox"/> Hedges <input type="checkbox"/> Trees <input type="checkbox"/> Fences <input type="checkbox"/> Bus Shelter <input type="checkbox"/> Newspaper Boxes <input type="checkbox"/> Other (Specify):
Road Grade:	<input checked="" type="checkbox"/> Flat <input type="checkbox"/> Incline <input type="checkbox"/> Decline
Road Geometrics:	<input checked="" type="checkbox"/> Straight <input type="checkbox"/> Curved Comments:
Road Width:	N/A feet/metres Curb to Curb: feet/metres Curb to Median: feet/metres
Road Conditions:	AM: <input type="checkbox"/> Dry <input checked="" type="checkbox"/> Wet <input type="checkbox"/> Snow Covered <input type="checkbox"/> Ice PM: <input checked="" type="checkbox"/> Dry <input type="checkbox"/> Wet <input type="checkbox"/> Snow Covered <input type="checkbox"/> Ice
Sidewalks:	<input type="checkbox"/> Not Present <input checked="" type="checkbox"/> North <input checked="" type="checkbox"/> South <input checked="" type="checkbox"/> East <input checked="" type="checkbox"/> West
Proximity to School:	<input type="checkbox"/> In Front of <input checked="" type="checkbox"/> Within 800 feet/metres
Route Survey:	<input type="checkbox"/> Shopping Area <input type="checkbox"/> Construction <input type="checkbox"/> Driveway <input type="checkbox"/> Parked Vehicle(s) <input type="checkbox"/> Transit Bus Stop <input type="checkbox"/> Underpass Within feet/metres Other (specify):
Comments / Conflicts:	Principal: Andrea Milanetti 905 270 3140 Zero conflicts since zero students crossing AM or PM

8e

Crossing Guard Warrant Survey

Location: Sullmeadow Rd & The Queensway

☐ Safe Gap TimeSafe Gap Time Calculation (if applicable): $\left(\frac{W}{3.5} + 4 \right)$ = sec.☒ Signalized Intersection turning traffic count**Morning Intervals**

Time (AM)	# of Peds	# of Conflicts	Gaps		# of Gaps
7:45 - 7:50					
7:50 - 7:55					
7:55 - 8:00					
8:00 - 8:05					
8:05 - 8:10					
8:10 - 8:15					
8:15 - 8:20					
8:20 - 8:25					
8:25 - 8:30			West	South	
8:30 - 8:35	0		0,0,0	1,0,0	
8:35 - 8:40	0		0,0,0	1,0,1,0,0,0	
8:40 - 8:45	0		0,0,0	0,0,0,0	
8:45 - 8:50	0		0,0,0,1	0,0,2,0,0,0,1	
8:50 - 8:55	0		0,1,0	0,0,1,0,1,0,0,0	
8:55 - 9:00	0		0,0,0	0,0,3,0,3	

Afternoon Intervals

Time (PM)	# of Peds	# of Conflicts	Gaps		# of Gaps
2:45 - 2:50					
2:50 - 2:55					
2:55 - 3:00					
3:00 - 3:05					
3:05 - 3:10					
3:10 - 3:15					
3:15 - 3:20					
3:20 - 3:25					
3:25 - 3:30			West	South	
3:30 - 3:35	0		0,0	2,1,0	
3:35 - 3:40	0		0,0,0	0,2,0,2	
3:40 - 3:45	0		0,0	0,3,0,6	
3:45 - 3:50	0		0,0	0,4,4	
3:50 - 3:55	0		0,0	0,1,2	
3:55 - 4:00	0		0,0	1,3,2	

Recommendations

1) Warrants not met for a crossing guard

Observations

Volume of Traffic (see Intersection Plan):

AM: ☐ Heavy ☒ Light ☐ Intermittant PM: ☐ Heavy ☒ Light ☐ Intermittant

Number of Crossing Pedestrians:

AM: North 0 East 0 South 0 West 0 PM: North 0 East 0 South 0 West 0

Turning Traffic:

AM: ☐ Heavy ☐ Light ☒ Intermittant PM: ☐ Heavy ☐ Light ☒ Intermittant

89

Heather McGuire

From: Sheelagh Duffin
Sent: 2013/12/03 5:06 PM
To: Sim, Catherine
Cc: Peter Westbrook [REDACTED]; Heather McGuire; 'Andrea.Milanetti@dpocsb.org'; Louise Goegan [REDACTED]; Kells, Christine (Christine.Kells@peelregion.ca); 'a.giorgio [REDACTED]'; 'phanson1 [REDACTED]'; 'lisa.nucci@dpocsb.org'; Vafaie, Melanie
Subject: RE: Mary Fix Walkabout

Hi Catherine,

Sorry I wasn't able to attend the walkabout at Mary Fix last Friday. I did, however, speak to Louise and she provided us with the Walkabout Hazard Identification List. Based on the list, we will be scheduling Site Inspections to determine if the warrants are met for the implementation of school crossings manned by a crossing guard.

We will be scheduling Site Inspections and Gap Studies at 3 of the locations:

- 1) Paisley Boulevard and Crystalburn Avenue
- 2) Stillmeadow Road and Louis Drive
- 3) Queensway West and Stillmeadow Road

Please note that we would not provide crossing guard service at the other 3 locations on Paisley Boulevard identified on the Walkabout Hazard Identification List, Cashmere Avenue, Palisander Avenue, and Kingsberry Crescent. If the warrants were met for a crossing guard at Crystalburn and Paisley, the closest location to the school, that one location would provide safe crossing for all students living west of the school on the north side of Paisley Boulevard.

We would not normally schedule Site Inspections for January and February when the weather is coldest and there tend to be fewer students walking to school. However, if there is urgency to inspecting the 3 sites, we could schedule them for January. I will wait to hear from you as to the preferred timing before requesting that the inspections be added to the calendar.

In future, would it be possible to receive a copy of the Walkabout Hazard Identification Lists as soon as they are available before the walkabout? For Mississauga's School Walking Routes program, we try to address parent concerns prior to the walkabout.

Thank you. Peter Westbrook will be attending the walkabout for Corpus Christi December 16th. I will try to make it as well.

Sheelagh

Sheelagh Duffin

City of Mississauga
Supervisor, Crossing Guards
3185 Mavis Road
Mississauga ON L5C 1T7
905 896-5167
Fax 905 896-5583

9

Angie Melo

From: Sheelagh Duffin
Sent: 2014/03/25 4:00 PM
To: Heather McGuire
Cc: Angie Melo; Peter Westbrook [REDACTED]; Hiramchuk, Caren
Subject: Site Inspection Request -Alexandra Avenue & Fourth Street

Follow Up Flag: Follow up
Flag Status: Flagged

Traffic Safety Council
APR 23 2014

Hi Heather,

Would you kindly schedule a Site Inspection to determine if the warrants are met for the implementation of a school crossing guard for the students of Queen of Heaven Catholic School at the intersection of Alexandra Avenue and Fourth Street.

March 24th Peter Westbrook attended a walkabout for Peel's School Travel Planning Pilot at Queen of Heaven Catholic School. Several parents indicated they had a concern with students crossing Alexandra Avenue and Fourth Street. The times of the inspection would be 8:00 – 8:30am and 3:00 – 3:30pm.

Thank you.

Sheelagh
5167

Sheelagh Duffin
City of Mississauga
Supervisor, Crossing Guards
3185 Mavis Road
Mississauga ON L5C 1T7
905 896-5167
Fax 905 896-5583

Angie Melo

From: boris swedak <[REDACTED]>
Sent: 2014/04/02 7:37 PM
To: Angie Melo
Cc: Marcotte David
Subject: Foest Ave PS

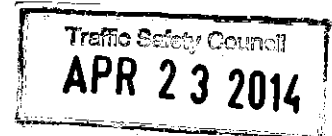

Dismissal Report

School Name Forest Ave PS

Address 20 Forest Ave

Phone No. 905-278-2472

Z # 7 ID # 19

Grades K-6

Dismissal Time 3:15 PM – K & 3:30 PM

Date of Inspection April 2, 2014

Weather Sunny and 7 deg. C

Adjacent to Park- No

Public Transit- No

School Transport- 1 Cube van at 3:15 PM for special needs student, 1 dodge caravan

Parent Behaviour – Good

Parking- one row adjacent to front of school containing 8 stalls, a diagonal driveway and 8 spaces

adjoining the driveway, on the east side of Elmwood, on the south side of Forest Ave.

Kissn' Ride- no provisions to install same at this site due to property restrictions

Signs- Acceptable on school and right of way

Small community school located in a totally residential area

Relatively light traffic volumes during most periods of the day

TSC is reviewing the retention of Crossing Guard at this site.

Guard is located at the intersection of Forest Ave and Elmwood Ave.
Xing guard crosses students on the west side of the 4 way stop
intersection in a north south orientation.

Parents parking on Elmwood Ave are performing hazardous u-turns during Dismissal
period.

There are no sidewalks on the east side of Elmwood Ave .although Forest Ave has
walks on both sides of the right of way

Existing school driveway is not signed as a one way facility ,paint is
badly faded on drive and should require painting his year.

Recommendations:

1. That Peel Maintenance manager place Forest Ave. PS on the 2014
painting contract.
2. That Peel Maintenance manager consider defining the diagonal driveway as a one
way
system, paint directional arrows on the drive and install all appropriate signage on site
as required.
3. That T & W install No U Turn signs on the east side of Elmwood in front of Forest
Ave. School .

Boris Swedak
TSC Citizen Member
Ward 3

Angie Melo

From: boris swedak <[REDACTED]>
Sent: 2014/04/03 4:44 PM
To: Angie Melo
Cc: Sheelagh Duffin; Marcotte David; Westbrook Peter
Subject: Fw: Artesian Dismissal Report

Dismissal Report

Artesian Drive Public School

Address- 3325 Artesian Dr.

Phone No. [905] 820-7786

Z # 58

ID # 207

Grades -- K-5

Dismissal Time--3:00 PM

Date of Inspection - April 3 , 2014

Weather- Overcast 3 deg.C

Adjacent to Park- Yes

Public Transit- Yes, and it does impact on Dismissal as cars parked on Artesian Dr. narrow the travel lane.

School Transport- 7 cube vans, 3 full size buses 1 dodge caravan

Parent Behavior- Reasonable

100

Parking- Single row of parking at right angles to front entry drive on the south side of school; in the street lay-by on the North side of Artesian Blvd; Main lot consisting of 2 long rows of parking on West limit of property.

Kissn' Ride- Yes a 2 lane one way drive located at the west side of school, separate from the bus exclusive storage in front of school. Parents not permitted entry to drive in the afternoon

Signs- All posted signs on school & on Right- of -way are in place .

Comments:

Very heavy volume of students observed walking home from this site.

Lots of activity on Artesian Blvd and especially on the intersecting side streets.

No conflicts observed this inspection.

Staff assist with bus loading and school ground monitoring. Principal was sited at drive entrance ,

3 vested volunteers assist with bussing activities

Dismissal works well at Artesian P.S., an very large improvement over previous inspection

in 2012. I was pleasantly surprised to see such a vast reduction in vehicle volumes and an increase in student/parent walkers even before the official launch of the walk to school program proper

I spoke to Principal Margret Wyse-Hellmut who was monitoring the drive entrance about

her concerns during Dismissal. Margret stated they are no big problems she is aware of.

She indicated she has contact with Peter Westbroke and Sheelagh Duffin regarding

Walk to school implementation and crossing guard review and is looking forward to these being perused..

Morning K & R issues are being addressed on a daily basis.

Xing Guard in place at Artesian/Long acre Dr. intersection

Recommendations:

1. That Parking Control Officer visit this site during

Dismissal Period [2:50- 3:10 PM]

10d

2. That Peel Public Maintenance Manager, review this site for inclusion in Peel's current year pavement painting contract

Boris Swedak
Traffic Safety Council
Citizen Member
Ward 3

10e

Angie Melo

From: boris swedak <[REDACTED]>
Sent: 2014/04/04 4:34 PM
To: Angie Melo
Cc: Westbrook Peter, Dale Lucas,
Subject: Fw: St. Margaret of Scotland Dismissal

Dismissal Report

School Name St. Margaret of Scotland

Address- 2266 Council Ring Rd.

Phone No.[905] 820- 5115

Z # 25 ID # 101

Grades - JK-8

Dismissal Time- 3:15 PM

Date of Inspection -April 4, 2014

Weather-- Rain 6 Deg.C

Adjacent to Park- Yes

Public Transit- No

School Transport- 4 vans various sizes

Parent Behavior- Good

Parking- Parents store in the center K & R lane during afternoon time frame, also on the south side of Council Ring Rd., a single lane at right angles to the driveway, Main lot is located at the westerly limit of school grounds, also on Chokecherry Cresc, the intersecting street.

Kissn' Ride- Yes a standard 3 lane, one way layout with exclusive bus lane adjacent to curb.

Signs- In place and adequate on the City right of way and school property.

Comments:

Parents park on both sides of Council Ring Rd. beyond the school property boundary causing a restriction and congestion to through traffic on this collector road.

Lots of students observed walking home from this school.

Crossing Guard in place at the driveway exit of St. Margaret of Scotland

No conflicts noted this inspection.

Custodian closes aluminum swing gates at 2:50 PM prohibiting entry to the main parking lot,

Vice principal and 3 vested staff members assist with bus loading and student management on school grounds.

Dismissal works well save for the traffic concerns beyond school limits.

Spoke to Principal J. Igercich regarding Dismissal program, she indicated no immediate concerns.

Stated she was in contact with Peter Westbrook regarding K& R issues.

Recommendations:

1. That Parking Control Officer visit St. Margaret of Scotland school during Dismissal [3:05-3:25 PM] to enforce existed posted "no stopping & no parking" signs on Council Ring Rd..
2. That T & W review the adequacy of signs on Council Ring Rd. beyond the school boundaries with a view to eliminate parking on both sides of the road.
3. That Catholic Board Maintenance manager review the placement of a No Left Turn sign at the driveway exit location.

Boris Swedak
Traffic Safety Council
Citizen Member
Ward 3

109

Angie Melo

From: boris swedak <[REDACTED]>
Sent: 2014/04/07 5:17 PM
To: Angie Melo
Cc: Westbrook Peter, Marcotte David
Subject: Fw: Oscar Peterson PS Dismissal Report

Oscar Peterson PS Dismissal Report

Address---5120 Perennial Dr.

Phone [905] 569-6261

Grades - K-5

Dismissal time - 3:25 PM

Date of Inspection - April 7th., 2014

Weather- Overcast, 8 deg.C

Zone # Z-57

School ID # 205

Adjacent to Park--Yes

Public Transit- Yes, on 10th. Line,

No Transit on Perennial Dr.

School Transport --3 full size buses, 2 cube vans,

Signage-In place on both school property and on adjacent right of ways of 10th. line & Perennial Dr.

Kissn' Ride--Yes, at westerly limit of school, totally separate from exclusive bus only lane in front of school. Entry drive is a two lane one way layout which splits with a raised grassed median separating the entry drive and the exclusive 2 lane bus storage lanes to the north. 10h

Parking--Single angled row at 90 deg. to thru driveway on south side of school property, 3 rows of parking in main lot at westerly sector of property, on North side of Perennial Dr, on east and west side of 10th Line in lay-by cut outs, and on Perennial Dr. Speed Humps are present in the school parking lot driving lanes. parents also store in the K & R lane during the Dismissal period

Parental Behavior- Quite Acceptable on school property. Very disorganized on adjacent streets.

Comments:

Exceptional large volume of students observed walking with parent or adult from school

School is participating in a walk to school programme

A number of parents continue to abuse the parking signs on Perennial Dr. even though more than adequate parking exists around the site. Adequate parking on 10 th. Line

No conflicts noted with students and autos this date

A number of vested volunteers were monitoring students waiting to access buses and crossing the parking areas.

Dismissal works relatively well at Oscar Peterson PS due to efforts of the vested volunteers assisting parents who store in the K & R drop off lane during the afternoon time frame

Approximately 950 students attend this P.S., Oscar Peterson is a French Immersion school

There was some thought of installing a Lay-by on the north side of Perennial Dr. to assist with the free flow of traffic along this road and providing a few additional parking spots. It is my opinion that the parking and exit traffic from the Lay-by would cancel any benefit

10⁵
achieved for the 15 minute Dismissal time frame in question.

Spoke to Vice Principal D Sidial regarding school concerns at Dismissal. These are a number of issues we both identified:

- a." Parent behaviour or lack of same, in adhering to existing posted traffic signs on adjacent right of ways.
- b. Congestion and back up of traffic attempting to gain access to driveway entrance, both right and left turn moves off Perennial Dr.
- c. Since there are `` No Left Turn Signs `` posted at driveway exit, parents now experience delays at Eglinton-Perennial drive intersection which it is not signalized.
- d. Crossing Guard at Perennial Dr.-10 th Line intersection crosses students with the light, and due to high volume of walkers, vehicles attempting to make left turns on Perennial Dr. or right turns on Perennial Dr. & 10 th. Line can only accomplish same during a yellow signal.

Recommendations:

- 1. That Parking Control Officer visit Oscar Peterson PS during the Dismissal period [3:10-3:35 PM] to ensure compliance with posted signs on Perennial Dr. & 10th Line. That there be a minimum of 3 consecutive days of enforcement.
- 2. That T & W undertake a traffic light study to determine if warrants exist for lights at Perennial-Eglinton Intersection
- 3. That Crossing Guard Supervisor review procedures at 10 th. Line-Perennial intersection to determine if improvements are possible.

Boris Swedak
Traffic Safety Council
Citizen Member
Ward 3

Angie Melo

105

From: boris swedak [REDACTED]
Sent: 2014/04/08 5:05 PM
To: Angie Melo
Cc: Westbrook Peter
Subject: Fw: St Hubert Dismissal Report

School Name . St. Hubert CS

Address- 5180 Fallingbrook Dr.

Phone No. [905] 858-1171

Z # 38 -E ID # 187

Grades JK-8

Dismissal Time- 3:30 PM

Date of Inspection April 8th. 2014

Weather- Sun -cloud mix 8 deg. C

Adjacent to Park- Yes

Public Transit- Yes , but no impact on Dismissal

School Transport- 1 cube van

Parent Behavior- Acceptable

Parking- A parking lot located at the southerly end of property consisting of 4 lanes oriented in an east-west direction plus one north- south lane, on Fallingbrook Dr. where signs permit , parents park in K & R lane during afternoon timeframe

Kissn' Ride- Yes a one way 3 lane layout with exclusive bus lane adjacent to curb

Signs- Yes, in place and quite adequate

10K

Comments:

Lots of walkers leaving school in the afternoon.

No observed conflicts this inspection

The area has three schools clustered in a contained area and lots of vehicles picking up students between the hours of 2:45-3:30 PM

Staff volunteers assist with bus loading

Dismissal works well at St. Hubert

Recommendations:

1. That Parking Control Officer visit this site during Dismissal Period [3:20-3:40 PM] and enforce the posted signs on Fallingbrook Dr.

Boris Swedak
Traffic Safety Council
Citizen Member
Ward 3

Angie Melo

From: boris swedak [REDACTED]
Sent: 2014/04/09 5:20 PM
To: Angie Melo
Cc: Marcotte David; Westbrook Peter
Subject: Fw: Castlebridge PS DISmissal Report

Dismissal Report

School Name- Castlebridge PS

Address- 2801 Castlebridge Dr.

Phone No. [905] 812-7906

Z # 39 W ID # 188

Grades -- K-6

Dismissal Time- 3:30 PM

Date of Inspection-April 9th., 2014

Weather- Sunny 12 deg. C

Adjacent to Park-Yes

Public Transit- No

School Transport-6 cube vans, 2 caravans

Parent Behavior- Very good

Parking-north side of Castlebridge Dr., in a parking pod located on the east side of the school consisting of 3 lanes, parking in the wide front exit drive, along the curb side of the easterly parking lot K & R drive

Kissn' Ride-- A drop off along the curb lane of the easterly parking lot, totally separate from the exclusive bus lane located at the front of school.

Signs- Well placed and visible on both school grounds and roadway

10m Comments:

3 vested staff members assist with the Dismissal procedure monitoring students leaving school, bus loading and crossing students at asphalt driveway at entrance

High volume of students observed walking home

Many students are seen biking home from school with bicycle stand in place at K & R location

No conflicts observed this inspection

Driveway needs to be repainted especially the pedestrian cross walk hatching

Spoke to Principal M Haddad regarding her concerns during Dismissal. She indicated the gridlock at times with entry vehicles, busses and exiting parents.

I can attest to the fact that I have never before observed such a high volume of autos picking up area students, all within walking distance of their homes, in my 15 year service with TSC

Most, if not all of the Principal's concerns could be erased if these parents would walk to and from Castlebridge public school.

Pavement markings for pedestrian crossing requires attention as they are faded

Xing guard in place and crosses students at Glen Erin and Castlebridge Dr. intersection

It is my understanding that next term, Castlebridge will become a French Immersion School. This will increase the volume of autos as the catchment area will become larger signifying more cars.

Dismissal works quite well at Castlebridge PS

Recommendations:

1. That Peel Maintenance staff place Castlebridge PS on the 2014 painting contract.
2. That Parking Control Officer visit Castlebridge PS During Dismissal period, 3:15 PM — 3:40 PM to enforce the posted street signs.

3. That Principal M. Haddad be requested to encourage more parents to leave their cars at home during Dismissal and walk their children home from school. 10n

Boris Swedak
Citizen Member
Traffic Safety Council
Ward 3

10 0.
Angie Melo

From: boris swedak [REDACTED]
Sent: 2014/04/14 4:14 PM
To: Angie Melo
Subject: Fw: Erin Centre Dismissal Report

Dismissal Report

School Name- Erin Centre Middle School

Address-3240 Erin Centre Blvd

Phone No. [905] 820 5720

Z # 57

ID # 204

Grades- 6-8

Dismissal Time-2:30 PM

Date of Inspection-April 14 ,2014

Weather- Overcast/Showers 20 deg. C

Adjacent to Park-Yes

Public Transit-Yes, but there is no impact on Dismissal Proceedure

School Transport- 2 cube vans, 2 dodge caravans, 2 full size buses

Parent Behavior- Good

Parking- 5 long rows of parking straddled between 2 lane one way entrance and exit driveways;

parking on the west side of 10th Line in marked out stalls; on the south side of Erin Centre

Bld. in the lay-by ; and in the designated K &R lane during the afternoon period.

Kissn' Ride- Yes, a vey long entry drive consisting of a 2 lane , one way layout provides for storage behind the forward exclusive curb side bus lane only location at the front of the drive.

Signs- Very good placement of signs and very visible pavement markings on this site and on City right-of-way

10p.

Comments:

Excellent layout providing for a good dismissal procedure.

School staff and Principal assist with monitoring students during Dismissal

Many students observed walking from school.

No conflicts observed during this inspection

Dismissal works well at Erin Centre Middle School

Recommendations:

1. That Traffic Control Officer visit this site during Dismissal [2:20-2:35 p.m.] to ensure adherence to posted signs on both 10th. line and Erin Centre Blvd.

Boris Swedak
TSC Citizen Member
Ward 3

109
Angie Melo

From: boris swedak [REDACTED]
Sent: 2014/04/15 5:18 PM
To: Angie Melo
Cc: Westbrook Peter; Dale Lucas,
Subject: Fw: Form

Dismissal Report

School Name St Timothy CS

Address 2214 Cliff Rd

Phone No. [905] 277-0990

Z # 14

ID # 133

Grades K-8

Dismissal Time 3:30 PM

K dismissed at 3:20 PM

Date of Inspection April 14th 2014

Weather -Overcast, Cold -1 deg. C

Adjacent to Park- No

Public Transit -No

School Transport- 1 Full size Bus, 2 Caravans

Parent Behaviour Good

Parking- 2 single lanes with drive through lane located on north side of school site, Parents store in curb side K & R Lane during Dismissal period.

Kissn' Ride- 2 lane , one way driveway at north side of school ,bus lanes totally separate and located on East side of school, Driveway exit consists of 3 lanes, the bus lane with 2 through lanes.

Signs- in place on school site, Fire route signs posted along east 3 lane exit driveway but not along the north K & R lanes

Comments:

Vested school volunteers assist with Dismissal procedures

One way entrance is off Cliff Rd. located at north limit of school, continuing into the drive through of parking stalls & evolving into 2 lane K & R lane. There is such a volume of autos that a backup of cars is evident on Cliff Rd proper

Large number of students walk home from St Timothy

Unbelievable large number of vehicles, 80 plus, pick up children during Dismissal

This school was recently refurbished and is properly signed .

Dale Lucas is requested to determine if there is a fire route area along the K & R lane, if so, appropriate Fire Route signs are to be installed at this location.

Recommendations.

1. That Traffic Control Officer visit St. Timothy during Dismissal Period, 2:50 PM-3:40 PM to enforce posted signs on Cliff Rd.
2. That the Principal of St. Timothy CS be requested to encourage parents presently driving during the Dismissal period to have their children walk to school

Boris Swedak
Traffic Safety Council
Citizen Member
Ward 3

School Zone Safety (Kiss & Ride) Report
March and April 2014

Attended By: Peter Westbrook

March 20, 2014

Lisgar Middle School (Ward 10)

COMMENTS

Kiss & Ride works well with high volume of cars.

RECOMMENDATION

1. That the Peel District School Board be requested to consider relocating the drop off for Kiss & Ride at Lisgar Middle School, to the south side of the building, to create a larger storage area for cars in the queue to drop off students.
2. That the Principal at Lisgar Middle School be requested to ensure staff at the Kiss & Ride wear the safety vests.

March 26, 2014

Clifton Public School (Ward 7)

COMMENTS

Parents are stopping and parking where they want to.

RECOMMENDATION

That the Peel District School Board be requested to review the feasibility of the following at the Kiss & Ride at Clifton Public School:

- a. Install Kiss & Ride sign and stop bar at the drop off areas located at the south side of the building.
- b. Fire Route signage on property.
- c. Creating a walkway for parents, from the south part of the parking lot.
- d. Repaint the pavement signs before the start of school in September 2014.

March 27, 2014

Sheridan Park Public School (Ward 2)

COMMENTS

Kiss & Ride works well with high volume in a small area.

RECOMMENDATION

That the Peel District School Board be requested to consider the following at Sheridan Park Public School:

- a. Install a "No Left Turn" sign on driveway exit; and,
- b. Place Kiss & Ride signs on the driveway

April 2, 2014

Corpus Christi Catholic School (Ward 4/6)

COMMENTS

Two drop off areas.

RECOMMENDATION

That the Dufferin-Peel Catholic District School Board be requested to consider the following at Corpus Christi Catholic School:

- a. Review the Kiss & Ride and Fire Route signage.
- b. Mark two lanes for traffic to exit the driveway.
- c. Move the stop bar located in the Kiss & Ride to all buses more room.



Traffic Safety Council
APR 23 2014

MINUTES

TRAFFIC SAFETY COUNCIL – BUDGET SUBCOMMITTEE

THE CORPORATION OF THE CITY OF MISSISSAUGA
WEDNESDAY, April 2, 2014 – 1:10 P.M.

BOARDROOM 2B, SECOND FLOOR
300 CITY CENTRE DRIVE, MISSISSAUGA, ONTARIO L5B 3C1
MISSISSAUGA, ONTARIO
www.mississauga.ca

Members Present

Heather Relf, Citizen Member
Sushil Kumra, Citizen Member
Peter Westbrook, Citizen Member

Staff Present

Sheelagh Duffin, Crossing Guard Supervisor
Angie Melo, Legislative Coordinator

Contact: Angie Melo, Legislative Coordinator
Office of the Clerk 905-615-3200 ext. 5423 Fax 905-615-4181
angie.melo@mississauga.ca

CALL TO ORDER - 1:10 P.M.

DECLARATIONS OF CONFLICT OF INTEREST - Nil

PRESENTATIONS/ DEPUTATIONS - Nil

MATTERS TO BE CONSIDERED

1. Review of Traffic Safety Council General Ledger and Budget Monitoring Report for 2013

The Budget Subcommittee reviewed the Council General Ledger and Budget Monitoring Report outlining Traffic Safety Council expenditures in 2013.

2. Review Draft 2014 Traffic Safety Council Budget

The Draft 2014 Traffic Safety Council Budget was presented, reviewed and discussed. The subcommittee noted the proposed budget allocation for each expense incurred by Traffic Safety Council and amended the draft budget where required.

The proposed amendments to the Draft Budget were as follows:

- It was suggested that the Crossing Guard Appreciation gift budget allocation be increased to \$1,500.00 for Crossing Guard gifts.
- It was suggested that the Crossing Guard Appreciation Award budget allocation be increased to \$2,300.00 for Crossing Guard long service awards.
- It was suggested that no funds be allocated to the Promotional Items for as there is no need to make any purchases for the year 2014.
- With the responsibility for the Kiss & Ride Program moving over to the School Boards for the new school year in 2014, it was determined that the allocation would be reduced to \$4,500.00 from \$8,500.00.
- It was suggested that the Walking School Routes Program budget allocation be increased from \$11,000 to \$16,500.00 to cover costs to replenish stock.

- It was suggested that the Conferences budget be increased to \$6,500 from \$5,700.00 and that the Legislative Coordinator place an item on the upcoming Traffic Safety Council Agenda, regarding the Ontario Traffic Council 2014 Conference in Kitchener.
- It was suggested that Printing/Creative Services budget be increased to \$2,000.00 to cover costs of updating Traffic Safety Council literature.
- It was suggested that the Mileage budget allocation be reduced from \$8,500.00 to \$7,400.00 as it is anticipated that the site visits for the purpose of conducting Kiss & Ride and Dismissal inspections would be reduced as a result of the School Boards taking responsibility of these programs.

OTHER BUSINESS

2013-2014 SCHOOL SAFETY PATROLLER PROGRAM

Angie Melo, Legislative Coordinator advised the Budget Subcommittee of an email she received from Michelle Vivian, dated April 2, 2014 requesting that the Traffic Safety Council consider funding Mississauga students at this event. The cost for each patroller is \$225.00. The committee discussed the matter and suggested that the Traffic Safety Council sponsor three participants.

RECOMMENDATION

That the amount of \$775.00 be allocated in the 2014 Traffic Safety Council Operating Budget to send three Mississauga students to participate in the 2013/2014 School Safety Patroller Program.

OTC & CITE JOINT CONFERENCE

This year's conference will be held on June 1 to June 4, 2014 in Kitchener, Ontario. The cost for the conference is \$645.00 per participant, not including travel and accommodations. Members of the Traffic Safety Council will have an opportunity to express their interest in attending the conference, at the April 23, 2014 Traffic Safety Council meeting, as this item will be added to the agenda.

Date of Next Meeting – TBD

ADJOURNMENT - 2:45 P.M.

DRAFT TRAFFIC SAFETY COUNCIL NON-DEPARTMENTAL BUDGET 2014

Total Budget Allocated = \$84,800.00

<u>School Board/City Directories</u>	<u>Allocated</u>
City of Mississauga Street Guides (13 guides)	\$ 150.00
<u>Crossing Guards</u>	
Appreciation Day - June	\$ 2,000.00
Appreciation Dinner Gifts - December	\$ 1,500.00
Appreciation Dinner Awards - December	\$ 2,300.00
Promotional Items	0.00
<u>Kiss & Ride Program</u>	
Equipment (cones, stop signs, weights)	\$ 1,500.00
Safety Vests (orange & green)	\$ 1,000.00
Promotional items	\$ 0.00
Volunteer Recognition – June (4 schools @ \$500/school)	\$ 2,000.00
<u>Walking to School Program</u>	
Walking School Routes Program Implementation	\$16,500.00
<u>Membership</u> – Ontario Traffic Council	\$ 300.00
<u>Conferences</u> - Ontario Traffic Conference 2012	\$ 6,500.00
<u>TSC Christmas Dinner</u>	
Appreciation Dinner/Meeting - December	\$ 2,000.00
Appreciation Gifts for TSC Members (15 x \$10.00)	\$ 150.00
<u>Printing/Creative Services</u> (pamphlets, brochures)	\$ 2,000.00
<u>TSC Promotional Items</u>	\$ 3,700.00
<u>Mileage</u>	\$ 7,400.00
<u>TOTAL</u>	<u>\$49, 000.00</u>

***Please note: the following was allocated for a special project namely the Traffic Safety Council Instructional DVD and is not included in the regular Traffic Safety Council budget.*

*****TSC Instructional DVD** **\$35,000.00**

Total Including Instructional DVD allocation **\$84,000.00**

****Please note: that \$200.00 per year can be awarded by the Traffic Safety Council for the Dr. Arthur Wood Safety Award and \$2,075.00 in sympathy contributions is being held in reserve for this purpose.*

12d

Angie Melo

From: Angie Melo
Sent: 2014/04/16 11:37 AM
To: Angie Melo
Subject: FW: School Safety Patrol Leadership Camp - Funding Request 2014

From: Michelle Vivian [REDACTED]
Sent: 2014/04/02 12:23 PM
To: Sacha Smith
Subject: School Safety Patrol Leadership Camp - Funding Request 2014

April 2014
City of Mississauga – Office of the City Clerk
Sasha Smith
Committee Coordinator – Traffic Safety Council

2013-2014 SCHOOL SAFETY PATROLLER PROGRAM

The Canadian Automobile Association (C.A.A) first developed the School Safety Patrol Program in 1929. During this time the automobile was quickly rising in popularity and as a result school aged children were being struck at an alarmingly high rate. This program was designed to educate young people about the dangers of traffic and how they could take charge and protect themselves and other from injury and/or possible death to and from school.

The Canadian Automobile Association partners with more than 55 Ontario Police Services, who in turn deliver the program to more than 800 Schools across Ontario. Since its conception 25,000 students volunteer their time each year to become Safety Patrollers.

Peel Regional Police have been involved with The School Safety Patrol Program for over 18 years. We instruct approximately 1800 children every September on how to be Bus Patrollers. These students arrive at the Peel Children's Safety Village where they receive the required information from a qualified Police instructor. Their training involves verbal lessons, physical mock evacuations and a written test.

The students chosen for this program display exceptional skills of leadership, they are confident in the jobs they are required to do, they have qualities that make them dependable and they show true values. These children volunteer their time not for money or status; they do it because they believe in helping other children.

For the last 45 years, C.A.A. has been hosting a very important camp for Safety Patrollers across Ontario. Camp Samac is held every year at the Boy Scout camp in Oshawa. This year, camp runs from Tuesday July 15th, 2013 to Friday July 18th, 2014. Approximately 30 Police Officers from across Ontario attend and are in charge of the campers. During this week-long camp, nearly 200 Safety Patrollers learn the skills required to save a life including basic first aid training, fire safety, team building, bus patrol training, evacuations and the information required to become a Safety Patrol Captain. A Safety Patrol Captain will be that child who the following school year assists the Safety Patrol Supervisor with general duties.

Last year, as a result of your generous donation, we were able to send 3 safety patrollers from Mississauga to at no expense to the student. It is our goal again, this year to collectively send a minimum of 20

students, from the Mississauga, Brampton and Caledon areas. To date we have received 6 applications from 12e
patrollers in Mississauga. The cost for each patroller is \$225.00; this includes all scheduled events, all
meals, accommodations and all transportation. We also provide each camper with a t-shirt and a
sweatshirt/jacket which bears our patroller logo.

It would be greatly appreciated if the City of Mississauga – Traffic Safety Council would consider funding
these Mississauga students to attend.

If you would like to support the Mississauga students for this worthwhile event, please contact Constable
Michelle Vivian at (905) 453-2121 ext. 4070. We will not require the funds until MAY 2014; however we
would appreciate a letter of intent as soon as possible to be able to make the necessary arrangements.

Yours truly,

Cst. Michelle Vivian, #1445
Peel Children's Safety Village
905-453-2121 ext: 4070

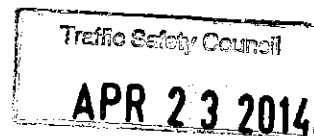
MINUTES

TRAFFIC SAFETY COUNCIL – WALK TO SCHOOL SUBCOMMITTEE

THE CORPORATION OF THE CITY OF MISSISSAUGA
WEDNESDAY, April 11, 2014 – 10:00 a.m.

BOARDROOM 2D, SECOND FLOOR
300 CITY CENTRE DRIVE, MISSISSAUGA, ONTARIO L5B 3C1
MISSISSAUGA, ONTARIO
www.mississauga.ca

Members Present

Louise Goegan (Chair)
Peter Westbrook (Citizen Member)
Dan Suess (Citizen Member)
Altamash Syed (Citizen Member)

Staff Present

Sheelagh Duffin, Crossing Guard Supervisor
Angie Melo, Legislative Coordinator

Contact: Angie Melo, Legislative Coordinator
Office of the Clerk 905-615-3200 ext. 5423 Fax 905-615-4181
angie.melo@mississauga.ca

CALL TO ORDER - 10:07 a.m.

ITEMS FOR DISCUSSION:

1. Selection of Chair

Peter Westbrook nominated Louise Goegan as Chair of the Walk to School Subcommittee. Ms. Goegan accepted the nomination and the motion was passed.

RECOMMENDATION

That Louise Goegan be appointed as Chair of the Traffic Safety Council's Walk to School Subcommittee for a term ending on November 30, 2014 or until a successor is appointed.

2. Allocation of Budget Funds for Walk to School Subcommittee

Angie Melo, Legislative Coordinator provided a verbal update on the budget allocation for the Walk to School Program that is being proposed at the next Traffic Safety Council meeting. Moving forward, Ms. Melo advised that she will be tracking inventory of the supplies purchased and the cost of those supplies.

3. Update of Present Projects

Sheelagh Duffin, Supervisor, Crossing Guards advised that she has prepared the spring baskets.

Louise Goegan, Chair, advised that there are two schools launching their Walk to School program. Artesian Drive Public School will launch on April 16, 2014, and St. Margaret of Scotland School will launch on May 14, 2014.

4. Review of School Participation Criteria

The Walk to School Subcommittee of the Traffic Safety Council reviewed the School Participation Criteria for the School Walking Routes Program and made appropriate changes:

5. Support of Other Initiatives

Louise Goegan, Chair, opened discussions regarding the request from Travel Plan to have the Traffic Safety Council's support to provide pencils for their program initiative. Discussion ensued with respect to sharing resource materials, with organizations, whether Traffic Safety Council members participate or do not participate in events hosted by other organizations.

It was decided that the Traffic Safety Council would not provide promotional materials for events that members of the Traffic Safety Council do not participate in; however, the Traffic Safety Council would provide educational literature, such as the TSC Times, which is more helpful to provide awareness of the issues and remedies for school zone safety.

6. Direction for Upcoming Year

Louise Goegan, Chair, advised that there are currently 18 schools that participate in the Walk to School Program, and that there are two schools, Artesian Drive Public School and St. Margaret of Scotland School, who will launch their Walk to School Program within the next month. This will bring a total of 20 schools participating in the Walk to School Program.

Members of the Walk to School Program have been working with Barondale Public School and St. Bernard of Clairvaux Catholic School to launch the Walk to School Program in the fall, although other schools will also be canvassed.

OTHER BUSINESS

ADJOURNMENT - 11:45 p.m.

NEXT MEETING

To be scheduled after May 14, 2014

TRAFFIC SAFETY COUNCIL
Transportation and Works - Action Items

Feb-14			
Reference	School / Location	Item	Action
TSC-0052-2014	Divine Mercy Elementary School.	1. That Transportation and Works be requested to review signage in the school area and to consider installing "No U-turn" signs in front of Divine Mercy Elementary School.	utility locates required to accommodate this request
TSC-0053-2014	Olive Grove Private School.	1. That Transportation and Works be requested to review the "No Parking" and "No Stopping" signs in the school zone near Olive Grove Private School.	work order issued
TSC-0065-2014	Canadian Martyrs Catholic School	1. That Transportation and Works be requested to review the signage located in front of Canadian Martyrs Catholic for clarity.	signage is adequate

Traffic Safety Council
APR 23 2014

Parking Enforcement Report – March 2014

Traffic Safety Council

APR 23 2014

School Name	Offence Code	Values	
		Issued Tickets	Total Visits
All Saints	27	2	1
Allen A Martin Sr.	(blank)		3
Artesian Drive	43	2	1
	(blank)		1
Ashgrove	43	1	1
Barondale	12	3	2
	27	3	2
	43	12	6
	(blank)		4
Bishop Scalabrini	17	1	0
	27	3	2
Brandon Gate	43	3	1
	(blank)		1
Brian W Fleming	43	8	3
Briarwood	27	4	3
Bristol Rd. Middle	(blank)		5
Britannia	17	1	0
	43	2	1
Burnhamthorpe	15	1	0
	17	1	0
	27	4	2
	42	2	1
	43	2	1
	(blank)		0
Canadian Martyrs	17	4	1
	27	8	0
	43	8	5
	(blank)		3
Castlebridge	27	3	1
Christ The King Catholic	27	3	1
Corliss	(blank)		3
Corsair	27	3	0
	43	6	1
Credit Valley	27	10	4
	43	1	1
Divine Mercy	42	2	1
Dunrankin Drive	27	3	2
Edenrose	27	14	4
Fairview	43	2	1

Parking Enforcement Report – March 2014

Father Daniel Zanon	43	1	1
Floradale	29	3	1
	(blank)		1
Forest Glen	(blank)		2
Glenhaven Sr	15	1	0
	42	1	1
	(blank)		0
Hawthorn	42	1	1
Hazel McCallion Sr.	27	1	1
Hillcrest Middle	(blank)		1
Holy Cross	27	4	1
	(blank)		3
Homelands Sr.	(blank)		2
Huntington Ridge	27	1	1
	43	6	2
Kindree	43	10	4
	(blank)		2
Lancaster	42	2	1
	43	1	1
Lisgar Middle	27	1	1
Lorne Park	42	1	1
	(blank)		0
McBride Avenue	(blank)		1
McKinnon	43	6	2
	(blank)		4
Mentor College	12	1	1
	15	1	0
	42	3	1
	43	1	0
Middlebury	27	1	1
Mineola	(blank)		1
Morning Star Middle	(blank)		1
Munden Park	(blank)		2
Nahani Way	7	1	1
	17	1	1
	27	6	2
	43	4	2
	(blank)		2
Oscar Peterson	15	1	1
	27	4	3
	43	8	1

Parking Enforcement Report – March 2014

	(blank)		2
Osprey Woods	7	2	0
	27	1	1
	43	6	3
Our Lady of Mt. Carmel	43	2	1
Plum Tree Park	26	1	1
	43	5	3
	(blank)		3
Queen of Heaven	43	3	3
	(blank)		3
Ridgewood	43	4	1
Ruth Thompson Middle	(blank)		1
San Lorenzo Ruiz	43	7	4
Sawmill Valley	27	2	1
Sheridan Park	27	1	1
	(blank)		1
Sherwood Mills	27	6	1
St. Albert of Jerusalem	(blank)		1
St. Basil	43	4	2
	(blank)		0
St. Bernard of Clairvaux Catholic	27	1	1
	43	1	1
	(blank)		2
St. Faustina	27	1	1
St. Francis of Assisi	27	2	2
	43	1	1
St. Hilary	27	2	1
St. John of the Cross	43	1	1
St. Joseph (Mississauga)	27	1	0
	43	4	2
	(blank)		2
St. Jude	27	1	1
	43	3	3
St. Louis	27	1	0
	(blank)		2
St. Luke Catholic	27	1	1
	43	1	1
	(blank)		0
St. Margaret of Scotland	12	1	1
	27	1	1
	43	9	3

Parking Enforcement Report – March 2014

	(blank)		6
St. Mark	27	1	1
St. Pio of Pietrelcina	43	1	1
St. Raphael	27	1	1
St. Raymond	27	2	2
St. Richard	43	1	1
St. Sofia	43	2	1
St. Teresa of Avila	27	1	1
St. Vincent de Paul	(blank)		1
Sts. Martha & Mary	(blank)		1
T.L. Kennedy	27	1	1
Tecumseh	7	1	1
	43	1	1
	(blank)		2
Trelawny	43	12	5
Westacres	(blank)		1
Whitehorn	3	1	1
	24	1	1
	43	5	2
	(blank)		10
Whiteoaks	7	1	0
	(blank)		2
Willow Glen	(blank)		3
Willow Way	27	1	0
	43	2	1
Glenforest	(blank)		2
Horizon Jeunesse	27	1	1
	43	1	1
Olive Grove	27	6	3
Ascension Of Our Lord	(blank)		1
Garthwood Park	27	1	1
Team	43	4	3
	(blank)		1
Father Michael Goetz	27	1	1
Grand Total		319	245

APR 23 2014

A member of the Institute of Transportation Engineers

Canadian Institute
of Transportation Engineers

HOME

EMPLOYMENT
OPPORTUNITIES

NEWS AND UPDATES

RESOURCES AND
PUBLICATIONSSCHOLARSHIPS AND
AWARDS

EXECUTIVE

SECTIONS

STUDENTS

TECHNICAL LIAISON
COMMITTEE

VOLUNTEERING

CONFERENCES

Waterloo Region 2014

Registration & Hotel

Find Us

Guest Speakers

Special Events

Call for Abstracts

Speakers Info

Famous Contest

Exhibitor Opportunities

Sponsorship
Opportunities

Calgary 2013

2013 Compendium

Winnipeg 2012

2012 Compendium

Halifax 2011

2011 Compendium



Institute of Transportation Engineers

Ontario
Traffic
CouncilREGION OF JUNE 14
WATERLOO 2014TRANSPORTATIONfest
A Celebration of Innovation

FOLLOW US

Registration and Hotel

The Waterloo Region LAC is working hard to deliver a leading-edge technical program and an exciting mix of activities, and we look forward to meeting you in Kitchener!

2014 CONFERENCE REGISTRATION & FEES

All of the applicable conference fees are listed below and once again CITE is offering full online registration, with real-time credit card processing. Our online registration site is now ready, but before you proceed to our e-commerce site we ask that you take a few minutes to review the following:

[Click here](#) to proceed with the online conference registration.

REGISTRATION - FULL

	Early Bird	After April 21st
Full Registration	\$595	\$645
Students	\$275	\$275

REGISTRATION - DAILY

	Early Bird	After April 21st
Monday	\$300	\$325
Tuesday	\$300	\$325
Wednesday	\$300	\$325

EVENTS & ACTIVITIES (extra tickets)

Full registration includes one complete set of event tickets.
Daily registration includes event tickets for the day-of with the exception of the Monday banquet (which must be purchased in addition).

Welcome Reception	\$10 per
Lunch Tickets	\$35 per
Monday Banquet	\$60 per

169

Special Note: Ontario HST (13%) will be applied in addition to all above noted

Changing or Cancelling an Order:

All change or cancellation requests must be submitted in writing to our WaterlooRegion2014_Finance@cite7.org. A full refund will be provided if the request is received prior to May 19, 2014 (23:55 EDT). A 50% refund is provided if the request is received prior to May 26, 2014 (23:55 EDT). No refunds or change orders will be accepted after May 26, 2014.

For more information contact: WaterlooRegion2014_Finance@cite7.org

THE CROWNE PLAZA HOTEL



The Crowne Plaza Kitchener-Waterloo is Kitchener's largest and premier full service hotel. Ideally located in the heart of downtown Kitchener, the Crowne Plaza Kitchener-Waterloo is the jewel of downtown, providing upscale accommodations and meeting/conference facilities. With a multi-million dollar renovation completed each guest room is brand new, offering our guests a luxurious stay. Three special room rates are available for CITE / OTC delegates. To book, please use this direct [booking link](#) or use group code "CTE".

PLEASE NOTE that this special rate is only guaranteed until April 30, 2014.

Standard Two Queen Bed Room	\$119 per night
King Executive Room	\$139 per night
King Suite Room	\$179 per night

GETTING HERE

As there are so many options for you to choose from we have set-up a dedicated page with directions at... [Find Us](#)

TOURISM INFORMATION

Imagine a place where old traditions meet new, where urban meets rural, where nature leads to great adventures, where distinguished events and festivals unite friends and family, a place for you to explore... Waterloo Region is a vital and prosperous area in southern Ontario. It is comprised of three bustling urban cities: Cambridge, Kitchener and Waterloo plus four scenic rural townships: North Dumfries, Wellesley, Wilmot and Woolwich. Excite your taste buds at farmers' markets, renowned restaurants and microbreweries. Find outstanding antiques and hand crafted goods in St. Jacobs and be captivated by the largest outdoor market in Canada. Discover the Grand outdoors: camp, fish, paddle or make a splash at the water-park. Go wild at the Safari or unwind with butterflies. Take part in the largest Oktoberfest outside of Munich and the best Blues Festival in the province! Experience great entertainment including the KW Symphony, theaters, live music and ballet performances. Discover Mennonite culture that still exists today by visiting our Townships and going on a horse-drawn trolley tour of a Mennonite farm.

<http://www.explorewaterlooregion.com/>

PRIVACY COPYRIGHT TERMS OF USE CONTACT US

COPYRIGHT 2008-2014. CANADIAN INSTITUTE OF TRANSPORTATION ENGINEERS

transportation and distinguished service. These awards, presented during the Awards Luncheon, bestow recognition upon the recipients, and increase the public's awareness of the role and responsibilities of the transportation practitioner.

Please note that the CITE/OTC Awards Luncheon is a ticketed event, and your full registration package includes one (1) lunch ticket. Additional tickets (\$35.00 each) may be purchased online along with your conference registration.

[PRIVACY](#) [COPYRIGHT](#) [TERMS OF USE](#) [CONTACT US](#)

COPYRIGHT 2008-2014, CANADIAN INSTITUTE OF TRANSPORTATION ENGINEERS

116c

A member of the Institute of Transportation Engineers

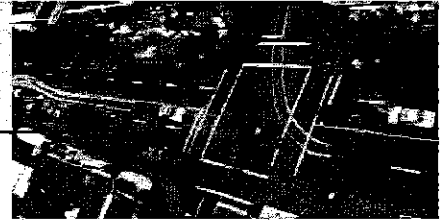
Canadian Institute
of Transportation Engineers

HOME

EMPLOYMENT
OPPORTUNITIES

NEWS AND UPDATES

RESOURCES AND
PUBLICATIONSSCHOLARSHIPS AND
AWARDS

EXECUTIVE

SECTIONS

STUDENTS

TECHNICAL LIAISON
COMMITTEE

VOLUNTEERING

CONFERENCES

Waterloo Region 2014

Registration & Hotel

Find Us

Guest Speakers

Special Events

Call for Abstracts

Speakers Info

Famous Contest

Exhibitor Opportunities

Sponsorship
Opportunities

Calgary 2013

2013 Compendium

Winnipeg 2012

2012 Compendium

Halifax 2011

2011 Compendium

REGION OF JUNE 1-4
WATERLOO 2014TRANSPORTATIONfest
A Celebration of Innovation

FOLLOW US

Special Events Highlights

SUNDAY, JUNE 1
Welcoming Reception

The traditional Sunday evening Welcoming Reception will provide you with the opportunity to catch up with fellow attendees and friends while you enjoy beverages and appetizers in the relaxed atmosphere of our conference exhibitor area.

Please note that this is a ticketed event, and your full registration package includes one (1) reception ticket and two (2) complimentary beverage tickets. Additional event tickets (\$10.00 each) may be purchased online along with your conference registration.

MONDAY, JUNE 2
Opening Session with Keynote Speaker: Iain Klugman, CEO of Communitech

Luncheon with Guest Speaker – Dr. Jeff Casello, University of Waterloo

For more information on our guest speakers, visit our [Guest Speakers page](#).

Please note that the luncheon is a ticketed event, and your full registration package includes one (1) lunch ticket. Additional tickets (\$35.00 each) may be purchased online along with your conference registration.

Banquet

The dinner banquet will be held at one of Waterloo Region's oldest traditional fest halls, The Schwaben Club. Delegates will enjoy a traditional Oktoberfest party, complete with a special Oktoberfest menu, traditional German dancers, and live entertainment by a local German Oktoberfest band.

Please note that this is a ticketed event, and your full registration package includes one (1) banquet ticket.

Additional tickets (\$60.00 each) may be purchased online along with your conference registration. For anyone requiring special meal considerations please make appropriate note during the online registration process.



TUESDAY, JUNE 3 **CITE Past President's Breakfast**

A conference regular, the Past President's Breakfast provides a forum for District and Section presidents, either currently sitting or who have completed their term in office, to discuss matters affecting the Canadian District, and serves as a think tank to identify issues on which the CITE Executive should focus in the coming years.

Luncheon with Guest Speaker: Rod Regier, Executive Director of Economic Development for the City of Kitchener

For more information on our guest speakers, visit our [Guest Speakers page](#).

Please note that this is a ticketed event, and your full registration package includes one (1) lunch ticket. Additional tickets (\$35.00 each) may be purchased online along with your conference registration.

Street Hockey Challenge 2014 at Kitchener City Hall Square

The annual hockey game will be coming to the conference with a twist this year: CITE versus OTC. Come support your organization of choice by grabbing a stick or cheering on the sidelines. The game will be held in the Civic Square of Kitchener City Hall on Tuesday after the technical program ends for the day.



Student Mixer at Bobby O'Brien's:

Join us Tuesday evening after the hockey game for our annual student mixer. This will be a great opportunity for students and employers to get to know one another over a pint and enjoy the laid back atmosphere of Bobby O'Brien's, a local pub. There will be food and activities to help everyone get acquainted.



WEDNESDAY, JUNE 4 **CITE Collegiate Traffic Bowl**

Teams from across Canada will travel to Waterloo Region to compete in the CITE Traffic Bowl. The 2014 winners of the Canadian District event will travel to Seattle, Washington to compete in the ITE Collegiate Traffic Bowl to be held during the ITE 2014 Annual Meeting and Exhibit this coming August.



Joint CITE / OTC Awards Luncheon & Annual General Meeting:

Each year, the Canadian Institute of Transportation Engineers and the Ontario Traffic Council present a series of awards to honour outstanding achievement in

A member of the Institute of Transportation Engineers

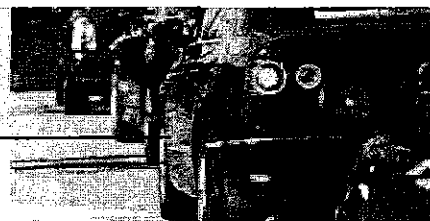
Canadian Institute
of Transportation Engineers

HOME

EMPLOYMENT
OPPORTUNITIES

NEWS AND UPDATES

RESOURCES AND
PUBLICATIONSSCHOLARSHIPS AND
AWARDS

EXECUTIVE

SECTIONS

STUDENTS

TECHNICAL LIAISON
COMMITTEE

VOLUNTEERING

CONFERENCES

Waterloo Region 2014

Registration & Hotel

Find Us

Guest Speakers

Special Events

Call for Abstracts

Speakers Info

Famous Contest

Exhibitor Opportunities

Sponsorship
Opportunities

Calgary 2013

2013 Compendium

Winnipeg 2012

2012 Compendium

Halifax 2011

2011 Compendium



Institute of Transportation Engineers

Ontario
Traffic
CouncilREGION OF JUNE 1-4
WATERLOO 2014TRANSPORTATIONfest
A Celebration of Innovation

FOLLOW US

Guest Speakers

MONDAY, JUNE 2
Opening Keynote Speaker

Iain Klugman, CEO, Communitech

The keynote speaker for our plenary session will be Iain Klugman, CEO of Communitech in Waterloo Region – Canada's hottest technology cluster. Communitech is one of North America's leading tech enabling organizations, supporting the growth of more than 1,000 small, mid-sized and large technology companies. Iain will be sharing the story of the conception and growth of Communitech.

MONDAY, JUNE 2
Luncheon Guest Speaker

Dr. Jeff Casello, Professor, University of Waterloo

The speaker for our first lunch session will be Dr. Jeff Casello, an Engineering Professor at the University of Waterloo jointly appointed to the Department of Civil and Environmental Engineering and the School of Planning. Jeff will be drawing from his broad transportation and urban development background to give his perspective on the role of transportation engineering and planning in City building.

TUESDAY, JUNE 3
Luncheon Guest SpeakerRod Regier, Executive Director, Economic
Development for the City of Kitchener

The speaker for our lunch session on Tuesday will be Rod Regier, the Executive Director of Economic Development for the City of Kitchener. The City of Kitchener is in the midst of an exciting renewal of their downtown. Rod will be talking about the importance of collaboration among urban professionals including transportation professionals in achieving the economic goals set out by the City. He will be speaking to the critical



role that the Region's LRT will have in shaping Kitchener's downtown and he will share the significant successes the City has achieved over the last several years and some of the challenges they are currently facing. On Tuesday afternoon, City staff will be leading a walking tour of the downtown area to highlight some of the projects that have been built and are under development as part of the renewal in the downtown core.

[PRIVACY](#) [COPYRIGHT](#) [TERMS OF USE](#) [CONTACT US](#)

COPYRIGHT 2008-2014. CANADIAN INSTITUTE OF TRANSPORTATION ENGINEERS

17

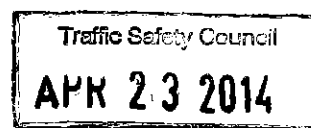

Anna Myrdal

March 31, 2014

Traffic Safety Council
City Of Mississauga
300 City Centre Drive
Mississauga, ON
L5B 3C1

Dear Peter, Angie and the Traffic Safety Council:

Please accept this letter as my resignation from the Traffic Safety Council, effective immediately.

Over the past 21 years of raising my two children, I have always wanted to return to the workforce having a full time position. I have accepted a full time position at Medcan Medical Clinic in downtown Toronto – somewhere I have always wanted to work. Needless to say, with the commute and regular hours I will no longer be able to volunteer with the Traffic Safety Council.

I must say the past 7 months have been a lot a fun and a real learning experience. Everyone I have met and worked with are awesome, 'special people' and soooo much fun at 8am!

Angie, I will stop by the Clerk's Office in the next two weeks and drop off all the items you have given me (clip board, parking pass, map, stopwatch, etc).

Yours sincerely,

Anna Myrdal