



BURNSIDE

[THE DIFFERENCE IS OUR PEOPLE]

Appendix N

Preliminary Streetscape Plan

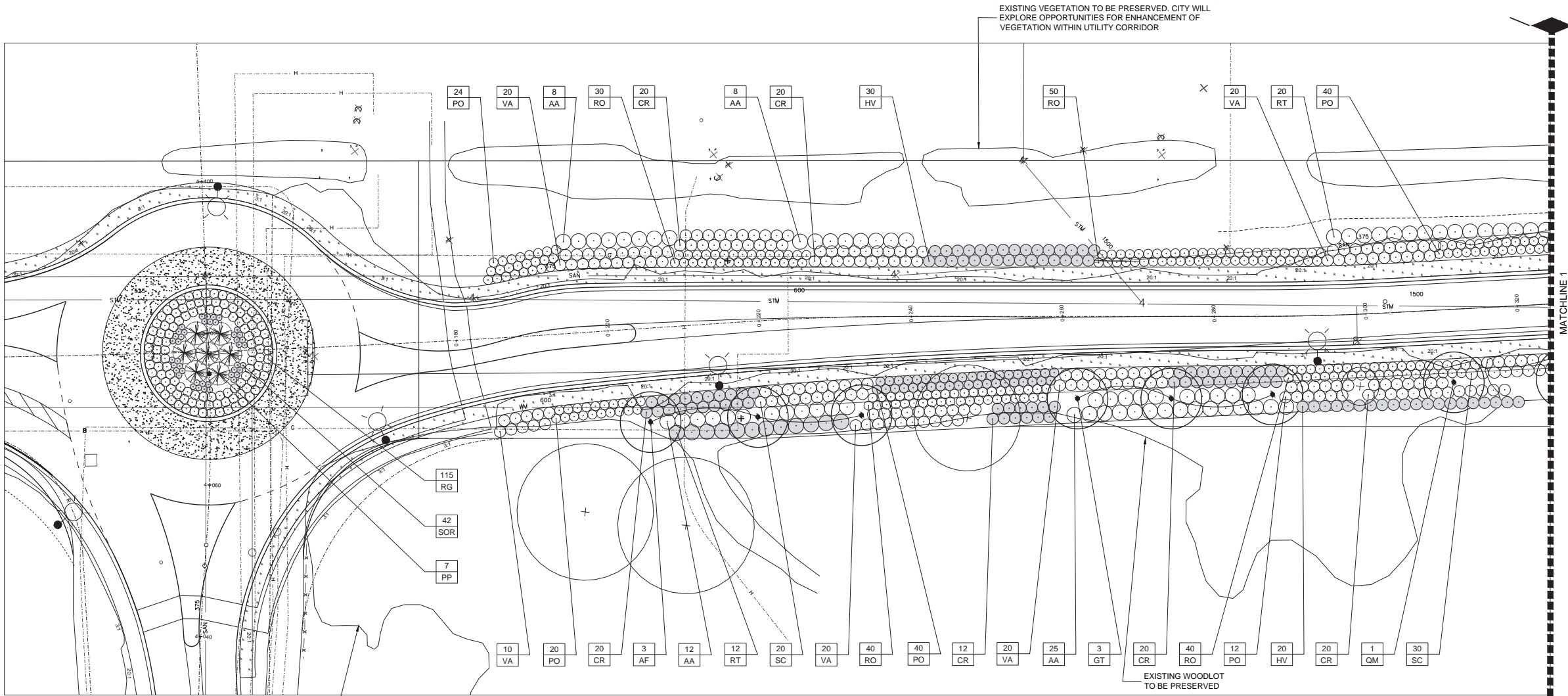

SERVICE DATA					
SERVICE	DATE	INIT.	SERVICE	DATE	INIT.
SAN. SEWERS			GAS MAINS		
STM. SEWERS			BELL U/G CABLE		
WATERMANS			HYDRO U/G CABLE		
M.O.E.			ROGERS U/G CABLE		

REVISIONS			DETAILS		INIT.
DATE					
12 DEC 17	LANDSCAPE PLAN FOR COORDINATION				N.H.
13 DEC 17	LANDSCAPE PLAN FOR COORDINATION				N.H.

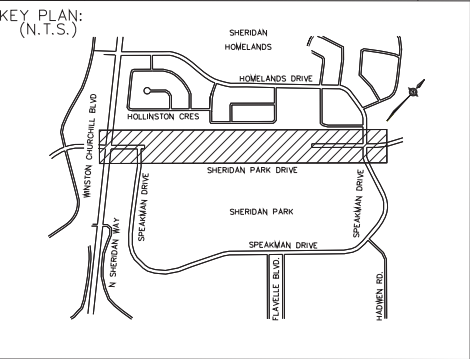

LEGEND:	
	EXISTING TREES
	PROPOSED DECIDUOUS TREES
	PROPOSED CONIFEROUS TREES
	PROPOSED DECIDUOUS SHRUBS
	PROPOSED ORNAMENTAL GRASSES
	PROPOSED SOD
	PROPOSED SEED AREA - S-1 MIX
	PROPOSED SEED AREA - S-2 MIX
	PLANT KEY
	LUMINAIRES

- INFORMATION SOURCES**
- Photometric Plan dated 2017-12-01 obtained from R.J. Burnside & Associates Ltd. T:800-265-9662. Design Base Plan dated 2017-11-15 obtained from R.J. Burnside & Associates Ltd. T:800-265-9662.
 - Existing Utilities Plan dated 2017-11-15 obtained from J. Burnside & Associates Ltd. T:800-265-9662. Basemap Plan dated 2017-11-15 obtained from R.J. Burnside & Associates Ltd. T:800-265-9662.
 - Tree Inventory dated 2017-11-15 obtained from R.J. Burnside & Associates Ltd. T:800-265-9662.

ABOUT & ASSOCIATES INC.
Consulting Arborists • Ecologists • Landscape Architects
190 North Road, Guelph, Ontario, Canada N1H 7J5
T:519.822.6839 • F:519.822.4852 • info@aboutinc.com • www.aboutinc.com

BURNSIDE
R. J. Burnside & Associates Limited
6990 Creditview Road, Unit 2, Mississauga, Ontario, L5N 8R9
telephone (905) 821-1800 fax (905) 821-1809
web www.rjburnside.com
RJB Project No. 300039474
PRODUCED FOR - T&W, ENGINEERING AND WORKS

**SHERIDAN PARK DRIVE
EXTENSION
PRELIMINARY STREETSCAPE PLAN**

SCALE	1:300	AREA	PROJECT No. AA-16-136A
DRAWN BY	N.H.	CHECKED BY	M.G.N.
DATE	DECEMBER 2017	SHEET	2 OF 6
			L2

FILEPATH: S:\AA PROJECTS\2017\16\136A\16-136A.LP 2017-12-14 09:05 CTB: A:\autob. PL: 07/14/14 Date: 17-12-14 PM

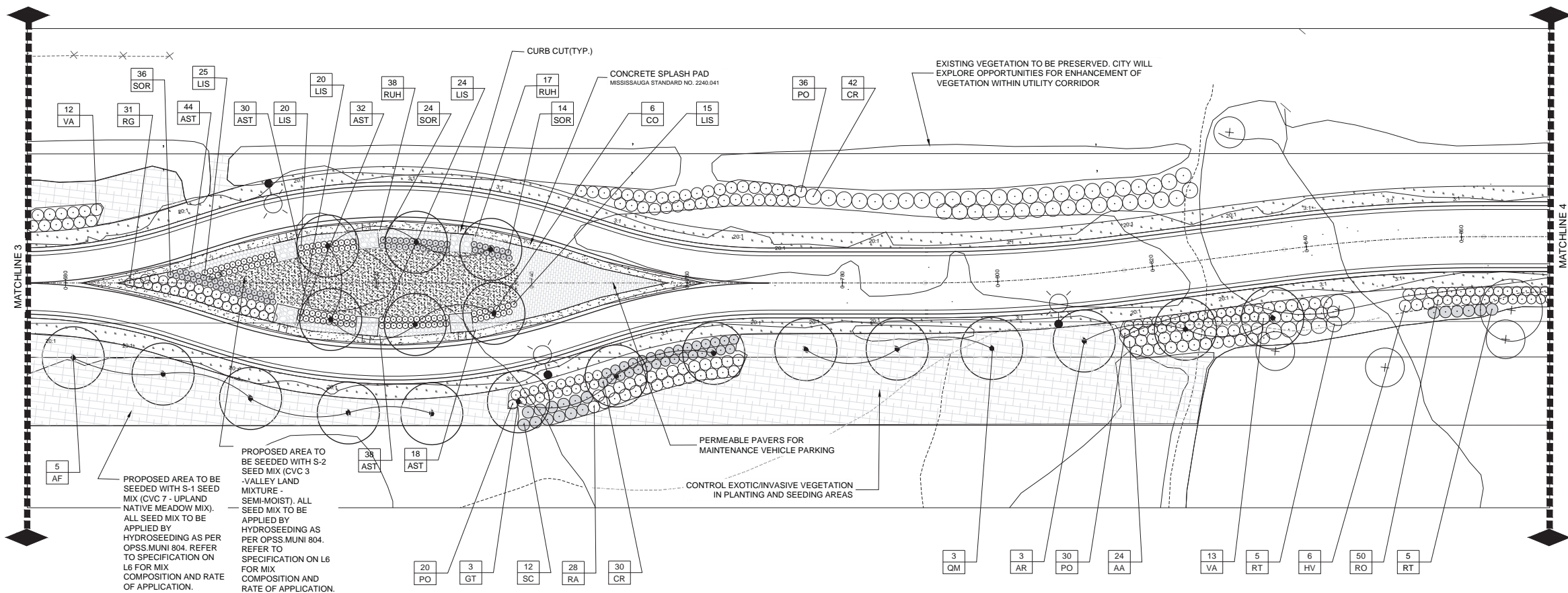

INFORMATION SOURCES

1. Photometric Plan dated 2017-12-01 obtained from R.J. Burnside & Associates Ltd. T.800-265-9662. Design Base Plan dated 2017-11-15 obtained from R.J. Burnside & Associates Ltd. T.800-265-9662.
2. Existing Utilities Plan dated 2017-11-15 obtained from J. Burnside & Associates Ltd. T.800-265-9662. Basemap plan dated 2017-11-15 obtained from R.J. Burnside & Associates Ltd. T.800-265-9662.
3. Tree Inventory dated 2017-11-15 obtained from R.J. Burnside & Associates Ltd. T.800-265-9662.

ABOUT & ASSOCIATES INC.
Consulting Arborists • Ecologists • Landscape Architects
190 Hadden Road, Guilford, Conn., Canada, RI 01151
519.822.6839, F:519.822.4052, info@aboutdng.com, www.aboutdng.com

BURNSIDE
 R. J. Burnside & Associates Limited
 6990 Creditview Road, Unit 2, Mississauga, Ontario, L5N 8R9
 telephone (905) 821-1800 fax (905) 821-1809
 web www.rjburnside.com **RJB Project No. 300039474**
 PRODUCED FOR — T&W, ENGINEERING AND WORKS

SHERIDAN PARK DRIVE
EXTENSION
PRELIMINARY STREETSCAPE PLAN

SCALE 1:300	AREA	PROJECT No. AA-16-136A
DRAWN BY N.H.	CHECKED BY M.G.N.	PLAN No.
DATE DECEMBER 2017	SHEET 3 OF 6	13

FILEPATH: S:\AA PROJECTS\STREETSCAPE\156A SHERIDAN PARK\EACAD\AA 02\156A LP 2017-12-14.DWG CTE: AA-16-136A PLOTTED: 14-Dec-17 2:24 PM

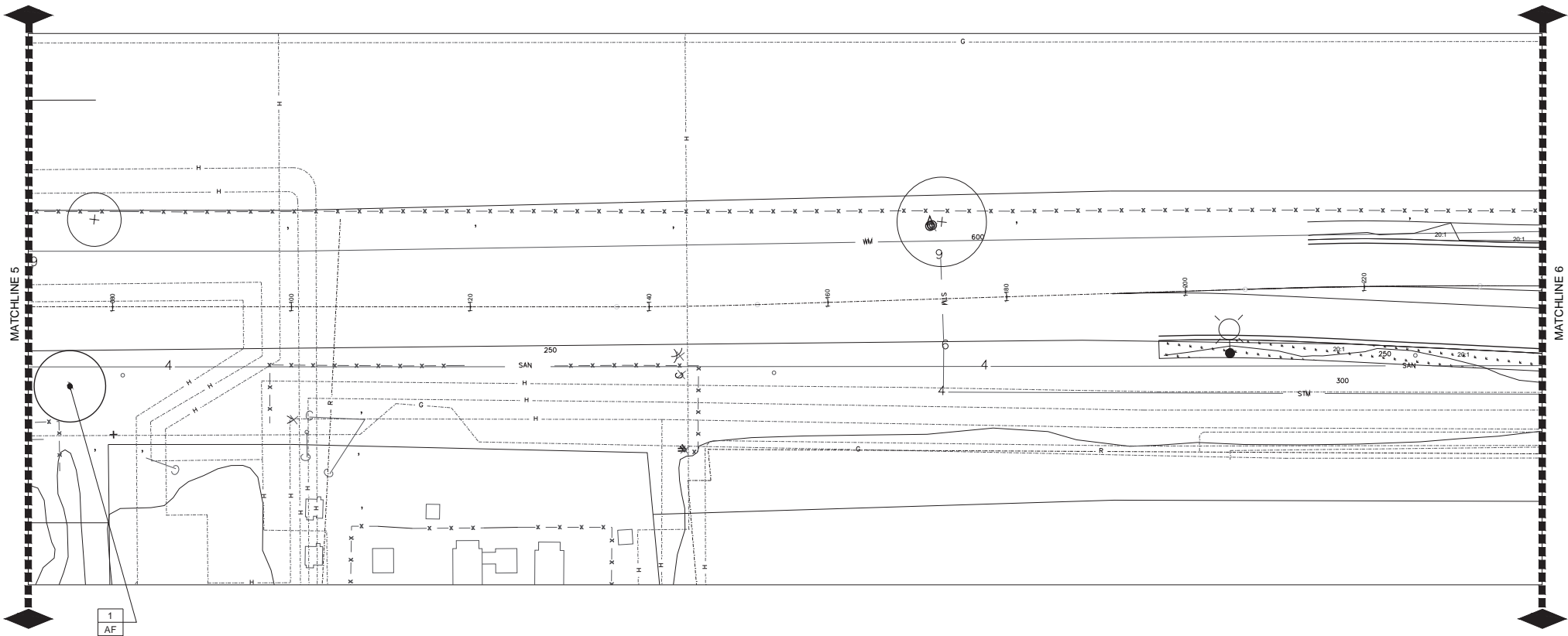
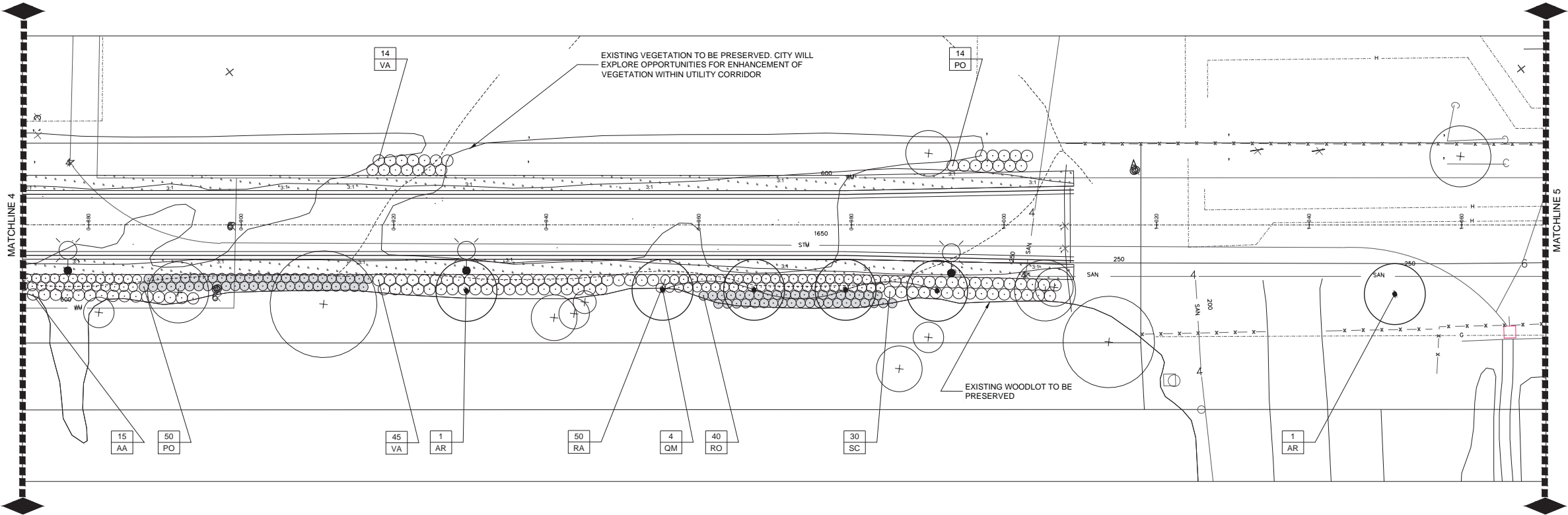

SERVICE DATA					
SERVICE	DATE	INIT.	SERVICE	DATE	INIT.
SAN. SEWERS			GAS MAINS		
STM. SEWERS			BELL U/G CABLE		
WATERMAINS			HYDRO U/G CABLE		
M.O.E.			ROGERS U/G CABLE		

REVISIONS		
DATE	DETAILS	INIT.
12 DEC 17	LANDSCAPE PLAN FOR COORDINATION	N.H.
13 DEC 17	LANDSCAPE PLAN FOR COORDINATION	N.H.

KEY PLAN:
(N.T.S.)

LEGEND:

- EXISTING TREES
- PROPOSED DECIDUOUS TREES
- PROPOSED CONIFEROUS TREES
- PROPOSED DECIDUOUS SHRUBS
- PROPOSED ORNAMENTAL GRASSES
- PROPOSED SOD
- PROPOSED SEEDING AREA - S-1 MIX
- PROPOSED SEEDING AREA - S-2 MIX
- PLANT KEY
- LUMINAIRES

INFORMATION SOURCES

- Photometric Plan dated 2017-12-01 obtained from R.J. Burnside & Associates Ltd. T:800-265-9662 Design Base Plan dated 2017-11-15 obtained from R.J. Burnside & Associates Ltd. T:800-265-9662.
- Existing Utilities Plan dated 2017-11-15 obtained from J. Burnside & Associates Ltd. T:800-265-9662 Basemap Plan dated 2017-11-15 obtained from R.J. Burnside & Associates Ltd. T:800-265-9662.
- Tree Inventory dated 2017-11-15 obtained from R.J. Burnside & Associates Ltd. T:800-265-9662.

ABOUT & ASSOCIATES INC.
Consulting Arborists • Ecologists • Landscape Architects
190 Keele Road, Suite 201, Oakville, Ontario, Canada, N4W 7L5
1519.822.6839, F519.822.4052, info@aboutinc.com, www.aboutinc.com

BURNSIDE
R. J. Burnside & Associates Limited
6990 Creditview Road, Unit 2, Mississauga, Ontario, L5N 6R9
telephone (905) 821-1800 fax (905) 821-1809
web www.rjburnside.com

RJB Project No. 300039474

PRODUCED FOR – T&W, ENGINEERING AND WORKS

**SHERIDAN PARK DRIVE
EXTENSION
PRELIMINARY STREETSCAPE PLAN**

SCALE	1:300	AREA	PROJECT No. AA-16-136A
DRAWN BY	N.H.	CHECKED BY	M.G.N.
DATE	DECEMBER 2017	SHEET	4 OF 6
			PLAN No. L4

SERVICE DATA					
SERVICE	DATE	INIT.	SERVICE	DATE	INIT.
SAN. SEWERS			GAS MAINS		
STM. SEWERS			BELL U/G CABLE		
WATERMAINS			HYDRO U/G CABLE		
M.O.E.			ROGERS U/G CABLE		

REVISIONS		
DATE	DETAILS	INIT.
12 DEC 17	LANDSCAPE PLAN FOR COORDINATION	N.H.
13 DEC 17	LANDSCAPE PLAN FOR COORDINATION	N.H.

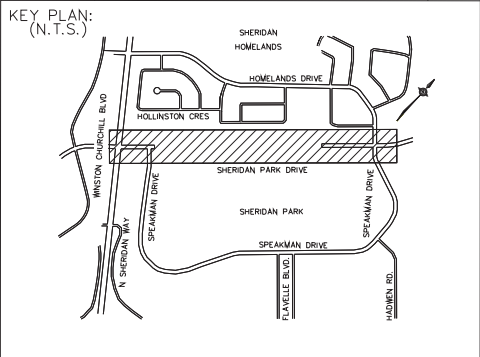

LEGEND:	
	EXISTING TREES
	PROPOSED DECIDUOUS TREES
	PROPOSED CONIFEROUS TREES
	PROPOSED DECIDUOUS SHRUBS
	PROPOSED ORNAMENTAL GRASSES
	PROPOSED SOD
	PROPOSED SEEDED AREA - S-1 MIX
	PROPOSED SEEDED AREA - S-2 MIX
	PLANT KEY
	LUMINAIRES

- INFORMATION SOURCES**
1. Photometric Plan dated 2017-12-01 obtained from R.J. Burnside & Associates Ltd. T:800-265-9662.Design Base Plan dated 2017-11-15 obtained from R.J. Burnside & Associates Ltd. T:800-265-9662.
 2. Existing Utilities Plan dated 2017-11-15 obtained from J. Burnside & Associates Ltd. T:800-265-9662.Base map Plan dated 2017-11-15 obtained from R.J. Burnside & Associates Ltd. T:800-265-9662.
 3. Tree Inventory dated 2017-11-15 obtained from R.J. Burnside & Associates Ltd. T:800-265-9662.

ABOUD & ASSOCIATES INC.
Consulting Arborists • Ecologists • Landscape Architects
190 Neilson Road, Quebec, Ontario, Canada • N1H 7J5
T:519.822.6839 • F:519.822.4052 • info@abouding.com • www.abouding.com

BURNSIDE
R. J. Burnside & Associates Limited
6990 Creditview Road, Unit 2, Mississauga, Ontario, L5N 8R9
telephone (905) 821-1800 fax (905) 821-1809
web www.rjburnside.com

RJB Project No. 300039474

PRODUCED FOR – T&W, ENGINEERING AND WORKS		
SHERIDAN PARK DRIVE EXTENSION PRELIMINARY STREETSCAPE PLAN		
SCALE	1:300	AREA
DRAWN BY	N.H.	CHECKED BY M.G.N.
DATE	DECEMBER 2017	SHEET 5 OF 6
		PROJECT No. AA-16-136A PLAN No. L5

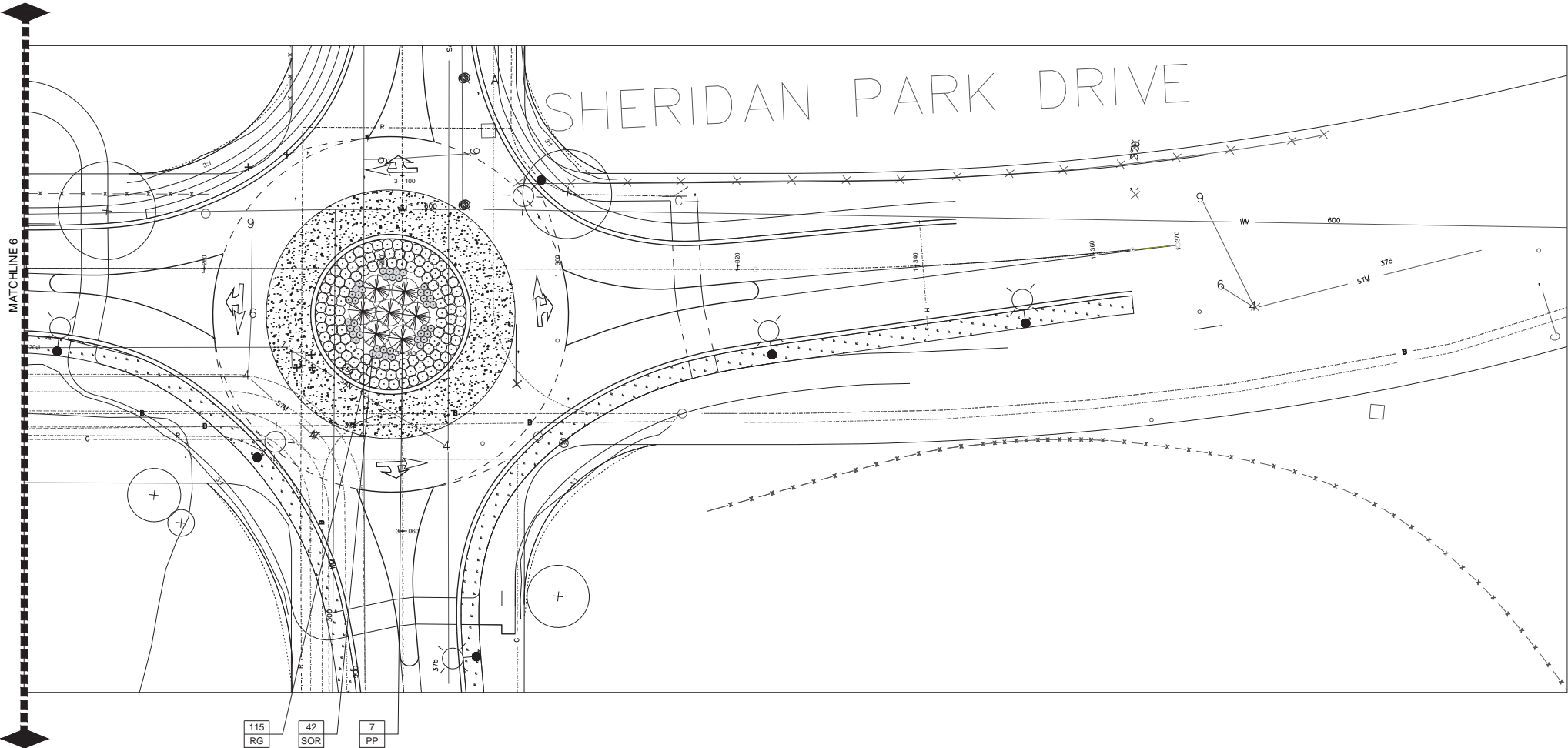

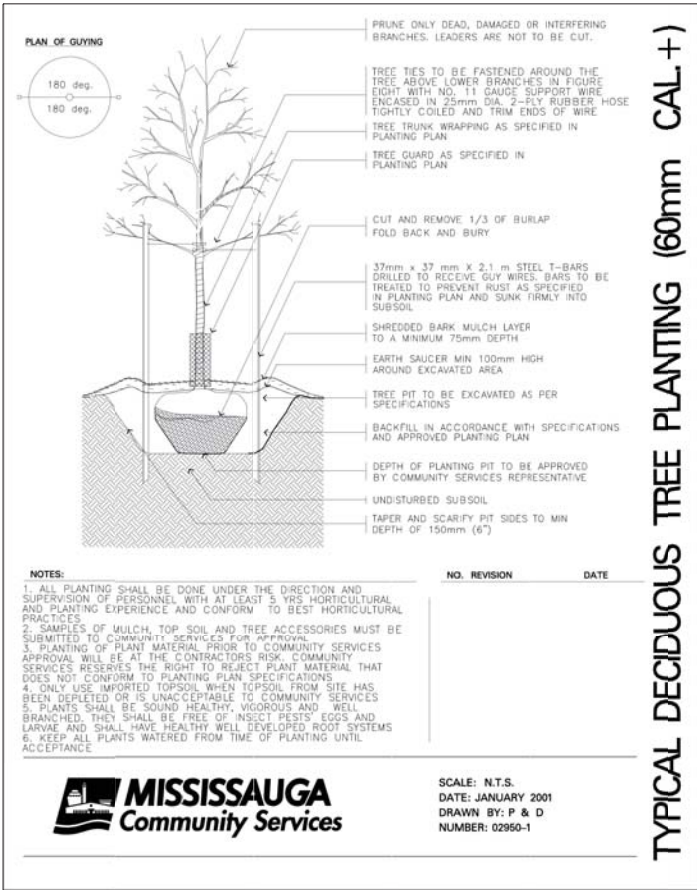

1
L6
TYPICAL DECIDUOUS TREE PLANTING DETAIL
N.T.S.

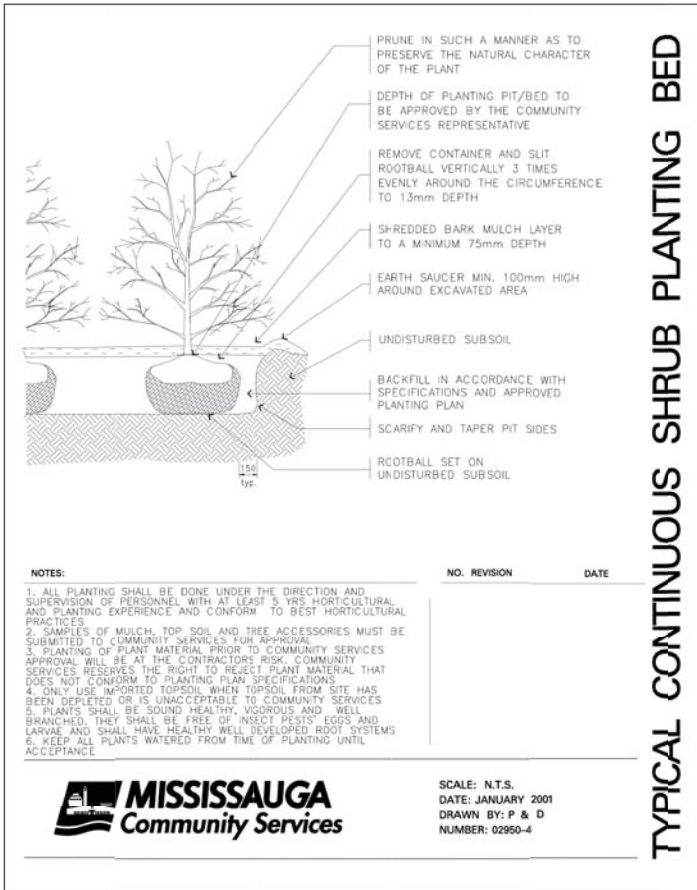

2
L6
TYPICAL CONTINUOUS SHRUB PLANTING DETAIL
N.T.S.

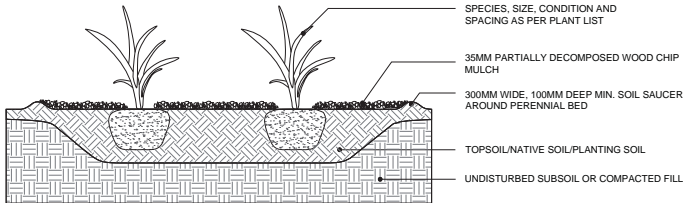

3
L6
TYPICAL CONTAINER PERENNIAL PLANTING DETAIL
N.T.S.

PLANT LIST

KEY	QTY	BOTANICAL NAME	COMMON NAME	SIZE	TYPE	REMARKS
TREES						
AR	8	ACER RUBRUM	Red Maple	60 MM CAL	WB	
AF	14	ACER X FREEMANII	Hybrid Maple / Freeman Maple	60 MM CAL	WB	
CO	15	CELTIS OCCIDENTALIS	Hackberry	60 MM CAL	WB	
GT	9	GLEDITSIA TRICANTHOS VAR. INERMIS	Thornless Honey Locust	60 MM CAL	WB	
PP	14	PICEA PUNGENS 'FAT ALBERT'	Fat Albert Colorado Blue Spruce	180 CM HT	WB	
QM	13	QUERCUS MACROCARPA	Bur Oak	60 MM CAL	WB	
	73	TOTAL TREES				
SHRUBS						
AA	92	AMELANCHIER ARBOREA	DOWNY SERVICEBERRY	60 CM HT	POTTED	
CR	369	CORNUS RACEMOSA	GRAY DOGWOOD	60 CM HT	POTTED	
HV	71	HAMAMELIS VIRGINIANA	WITCH HAZEL	60 CM HT	POTTED	
PO	416	PHYSOCARPUS OPULIFOLIUS	COMMON NINEBARK	60 CM HT	POTTED	
RA	151	RHUS AROMATICA	FRAGRANT SUMAC	60 CM HT	POTTED	
RG	292	RHUS AROMATICA 'GRO-LOW'	GRO LOW FRAGRANT SUMAC	60 CM HT	POTTED	
RT	72	RHUS TYPHINA	STAGHORN SUMAC	60 CM HT	POTTED	
RO	370	RUBUS ODORATUS	PURPLE FLOWERING RASPBERRY	60 CM HT	POTTED	
SC	104	SAMBUCUS CANADENSIS	AMERICAN ELDER	60 CM HT	POTTED	
VA	259	VIBURNUM ACERIFOLIUM	MAPLE-LEAF VIBURNUM	60 CM HT	POTTED	
	2196	TOTAL SHRUBS				
ORNAMENTAL GRASSES AND PERENNIALS						
AST	324	ASCLEPIAS TUBEROSA	BUTTERFLY MILKWEED	1 GAL	POTTED	
LIS	208	LIATRIS SPICATA	DENSE BLAZINGSTAR	1 GAL	POTTED	
RUH	110	RUDBECKIA HIRTA	BLACK-EYED SUSAN	1 GAL	POTTED	
SCH	118	SCHIZACHYRIUM SCOPARIUM	LITTLE BLUESTEM	1 GAL	POTTED	
SOR	232	SORGHASTRUM NUTANS	INDIAN GRASS	1 GAL	POTTED	
	992	TOTAL ORNAMENTAL GRASSES AND PERENNIALS				

NURSE CROP

% BY WEIGHT	BOTANICAL NAME	COMMON NAME
50	AVENA SATIVA	OATS
50	FAGOPYRUM ESCULENTUM	BUCKWHEAT

SEEDING RATE = 22 KG / HECTARE

S-1 SEED MIX (CVC 7 - UPLAND NATIVE MEADOW MIX)

% BY WEIGHT	BOTANICAL NAME	COMMON NAME
10	RUDBECKIA HIRTA	BLACK-EYED SUSAN
1	ASTER CORDIFOLIUS	BLUE WOOD (HEART LEAVED ASTER)
1	ANEMONE CANADENSIS	CANADA ANEMONE
2	SOLIDAGO CANADENSIS	CANADA GOLDENROD
2	ASCLEPIAS SYRIACA	COMMON MILKWEED
25	OENOTHERA BIENNIS	EVENING PRIMROSE
1	EUTHAMIA GRAMINIFOLIA	GRASS LEAVED GOLDENROD
15	CAREX GRANULARIS	MEADOW/ OPEN FIELD SEDGE
1	ASTER NOVAE-ANGLIAE	NEW ENGLAND ASTER
40	ELYMUS RIPARIUS	RIVERBANK WILD RYE
1	CLEMATIS VIRGINIANA	VIRGINS BOWER
1	MONARDA FISTULOSA	WILD BERGAMOT

SEEDING RATE = 25 KG / HECTARE

S-2 SEED MIX (CVC 3 - VALLEY LAND MIXTURE - SEMI-MOIST)

% BY WEIGHT	BOTANICAL NAME	COMMON NAME
2	GLYCERIA STRIATA	FOWL MANNA GRASS
30	POA PALUSTRIS	FOWL BLUEGRASS
30	CAREX VULPINOIDEA	FOX SEDGE
8	JUNCUS TENUIIS	PATH RUSH
30	ELYMUS VIRGINICUS	VIRGINIA WILD RYE

SEEDING RATE = 25 KG / HECTARE

- NOTES:
- COVER STOCK WHILE IN TRANSIT OR TEMPORARY STORAGE
 - EXCAVATE AND PREPARE BED TO DEPTH AS INDICATED. SCARIFY BOTTOM & SIDES OF PLANTING PIT TO A DEPTH OF 50mm.
 - CAREFULLY REMOVE PLANT FROM POT WITHOUT DISTURBING ROOT BALL AND GENTLY PLACE IN PLANTING PIT.
 - PLANT SO THAT NURSERY SOIL LINE MATCHES FINISHED GRADE AFTER SETTLING.
 - BACKFILL PLANTING PIT IN 150MM LIFTS TAMPING BACKFILL TO REMOVE AIR POCKETS, FORMING SOIL SAUCER AS SHOWN.
 - FOLLOWING PLANTING, SOAK THOROUGHLY WITH WATER THEN MULCH, KEEP MULCH AWAY FROM STEM.
 - REMOVE ALL NURSERY TAGS AND WRAPS.

SERVICE DATA					
SERVICE	DATE	INIT.	SERVICE	DATE	INIT.
SAN. SEWERS			GAS MAINS		
STM. SEWERS			BELL U/G CABLE		
WATER MAINS			HYDRO U/G CABLE		
M.O.E.			ROGERS U/G CABLE		

REVISIONS		
DATE	DETAILS	INIT.
12 DEC 17	LANDSCAPE PLAN FOR COORDINATION	N.H.
13 DEC 17	LANDSCAPE PLAN FOR COORDINATION	N.H.

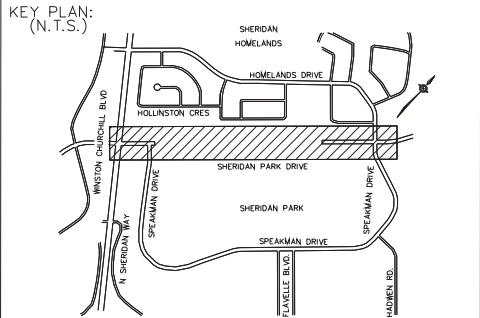

LEGEND:

- EXISTING TREES
- PROPOSED DECIDUOUS TREES
- PROPOSED CONIFEROUS TREES
- PROPOSED DECIDUOUS SHRUBS
- PROPOSED ORNAMENTAL GRASSES
- PROPOSED SOD
- PROPOSED SEEDED AREA - S-1 MIX
- PROPOSED SEEDED AREA - S-2 MIX
- PLANT KEY
- LUMINAIRES

INFORMATION SOURCES

- Photometric Plan dated 2017-12-01 obtained from R.J. Burnside & Associates Ltd. T:800-265-9662. Design Base Plan dated 2017-11-15 obtained from R.J. Burnside & Associates Ltd. T:800-265-9662.
- Existing Utilities Plan dated 2017-11-15 obtained from J. Burnside & Associates Ltd. T:800-265-9662. Basemap Plan dated 2017-11-15 obtained from R.J. Burnside & Associates Ltd. T:800-265-9662.
- Tree Inventory dated 2017-11-15 obtained from R.J. Burnside & Associates Ltd. T:800-265-9662.

ABOUT & ASSOCIATES INC.
Consulting Arborists • Ecologists • Landscape Architects
190 Neelon Road, Guelph, Ontario, Canada, N1H 7J5
T:519.822.6839, F:519.822.4052, info@aboutandinc.com, www.aboutandinc.com

BURNSIDE
R. J. Burnside & Associates Limited
6990 Creditview Road, Unit 2, Mississauga, Ontario, L5N 8R9
telephone (905) 821-1800 fax (905) 821-1809
web www.rjburnside.com **RJB Project No. 300039474**

PRODUCED FOR - T&W, ENGINEERING AND WORKS

**SHERIDAN PARK DRIVE
EXTENSION
PRELIMINARY STREETSCAPE PLAN**

SCALE	N.T.S.	AREA		PROJECT No. AA-16-136A
DRAWN BY	N.H.	CHECKED BY	M.G.N.	PLAN No.
DATE	DECEMBER 2017	SHEET	6 OF 6	L6