

CUT OPENING FOR NEW EXTERIOR TYPE DOOR & PROVIDE STEEL LINTEL 2L'S 90 x 90 x 6

RSI 2.11 INSULATION CONT. W/ INTEGRAL VAPOUR/ AIR BARRIER ON WARM SIDE 38x89 STRAPPING NO. 15 BLDG. PAPER

75mm DEEP POCKETS FOR CONCRETE SLAB SUPPORT (REMOVE EVERY 2ND PAIR OF FACE BRICKS)

MIN. 89mm BEARING ON WOOD FRAMING OR SOLID MASONRY @ EXISTING HOUSE

TIE NEW CONCRETE TO EXISTING W/ 1-10M RODS 200mm LONG, 100mm INTO WALL EVERY OTHER COURSE

2500mm Max.

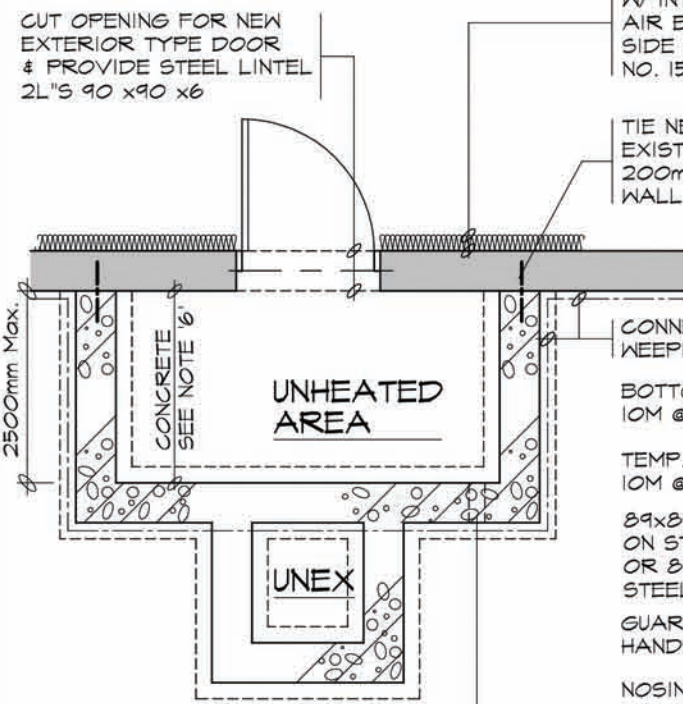

**FOUNDATION PLAN**

CONNECT EXISTING WEEPING TILE TO NEW

BOTTOM REINF. 10M @ 200mm O.C.

TEMP. STEEL 10M @ 200mm O.C.

89x89 WOOD POST ON STEEL SADDLE OR 89mm DIA. STEEL POST (TYP.)

GUARD & HANDRAIL

NOSING REINF. W/ 10M BARS

VENTILATION OPENING PROTECTED FROM WEATHER & INSECTS

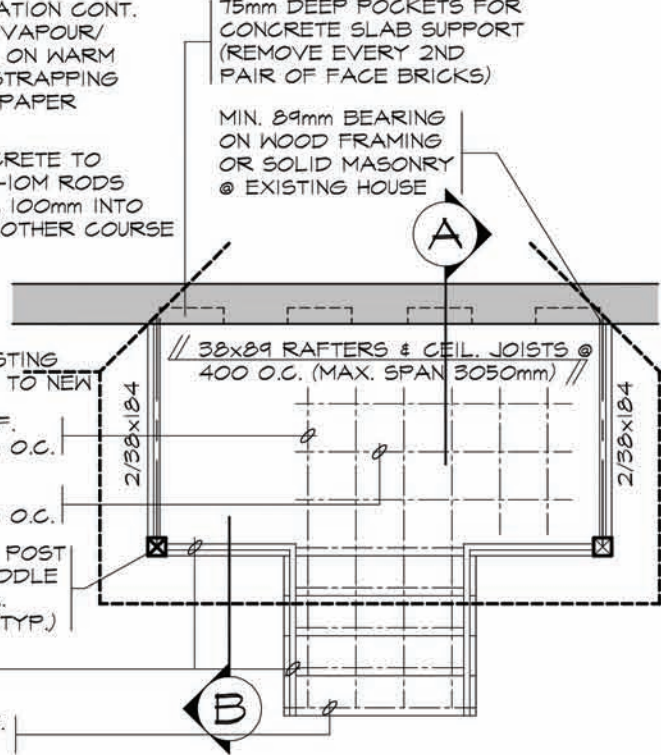

**GROUND FLOOR PLAN**

SLAB REINFORCEMENT IF USED AS COLD CELLAR

GUARDS SEE NOTE 3.

EXISTING WALL

TEMP. STEEL 10M @ 200mm O.C.

75mm BEARING FOR SLAB

BOTTOM REINF. 10M @ 200mm O.C.

PROVIDE DRYWALL FINISH IF FOAM INSULATION IS USED

100mm COMPACTED CRUSHED STONE

75mm CONCRETE FLOOR SLAB

SADDLE FOR WOOD POST ANCHORED TO SLAB

10M DOWELS 600x600mm @ 600mm O.C.

MASONRY EXTERIOR FACING, FILL SPACE BETWEEN WALL & FACING W/ MORTAR & PROVIDE METAL TIES SEE NOTE 4'

NOSING REINF. W/ 10M BARS

DAMP PROOFING & 6mm THICK CEMENT PARGING COVERED @ FOOTING

200mm CONCRETE BLOCK OR POURED CONCRETE FOUNDATION WALL

100mmx400mm POURED CONCRETE FOOTING

100mm DIA. WEEPING TILE W/ 150mm CRUSHED STONE COVERAGE

**SECTION 'A'**

**SECTION 'B'**

**GENERAL NOTES**

**1. EXTERIOR STAIRS**

125mm - 200mm RISE  
210mm - 355mm RUN  
235mm - 355mm TREAD  
STEPS ARE TO BE UNIFORM THROUGHOUT FLIGHT

**2. HANDRAILS**

ARE REQUIRED WHERE STEPS HAVE MORE THAN 3 RISERS. HANDRAIL HEIGHT 800mm - 965mm

**3. GUARDS**

ARE REQUIRED AROUND CONCRETE SLAB IF MORE THAN 600mm ABOVE GRADE & ON BOTH SIDES OF STAIRS  
MINIMUM 900mm HIGH FOR STAIRS  
MINIMUM 900mm HIGH FOR PORCHES UP TO 1800mm ABOVE GRADE.  
MINIMUM 1070mm HIGH FOR GREATER HTS.  
MAXIMUM 100mm BETWEEN PICKETS AND NO MEMBER DESIGNED TO FACILITATE CLIMBING BETWEEN 140mm & 900mm

**4. MASONRY TIES**

WHEN BRICK FACING IS USED ABOVE GROUND LEVEL, PROVIDE 0.76mm THICK & 22mm WIDE CORROSION RESISTANT METAL TIES @ 600mm HORIZ. & 500mm VERTICAL

**5. FOUNDATION WALLS**

THICKNESS OF UNREINFORCED FOUNDATION WALLS LATERALLY SUPPORTED AT THE TOP ARE DEPENDANT UPON HEIGHT OF FINISH GRADE ABOVE BASEMENT FLOOR

UNIT MASONRY THICKNESS 190mm - MAX. HEIGHT 1200mm  
UNIT MASONRY THICKNESS 240mm - MAX. HEIGHT 1800mm  
UNIT MASONRY THICKNESS 290mm - MAX. HEIGHT 2200mm

**6. CONCRETE**

MINIMUM CONCRETE STRENGTH SHALL BE 32Mpa W/ 5%-8% AIR ENTRAINMENT  
CONCRETE SLAB THICKNESS 125mm  
PROVIDE MIN. 30mm CLEAR CONCRETE COVER TO REINFORCING BARS