

**GENERAL NOTES**

- VERIFY ALL DIMENSIONS.
- DO NOT SCALE DRAWINGS.
- REPORT ANY DISCREPANCIES, DISCOVERED ERRORS, OR OMISSIONS TO THE LANDSCAPE ARCHITECT BEFORE PROCEEDING.
- IT IS ADVISED THAT CONTRACTORS CONTACT THE LANDSCAPE ARCHITECT PRIOR TO CONSTRUCTION TO ENSURE THE USE OF THE LATEST REVISED DRAWINGS.
- DRAWINGS AND SPECIFICATIONS ARE THE PROPERTY OF THE LANDSCAPE ARCHITECT.

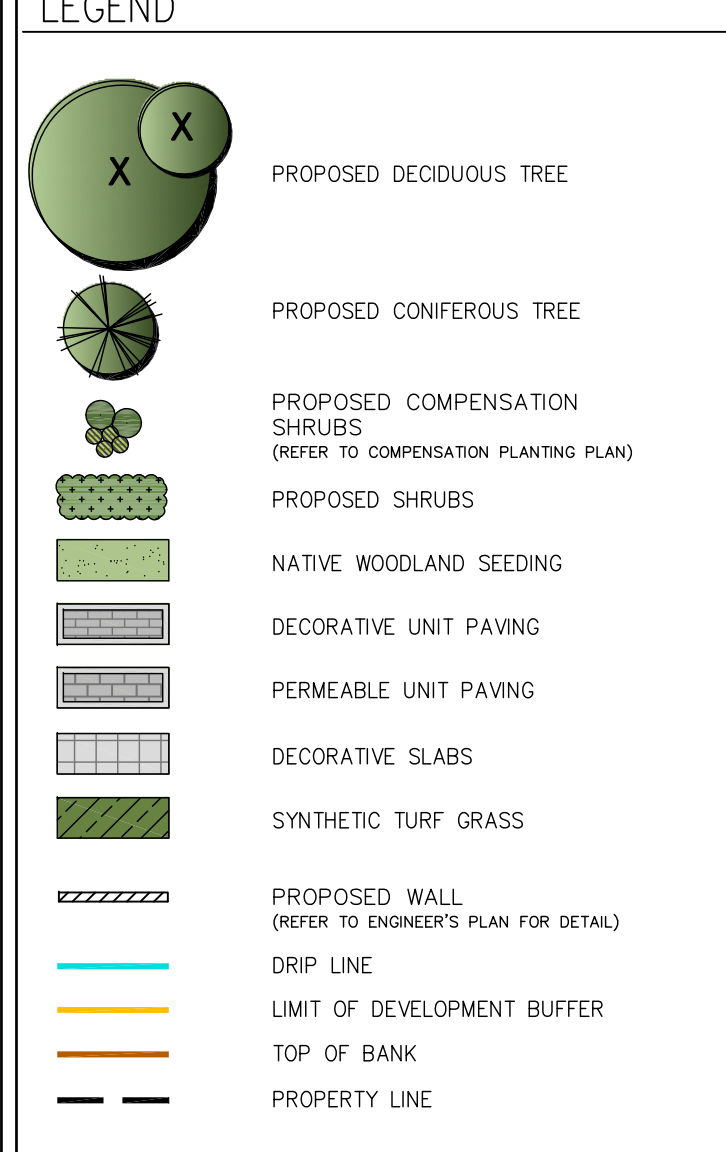

No.	DATE	REVISION	BY
3	JUN. 19, 2020	ISSUED FOR SPA SUBMISSION	SV
2	JUN. 02, 2020	CONCEPT ISSUED FOR CLIENT REVIEW	SV
1	FEB. 11, 2020	COMPENSATION PLANTING PLAN	SV
		ISSUED FOR CLIENT REVIEW	

It is the responsibility of the Contractor and/or Owner to ensure that the drawings with the latest revisions are used for construction.

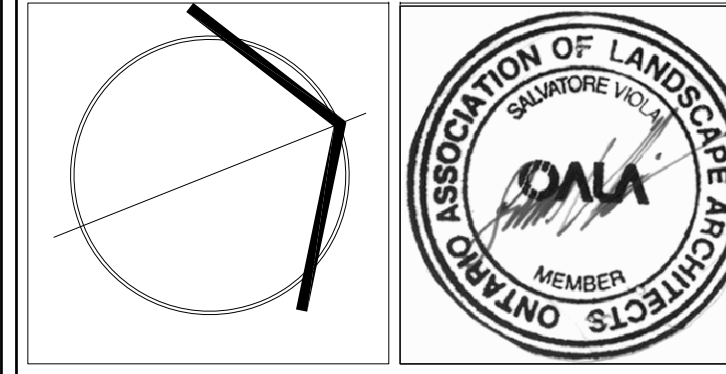

**SBK** 5770 HURONTARIO STREET, SUITE 320  
MISSISSAUGA, ONTARIO, L5R 3G5  
T: 416.695.4949 F: 905.712.3101  
WWW.SBK905.COM

**STRBYOS BARRON KING**  
LANDSCAPE ARCHITECTURE

PROJECT: **PROPOSED 4 STOREY BUILDING**  
DI BLASIO HOMES  
6620 ROTHSCHILD TRAIL

DRAWING TITLE: **LANDSCAPE PLAN**

SCALE:	1:250	PROJECT No.	5437
DATE:	FEBRUARY 2020	DRAWING No.	L100
DRAWN BY:	J.M.	CHECKED BY:	S.V.

**PLANTING:**(UNLESS OTHERWISE SPECIFIED)

- PREPARE PLANTING SOIL BY EVENLY MIXING FOUR PARTS SANDY TOPSOIL, ONE PART ORGANIC SOIL ADDITIVE WITH 500g BONE MEAL AND 750g COMMERCIAL FERTILIZER PER CUBIC METER. THE FOREGOING RATES ARE SUBJECT TO ADJUSTMENT ON RECEIPT OF TOPSOIL ANALYSIS REPORT.
- EXCAVATE AND PROVIDE PLANTING SOILS AS PER PLANTING DETAILS.
- PROVIDE ALL SHRUBS AND TREES ACCORDING TO THE GUIDE SPECIFICATIONS FOR NURSERY STOCK OF THE CANADIAN NURSERY TRADE ASSOCIATION WITH REGARD TO QUALITY AND GRADING AND SIZED AS PER PLANT LIST.
- SPRAY ALL PLANTINGS IN LEAF WITH ANTI-DESICCANT. PROVIDE TREES WITH STAKES.
- PLANTS ARE TO BE NO. 1 NURSERY GROWN, UNDER PROPER CULTURAL PRACTICES, IN PARTICULAR WITH RESPECT TO AMPLE SPACING, PEST AND DISEASE CONTROL, AND BRANCH AND ROOT PRUNING.
- TREES ARE TO HAVE STURDY, STRAIGHT TRUNKS.
- TREES SHALL BE WELL BRANCHED AND BALANCED WITH A STRONG CENTRAL LEADER.
- DECIDUOUS SHADE TREES SHALL BE TREES OF BRANCHES NOT LESS THAN 1.8m ABOVE THE GROUND.
- ALL SHRUBS ARE TO BE PLANTED IN CONTINUOUS BEDS.
- DO NOT SOO BETWEEN PLANTS. EXCAVATE ENTIRE AREA OF SHRUB BED UNIFORM TO SPECIFIED DEPTH AND FILL WITH SPECIFIED PLANTING SOIL.

**MAINTENANCE & ACCEPTANCE:**

- ALL PLANT MATERIAL SHALL BE MAINTAINED BY THE CONTRACTOR IMMEDIATELY AFTER ANY PLANTING HAS BEEN INSTALLED AND SHALL CONTINUE UNTIL THE DATE OF FINAL ACCEPTANCE.
- SUCH MAINTENANCE SHALL INCLUDE ALL MEASURES NECESSARY TO ESTABLISH AND MAINTAIN ALL PLANTS IN AN ACCEPTABLE, VIGOROUS AND HEALTHY GROWING CONDITION INCLUDING CULTIVATING AND WEEDING, WATERING (WHEN REQUIRED), PRUNING AND MAINTENANCE OF ALL ACCESSORIES.
- AT TIME OF INSPECTION FOR INITIAL & FINAL ACCEPTANCE, ALL PLANTING BEDS AND TREE PITS SHALL BE FRESHLY CULTIVATED, FREE OF WEEDS, LEAVES, BROKEN BRANCHES AND RUBBISH AND SHALL BE IN A NEAT AND TIDY CONDITION.
- ALL PLANT MATERIAL IS TO BE GUARANTEED FOR A PERIOD OF 2 (TWO) YEARS FROM THE DATE OF ACCEPTANCE BY THE LANDSCAPE ARCHITECT AND LOCAL AUTHORITY UNLESS OTHERWISE NOTED.
- MAINTAIN PLANTING BEDS AND TREE PITS FREE OF WEEDS THROUGHOUT THE GUARANTEE PERIOD.
- THE DEVELOPER SHALL REGULARLY REMOVE WEEDS FROM THE WETLAND UNTIL THE COMPLETION OF ALL BUILDING CONSTRUCTION WITHIN THE DEVELOPMENT.

**UNIT PAVING:**

- PAVERS SHALL BE PRECAST CONCRETE UNIT PAVERS WITH MIN. 58.65 M.P.A. (8500 P.S.I.) COMPRESSIVE STRENGTH, AND A WATER ABSORPTION NOT EXCEEDING 5% AND A FREEZE-THAW RESISTANCE EQUAL TO C.S.A.-A82-2 (1997).
- SETTING BED SHALL CONSIST OF SHARP, CLEAN, COARSE CONCRETE SAND OR APPROVED LIMESTONE SCREENINGS.
- SAND FOR JOINTS SHALL BE A CLEAN, NATURAL GRAVEL, CRUSHED STONE OR ROCK.
- INSTALL GRANULAR BASE AND COMPACT TO A MINIMUM 98% STANDARD PROCTOR DENSITY UNTIL THE MIN. SPECIFIED DEPTH AS DETAILED, HAS BEEN ESTABLISHED.
- LOOSELY PLACED CONCRETE SAND OR SCREENINGS TO A UNIFORM DEPTH OF 50mm. (2"), MIN.
- MAINTAIN JOINTS UNIFORM AND CLOSELY BUTTED THROUGHOUT.
- WHERE NECESSARY, SAW OUT PAVERS TO PRODUCE A SHARP, VERTICAL CUT WITHOUT DAMAGED EDGES, AND TO FIT ACCURATELY.
- AFTER COMPLETION OF INSTALLATION, COMPACT PAVING BY MEANS OF A VIBRATING PLATE TAMPER.
- FILL THE JOINTS WITH FINE SAND, BY BRUSHING AND SWEEPING, HOSE PAVING WITH FINE WATER SPRAY.

**RODENT PROTECTION:**

- THE CONTRACTOR SHALL BE RESPONSIBLE FOR THE PROTECTION OF ALL TREES AND SHRUBS FROM RODENT INJURY FOR THE DURATION OF THE GUARANTEE PERIOD. PROTECTIVE WIRE MESH GUARDS SHALL BE EMPLOYED AROUND ALL DECIDUOUS TREES. GUARDS SHALL BE INSTALLED PRIOR TO THE APPLICATION OF MULCH AND SHOULD BE PLACED A MINIMUM OF 50mm OUT FROM THE TREE TRUNK ON ALL SIDES. SUFFICIENT MESH SHOULD BE CUT TO COMPLETE THIS CIRCUMFERENCE AS WELL AS TO PROVIDE A MINIMUM OF 25mm OVERLAP.
- THE WIRE MESH GUARDS MUST BE OF GALVANIZED STEEL 12mm SQUARE MESH, 19 GAUGE AND SUPPLIED IN 600mm ROLLS. THE WIRE MESH CAN BE FASTENED WITH ANY ACCEPTABLE GALVANIZED WIRE TIE. ALL SHRUBS AND CONIFEROUS TREES SHALL HAVE AN APPLICATION OF "SKOOT" OR APPROVED EQUIVALENT RODENT FORMULA, TO BE APPLIED AT THE END OF OCTOBER. FOLLOW MANUFACTURER'S DIRECTIONS FOR APPLICATION.

**SODDING:**

- PREPARE A MINIMUM 100mm DEPTH OF TOPSOIL WITH A 10-6-4 COMMERCIAL FERTILIZER AT 7.3kg/1000sq.m. AND SUPER PHOSPHATE AT 5kg/1000sq.m. THE PROPORTIONS SPECIFIED ARE SUBJECT TO ADJUSTMENT DEPENDING ON TOPSOIL ANALYSIS REPORT.
- LAY NO. 1 NURSERY SOO ON ALL AREAS OF THE PROJECT NOT COVERED BY BUILDINGS OR PAVING.
- IMMEDIATELY AFTER INSTALLATION, SOO MUST BE WATERED AND ROLLED.

**TREE LOCATION:**

- NO TREES SHALL BE PLANTED UNDER OVERHEAD WIRES OR OVER UNDERGROUND SERVICES.
- TREES ARE NOT TO BE PLANTED LESS THAN 1m FROM CURBS, UNDERGROUND UTILITIES, SIDEWALKS AND DRIVEWAYS, 2m FROM FIRE HYDRANTS AND TRANSFORMERS, AND 4m FROM LIGHT STANDARDS.
- THE CONTRACTOR IS TO STAKE OUT LOCATIONS OF TREE PITS. THIS STAKE OUT IS TO BE INSPECTED BEFORE THE EXCAVATION OF ANY TREE PITS.
- BEFORE THIS STAKE OUT, THE CONTRACTOR IS TO REQUEST A STAKE OUT ALL UNDERGROUND SERVICES. THE LANDSCAPE ARCHITECT AND THE MUNICIPALITY MAY, AT THEIR DISCRETION REDISTRIBUTE TREE LOCATIONS, PRIOR TO PLANTING, IN ORDER TO MINIMIZE CONFLICTS WITH UTILITIES, DRIVEWAYS AND INTERSECTION VISIBILITY.

**UTILITIES:**

- APPLICANT IS RESPONSIBLE FOR OBTAINING NECESSARY APPROVALS FROM THE UTILITY COMPANIES FOR WORKS WITHIN THE MUNICIPAL BOULEVARD.
- ALL UTILITIES WITHIN THE BOULEVARDS MUST BE LOCATED PRIOR TO COMMENCING CONSTRUCTION WITHIN THE BOULEVARD.

**TOPSOIL:**

- USE EVENLY MIXED TOPSOIL OF FERTILE, FRIABLE NATURAL LOAM CONTAINING NOT LESS THAN 4% ORGANIC MATTER FOR CLAY LOAMS AND 2% MINIMUM ORGANIC MATTER FOR SAND LOAMS WITH AN ACIDITY RANGE OF 5.5 TO 7.5 pH. ALL TOPSOIL SHOULD BE FREE OF SUBSOILS, CLAY, STONES, ROOTS, EXCESS WATER, FROST AND OTHER EXTRANEOUS MATTER.

**PLANT LIST**

DECIDUOUS TREES															
KEY	QUANT.	BOTANICAL NAME	COMMON NAME	CAL.	HEIGHT	SPREAD	SPACE	COND.	ON	FS	PS	SH	SLT	DT	KEY
AR	1	Acer rubrum	Red Maple	60	4000	2000	-	SB	✓						AR
GB	1	Ginkgo biloba	Maidenhair Tree	60	4000	2000	-	SB	✓	✓					GB
LT	4	Liriodendron tulipifera	Tulip Tree	60	4000	2000	-	SB	✓						LT
SHRUBS															
KEY	QUANT.	BOTANICAL NAME	COMMON NAME	CAL.	HEIGHT	SPREAD	SPACE	COND.	ON	FS	PS	SH	SLT	DT	KEY
Cr	7	Cornus racemosa	Gray Dogwood	-	750	-	900	SB	✓	✓	✓	✓	✓	✓	Cr
Ha	18	Hydrangea arborescens 'Annabelle'	Annabelle Hydrangea	-	600	-	750	CG	✓	✓	✓	✓	✓	✓	Ha
Tm	27	Taxus x media 'Hickslii'	Hick's Yew	-	600	-	750	CG	✓	✓	✓	✓	✓	✓	Tm
GRASSES & PERENNIALS															
KEY	QUANT.	BOTANICAL NAME	COMMON NAME	CAL.	HEIGHT	SPREAD	SPACE	COND.	ON	FS	PS	SH	SLT	DT	KEY
cak	24	Calamagrostis acutiflora 'Karl Foerster'	Feather Reed Grass	-	2 gal	-	-	potted		✓	✓				cak
hem	62	Hemerocallis 'Stella D'Oro'	Stella D'Oro Daylily	-	1 gal	-	-	potted	✓	✓	✓				hem
pen	45	Pennisetum alopecuroides 'Hamel'	Dwarf Fountain Grass	-	1 gal	-	-	potted	✓	✓	✓				pen

**NOTE:**

- CHECK ALL QUANTITIES.
- REPORT ANY DISCREPANCIES TO THE LANDSCAPE ARCHITECT.
- THE LAYOUT OF ALL PLANT MATERIAL IS TO BE APPROVED BY THE LANDSCAPE ARCHITECT PRIOR TO PLANTING.
- THE QUANTITIES INDICATED ON THE PLAN SUPERCEDE THE TOTALS OF THE PLANT LIST.

ON - ONTARIO NATIVE  
FS - FULL SUN  
PS - PART SUN  
SH - FULL SHADE  
SLT - SALT TOLERANT

**Owner's Note:**

We agree to implement the approved Site and Landscape Plans within 18 months after the execution of the Site Plan Undertaking and will retain the Landscape Architect to make periodic site inspections. Upon completion of the works we will forward to the City of Mississauga a copy of the Completion Notification Certificate from the Landscape Architect and the applicable inspection fee.

The Landscape Architect or Consulting Engineer will provide certification to indicate that:

- the recommendations outlined in the Acoustic Vibration Study have been implemented in accordance with the study.
- the Engineering Certificate Lighting Plan and the LID techniques for this project have been installed in accordance with the approved plans.

Any revision to the Site Plan, Landscape Plans and Engineer Certified Lighting Plan (if applicable) will be submitted to the Planning and Building Department, Development and Design Division, City of Mississauga for review and approval, prior to the commencement of the works.

We hereby authorize the City, its authorized agents, servants or employees to enter upon our land to carry out inspections from time to time and agree to indemnify the City and its authorized agents and save them harmless from any and all actions arising out of the exercise by the City, its authorized agents, servants or employees of the rights hereby given to them. We undertake to notify the City forthwith of any change of ownership of the said lands.

Signature of Owner: \_\_\_\_\_  
Name of Owner: \_\_\_\_\_  
Address: \_\_\_\_\_  
Date: \_\_\_\_\_

**Grading Note:**

I hereby certify that the Landscape Plan conforms to the approved Site Grading Plan for this application.

Signature of Landscape Architect: \_\_\_\_\_  
Salvatore Vida  
Print Name of Landscape Architect

Date: JUNE 19, 2020

**NOTE FOR LANDSCAPE ARCHITECT, DEVELOPER & HOUSER:**

THIS WORK MAY BE BEING USED FOR OTHER PROJECTS. THE CONTRACTOR SHALL BE RESPONSIBLE FOR OBTAINING NECESSARY APPROVALS FROM THE UTILITY COMPANIES FOR WORKS WITHIN THE MUNICIPAL BOULEVARD. ALL UTILITIES WITHIN THE BOULEVARDS MUST BE LOCATED PRIOR TO COMMENCING CONSTRUCTION WITHIN THE BOULEVARD.

SIGNATURE OF OWNER: \_\_\_\_\_  
DATE: \_\_\_\_\_