

5150 Ninth Line, Mississauga

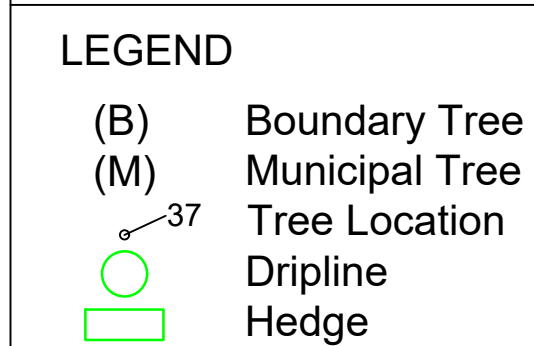

(B) Boundary Tree
(M) Municipal Tree
37 Tree Location
○ Dripline
□ Hedge



Date: August 2019

5150 Ninth Line Tree Management Plan Mattamy Homes

5150 Ninth Line, Mississauga

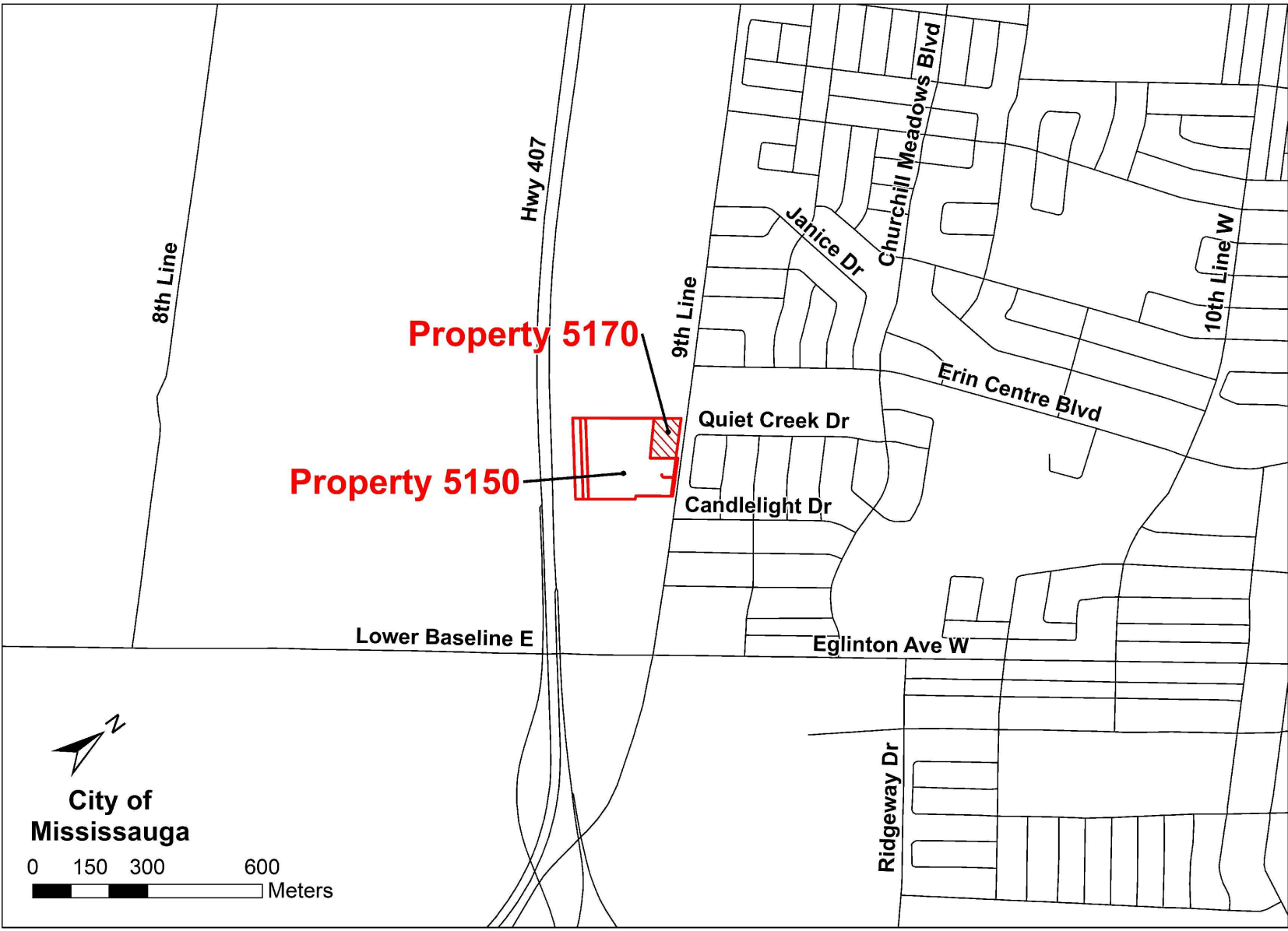

LEGEND			
(B)	Boundary Tree		Dripline and Tree Protection Zone
(M)	Municipal Tree		Dripline - Removal
	Tree Identified for Protection		Portion of Hedge Identified for Removal
	Tree Identified for Removal		Tree Protection Fence

RECOMMENDATIONS:
Trees outside of the subject lands shall be protected from the impacts of grading, manoeuvring of machinery, material laydown, and other construction related activities. The following recommendations are intended to isolate trees from the impacts of construction:

- Delineation of the disturbance limits within work areas should be clearly defined on construction drawings and on site prior to construction;
- No trees shall be pruned or removed or impacted without prior approval from the City;
- It is the responsibility of the project team to become directly acquainted with the site, to carefully examine the location of the proposed work, and to notify the City of any discrepancies in the site conditions;
- The Site Supervisor shall be familiar with these recommendations and be cognizant of the purpose and function of Tree Protection Zones (TPZ);
- Trees on neighbouring non-participating properties or on the property boundary shall be left in place until such time that the ownership is confirmed or upon written authorization for removal;
- Tree protection hoarding/barrier shall be installed as detailed in Appendix B of this report and City specification, or a suitable alternative as approved by the City (i.e. Erosion and Sediment Control fence);
- Tree protection hoarding/barrier must be erect prior to commencement of work;
- Any area inside a TPZ must be left undisturbed (including overhead);
- Heavy machinery is not to be operated within the TPZ (including overhead swinging of machine arms);
- Construction materials or equipment are not to be stored within the TPZ or dripline of the trees;
- No signs or objects should be displayed or affixed to any retained trees;
- Disposal of any liquids shall not occur within the TPZ;
- For project planning and scheduling purposes, removal of vegetation should occur:
 - outside of the bird nesting season to comply with the Migratory Birds Convention Act (MBCA), and the Fish and Wildlife Conservation Act (FWCA). Together, these Acts protect birds, nests, and eggs of regulated species (game birds, raptors, owls, migratory song birds). The nesting season is generally considered to be late March to late August (<https://www.ec.gc.ca>); and,
 - outside of the bat summer roosting period considered April 1-September 30 to avoid impacts to bats protected by the FWCA and the Endangered Species Act;
- Vegetation removals are preferred during November to March to minimize impacts on wildlife;
- This report is intended to satisfy the municipal requirements for arborist reports and tree removals only. The proponent should be aware that additional studies may be required in relation to natural heritage significance;
- Should any additional, incidental or accidental tree injuries occur during construction, a qualified professional should be consulted to determine if additional mitigation measures should be employed; and,
- Ash tree removals are subject to CFIA Regulation D-03-08, which details the phytosanitary requirements to prevent the entry into, and spread of the Emerald Ash Borer (EAB), *Agnilus planipennis Fairmaire*. The tree removal contractor shall comply with the conditions set by D-03-08 when conducting Ash tree removal.



Concept Plan vers: Oct 8, 2019		
Project: TA8851-01	Figure: 3	Scale: 1:500
Prepared by: KC	Verified by: MJO	Date: Oct 17, 2019

HIGHWAY 407

WOODLOT

10m Buffer

Landscape Buffer (2.0m)

PHASE 2

STREET "A"

Amenity: 835m²

Written authorization from owner and City to be obtained prior to removal of boundary trees.

Appendix A Table 1 Tree Inventory

Project: Mattamy 9th Line 5150/5170
Client: Mattamy
Collectors: MJO, VLG, LC

Date: Sept 27 2018, August 7, 2019

Area: 9th Line, Mississauga



TAG#	Scientific Name	Common Name	DBH (cm)	Additional Stems	Estimation of DBH (x)	CONDITION																				Location			Meets City Compensation Criteria	Remove	Protect	Impacted	Management			COMMENTS
						TI	CS	CV	Radial Dripline (m)	Canopy Die Back (%)	Co-dominant stem	Included Bark	Lean, Dir.	Fungus	Insects	Cavity	Rot	Wound	Frost Crack	Epicormic	EAB	Canker	Suppressed	PFW	Hazard	Boundary Tree	Municipal Ownership	GPS corrected					Rationale	TPZ, if applicable	ESA/SARA	
1,707	<i>Pinus sylvestris</i>	Scots Pine	43.0			g	g	g	4																x	x		x	x		conflict with draft plan (street/lot layout)			acquire permit from City for removal		
1,708	<i>Picea glauca</i>	White Spruce polygon	23, 22, 19, 23, 16, 16, 24, 19, 20, 15, 21, 16, 23, 31, 30, 24, 19, 15, 18, 19, 17, 22, 15, 17, 23, 14, 18, 20, 17, 21, 19, 21, 27, 19, 14, 16, 20, 22, 18, 21, 17, 10			g	g	g	3																x			x		x		conflict with draft plan (street/lot layout)	3		remove portion of hedgerow within subject lands. Acquire written authorization for removal of boundary trees.	
1,709	<i>Thuja occidentalis</i>	Eastern White Cedar polygon	22, 20, 20, 24, 25, 15, 16, 28, 20, 19, 14, 14, 14, 13, 12, 10, 14, 14, 12, 14, 13, 10, 14, 12, 12, 13			g	g	g	2																x			x		x		preserve in landscape buffer	2			
1,710	<i>Picea glauca</i>	White Spruce polygon	22, 22, 20, 20, 24, 25, 15, 16, 28, 20, 19			g	g	g	3																				x	x		conflict with draft plan (street/lot layout)				
1,711	<i>Thuja occidentalis</i>	Eastern White Cedar	15.0	13.0		g	g	g	2																			x	x		conflict with draft plan (street/lot layout)					
1,712	<i>Picea glauca</i>	White Spruce	32.0			g	g	g	3																			x	x		conflict with draft plan (street/lot layout)					
1,713	<i>Picea abies</i>	Norway Spruce	34.0			g	g	g	4																			x	x		conflict with draft plan (street/lot layout)					
1,714	<i>Picea abies</i>	Norway Spruce	32.0			g	g	g	4																			x	x		conflict with draft plan (street/lot layout)					
1,715	<i>Tilia cordata</i>	Little Leaf Linden	35.0			g	f	f	6	10															x				x		preserve in landscape buffer	6				
1,716	<i>Quercus macrocarpa</i>	Bur Oak	123.0			g	g	g	10																			x	x		conflict with draft plan (street/lot layout)					
1,717	<i>Picea glauca</i>	White Spruce polygon	15, 15, 16, 19, 18, 20, 26, 19, 27, 17, 15			g	g	g	5																			x	x		conflict with draft plan (street/lot layout)					
1,718	<i>Pinus strobus</i>	White Pine	31.0			g	g	g	4																			x	x		conflict with draft plan (street/lot layout)					
1,719	<i>Acer saccharinum</i>	Silver Maple	39.0			g	f	g	7		x	x																x	x		conflict with draft plan (street/lot layout)					
1,720	<i>Tilia cordata</i>	Little Leaf Linden	32.0			g	g	g	4																			x	x		conflict with draft plan (street/lot layout)					
1,721	<i>Acer saccharinum</i>	Silver Maple	77.0			g	g	g	10																			x	x		conflict with draft plan (street/lot layout)					
1,722	<i>Quercus macrocarpa</i>	Bur Oak	24.0	9.0		g	f	g	3		x	x																x	x		conflict with draft plan (street/lot layout)					
1,723	<i>Quercus macrocarpa</i>	Bur Oak	37.0			g	g	g	9																			x	x		conflict with draft plan (street/lot layout)					
1,724	<i>Quercus macrocarpa</i>	Bur Oak	98.0			f	f	g	9									x	x						x				x		conflict with draft plan (street/lot layout)			painted orange dot, pruned dead leader, callused wound at base		
1,725	<i>Quercus macrocarpa</i>	Bur Oak	25.0	23.0		g	g	g	6																			x	x		conflict with draft plan (street/lot layout)					
1,726	<i>Quercus macrocarpa</i>	Bur Oak	45.0			g	g	g	6																			x	x		conflict with draft plan (street/lot layout)					
1,727	<i>Quercus macrocarpa</i>	Bur Oak	23.0	16.0		f	p	p	2	30	x	x																	x		conflict with draft plan (street/lot layout)					
1,728	<i>Quercus macrocarpa</i>	Bur Oak	27.0			g	g	g	7																			x	x		conflict with draft plan (street/lot layout)					
1,729	<i>Quercus macrocarpa</i>	Bur Oak	47.0			g	g	g	7		x	x																x	x		conflict with draft plan (street/lot layout)					
1,730	<i>Quercus macrocarpa</i>	Bur Oak	55.0	49.0		g	g	g	7																x			x	x		conflict with draft plan (street/lot layout)			painted orange dot, acquire permit from City for removal		
1,731	<i>Morus alba</i>	White Mulberry	18.0	17.0		g	f	f	3	20			s															x	x		conflict with draft plan (street/lot layout)					
1,732	<i>Quercus macrocarpa</i>	Bur Oak	25.0			f	f	f	3	20	x	x																	x		conflict with draft plan (street/lot layout)					
1,733	<i>Quercus macrocarpa</i>	Bur Oak	30.0			g	g	f	4	15																		x	x		conflict with draft plan (street/lot layout)					
1,734	<i>Quercus rubra</i>	Red Oak	65.0			g	g	g	8																			x	x		conflict with draft plan (street/lot layout)					
1,735	<i>Acer negundo</i>	Manitoba Maple	37.0	17,17,31,18		f	f	g	7																x				x		conflict with draft plan (street/lot layout)			acquire written permission from owner and City prior to removal		
1,736	<i>Juglans nigra</i>	Black Walnut	39.0			g	g	g	5																			x	x		conflict with draft plan (street/lot layout)					
1,737	<i>Juglans nigra</i>	Black Walnut	40.0			g	g	g	5																			x	x		conflict with draft plan (street/lot layout)					
1,738	<i>Quercus macrocarpa</i>	Bur Oak	29.0			g	g	f	3	20																		x	x		conflict with draft plan (street/lot layout)					
1,739	<i>Pinus strobus</i>	White Pine	25.0			g	g	g	4	10																		x	x		conflict with draft plan (street/lot layout)					
1,740	<i>Juniperus virginiana</i>	Eastern Red Cedar	15.0			g	g	g	2																			x	x		conflict with draft plan (street/lot layout)					
1,741	<i>Pinus strobus</i>	White Pine	15.0			g	g	g	2																			x	x		conflict with draft plan (street/lot layout)					
1,742	<i>Morus alba</i>	White Mulberry	45.0			f	f	g	4		x	x																	x		conflict with draft plan (street/lot layout)					
1,743	<i>Quercus macrocarpa</i>	Bur Oak	34.0			g	g	g	4																			x	x		conflict with draft plan (street/lot layout)					
1,744	<i>Morus alba</i>	White Mulberry	31.0	17,19		f	f	g	6		x	x																	x		conflict with draft plan (street/lot layout)					
1,745	<i>Morus alba</i>	White Mulberry	35.0			p	p	g	4																				x		conflict with draft plan (street/lot layout)			split at 2 metres		
1,746	<i>Morus alba</i>	White Mulberry	22.0	12.0		g	g	g	3																			x	x		conflict with draft plan (street/lot layout)					
1,747	<i>Morus alba</i>	White Mulberry	15.0	13.0		g	f	g	3																											

TAG#	Scientific Name	Common Name	DBH (cm)	Additional Stems	Estimation of DBH (x)	CONDITION																				Location			Meets City Compensation Criteria	Remove	Protect	Impacted	Rationale	TPZ, if applicable	ESASARA	COMMENTS		
						TI	CS	CV	Radial Dripline (m)	Canopy Die Back (%)	Co-dominant stem	Included Bark	Lean, Dir.	Fungus	Insects	Cavity	Rot	Wound	Frost Crack	Epicormic	EAB	Canker	Suppressed	PFW	Hazard	Boundary Tree	Municipal Ownership	GPS corrected										
1,759	<i>Acer saccharinum</i>	Silver Maple	21.0			g	g	f	3	15															x				x	x		conflict with draft plan (street/lot layout)			acquire written permission from owner and City prior to removal			
1,760	<i>Acer saccharinum</i>	Silver Maple	27.0			g	g	g	3																	x				x	x		conflict with draft plan (street/lot layout)			acquire written permission from owner and City prior to removal		
1,761	<i>Picea glauca</i>	White Spruce	22.0			g	g	g	3																					x	x		conflict with draft plan (street/lot layout)					
1,762	<i>Picea glauca</i>	White Spruce	31.0			g	g	g	3																					x	x		conflict with draft plan (street/lot layout)					
1,763	<i>Picea glauca</i>	White Spruce	27.0			g	g	g	3																					x	x		conflict with draft plan (street/lot layout)					
1,764	<i>Picea glauca</i>	White Spruce	15.0			g	g	g	3																					x	x		conflict with draft plan (street/lot layout)					
1,765	<i>Acer saccharinum</i>	Silver Maple	33.0			g	g	g	6																					x	x		conflict with draft plan (street/lot layout)					
1,766	<i>Fraxinus pennsylvanica</i>	Red Ash	21.0			d	d	d																							x		conflict with draft plan (street/lot layout)					
1,767	<i>Fraxinus pennsylvanica</i>	Red Ash	28.0			d	d	d																							x		conflict with draft plan (street/lot layout)					
1,768	<i>Picea glauca</i>	White Spruce	24.0			g	g	g	4																					x	x		conflict with draft plan (street/lot layout)					
1,769	<i>Picea glauca</i>	White Spruce	16.0			g	g	g	4																					x	x		conflict with draft plan (street/lot layout)					
1,770	<i>Picea glauca</i>	White Spruce	20.0			g	g	g	4																					x	x		conflict with draft plan (street/lot layout)					
1,771	<i>Picea glauca</i>	White Spruce	26.0			g	g	g	4																					x	x		conflict with draft plan (street/lot layout)					
1,772	<i>Fraxinus pennsylvanica</i>	Red Ash	25.0			d	d	d																							x		conflict with draft plan (street/lot layout)					
1,773	<i>Thuja occidentalis</i>	Eastern White Cedar	18.0			g	g	g	2																					x	x		conflict with draft plan (street/lot layout)					
1,774	<i>Fraxinus pennsylvanica</i>	Red Ash	27.0			d	d	d																							x		conflict with draft plan (street/lot layout)					
1,775	<i>Fraxinus pennsylvanica</i>	Red Ash	25.0			d	d	d																							x		conflict with draft plan (street/lot layout)					
1,776	<i>Fraxinus pennsylvanica</i>	Red Ash	23.0			d	d	d																							x		conflict with draft plan (street/lot layout)					
1,777	<i>Thuja occidentalis</i>	Eastern White Cedar polygon	20, 11, 15, 13, 17, 18, 12, 15, 15, 15			g	g	g	2																						x	x		conflict with draft plan (street/lot layout)				
1,778	<i>Acer saccharinum</i>	Silver Maple	27.0			g	g	g	6																						x	x		conflict with draft plan (street/lot layout)				
1,779	<i>Acer saccharinum</i>	Silver Maple	41.0			g	g	g	6																						x	x		conflict with draft plan (street/lot layout)				
1,780	<i>Acer saccharinum</i>	Silver Maple	32.0			g	g	g	6																						x	x		conflict with draft plan (street/lot layout)				
1,781	<i>Acer saccharinum</i>	Silver Maple	23.0	17.0		p	g	g	6																						x		conflict with draft plan (street/lot layout)					
1,782	<i>Picea glauca</i>	White Spruce	15.0			g	g	g	3																						x	x		conflict with draft plan (street/lot layout)				
1,783	<i>Picea glauca</i>	White Spruce	16.0			p	g	g	3																						x		conflict with draft plan (street/lot layout)			split		
1,784	<i>Acer saccharinum</i>	Silver Maple	23.0			g	g	g	4																						x	x		conflict with draft plan (street/lot layout)				
1,785	#N/A	White Spruce polygon	22, 16, 16, 18, 18, 22, 18			g	g	g	2																						x	x		conflict with draft plan (street/lot layout)				
1,786	<i>Acer saccharinum</i>	Silver Maple	34.0			g	g	g	6																						x	x		conflict with draft plan (street/lot layout)				
1,787	<i>Acer saccharinum</i>	Silver Maple	34.0			g	g	g	7																						x	x		conflict with draft plan (street/lot layout)				
1,788	<i>Acer saccharinum</i>	Silver Maple	32.0			p	g	g	7																							x		conflict with draft plan (street/lot layout)				
1,789	<i>Acer saccharinum</i>	Silver Maple	21.0			g	g	g	6																						x	x		conflict with draft plan (street/lot layout)				
1,790	<i>Salix sp.</i>	Willow	61.0	39,33,23,42,55,50		f	f	g	9																							x		conflict with draft plan (street/lot layout)			sprawling	
1,791	<i>Acer saccharinum</i>	Silver Maple	25.0			g	g	g	3				e																		x	x		conflict with draft plan (street/lot layout)				
1,792	<i>Acer saccharinum</i>	Silver Maple	25.0			g	g	g	4																							x	x		conflict with draft plan (street/lot layout)			
1,793	<i>Acer saccharinum</i>	Silver Maple	49.0			g	g	g	6																	</												

TAG#	Scientific Name	Common Name	DBH (cm)	Additional Stems	Estimation of DBH (x)	CONDITION																				Location			Meets City Compensation Criteria	Remove	Protect	Impacted	Management			COMMENTS
						TI	CS	CV	Radial Dripline (m)	Canopy Die Back (%)	Co-dominant stem	Included Bark	Lean, Dir.	Fungus	Insects	Cavity	Rot	Wound	Frost Crack	Epicormic	EAB	Canker	Suppressed	PFW	Hazard	Boundary Tree	Municipal Ownership	GPS corrected					Rationale	TPZ, if applicable	ESASARA	
1,821	<i>Picea glauca</i>	White Spruce	18.0			g	g	g	3																	x	x			conflict with draft plan (street/lot layout)						
1,822	<i>Picea glauca</i>	White Spruce	16.0			g	g	g	3																	x	x			conflict with draft plan (street/lot layout)						
1,823	<i>Picea glauca</i>	White Spruce	26.0			g	g	g	3																	x	x			conflict with draft plan (street/lot layout)						
1,824	<i>Picea glauca</i>	White Spruce	18.0			g	g	g	3																	x	x			conflict with draft plan (street/lot layout)						
1,825	<i>Picea glauca</i>	White Spruce	28.0			g	g	g	3																	x	x			conflict with draft plan (street/lot layout)						
1,826	<i>Picea glauca</i>	White Spruce	14.0			g	g	g	3																		x				conflict with draft plan (street/lot layout)					
1,827	<i>Picea glauca</i>	White Spruce	13.0			g	g	g	3																		x				conflict with draft plan (street/lot layout)					
1,828	<i>Picea glauca</i>	White Spruce	12.0			g	g	g	3																		x				conflict with draft plan (street/lot layout)					
1,829	<i>Picea glauca</i>	White Spruce	12.0			g	g	g	3																		x				conflict with draft plan (street/lot layout)					
1,830	<i>Picea glauca</i>	White Spruce	12.0			g	g	g	3																		x				conflict with draft plan (street/lot layout)					
1,831	<i>Picea glauca</i>	White Spruce	13.0			g	g	g	3																		x				conflict with draft plan (street/lot layout)					
1,832	<i>Picea glauca</i>	White Spruce	16.0			g	g	g	3																	x	x			conflict with draft plan (street/lot layout)						
1,833	<i>Picea glauca</i>	White Spruce	17.0			g	g	g	3																	x	x			conflict with draft plan (street/lot layout)						
1,834	<i>Picea glauca</i>	White Spruce	10.0			g	g	g	3																		x				conflict with draft plan (street/lot layout)					
1,835	<i>Picea glauca</i>	White Spruce	14.0			g	g	g	3																		x				conflict with draft plan (street/lot layout)					
1,836	<i>Juniperus virginiana</i>	Eastern Red Cedar	10.0			g	f	p	1	80																	x				conflict with draft plan (street/lot layout)					
1,837	<i>Juniperus virginiana</i>	Eastern Red Cedar	10.0			g	f	p	1	80																	x				conflict with draft plan (street/lot layout)					
1,838	<i>Juniperus virginiana</i>	Eastern Red Cedar	10.0			g	f	p	1	80																	x				conflict with draft plan (street/lot layout)					
1,839	<i>Juniperus virginiana</i>	Eastern Red Cedar	11.0			g	f	p	1	80																	x				conflict with draft plan (street/lot layout)					
1,840	<i>Juniperus virginiana</i>	Eastern Red Cedar	11.0			g	f	p	1	80																	x				conflict with draft plan (street/lot layout)					
1,841	<i>Juniperus virginiana</i>	Eastern Red Cedar	10.0			g	f	p	1	80																	x				conflict with draft plan (street/lot layout)					
1,842	<i>Juniperus virginiana</i>	Eastern Red Cedar	12.0			g	f	p	1	80																	x				conflict with draft plan (street/lot layout)					
1,843	<i>Fraxinus pennsylvanica</i>	Red Ash	10.0			d	d	d	2																		x				conflict with draft plan (street/lot layout)					
1,844	<i>Morus alba</i>	White Mulberry	11.0			g	g	g	3																		x				conflict with draft plan (street/lot layout)					
1,845	<i>Morus alba</i>	White Mulberry	14.0	12.0		g	g	g	3																		x				conflict with draft plan (street/lot layout)					
1,846	<i>Acer saccharinum</i>	Silver Maple	14.0			g	g	g	3															x			x				conflict with draft plan (street/lot layout)			obtain permission from owner and City prior to removal		
1,847	<i>Fraxinus pennsylvanica</i>	Red Ash	11.0	10,10		d	d	d	2																		x				conflict with draft plan (street/lot layout)					
1,848	<i>Fraxinus pennsylvanica</i>	Red Ash	18.0			d	d	d	2																		x				conflict with draft plan (street/lot layout)					
1,849	<i>Fraxinus pennsylvanica</i>	Red Ash	12.0			p	p	p	2	90																	x				conflict with draft plan (street/lot layout)					
1,850	<i>Picea glauca</i>	White Spruce	13.0			g	g	g	3																		x				conflict with draft plan (street/lot layout)					
1,851	<i>Picea glauca</i>	White Spruce	17.0			g	g	g	3																	x	x			conflict with draft plan (street/lot layout)						
1,852	<i>Picea glauca</i>	White Spruce	15.0			g	g	g	3																	x	x			conflict with draft plan (street/lot layout)						
1,853	<i>Picea glauca</i>	White Spruce	24.0			g	g	g	3																	x	x			conflict with draft plan (street/lot layout)						
1,854	<i>Picea glauca</i>	White Spruce	14.0			g	g	g	3																		x				conflict with draft plan (street/lot layout)					
1,855	<i>Picea glauca</i>	White Spruce	19.0			g	g	g	3																	x	x			conflict with draft plan (street/lot layout)						
1,856	<i>Picea glauca</i>	White Spruce	13.0			g	g	g	3																		x				conflict with draft plan (street/lot layout)					
1,857	<i>Picea glauca</i>	White Spruce	23.0			g	g	g	3																	x	x			conflict with draft plan (street/lot layout)						
1,858	<i>Picea glauca</i>	White Spruce	18.0			g	g	g	3																	x	x			conflict with draft plan (street/lot layout)						
1,859	<i>Picea glauca</i>	White Spruce	17.0			g	g	g	3																	x	x			conflict with draft plan (street/lot layout)						
1,860	<i>Picea glauca</i>	White Spruce	17.0			g	g	g	3																	x	x			conflict with draft plan (street/lot layout)			obtain permission from owner and City prior to removal			
1,861	<i>Picea glauca</i>	White Spruce	18.0			g	g	g	3																	x	x			conflict with draft plan (street/lot layout)			obtain permission from owner and City prior to removal			
1,862	<i>Picea glauca</i>	White Spruce	21.0			g	g	g	3																	x	x			conflict with draft plan (street/lot layout)			obtain permission from owner and City prior to removal			
1,863	<i>Picea glauca</i>	White Spruce	13.0			g	g	g	3																	x	x			conflict with draft plan (street/lot layout)			obtain permission from owner and City prior to removal			
1,864	<i>Picea glauca</i>	White Spruce	12.0			g	g	g	3																	x	x			conflict with draft plan (street/lot layout)			obtain permission from owner and City prior to removal			
1,865	<i>Picea glauca</i>	White Spruce	21.0			g	g	g	3																	x	x			conflict with draft plan (street/lot layout)			obtain permission from owner and City prior to removal			
1,866	<i>Picea glauca</i>	White Spruce	16.0			g	g	g	3																	x	x			conflict with draft plan (street/lot layout)			obtain permission from owner and City prior to removal			
1,867	<i>Picea glauca</i>	White Spruce	19.0			g	g	g	3																	x	x			conflict with draft plan (street/lot layout)			obtain permission from owner and City prior to removal			
1,868	<i>Picea</i>																																			

Legend		Condition	
DBH (cm)	Diameter at breast height	G	Good
TI	Trunk Integrity	F	Fair
CS	Crown Structure	P	Poor
CV	Crown Vigour	D	Dead
DL (m)	Drip Line	L	Light
CDB	Crown Dieback	M	Moderate
EAB	Emerald Ash Borer	H	Heavy
ESA/SARA	Species at Risk	E	East
TPZ	Tree Protection Zone	W	West
Lean Dir.	Lean Direction	N	North
		S	South
		F	Frost
		C	Compression
		T	Tension
		S	Shear Plane