

Legend

- Sanitary
- Storm
- Water

Proposed Water Service to pass under 2m depth tree corridor: **No conflict**

Existing Hydrant to Remain

Existing Municipal Sidewalk

Property Line

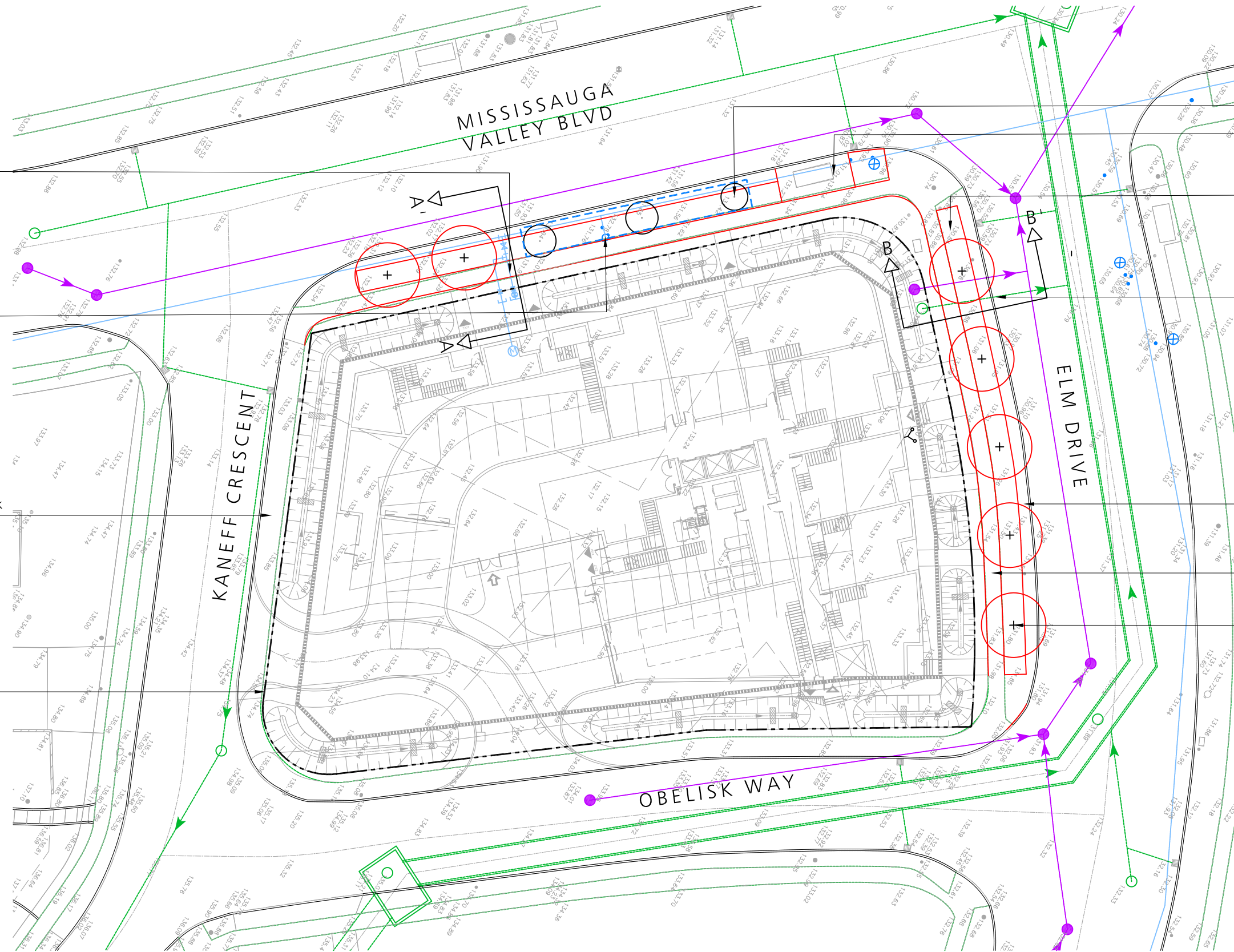

Existing Street Trees to Remain. See TPP by BTi

Existing Bus Shelter To Remain

2 m Wide Street Tree Corridor Per City Standards (typ.)

Existing Storm and Sanitary Connections under 2m depth tree corridor: **No conflict**

0.75 m Minimum Concrete Splash Edge Per City Standards (typ.)

Concrete Sidewalk Per City Standards (typ.)

High Branching Deciduous Street Tree (typ.)

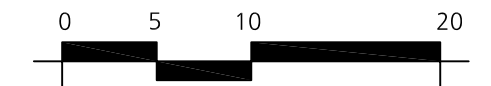

SK-01 STREETScape PLAN

3575 KANEFF CRESCENT

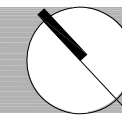

21 May 2020
As Shown
BTi 1486



Landscape Architecture | Site Design

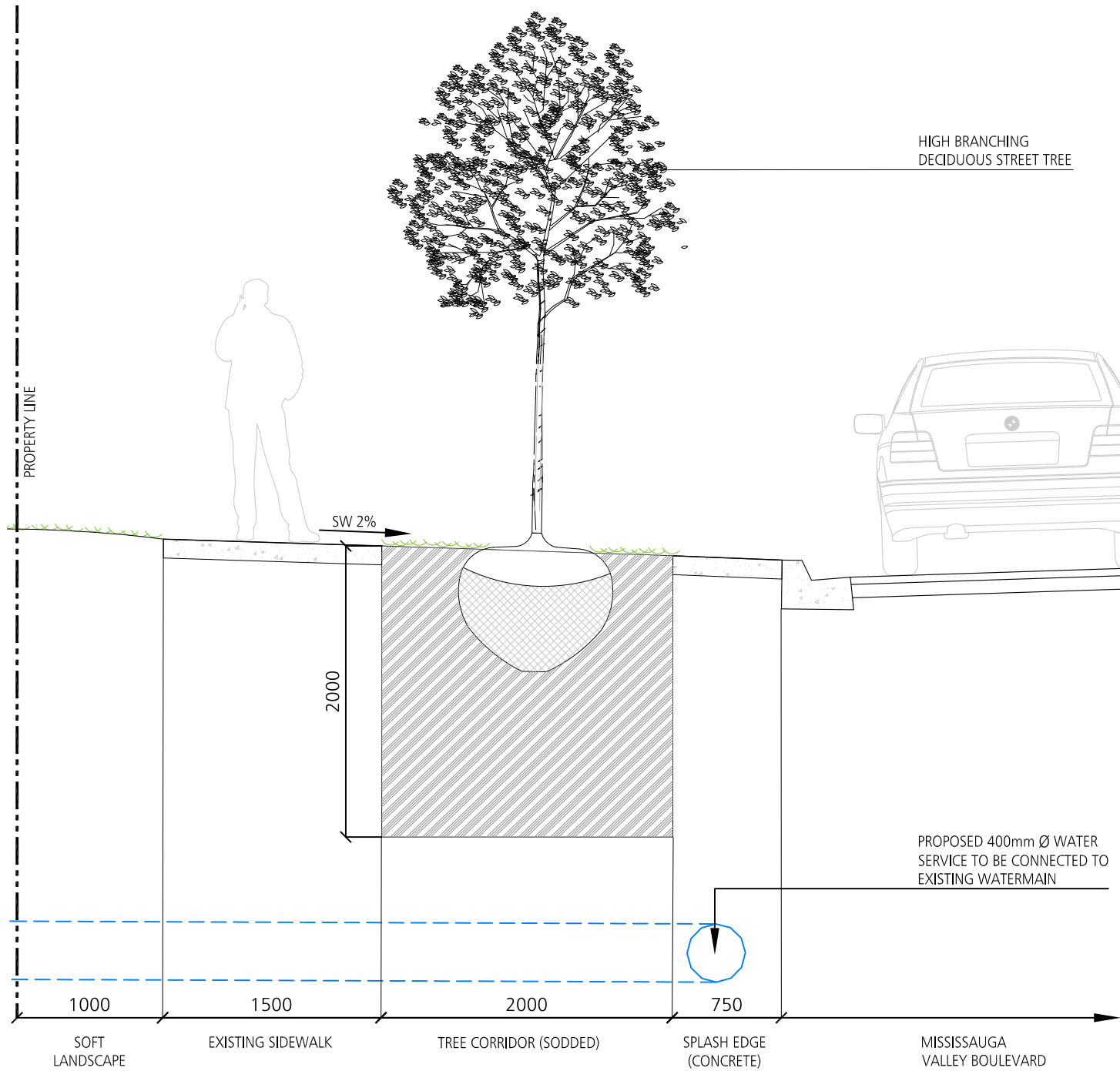

Section A - A'
Scale 1:40

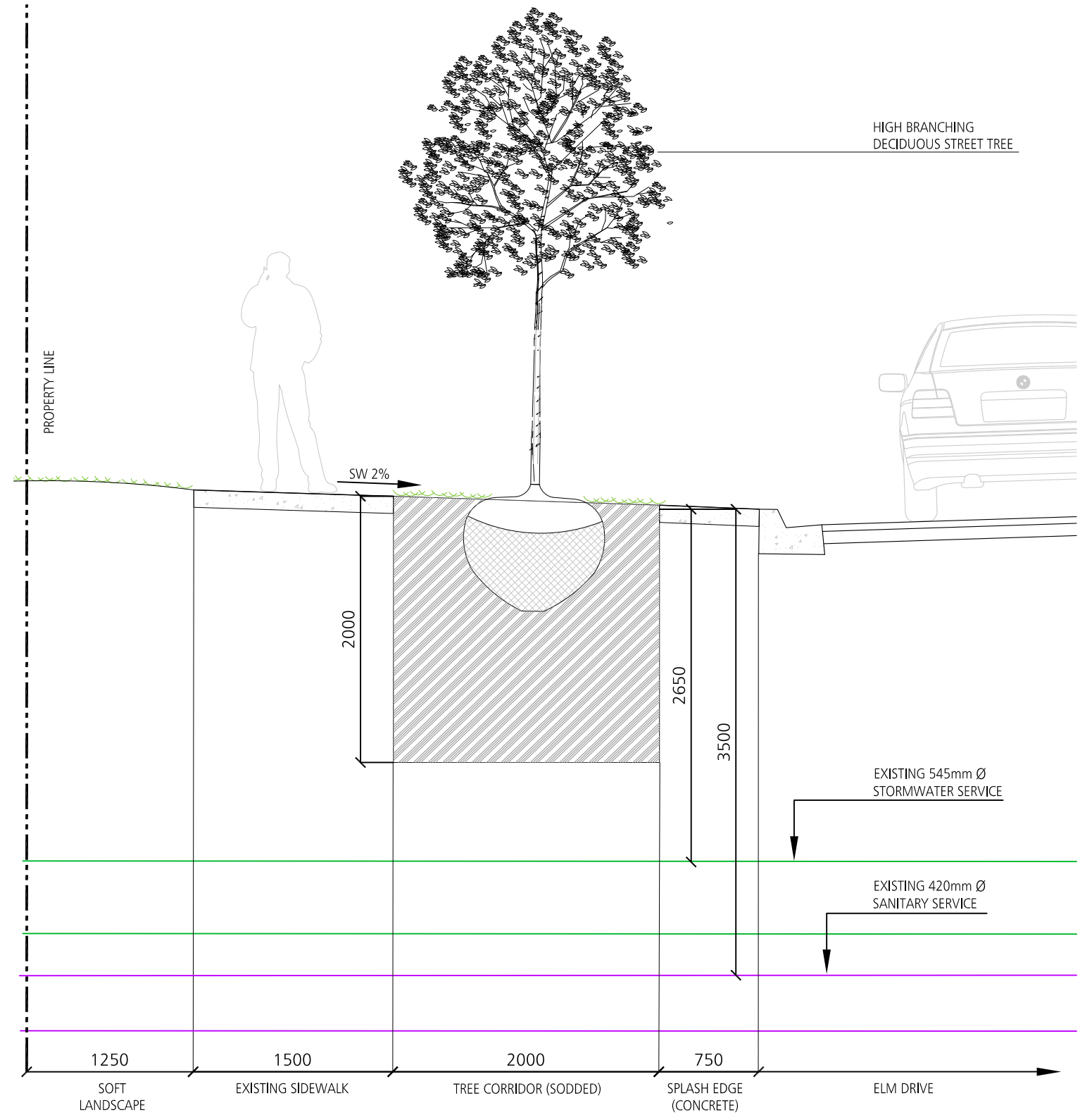

Section B - B'
Scale 1:40

SK-02 STREETScape SECTIONS

3575 KAN EFF CRESCENT

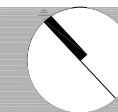

21 May 2020
As Shown
BTi 1486



Landscape Architecture | Site Design