

**1444
1458**

**1444-1458 CAWTHRA ROAD
MISSISSAUGA, ON**

© Copyright KFA Architects and Planners Inc., all rights reserved. No part of this document whether printed form or supplied as digital data may be reproduced, stored in a retrieval system or transmitted in any form or by any means, mechanical, photocopying, recording or otherwise without the prior written permission of KFA Architects and Planners Inc.. All dimensions to be checked on site by the contractor. Drawings are not to be scaled, and any discrepancies are to be reported to the Architect before proceeding with the work.

1	Issue to Consultants	2018.09.12
2	Issue for OPI/RZ	2018.09.28
3	Issued for Review	2019.08.13

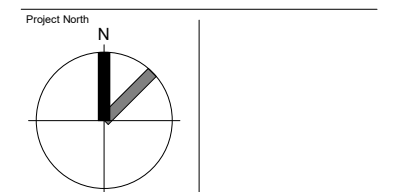
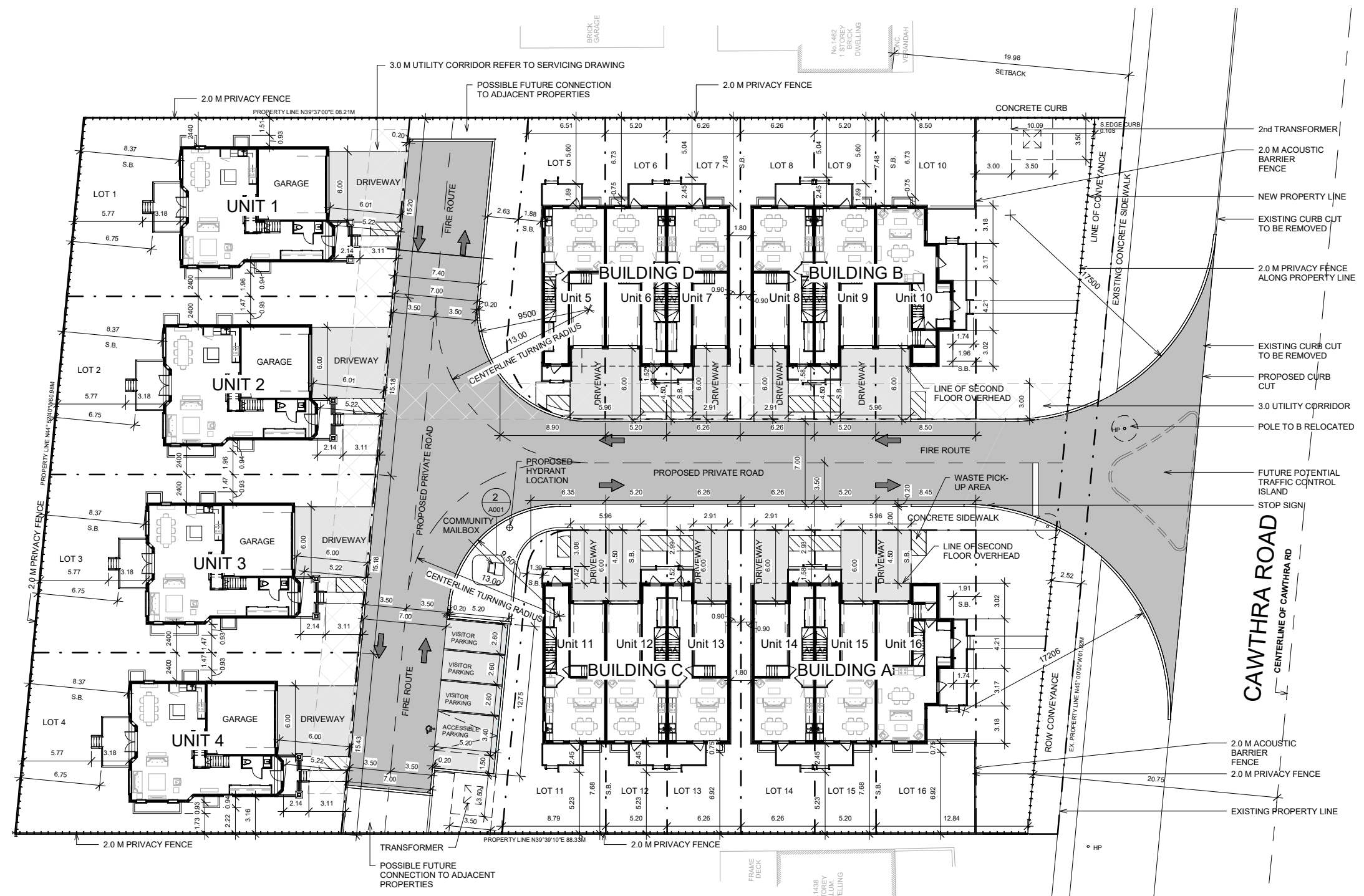

Project No: 16071
 Scale: As indicated
 Date: 2017/04/05
 Drawn by: R.V.W.
 Drawing Title

- NOTES:**
- THIS SITE HAS BEEN PREPARED IN ACCORDANCE WITH THE CITY OF MISSISSAUGA ZONING BYLAW NO. FOR STORM WATER MANAGEMENT. SITE SERVING AND GRADING INFORMATION REFER TO DRAWINGS PREPARED BY LITHOS GROUP INC. 150 BERRARDSEY ROAD UNIT #200 TORONTO ON, M4A 1Y1 FOR LANDSCAPE INFORMATION. REFER TO DRAWINGS PREPARED BY JOHN RUSSO LANDSCAPE ARCHITECT SURVEY CREDIT
 - INFORMATION TAKEN FROM PLAN OF PART OF LOTS 188, 189, 190 & 191 REGISTERED PLAN B-19, CITY OF MISSISSAUGA PREPARED BY: TOM A. SENKUS ONTARIO LAND SURVEYOR, 40 BURROWS AVENUE TORONTO (ISLINGTON), ON M9B 4W7
 - ANY GRADE ELEVATIONS ARE SHOWN FOR REFERENCE ONLY, REFER TO GRADING AND SITE SERVING PLAN FOR GRADING AND UIG SERVICES
 - ALL SITE AREA LIGHTING TO BE DIRECTED DOWNWARD AND DEFLECTED AWAY FROM ADJACENT LOTS ROADS AND STREETS
 - ALL CURBING AND DRIVEWAY ENTRANCES TO BE DESIGNED IN ACCORDANCE WITH THE CITY'S MATERIALS STANDARDS AND SPECIFICATIONS MANUAL
 - GUARD RAILS IN ACCORDANCE TO THE OBC 2012 SHALL BE PROVIDED WHENEVER GRADE DEFERENCE EXCEEDS 600MM DETAILS TO BE SUBMITTED AND BUILDING PERMIT STAGE.
 - BOULEVARD TO BE REINSTATED IN ACCORDANCE WITH CITY STANDARDS AND TO THE SATISFACTION OF THE CHIEF ENGINEER, EXECUTIVE DIRECTOR OF ENGINEERING AND CONSTRUCTION SERVICES
 - EXISTING WATER SERVICE TO BE DISCONNECTED BY THE CITY OF MISSISSAUGA
 - SNOW WILL BE REMOVED OFF SITE
 - SITE SERVICES DISCLAIMER**
BE ADVISED THAT SHOULD ANY PARTY INCLUDING THE APPLICANT OR ANY SUBSEQUENT OWNER, APPLY FOR MORE THAN ONE CONDOMINIUM CORPORATION ENCOMPASSING ANY OR ALL OF THIS DEVELOPMENT OR MAKE AN APPLICATION THAT RESULTS IN A LAND DIVISION, STAFF MAY REQUIRE LEGAL ASSURANCES, INCLUDING BUT NOT LIMITED TO EASEMENTS WITH RESPECT TO THE APPROVED SERVICES, SUCH ASSURANCES WILL BE DETERMINED AT THE TIME OF THE APPLICATION FOR CONDOMINIUM APPROVAL.

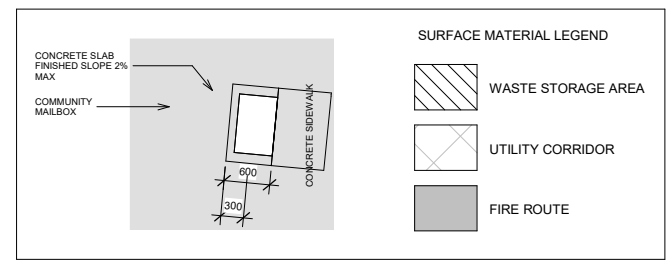

2 Community Mailbox Plan
1 : 50

Site Plan

A001