

NOTES TO CONTRACTOR:

- 1. INSPECTION**
CONTRACTOR IS RESPONSIBLE FOR CONTACTING ENGINEER 48 HRS PRIOR TO COMMENCING WORK TO ARRANGE FOR INSPECTION. ENGINEER TO DETERMINE DEGREE OF INSPECTION AND TESTING REQUIRED FOR CERTIFICATION OF UNDERGROUND SERVICE INSTALLATION AS MANDATED BY ONTARIO BUILDING CODE DIVISION C, PART 1, SECTION 1.2.2, GENERAL REVIEW. FAILURE TO NOTIFY ENGINEER WILL RESULT IN EXTENSIVE POST CONSTRUCTION INSPECTION AT CONTRACTORS EXPENSE.
- 2. CONFIRMATION OF EXISTING INVERTS**
72 HOURS PRIOR TO THE START OF CONSTRUCTION, THE CONTRACTOR IS TO LOCATE, EXPOSE AND VERIFY INVERTS OF EXISTING SEWERS AT CONNECTION POINTS. SHOULD THE CONTRACTOR PROCEED WITHOUT COMPLETING THESE LOCATES, EXTRA COSTS RESULTING FROM DELAYS AND STANDBY TIME WILL NOT BE CONSIDERED.

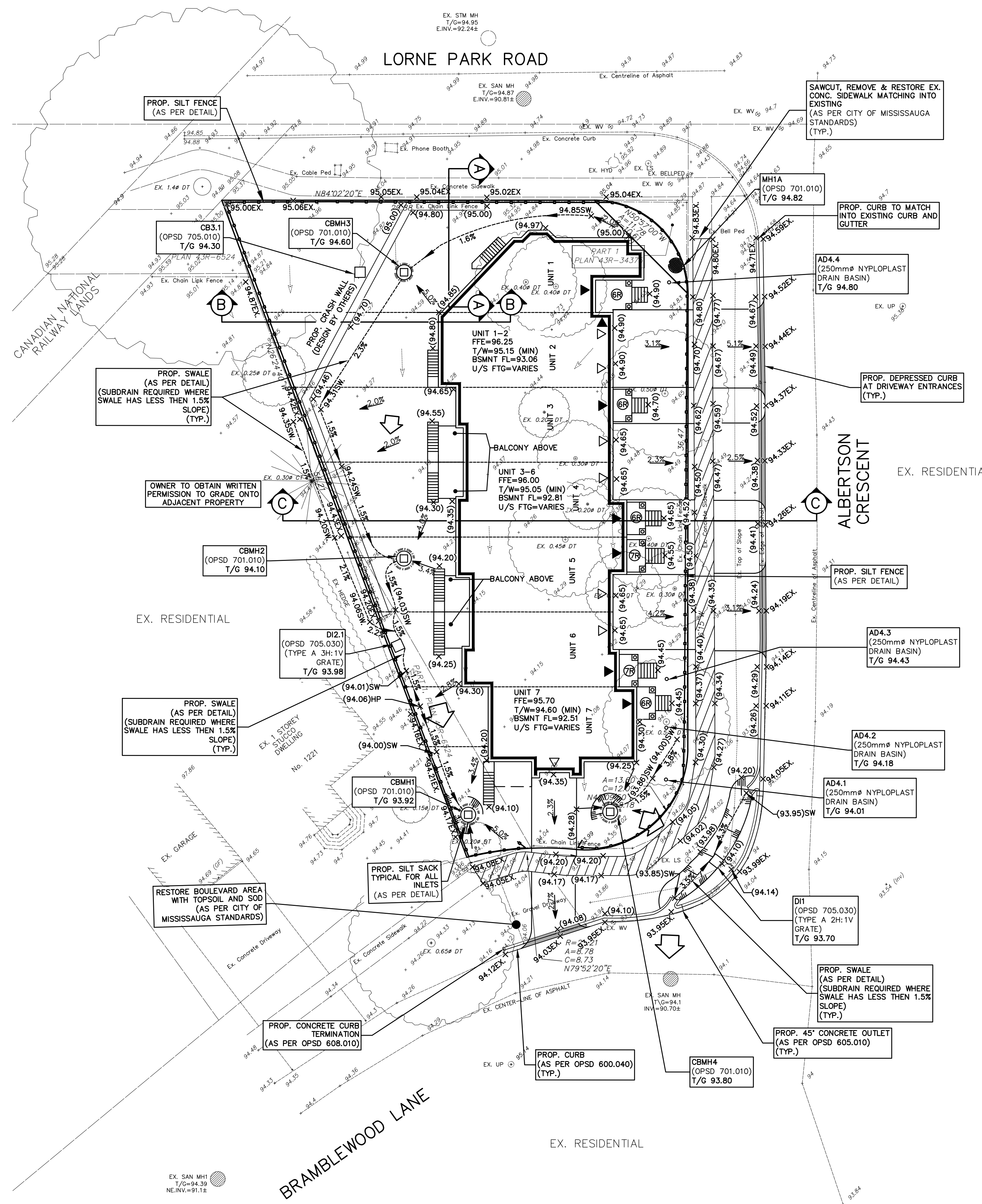

LEGEND:

- EXISTING GROUND ELEVATION
- X(100.00) PROPOSED GROUND ELEVATION
- X100.00EX PROPOSED ELEVATION TO MATCH EXISTING
- X(100.00)SW PROPOSED SWALE ELEVATION
- 2.0% PROPOSED DIRECTION OF SHEET FLOW
- EXISTING CATCHBASIN
- EXISTING STORM/SANITARY MANHOLE
- PROPOSED CATCHBASIN
- PROPOSED STORM/SANITARY MANHOLE
- PROPOSED CATCHBASIN MANHOLE
- EMERGENCY OVERLAND FLOW ROUTE
- EXISTING DIRECTION OF SHEET FLOW
- PROPOSED SILTATION CONTROL FENCE
- PROPOSED CATCHBASIN SILT SACK
- 3:1 MAX SLOPE

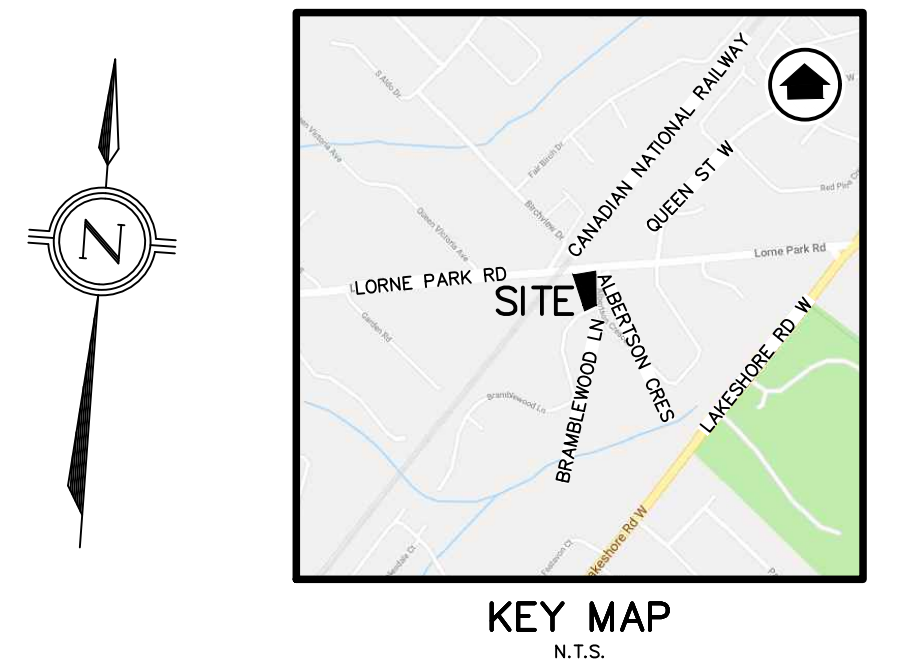

BENCH MARK NOTE:
CITY OF MISSISSAUGA BENCHMARK No. 132 (CGVD 1928 : PRE 1978)
LOCATED ON THE SOUTH FACE AT THE EAST CORNER OF A RED BRICK HOUSE, No. 1023, ON THE NORTH SIDE OF LORNE PARK ROAD, 68 METRES WEST OF LAKESHORE ROAD WEST.
ELEVATION 93.63m.

NO.	DATE	BY	REVISIONS
04	08/28/20	SD	REVISED PER CITY COMMENTS
03	01/14/20	SD	REVISED PER CITY COMMENTS
02	11/22/19	SD	REVISED PER CITY COMMENTS
01	09/14/18	SD	ISSUED FOR OWNERS REVIEW

- NOTES TO CONTRACTOR:**
- CONTRACTORS AND SUBCONTRACTORS SHALL NOT SCALE FROM THIS DRAWING.
 - ANY INCONSISTENCIES AND OMISSIONS FOUND ON THE DRAWINGS MUST BE REPORTED TO THE ENGINEER FOR CLARIFICATION BEFORE COMMENCING THE WORK.
 - PRIOR TO THE START OF CONSTRUCTION, THE CONTRACTOR MUST CHECK AND VERIFY ALL DIMENSIONS AND ELEVATIONS AND REPORT ALL FINDINGS TO THE ENGINEER. ONCE CONSTRUCTION HAS COMMENCED, THE CONTRACTOR ACCEPTS RESPONSIBILITY FOR ALL DIMENSIONS, ELEVATIONS, AND SITE CONDITIONS.
 - THE POSITIONS OF POLE LINES, CONDUITS, WATERMANS, SEWERS AND OTHER UNDERGROUND AND OVER-GROUND UTILITIES AND STRUCTURES ARE NOT NECESSARILY SHOWN ON THE DRAWINGS, WHICH SHOWN ON THE DRAWING, THE ACCURACY OF THE POSITION OF SUCH UTILITIES AND STRUCTURES IS NOT GUARANTEED. BEFORE STARTING WORK, THE CONTRACTOR SHALL INFORM THEMSELVES OF THE EXACT LOCATION OF ALL SUCH UTILITIES AND STRUCTURES AND ASSUME ALL LIABILITY FOR DAMAGE TO THEM.
 - ALL DRAWINGS REMAIN THE PROPERTY OF THE ENGINEER AND SHALL NOT BE REPRODUCED, REVISED, OR REVISED WITHOUT THE WRITTEN CONSENT OF S. LLEWELLYN AND ASSOCIATES LIMITED.

DESIGN	AGM	CHK'D	AGM	DATE
DRAWN	SD	CHK'D	AGM	SEPT 6, 2018

SCALE 1:200

APPROVALS

STAMP
LICENSED PROFESSIONAL ENGINEER
28-AUG-2020
J. G. ORESKOWIC
PROFESSIONAL ENGINEER OF ONTARIO

S. LLEWELLYN & ASSOCIATES LIMITED
CONSULTING ENGINEERS
3228 South Service Road, Suite #105 East Wing, Burlington, Ont., L7N 3H8
Tel. (905) 631-6978
Fax (905) 631-8927
email: info@sla.on.ca

CLIENT
JACAN CONSTRUCTION LTD.
UNIT 28, 1860 APPEBY LINE,
BURLINGTON, ON

PROJECT NAME
PROPOSED TOWNHOUSES
1110 LORNE PARK ROAD,
MISSISSAUGA, ON
FILE: OZ 19/006 W2

TITLE
SITE GRADING & EROSION
CONTROL PLAN

PROJECT No. 18091	DRAWING No. C101
----------------------	---------------------